



CIVIL GEOTECHNICAL SERVICES
ABN 26 474 013 724
PO Box 678 Croydon Vic 3136
Telephone: 9723 0744 Facsimile: 9723 0799

8th February 2023

Our Reference: 22064:NB1453

Winslow Constructors Pty Ltd
50 Barry Road
CAMPBELLFIELD VIC 3061

Dear Sirs/Madams,

**RE: LEVEL 1 EARTHWORKS INSPECTION AND TESTING
ELLERY – STAGE 8 (WOLLERT)**

Please find attached our Report No 22064/R001 which relates to the field density testing that was conducted within the filled allotments at the above subdivision. The level 1 inspections and associated field density testing was performed in June 2022.

The inspections and testing of the earthworks was undertaken in general accordance with the Level 1 requirements of AS 3798 - Guidelines on Earthworks for Commercial and Residential Developments.

The site inspection and testing was performed by experienced geotechnicians from this office. Any areas that were deemed unsatisfactory were reworked and retested under their supervision. The testing was performed to the relevant Australian Standards and the accompanying test reports carry NATA endorsement. The attached compaction results, which were located randomly throughout the fill profile, are considered to be representative of the bulk fill materials that were placed across the reported allotments by Winslow Constructors during the aforementioned period. The approximate locations of the field density tests can be seen on the attached plan (Figure 1).

We are of the view that the bulk fill materials that have been placed across the reported allotments by Winslow Constructors during the aforementioned period can be considered as having been placed in a controlled manner to a minimum density ratio of 95% (standard compactive effort).

Please contact the undersigned if you require any additional information.

Civil Geotechnical Services

A handwritten signature in blue ink, appearing to be 'Nick Brock', written in a cursive style.

Nick Brock

FIGURE 1

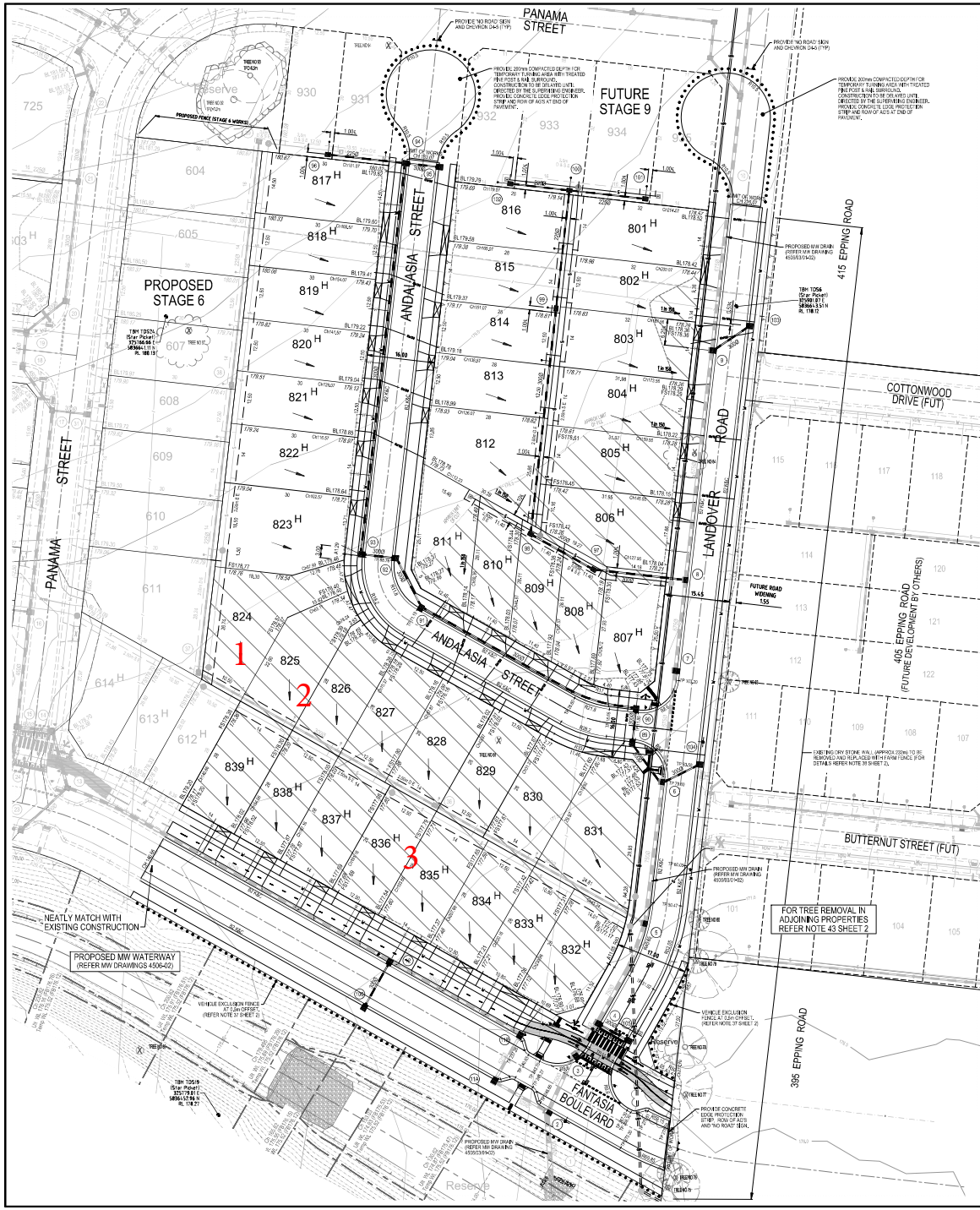

SERVICES OFFSETS AND LOCATIONS

STREET NAME	RESERVE	WATER		GAS	ELECTRICITY CABLES	FIBRE TO THE HOME		BL. OF KERB	JOINT TRENCHING	
		DW	NDW			FIBRE CABLES	FIBRE PITS			
FANTASIA BOULEVARD	25.00	3.30 N	2.75 N	2.25 N	2.75 S	1.00 BOK	1.85 S	1.85 N & S	8.85M, 55S	W & G, F & E
LANDOVER ROAD	15.80	1.85 E	3.00 E	2.00 E	2.75 E	3.20 W	1.30 BOK	2.45 W	1.95, 1.85, 2.05, 2.45 W	W & G, F & E
LANDOVER ROAD (Opp Lot 832)	17.80	3.20 E	2.70 E	2.25 E	2.80 W	1.50 BOK	1.85 W	1.85 W	4.05 W	W & G, F & E
ANDALASIA STREET	16.80	3.05 SW	2.55 SW	2.10 SW	2.80 N&E	0.90 BOK	1.85 N&E	1.85 N&E	4.20 SW, 4.20 N&E	W & G, F & E
COTTONWOOD DRIVE (FUT)	14.50	3.00 S	2.50 S	2.10 S	1.10 N	-	0.35 N	-	4.20 S, 4.20 N	W & G, F & E
BUTTERNUT STREET (FUT)	16.80	3.00 S	2.50 S	2.10 S	2.80 N	-	1.85 N	-	4.20 S, 4.20 N	W & G, F & E

NOTE: a) Landover offsets shown to current 15.45m road reserve width. v Indicates offsets from future eastern road reserve boundary (ie ultimate 17m road width).
 b) Street trees to be located in the centre of nature strips.
 c) Typical pole offsets shown. Refer electrical design plans for specific pole offsets.

DRAWING INDEX

SHT. No.	VER.	DESCRIPTION
1	E	LAYOUT PLAN & SERVICES SCHEDULE
2	C	NOTES, PAVEMENT COMPOSITION & DETAILS
3	B	INTERSECTION DETAILS & DETAIL NOTES
4	B	LONGITUDINAL & CROSS SECTIONS - FANTASIA BOULEVARD
5	B	LONGITUDINAL SECTION - LANDOVER ROAD and TYPICAL SECTIONS
6	B	CROSS SECTIONS - LANDOVER ROAD
7	B	LONGITUDINAL & CROSS SECTIONS - ANDALASIA STREET
8	B	DRAINAGE LONGITUDINAL SECTIONS
9	B	DRAINAGE LONGITUDINAL SECTIONS & FIT SCHEDULE
10	B	SEWAGE & LINDAMARKING PLAN

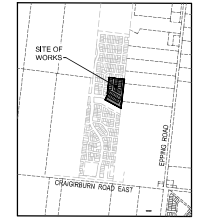

WARNING
 BEWARE OF UNDERGROUND SERVICES
 THE LOCATIONS OF UNDERGROUND SERVICES ARE APPROXIMATE ONLY AND THEIR EXACT POSITION SHOULD BE PROVEN ON SITE. NO GUARANTEE IS GIVEN THAT ALL EXISTING SERVICES ARE SHOWN.

ATTENTION TO CONTRACTOR

- IT IS THE CONTRACTORS RESPONSIBILITY TO ENSURE THAT THE DIGITAL PLAN PROVIDED FOR SETOUT PURPOSES, MATCHES THE TBM COORDINATES SHOWN.
- CONTRACTOR TO ENSURE THAT THE SITES PRESED AND OR SET OUT CHECKED BY THE LICENSED SURVEYOR RESPONSIBLE FOR CERTIFYING THE PLAN OF SUBMISSION PRIOR TO UNDERGROUND INFRASTRUCTURE BEING INSTALLED.
- WHERE CONCRETE WORKS ABOUT A SEWER ACCESS CHAMBER SURROUND OR SIMILAR STRUCTURE, AN EXPANSION JOINT OF APPROVED MATERIAL SHALL BE PROVIDED BETWEEN THE TWO FACES.

SYMBOL LEGEND

Drains <300		Ex/Natural F/S Level	
Sewer >300		FS @ Building Line	
Water		Top/Face of Batter	
House Drain		Top Ret. Wall Level	
Property Inlet		100yr Flood Level	
Street Sign		Retaining Wall	
Retaining Wall		Conduits 50mm	
Conduits 100mm		Cut Prop/Ex	
Ex Gas/Elect/Tel		ROCK RET WALL	
		SLEEPER RET WALL	

Approximate field density test location

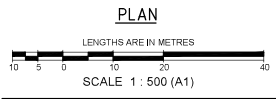

breese pitt dixon pty. ltd. land surveyors civil engineers		1/79 cote street hawthorn east, 3123 telephone 8823 2300 fax no. 8823 2310
ELLERY ESTATE STAGE 8 LAYOUT PLAN AND SERVICES SCHEDULE		MUNICIPALITY WHITTLESEA REFERENCE 8625 E/08
3.11.21 AMENDED EASEMENT/SEWER IN LOT 811 5/10/21 ESTATE NAME, ENBN OFFSETS & LANDOVER SHEET INDEX REVISED 12.10.20 SERVICES SCHEDULE (ELEC POLE O/S) AMENDED SHEET INDEX UPDATED 23.09.20 SERVICES TABLE REVISED (LANDOVER OPP LOT 832) 28.07.20 ISSUED FOR CONSTRUCTION	MELWAY REF. 389-B-11 SURVEY BPD DESIGN DG DRAWN DG	MUNICIPALITY SHEET 1 OF 10
VER. DATE 10/05/2024	REMARKS 10/05/2024	SCALE As Shown DATUM AHD DATE May'20 SHEET 1 OF 10

T:\Projects\BPP\B25\MyPlan\CAD\Drawings\Stage 8\B25_08_01_DET.dwg 09/2

Printed: Mon 05/05/2024 10:05:30 AM



COMPACTION ASSESSMENT

Job No 22064
 Report No 22064/R001
 Date Issued 04/07/2022

CIVIL GEOTECHNICAL SERVICES

6 - 8 Rose Avenue, Croydon 3136

Client	WINSLOW CONSTRUCTORS PTY LTD (CAMPBELLFIELD)	Tested by	AC
Project	ELLERY - STAGE 8	Date tested	28/06/22
Location	WOLLERT	Checked by	JHF

Feature	EARTHWORKS	Layer thickness	200 mm	Time: 13:27
---------	------------	-----------------	--------	-------------

Test procedure AS 1289.2.1.1 & 5.8.1

Test No	1	2	3	-	-	-
Location	REFER TO FIGURE 1	REFER TO FIGURE 1	REFER TO FIGURE 1			
Approximate depth below FSL						
Measurement depth	mm	175	175	175	-	-
Field wet density	t/m ³	1.96	1.99	1.99	-	-
Field moisture content	%	20.6	20.8	18.7	-	-

Test procedure AS 1289.5.7.1

Test No	1	2	3	-	-	-
Compactive effort	Standard					
Oversize rock retained on sieve	mm	19.0	19.0	19.0	-	-
Percent of oversize material	wet	0	0	0	-	-
Peak Converted Wet Density	t/m ³	2.00	2.06	2.05	-	-
Adjusted Peak Converted Wet Density	t/m ³	-	-	-	-	-
Optimum Moisture Content	%	20.5	22.5	20.5	-	-

Moisture Variation From Optimum Moisture Content	0.0%	1.5% dry	2.0% dry	-	-	-
--	------	----------	----------	---	---	---

density and moisture ratio results relate only to the soil to the depth of test and not to the full depth of the layer

Density Ratio (R _{HD})	%	98.0	96.5	96.5	-	-
-----------------------------------	---	------	------	------	---	---

Material description

No 1 - 3 Clay Fill

AVRLOT HILF V1.10 MAR 13



NATA Accredited Laboratory No 9909
 Accredited for compliance with
 ISO/IEC 17025 - Testing

Approved Signatory : Justin Fry