

**NOTES**

This plan was prepared as a provisional layout to accompany a development application. The information on this plan is not suitable for any other purpose.

Property dimensions, areas, numbers of lots and contours and other physical features shown have been compiled from existing information and may not have been verified by field survey. These may need verification if the development application is approved and development proceeds, and may change when a full survey is undertaken or in order to comply with development approval conditions.

No reliance should be placed on the information on this plan for detailed subdivision design or for any financial dealings involving the land.

The Saunders Havill Group therefore disclaims any liability for any loss or damage whatsoever or howsoever incurred, arising from any party using or relying upon this plan for any purpose other than as a document prepared for the sole purpose of accompanying a development application and which may be subject to alteration beyond the control of the Saunders Havill Group. Unless a development approval states otherwise, this is not an approved plan.

\* This note is an integral part of this plan/data. Reproduction of this plan or any part of it without this note being included in full will render the information shown on such reproduction invalid and not suitable for use.

- 2000m<sup>2</sup> - < 2500m<sup>2</sup>
- 2500m<sup>2</sup> - < 3000m<sup>2</sup>
- 3000m<sup>2</sup> - < 3500m<sup>2</sup>
- 3500m<sup>2</sup> - < 4000m<sup>2</sup>
- > 4000m<sup>2</sup>
- Open Space
- Q2 Floodline
- Q20 Floodline
- Q100 Floodline
- Buffer Areas
- Sub-Stage Boundary

**STATISTICS - STAGE 16 OVERALL**

No of Proposed Lots	82
Length New Road	2946 m
Total Area Parks	13.951 ha
Total Area New Road	6.698 ha
Area of Stage	49.53 ha

**STATISTICS - STAGE 16A**

No of Proposed Lots	39
Length New Road	1670 m
Total Area Parks	13.951 ha
Total Area New Road	4.095 ha
Area of Stage	31.56 ha

**STATISTICS - STAGE 16B**

No of Proposed Lots	18
Length New Road	496 m
Total Area Parks	Nil
Total Area New Road	9735 m <sup>2</sup>
Area of Stage	7.373 ha

**STATISTICS - STAGE 16C**

No of Proposed Lots	25
Length New Road	780 m
Total Area Parks	Nil
Total Area New Road	1.63 ha
Area of Stage	10.6 ha

No.	by	Date	Description
A	AJB	21/08/15	Original Issue
B	AJB	09/09/15	Statistics added

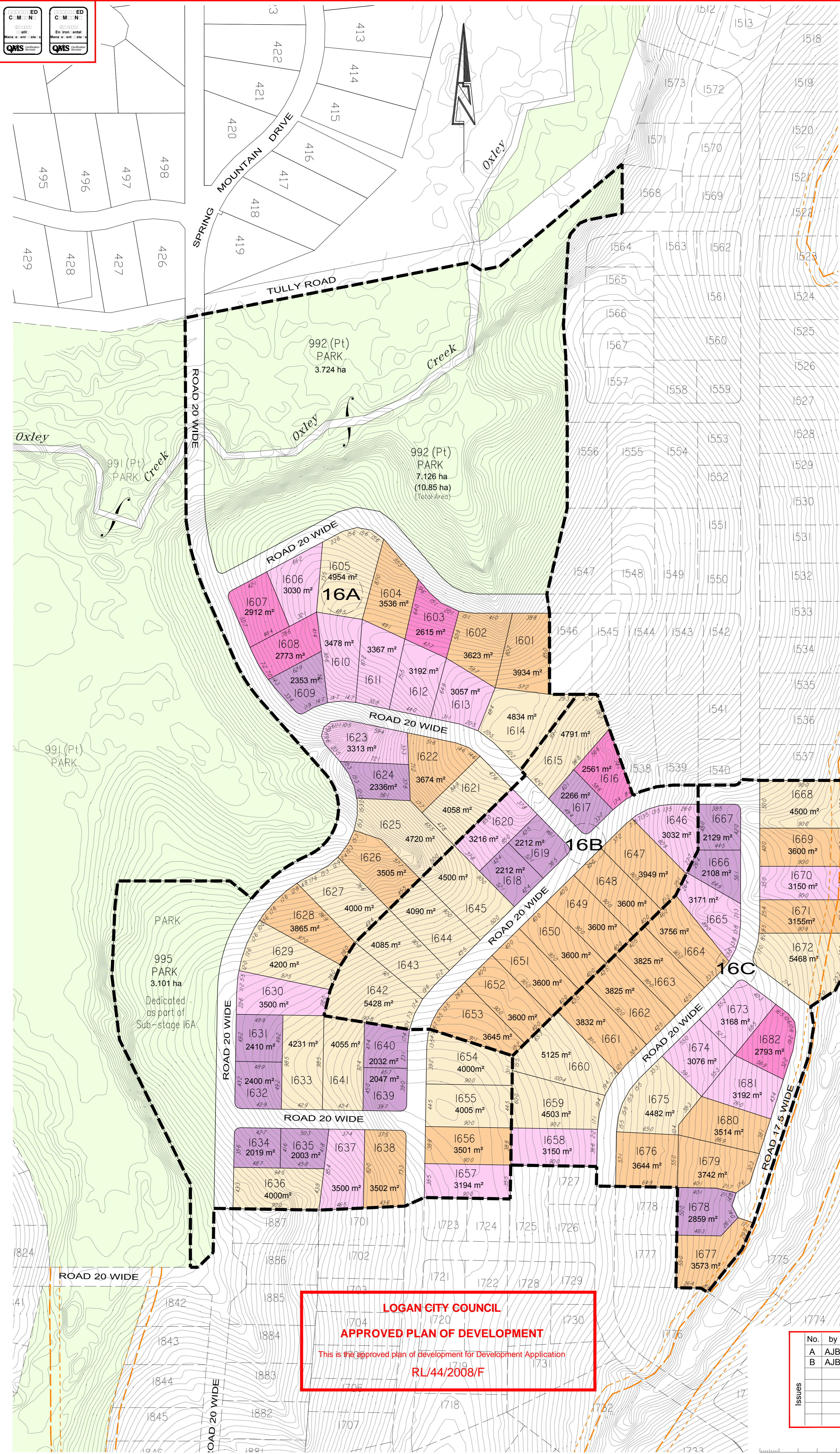

**LOGAN CITY COUNCIL**  
**APPROVED PLAN OF DEVELOPMENT**  
 This is the approved plan of development for Development Application  
**RL/44/2008/F**

Scale 1:2000 - Lengths are in Metres.

**saunders havill group**  
 Saunders Havill Group Pty Ltd ABN 24 144 972 949  
 Brisbane • Emerald • Gladstone  
 head office 9 Thompson St Bowen Hills Q 4006  
 phone 1300 123 SHG web www.saundershavill.com  
 ■ surveying ■ town planning ■ urban design ■ environmental management ■ landscape architecture

Plan of **SUB-STAGING PLAN STAGE 16**  
 Project **SPRING MOUNTAIN ESTATE - GREENBANK**  
 Client **MTAA Superannuation Fund (Flagstone Creek and Spring Mountain Park) Property Pty Ltd**

**town planning**  
 Scale @A1 1: 2000  
 @A3 1: 4000  
 Dwg No. **7081 P 04 PP B**