

Preliminary **SITE PLAN**

FOR PROPOSED LOT 1842

SPRING MOUNTAIN STAGE 18D

LEGEND

- Final surface contours based on A.H.D datum at an interval of 0.5m, shown as: --- 24.0 ---
- Natural surface contours in undisturbed areas at an interval of 1.0m shown: --- 24.0 ---
- Easement for Services and or Access **EMT**
- Earthworks Batter Top
 Toe
- Kerb/Kerb & Channel
- Drainage Line
- Drainage Pit
- Drainage Gully Pit
- Drainage MH
- Drainage Pit & Soakage Trench
- Water Line
- Water Conduit
- Water Service Point of Entry
- Water Stop Valve
- Fire Hydrant
- Underground Comms
- Comms Pit
- Underground Electricity
- Elec Box/Pit
- Street Light
- Indicative Driveway location
- Building Envelope in accordance with Approved Building Envelope Plan 7081 P06 BE A 14/10/2015 by Saunders Havill Group
- Q100 Flood Area

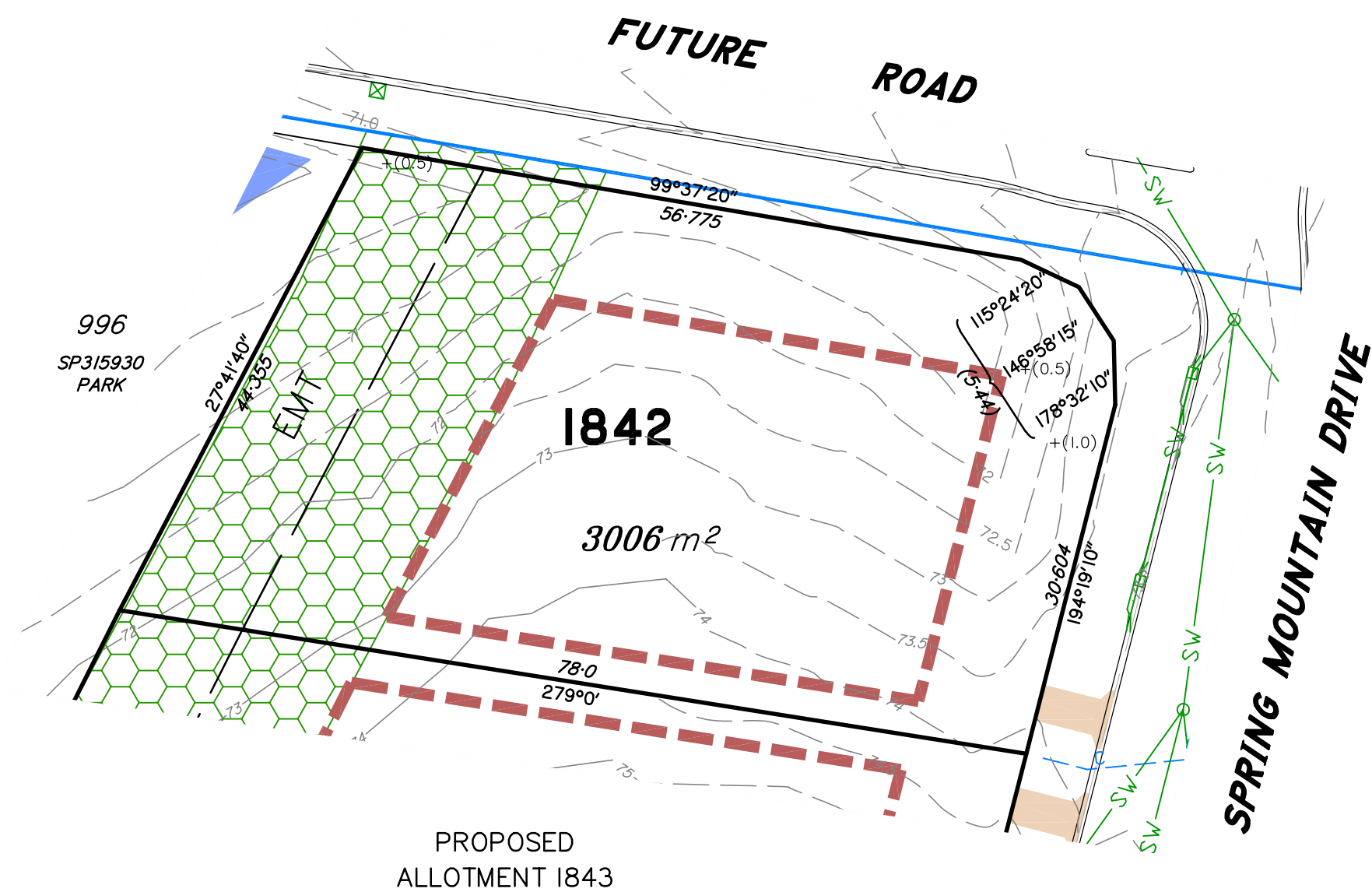

IMPORTANT NOTES:

This plan has been prepared for PEET Pty Ltd for the purposes of Discussion only. All areas and dimensions are subject to final survey and relevant authority approval.

Location of sewer, roofwater, stormwater, water reticulation, electricity and communication lines, manholes and pits, streetscaping, banks, batters, retaining walls, fencing, footpaths & building envelopes are as shown on engineering design drawings, supplied by KN Group Pty Ltd Consulting Engineers and may differ from the as constructed location. Levels and Contours shown are not to be used for building design or construction. A site survey is required.

For final building requirements the relevant approved Plan of Development prevail over this site plan.

These notes form an integral part of this plan and no part of this plan may be reproduced in whole or in part without these notes.

AMENDMENTS	
DESCRIPTION	DATE

State Protected Vegetation:

Area B4 shown on Technical Agency Response (Vegetation) Plan (TARP) 1902-9640-SPD dated 27/3/2019. No built structure, other than fences, roads and underground services are to be established within these areas.

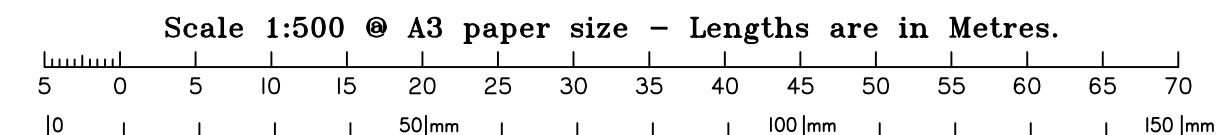

This plan is **NOT** a Disclosure Plan as set out in the Land Sales Act 1984 and is for General Information Only.

SCHLENCKER SURVEYING (QLD)
Gold Coast ♦ Brisbane ♦ Rockhampton
Consultants in Surveying, Mapping & Development

A.B.N. 36 909 833 411
PO Box 41, Helensvale QLD 4212.

Suite 206,
Helensvale Professional Centre
3 Sir John Overall Dr., Helensvale QLD 4212.

Ph.: (07) 5573 6744
Fax: (07) 5573 6755
Mob.: 0413 945 959
EMAIL: mail@ssq.net.au

SCALE @ A3 **1:500** DWG. NO. **15159-119-1842**

Preliminary **SITE PLAN**

FOR PROPOSED LOT 1844

SPRING MOUNTAIN STAGE 18D

LEGEND

- Final surface contours based on A.H.D datum at an interval of 0.5m, shown as: -24.0--
- Natural surface contours in undisturbed areas at an interval of 1.0m shown: 24.0
- Easement for Services and or Access **EMT**
- Earthworks Batter
- Kerb/Kerb & Channel
- Drainage Line
- Drainage Pit
- Drainage Gully Pit
- Drainage MH
- Drainage Pit & Soakage Trench
- Water Line
- Water Conduit
- Water Service Point of Entry
- Water Stop Valve
- Fire Hydrant
- Underground Comms
- Comms Pit
- Underground Electricity
- Elec Box/Pit
- Street Light
- Indicative Driveway location
- Building Envelope in accordance with Approved Building Envelope Plan 7081 P06 BE A 14/10/2015 by Saunders Havill Group
- Q100 Flood Area

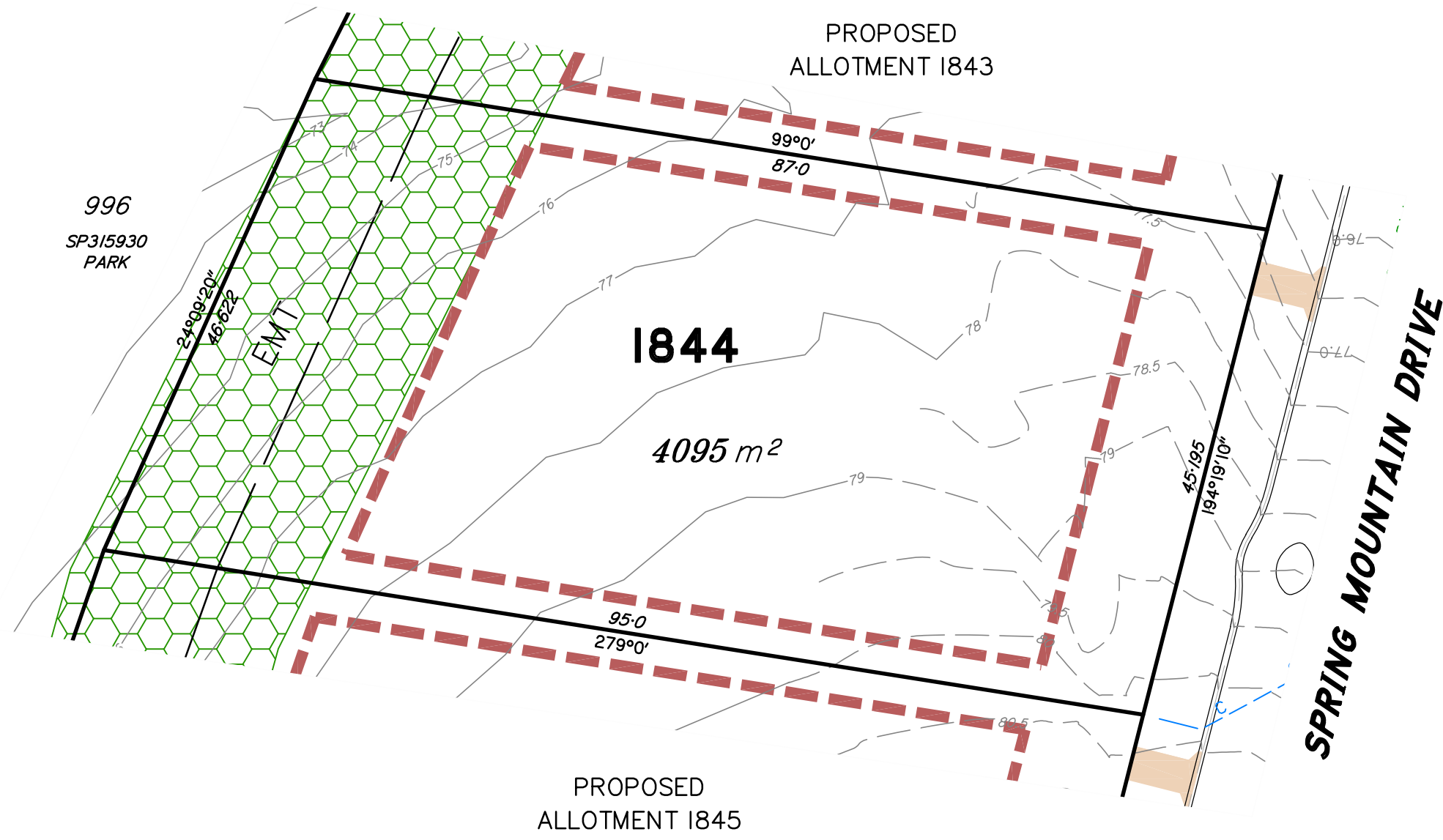

IMPORTANT NOTES:

This plan has been prepared for PEET Pty Ltd for the purposes of Discussion only. All areas and dimensions are subject to final survey and relevant authority approval. Location of sewer, roofwater, stormwater, water reticulation, electricity and communication lines, manholes and pits, streetscaping, banks, batters, retaining walls, fencing, footpaths & building envelopes are as shown on engineering design drawings, supplied by KN Group Pty Ltd Consulting Engineers and may differ from the as constructed location. Levels and Contours shown are not to be used for building design or construction. A site survey is required. For final building requirements the relevant approved Plan of Development prevail over this site plan. These notes form an integral part of this plan and no part of this plan may be reproduced in whole or in part without these notes.

AMENDMENTS

DESCRIPTION	DATE

State Protected Vegetation:
Area B4 shown on Technical Agency Response (Vegetation) Plan (TARP) 1902-9640-SPD dated 27/3/2019. No built structure, other than fences, roads and underground services are to be established within these areas.

SCHLENCKER SURVEYING (QLD)
Gold Coast ♦ Brisbane ♦ Rockhampton
Consultants in Surveying, Mapping & Development

A.B.N. 36 909 833 411
PO Box 41, Helensvale QLD 4212.
Suite 206,
Helensvale Professional Centre
3 Sir John Overall Dr., Helensvale QLD 4212.
Ph: (07) 5573 6744
Fax: (07) 5573 6755
Mob: 0413 945 959
EMAIL: mail@ssq.net.au

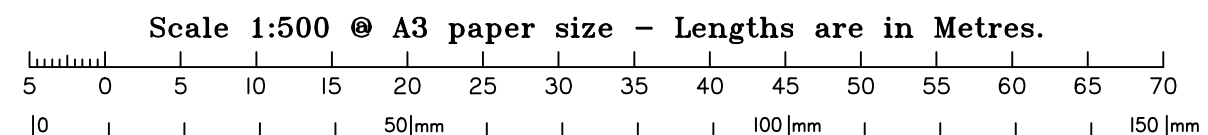

This plan is **NOT** a Disclosure Plan as setout in the Land Sales Act 1984 and is for General Information Only.

SCALE @ A3 **1:500** DWG. NO. **15159-119-1844**

Preliminary **SITE PLAN**

FOR PROPOSED LOT 1845

SPRING MOUNTAIN STAGE 18D

LEGEND

- Final surface contours based on A.H.D datum at an interval of 0.5m, shown as: -24.0--
- Natural surface contours in undisturbed areas at an interval of 1.0m shown: 24.0
- Easement for Services and or Access **EMT**
- Earthworks Batter
- Kerb/Kerb & Channel
- Drainage Line
- Drainage Pit
- Drainage Gully Pit
- Drainage MH
- Drainage Pit & Soakage Trench
- Water Line
- Water Conduit
- Water Service Point of Entry
- Water Stop Valve
- Fire Hydrant
- Underground Comms
- Comms Pit
- Underground Electricity
- Elec Box/Pit
- Street Light
- Indicative Driveway location
- Building Envelope in accordance with Approved Building Envelope Plan 7081 P06 BE A 14/10/2015 by Saunders Havill Group
- Q100 Flood Area

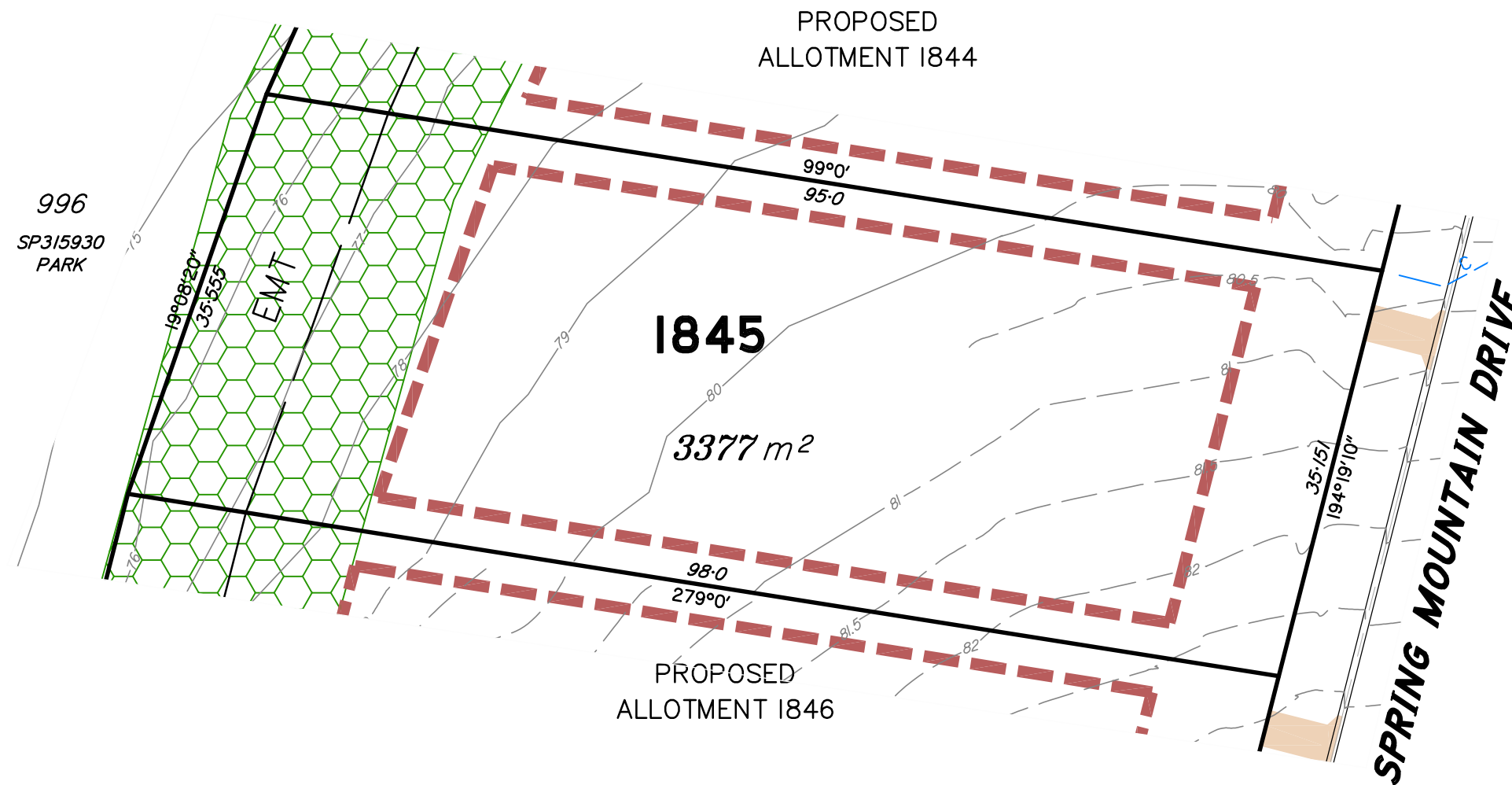

IMPORTANT NOTES:

This plan has been prepared for PEET Pty Ltd for the purposes of Discussion only. All areas and dimensions are subject to final survey and relevant authority approval.

Location of sewer, roofwater, stormwater, water reticulation, electricity and communication lines, manholes and pits, streetscaping, banks, batters, retaining walls, fencing, footpaths & building envelopes are as shown on engineering design drawings, supplied by KN Group Pty Ltd Consulting Engineers and may differ from the as constructed location. Levels and Contours shown are not to be used for building design or construction. A site survey is required.

For final building requirements the relevant approved Plan of Development prevail over this site plan.

These notes form an integral part of this plan and no part of this plan may be reproduced in whole or in part without these notes.

AMENDMENTS

DESCRIPTION	DATE

State Protected Vegetation:

Area B4 shown on Technical Agency Response (Vegetation) Plan (TARP) 1902-9640-SPD dated 27/3/2019. No built structure, other than fences, roads and underground services are to be established within these areas.

Scale 1:500 @ A3 paper size – Lengths are in Metres.

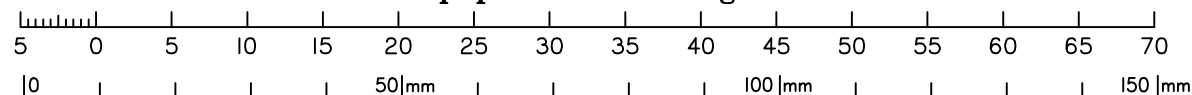

This plan is **NOT** a Disclosure Plan as set out in the Land Sales Act 1984 and is for General Information Only.

SCHLENCKER SURVEYING (QLD)

Gold Coast ♦ Brisbane ♦ Rockhampton
Consultants in Surveying,
Mapping & Development



A.B.N. 36 909 833 411
PO Box 41, Helensvale QLD 4212.

Suite 206,
Helensvale Professional Centre
3 Sir John Overall Dr., Helensvale QLD 4212.

Ph.: (07) 5573 6744
Fax: (07) 5573 6755
Mob.: 0413 945 959
EMAIL: mail@ssq.net.au

SCALE @ A3 **1:500**

DWG. NO. **15159-119-1845**

Preliminary **SITE PLAN**

FOR PROPOSED LOT 1846

SPRING MOUNTAIN STAGE 18D

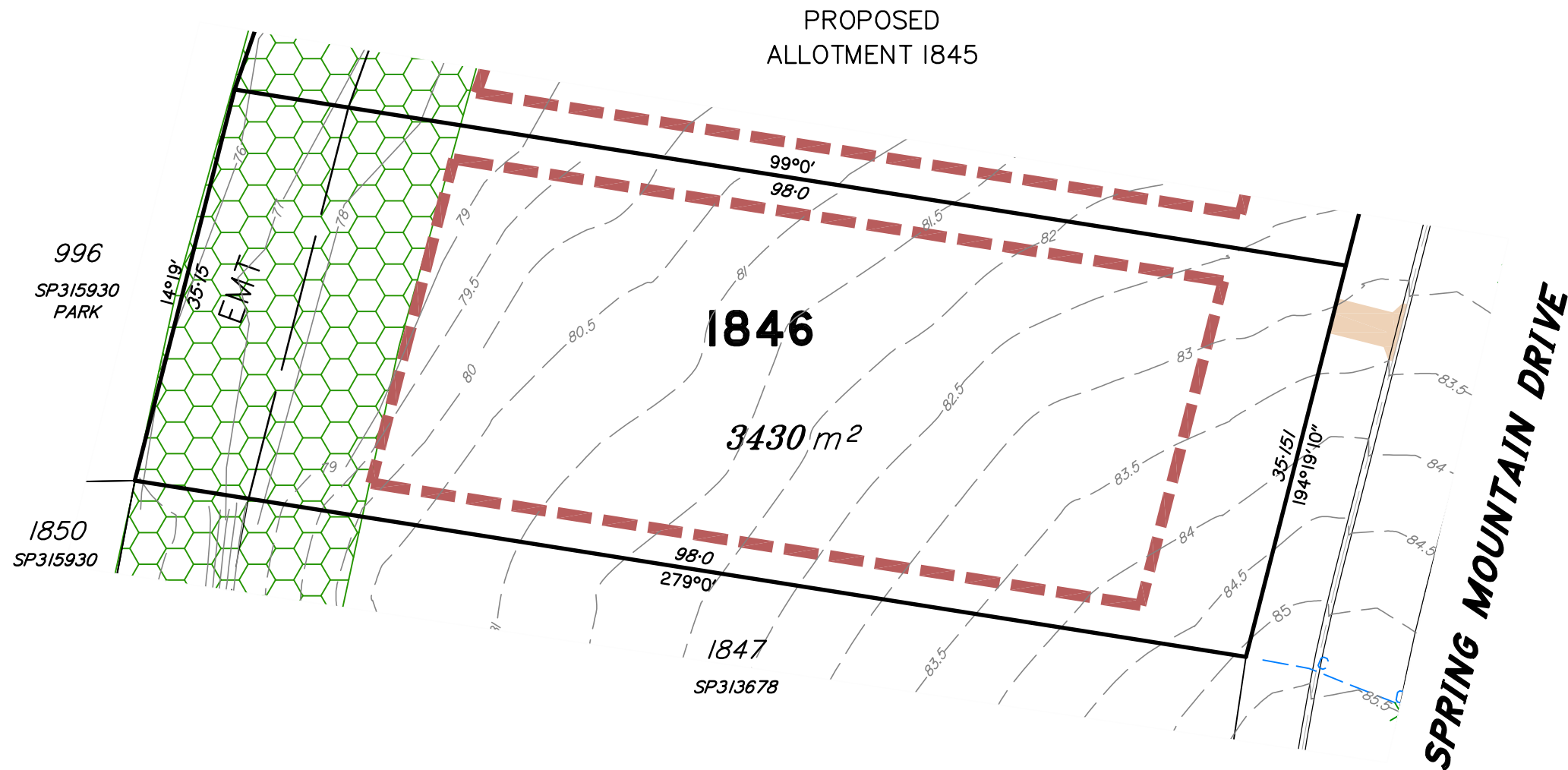

LEGEND

- Final surface contours based on A.H.D datum at an interval of 0.5m, shown as: ---24.0---
 - Natural surface contours in undisturbed areas at an interval of 1.0m shown: —24.0—
 - Easement for Services and or Access **EMT**
 - Earthworks Batter
 - Kerb/Kerb & Channel
 - Drainage Line
 - Drainage Pit
 - Drainage Gully Pit
 - Drainage MH
 - Drainage Pit & Soakage Trench
 - Water Line
 - Water Conduit
 - Water Service Point of Entry
 - Water Stop Valve
 - Fire Hydrant
 - Underground Comms
 - Comms Pit
 - Underground Electricity
 - Elec Box/Pit
 - Street Light
 - Indicative Driveway location
 - Building Envelope in accordance with Approved Building Envelope Plan 7081 P06 BE A 14/10/2015 by Saunders Havill Group
 - Q100 Flood Area
- INFORMATION NOT AVAILABLE AT THIS TIME

IMPORTANT NOTES:

This plan has been prepared for PEET Pty Ltd for the purposes of Discussion only.
 All areas and dimensions are subject to final survey and relevant authority approval.
 Location of sewer, roofwater, stormwater, water reticulation, electricity and communication lines, manholes and pits, streetscaping, banks, batters, retaining walls, fencing, footpaths & building envelopes are as shown on engineering design drawings, supplied by KN Group Pty Ltd Consulting Engineers and may differ from the as constructed location. Levels and Contours shown are not to be used for building design or construction. A site survey is required.
 For final building requirements the relevant approved Plan of Development prevail over this site plan.
 These notes form an integral part of this plan and no part of this plan may be reproduced in whole or in part without these notes.

AMENDMENTS

DESCRIPTION	DATE

State Protected Vegetation:

Area B4 shown on Technical Agency Response (Vegetation) Plan (TARP) 1902-9640-SPD dated 27/3/2019. No built structure, other than fences, roads and underground services are to be established within these areas.

Scale 1:500 @ A3 paper size – Lengths are in Metres.

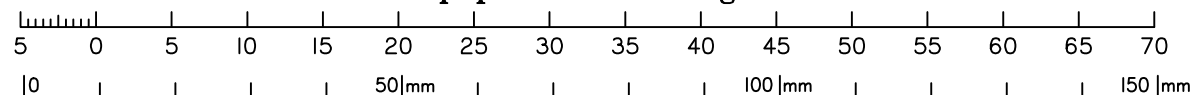

This plan is **NOT** a Disclosure Plan as set out in the Land Sales Act 1984 and is for General Information Only.

SCHLENCKER SURVEYING (QLD)

Gold Coast ♦ Brisbane ♦ Rockhampton

Consultants in Surveying,
Mapping & Development



A.B.N. 36 909 833 411
PO Box 41, Helensvale QLD 4212.

Suite 206,
Helensvale Professional Centre
3 Sir John Overall Dr., Helensvale QLD 4212.

Ph.: (07) 5573 6744
Fax: (07) 5573 6755
Mob.: 0413 945 959
EMAIL: mail@ssq.net.au

SCALE @ A3 **1:500**

DWG. NO. **15159-119-1846**