

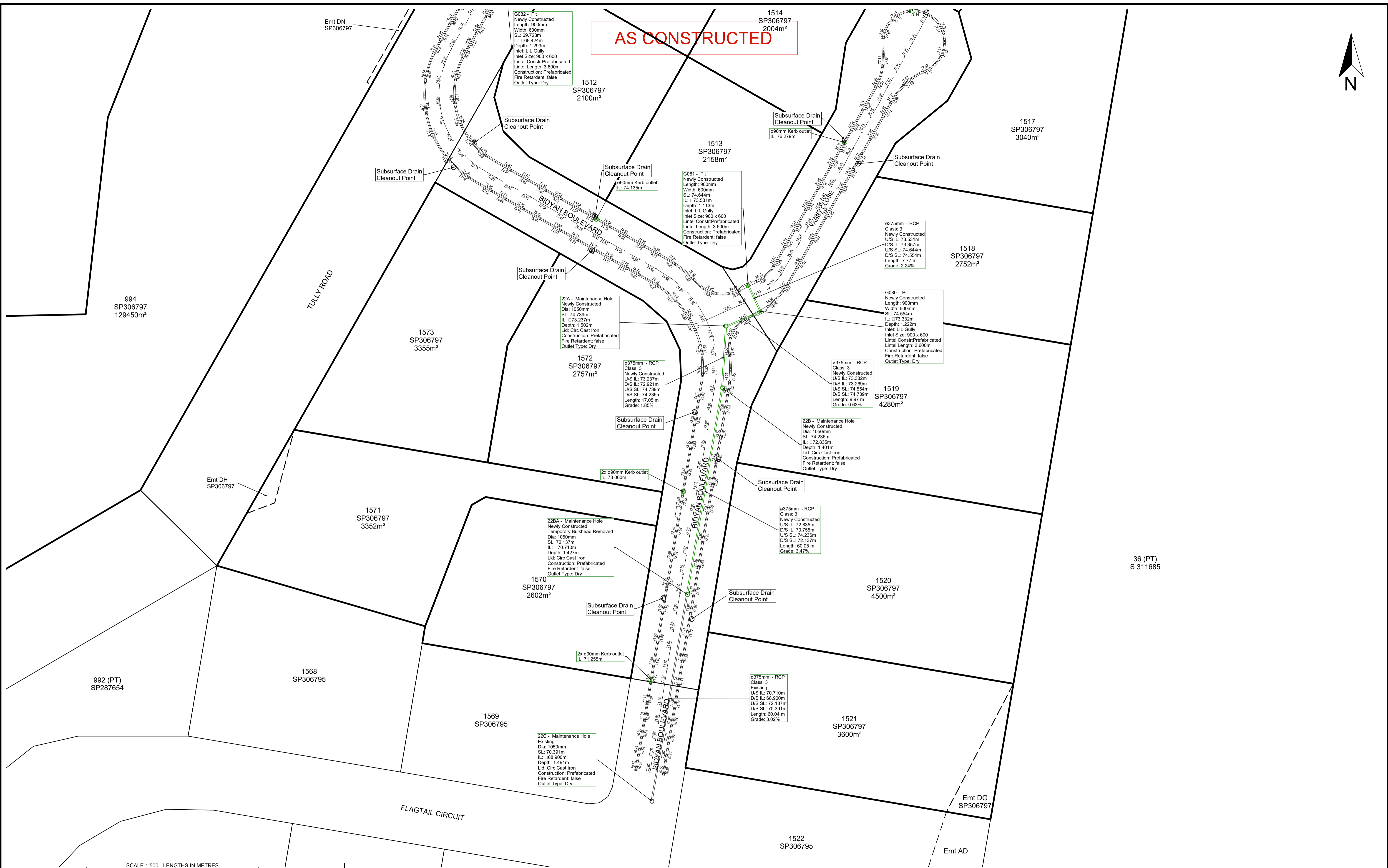

**AS CONSTRUCTED**



SCALE 1:500 - LENGTHS IN METRES

A1	INDEX	DATE	REVISIONS	DRAWN	CHECKED	PASSED

**SCHLENCKER SURVEYING (QLD)**  
 Gold Coast - Brisbane  
 Consultants in Surveying, Mapping & Development

A.B.N. 38 909 833 411  
 PO Box 41,  
 Helensvale QLD 4212.

Suite 206,  
 Helensvale Professional Centre  
 3 Sir John Overall Dr.,  
 Helensvale QLD 4212. EMAIL: mail@ssq.net.au

Ph: (07) 5573 6744  
 Fax: (07) 5573 6755  
 Mob: 0413 945 959

**REGISTERED SURVEYOR'S CERTIFICATION**

Schlencker Surveying (Qld) Pty Ltd (ACN 063 830 642), hereby certify that the horizontal and vertical locations, and dimensions shown in the plans contained in this electronic submission are a true and correct record of the As-constructed information.

*[Signature]*  
 Director (sig.)

Date: 26/05/2023  
 Reg. Surveyor No. 3337

**REGISTERED ENGINEER'S CERTIFICATION**

I, \_\_\_\_\_ hereby certify that the As-constructed information shown on the plans contained in this electronic submission is a true and correct record of the sizes, types, materials, classes etc., and it corresponds with the relevant approved Engineering Drawings.

Project Name  
 Company  
 Consultant: KN GROUP  
 RPEQ/CPeng Membership No.

Date: \_\_\_\_\_

This Plan has been prepared for Logan City Council for the purpose of recording the As Constructed details of a new service constructed under a specific Council Approval and should not be used for any other purpose. No report is made on any other services, nor any services that may exist before or be constructed after, the time of survey, or constructed under any other approval. The property boundaries, easements and lot numbers shown hereon may be proposed only and subject to registration by the Department of Natural Resources & Mines. All property information should be determined from the registered Survey Plans.

THIS NOTE IS AN INTEGRAL PART OF THIS PLAN.

### STORMWATER AS CONSTRUCTED

**STAGE 15C  
 SPRING MOUNTAIN**  
 OW/242/2021

LOCAL AUTHORITY	LOGAN CITY COUNCIL
LOCALITY	NEW BEITH
LEVEL DATUM	AHD DERIVED
LEVEL ORIGIN	PM180644 RL: 77.302 m
SURVEYED	TR, JM, RB
DRAWN	ASS
SCALE	1:1000 SHEET 1 OF 3
DRAWING NO.	15159 - 126



**AS CONSTRUCTED**

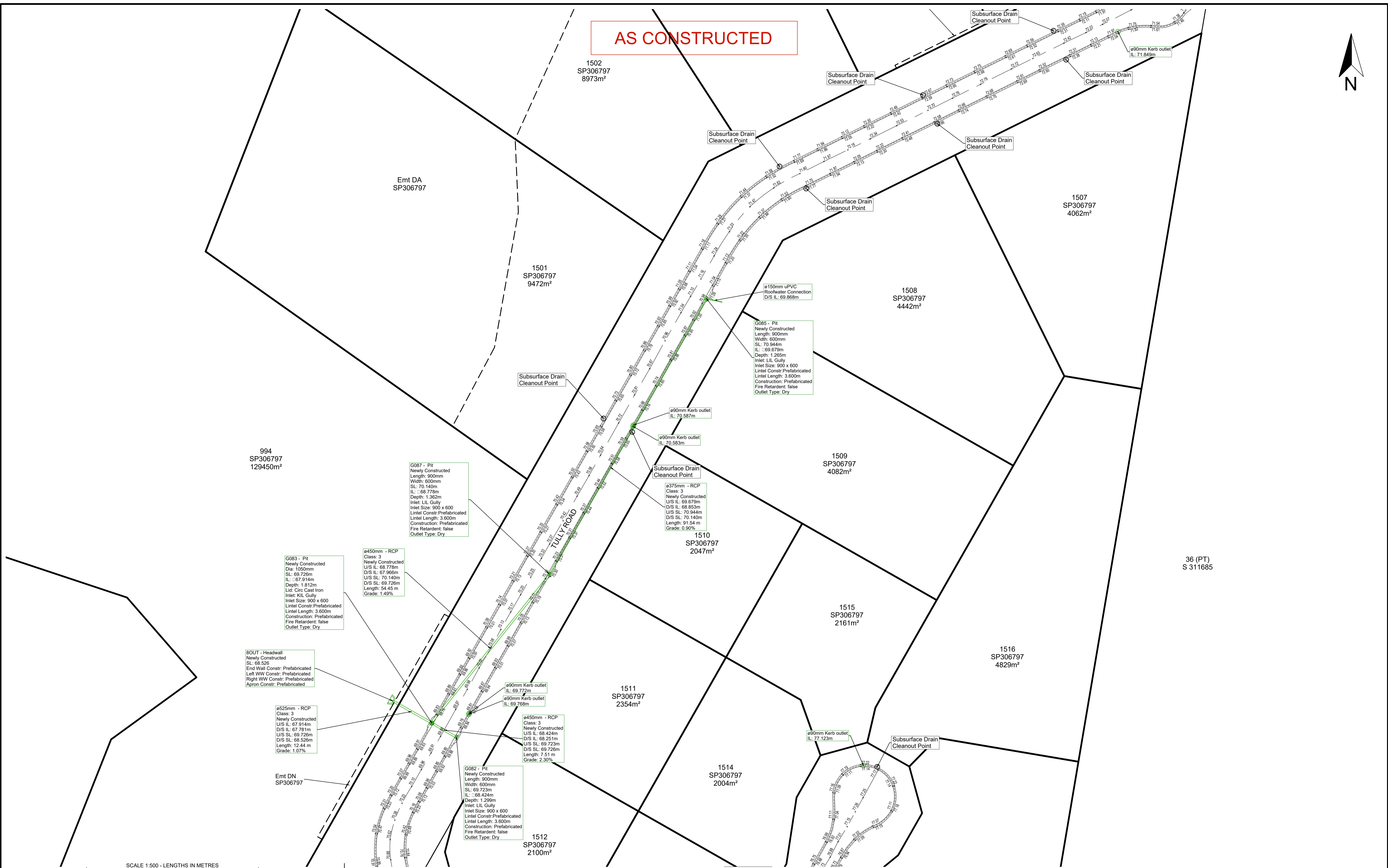

A1	INDEX	DATE	REVISIONS	DRAWN	CHECKED	PASSED

**SCHLENCKER SURVEYING (QLD)**  
 Gold Coast - Brisbane  
 Consultants in Surveying, Mapping & Development

A.B.N. 38 909 833 411  
 PO Box 41,  
 Helensvale QLD 4212.

Suite 206,  
 Helensvale Professional Centre  
 3 Sir John Overall Dr,  
 Helensvale QLD 4212. EMAIL: mail@ssq.net.au

Ph: (07) 5573 6744  
 Fax: (07) 5573 6755  
 Mob: 0413 945 959

**REGISTERED SURVEYOR'S CERTIFICATION**

Schlencker Surveying (Qld) Pty Ltd (ACN 063 830 642), hereby certify that the horizontal and vertical locations, and dimensions shown in the plans contained in this electronic submission are a true and correct record of the As-constructed information.

*[Signature]*  
 Director (sig.)

Date: 26/05/2023  
 Reg. Surveyor No. 3337

**REGISTERED ENGINEER'S CERTIFICATION**

I, \_\_\_\_\_, hereby certify that the As-constructed information shown on the plans contained in this electronic submission is a true and correct record of the sizes, types, materials, classes etc., and it corresponds with the relevant approved Engineering Drawings.

Project Name  
 Company  
 Consultant: KN GROUP  
 RPEQ/CPENG Membership No.

Date: \_\_\_\_\_

This Plan has been prepared for Logan City Council for the purpose of recording the As Constructed details of a new service constructed under a specific Council Approval and should not be used for any other purpose. No report is made on any other services, nor any services that may exist before or be constructed after, the time of survey, or constructed under any other approval. The property boundaries, easements and lot numbers shown hereon may be proposed only and subject to registration by the Department of Natural Resources & Mines. All property information should be determined from the registered Survey Plans.

THIS NOTE IS AN INTEGRAL PART OF THIS PLAN.

**STORMWATER AS CONSTRUCTED**

**STAGE 15C**  
**SPRING MOUNTAIN**  
 OW/242/2021

LOCAL AUTHORITY	LOGAN CITY COUNCIL
LOCALITY	NEW BEITH
LEVEL DATUM	AHD DERIVED
LEVEL ORIGIN	PM180644 RL: 77.302 m
SURVEYED	TR, JM, RB
DRAWN	ASS
SCALE	1:1000 SHEET 2 OF 3
DRAWING NO.	15159 - 126

AS CONSTRUCTED

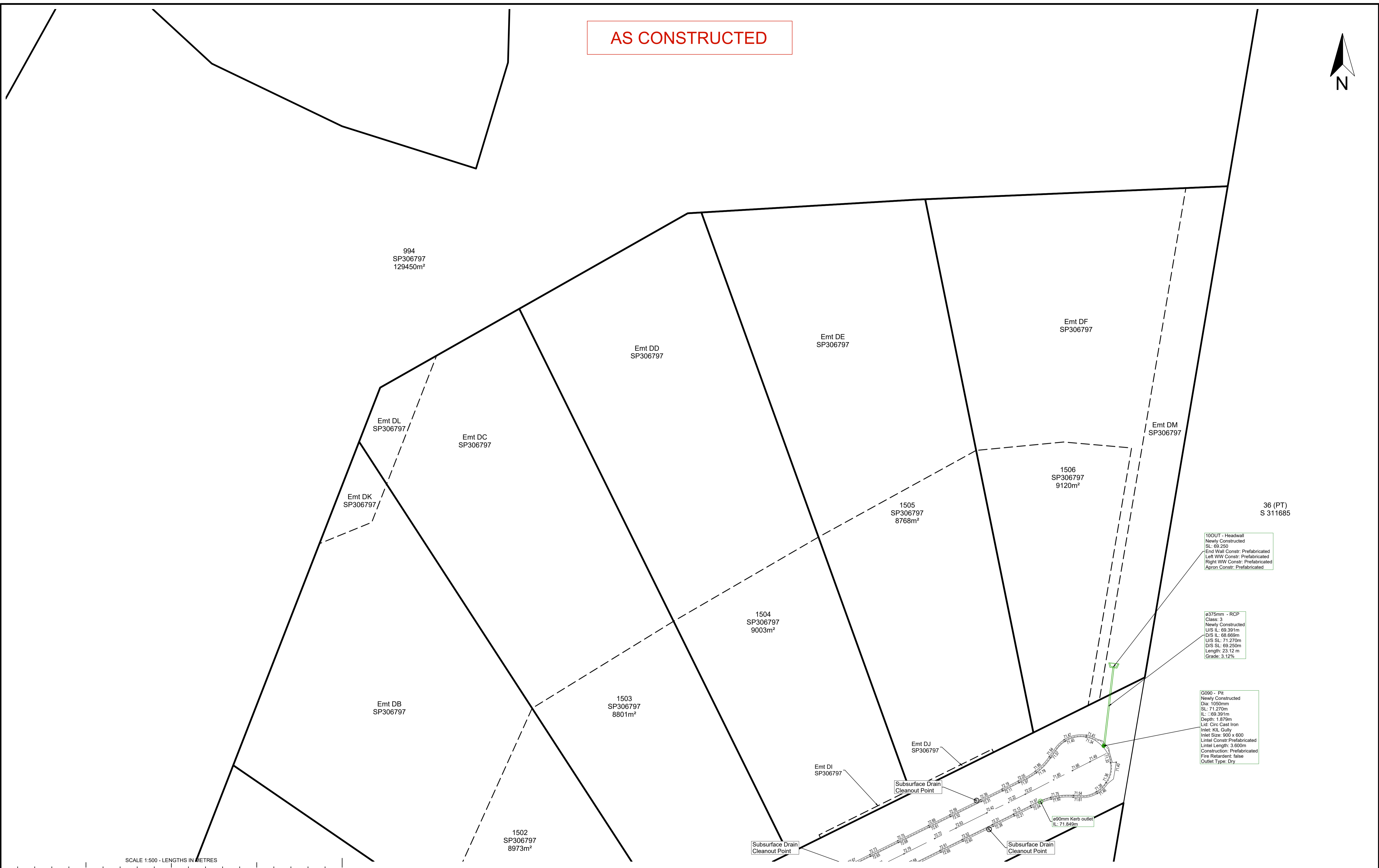

1000 - Headwall  
Newly Constructed  
SL: 69.250  
End Wall Constr: Prefabricated  
Left WW Constr: Prefabricated  
Right WW Constr: Prefabricated  
Apron Constr: Prefabricated

637.5mm - RCP  
Class: 3  
Newly Constructed  
U/S IL: 69.391m  
D/S IL: 68.668m  
U/S SL: 71.270m  
D/S SL: 69.250m  
Length: 23.12 m  
Grade: 3.12%

G690 - PIR  
Newly Constructed  
Dia: 1050mm  
SL: 71.270m  
IL: 69.391m  
Depth: 1.879m  
Lid: Circ Cast Iron  
Inlet: KIL Gully  
Inlet Size: 900 x 600  
Lintel Constr: Prefabricated  
Lintel Length: 3.600m  
Construction: Prefabricated  
Fire Retardant: false  
Outlet Type: Dry

SCALE 1:500 - LENGTHS IN METRES

A1	INDEX	DATE	REVISIONS	DRAWN	CHECKED	PASSED

**SCHLENCKER SURVEYING (QLD)**  
Gold Coast - Brisbane  
Consultants in Surveying,  
Mapping & Development

A.B.N. 38 909 833 411  
PO Box 41,  
Helensvale QLD 4212.

Suite 206,  
Helensvale Professional Centre  
3 Sir John Overall Dr.,  
Helensvale QLD 4212. EMAIL: mail@ssq.net.au

Ph: (07) 5573 6744  
Fax: (07) 5573 6755  
Mob: 0413 945 999

**REGISTERED SURVEYOR'S CERTIFICATION**

Schlencker Surveying (Qld) Pty Ltd (ACN 063 830 642), hereby certify that the horizontal and vertical locations, and dimensions shown in the plans contained in this electronic submission are a true and correct record of the As-constructed information.

Director (sig.)

Date: 26/05/2023  
Reg. Surveyor No. 3337

**REGISTERED ENGINEER'S CERTIFICATION**

I, \_\_\_\_\_ hereby certify that the As-constructed information shown on the plans contained in this electronic submission is a true and correct record of the sizes, types, materials, classes etc., and it corresponds with the relevant approved Engineering Drawings.

Project Name  
Company  
Consultant: KN GROUP  
RPEQ/CPENG Membership No.

Date: \_\_\_\_\_

This Plan has been prepared for Logan City Council for the purpose of recording the As Constructed details of a new service constructed under a specific Council Approval and should not be used for any other purpose. No report is made on any other services, nor any services that may exist before or be constructed after, the time of survey, or constructed under any other approval. The property boundaries, easements and lot numbers shown hereon may be proposed only and subject to registration by the Department of Natural Resources & Mines. All property information should be determined from the registered Survey Plans.

THIS NOTE IS AN INTEGRAL PART OF THIS PLAN.

**STORMWATER AS CONSTRUCTED**

**STAGE 15C  
SPRING MOUNTAIN**

OW/242/2021

LOCAL AUTHORITY	LOGAN CITY COUNCIL
LOCALITY	NEW BEITH
LEVEL DATUM	AHD DERIVED
LEVEL ORIGIN	PM180644 RL: 77.302 m
SURVEYED	TR, JM, RB
DRAWN	ASS
SCALE	1:1000 SHEET 3 OF 3
DRAWING NO.	15159 - 126