



LEGEND

Final surface contours based on A.H.D. datum at an interval of 0.1m, shown as: 1.0

Where applicable, areas filled from existing surface are shown as:-

Depth of Fill $+0.13$

Sewer line shown as: S

Sewer Manhole/Maintenance Shaft shown as:

Roofwater Drainage line shown as: RWD

Roofwater Manhole shown as:

Roofwater Pit shown as:

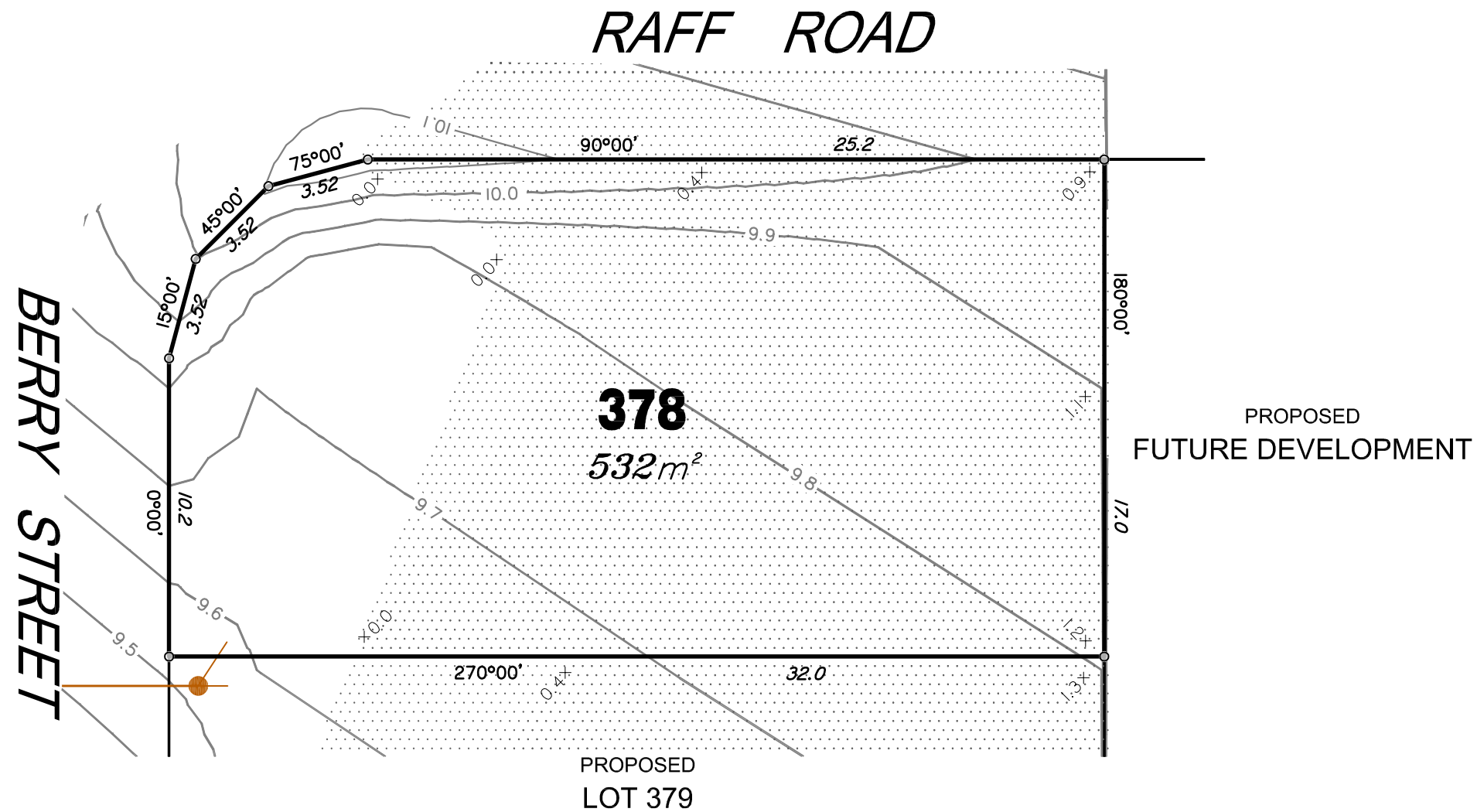

RIVERBANK

For
PEET

IMPORTANT NOTES:
(These notes are an integral part of this plan)
This plan has been prepared for PEET & CO for the purposes of **A Disclosure Plan Under the Land Sales Act 1984 (as Amended)**.

It is not to be used by any other person or corporation or for any other purposes and is subject to the following limitations:

The Lot dimensions and area shown hereon are subject to final field survey and also to the requirements of Council and any other authority which may have requirements under any relevant legislation.

Design surface contours from the design surface data supplied by Brown Consulting Pty Ltd. Where final surface contours are not shown, no change to existing surface level is proposed.

Compaction of any fill material placed on this site shall be completed under inspection and testing services in accordance with AS3798-2007.

Location of sewer and roofwater lines, manholes and pits are those shown on engineering design drawings and may differ from the as-constructed location.

Copyright © Queensland Surveying Pty Ltd t/a THG Resource Strategists 1/6/2015.

THESE DESIGNS AND DRAWINGS ARE COPYRIGHT AND ARE NOT TO BE USED OR REPRODUCED WITHOUT THE WRITTEN PERMISSION OF THG

Data Sources
Cadastral Boundaries 215809_1.LC1(D).dwg
Design Surface Contours 20150601 Stage 9 Design Tin.dwg
Engineering Design X_813243_BASE_SLAVE.dwg

| No | Revisions | Date | Chkd |
|----|--|---------|------|
| C | Update design surface and services, remove easement. | 1/6/15 | EJM |
| B | Revised to suit new Act | 2/12/14 | EJM |
| A | Original | 8/9/14 | EJM |

Parish: CABOOLTURE
County: STANLEY
Locality: CABOOLTURE SOUTH
Local Authority: M.B.R.C
Horizontal Meridian: SP232377
Vertical Level Datum: AHD
Level Origin: PM109474(RL15.112)
Scale: 1:200 @ A3
Surveyed: Queensland Surveying Pty Ltd
Designed: Calibre
Drawn: EJM
Checked: MMR
Plot Date: 01 Jun, 2015
Computer File Ref: 215809_5 DPs(C).dwg

DISCLOSURE PLAN
of Proposed Lot 378
being part of
Lot 2 on SP269617



BRISBANE (07) 3666 4700 MACKAY (07) 4951 2911 PROSERPINE (07) 4945 1722
BOWEN (07) 4786 1050 CAIRNS (07) 4051 6722

Email mail@thg.com.au www.thg.com.au
ABN 25 604 671 374
Queensland Surveying Pty Ltd t/a THG Resource Strategists

Drawing No **30599-DP378** Issue **C**



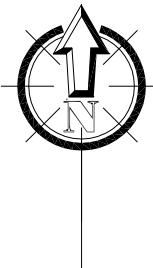

LEGEND

Final surface contours based on A.H.D. datum at an interval of 0.1m, shown as: 1:0

Where applicable, areas filled from existing surface are shown as:-

Depth of Fill +0.13

Sewer line shown as:

Sewer Manhole/Maintenance Shaft shown as:

Roofwater Drainage line shown as:

Roofwater Manhole shown as:

Roofwater Pit shown as:

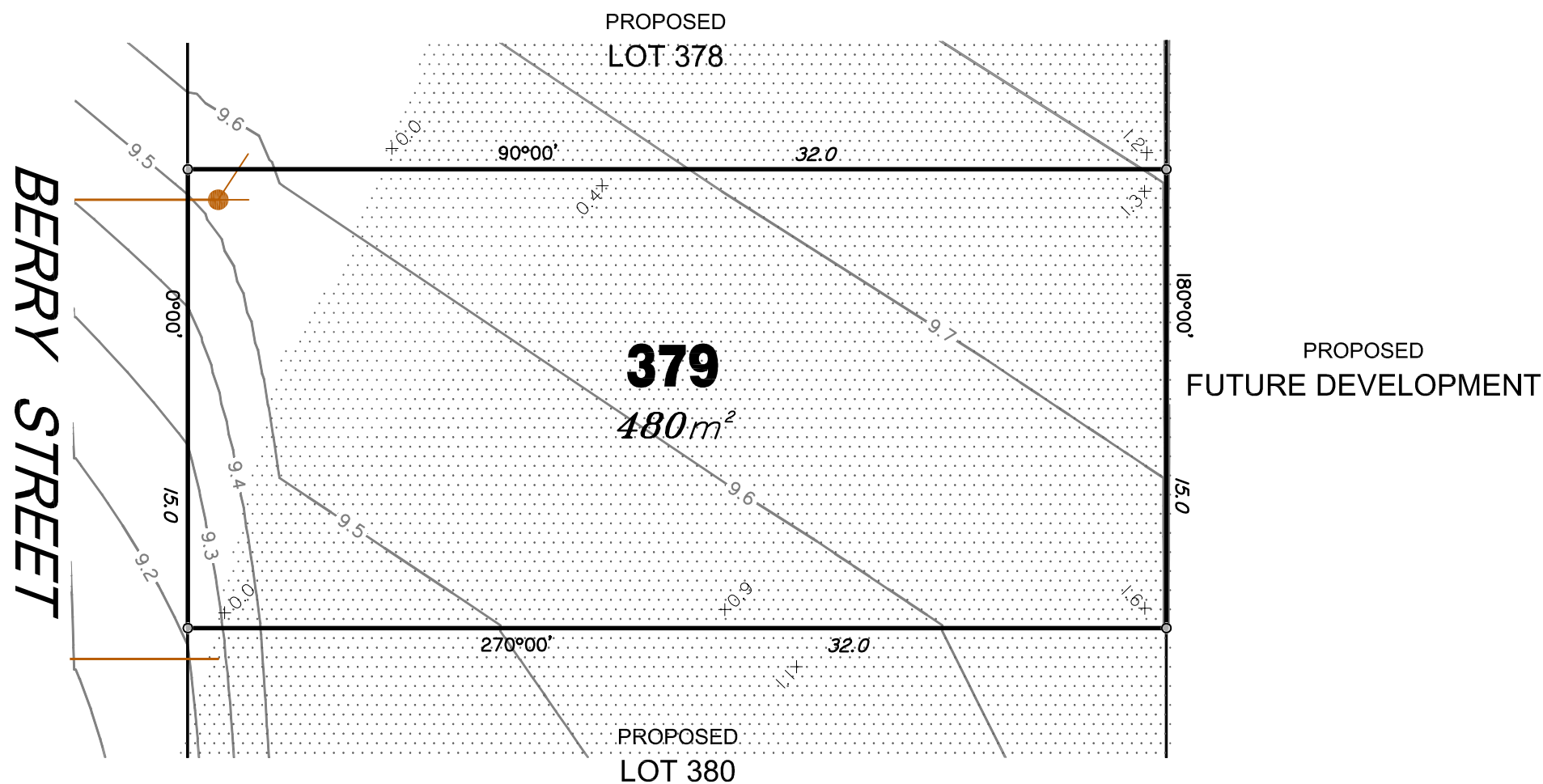

BERRY STREET

PROPOSED FUTURE DEVELOPMENT

RIVERBANK

For
PEET

IMPORTANT NOTES:
(These notes are an integral part of this plan)
This plan has been prepared for PEET & CO for the purposes of **A Disclosure Plan Under the Land Sales Act 1984 (as Amended)**.

It is not to be used by any other person or corporation or for any other purposes and is subject to the following limitations:

The Lot dimensions and area shown hereon are subject to final field survey and also to the requirements of Council and any other authority which may have requirements under any relevant legislation.

Design surface contours from the design surface data supplied by Brown Consulting Pty Ltd. Where final surface contours are not shown, no change to existing surface level is proposed.

Compaction of any fill material placed on this site shall be completed under inspection and testing services in accordance with AS3798-2007.

Location of sewer and roofwater lines, manholes and pits are those shown on engineering design drawings and may differ from the as-constructed location.

Copyright © Queensland Surveying Pty Ltd t/a THG Resource Strategists 1/6/2015.

THESE DESIGNS AND DRAWINGS ARE COPYRIGHT AND ARE NOT TO BE USED OR REPRODUCED WITHOUT THE WRITTEN PERMISSION OF THG

| Data Sources | | |
|-------------------------|---------------------------------|--|
| Cadastral Boundaries | 215809_1_LC1(D).dwg | |
| Design Surface Contours | 20150601 Stage 9 Design Tin.dwg | |
| Engineering Design | X_813243_BASE_SLAVE.dwg | |

| No | Revisions | Date | Chkd |
|----|--|---------|------|
| C | Update design surface and services, remove easement. | 1/6/15 | EJM |
| B | Revised to suit new Act | 2/12/14 | EJM |
| A | Original | 8/9/14 | EJM |

Parish: CABOOLTURE
 County: STANLEY
 Locality: CABOOLTURE SOUTH
 Local Authority: M.B.R.C
 Horizontal Meridian: SP232377
 Vertical Level Datum: AHD
 Level Origin: PM109474(RL15.112)
 Scale: 1:200 @ A3
 Surveyed: Queensland Surveying Pty Ltd
 Designed: Calibre
 Drawn: EJM
 Checked: MMR
 Plot Date: 01 Jun, 2015
 Computer File Ref: 215809_5 DPs(C).dwg

DISCLOSURE PLAN
 of Proposed Lot 379
 being part of
 Lot 2 on SP269617



BRISBANE (07) 3666 4700 MACKAY (07) 4951 2911 PROSERPINE (07) 4945 1722
 BOWEN (07) 4786 1050 CAIRNS (07) 4051 6722

Email mail@thg.com.au www.thg.com.au
 ABN 25 604 671 374
 Queensland Surveying Pty Ltd t/a THG Resource Strategists

Drawing No **30599-DP379** Issue **C**





LEGEND

Final surface contours based on A.H.D. datum at an interval of 0.1m, shown as: — 1:0 —

Where applicable, areas filled from existing surface are shown as:-

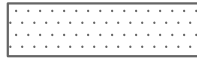

Depth of Fill +0.13

Sewer line shown as: — S —

Sewer Manhole/Maintenance Shaft shown as:

Roofwater Drainage line shown as: — RWD —

Roofwater Manhole shown as:

Roofwater Pit shown as:

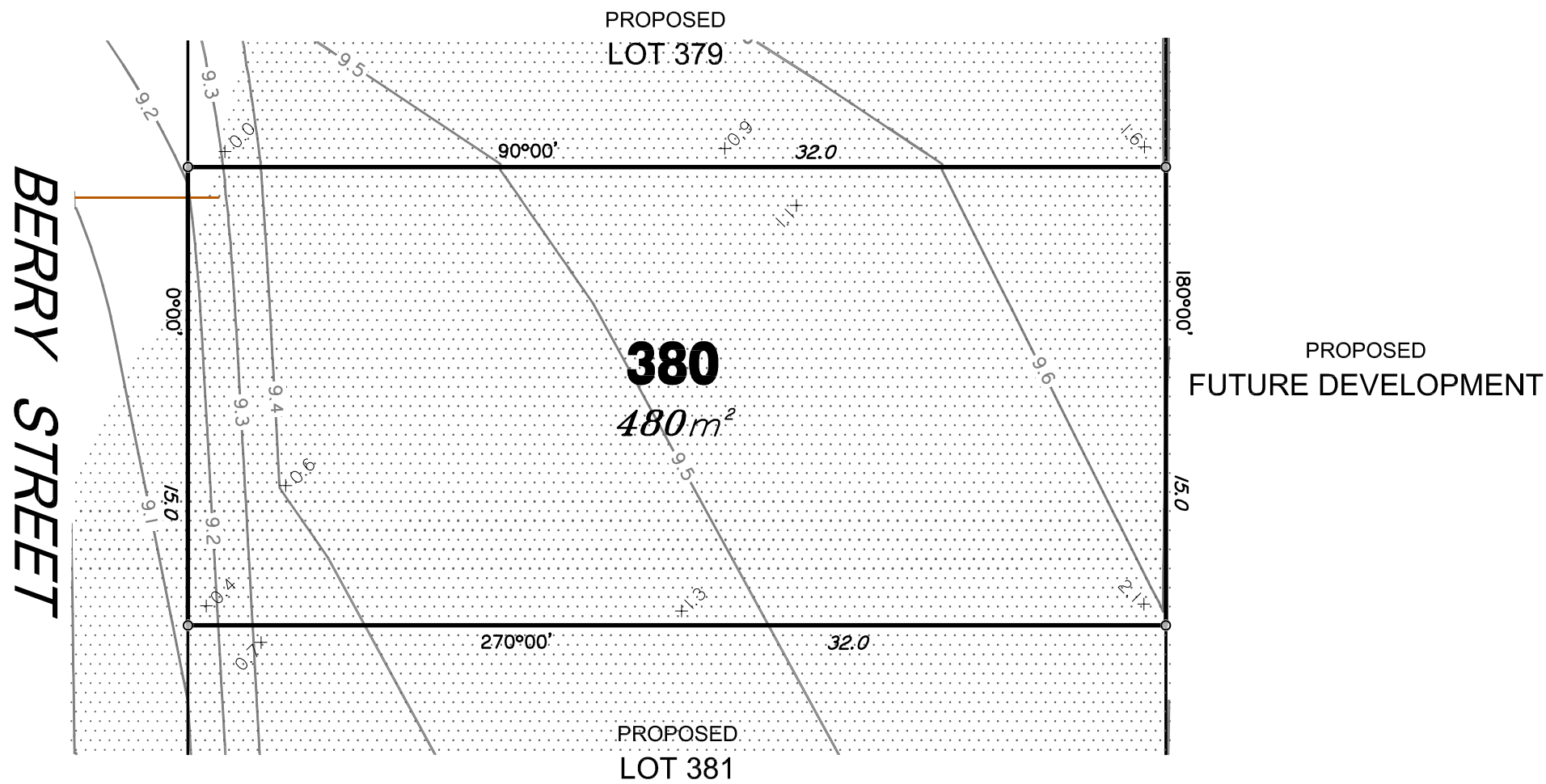

BERRY STREET

PROPOSED FUTURE DEVELOPMENT

RIVERBANK

For
PEET

IMPORTANT NOTES:
(These notes are an integral part of this plan)
This plan has been prepared for PEET & CO for the purposes of A Disclosure Plan Under the Land Sales Act 1984 (as Amended).

It is not to be used by any other person or corporation or for any other purposes and is subject to the following limitations:

The Lot dimensions and area shown hereon are subject to final field survey and also to the requirements of Council and any other authority which may have requirements under any relevant legislation.

Design surface contours from the design surface data supplied by Brown Consulting Pty Ltd. Where final surface contours are not shown, no change to existing surface level is proposed.

Compaction of any fill material placed on this site shall be completed under inspection and testing services in accordance with AS3798-2007.

Location of sewer and roofwater lines, manholes and pits are those shown on engineering design drawings and may differ from the as-constructed location.

Copyright © Queensland Surveying Pty Ltd t/a THG Resource Strategists 1/6/2015.

THESE DESIGNS AND DRAWINGS ARE COPYRIGHT AND ARE NOT TO BE USED OR REPRODUCED WITHOUT THE WRITTEN PERMISSION OF THG

| Data Sources | | |
|-------------------------|---------------------------------|--|
| Cadastral Boundaries | 215809_1_LC1(D).dwg | |
| Design Surface Contours | 20150601_Stage 9 Design Tin.dwg | |
| Engineering Design | X_813243_BASE_SLAVE.dwg | |

| No | Revisions | Date | Chkd |
|----|--|---------|------|
| C | Update design surface and services, remove easement. | 1/6/15 | EJM |
| B | Revised to suit new Act | 2/12/14 | EJM |
| A | Original | 8/9/14 | EJM |

Parish: CABOOLTURE
County: STANLEY
Locality: CABOOLTURE SOUTH
Local Authority: M.B.R.C
Horizontal Meridian: SP232377
Vertical Level Datum: AHD
Level Origin: PM109474(RL15.112)
Scale: 1:200 @ A3
Surveyed: Queensland Surveying Pty Ltd
Designed: Calibre
Drawn: EJM
Checked: MMR
Plot Date: 01 Jun, 2015
Computer File Ref: 215809_5_DPs(C).dwg

DISCLOSURE PLAN
of Proposed Lot 380
being part of
Lot 2 on SP269617



BRISBANE (07) 3666 4700 MACKAY (07) 4951 2911 PROSERPINE (07) 4945 1722
BOWEN (07) 4786 1050 CAIRNS (07) 4051 6722

Email mail@thg.com.au www.thg.com.au
ABN 25 604 671 374
Queensland Surveying Pty Ltd t/a THG Resource Strategists

Drawing No 30599-DP380 Issue C





LEGEND

Final surface contours based on A.H.D. datum at an interval of 0.1m, shown as: — 1.0 —

Where applicable, areas filled from existing surface are shown as:-



Depth of Fill +0.13

Sewer line shown as: — S —

Sewer Manhole/Maintenance Shaft shown as:

Roofwater Drainage line shown as: — RWD —

Roofwater Manhole shown as:

Roofwater Pit shown as:

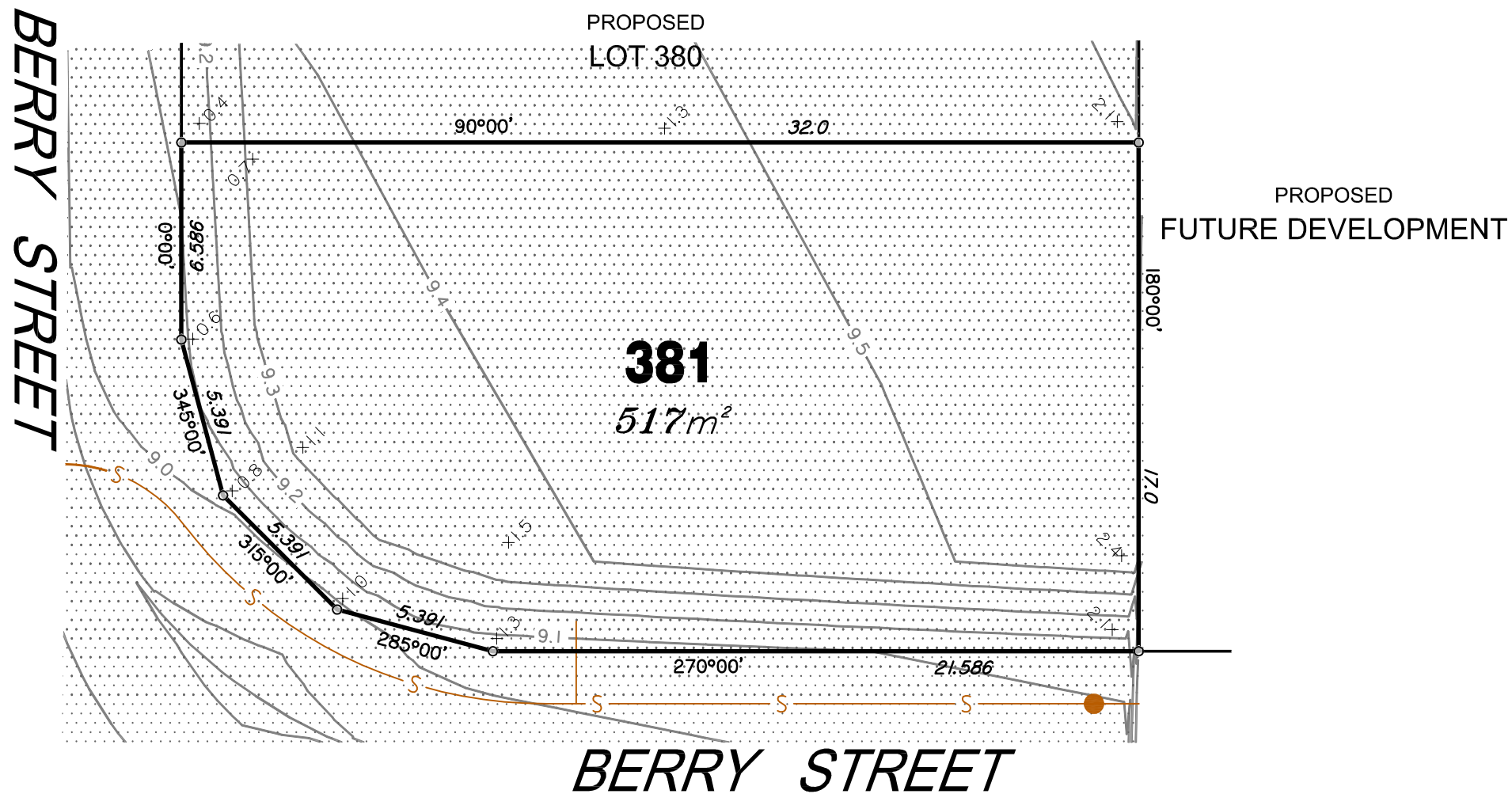

RIVERBANK

For
PEET

IMPORTANT NOTES:
(These notes are an integral part of this plan)
This plan has been prepared for PEET & CO for the purposes of A Disclosure Plan Under the Land Sales Act 1984 (as Amended).

It is not to be used by any other person or corporation or for any other purposes and is subject to the following limitations:

The Lot dimensions and area shown hereon are subject to final field survey and also to the requirements of Council and any other authority which may have requirements under any relevant legislation.

Design surface contours from the design surface data supplied by Brown Consulting Pty Ltd. Where final surface contours are not shown, no change to existing surface level is proposed.

Compaction of any fill material placed on this site shall be completed under inspection and testing services in accordance with AS3798-2007.

Location of sewer and roofwater lines, manholes and pits are those shown on engineering design drawings and may differ from the as-constructed location.

Copyright © Queensland Surveying Pty Ltd t/a THG Resource Strategists 1/6/2015.

THESE DESIGNS AND DRAWINGS ARE COPYRIGHT AND ARE NOT TO BE USED OR REPRODUCED WITHOUT THE WRITTEN PERMISSION OF THG

| Data Sources | | |
|-------------------------|---------------------------------|--|
| Cadastral Boundaries | 215809_1_LC1(D).dwg | |
| Design Surface Contours | 20150601_Stage 9 Design Tin.dwg | |
| Engineering Design | X_813243_BASE_SLAVE.dwg | |

| No | Revisions | Date | Chkd |
|----|--|---------|------|
| C | Update design surface and services, remove easement. | 1/6/15 | EJM |
| B | Revised to suit new Act | 2/12/14 | EJM |
| A | Original | 8/9/14 | EJM |

Parish: CABOOLTURE
 County: STANLEY
 Locality: CABOOLTURE SOUTH
 Local Authority: M.B.R.C
 Horizontal Meridian: SP232377
 Vertical Level Datum: AHD
 Level Origin: PM109474(RL15.112)
 Scale: 1:200 @ A3
 Surveyed: Queensland Surveying Pty Ltd
 Designed: Calibre
 Drawn: EJM
 Checked: MMR
 Plot Date: 01 Jun, 2015
 Computer File Ref: 215809_5_DPs(C).dwg

DISCLOSURE PLAN
 of Proposed Lot 381
 being part of
 Lot 2 on SP269617



BRISBANE (07) 3666 4700 MACKAY (07) 4951 2911 PROSERPINE (07) 4945 1722
 BOWEN (07) 4786 1050 CAIRNS (07) 4051 6722

Email mail@thg.com.au www.thg.com.au
 ABN 25 604 671 374
 Queensland Surveying Pty Ltd t/a THG Resource Strategists

Drawing No 30599-DP381 Issue C

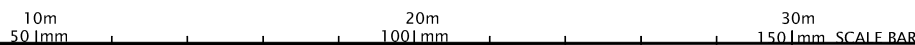

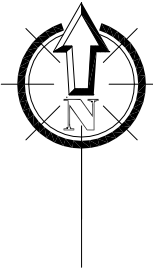

LEGEND

Final surface contours based on A.H.D. datum at an interval of 0.1m, shown as: 1:0

Where applicable, areas filled from existing surface are shown as:-

Depth of Fill $+0.13$

Sewer line shown as:

Sewer Manhole/Maintenance Shaft shown as:

Roofwater Drainage line shown as:

Roofwater Manhole shown as:

Roofwater Pit shown as:

PROPOSED LOT 384

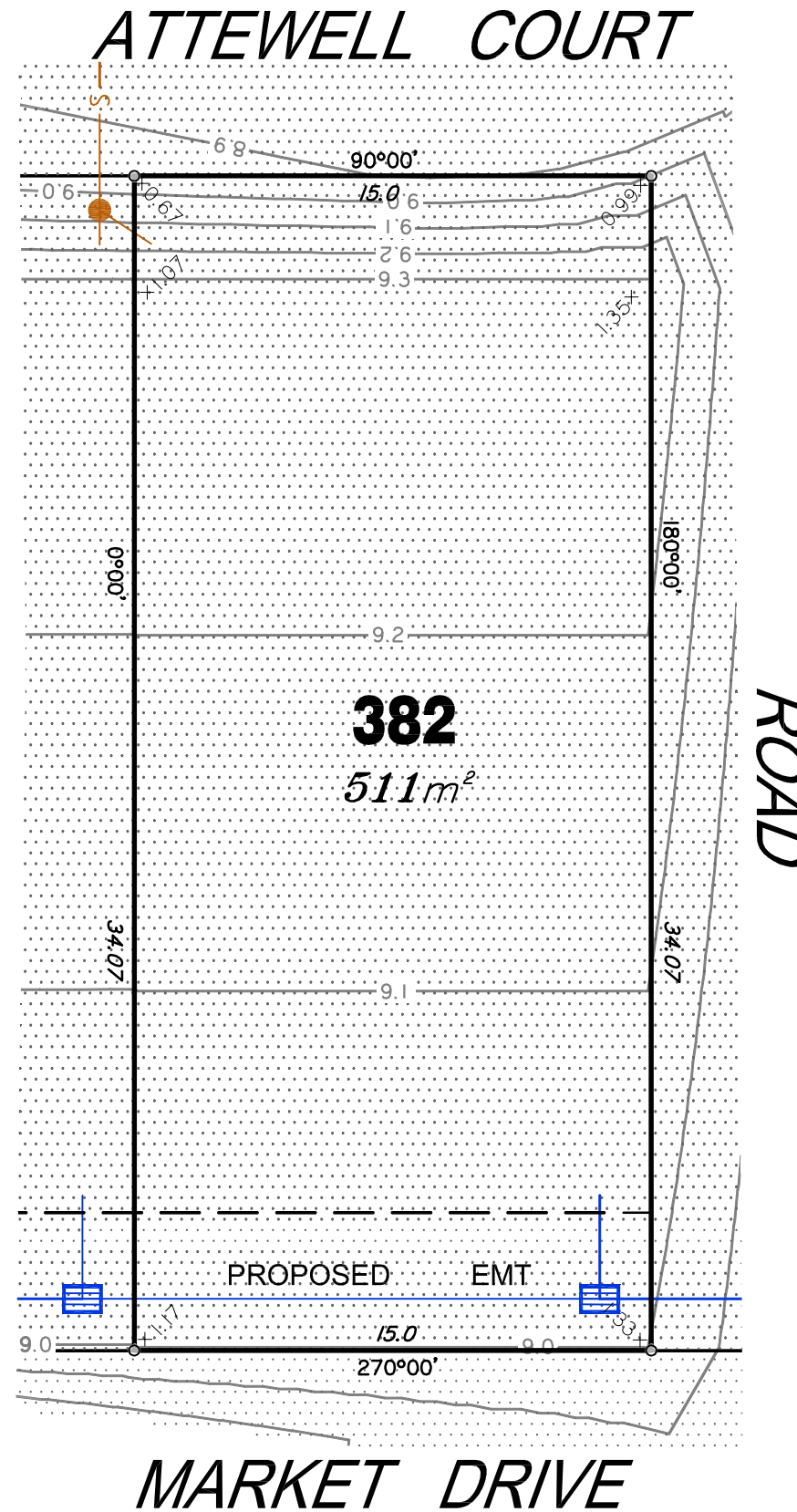

RIVERBANK

For
PEET

IMPORTANT NOTES:
(These notes are an integral part of this plan)
This plan has been prepared for PEET & CO for the purposes of A Disclosure Plan Under the Land Sales Act 1984 (as Amended).

It is not to be used by any other person or corporation or for any other purposes and is subject to the following limitations:

The Lot dimensions and area shown herein are subject to final field survey and also to the requirements of Council and any other authority which may have requirements under any relevant legislation.

Design surface contours from the design surface data supplied by Brown Consulting Pty Ltd. Where final surface contours are not shown, no change to existing surface level is proposed.

Compaction of any fill material placed on this site shall be completed under inspection and testing services in accordance with AS3798-2007.

Location of sewer and roofwater lines, manholes and pits are those shown on engineering design drawings and may differ from the as-constructed location.

THESE DESIGNS AND DRAWINGS ARE COPYRIGHT AND ARE NOT TO BE USED OR REPRODUCED WITHOUT THE WRITTEN PERMISSION OF THG

Data Sources
Cadastral Boundaries 215809_1_LC1(D).dwg
Design Surface Contours Stage 9 - 12D Design Tin.12da
Engineering Design X_806158_BASE_MASTER_2014_09_08.dwg

| No | Revisions | Date | Chkd |
|----|-------------------------|---------|------|
| B | Revised to suit new Act | 2/12/14 | EJM |
| A | Original | 8/9/14 | EJM |

Parish: CABOOLTURE
County: STANLEY
Locality: CABOOLTURE SOUTH
Local Authority: M.B.R.C
Horizontal Meridian: SP232377
Vertical Level Datum: AHD
Level Origin: PM109474(RL15.112)
Scale: 1:200 @ A3
Surveyed: THG WSG Pty Ltd
Designed: Brown Consulting
Drawn: EJ
Checked: MMR
Plot Date: 03 Dec, 2014
Computer File Ref: 215809_5 DPs(B).dwg

DISCLOSURE PLAN
of Proposed Lot 382
being part of
Lot 2 on SP269617



BRISBANE (07) 3666 4700
MACKAY (07) 4951 2911
PROSERPINE (07) 4945 1722
BOWEN (07) 4786 1050
CAIRNS (07) 4051 6722

Email mail@thg.com.au www.thg.com.au
ABN 55156210052 THG WSG Pty Ltd t/a THG Resource Strategists

Drawing No 30599-DP382 Issue B



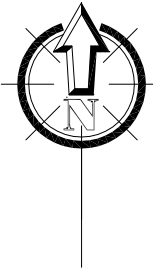

LEGEND

Final surface contours based on A.H.D. datum at an interval of 0.1m, shown as: — 1.0 —

Where applicable, areas filled from existing surface are shown as:-

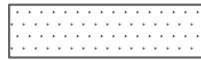

Depth of Fill +0.13

Sewer line shown as: — S —

Sewer Manhole/Maintenance Shaft shown as:

Roofwater Drainage line shown as: — RWD —

Roofwater Manhole shown as:

Roofwater Pit shown as:

ATTEWELL COURT

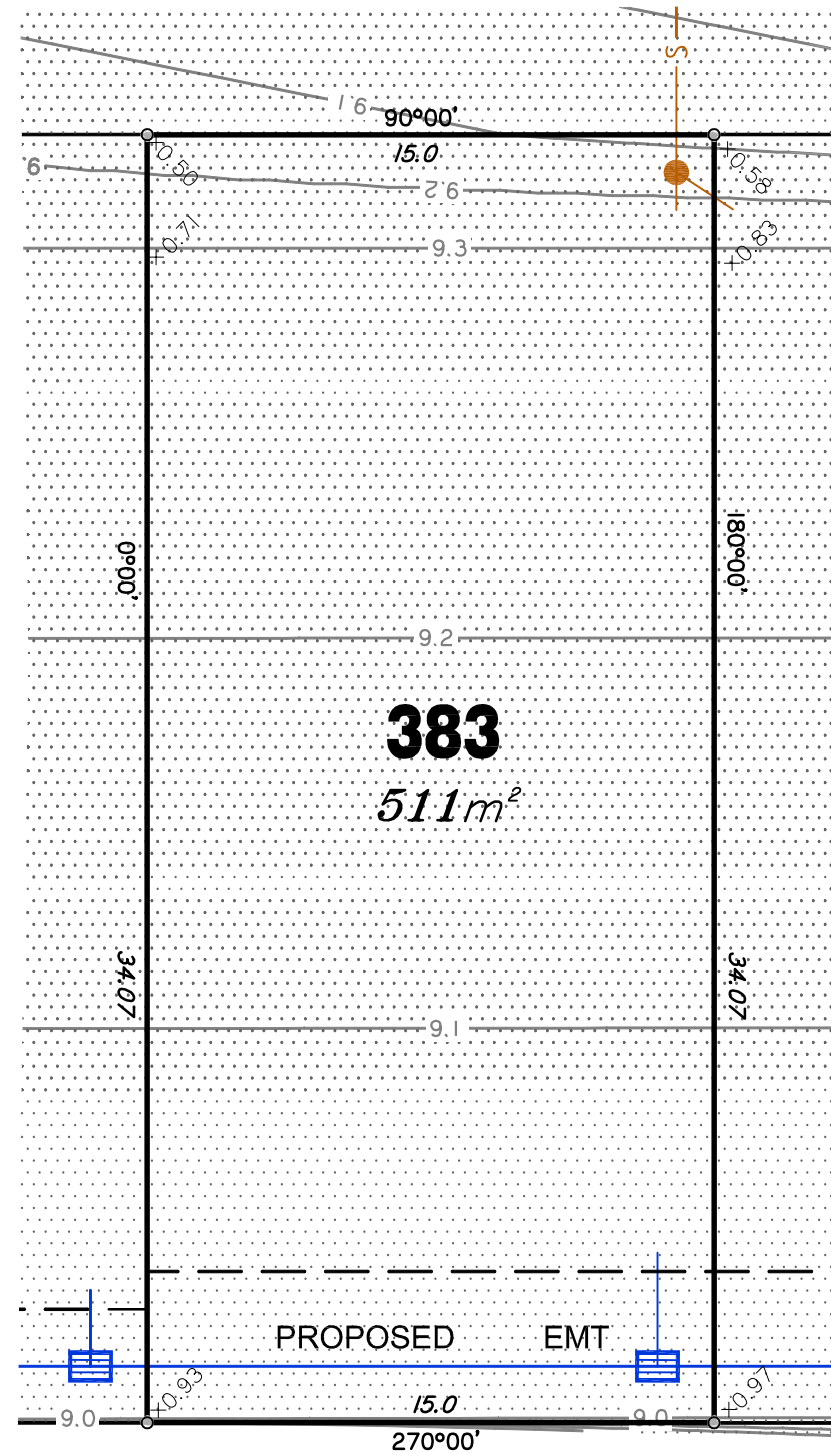

PROPOSED LOT 385

PROPOSED LOT 387

MARKET DRIVE

RIVERBANK

For **PEET**

IMPORTANT NOTES:
(These notes are an integral part of this plan)
This plan has been prepared for PEET & CO for the purposes of A Disclosure Plan Under the Land Sales Act 1984 (as Amended).

It is not to be used by any other person or corporation or for any other purposes and is subject to the following limitations:

The Lot dimensions and area shown hereon are subject to final field survey and also to the requirements of Council and any other authority which may have requirements under any relevant legislation.

Design surface contours from the design surface data supplied by Brown Consulting Pty Ltd. Where final surface contours are not shown, no change to existing surface level is proposed.

Compaction of any fill material placed on this site shall be completed under inspection and testing services in accordance with AS3798-2007.

Location of sewer and roofwater lines, manholes and pits are those shown on engineering design drawings and may differ from the as-constructed location.

THESE DESIGNS AND DRAWINGS ARE COPYRIGHT AND ARE NOT TO BE USED OR REPRODUCED WITHOUT THE WRITTEN PERMISSION OF THG

Data Sources
Cadastral Boundaries 215809_1_LC1(D).dwg
Design Surface Contours Stage 9 - 12D Design Tin.12da
Engineering Design X_806158_BASE_MASTER_2014_09_08.dwg

| No | Revisions | Date | Chkd |
|----|-------------------------|---------|------|
| B | Revised to suit new Act | 2/12/14 | EJM |
| A | Original | 8/9/14 | EJM |

Parish: CABOOLTURE
County: STANLEY
Locality: CABOOLTURE SOUTH
Local Authority: M.B.R.C
Horizontal Meridian: SP232377
Vertical Level Datum: AHD
Level Origin: PM109474(RL15.112)
Scale: 1:200 @ A3
Surveyed: THG WSG Pty Ltd
Designed: Brown Consulting
Drawn: EJM
Checked: MMR
Plot Date: 03 Dec, 2014
Computer File Ref: 215809_5_DPs(B).dwg

DISCLOSURE PLAN
of Proposed Lot 383
being part of
Lot 2 on SP269617



BRISBANE (07) 3666 4700
MACKAY (07) 4951 2911
PROSERPINE (07) 4945 1722
BOWEN (07) 4786 1050
CAIRNS (07) 4051 6722

Email mail@thg.com.au www.thg.com.au
ABN 55156210052 THG WSG Pty Ltd t/a THG Resource Strategists

Drawing No **30599-DP383** Issue **B**



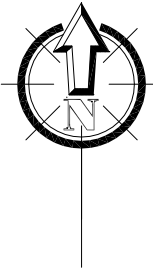

LEGEND

Final surface contours based on A.H.D. datum at an interval of 0.1m, shown as: — 1.0 —

Where applicable, areas filled from existing surface are shown as:-

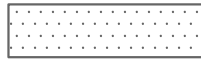

Depth of Fill +0.13

Sewer line shown as: — S —

Sewer Manhole/Maintenance Shaft shown as: ●

Roofwater Drainage line shown as: — RWD —

Roofwater Manhole shown as: ●

Roofwater Pit shown as: ■

ATTEWELL COURT

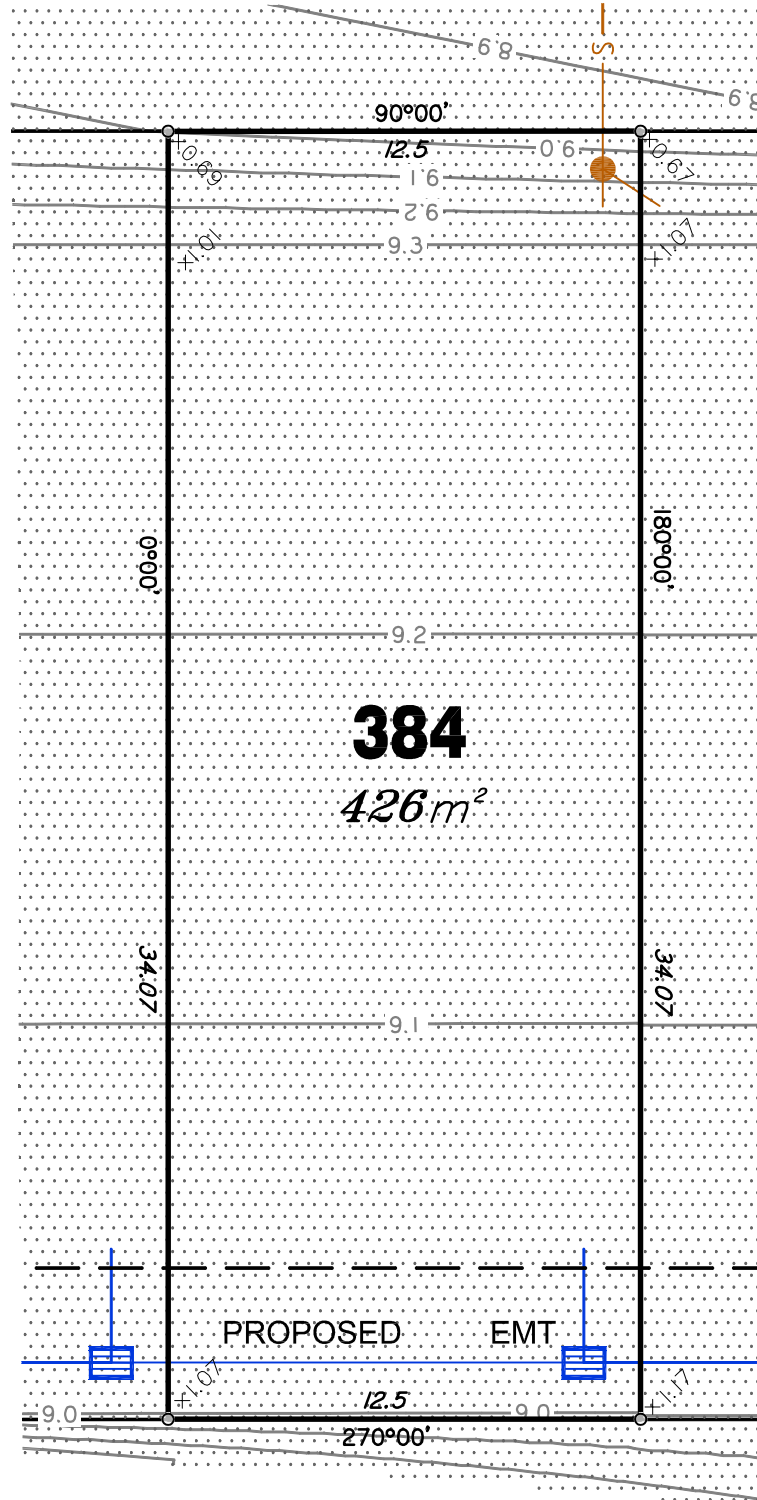

PROPOSED LOT 387

PROPOSED LOT 382

MARKET DRIVE

RIVERBANK

For **PEET**

IMPORTANT NOTES:
(These notes are an integral part of this plan)
This plan has been prepared for PEET & CO for the purposes of **A Disclosure Plan Under the Land Sales Act 1984 (as Amended)**.

It is not to be used by any other person or corporation or for any other purposes and is subject to the following limitations:

The Lot dimensions and area shown hereon are subject to final field survey and also to the requirements of Council and any other authority which may have requirements under any relevant legislation.

Design surface contours from the design surface data supplied by Brown Consulting Pty Ltd. Where final surface contours are not shown, no change to existing surface level is proposed.

Compaction of any fill material placed on this site shall be completed under inspection and testing services in accordance with AS3798-2007.

Location of sewer and roofwater lines, manholes and pits are those shown on engineering design drawings and may differ from the as-constructed location.

THESE DESIGNS AND DRAWINGS ARE COPYRIGHT AND ARE NOT TO BE USED OR REPRODUCED WITHOUT THE WRITTEN PERMISSION OF THG

Data Sources
Cadastral Boundaries 215809_1_LC1(D).dwg
Design Surface Contours Stage 9 - 12D Design Tin.12da
Engineering Design X_806158_BASE_MASTER_2014_09_08.dwg

| No | Revisions | Date | Chkd |
|----|-------------------------|---------|------|
| B | Revised to suit new Act | 2/12/14 | EJM |
| A | Original | 8/9/14 | EJM |

Parish: CABOOLTURE
County: STANLEY
Locality: CABOOLTURE SOUTH
Local Authority: M.B.R.C
Horizontal Meridian: SP232377
Vertical Level Datum: AHD
Level Origin: PM109474(RL15.112)
Scale: 1:200 @ A3
Surveyed: THG WSG Pty Ltd
Designed: Brown Consulting
Drawn: EJM
Checked: MMR
Plot Date: 03 Dec, 2014
Computer File Ref: 215809_5 DPs(B).dwg

DISCLOSURE PLAN
of Proposed Lot 384
being part of
Lot 2 on SP269617



BRISBANE (07) 3666 4700 MACKAY (07) 4951 2911 PROSERPINE (07) 4945 1722
BOWEN (07) 4786 1050 CAIRNS (07) 4051 6722

Email mail@thg.com.au www.thg.com.au
ABN 55156210052 THG WSG Pty Ltd t/a THG Resource Strategists

Drawing No **30599-DP384** Issue **B**



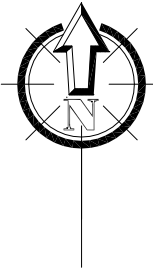

LEGEND

Final surface contours based on A.H.D. datum at an interval of 0.1m, shown as: — 1-0 —

Where applicable, areas filled from existing surface are shown as:-



Depth of Fill +0.13

Sewer line shown as: — S —

Sewer Manhole/Maintenance Shaft shown as: ●

Roofwater Drainage line shown as: — RWD —

Roofwater Manhole shown as: ●

Roofwater Pit shown as: ■

ATTEWELL COURT

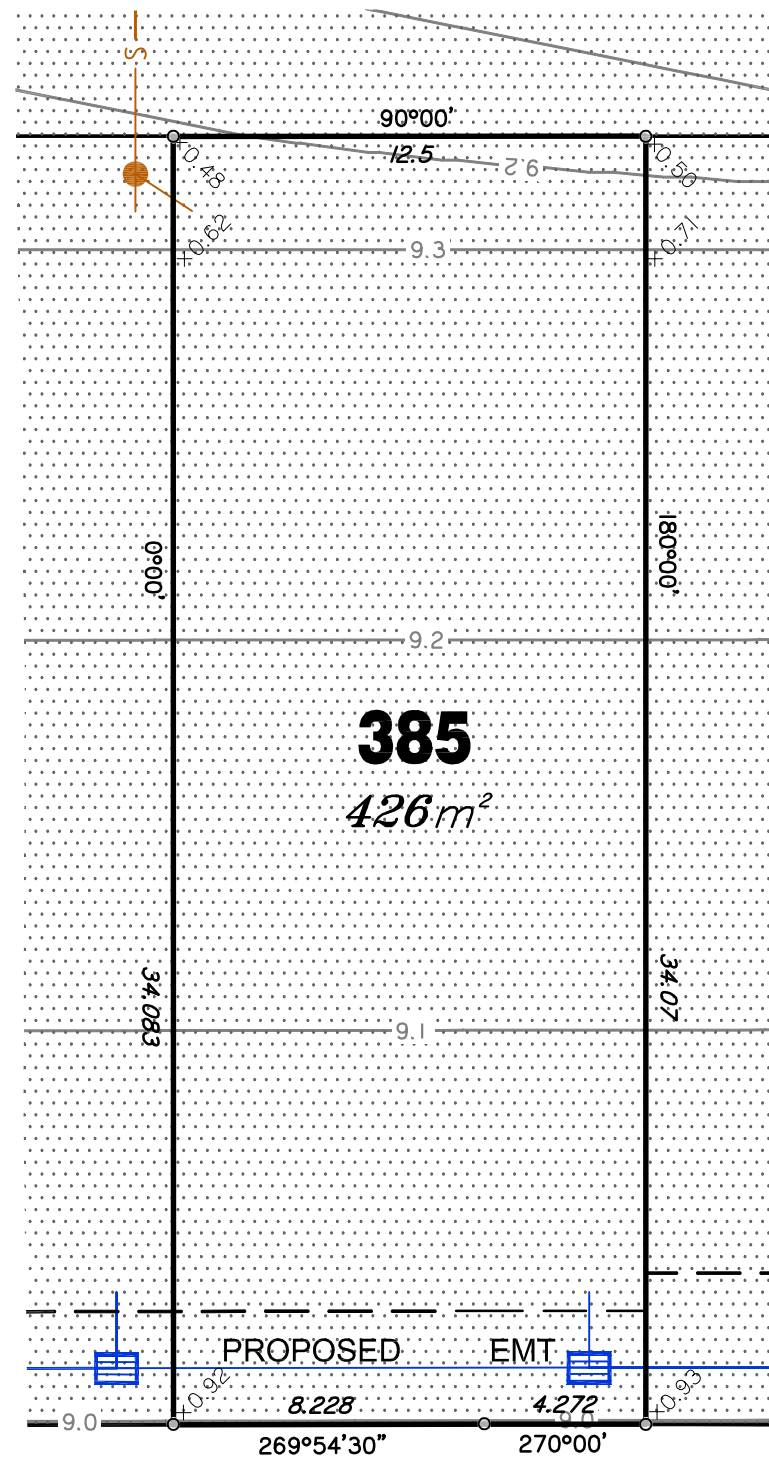

PROPOSED LOT 386

PROPOSED LOT 383

MARKET DRIVE

RIVERBANK

For
PEET

IMPORTANT NOTES:
(These notes are an integral part of this plan)
This plan has been prepared for PEET & CO for the purposes of A Disclosure Plan Under the Land Sales Act 1984 (as Amended).

It is not to be used by any other person or corporation or for any other purposes and is subject to the following limitations:

The Lot dimensions and area shown herein are subject to final field survey and also to the requirements of Council and any other authority which may have requirements under any relevant legislation.

Design surface contours from the design surface data supplied by Brown Consulting Pty Ltd. Where final surface contours are not shown, no change to existing surface level is proposed.

Compaction of any fill material placed on this site shall be completed under inspection and testing services in accordance with AS3798-2007.

Location of sewer and roofwater lines, manholes and pits are those shown on engineering design drawings and may differ from the as-constructed location.

THESE DESIGNS AND DRAWINGS ARE COPYRIGHT AND ARE NOT TO BE USED OR REPRODUCED WITHOUT THE WRITTEN PERMISSION OF THG

Data Sources
Cadastral Boundaries 215809_1_LC1(D).dwg
Design Surface Contours Stage 9 - 12D Design Tin.12da
Engineering Design X_806158_BASE_MASTER_2014_09_08.dwg

| No | Revisions | Date | Chkd |
|----|-------------------------|---------|------|
| B | Revised to suit new Act | 2/12/14 | EJM |
| A | Original | 8/9/14 | EJM |

Parish: CABOOLTURE
County: STANLEY
Locality: CABOOLTURE SOUTH
Local Authority: M.B.R.C
Horizontal Meridian: SP232377
Vertical Level Datum: AHD
Level Origin: PM109474(RL15.112)
Scale: 1:200 @ A3
Surveyed: THG WSG Pty Ltd
Designed: Brown Consulting
Drawn: EJM
Checked: MMR
Plot Date: 03 Dec, 2014
Computer File Ref: 215809_5 DPs(B).dwg

DISCLOSURE PLAN
of Proposed Lot 385
being part of
Lot 2 on SP269617



BRISBANE (07) 3666 4700
MACKAY (07) 4951 2911
PROSERPINE (07) 4945 1722
BOWEN (07) 4786 1050
CAIRNS (07) 4051 6722

Email mail@thg.com.au www.thg.com.au
ABN 55156210052 THG WSG Pty Ltd t/a THG Resource Strategists

Drawing No **30599-DP385** Issue **B**



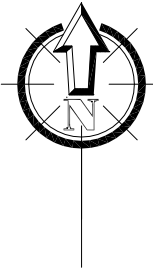

LEGEND

Final surface contours based on A.H.D. datum at an interval of 0.1m, shown as: 1:0

Where applicable, areas filled from existing surface are shown as:-

Depth of Fill $+0.13$

Sewer line shown as:

Sewer Manhole/Maintenance Shaft shown as:

Roofwater Drainage line shown as:

Roofwater Manhole shown as:

Roofwater Pit shown as:

PROPOSED LOT 388

PROPOSED LOT 385

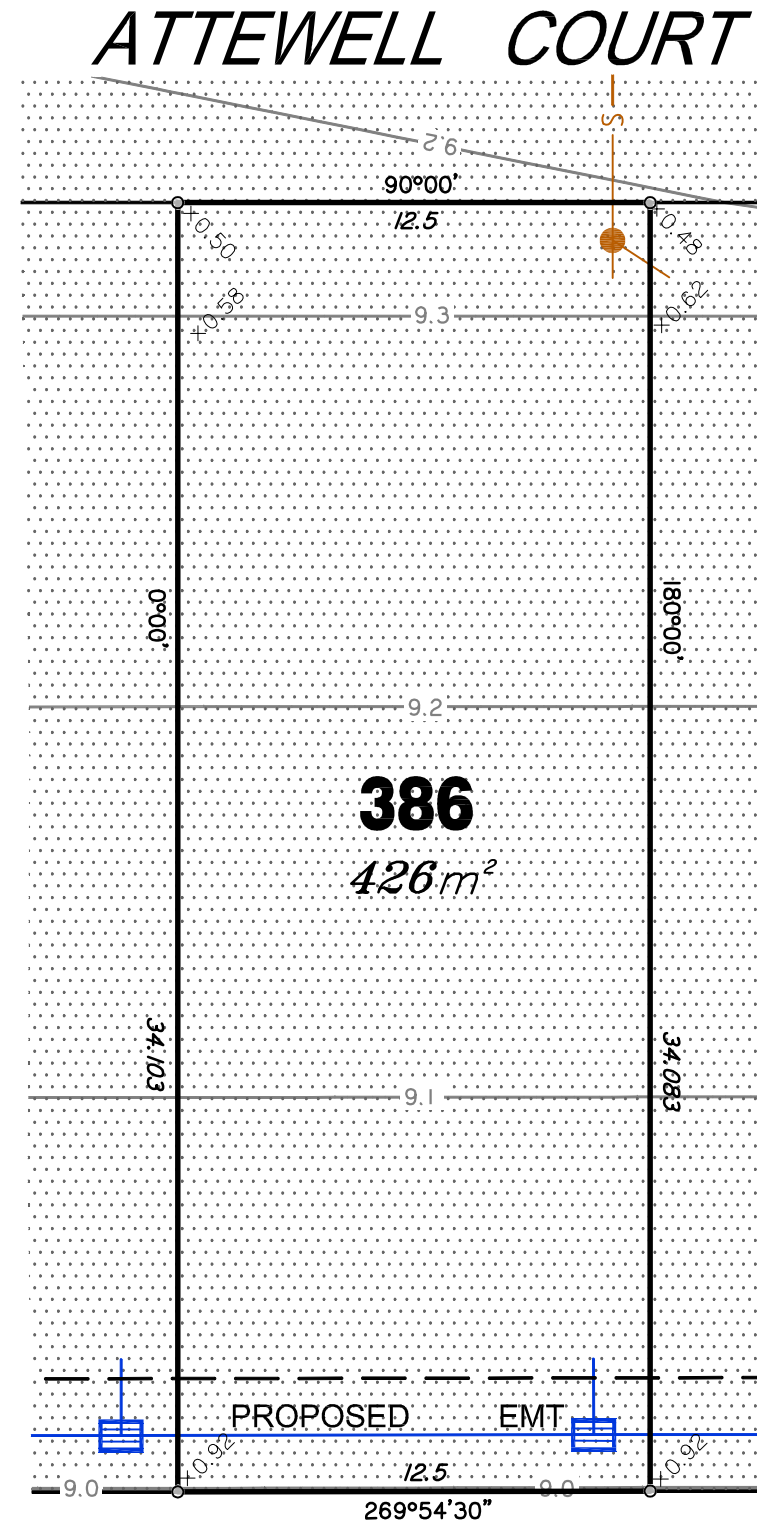

MARKET DRIVE

RIVERBANK

For
PEET

IMPORTANT NOTES:
(These notes are an integral part of this plan)
This plan has been prepared for PEET & CO for the purposes of **A Disclosure Plan Under the Land Sales Act 1984 (as Amended)**.

It is not to be used by any other person or corporation or for any other purposes and is subject to the following limitations:

The Lot dimensions and area shown hereon are subject to final field survey and also to the requirements of Council and any other authority which may have requirements under any relevant legislation.

Design surface contours from the design surface data supplied by Brown Consulting Pty Ltd. Where final surface contours are not shown, no change to existing surface level is proposed.

Compaction of any fill material placed on this site shall be completed under inspection and testing services in accordance with AS3798-2007.

Location of sewer and roofwater lines, manholes and pits are those shown on engineering design drawings and may differ from the as-constructed location.

THESE DESIGNS AND DRAWINGS ARE COPYRIGHT AND ARE NOT TO BE USED OR REPRODUCED WITHOUT THE WRITTEN PERMISSION OF THG

Data Sources
Cadastral Boundaries 215809_1_LC1(D).dwg
Design Surface Contours Stage 9 - 12D Design Tin.12da
Engineering Design X_806158_BASE_MASTER_2014_09_08.dwg

| No | Revisions | Date | Chkd |
|----|-------------------------|---------|------|
| B | Revised to suit new Act | 2/12/14 | EJM |
| A | Original | 8/9/14 | EJM |

Parish: CABOOLTURE
County: STANLEY
Locality: CABOOLTURE SOUTH
Local Authority: M.B.R.C
Horizontal Meridian: SP232377
Vertical Level Datum: AHD
Level Origin: PM109474(RL15.112)
Scale: 1:200 @ A3
Surveyed: THG WSG Pty Ltd
Designed: Brown Consulting
Drawn: EJM
Checked: MMR
Plot Date: 03 Dec, 2014
Computer File Ref: 215809_5 DPs(B).dwg

DISCLOSURE PLAN
of Proposed Lot 386
being part of
Lot 2 on SP269617



BRISBANE (07) 3666 4700 MACKAY (07) 4951 2911 PROSERPINE (07) 4945 1722
BOWEN (07) 4786 1050 CAIRNS (07) 4051 6722

Email mail@thg.com.au www.thg.com.au
ABN 55156210052 THG WSG Pty Ltd t/a THG Resource Strategists

Drawing No **30599-DP386** Issue **B**



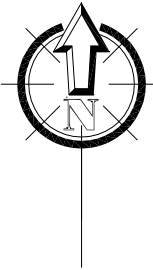

LEGEND

Final surface contours based on A.H.D. datum at an interval of 0.1m, shown as: — 1.0 —

Where applicable, areas filled from existing surface are shown as:-

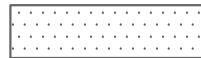

Depth of Fill +0.13

Sewer line shown as: — S —

Sewer Manhole/Maintenance Shaft shown as: ●

Roofwater Drainage line shown as: — RWD —

Roofwater Manhole shown as: ●

Roofwater Pit shown as: ■

ATTEWELL COURT

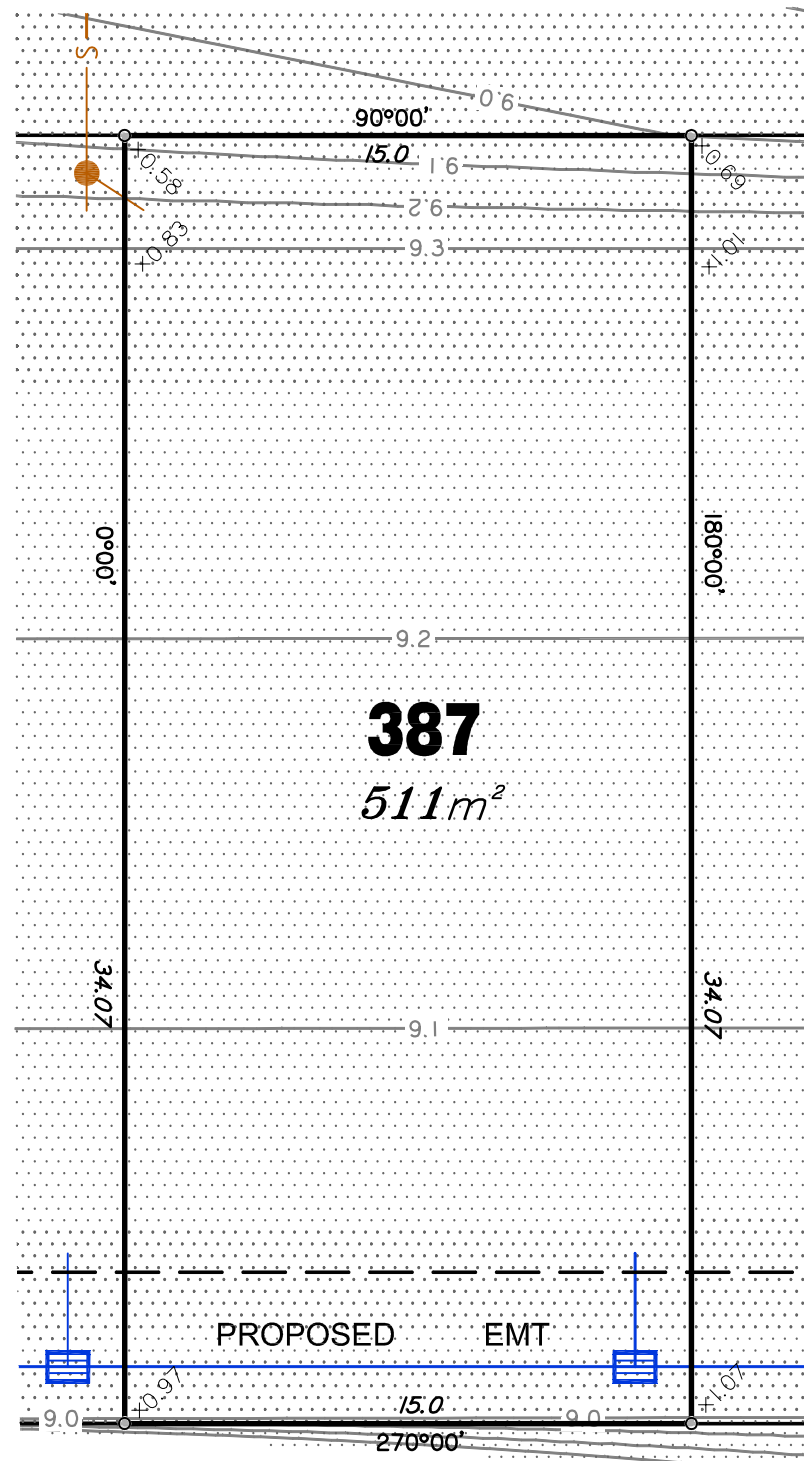

PROPOSED LOT 383

387
511m²

PROPOSED LOT 384

MARKET DRIVE

RIVERBANK

For
PEET

IMPORTANT NOTES:
(These notes are an integral part of this plan)
This plan has been prepared for PEET & CO for the purposes of A Disclosure Plan Under the Land Sales Act 1984 (as Amended).

It is not to be used by any other person or corporation or for any other purposes and is subject to the following limitations:

The Lot dimensions and area shown herein are subject to final field survey and also to the requirements of Council and any other authority which may have requirements under any relevant legislation.

Design surface contours from the design surface data supplied by Brown Consulting Pty Ltd. Where final surface contours are not shown, no change to existing surface level is proposed.

Compaction of any fill material placed on this site shall be completed under inspection and testing services in accordance with AS3798-2007.

Location of sewer and roofwater lines, manholes and pits are those shown on engineering design drawings and may differ from the as-constructed location.

THESE DESIGNS AND DRAWINGS ARE COPYRIGHT AND ARE NOT TO BE USED OR REPRODUCED WITHOUT THE WRITTEN PERMISSION OF THG

Data Sources
Cadastral Boundaries 215809_1_LC1(D).dwg
Design Surface Contours Stage 9 - 12D Design Tin.12da
Engineering Design X_806158_BASE_MASTER_2014_09_08.dwg

| No | Revisions | Date | Chkd |
|----|-------------------------|---------|------|
| B | Revised to suit new Act | 2/12/14 | EJM |
| A | Original | 8/9/14 | EJM |

Parish: CABOOLTURE
County: STANLEY
Locality: CABOOLTURE SOUTH
Local Authority: M.B.R.C
Horizontal Meridian: SP232377
Vertical Level Datum: AHD
Level Origin: PM109474(RL15.112)
Scale: 1:200 @ A3
Surveyed: THG WSG Pty Ltd
Designed: Brown Consulting
Drawn: EJM
Checked: MMR
Plot Date: 03 Dec, 2014
Computer File Ref: 215809_5 DPs(B).dwg

DISCLOSURE PLAN
of Proposed Lot 387
being part of
Lot 2 on SP269617



BRISBANE (07) 3666 4700 MACKAY (07) 4951 2911 PROSERPINE (07) 4945 1722
BOWEN (07) 4786 1050 CAIRNS (07) 4051 6722

Email mail@thg.com.au www.thg.com.au
ABN 55156210052 THG WSG Pty Ltd t/a THG Resource Strategists

Drawing No **30599-DP387** Issue **B**



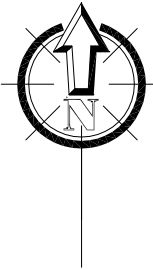

LEGEND

Final surface contours based on A.H.D. datum at an interval of 0.1m, shown as: 1:0

Where applicable, areas filled from existing surface are shown as:-

Depth of Fill $+0.13$

Sewer line shown as:

Sewer Manhole/Maintenance Shaft shown as:

Roofwater Drainage line shown as:

Roofwater Manhole shown as:

Roofwater Pit shown as:

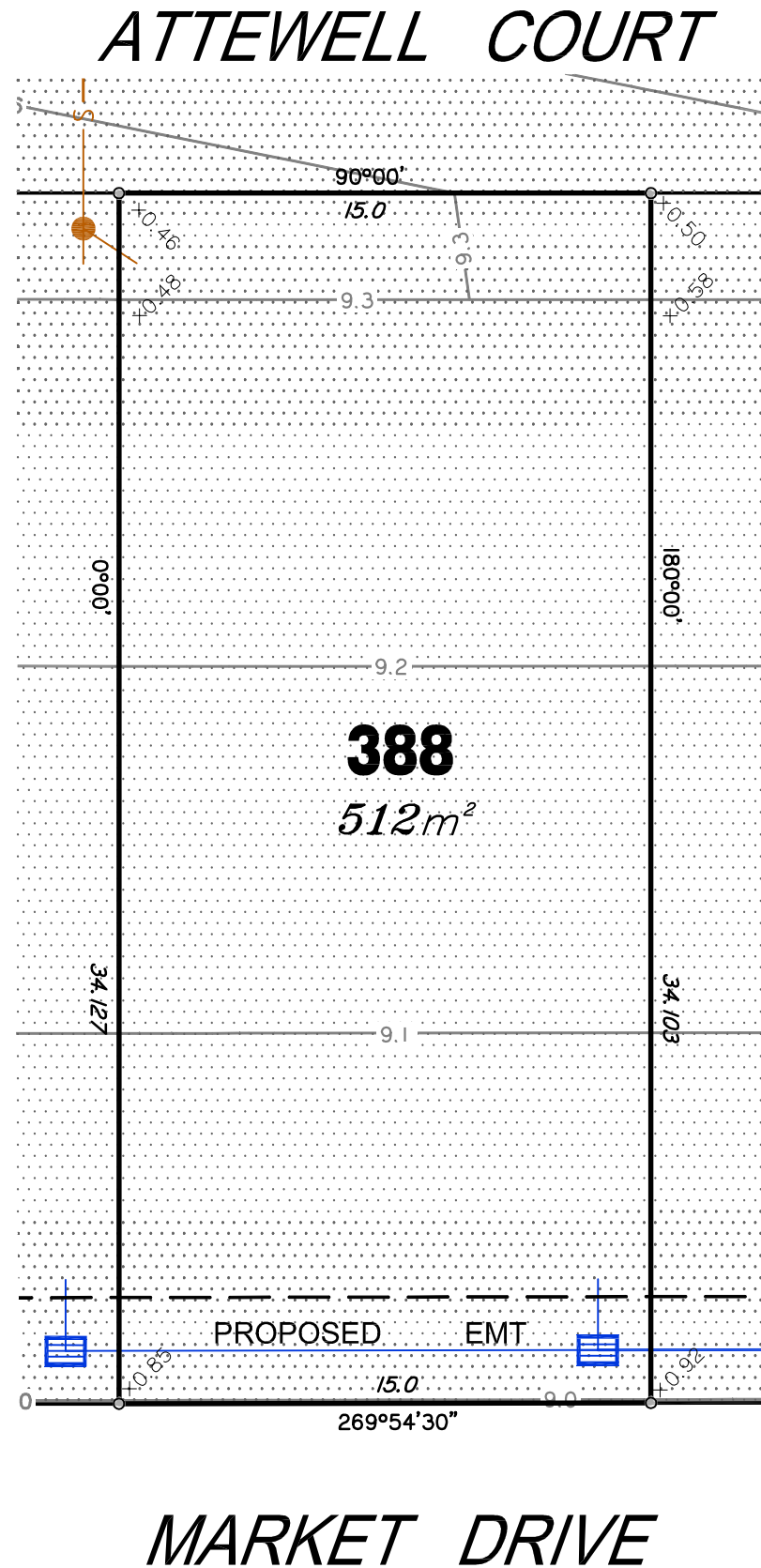

PROPOSED
LOT 389

PROPOSED
LOT 386

MARKET DRIVE

RIVERBANK

For
PEET

IMPORTANT NOTES:
(These notes are an integral part of this plan)
This plan has been prepared for PEET & CO for the purposes of **A Disclosure Plan Under the Land Sales Act 1984 (as Amended)**.

It is not to be used by any other person or corporation or for any other purposes and is subject to the following limitations:

The Lot dimensions and area shown herein are subject to final field survey and also to the requirements of Council and any other authority which may have requirements under any relevant legislation.

Design surface contours from the design surface data supplied by Brown Consulting Pty Ltd. Where final surface contours are not shown, no change to existing surface level is proposed.

Compaction of any fill material placed on this site shall be completed under inspection and testing services in accordance with AS3798-2007.

Location of sewer and roofwater lines, manholes and pits are those shown on engineering design drawings and may differ from the as-constructed location.

THESE DESIGNS AND DRAWINGS ARE COPYRIGHT AND ARE NOT TO BE USED OR REPRODUCED WITHOUT THE WRITTEN PERMISSION OF THG

Data Sources
Cadastral Boundaries 215809_1_LC1(D).dwg
Design Surface Contours Stage 9 - 12D Design Tin.12da
Engineering Design X_806158_BASE_MASTER_2014_09_08.dwg

| No | Revisions | Date | Chkd |
|----|-------------------------|---------|------|
| B | Revised to suit new Act | 2/12/14 | EJM |
| A | Original | 8/9/14 | EJM |

Parish: CABOOLTURE
County: STANLEY
Locality: CABOOLTURE SOUTH
Local Authority: M.B.R.C
Horizontal Meridian: SP232377
Vertical Level Datum: AHD
Level Origin: PM109474(RL15.112)
Scale: 1:200 @ A3
Surveyed: THG WSG Pty Ltd
Designed: Brown Consulting
Drawn: EJM
Checked: MMR
Plot Date: 03 Dec, 2014
Computer File Ref: 215809_5_DPs(B).dwg

DISCLOSURE PLAN
of Proposed Lot 388
being part of
Lot 2 on SP269617



BRISBANE (07) 3666 4700
MACKAY (07) 4951 2911
PROSERPINE (07) 4945 1722
BOWEN (07) 4786 1050
CAIRNS (07) 4051 6722

Email mail@thg.com.au www.thg.com.au
ABN 551 5621 0052 THG WSG Pty Ltd t/a THG Resource Strategists

Drawing No 30599-DP388 Issue B



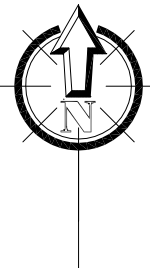

LEGEND

Final surface contours based on A.H.D. datum at an interval of 0.1m, shown as: — 1·0 —

Where applicable, areas filled from existing surface are shown as:-

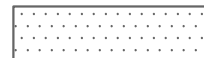

Depth of Fill +0.13

Sewer line shown as: — S —

Sewer Manhole/Maintenance Shaft shown as:

Roofwater Drainage line shown as: — RWD —

Roofwater Manhole shown as:

Roofwater Pit shown as:

ATTEWELL COURT

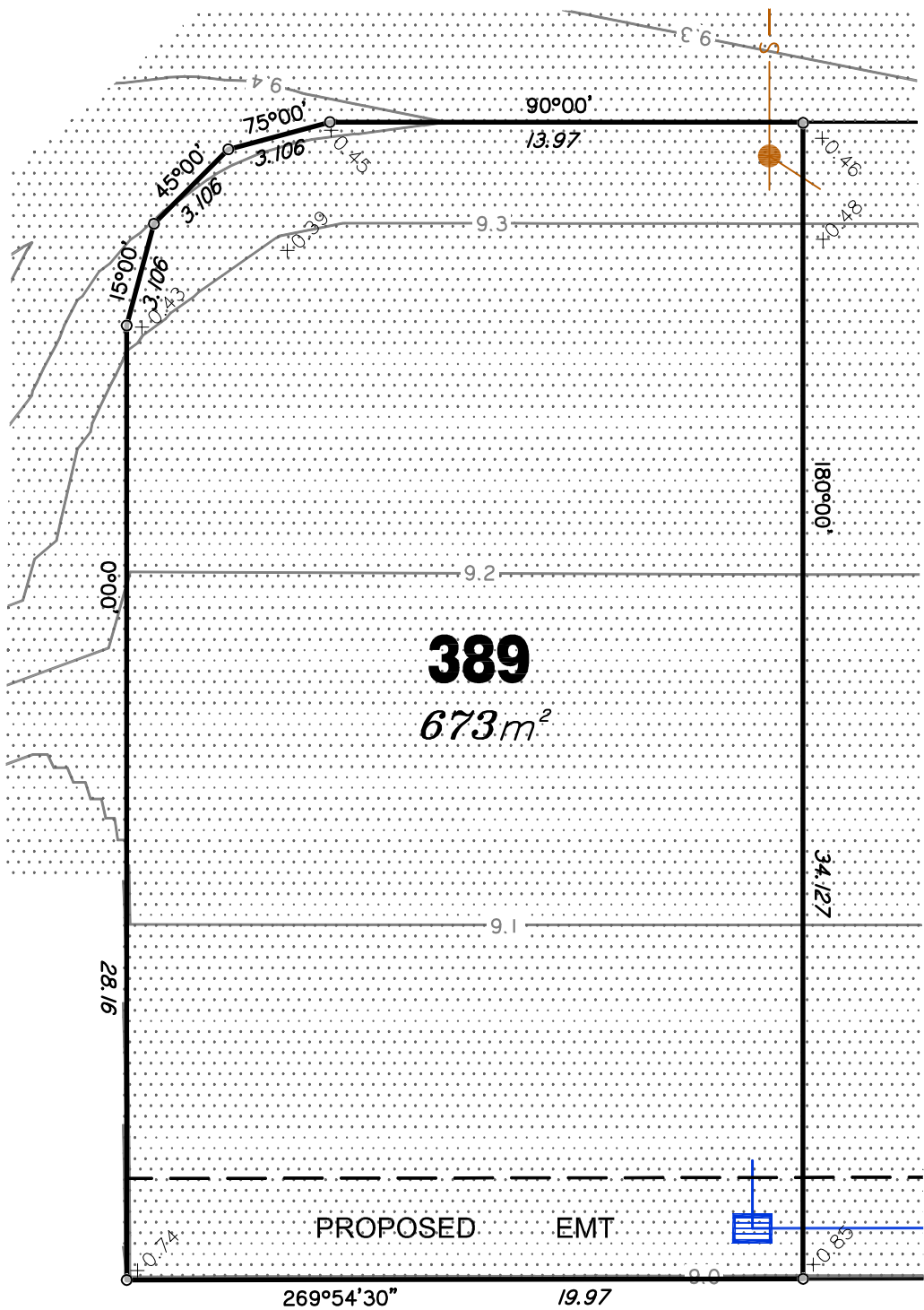

PROPOSED
LOT 388

389

673m²

PROPOSED EMT

MARKET DRIVE



RIVERBANK

For
PEET

IMPORTANT NOTES:
(These notes are an integral part of this plan)
This plan has been prepared for PEET & CO for the purposes of A Disclosure Plan Under the Land Sales Act 1984 (as Amended).

It is not to be used by any other person or corporation or for any other purposes and is subject to the following limitations:

The Lot dimensions and area shown herein are subject to final field survey and also to the requirements of Council and any other authority which may have requirements under any relevant legislation.

Design surface contours from the design surface data supplied by Brown Consulting Pty Ltd. Where final surface contours are not shown, no change to existing surface level is proposed.

Compaction of any fill material placed on this site shall be completed under inspection and testing services in accordance with AS3798-2007.

Location of sewer and roofwater lines, manholes and pits are those shown on engineering design drawings and may differ from the as-constructed location.

THESE DESIGNS AND DRAWINGS ARE COPYRIGHT AND ARE NOT TO BE USED OR REPRODUCED WITHOUT THE WRITTEN PERMISSION OF THG

Data Sources
Cadastral Boundaries 215809_1_LC1(D).dwg
Design Surface Contours Stage 9 - 12D Design Tin.12da
Engineering Design X_806158_BASE_MASTER_2014_09_08.dwg

| | | | |
|----|-------------------------|---------|------|
| | | | |
| B | Revised to suit new Act | 2/12/14 | EJM |
| A | Original | 8/9/14 | EJM |
| No | Revisions | Date | Chkd |

Parish: CABOOLTURE
County: STANLEY
Locality: CABOOLTURE SOUTH
Local Authority: M.B.R.C
Horizontal Meridian: SP232377
Vertical Level Datum: AHD
Level Origin: PM109474(RL15.112)
Scale: 1:200 @ A3
Surveyed: THG WSG Pty Ltd
Designed: Brown Consulting
Drawn: EJM
Checked: MMR
Plot Date: 03 Dec, 2014
Computer File Ref: 215809_5_DPs(B).dwg

DISCLOSURE PLAN
of Proposed Lot 389
being part of
Lot 2 on SP269617



BRISBANE (07) 3666 4700 MACKAY (07) 4951 2911 PROSERPINE (07) 4945 1722
BOWEN (07) 4786 1050 CAIRNS (07) 4051 6722

Email mail@thg.com.au www.thg.com.au
ABN 551 5621 0052 THG WSG Pty Ltd t/a THG Resource Strategists

Drawing No 30599-DP389 Issue B



LEGEND

Final surface contours based on A.H.D. datum at an interval of 0.1m, shown as: 1.0

Where applicable, areas filled from existing surface are shown as:

Depth of Fill $+0.1^3$

Sewer line shown as:

Sewer Manhole/Maintenance Shaft shown as:

Roofwater Drainage line shown as:

Roofwater Manhole shown as:

Roofwater Pit shown as:

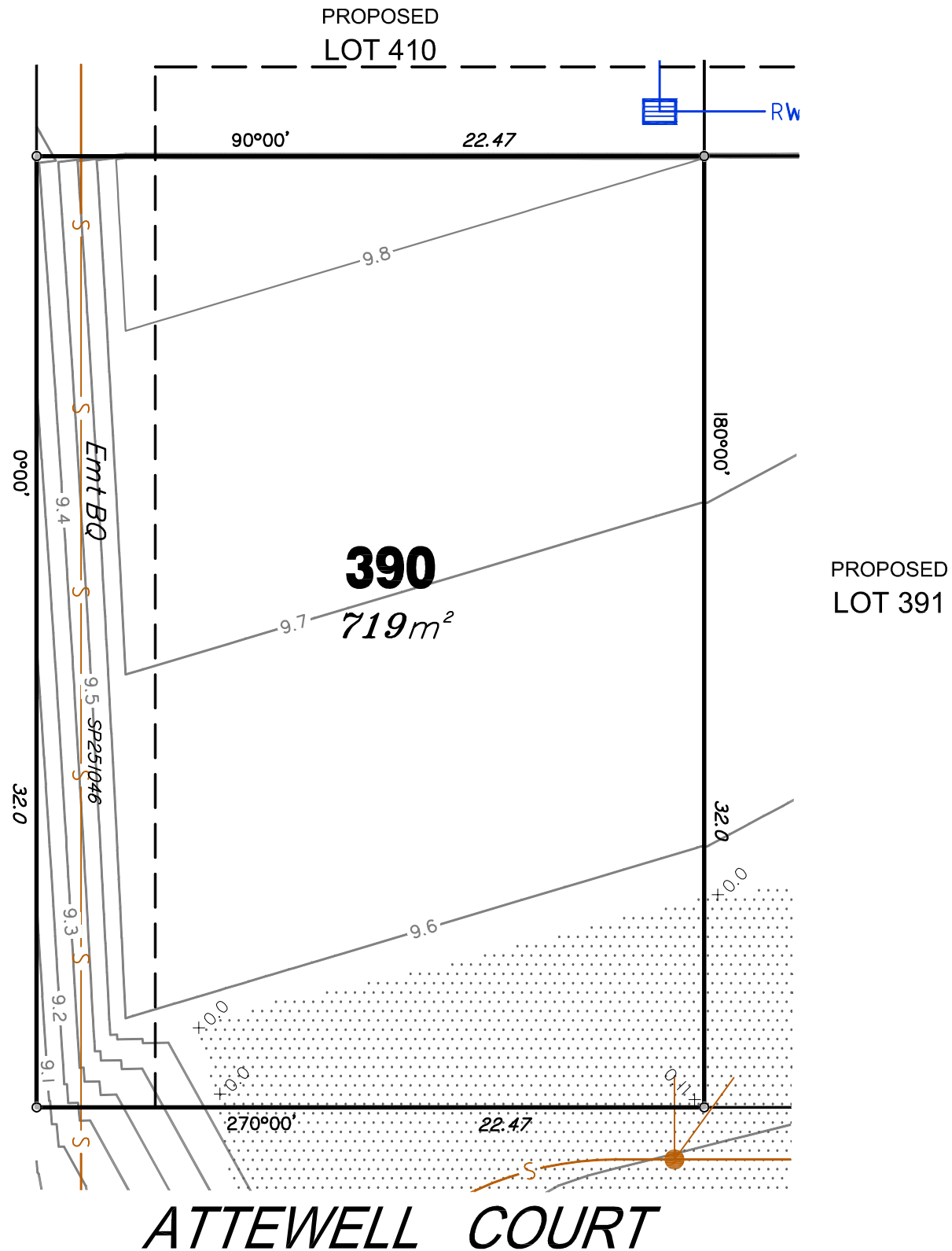

RIVERBANK

For
PEET

IMPORTANT NOTES:
(These notes are an integral part of this plan)
This plan has been prepared for PEET & CO for the purposes of a Disclosure Plan Under the Land Sales Act 1984 (as Amended).

It is not to be used by any other person or corporation or for any other purposes and is subject to the following limitations:

The Lot dimensions and area shown hereon are subject to final field survey and also to the requirements of Council and any other authority which may have requirements under any relevant legislation.

Design surface contours from the design surface data supplied by Brown Consulting Pty Ltd. Where final surface contours are not shown, no change to existing surface level is proposed.

Compaction of any fill material placed on this site shall be completed under inspection and testing services in accordance with AS3798-2007.

Location of sewer and roofwater lines, manholes and pits are those shown on engineering design drawings and may differ from the as-constructed location.

THESE DESIGNS AND DRAWINGS ARE COPYRIGHT AND ARE NOT TO BE USED OR REPRODUCED WITHOUT THE WRITTEN PERMISSION OF THG

Data Sources
Cadastral Boundaries 215809_1_LC1(D).dwg
Design Surface Contours Stage 9 - 12D Design Tin.12da
Engineering Design X_806158_BASE_MASTER_2014_09_08.dwg

| No | Revisions | Date | Chkd |
|----|-------------------------|---------|------|
| B | Revised to suit new Act | 2/12/14 | EJM |
| A | Original | 8/9/14 | EJM |

Parish: CABOOLTURE
County: STANLEY
Locality: CABOOLTURE SOUTH
Local Authority: M.B.R.C
Horizontal Meridian: SP232377
Vertical Level Datum: AHD
Level Origin: PM109474(RL15.112)
Scale: 1:200 @ A3
Surveyed: THG WSG Pty Ltd
Designed: Brown Consulting
Drawn: EJM
Checked: MMR
Plot Date: 03 Dec, 2014
Computer File Ref: 215809_5_DPs(B).dwg

DISCLOSURE PLAN
of Proposed Lot 390
being part of
Lot 2 on SP269617



BRISBANE (07) 3666 4700 MACKAY (07) 4951 2911 PROSERPINE (07) 4945 1722
BOWEN (07) 4786 1050 CAIRNS (07) 4051 6722

Email mail@thg.com.au www.thg.com.au
ABN 55156210052 THG WSG Pty Ltd t/a THG Resource Strategists

Drawing No **30599-DP390** Issue **B**



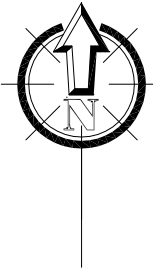

LEGEND

Final surface contours based on A.H.D. datum at an interval of 0.1m, shown as: — 1.0 —

Where applicable, areas filled from existing surface are shown as:-



Depth of Fill +0.13

Sewer line shown as: — S —

Sewer Manhole/Maintenance Shaft shown as:

Roofwater Drainage line shown as: — RWD —

Roofwater Manhole shown as:

Roofwater Pit shown as:

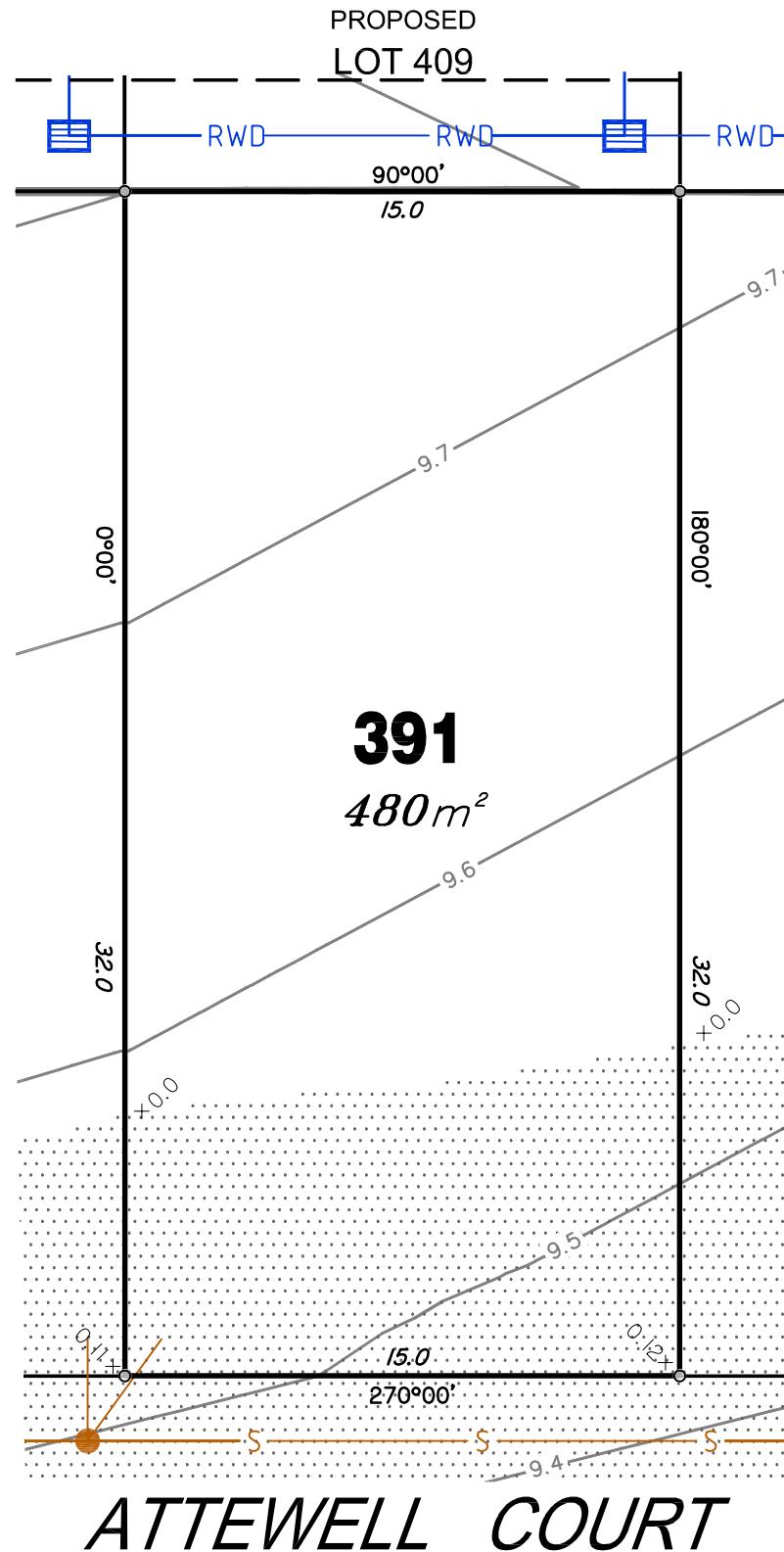

RIVERBANK

For
PEET

IMPORTANT NOTES:
(These notes are an integral part of this plan)
This plan has been prepared for PEET & CO for the purposes of A Disclosure Plan Under the Land Sales Act 1984 (as Amended).

It is not to be used by any other person or corporation or for any other purposes and is subject to the following limitations:

The Lot dimensions and area shown herein are subject to final field survey and also to the requirements of Council and any other authority which may have requirements under any relevant legislation.

Design surface contours from the design surface data supplied by Brown Consulting Pty Ltd. Where final surface contours are not shown, no change to existing surface level is proposed.

Compaction of any fill material placed on this site shall be completed under inspection and testing services in accordance with AS3798-2007.

Location of sewer and roofwater lines, manholes and pits are those shown on engineering design drawings and may differ from the as-constructed location.

THESE DESIGNS AND DRAWINGS ARE COPYRIGHT AND ARE NOT TO BE USED OR REPRODUCED WITHOUT THE WRITTEN PERMISSION OF THG

Data Sources
Cadastral Boundaries 215809_1.LC1(D).dwg
Design Surface Contours Stage 9 - 12D Design Tin.12da
Engineering Design X_806158.BASE_MASTER_2014_09_08.dwg

| No | Revisions | Date | Chkd |
|----|-------------------------|---------|------|
| B | Revised to suit new Act | 2/12/14 | EJM |
| A | Original | 8/9/14 | EJM |

Parish: CABOOLTURE
County: STANLEY
Locality: CABOOLTURE SOUTH
Local Authority: M.B.R.C
Horizontal Meridian: SP232377
Vertical Level Datum: AHD
Level Origin: PM109474(RL15.112)
Scale: 1:200 @ A3
Surveyed: THG WSG Pty Ltd
Designed: Brown Consulting
Drawn: EJM
Checked: MMR
Plot Date: 03 Dec, 2014
Computer File Ref: 215809_5 DPs(B).dwg

DISCLOSURE PLAN
of Proposed Lot 391
being part of
Lot 2 on SP269617



BRISBANE (07) 3666 4700
MACKAY (07) 4951 2911
PROSERPINE (07) 4945 1722
BOWEN (07) 4786 1050
CAIRNS (07) 4051 6722

Email mail@thg.com.au www.thg.com.au
ABN 55156210052 THG WSG Pty Ltd t/a THG Resource Strategists

Drawing No 30599-DP391 Issue B





LEGEND

Final surface contours based on A.H.D. datum at an interval of 0.1m, shown as: — 1.0 —

Where applicable, areas filled from existing surface are shown as:-

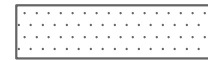

Depth of Fill +0.13

Sewer line shown as: — S —

Sewer Manhole/Maintenance Shaft shown as:

Roofwater Drainage line shown as: — RWD —

Roofwater Manhole shown as:

Roofwater Pit shown as:

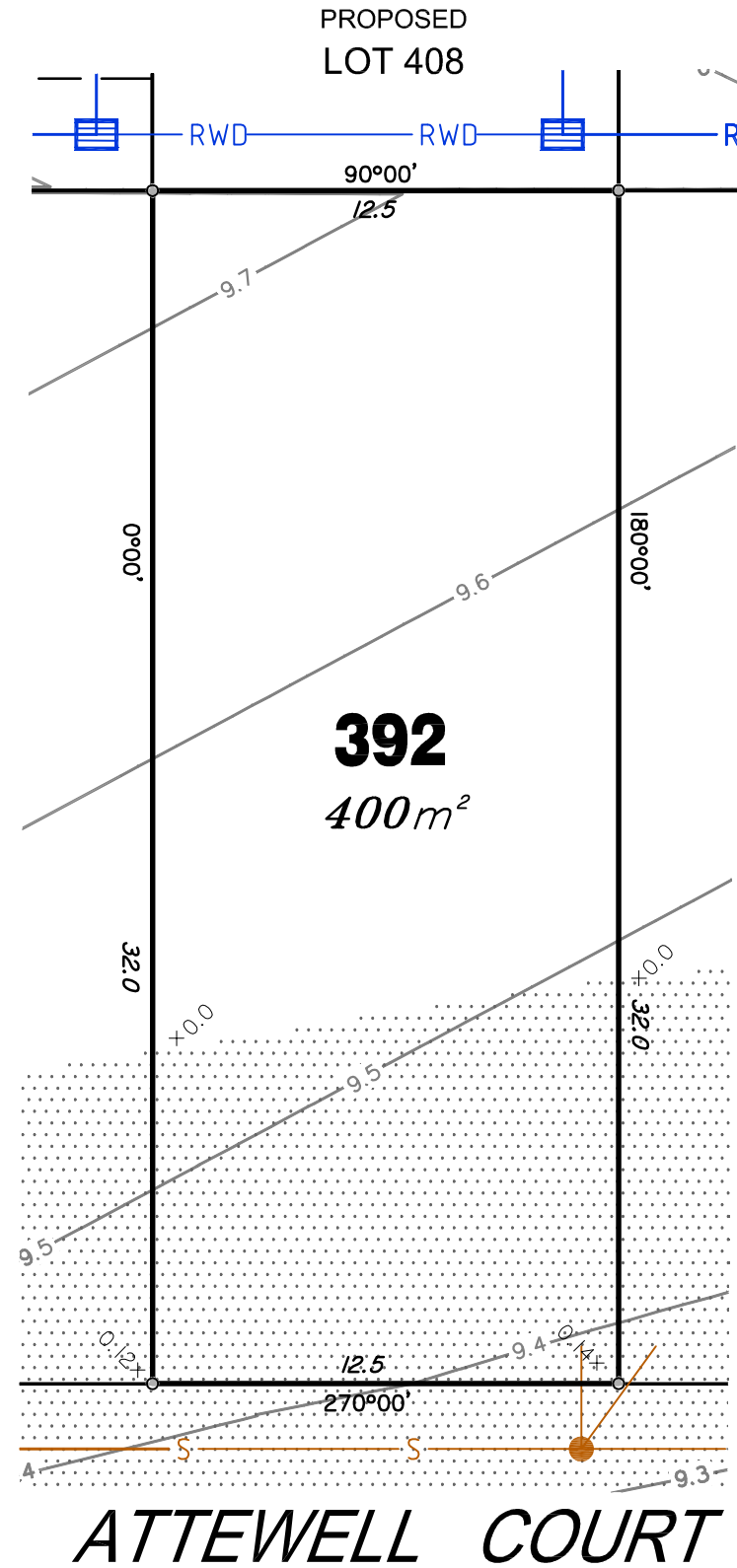

PROPOSED LOT 391

392
400m²

PROPOSED LOT 393

ATTEWELL COURT

RIVERBANK

For
PEET

IMPORTANT NOTES:
(These notes are an integral part of this plan)
This plan has been prepared for PEET & CO for the purposes of A Disclosure Plan Under the Land Sales Act 1984 (as Amended).

It is not to be used by any other person or corporation or for any other purposes and is subject to the following limitations:

The Lot dimensions and area shown herein are subject to final field survey and also to the requirements of Council and any other authority which may have requirements under any relevant legislation.

Design surface contours from the design surface data supplied by Brown Consulting Pty Ltd. Where final surface contours are not shown, no change to existing surface level is proposed.

Compaction of any fill material placed on this site shall be completed under inspection and testing services in accordance with AS3798-2007.

Location of sewer and roofwater lines, manholes and pits are those shown on engineering design drawings and may differ from the as-constructed location.

THESE DESIGNS AND DRAWINGS ARE COPYRIGHT AND ARE NOT TO BE USED OR REPRODUCED WITHOUT THE WRITTEN PERMISSION OF THG

Data Sources
Cadastral Boundaries 215809_1_LC1(D).dwg
Design Surface Contours Stage 9 - 12D Design Tin.12da
Engineering Design X_806158_BASE_MASTER_2014_09_08.dwg

| No | Revisions | Date | Chkd |
|----|-------------------------|---------|------|
| B | Revised to suit new Act | 2/12/14 | EJM |
| A | Original | 8/9/14 | EJM |

Parish: CABOOLTURE
County: STANLEY
Locality: CABOOLTURE SOUTH
Local Authority: M.B.R.C
Horizontal Meridian: SP232377
Vertical Level Datum: AHD
Level Origin: PM109474(RL15.112)
Scale: 1:200 @ A3
Surveyed: THG WSG Pty Ltd
Designed: Brown Consulting
Drawn: EJM
Checked: MMR
Plot Date: 03 Dec, 2014
Computer File Ref: 215809_5 DPs(B).dwg

DISCLOSURE PLAN
of Proposed Lot 392
being part of
Lot 2 on SP269617



BRISBANE (07) 3666 4700 MACKAY (07) 4951 2911 PROSERPINE (07) 4945 1722
BOWEN (07) 4786 1050 CAIRNS (07) 4051 6722

Email mail@thg.com.au www.thg.com.au
ABN 551 5621 0052 THG WSG Pty Ltd t/a THG Resource Strategists

Drawing No 30599-DP392 Issue B





LEGEND

Final surface contours based on A.H.D. datum at an interval of 0.1m, shown as: 1:0

Where applicable, areas filled from existing surface are shown as:-

Depth of Fill $+0.13$

Sewer line shown as: S

Sewer Manhole/Maintenance Shaft shown as:

Roofwater Drainage line shown as: RWD

Roofwater Manhole shown as:

Roofwater Pit shown as:

PROPOSED LOT 392

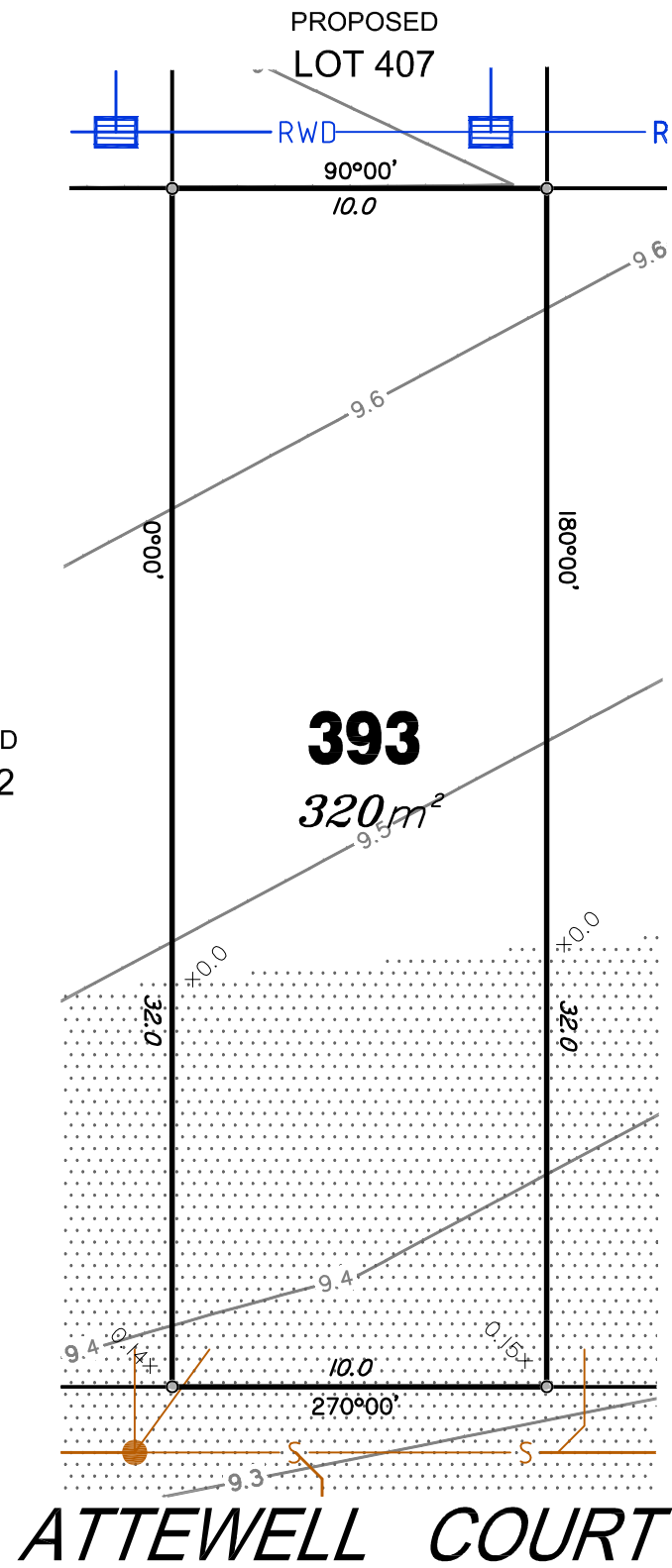

PROPOSED LOT 394

ATTEWELL COURT

RIVERBANK

For
PEET

IMPORTANT NOTES:
(These notes are an integral part of this plan)
This plan has been prepared for PEET & CO for the purposes of A Disclosure Plan Under the Land Sales Act 1984 (as Amended).

It is not to be used by any other person or corporation or for any other purposes and is subject to the following limitations:

The Lot dimensions and area shown herein are subject to final field survey and also to the requirements of Council and any other authority which may have requirements under any relevant legislation.

Design surface contours from the design surface data supplied by Brown Consulting Pty Ltd. Where final surface contours are not shown, no change to existing surface level is proposed.

Compaction of any fill material placed on this site shall be completed under inspection and testing services in accordance with AS3798-2007.

Location of sewer and roofwater lines, manholes and pits are those shown on engineering design drawings and may differ from the as-constructed location.

THESE DESIGNS AND DRAWINGS ARE COPYRIGHT AND ARE NOT TO BE USED OR REPRODUCED WITHOUT THE WRITTEN PERMISSION OF THG

Data Sources
Cadastral Boundaries 215809_1_LC1(D).dwg
Design Surface Contours Stage 9 - 12D Design Tin.12da
Engineering Design X_806158_BASE_MASTER_2014_09_08.dwg

| No | Revisions | Date | Chkd |
|----|-------------------------|---------|------|
| B | Revised to suit new Act | 2/12/14 | EJM |
| A | Original | 8/9/14 | EJM |

Parish: CABOOLTURE
County: STANLEY
Locality: CABOOLTURE SOUTH
Local Authority: M.B.R.C
Horizontal Meridian: SP232377
Vertical Level Datum: AHD
Level Origin: PM109474(RL15.112)
Scale: 1:200 @ A3
Surveyed: THG WSG Pty Ltd
Designed: Brown Consulting
Drawn: EJM
Checked: MMR
Plot Date: 03 Dec, 2014
Computer File Ref: 215809_5 DPs(B).dwg

DISCLOSURE PLAN
of Proposed Lot 393
being part of
Lot 2 on SP269617



BRISBANE (07) 3666 4700 MACKAY (07) 4951 2911 PROSERPINE (07) 4945 1722
BOWEN (07) 4786 1050 CAIRNS (07) 4051 6722

Email mail@thg.com.au www.thg.com.au
ABN 55156210052 THG WSG Pty Ltd t/a THG Resource Strategists

Drawing No 30599-DP393 Issue B



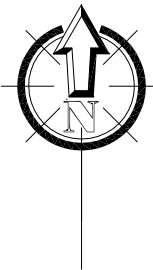

LEGEND

Final surface contours based on A.H.D. datum at an interval of 0.1m, shown as: — 1-0 —

Where applicable, areas filled from existing surface are shown as:-

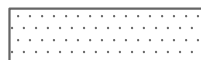

Depth of Fill +0.13

Sewer line shown as: — S —

Sewer Manhole/Maintenance Shaft shown as:

Roofwater Drainage line shown as: — RWD —

Roofwater Manhole shown as:

Roofwater Pit shown as:

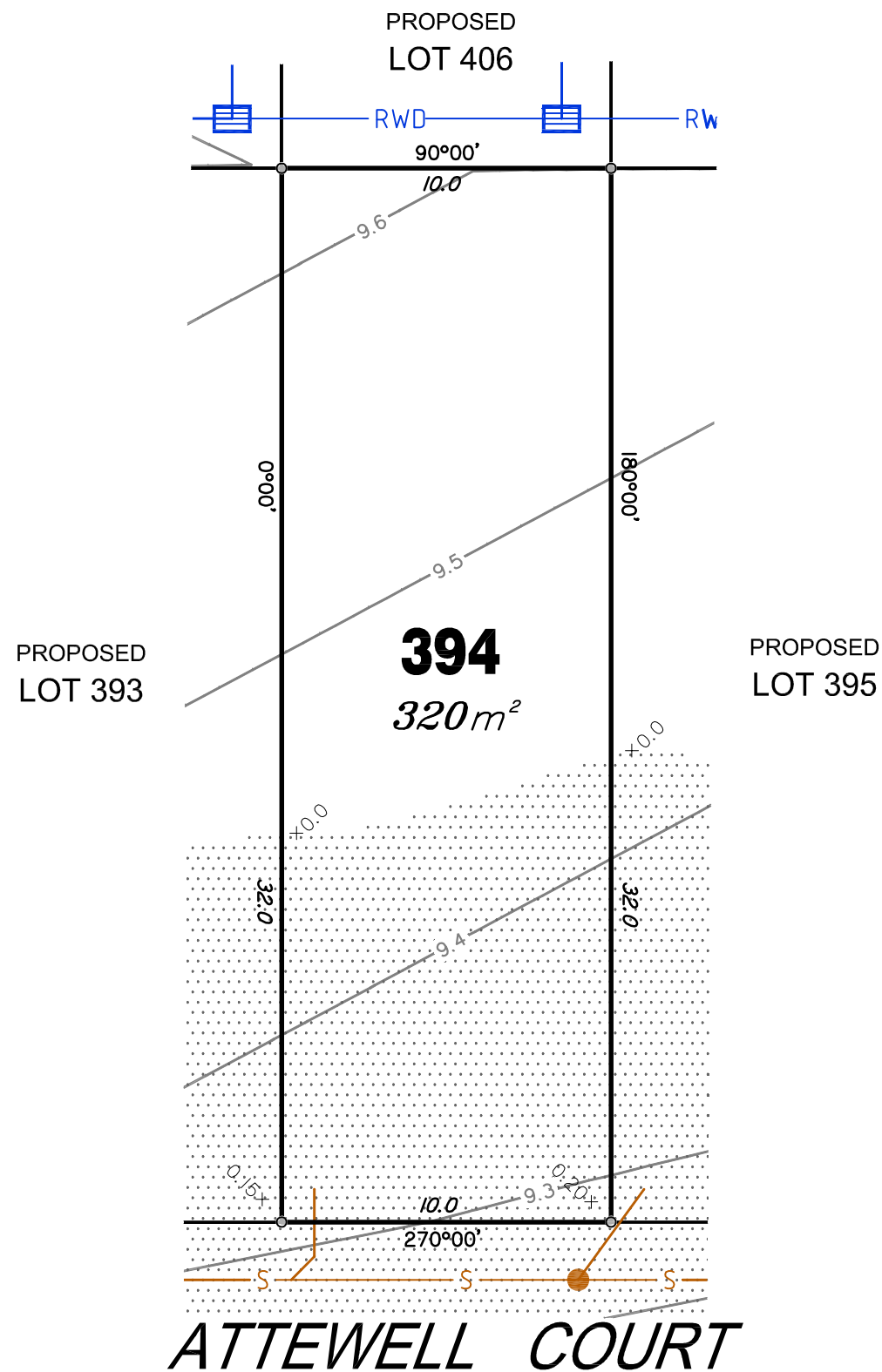

RIVERBANK

For
PEET

IMPORTANT NOTES:
(These notes are an integral part of this plan)
This plan has been prepared for PEET & CO for the purposes of **A Disclosure Plan Under the Land Sales Act 1984 (as Amended)**.

It is not to be used by any other person or corporation or for any other purposes and is subject to the following limitations:

The Lot dimensions and area shown herein are subject to final field survey and also to the requirements of Council and any other authority which may have requirements under any relevant legislation.

Design surface contours from the design surface data supplied by Brown Consulting Pty Ltd. Where final surface contours are not shown, no change to existing surface level is proposed.

Compaction of any fill material placed on this site shall be completed under inspection and testing services in accordance with AS3798-2007.

Location of sewer and roofwater lines, manholes and pits are those shown on engineering design drawings and may differ from the as-constructed location.

THESE DESIGNS AND DRAWINGS ARE COPYRIGHT AND ARE NOT TO BE USED OR REPRODUCED WITHOUT THE WRITTEN PERMISSION OF THG

Data Sources
Cadastral Boundaries 215809_1_LC1(D).dwg
Design Surface Contours Stage 9 - 12D Design Tin.12da
Engineering Design X_806158_BASE_MASTER_2014_09_08.dwg

| No | Revisions | Date | Chkd |
|----|-------------------------|---------|------|
| B | Revised to suit new Act | 2/12/14 | EJM |
| A | Original | 8/9/14 | EJM |

Parish: CABOOLTURE
County: STANLEY
Locality: CABOOLTURE SOUTH
Local Authority: M.B.R.C
Horizontal Meridian: SP232377
Vertical Level Datum: AHD
Level Origin: PM109474(RL15.112)
Scale: 1:200 @ A3
Surveyed: THG WSG Pty Ltd
Designed: Brown Consulting
Drawn: EJM
Checked: MMR
Plot Date: 03 Dec, 2014
Computer File Ref: 215809_5 DPs(B).dwg

DISCLOSURE PLAN
of Proposed Lot 394
being part of
Lot 2 on SP269617



BRISBANE (07) 3666 4700
MACKAY (07) 4951 2911
PROSERPINE (07) 4945 1722
BOWEN (07) 4786 1050
CAIRNS (07) 4051 6722

Email mail@thg.com.au www.thg.com.au
ABN 55156210052 THG WSG Pty Ltd t/a THG Resource Strategists

Drawing No **30599-DP394** Issue **B**



LEGEND

Final surface contours based on A.H.D. datum at an interval of 0.1m, shown as: — 1:0 —

Where applicable, areas filled from existing surface are shown as:-

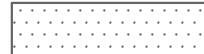

Depth of Fill +0.13

Sewer line shown as: — S —

Sewer Manhole/Maintenance Shaft shown as:

Roofwater Drainage line shown as: — RWD —

Roofwater Manhole shown as:

Roofwater Pit shown as:

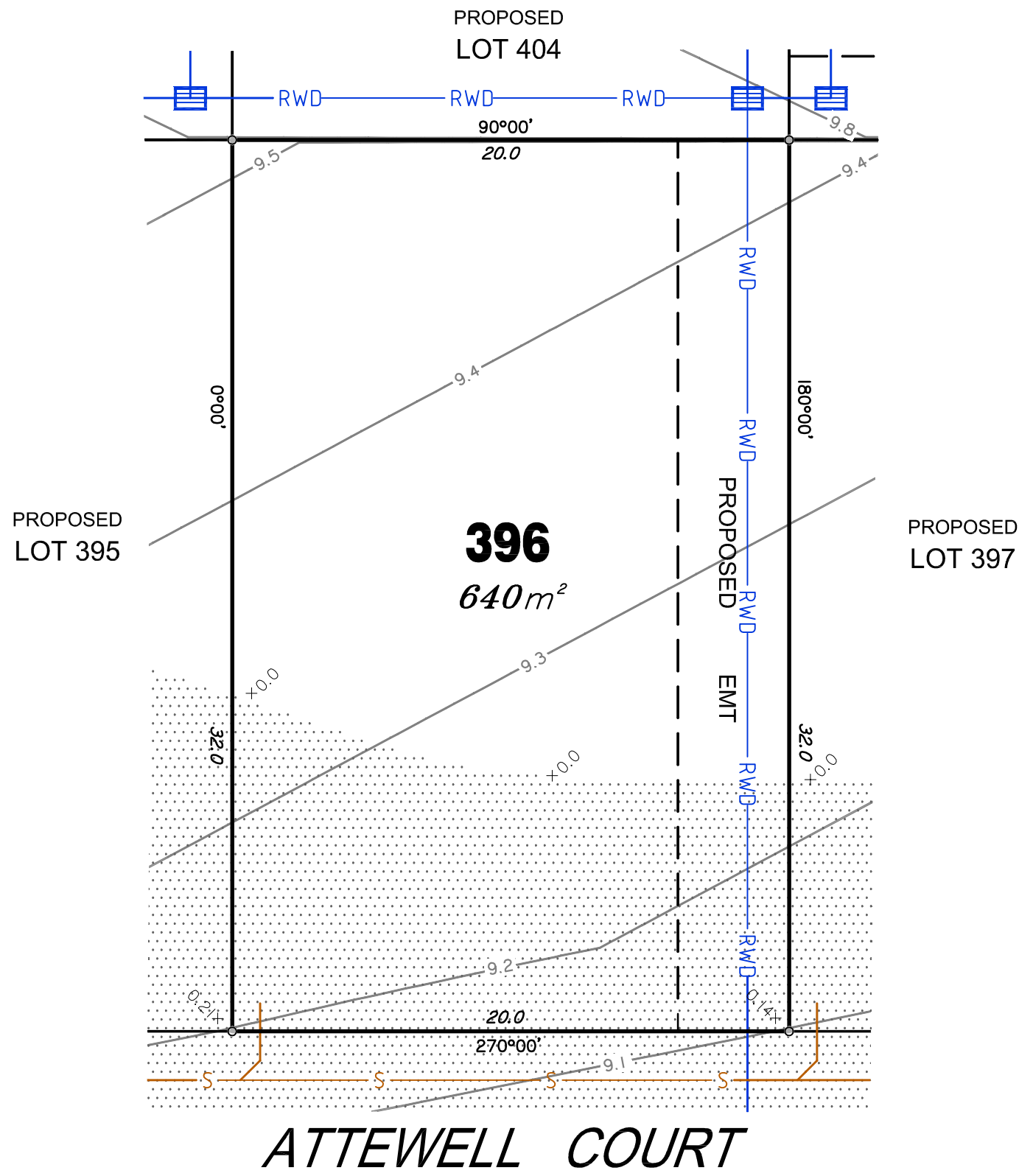

IMPORTANT NOTES:
(These notes are an integral part of this plan)
This plan has been prepared for PEET & CO for the purposes of **A Disclosure Plan Under the Land Sales Act 1984 (as Amended)**.

It is not to be used by any other person or corporation or for any other purposes and is subject to the following limitations:
The Lot dimensions and area shown herein are subject to final field survey and also to the requirements of Council and any other authority which may have requirements under any relevant legislation.

Design surface contours from the design surface data supplied by Brown Consulting Pty Ltd. Where final surface contours are not shown, no change to existing surface level is proposed.

Compaction of any fill material placed on this site shall be completed under inspection and testing services in accordance with AS3798-2007.

Location of sewer and roofwater lines, manholes and pits are those shown on engineering design drawings and may differ from the as-constructed location.

THESE DESIGNS AND DRAWINGS ARE COPYRIGHT AND ARE NOT TO BE USED OR REPRODUCED WITHOUT THE WRITTEN PERMISSION OF THG

Data Sources
Cadastral Boundaries 215809_1_LC1(D).dwg
Design Surface Contours Stage 9 - 12D Design Tin.12da
Engineering Design X_806158_BASE_MASTER_2014_09_08.dwg

| No | Revisions | Date | Chkd |
|----|-------------------------|---------|------|
| B | Revised to suit new Act | 2/12/14 | EJM |
| A | Original | 8/9/14 | EJM |

Parish: CABOOLTURE
County: STANLEY
Locality: CABOOLTURE SOUTH
Local Authority: M.B.R.C
Horizontal Meridian: SP232377
Vertical Level Datum: AHD
Level Origin: PM109474(RL15.112)
Scale: 1:200 @ A3
Surveyed: THG WSG Pty Ltd
Designed: Brown Consulting
Drawn: EJM
Checked: MMR
Plot Date: 03 Dec, 2014
Computer File Ref: 215809_5 DPs(B).dwg

DISCLOSURE PLAN
of Proposed Lot 396
being part of
Lot 2 on SP269617



THG

BRISBANE (07) 3666 4700 MACKAY (07) 4951 2911 PROSERPINE (07) 4945 1722
BOWEN (07) 4786 1050 CAIRNS (07) 4051 6722

Email mail@thg.com.au www.thg.com.au
ABN 55156210052 THG WSG Pty Ltd t/a THG Resource Strategists

Drawing No **30599-DP396** Issue **B**

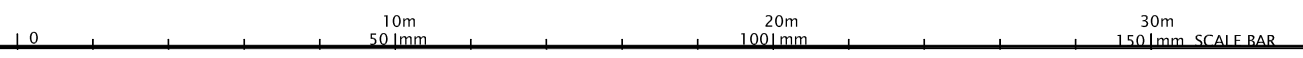



LEGEND

Final surface contours based on A.H.D. datum at an interval of 0.1m, shown as: 1:0

Where applicable, areas filled from existing surface are shown as:-

Depth of Fill $+0.13$

Sewer line shown as:

Sewer Manhole/Maintenance Shaft shown as:

Roofwater Drainage line shown as:

Roofwater Manhole shown as:

Roofwater Pit shown as:

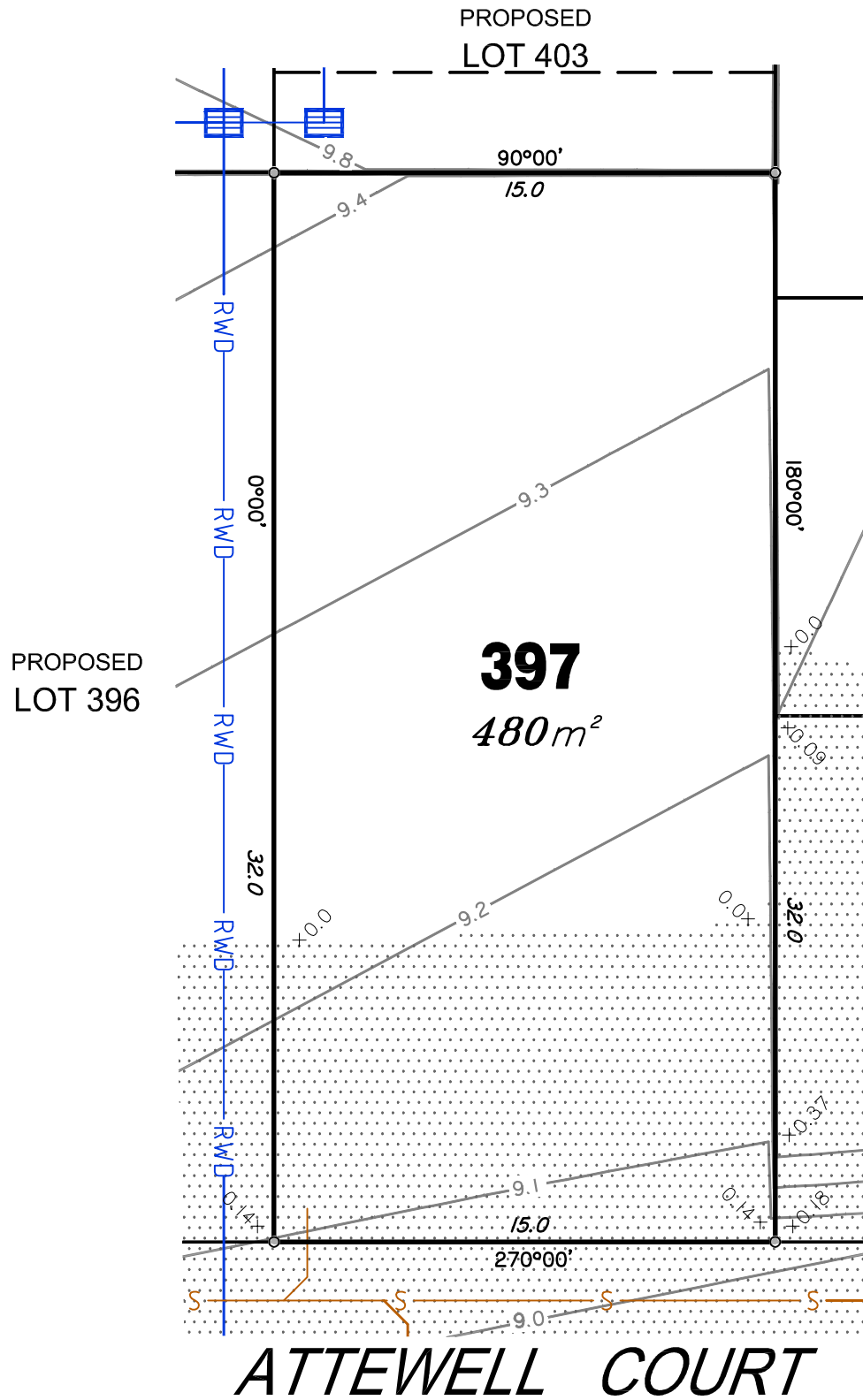

ATTEWELL COURT

RIVERBANK

For
PEET

IMPORTANT NOTES:
(These notes are an integral part of this plan)
This plan has been prepared for PEET & CO for the purposes of A Disclosure Plan Under the Land Sales Act 1984 (as Amended).

It is not to be used by any other person or corporation or for any other purposes and is subject to the following limitations:

The Lot dimensions and area shown herein are subject to final field survey and also to the requirements of Council and any other authority which may have requirements under any relevant legislation.

Design surface contours from the design surface data supplied by Brown Consulting Pty Ltd. Where final surface contours are not shown, no change to existing surface level is proposed.

Compaction of any fill material placed on this site shall be completed under inspection and testing services in accordance with AS3798-2007.

Location of sewer and roofwater lines, manholes and pits are those shown on engineering design drawings and may differ from the as-constructed location.

THESE DESIGNS AND DRAWINGS ARE COPYRIGHT AND ARE NOT TO BE USED OR REPRODUCED WITHOUT THE WRITTEN PERMISSION OF THG

Data Sources
Cadastral Boundaries 215809_1_LC1(D).dwg
Design Surface Contours Stage 9 - 12D Design Tin.12da
Engineering Design X_806158_BASE_MASTER_2014_09_08.dwg

| No | Revisions | Date | Chkd |
|----|-------------------------|---------|------|
| B | Revised to suit new Act | 2/12/14 | EJM |
| A | Original | 8/9/14 | EJM |

Parish: CABOOLTURE
County: STANLEY
Locality: CABOOLTURE SOUTH
Local Authority: M.B.R.C
Horizontal Meridian: SP232377
Vertical Level Datum: AHD
Level Origin: PM109474(RL15.112)
Scale: 1:200 @ A3
Surveyed: THG WSG Pty Ltd
Designed: Brown Consulting
Drawn: EJ
Checked: MMR
Plot Date: 03 Dec, 2014
Computer File Ref: 215809_5 DPs(B).dwg

DISCLOSURE PLAN
of Proposed Lot 397
being part of
Lot 2 on SP269617



BRISBANE (07) 3666 4700 MACKAY (07) 4951 2911 PROSERPINE (07) 4945 1722
BOWEN (07) 4786 1050 CAIRNS (07) 4051 6722

Email mail@thg.com.au www.thg.com.au
ABN 55156210052 THG WSG Pty Ltd t/a THG Resource Strategists

Drawing No 30599-DP397 Issue B





LEGEND

Final surface contours based on A.H.D. datum at an interval of 0.1m, shown as: 1-0

Where applicable, areas filled from existing surface are shown as:

Depth of Fill +0.13

Sewer line shown as:

Sewer Manhole/Maintenance Shaft shown as:

Roofwater Drainage line shown as:

Roofwater Manhole shown as:

Roofwater Pit shown as:

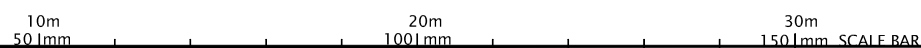
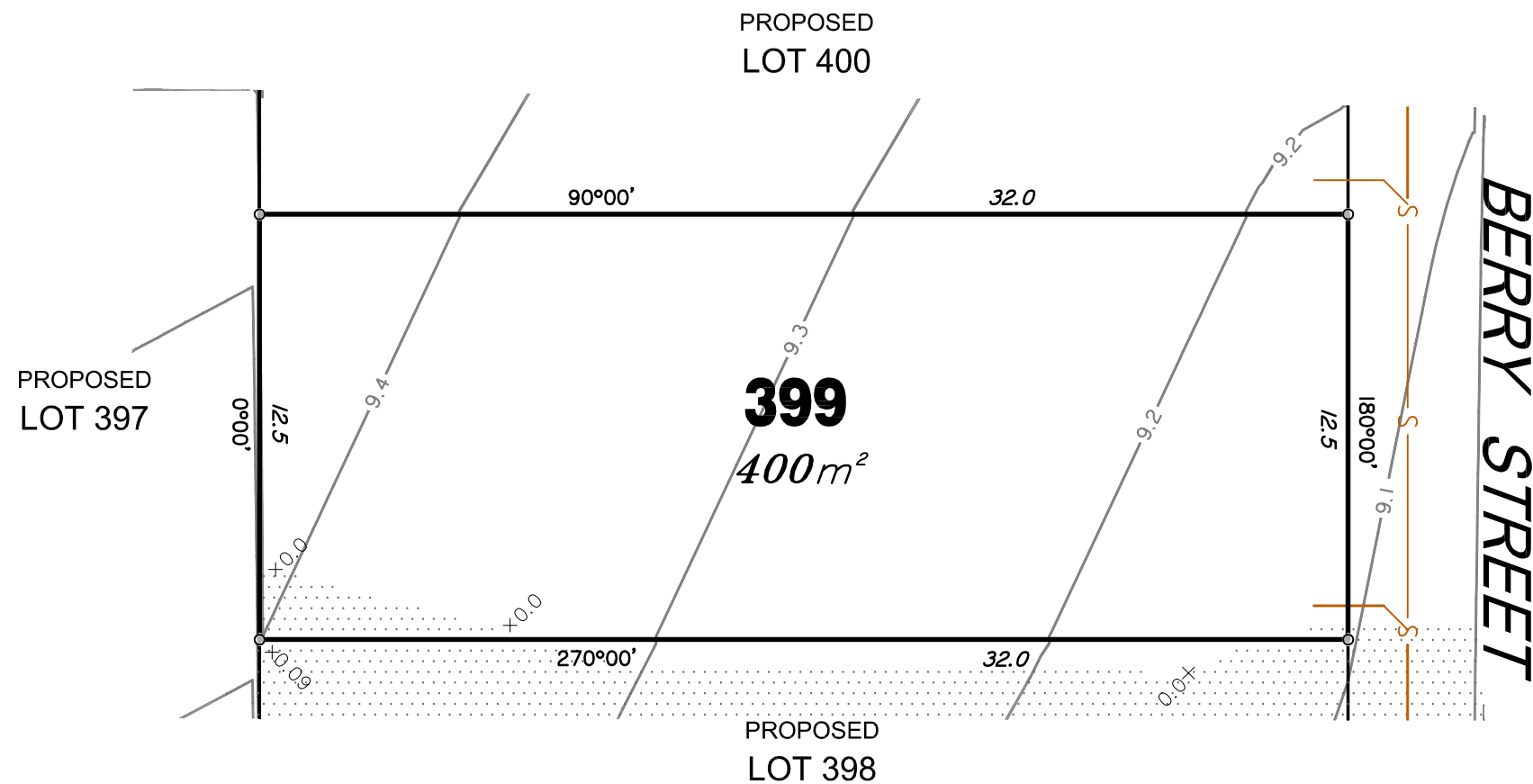

IMPORTANT NOTES:
(These notes are an integral part of this plan)
This plan has been prepared for PEET & CO for the purposes of **A Disclosure Plan Under the Land Sales Act 1984 (as Amended)**.

It is not to be used by any other person or corporation or for any other purposes and is subject to the following limitations:

The Lot dimensions and area shown herein are subject to final field survey and also to the requirements of Council and any other authority which may have requirements under any relevant legislation.

Design surface contours from the design surface data supplied by Brown Consulting Pty Ltd. Where final surface contours are not shown, no change to existing surface level is proposed.

Compaction of any fill material placed on this site shall be completed under inspection and testing services in accordance with AS3798-2007.

Location of sewer and roofwater lines, manholes and pits are those shown on engineering design drawings and may differ from the as-constructed location.

THESE DESIGNS AND DRAWINGS ARE COPYRIGHT AND ARE NOT TO BE USED OR REPRODUCED WITHOUT THE WRITTEN PERMISSION OF THG

Data Sources

| | |
|-------------------------|-------------------------------------|
| Cadastral Boundaries | 215809_1_LC1(D).dwg |
| Design Surface Contours | Stage 9 - 12D Design Tin.12da |
| Engineering Design | X_806158_BASE_MASTER_2014_09_08.dwg |

| No | Revisions | Date | Chkd |
|----|-------------------------|---------|------|
| B | Revised to suit new Act | 2/12/14 | EJM |
| A | Original | 8/9/14 | EJM |

Parish: CABOOLTURE
 County: STANLEY
 Locality: CABOOLTURE SOUTH
 Local Authority: M.B.R.C
 Horizontal Meridian: SP232377
 Vertical Level Datum: AHD
 Level Origin: PM109474(RL15.112)
 Scale: 1:200 @ A3
 Surveyed: THG WSG Pty Ltd
 Designed: Brown Consulting
 Drawn: EJM
 Checked: MMR
 Plot Date: 03 Dec, 2014
 Computer File Ref: 215809_5_DPs(B).dwg

DISCLOSURE PLAN
 of Proposed Lot 399
 being part of
 Lot 2 on SP269617



BRISBANE (07) 3666 4700 MACKAY (07) 4951 2911 PROSERPINE (07) 4945 1722
 BOWEN (07) 4786 1050 CAIRNS (07) 4051 6722

Email mail@thg.com.au www.thg.com.au
 ABN 551 5621 0052 THG WSG Pty Ltd t/a THG Resource Strategists

Drawing No **30599-DP399** Issue **B**



LEGEND

Final surface contours based on A.H.D. datum at an interval of 0.1m, shown as: 1.0

Where applicable, areas filled from existing surface are shown as:-

Depth of Fill +0.13

Sewer line shown as:

Sewer Manhole/Maintenance Shaft shown as:

Roofwater Drainage line shown as:

Roofwater Manhole shown as:

Roofwater Pit shown as:

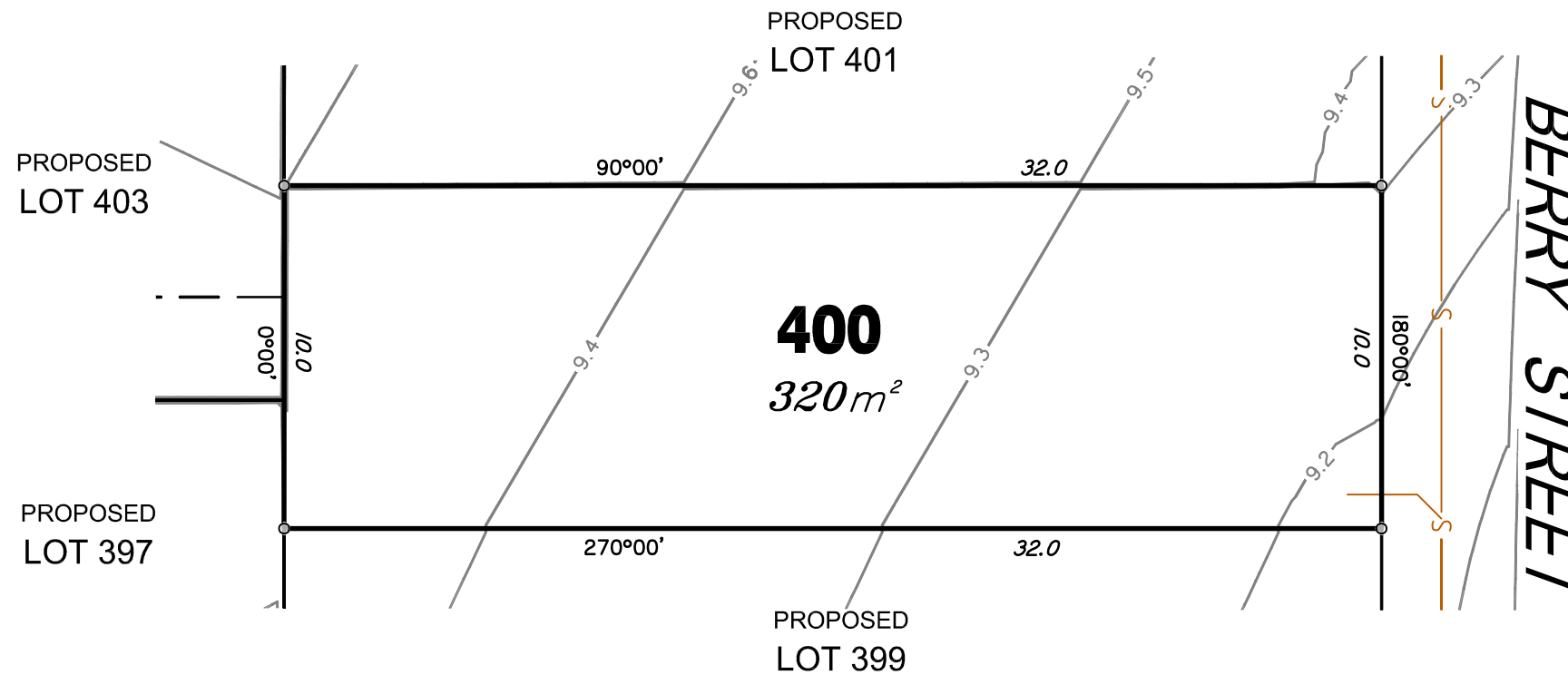

RIVERBANK

For
PEET

IMPORTANT NOTES:
(These notes are an integral part of this plan)
This plan has been prepared for PEET & CO for the purposes of **A Disclosure Plan Under the Land Sales Act 1984 (as Amended)**.

It is not to be used by any other person or corporation or for any other purposes and is subject to the following limitations:

The Lot dimensions and area shown herein are subject to final field survey and also to the requirements of Council and any other authority which may have requirements under any relevant legislation.

Design surface contours from the design surface data supplied by Brown Consulting Pty Ltd. Where final surface contours are not shown, no change to existing surface level is proposed.

Compaction of any fill material placed on this site shall be completed under inspection and testing services in accordance with AS3798-2007.

Location of sewer and roofwater lines, manholes and pits are those shown on engineering design drawings and may differ from the as-constructed location.

THESE DESIGNS AND DRAWINGS ARE COPYRIGHT AND ARE NOT TO BE USED OR REPRODUCED WITHOUT THE WRITTEN PERMISSION OF THG

Data Sources
Cadastral Boundaries 215809_1_LC1(D).dwg
Design Surface Contours Stage 9 - 12D Design Tin.12da
Engineering Design X_806158_BASE_MASTER_2014_09_08.dwg

| No | Revisions | Date | Chkd |
|----|-------------------------|---------|------|
| B | Revised to suit new Act | 2/12/14 | EJM |
| A | Original | 8/9/14 | EJM |

Parish: CABOOLTURE
County: STANLEY
Locality: CABOOLTURE SOUTH
Local Authority: M.B.R.C
Horizontal Meridian: SP232377
Vertical Level Datum: AHD
Level Origin: PM109474(RL15.112)
Scale: 1:200 @ A3
Surveyed: THG WSG Pty Ltd
Designed: Brown Consulting
Drawn: EJM
Checked: MMR
Plot Date: 03 Dec, 2014
Computer File Ref: 215809_5 DPs(B).dwg

DISCLOSURE PLAN
of Proposed Lot 400
being part of
Lot 2 on SP269617



BRISBANE (07) 3666 4700 MACKAY (07) 4951 2911 PROSERPINE (07) 4945 1722
BOWEN (07) 4786 1050 CAIRNS (07) 4051 6722

Email mail@thg.com.au www.thg.com.au
ABN 55156210052 THG WSG Pty Ltd t/a THG Resource Strategists

Drawing No **30599-DP400** Issue **B**



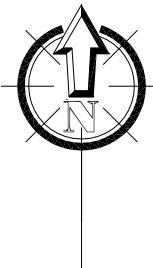

LEGEND

Final surface contours based on A.H.D. datum at an interval of 0.1m, shown as: — 1.0 —

Where applicable, areas filled from existing surface are shown as:-

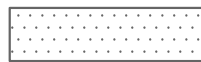

Depth of Fill +0.13

Sewer line shown as: — S —

Sewer Manhole/Maintenance Shaft shown as:

Roofwater Drainage line shown as: — RWD —

Roofwater Manhole shown as:

Roofwater Pit shown as:

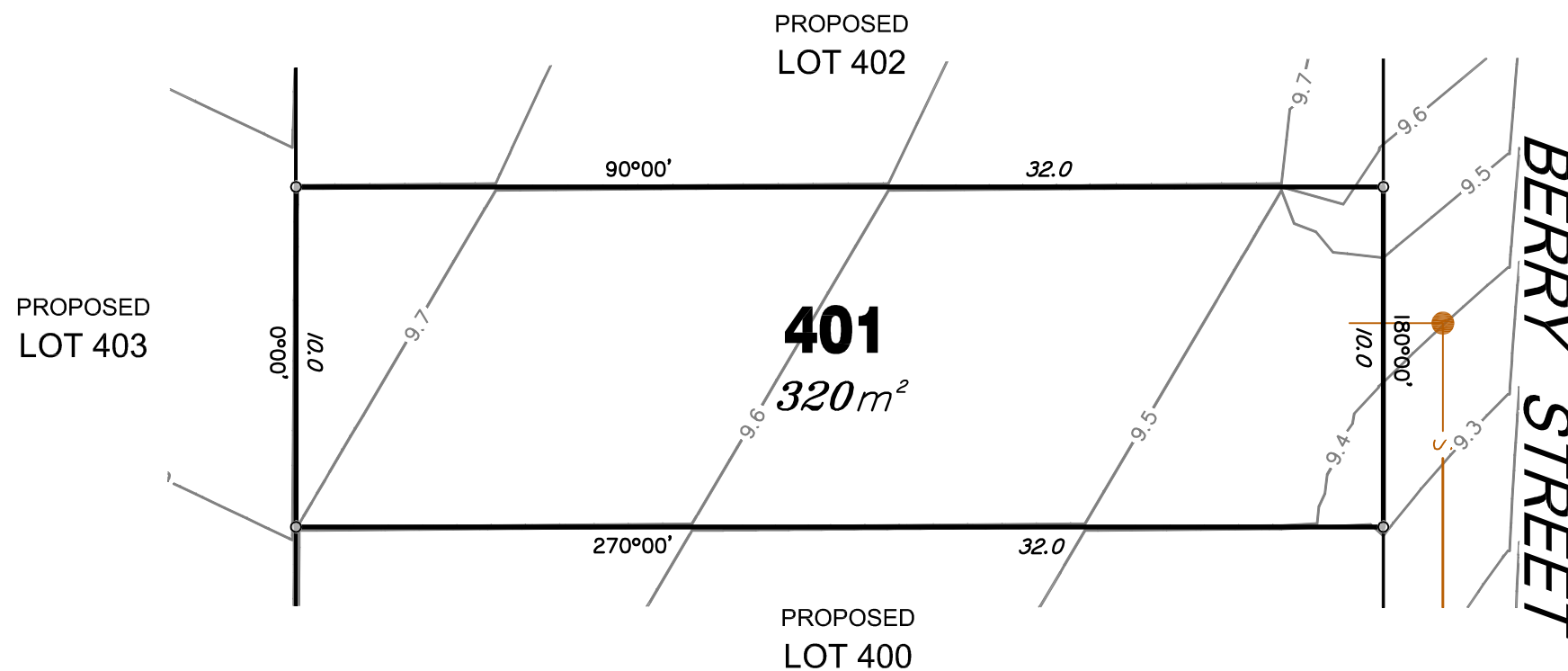

PROPOSED LOT 403

PROPOSED LOT 402

401
320m²

PROPOSED LOT 400

BERRY STREET

RIVERBANK

For
PEET

IMPORTANT NOTES:
(These notes are an integral part of this plan)
This plan has been prepared for **PEET & CO** for the purposes of **A Disclosure Plan Under the Land Sales Act 1984 (as Amended)**.

It is not to be used by any other person or corporation or for any other purposes and is subject to the following limitations:

The Lot dimensions and area shown herein are subject to final field survey and also to the requirements of Council and any other authority which may have requirements under any relevant legislation.

Design surface contours from the design surface data supplied by Brown Consulting Pty Ltd. Where final surface contours are not shown, no change to existing surface level is proposed.

Compaction of any fill material placed on this site shall be completed under inspection and testing services in accordance with AS3798-2007.

Location of sewer and roofwater lines, manholes and pits are those shown on engineering design drawings and may differ from the as-constructed location.

THESE DESIGNS AND DRAWINGS ARE COPYRIGHT AND ARE NOT TO BE USED OR REPRODUCED WITHOUT THE WRITTEN PERMISSION OF THG

Data Sources
Cadastral Boundaries 215809_1_LC1(D).dwg
Design Surface Contours Stage 9 - 12D Design Tin.12da
Engineering Design X_806158_BASE_MASTER_2014_09_08.dwg

| No | Revisions | Date | Chkd |
|----|-------------------------|---------|------|
| B | Revised to suit new Act | 2/12/14 | EJM |
| A | Original | 8/9/14 | EJM |

Parish: CABOOLTURE
County: STANLEY
Locality: CABOOLTURE SOUTH
Local Authority: M.B.R.C
Horizontal Meridian: SP232377
Vertical Level Datum: AHD
Level Origin: PM109474(RL15.112)
Scale: 1:200 @ A3
Surveyed: THG WSG Pty Ltd
Designed: Brown Consulting
Drawn: EJM
Checked: MMR
Plot Date: 03 Dec, 2014
Computer File Ref: 215809_5_DPs(B).dwg

DISCLOSURE PLAN
of Proposed Lot 401
being part of
Lot 2 on SP269617



BRISBANE (07) 3666 4700 MACKAY (07) 4951 2911 PROSERPINE (07) 4945 1722
BOWEN (07) 4786 1050 CAIRNS (07) 4051 6722

Email mail@thg.com.au www.thg.com.au
ABN 551 5621 0052 THG WSG Pty Ltd t/a THG Resource Strategists

Drawing No **30599-DP401** Issue **B**

