

IMPORTANT NOTES:
(These notes are an integral part of this plan)
This plan has been prepared for PEET & CO for the purposes of A Disclosure Plan Under the Land Sales Act 1984 (as Amended).

It is not to be used by any other person or corporation or for any other purposes and is subject to the following limitations:

The Lot dimensions and area shown hereon are subject to final field survey and also to the requirements of Council and any other authority which may have requirements under any relevant legislation.

Design surface contours from the design surface data supplied by Brown Consulting Pty Ltd. Where final surface contours are not shown, no change to existing surface level is proposed.

Compaction of any fill material placed on this site shall be completed under inspection and testing services in accordance with AS3798-2007.

Location of sewer and roofwater lines, manholes and pits are those shown on engineering design drawings and may differ from the as-constructed location.

THESE DESIGNS AND DRAWINGS ARE COPYRIGHT AND ARE NOT TO BE USED OR REPRODUCED WITHOUT THE WRITTEN PERMISSION OF THG

Data Sources
Cadastral Boundaries 215809_1_LC1(D).dwg
Design Surface Contours Stage 9 - 12D Design Tin.12da
Engineering Design X_806158_BASE_MASTER_2014_09_08.dwg

No	Revisions	Date	Chkd
C	Amend Riverbank logo	2/12/14	EJM
B	Revised to suit new Act	27/11/14	GTS
A	Original	8/9/14	EJM

Parish: CABOOLTURE
County: STANLEY
Locality: CABOOLTURE SOUTH
Local Authority: M.B.R.C
Horizontal Meridian: SP232377
Vertical Level Datum: AHD
Level Origin: PM109474(RL15.112)
Scale: 1:200 @ A3
Surveyed: THG WSG Pty Ltd
Designed: Brown Consulting
Drawn: EJM
Checked: MMR
Plot Date: 03 Dec, 2014
Computer File Ref: 215809_5 DPs(B).dwg

DISCLOSURE PLAN
of Proposed Lot 407
being part of
Lot 2 on SP269617



BRISBANE (07) 3666 4700 MACKAY (07) 4951 2911 PROSERPINE (07) 4945 1722
BOWEN (07) 4786 1050 CAIRNS (07) 4051 6722

Email mail@thg.com.au www.thg.com.au
ABN 551 5621 0052 THG WSG Pty Ltd t/a THG Resource Strategists

Drawing No **30599-DP407** Issue **C**

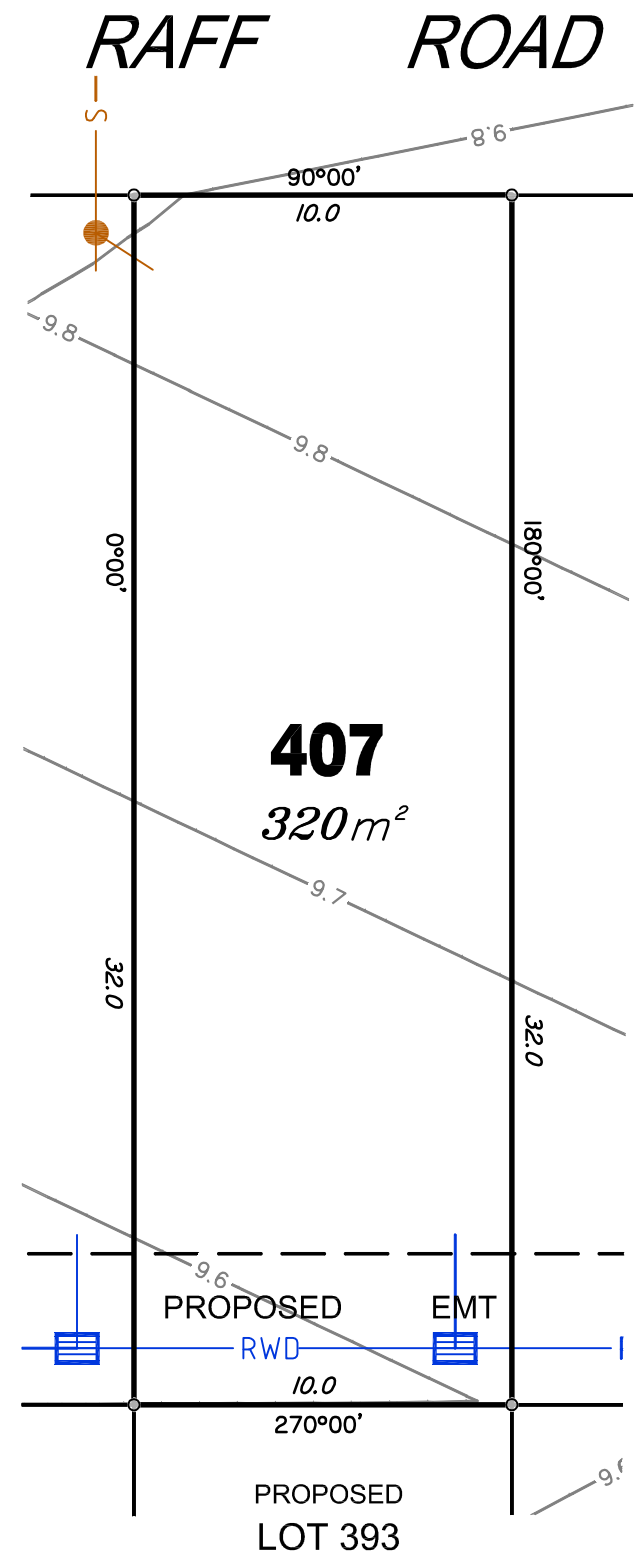

LEGEND

Final surface contours based on A.H.D. datum at an interval of 0.1m, shown as: — 1:0 —

Where applicable, areas filled from existing surface are shown as:-

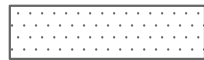

Depth of Fill +0.13

Sewer line shown as: — S —



Sewer Manhole/Maintenance Shaft shown as: ●



Roofwater Drainage line shown as: — RWD —



Roofwater Manhole shown as: ●



Roofwater Pit shown as: ■





IMPORTANT NOTES:
(These notes are an integral part of this plan)
This plan has been prepared for PEET & CO for the purposes of A Disclosure Plan Under the Land Sales Act 1984 (as Amended).

It is not to be used by any other person or corporation or for any other purposes and is subject to the following limitations:

The Lot dimensions and area shown hereon are subject to final field survey and also to the requirements of Council and any other authority which may have requirements under any relevant legislation.

Design surface contours from the design surface data supplied by Brown Consulting Pty Ltd. Where final surface contours are not shown, no change to existing surface level is proposed.

Compaction of any fill material placed on this site shall be completed under inspection and testing services in accordance with AS3798-2007.

Location of sewer and roofwater lines, manholes and pits are those shown on engineering design drawings and may differ from the as-constructed location.

THESE DESIGNS AND DRAWINGS ARE COPYRIGHT AND ARE NOT TO BE USED OR REPRODUCED WITHOUT THE WRITTEN PERMISSION OF THG

Data Sources
Cadastral Boundaries 215809_1_LC1(D).dwg
Design Surface Contours Stage 9 - 12D Design Tin.12da
Engineering Design X_806158_BASE_MASTER_2014_09_08.dwg

No	Revisions	Date	Chkd
C	Amend Riverbank logo	2/12/14	EJM
B	Revised to suit new Act	27/11/14	GTS
A	Original	8/9/14	EJM

Parish: CABOOLTURE
County: STANLEY
Locality: CABOOLTURE SOUTH
Local Authority: M.B.R.C
Horizontal Meridian: SP232377
Vertical Level Datum: AHD
Level Origin: PM109474(RL15.112)
Scale: 1:200 @ A3
Surveyed: THG WSG Pty Ltd
Designed: Brown Consulting
Drawn: EJM
Checked: MMR
Plot Date: 03 Dec, 2014
Computer File Ref: 215809_5 DPs(B).dwg

DISCLOSURE PLAN
of Proposed Lot 409
being part of
Lot 2 on SP269617



BRISBANE (07) 3666 4700 MACKAY (07) 4951 2911 PROSERPINE (07) 4945 1722
BOWEN (07) 4786 1050 CAIRNS (07) 4051 6722

Email mail@thg.com.au www.thg.com.au
ABN 551 5621 0052 THG WSG Pty Ltd t/a THG Resource Strategists

Drawing No **30599-DP409** Issue **C**

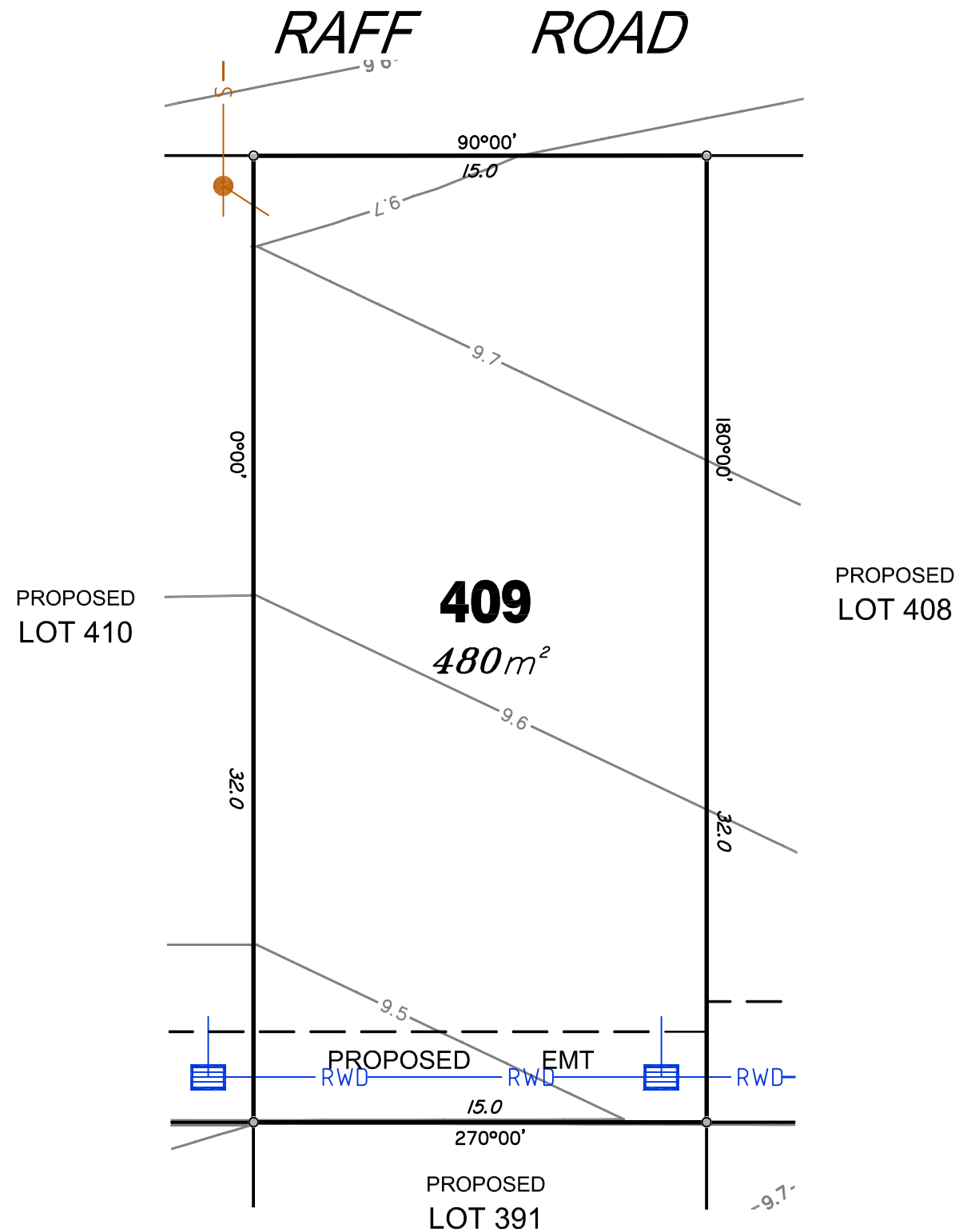

LEGEND

Final surface contours based on A.H.D. datum at an interval of 0.1m, shown as: — 1.0 —

Where applicable, areas filled from existing surface are shown as:-



Depth of Fill +0.13

Sewer line shown as: — S —

Sewer Manhole/Maintenance Shaft shown as:

Roofwater Drainage line shown as: — RWD —

Roofwater Manhole shown as:

Roofwater Pit shown as:





LEGEND

Final surface contours based on A.H.D. datum at an interval of 0.1m, shown as: 1:0

Where applicable, areas filled from existing surface are shown as:-

Depth of Fill $+0.13$

Sewer line shown as:

Sewer Manhole/Maintenance Shaft shown as:

Roofwater Drainage line shown as:

Roofwater Manhole shown as:

Roofwater Pit shown as:

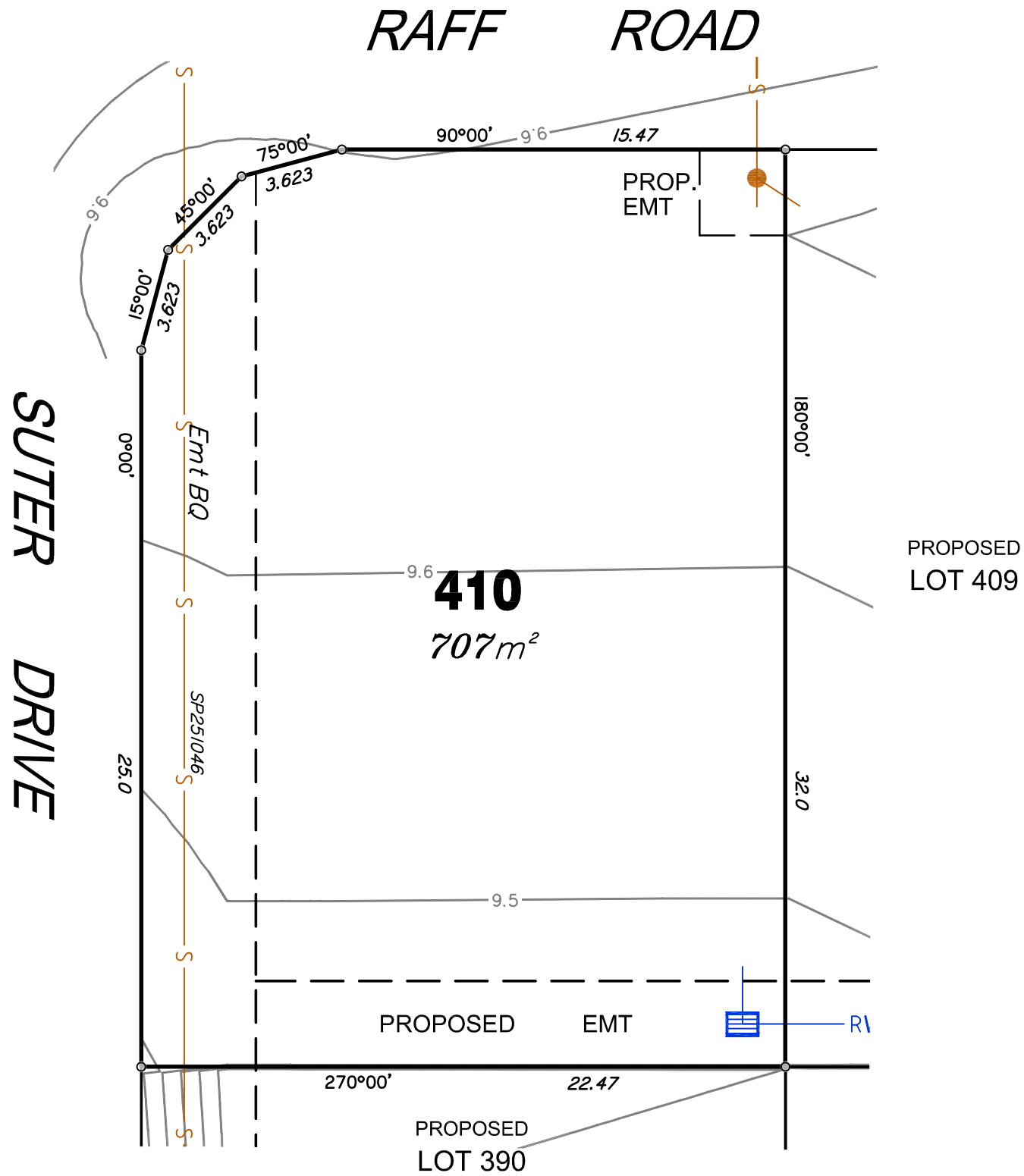

IMPORTANT NOTES:
(These notes are an integral part of this plan)
This plan has been prepared for PEET & CO for the purposes of a Disclosure Plan Under the Land Sales Act 1984 (as Amended).

It is not to be used by any other person or corporation or for any other purposes and is subject to the following limitations:

The Lot dimensions and area shown hereon are subject to final field survey and also to the requirements of Council and any other authority which may have requirements under any relevant legislation.

Design surface contours from the design surface data supplied by Brown Consulting Pty Ltd. Where final surface contours are not shown, no change to existing surface level is proposed.

Compaction of any fill material placed on this site shall be completed under inspection and testing services in accordance with AS3798-2007.

Location of sewer and roofwater lines, manholes and pits are those shown on engineering design drawings and may differ from the as-constructed location.

Copyright © Queensland Surveying Pty Ltd t/a THG Resource Strategists 24/6/2015.

THESE DESIGNS AND DRAWINGS ARE COPYRIGHT AND ARE NOT TO BE USED OR REPRODUCED WITHOUT THE WRITTEN PERMISSION OF THG

Data Sources
Cadastral Boundaries 215809_1_LC1(D).dwg
Design Surface Contours Stage 9 - 12D Design Tin.12da
Engineering Design X_806158_BASE_MASTER_2014_09_08.dwg

No	Revisions	Date	Chkd
D	Add sewer easement	24/6/15	EJM
C	Amend Riverbank logo	2/12/14	EJM
B	Revised to suit new Act	27/11/14	GTS
A	Original	8/9/14	EJM

Parish: CABOOLTURE
County: STANLEY
Locality: CABOOLTURE SOUTH
Local Authority: M.B.R.C
Horizontal Meridian: SP232377
Vertical Level Datum: AHD
Level Origin: PM109474(RL15.112)
Scale: 1:200 @ A3
Designed: Brown Consulting
Drawn: EJM
Checked: MMR
Plot Date: 24 Jun, 2015
Computer File Ref: 215809_5 DPs(D).dwg

DISCLOSURE PLAN
of Proposed Lot 410
being part of
Lot 2 on SP269617



BRISBANE (07) 3666 4700
MACKAY (07) 4951 2911
PROSERPINE (07) 4945 1722
BOWEN (07) 4786 1050
CAIRNS (07) 4051 6722

Email mail@thg.com.au www.thg.com.au
ABN 25 604 671 374
Queensland Surveying Pty Ltd t/a THG Resource Strategists

Drawing No 30599-DP410 Issue D



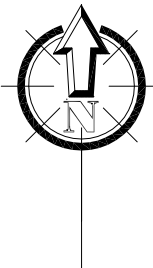

LEGEND

Final surface contours based on A.H.D. datum at an interval of 0.1m, shown as: — 1-0 —

Where applicable, areas filled from existing surface are shown as:-

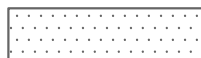

Depth of Fill +0.13

Sewer line shown as: — S —

Sewer Manhole/Maintenance Shaft shown as: ●

Roofwater Drainage line shown as: — RWD —

Roofwater Manhole shown as: ●

Roofwater Pit shown as: ■

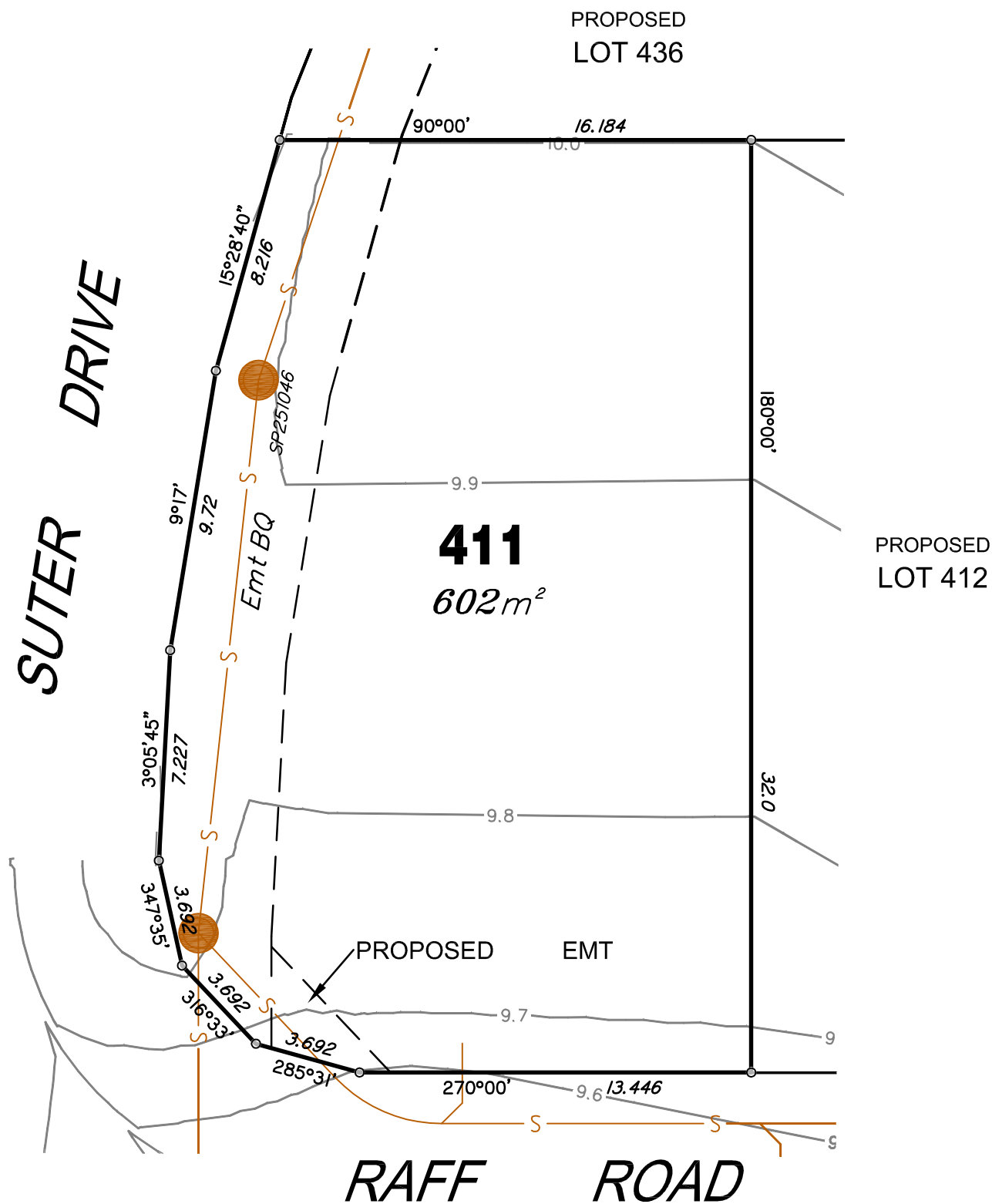

RIVERBANK

For
PEET

IMPORTANT NOTES:
(These notes are an integral part of this plan)
This plan has been prepared for PEET & CO for the purposes of A Disclosure Plan Under the Land Sales Act 1984 (as Amended).

It is not to be used by any other person or corporation or for any other purposes and is subject to the following limitations:

The Lot dimensions and area shown herein are subject to final field survey and also to the requirements of Council and any other authority which may have requirements under any relevant legislation.

Design surface contours from the design surface data supplied by Brown Consulting Pty Ltd. Where final surface contours are not shown, no change to existing surface level is proposed.

Compaction of any fill material placed on this site shall be completed under inspection and testing services in accordance with AS3798-2007.

Location of sewer and roofwater lines, manholes and pits are those shown on engineering design drawings and may differ from the as-constructed location.

THESE DESIGNS AND DRAWINGS ARE COPYRIGHT AND ARE NOT TO BE USED OR REPRODUCED WITHOUT THE WRITTEN PERMISSION OF THG

Data Sources
Cadastral Boundaries 215809_1_LC1(D).dwg
Design Surface Contours Stage 9 - 12D Design Tin.12da
Engineering Design X_806158_BASE_MASTER_2014_09_08.dwg

No	Revisions	Date	Chkd
C	Amend Riverbank logo	2/12/14	EJM
B	Revised to suit new Act	27/11/14	GTS
A	Original	8/9/14	EJM

Parish: CABOOLTURE
County: STANLEY
Locality: CABOOLTURE SOUTH
Local Authority: M.B.R.C
Horizontal Meridian: SP232377
Vertical Level Datum: AHD
Level Origin: PM109474(RL15.112)
Scale: 1:200 @ A3
Surveyed: THG WSG Pty Ltd
Designed: Brown Consulting
Drawn: EJM
Checked: MMR
Plot Date: 03 Dec, 2014
Computer File Ref: 215809_5 DPs(B).dwg

DISCLOSURE PLAN
of Proposed Lot 411
being part of
Lot 2 on SP269617



BRISBANE (07) 3666 4700
MACKAY (07) 4951 2911
PROSERPINE (07) 4945 1722
BOWEN (07) 4786 1050
CAIRNS (07) 4051 6722

Email mail@thg.com.au www.thg.com.au
ABN 55156210052 THG WSG Pty Ltd t/a THG Resource Strategists

Drawing No 30599-DP411 Issue C

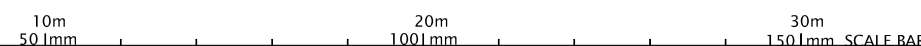

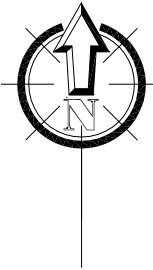

LEGEND

Final surface contours based on A.H.D. datum at an interval of 0.1m, shown as: — 1:0 —

Where applicable, areas filled from existing surface are shown as:-

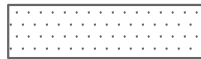

Depth of Fill +0.13

Sewer line shown as: — S —

Sewer Manhole/Maintenance Shaft shown as: ●

Roofwater Drainage line shown as: — RWD —

Roofwater Manhole shown as: ●

Roofwater Pit shown as: ■

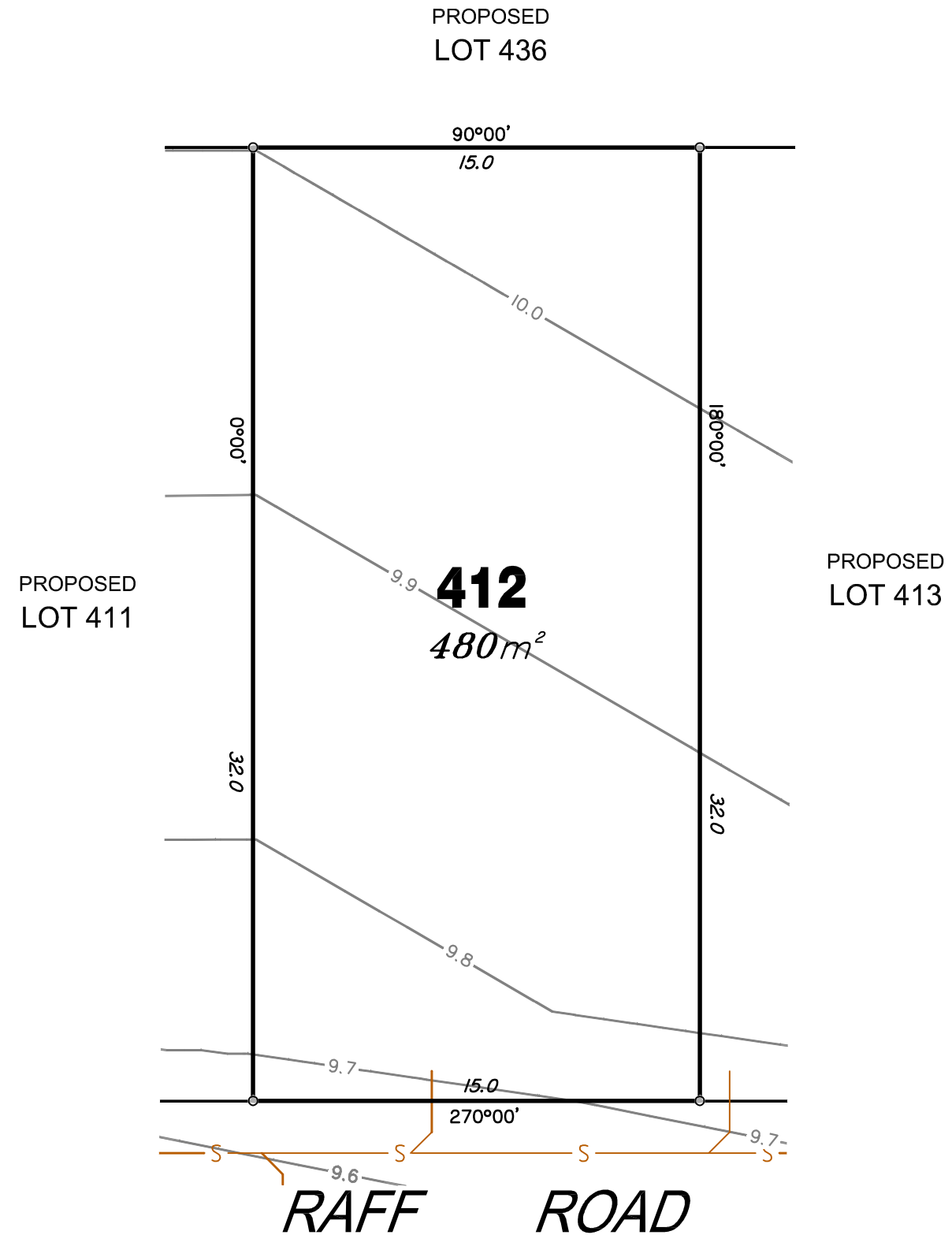

RIVERBANK

For
PEET

IMPORTANT NOTES:
(These notes are an integral part of this plan)
This plan has been prepared for PEET & CO for the purposes of a Disclosure Plan Under the Land Sales Act 1984 (as Amended).

It is not to be used by any other person or corporation or for any other purposes and is subject to the following limitations:

The Lot dimensions and area shown hereon are subject to final field survey and also to the requirements of Council and any other authority which may have requirements under any relevant legislation.

Design surface contours from the design surface data supplied by Brown Consulting Pty Ltd. Where final surface contours are not shown, no change to existing surface level is proposed.

Compaction of any fill material placed on this site shall be completed under inspection and testing services in accordance with AS3798-2007.

Location of sewer and roofwater lines, manholes and pits are those shown on engineering design drawings and may differ from the as-constructed location.

THESE DESIGNS AND DRAWINGS ARE COPYRIGHT AND ARE NOT TO BE USED OR REPRODUCED WITHOUT THE WRITTEN PERMISSION OF THG

Data Sources
Cadastral Boundaries 215809_1_LC1(D).dwg
Design Surface Contours Stage 9 - 12D Design Tin.12da
Engineering Design X_806158_BASE_MASTER_2014_09_08.dwg

No	Revisions	Date	Chkd
C	Amend Riverbank logo	2/12/14	EJM
B	Revised to suit new Act	27/11/14	GTS
A	Original	8/9/14	EJM

Parish: CABOOLTURE
County: STANLEY
Locality: CABOOLTURE SOUTH
Local Authority: M.B.R.C
Horizontal Meridian: SP232377
Vertical Level Datum: AHD
Level Origin: PM109474(RL15.112)
Scale: 1:200 @ A3
Surveyed: THG WSG Pty Ltd
Designed: Brown Consulting
Drawn: EJM
Checked: MMR
Plot Date: 03 Dec, 2014
Computer File Ref: 215809_5 DPs(B).dwg

DISCLOSURE PLAN
of Proposed Lot 412
being part of
Lot 2 on SP269617



BRISBANE (07) 3666 4700
MACKAY (07) 4951 2911
PROSERPINE (07) 4945 1722
BOWEN (07) 4786 1050
CAIRNS (07) 4051 6722

Email mail@thg.com.au www.thg.com.au
ABN 55156210052 THG WSG Pty Ltd t/a THG Resource Strategists

Drawing No 30599-DP412 Issue C



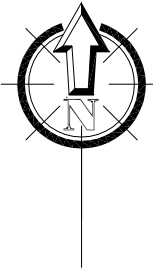

LEGEND

Final surface contours based on A.H.D. datum at an interval of 0.1m, shown as: 1.0

Where applicable, areas filled from existing surface are shown as:-

Depth of Fill +0.13

Sewer line shown as:

Sewer Manhole/Maintenance Shaft shown as:

Roofwater Drainage line shown as:

Roofwater Manhole shown as:

Roofwater Pit shown as:

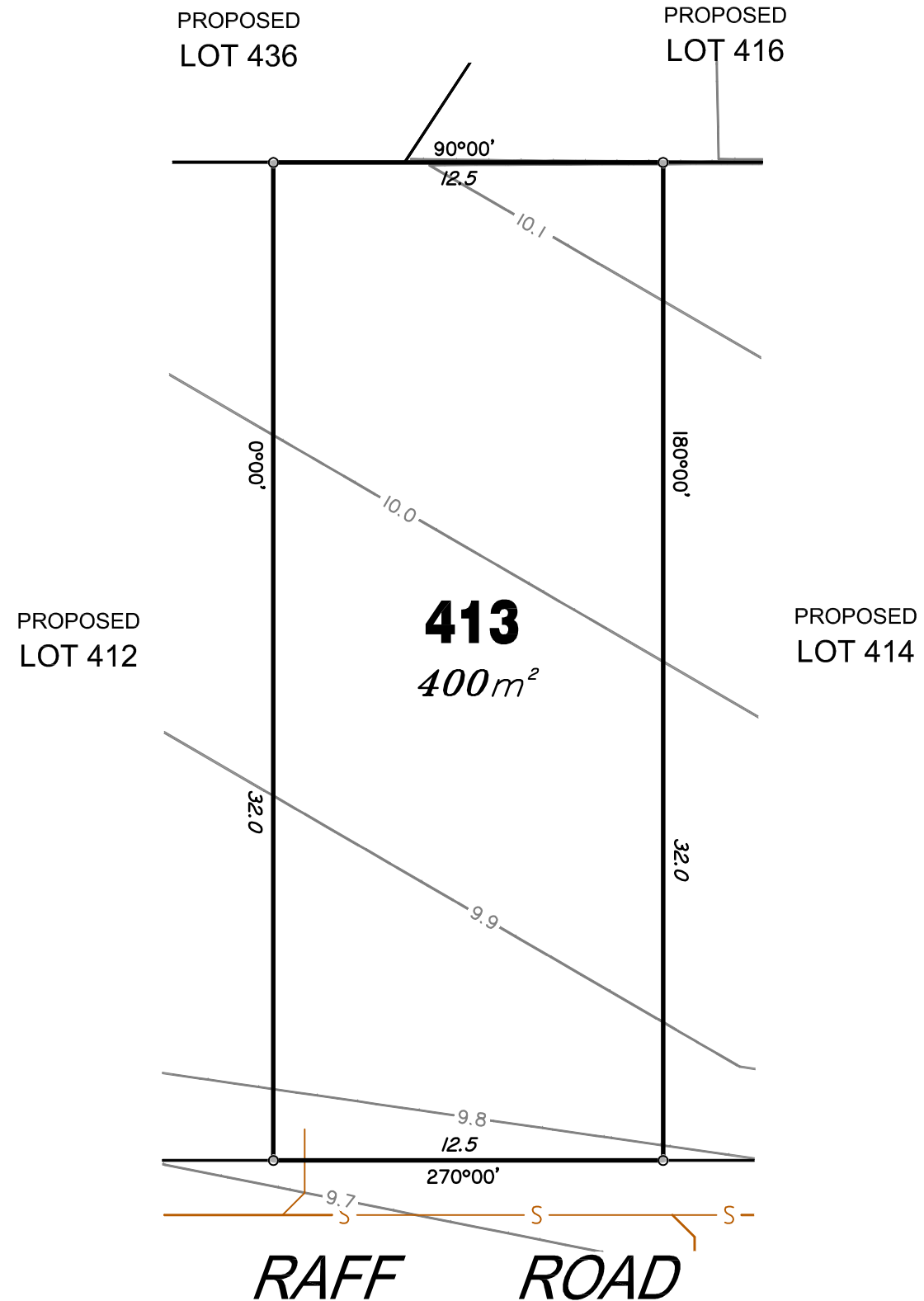

RIVERBANK

For
PEET

IMPORTANT NOTES:
(These notes are an integral part of this plan)
This plan has been prepared for PEET & CO for the purposes of A Disclosure Plan Under the Land Sales Act 1984 (as Amended).

It is not to be used by any other person or corporation or for any other purposes and is subject to the following limitations:

The Lot dimensions and area shown hereon are subject to final field survey and also to the requirements of Council and any other authority which may have requirements under any relevant legislation.

Design surface contours from the design surface data supplied by Brown Consulting Pty Ltd. Where final surface contours are not shown, no change to existing surface level is proposed.

Compaction of any fill material placed on this site shall be completed under inspection and testing services in accordance with AS3798-2007.

Location of sewer and roofwater lines, manholes and pits are those shown on engineering design drawings and may differ from the as-constructed location.

THESE DESIGNS AND DRAWINGS ARE COPYRIGHT AND ARE NOT TO BE USED OR REPRODUCED WITHOUT THE WRITTEN PERMISSION OF THG

Data Sources
Cadastral Boundaries 215809_1_LC1(D).dwg
Design Surface Contours Stage 9 - 12D Design Tin.12da
Engineering Design X_806158_BASE_MASTER_2014_09_08.dwg

No	Revisions	Date	Chkd
C	Amend Riverbank logo	2/12/14	EJM
B	Revised to suit new Act	27/11/14	GTS
A	Original	8/9/14	EJM

Parish: CABOOLTURE
County: STANLEY
Locality: CABOOLTURE SOUTH
Local Authority: M.B.R.C
Horizontal Meridian: SP232377
Vertical Level Datum: AHD
Level Origin: PM109474(RL15.112)
Scale: 1:200 @ A3
Surveyed: THG WSG Pty Ltd
Designed: Brown Consulting
Drawn: EJM
Checked: MMR
Plot Date: 03 Dec, 2014
Computer File Ref: 215809_5 DPs(B).dwg

DISCLOSURE PLAN
of Proposed Lot 413
being part of
Lot 2 on SP269617



BRISBANE (07) 3666 4700 MACKAY (07) 4951 2911 PROSERPINE (07) 4945 1722
BOWEN (07) 4786 1050 CAIRNS (07) 4051 6722

Email mail@thg.com.au www.thg.com.au
ABN 55156210052 THG WSG Pty Ltd t/a THG Resource Strategists

Drawing No 30599-DP413 Issue C



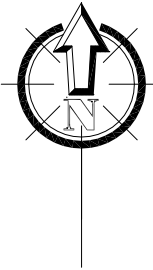

LEGEND

Final surface contours based on A.H.D. datum at an interval of 0.1m, shown as: 1:0

Where applicable, areas filled from existing surface are shown as:-

Depth of Fill +0.13

Sewer line shown as:

Sewer Manhole/Maintenance Shaft shown as:

Roofwater Drainage line shown as:

Roofwater Manhole shown as:

Roofwater Pit shown as:

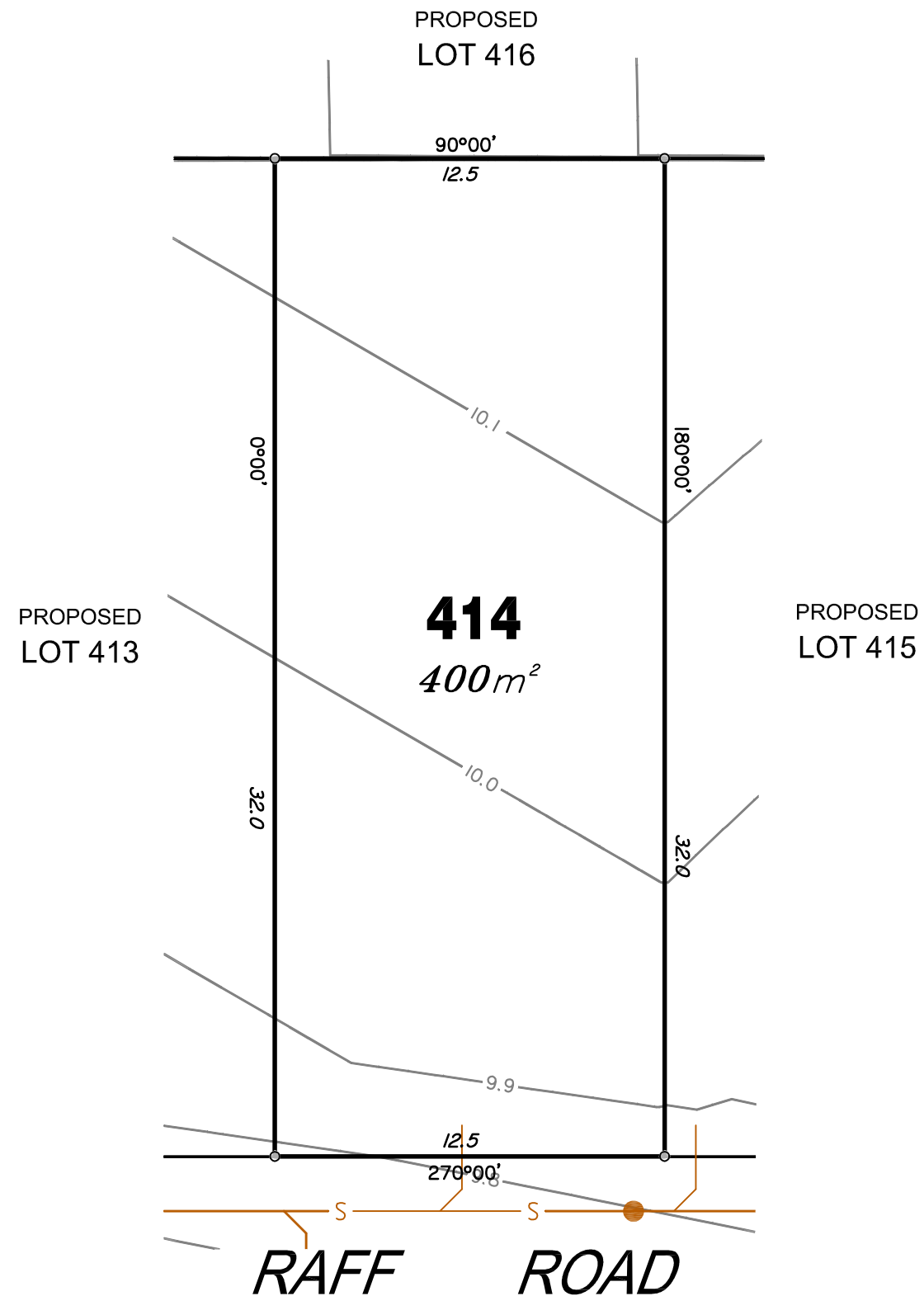

RIVERBANK

For
PEET

IMPORTANT NOTES:
(These notes are an integral part of this plan)
This plan has been prepared for PEET & CO for the purposes of A Disclosure Plan Under the Land Sales Act 1984 (as Amended).

It is not to be used by any other person or corporation or for any other purposes and is subject to the following limitations:

The Lot dimensions and area shown hereon are subject to final field survey and also to the requirements of Council and any other authority which may have requirements under any relevant legislation.

Design surface contours from the design surface data supplied by Brown Consulting Pty Ltd. Where final surface contours are not shown, no change to existing surface level is proposed.

Compaction of any fill material placed on this site shall be completed under inspection and testing services in accordance with AS3798-2007.

Location of sewer and roofwater lines, manholes and pits are those shown on engineering design drawings and may differ from the as-constructed location.

THESE DESIGNS AND DRAWINGS ARE COPYRIGHT AND ARE NOT TO BE USED OR REPRODUCED WITHOUT THE WRITTEN PERMISSION OF THG

Data Sources
Cadastral Boundaries 215809_1_LC1(D).dwg
Design Surface Contours Stage 9 - 12D Design Tin.12da
Engineering Design X_806158_BASE_MASTER_2014_09_08.dwg

No	Revisions	Date	Chkd
C	Amend Riverbank logo	2/12/14	EJM
B	Revised to suit new Act	27/11/14	GTS
A	Original	8/9/14	EJM

Parish: CABOOLTURE
County: STANLEY
Locality: CABOOLTURE SOUTH
Local Authority: M.B.R.C
Horizontal Meridian: SP232377
Vertical Level Datum: AHD
Level Origin: PM109474(RL15.112)
Scale: 1:200 @ A3
Surveyed: THG WSG Pty Ltd
Designed: Brown Consulting
Drawn: EJM
Checked: MMR
Plot Date: 03 Dec, 2014
Computer File Ref: 215809_5 DPs(B).dwg

DISCLOSURE PLAN
of Proposed Lot 414
being part of
Lot 2 on SP269617



BRISBANE (07) 3666 4700
MACKAY (07) 4951 2911
PROSERPINE (07) 4945 1722
BOWEN (07) 4786 1050
CAIRNS (07) 4051 6722

Email mail@thg.com.au www.thg.com.au
ABN 55156210052 THG WSG Pty Ltd t/a THG Resource Strategists

Drawing No 30599-DP414 Issue C



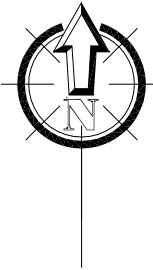

LEGEND

Final surface contours based on A.H.D. datum at an interval of 0.1m, shown as: — 1.0 —

Where applicable, areas filled from existing surface are shown as:-

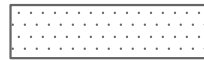

Depth of Fill +0.13

Sewer line shown as: — S —

Sewer Manhole/Maintenance Shaft shown as: ●

Roofwater Drainage line shown as: — RWD —

Roofwater Manhole shown as: ●

Roofwater Pit shown as: ■

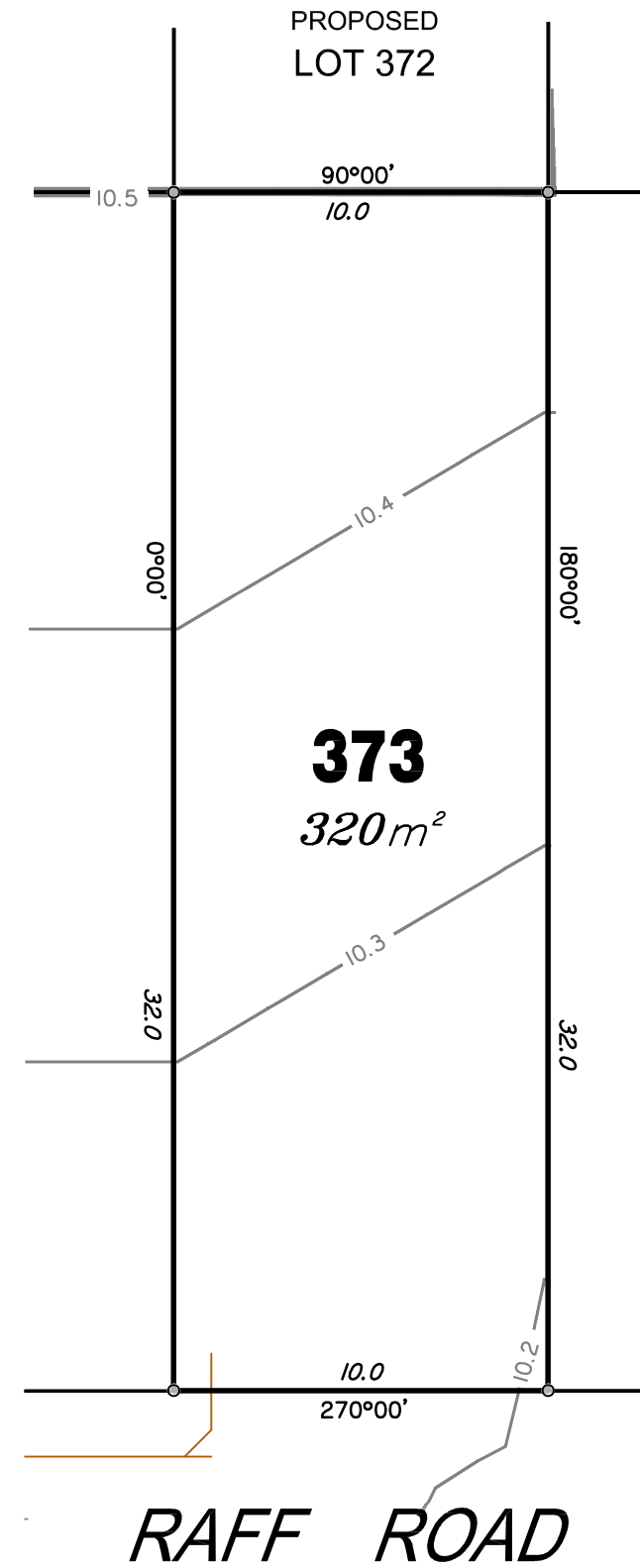

RIVERBANK

For
PEET

IMPORTANT NOTES:
(These notes are an integral part of this plan)
This plan has been prepared for PEET & CO for the purposes of A Disclosure Plan Under the Land Sales Act 1984 (as Amended).

It is not to be used by any other person or corporation or for any other purposes and is subject to the following limitations:

The Lot dimensions and area shown herein are subject to final field survey and also to the requirements of Council and any other authority which may have requirements under any relevant legislation.

Design surface contours from the design surface data supplied by Brown Consulting Pty Ltd. Where final surface contours are not shown, no change to existing surface level is proposed.

Compaction of any fill material placed on this site shall be completed under inspection and testing services in accordance with AS3798-2007.

Location of sewer and roofwater lines, manholes and pits are those shown on engineering design drawings and may differ from the as-constructed location.

THESE DESIGNS AND DRAWINGS ARE COPYRIGHT AND ARE NOT TO BE USED OR REPRODUCED WITHOUT THE WRITTEN PERMISSION OF THG

Data Sources
Cadastral Boundaries 215809_1_LC1(D).dwg
Design Surface Contours Stage 9 - 12D Design Tin.12da
Engineering Design X_806158_BASE_MASTER_2014_09_08.dwg

No	Revisions	Date	Chkd
C	Amend Riverbank logo	2/12/14	EJM
B	Revised to suit new Act	27/11/14	GTS
A	Original	8/9/14	EJM

Parish: CABOOLTURE
County: STANLEY
Locality: CABOOLTURE SOUTH
Local Authority: M.B.R.C
Horizontal Meridian: SP232377
Vertical Level Datum: AHD
Level Origin: PM109474(RL15.112)
Scale: 1:200 @ A3
Surveyed: THG WSG Pty Ltd
Designed: Brown Consulting
Drawn: EJM
Checked: MMR
Plot Date: 03 Dec, 2014
Computer File Ref: 215809_5 DPs(B).dwg

DISCLOSURE PLAN
of Proposed Lot 373
being part of
Lot 2 on SP269617



BRISBANE (07) 3666 4700
MACKAY (07) 4951 2911
PROSERPINE (07) 4945 1722
BOWEN (07) 4786 1050
CAIRNS (07) 4051 6722

Email mail@thg.com.au www.thg.com.au
ABN 55156210052 THG WSG Pty Ltd t/a THG Resource Strategists

Drawing No 30599-DP373 Issue C

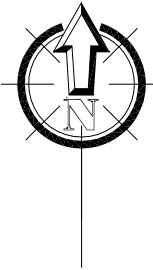

LEGEND

Final surface contours based on A.H.D. datum at an interval of 0.1m, shown as: — 1.0 —

Where applicable, areas filled from existing surface are shown as:-

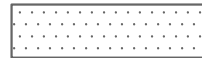

Depth of Fill +0.13

Sewer line shown as: — S —

Sewer Manhole/Maintenance Shaft shown as:

Roofwater Drainage line shown as: — RWD —

Roofwater Manhole shown as:

Roofwater Pit shown as:

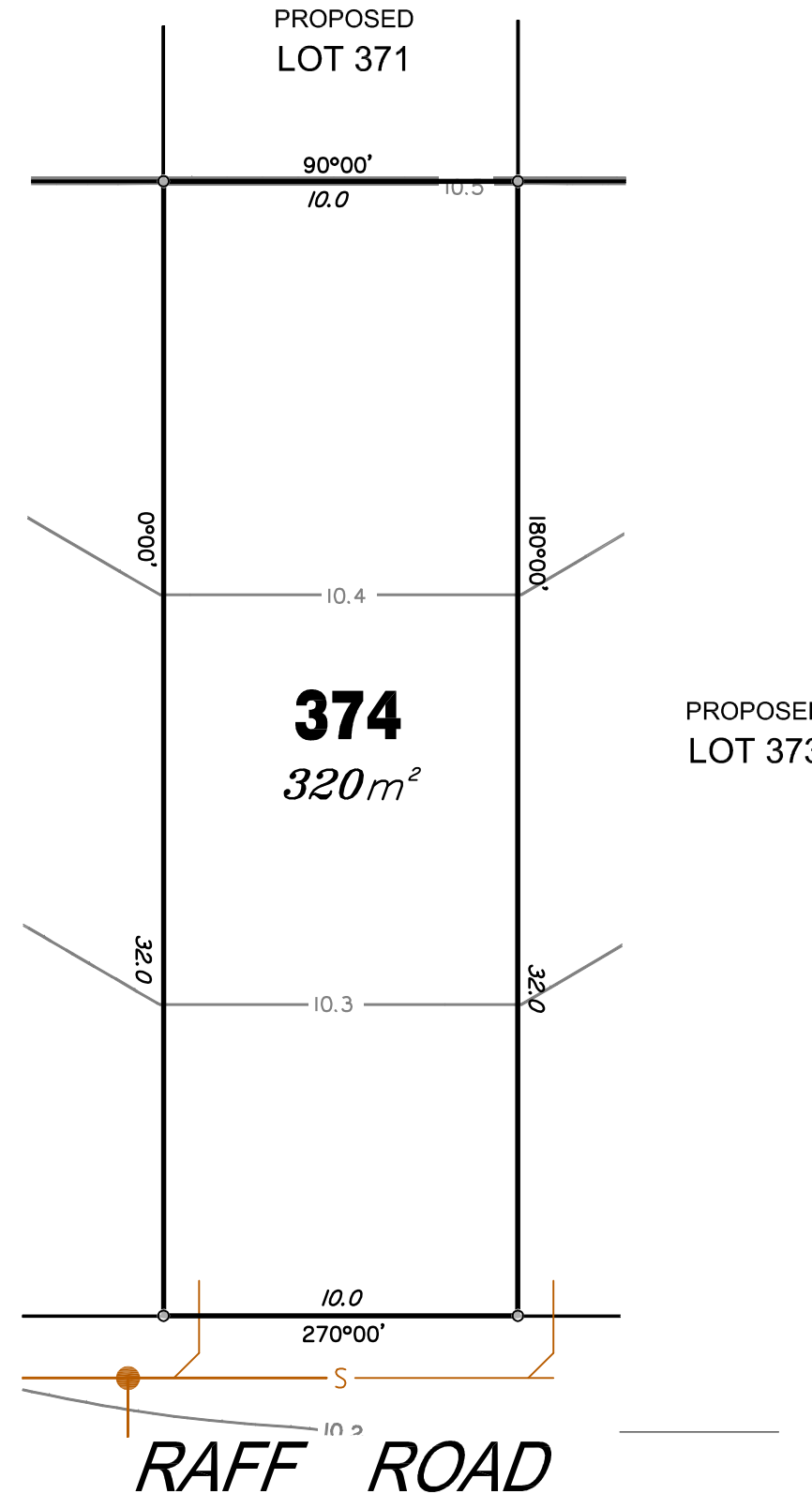

RIVERBANK

For
PEET

IMPORTANT NOTES:
(These notes are an integral part of this plan)
This plan has been prepared for PEET & CO for the purposes of **A Disclosure Plan Under the Land Sales Act 1984 (as Amended)**.

It is not to be used by any other person or corporation or for any other purposes and is subject to the following limitations:

The Lot dimensions and area shown herein are subject to final field survey and also to the requirements of Council and any other authority which may have requirements under any relevant legislation.

Design surface contours from the design surface data supplied by Brown Consulting Pty Ltd. Where final surface contours are not shown, no change to existing surface level is proposed.

Compaction of any fill material placed on this site shall be completed under inspection and testing services in accordance with AS3798-2007.

Location of sewer and roofwater lines, manholes and pits are those shown on engineering design drawings and may differ from the as-constructed location.

THESE DESIGNS AND DRAWINGS ARE COPYRIGHT AND ARE NOT TO BE USED OR REPRODUCED WITHOUT THE WRITTEN PERMISSION OF THG

Data Sources
Cadastral Boundaries 215809_1_LC1(D).dwg
Design Surface Contours Stage 9 - 12D Design Tin.12da
Engineering Design X_806158_BASE_MASTER_2014_09_08.dwg

No	Revisions	Date	Chkd
C	Amend Riverbank logo	2/12/14	EJM
B	Revised to suit new Act	27/11/14	GTS
A	Original	8/9/14	EJM

Parish: CABOOLTURE
County: STANLEY
Locality: CABOOLTURE SOUTH
Local Authority: M.B.R.C
Horizontal Meridian: SP232377
Vertical Level Datum: AHD
Level Origin: PM109474(RL15.112)
Scale: 1:200 @ A3
Surveyed: THG WSG Pty Ltd
Designed: Brown Consulting
Drawn: EJM
Checked: MMR
Plot Date: 03 Dec, 2014
Computer File Ref: 215809_5 DPs(B).dwg

DISCLOSURE PLAN
of Proposed Lot 374
being part of
Lot 2 on SP269617



BRISBANE (07) 3666 4700
MACKAY (07) 4951 2911
PROSERPINE (07) 4945 1722
BOWEN (07) 4786 1050
CAIRNS (07) 4051 6722

Email mail@thg.com.au www.thg.com.au
ABN 551 5621 0052 THG WSG Pty Ltd t/a THG Resource Strategists

Drawing No **30599-DP374** Issue **C**

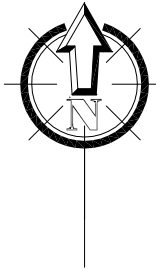

LEGEND

Final surface contours based on A.H.D. datum at an interval of 0.1m, shown as: — 1.0 —

Where applicable, areas filled from existing surface are shown as:-

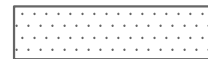

Depth of Fill +0.13

Sewer line shown as: — S —

Sewer Manhole/Maintenance Shaft shown as: ●

Roofwater Drainage line shown as: — RWD —

Roofwater Manhole shown as: ●

Roofwater Pit shown as: ■

PROPOSED
LOT 376

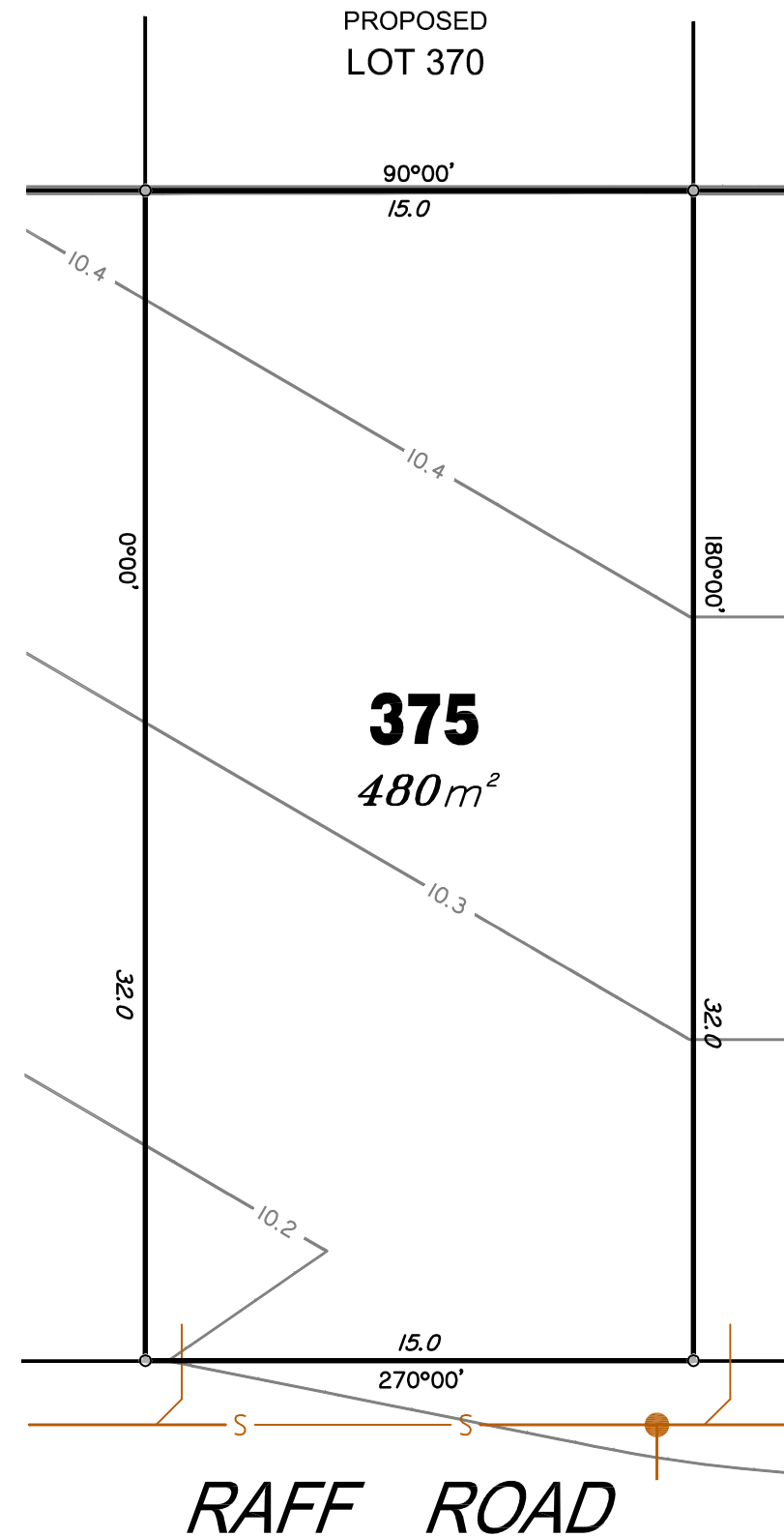

PROPOSED
LOT 374

RIVERBANK

For
PEET

IMPORTANT NOTES:
(These notes are an integral part of this plan)
This plan has been prepared for PEET & CO for the purposes of A Disclosure Plan Under the Land Sales Act 1984 (as Amended).

It is not to be used by any other person or corporation or for any other purposes and is subject to the following limitations:

The Lot dimensions and area shown herein are subject to final field survey and also to the requirements of Council and any other authority which may have requirements under any relevant legislation.

Design surface contours from the design surface data supplied by Brown Consulting Pty Ltd. Where final surface contours are not shown, no change to existing surface level is proposed.

Compaction of any fill material placed on this site shall be completed under inspection and testing services in accordance with AS3798-2007.

Location of sewer and roofwater lines, manholes and pits are those shown on engineering design drawings and may differ from the as-constructed location.

THESE DESIGNS AND DRAWINGS ARE COPYRIGHT AND ARE NOT TO BE USED OR REPRODUCED WITHOUT THE WRITTEN PERMISSION OF THG

Data Sources
Cadastral Boundaries 215809_1_LC1(D).dwg
Design Surface Contours Stage 9 - 12D Design Tin.12da
Engineering Design X_806158_BASE_MASTER_2014_09_08.dwg

No	Revisions	Date	Chkd
C	Amend Riverbank logo	2/12/14	EJM
B	Revised to suit new Act	27/11/14	GTS
A	Original	8/9/14	EJM

Parish: CABOOLTURE
County: STANLEY
Locality: CABOOLTURE SOUTH
Local Authority: M.B.R.C
Horizontal Meridian: SP232377
Vertical Level Datum: AHD
Level Origin: PM109474(RL15.112)
Scale: 1:200 @ A3
Surveyed: THG WSG Pty Ltd
Designed: Brown Consulting
Drawn: EJM
Checked: MMR
Plot Date: 03 Dec, 2014
Computer File Ref: 215809_5 DPs(B).dwg

DISCLOSURE PLAN
of Proposed Lot 375
being part of
Lot 2 on SP269617



BRISBANE (07) 3666 4700
MACKAY (07) 4951 2911
PROSERPINE (07) 4945 1722
BOWEN (07) 4786 1050
CAIRNS (07) 4051 6722

Email mail@thg.com.au www.thg.com.au
ABN 55156210052 THG WSG Pty Ltd t/a THG Resource Strategists

Drawing No 30599-DP375 Issue C



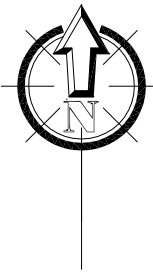

LEGEND

Final surface contours based on A.H.D. datum at an interval of 0.1m, shown as: — 1-0 —

Where applicable, areas filled from existing surface are shown as:-

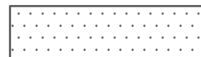

Depth of Fill +0.13

Sewer line shown as: — S —

Sewer Manhole/Maintenance Shaft shown as:

Roofwater Drainage line shown as: — RWD —

Roofwater Manhole shown as:

Roofwater Pit shown as:

PROPOSED LOT 377

PROPOSED LOT 369

PROPOSED LOT 375

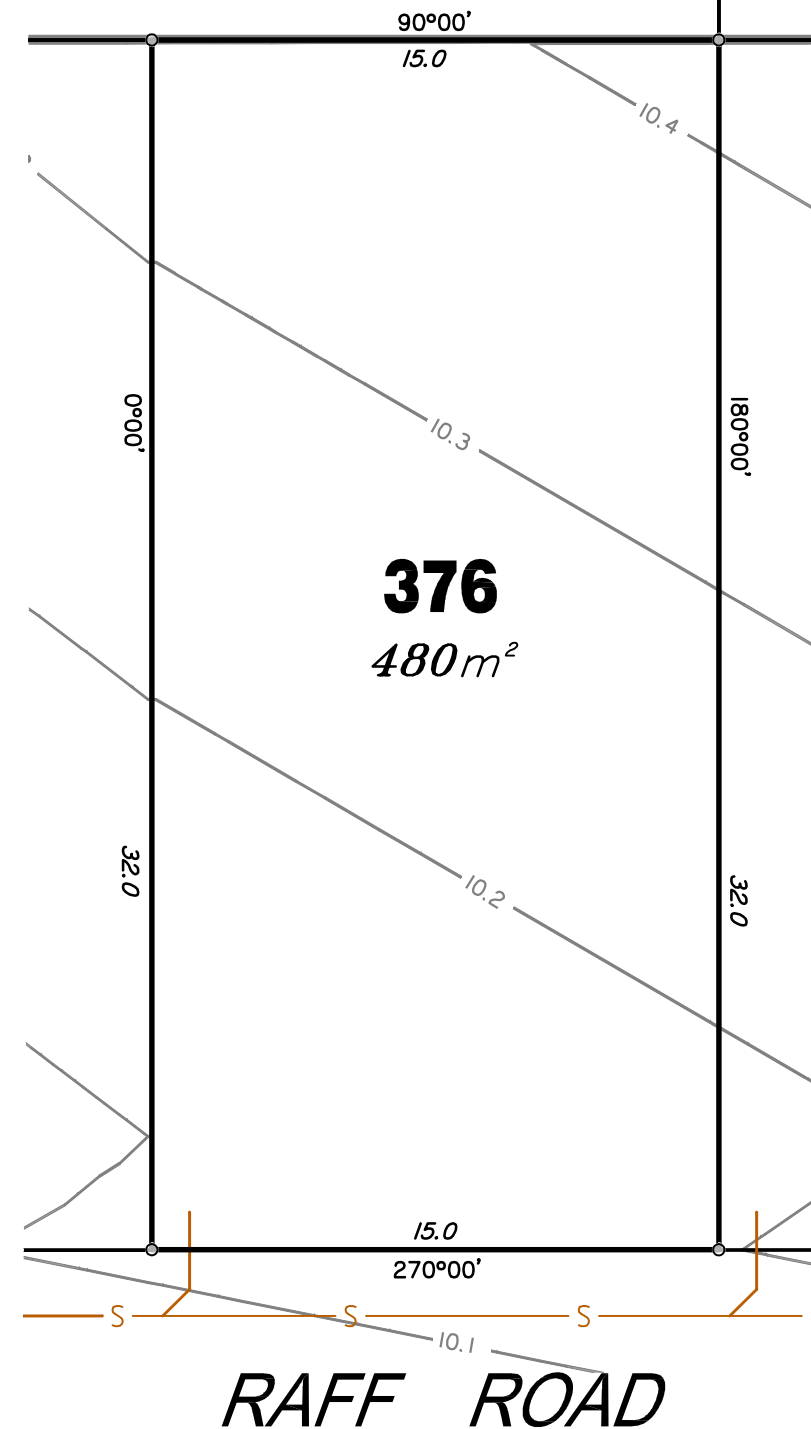

RIVERBANK

For
PEET

IMPORTANT NOTES:
(These notes are an integral part of this plan)
This plan has been prepared for PEET & CO for the purposes of A Disclosure Plan Under the Land Sales Act 1984 (as Amended).

It is not to be used by any other person or corporation or for any other purposes and is subject to the following limitations:

The Lot dimensions and area shown herein are subject to final field survey and also to the requirements of Council and any other authority which may have requirements under any relevant legislation.

Design surface contours from the design surface data supplied by Brown Consulting Pty Ltd. Where final surface contours are not shown, no change to existing surface level is proposed.

Compaction of any fill material placed on this site shall be completed under inspection and testing services in accordance with AS3798-2007.

Location of sewer and roofwater lines, manholes and pits are those shown on engineering design drawings and may differ from the as-constructed location.

THESE DESIGNS AND DRAWINGS ARE COPYRIGHT AND ARE NOT TO BE USED OR REPRODUCED WITHOUT THE WRITTEN PERMISSION OF THG

Data Sources
Cadastral Boundaries 215809_1_LC1(D).dwg
Design Surface Contours Stage 9 - 12D Design Tin.12da
Engineering Design X_806158_BASE_MASTER_2014_09_08.dwg

No	Revisions	Date	Chkd
C	Amend Riverbank logo	2/12/14	EJM
B	Revised to suit new Act	27/11/14	GTS
A	Original	8/9/14	EJM

Parish: CABOOLTURE
County: STANLEY
Locality: CABOOLTURE SOUTH
Local Authority: M.B.R.C
Horizontal Meridian: SP232377
Vertical Level Datum: AHD
Level Origin: PM109474(RL15.112)
Scale: 1:200 @ A3
Surveyed: THG WSG Pty Ltd
Designed: Brown Consulting
Drawn: EJM
Checked: MMR
Plot Date: 03 Dec, 2014
Computer File Ref: 215809_5 DPs(B).dwg

DISCLOSURE PLAN
of Proposed Lot 376
being part of
Lot 2 on SP269617



BRISBANE (07) 3666 4700 MACKAY (07) 4951 2911 PROSERPINE (07) 4945 1722
BOWEN (07) 4786 1050 CAIRNS (07) 4051 6722

Email mail@thg.com.au www.thg.com.au
ABN 55156210052 THG WSG Pty Ltd t/a THG Resource Strategists

Drawing No 30599-DP376 Issue C



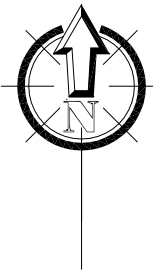

Retaining Wall Lot 377
 Min Height:- 0.00m
 Max Height:- 0.70m
 Average Height:- 0.35m

LEGEND

Final surface contours based on A.H.D. datum at an interval of 0.1m, shown as: — 1-0 —

Where applicable, areas filled from existing surface are shown as:-



Depth of Fill +0.13

Sewer line shown as: — S —

Sewer Manhole/Maintenance Shaft shown as:

Roofwater Drainage line shown as: — RWD —

Roofwater Manhole shown as:

Roofwater Pit shown as:

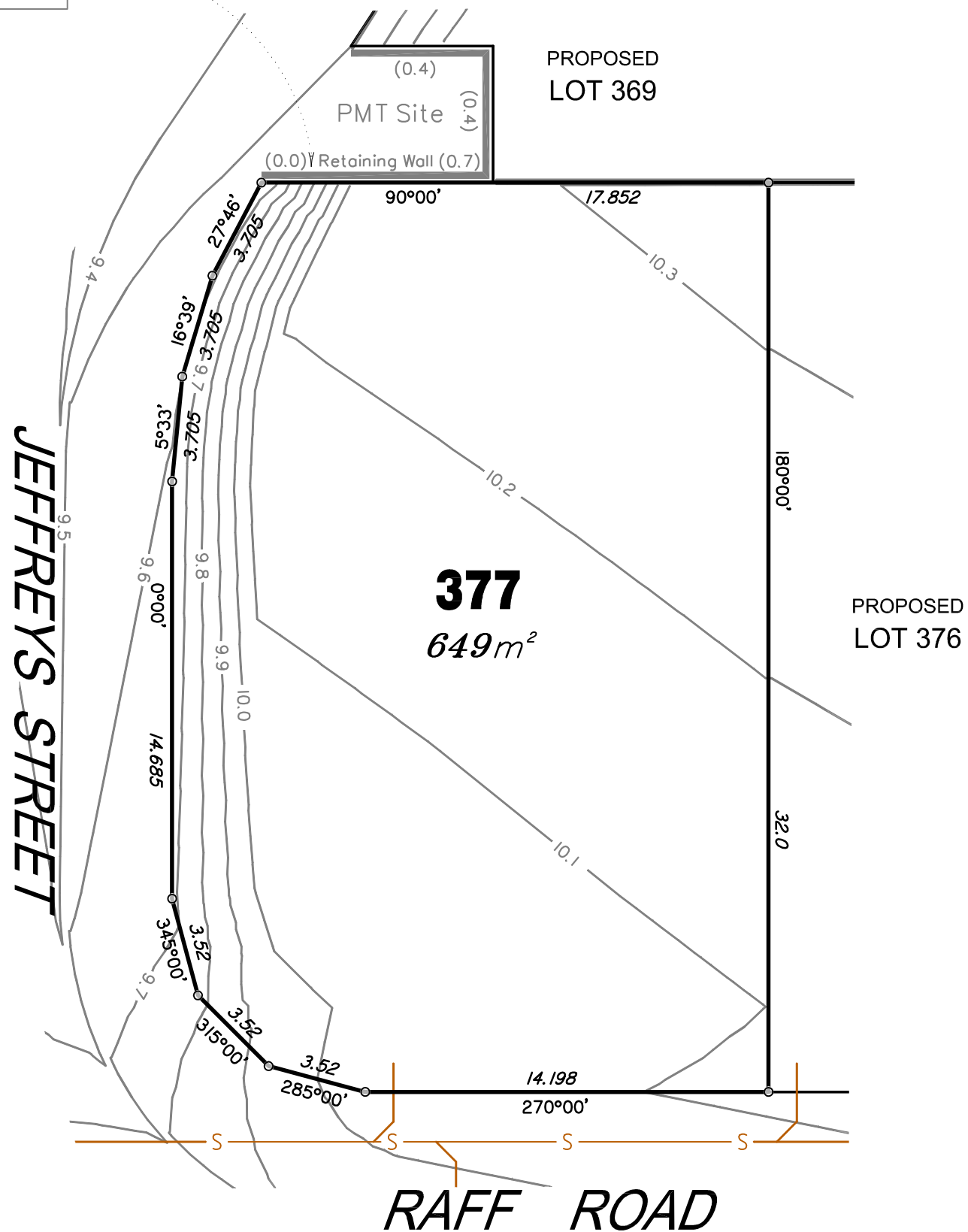

RIVERBANK

For
PEET

IMPORTANT NOTES:
 (These notes are an integral part of this plan)
 This plan has been prepared for PEET & CO for the purposes of A Disclosure Plan Under the Land Sales Act 1984 (as Amended).

It is not to be used by any other person or corporation or for any other purposes and is subject to the following limitations:

The Lot dimensions and area shown herein are subject to final field survey and also to the requirements of Council and any other authority which may have requirements under any relevant legislation.

Design surface contours from the design surface data supplied by Brown Consulting Pty Ltd. Where final surface contours are not shown, no change to existing surface level is proposed.

Compaction of any fill material placed on this site shall be completed under inspection and testing services in accordance with AS3798-2007.

Location of sewer and roofwater lines, manholes and pits are those shown on engineering design drawings and may differ from the as-constructed location.

THESE DESIGNS AND DRAWINGS ARE COPYRIGHT AND ARE NOT TO BE USED OR REPRODUCED WITHOUT THE WRITTEN PERMISSION OF THG

Data Sources
 Cadastral Boundaries 215809_1_LC1(D).dwg
 Design Surface Contours Stage 9 - 12D Design Tin.12da
 Engineering Design X_806158_BASE_MASTER_2014_09_08.dwg

No	Revisions	Date	Chkd
C	Amend Riverbank logo	2/12/14	EJM
B	Revised to suit new Act	27/11/14	GTS
A	Original	8/9/14	EJM

Parish: CABOOLTURE
 County: STANLEY
 Locality: CABOOLTURE SOUTH
 Local Authority: M.B.R.C
 Horizontal Meridian: SP232377
 Vertical Level Datum: AHD
 Level Origin: PM109474(RL15.112)
 Scale: 1:200 @ A3
 Surveyed: THG WSG Pty Ltd
 Designed: Brown Consulting
 Drawn: EJM
 Checked: MMR
 Plot Date: 03 Dec, 2014
 Computer File Ref: 215809_5_DPs(B).dwg

DISCLOSURE PLAN
 of Proposed Lot 377
 being part of
 Lot 2 on SP269617



BRISBANE (07) 3666 4700 MACKAY (07) 4951 2911 PROSERPINE (07) 4945 1722
 BOWEN (07) 4786 1050 CAIRNS (07) 4051 6722

Email mail@thg.com.au www.thg.com.au
 ABN 55156210052 THG WSG Pty Ltd t/a THG Resource Strategists

Drawing No 30599-DP377 Issue C





LEGEND

Final surface contours based on A.H.D. datum at an interval of 0.1m, shown as: 1:0

Where applicable, areas filled from existing surface are shown as:-

Depth of Fill $+0.13$

Sewer line shown as:

Sewer Manhole/Maintenance Shaft shown as:

Roofwater Drainage line shown as:

Roofwater Manhole shown as:

Roofwater Pit shown as:

IMPORTANT NOTES:
(These notes are an integral part of this plan)
This plan has been prepared for PEET & CO for the purposes of A Disclosure Plan Under the Land Sales Act 1984 (as Amended).

It is not to be used by any other person or corporation or for any other purposes and is subject to the following limitations:

The Lot dimensions and area shown herein are subject to final field survey and also to the requirements of Council and any other authority which may have requirements under any relevant legislation.

Design surface contours from the design surface data supplied by Brown Consulting Pty Ltd. Where final surface contours are not shown, no change to existing surface level is proposed.

Compaction of any fill material placed on this site shall be completed under inspection and testing services in accordance with AS3798-2007.

Location of sewer and roofwater lines, manholes and pits are those shown on engineering design drawings and may differ from the as-constructed location.

THESE DESIGNS AND DRAWINGS ARE COPYRIGHT AND ARE NOT TO BE USED OR REPRODUCED WITHOUT THE WRITTEN PERMISSION OF THG

Data Sources
Cadastral Boundaries 215809_1_LC1(D).dwg
Design Surface Contours Stage 9 - 12D Design Tin.12da
Engineering Design X_806158_BASE_MASTER_2014_09_08.dwg

No	Revisions	Date	Chkd
C	Amend Riverbank logo	2/12/14	EJM
B	Revised to suit new Act	27/11/14	GTS
A	Original	8/9/14	EJM

Parish: CABOOLTURE
County: STANLEY
Locality: CABOOLTURE SOUTH
Local Authority: M.B.R.C
Horizontal Meridian: SP232377
Vertical Level Datum: AHD
Level Origin: PM109474(RL15.112)
Scale: 1:200 @ A3
Surveyed: THG WSG Pty Ltd
Designed: Brown Consulting
Drawn: EJM
Checked: MMR
Plot Date: 03 Dec, 2014
Computer File Ref: 215809_5_DPs(B).dwg

DISCLOSURE PLAN
of Proposed Lot 402
being part of
Lot 2 on SP269617



BRISBANE (07) 3666 4700 MACKAY (07) 4951 2911 PROSERPINE (07) 4945 1722
BOWEN (07) 4786 1050 CAIRNS (07) 4051 6722

Email mail@thg.com.au www.thg.com.au
ABN 55156210052 THG WSG Pty Ltd t/a THG Resource Strategists

Drawing No **30599-DP402** Issue **C**

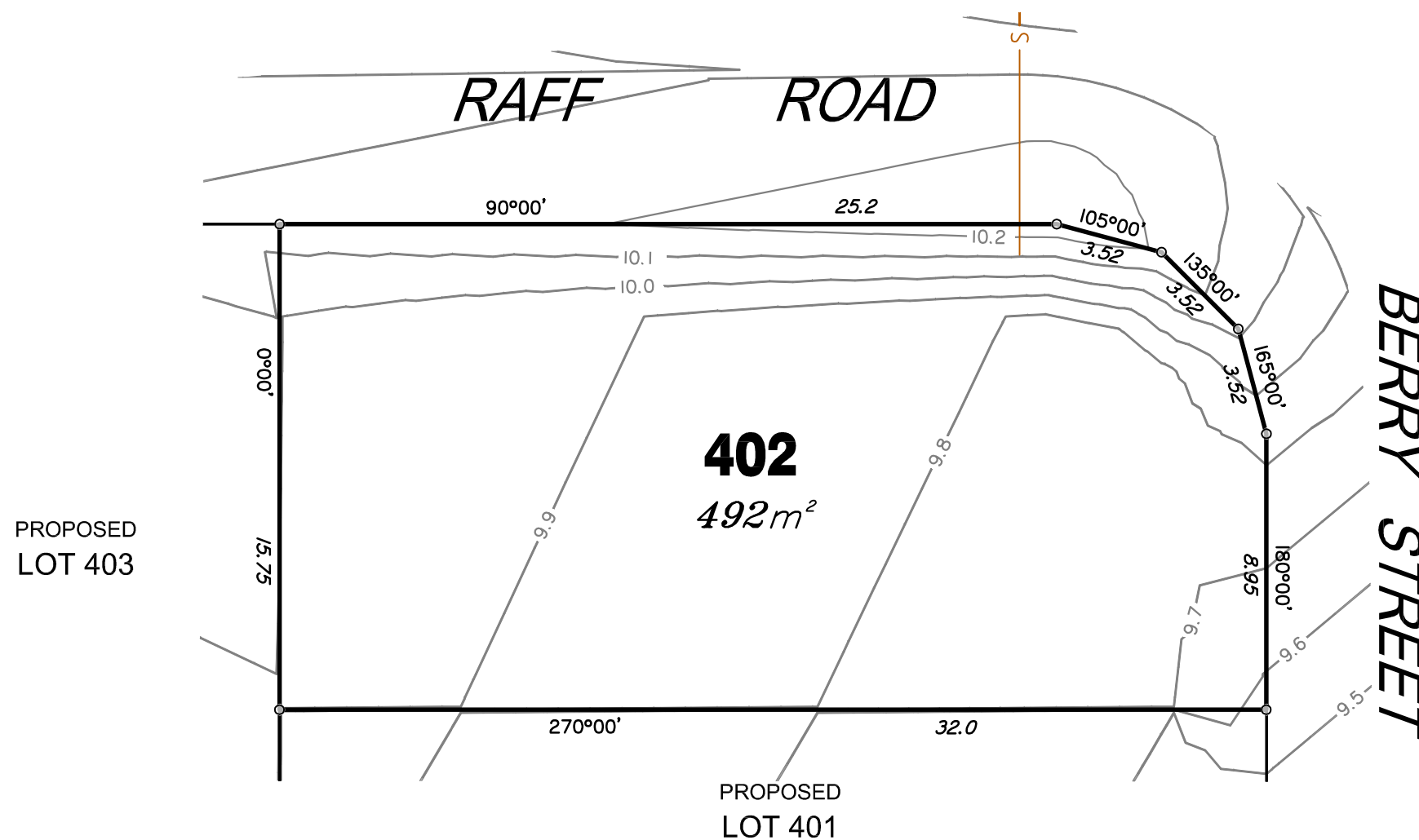

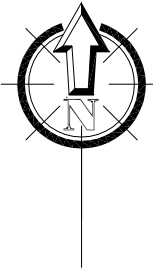

IMPORTANT NOTES:
(These notes are an integral part of this plan)
This plan has been prepared for PEET & CO for the purposes of a Disclosure Plan Under the Land Sales Act 1984 (as Amended).

It is not to be used by any other person or corporation or for any other purposes and is subject to the following limitations:

The Lot dimensions and area shown herein are subject to final field survey and also to the requirements of Council and any other authority which may have requirements under any relevant legislation.

Design surface contours from the design surface data supplied by Brown Consulting Pty Ltd. Where final surface contours are not shown, no change to existing surface level is proposed.

Compaction of any fill material placed on this site shall be completed under inspection and testing services in accordance with AS3798-2007.

Location of sewer and roofwater lines, manholes and pits are those shown on engineering design drawings and may differ from the as-constructed location.

THESE DESIGNS AND DRAWINGS ARE COPYRIGHT AND ARE NOT TO BE USED OR REPRODUCED WITHOUT THE WRITTEN PERMISSION OF THG

Data Sources
Cadastral Boundaries 215809_1_LC1(D).dwg
Design Surface Contours Stage 9 - 12D Design Tin.12da
Engineering Design X_806158_BASE_MASTER_2014_09_08.dwg

No	Revisions	Date	Chkd
C	Amend Riverbank logo	2/12/14	EJM
B	Revised to suit new Act	27/11/14	GTS
A	Original	8/9/14	EJM

Parish: CABOOLTURE
County: STANLEY
Locality: CABOOLTURE SOUTH
Local Authority: M.B.R.C
Horizontal Meridian: SP232377
Vertical Level Datum: AHD
Level Origin: PM109474(RL15.112)
Scale: 1:200 @ A3
Surveyed: THG WSG Pty Ltd
Designed: Brown Consulting
Drawn: EJM
Checked: MMR
Plot Date: 03 Dec, 2014
Computer File Ref: 215809_5_DPs(B).dwg

DISCLOSURE PLAN
of Proposed Lot 403
being part of
Lot 2 on SP269617



BRISBANE (07) 3666 4700 MACKAY (07) 4951 2911 PROSERPINE (07) 4945 1722
BOWEN (07) 4786 1050 CAIRNS (07) 4051 6722

Email mail@thg.com.au www.thg.com.au
ABN 55156210052 THG WSG Pty Ltd t/a THG Resource Strategists

Drawing No 30599-DP 403 Issue C

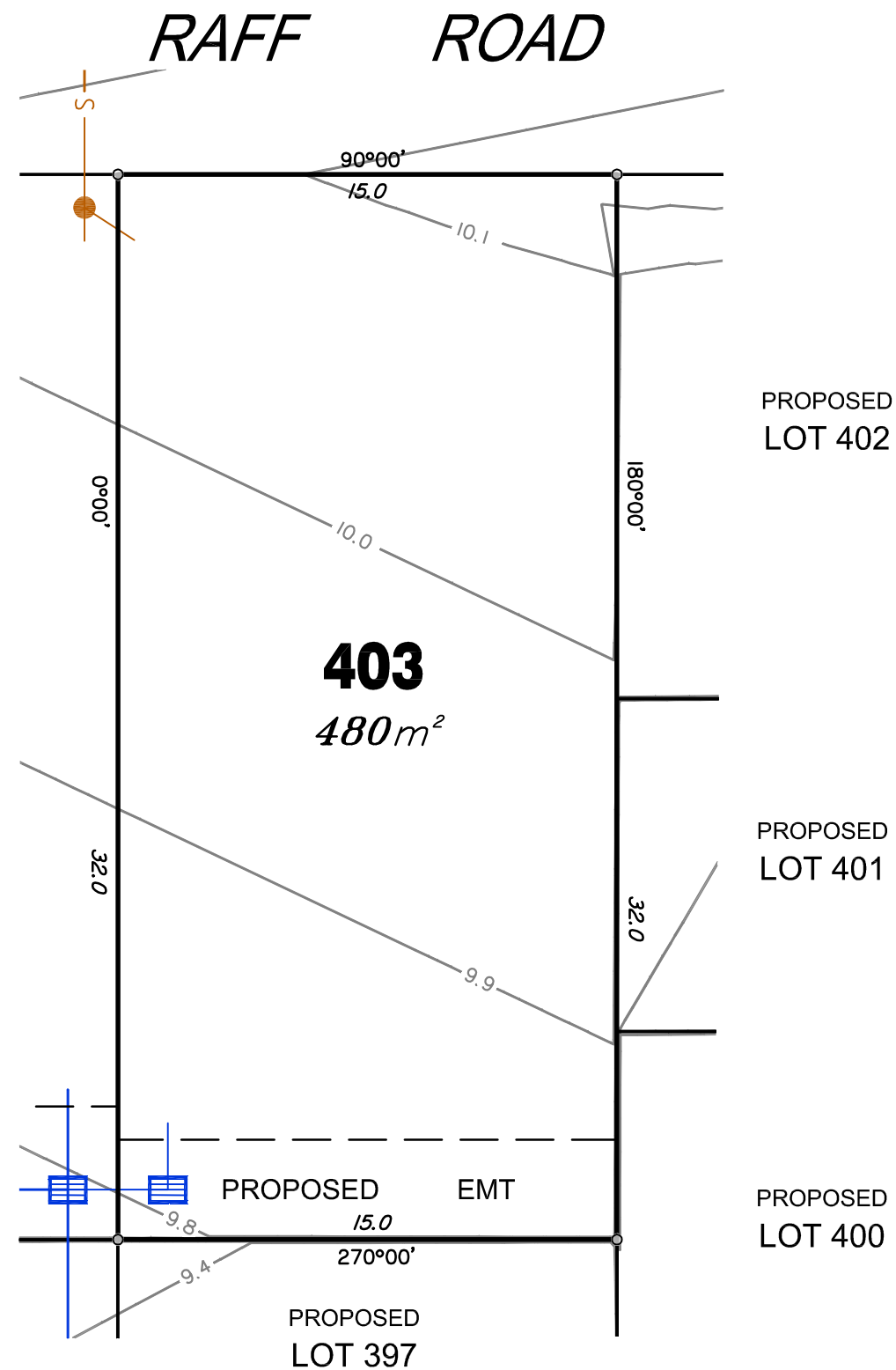

LEGEND

Final surface contours based on A.H.D. datum at an interval of 0.1m, shown as: — 1.0 —

Where applicable, areas filled from existing surface are shown as:-



Depth of Fill +0.13

Sewer line shown as: — S —

Sewer Manhole/Maintenance Shaft shown as: ●

Roofwater Drainage line shown as: — RWD —

Roofwater Manhole shown as: ●

Roofwater Pit shown as: ■



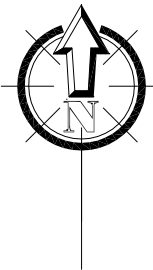

IMPORTANT NOTES:
(These notes are an integral part of this plan)
This plan has been prepared for PEET & CO for the purposes of A Disclosure Plan Under the Land Sales Act 1984 (as Amended).

It is not to be used by any other person or corporation or for any other purposes and is subject to the following limitations:

The Lot dimensions and area shown hereon are subject to final field survey and also to the requirements of Council and any other authority which may have requirements under any relevant legislation.

Design surface contours from the design surface data supplied by Brown Consulting Pty Ltd. Where final surface contours are not shown, no change to existing surface level is proposed.

Compaction of any fill material placed on this site shall be completed under inspection and testing services in accordance with AS3798-2007.

Location of sewer and roofwater lines, manholes and pits are those shown on engineering design drawings and may differ from the as-constructed location.

Copyright © Queensland Surveying Pty Ltd t/a THG Resource Strategists 24/6/2015.

THESE DESIGNS AND DRAWINGS ARE COPYRIGHT AND ARE NOT TO BE USED OR REPRODUCED WITHOUT THE WRITTEN PERMISSION OF THG

Data Sources
Cadastral Boundaries 215809_1_LC1(D).dwg
Design Surface Contours Stage 9 - 12D Design Tin.12da
Engineering Design X_806158_BASE_MASTER_2014_09_08.dwg

No	Revisions	Date	Chkd
D	Add sewer easement	24/6/15	EJM
C	Amend Riverbank logo	2/12/14	EJM
B	Revised to suit new Act	27/11/14	GTS
A	Original	8/9/14	EJM

Parish: CABOOLTURE
County: STANLEY
Locality: CABOOLTURE SOUTH
Local Authority: M.B.R.C
Horizontal Meridian: SP232377
Vertical Level Datum: AHD
Level Origin: PM109474(RL15.112)
Scale: 1:200 @ A3
Designed: Brown Consulting
Drawn: EJM
Checked: MMR
Plot Date: 24 Jun, 2015
Computer File Ref: 215809_5 DPs(D).dwg

DISCLOSURE PLAN
of Proposed Lot 404
being part of
Lot 2 on SP269617



BRISBANE (07) 3666 4700 MACKAY (07) 4951 2911 PROSERPINE (07) 4945 1722
BOWEN (07) 4786 1050 CAIRNS (07) 4051 6722

Email mail@thg.com.au www.thg.com.au
ABN 25 604 671 374

Queensland Surveying Pty Ltd t/a THG Resource Strategists

Drawing No 30599-DP404 Issue D

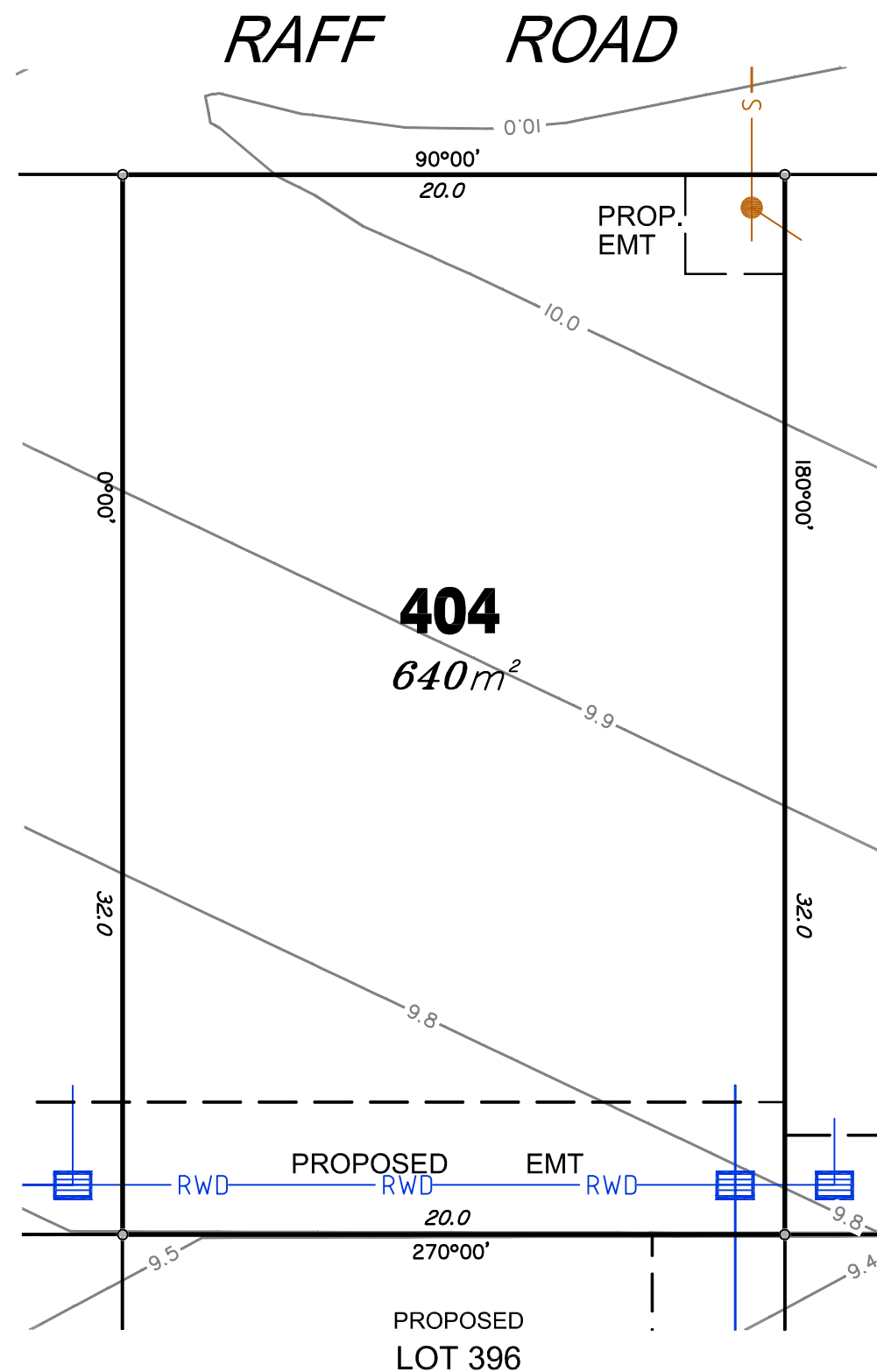

LEGEND

Final surface contours based on A.H.D. datum at an interval of 0.1m, shown as: — 1.0 —

Where applicable, areas filled from existing surface are shown as:-

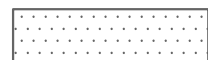

Depth of Fill +0.13

Sewer line shown as:



Sewer Manhole/Maintenance Shaft shown as:



Roofwater Drainage line shown as:



Roofwater Manhole shown as:



Roofwater Pit shown as:



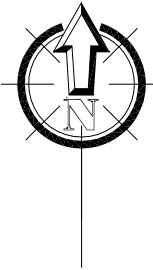

IMPORTANT NOTES:
(These notes are an integral part of this plan)
This plan has been prepared for PEET & CO for the purposes of **A Disclosure Plan Under the Land Sales Act 1984 (as Amended)**.

It is not to be used by any other person or corporation or for any other purposes and is subject to the following limitations:

The Lot dimensions and area shown hereon are subject to final field survey and also to the requirements of Council and any other authority which may have requirements under any relevant legislation.

Design surface contours from the design surface data supplied by Brown Consulting Pty Ltd. Where final surface contours are not shown, no change to existing surface level is proposed.

Compaction of any fill material placed on this site shall be completed under inspection and testing services in accordance with AS3798-2007.

Location of sewer and roofwater lines, manholes and pits are those shown on engineering design drawings and may differ from the as-constructed location.

THESE DESIGNS AND DRAWINGS ARE COPYRIGHT AND ARE NOT TO BE USED OR REPRODUCED WITHOUT THE WRITTEN PERMISSION OF THG

Data Sources
Cadastral Boundaries 215809_1_LC1(D).dwg
Design Surface Contours Stage 9 - 12D Design Tin.12da
Engineering Design X_806158_BASE_MASTER_2014_09_08.dwg

No	Revisions	Date	Chkd
C	Amend Riverbank logo	2/12/14	EJM
B	Revised to suit new Act	27/11/14	GTS
A	Original	8/9/14	EJM

Parish: CABOOLTURE
County: STANLEY
Locality: CABOOLTURE SOUTH
Local Authority: M.B.R.C
Horizontal Meridian: SP232377
Vertical Level Datum: AHD
Level Origin: PM109474(RL15.112)
Scale: 1:200 @ A3
Surveyed: THG WSG Pty Ltd
Designed: Brown Consulting
Drawn: EJM
Checked: MMR
Plot Date: 03 Dec, 2014
Computer File Ref: 215809_5_DPs(B).dwg

DISCLOSURE PLAN
of Proposed Lot 405
being part of
Lot 2 on SP269617



BRISBANE (07) 3666 4700 MACKAY (07) 4951 2911 PROSERPINE (07) 4945 1722
BOWEN (07) 4786 1050 CAIRNS (07) 4051 6722

Email mail@thg.com.au www.thg.com.au
ABN 55156210052 THG WSG Pty Ltd t/a THG Resource Strategists

Drawing No **30599-DP405** Issue **C**

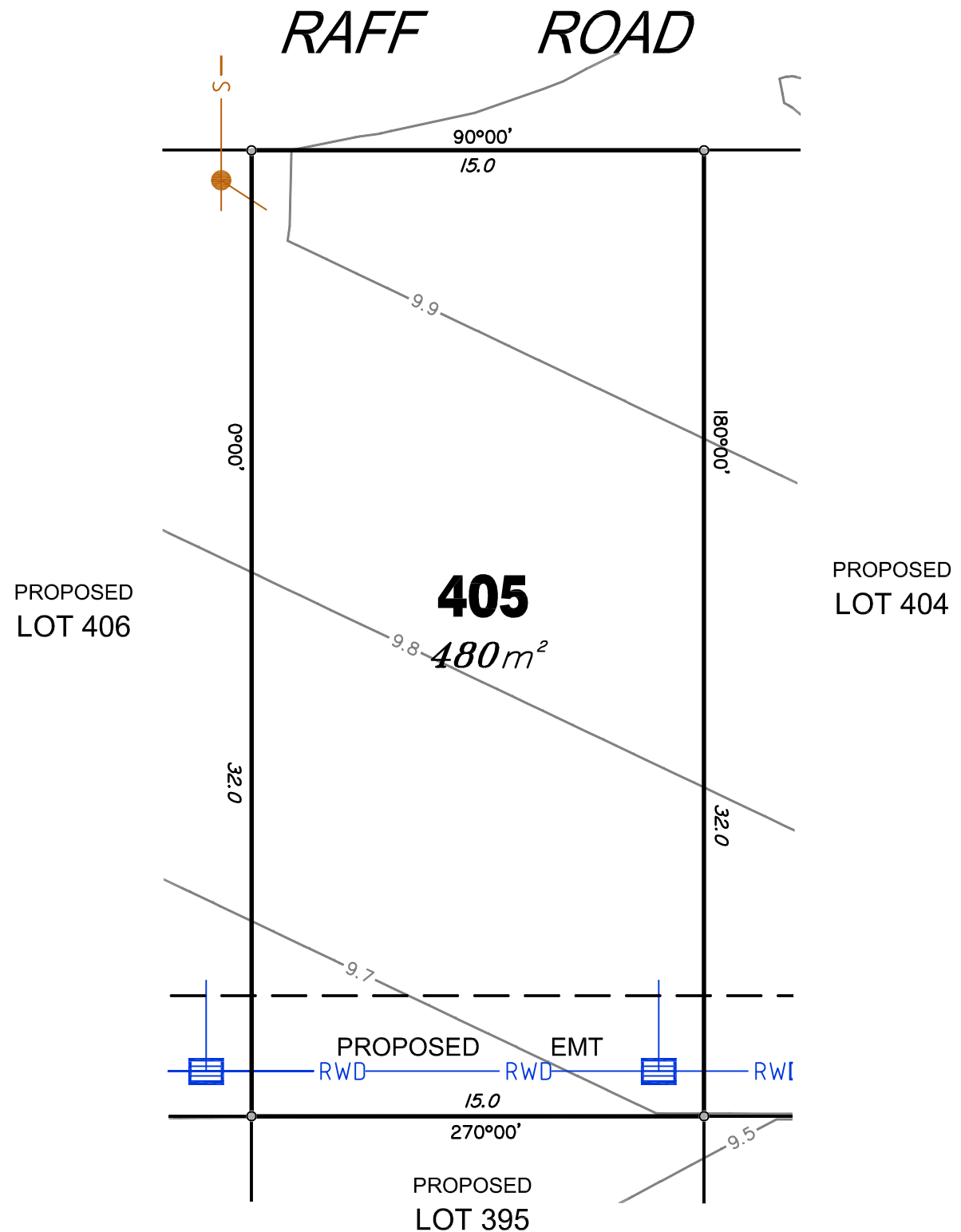

LEGEND

Final surface contours based on A.H.D. datum at an interval of 0.1m, shown as: — 1.0 —

Where applicable, areas filled from existing surface are shown as:-

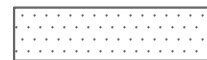

Depth of Fill +0.13

Sewer line shown as: — S —

Sewer Manhole/Maintenance Shaft shown as:

Roofwater Drainage line shown as: — RWD —

Roofwater Manhole shown as:

Roofwater Pit shown as:

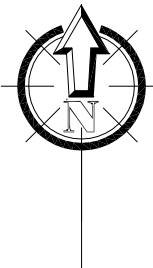

IMPORTANT NOTES:
(These notes are an integral part of this plan)
This plan has been prepared for PEET & CO for the purposes of **A Disclosure Plan Under the Land Sales Act 1984 (as Amended)**.

It is not to be used by any other person or corporation or for any other purposes and is subject to the following limitations:

The Lot dimensions and area shown hereon are subject to final field survey and also to the requirements of Council and any other authority which may have requirements under any relevant legislation.

Design surface contours from the design surface data supplied by Brown Consulting Pty Ltd. Where final surface contours are not shown, no change to existing surface level is proposed.

Compaction of any fill material placed on this site shall be completed under inspection and testing services in accordance with AS3798-2007.

Location of sewer and roofwater lines, manholes and pits are those shown on engineering design drawings and may differ from the as-constructed location.

Copyright © Queensland Surveying Pty Ltd t/a THG Resource Strategists 24/6/2015.

THESE DESIGNS AND DRAWINGS ARE COPYRIGHT AND ARE NOT TO BE USED OR REPRODUCED WITHOUT THE WRITTEN PERMISSION OF THG

Data Sources
Cadastral Boundaries 215809_1_LC1(D).dwg
Design Surface Contours Stage 9 - 12D Design Tin.12da
Engineering Design X_806158_BASE_MASTER_2014_09_08.dwg

No	Revisions	Date	Chkd
D	Add sewer easement	24/6/15	EJM
C	Amend Riverbank logo	2/12/14	EJM
B	Revised to suit new Act	27/11/14	GTS
A	Original	8/9/14	EJM

Parish: CABOOLTURE
County: STANLEY
Locality: CABOOLTURE SOUTH
Local Authority: M.B.R.C
Horizontal Meridian: SP232377
Vertical Level Datum: AHD
Level Origin: PM109474(RL15.112)
Scale: 1:200 @ A3
Designed: Brown Consulting
Drawn: EJM
Checked: MMR
Plot Date: 24 Jun, 2015
Computer File Ref: 215809_5 DPs(D).dwg

DISCLOSURE PLAN
of Proposed Lot 406
being part of
Lot 2 on SP269617



BRISBANE (07) 3666 4700 MACKAY (07) 4951 2911 PROSERPINE (07) 4945 1722

BOWEN (07) 4786 1050 CAIRNS (07) 4051 6722

Email mail@thg.com.au www.thg.com.au

ABN 25 604 671 374
Queensland Surveying Pty Ltd t/a THG Resource Strategists

Drawing No **30599-DP406** Issue **D**

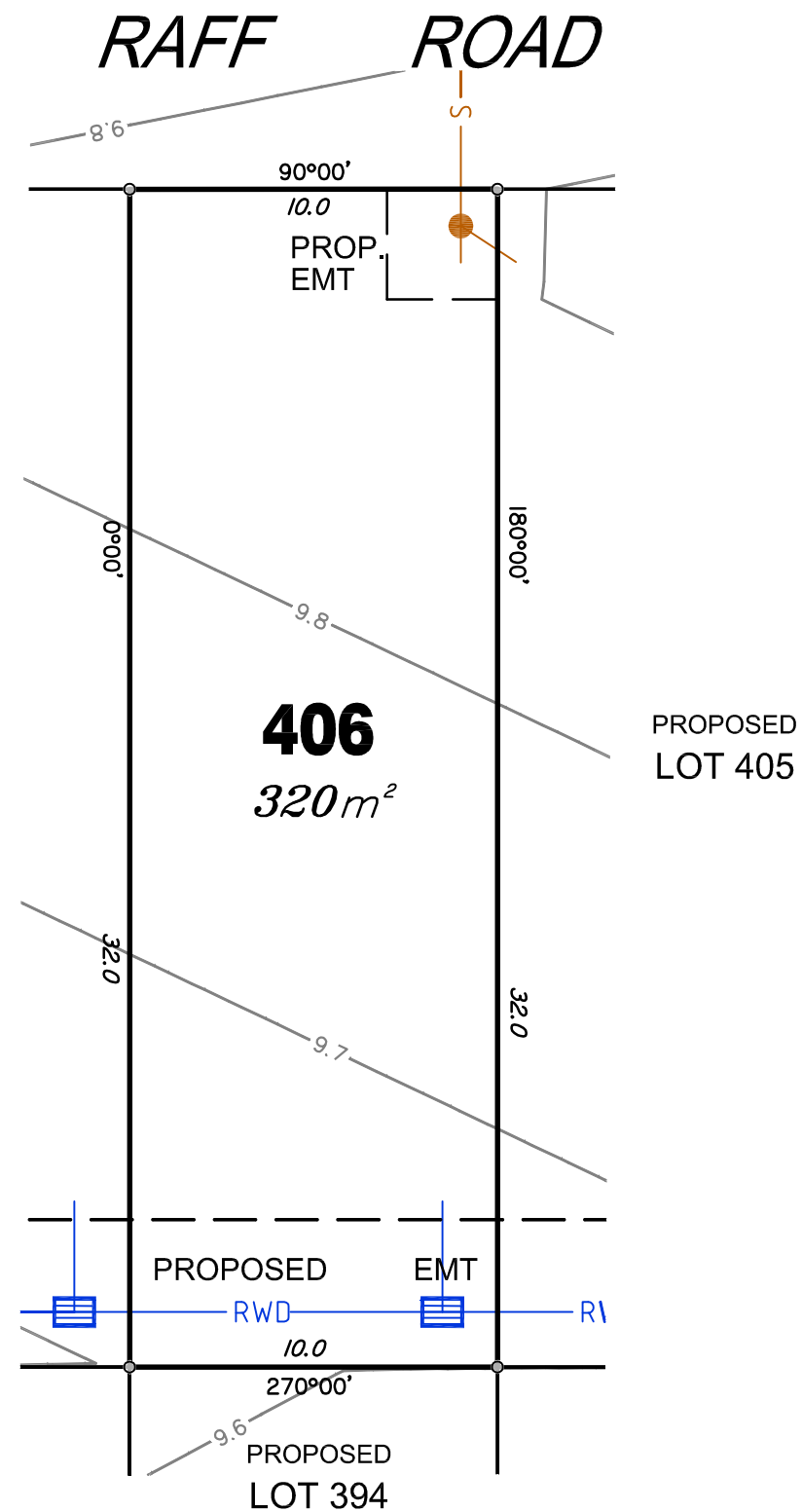

LEGEND

Final surface contours based on A.H.D. datum at an interval of 0.1m, shown as: — 1.0 —

Where applicable, areas filled from existing surface are shown as:-

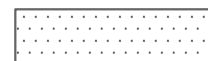

Depth of Fill +0.13

Sewer line shown as: — S —

Sewer Manhole/Maintenance Shaft shown as: ●

Roofwater Drainage line shown as: — RWD —

Roofwater Manhole shown as: ●

Roofwater Pit shown as: ■



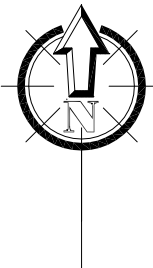

IMPORTANT NOTES:
(These notes are an integral part of this plan)
This plan has been prepared for PEET & CO for the purposes of A Disclosure Plan Under the Land Sales Act 1984 (as Amended).

It is not to be used by any other person or corporation or for any other purposes and is subject to the following limitations:

The Lot dimensions and area shown hereon are subject to final field survey and also to the requirements of Council and any other authority which may have requirements under any relevant legislation.

Design surface contours from the design surface data supplied by Brown Consulting Pty Ltd. Where final surface contours are not shown, no change to existing surface level is proposed.

Compaction of any fill material placed on this site shall be completed under inspection and testing services in accordance with AS3798-2007.

Location of sewer and roofwater lines, manholes and pits are those shown on engineering design drawings and may differ from the as-constructed location.

Copyright © Queensland Surveying Pty Ltd t/a THG Resource Strategists 24/6/2015.

THESE DESIGNS AND DRAWINGS ARE COPYRIGHT AND ARE NOT TO BE USED OR REPRODUCED WITHOUT THE WRITTEN PERMISSION OF THG

Data Sources
Cadastral Boundaries 215809_1_LC1(D).dwg
Design Surface Contours Stage 9 - 12D Design Tin.12da
Engineering Design X_806158_BASE_MASTER_2014_09_08.dwg

No	Revisions	Date	Chkd
D	Add sewer easement	24/6/15	EJM
C	Amend Riverbank logo	2/12/14	EJM
B	Revised to suit new Act	27/11/14	GTS
A	Original	8/9/14	EJM

Parish: CABOOLTURE
County: STANLEY
Locality: CABOOLTURE SOUTH
Local Authority: M.B.R.C
Horizontal Meridian: SP232377
Vertical Level Datum: AHD
Level Origin: PM109474(RL15.112)
Scale: 1:200 @ A3
Designed: Brown Consulting
Drawn: EJM
Checked: MMR
Plot Date: 24 Jun, 2015
Computer File Ref: 215809_5 DPs(D).dwg

DISCLOSURE PLAN
of Proposed Lot 408
being part of
Lot 2 on SP269617



BRISBANE (07) 3666 4700 MACKAY (07) 4951 2911 PROSERPINE (07) 4945 1722

BOWEN (07) 4786 1050 CAIRNS (07) 4051 6722

Email mail@thg.com.au www.thg.com.au

ABN 25 604 671 374
Queensland Surveying Pty Ltd t/a THG Resource Strategists

Drawing No **30599-DP408** Issue **D**

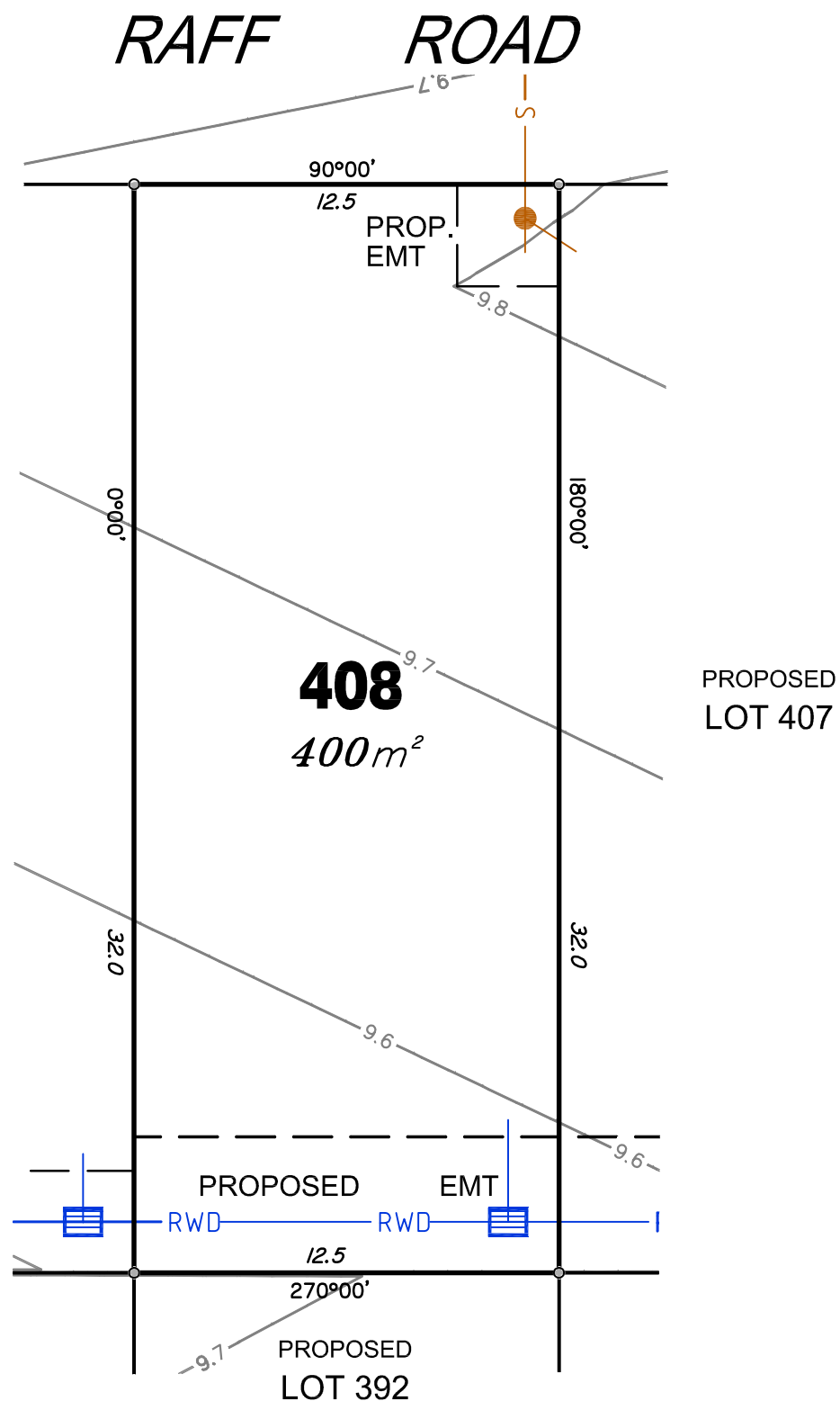

LEGEND

Final surface contours based on A.H.D. datum at an interval of 0.1m, shown as: — 1.0 —

Where applicable, areas filled from existing surface are shown as:-

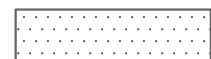

Depth of Fill +0.13

Sewer line shown as: — S —

Sewer Manhole/Maintenance Shaft shown as:

Roofwater Drainage line shown as: — RWD —

Roofwater Manhole shown as:

Roofwater Pit shown as:



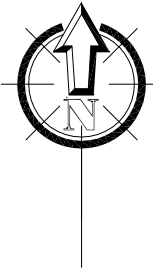

LEGEND

Final surface contours based on A.H.D. datum at an interval of 0.1m, shown as: 1:0

Where applicable, areas filled from existing surface are shown as:-

Depth of Fill +0.13

Sewer line shown as:

Sewer Manhole/Maintenance Shaft shown as:

Roofwater Drainage line shown as:

Roofwater Manhole shown as:

Roofwater Pit shown as:

PROPOSED LOT 414

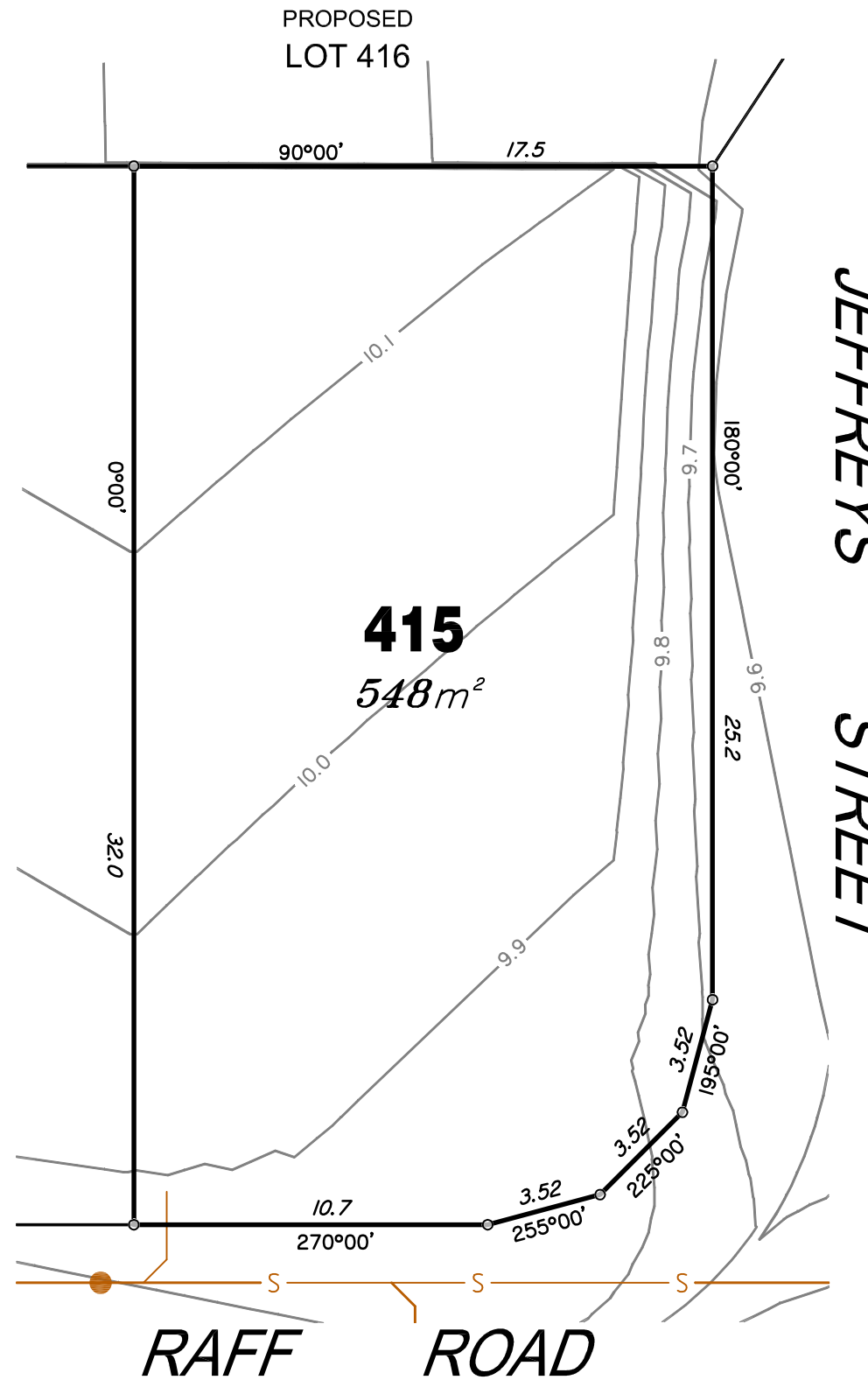

JEFFREYS STREET

RAFF ROAD

RIVERBANK

For
PEET

IMPORTANT NOTES:
(These notes are an integral part of this plan)
This plan has been prepared for PEET & CO for the purposes of A Disclosure Plan Under the Land Sales Act 1984 (as Amended).

It is not to be used by any other person or corporation or for any other purposes and is subject to the following limitations:

The Lot dimensions and area shown herein are subject to final field survey and also to the requirements of Council and any other authority which may have requirements under any relevant legislation.

Design surface contours from the design surface data supplied by Brown Consulting Pty Ltd. Where final surface contours are not shown, no change to existing surface level is proposed.

Compaction of any fill material placed on this site shall be completed under inspection and testing services in accordance with AS3798-2007.

Location of sewer and roofwater lines, manholes and pits are those shown on engineering design drawings and may differ from the as-constructed location.

THESE DESIGNS AND DRAWINGS ARE COPYRIGHT AND ARE NOT TO BE USED OR REPRODUCED WITHOUT THE WRITTEN PERMISSION OF THG

Data Sources
Cadastral Boundaries 215809_1_LC1(D).dwg
Design Surface Contours Stage 9 - 12D Design Tin.12da
Engineering Design X_806158_BASE_MASTER_2014_09_08.dwg

No	Revisions	Date	Chkd
C	Amend Riverbank logo	2/12/14	EJM
B	Revised to suit new Act	27/11/14	GTS
A	Original	8/9/14	EJM

Parish: CABOOLTURE
County: STANLEY
Locality: CABOOLTURE SOUTH
Local Authority: M.B.R.C
Horizontal Meridian: SP232377
Vertical Level Datum: AHD
Level Origin: PM109474(RL15.112)
Scale: 1:200 @ A3
Surveyed: THG WSG Pty Ltd
Designed: Brown Consulting
Drawn: EJM
Checked: MMR
Plot Date: 03 Dec, 2014
Computer File Ref: 215809_5_DPs(B).dwg

DISCLOSURE PLAN
of Proposed Lot 415
being part of
Lot 2 on SP269617



BRISBANE (07) 3666 4700
MACKAY (07) 4951 2911
PROSERPINE (07) 4945 1722
BOWEN (07) 4786 1050
CAIRNS (07) 4051 6722

Email mail@thg.com.au www.thg.com.au
ABN 55156210052 THG WSG Pty Ltd t/a THG Resource Strategists

Drawing No 30599-DP415 Issue C

