







PSM191027
 E: 495937.616
 N: 7003052.339
 RL: 8.767m

LEGEND:

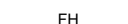
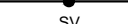
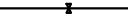
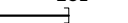
-  NEW Ø150 PVC-U CLASS PN16 WATERMAIN
-  NEW Ø100 PVC-U CLASS PN16 WATERMAIN
-  NEW READY TAP HOUSE CONNECTION
-  NEW HYDRANT
-  NEW SLUICE VALVE
-  NEW END CAP
-  NEW WATER SERVICE CONDUIT 100Ø PVC-O
-  EXISTING WATER MAIN
-  NEW WATER SERVICE CONNECTION 20mm MANUFACTURER - ELSTER
-  DICL WATERMAIN
-  REDUCER
-  NEW Ø150xØ100 REDUCER

COORDINATE DATUM NOTE:

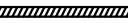
HORIZONTAL COORDINATES(E,N) SUPPLIED ARE MAPPING GRID OF AUSTRALIA(MGA), ZONE 56 BASED ON THE UNIVERSAL TRANSVERSE MERCATOR PROJECTION AND THE GEOCENTRIC DATUM OF AUSTRALIA 1994.
 HORIZONTAL DATUM DERIVED FROM PSM191027, E. 495937.616, N 7003052.339.
 LEVELS SUPPLIED ARE ON THE AUSTRALIAN HEIGHT DATUM(AHD)
 LEVEL DATUM DERIVED FROM PSM191027 RL 8.767 (AHD)

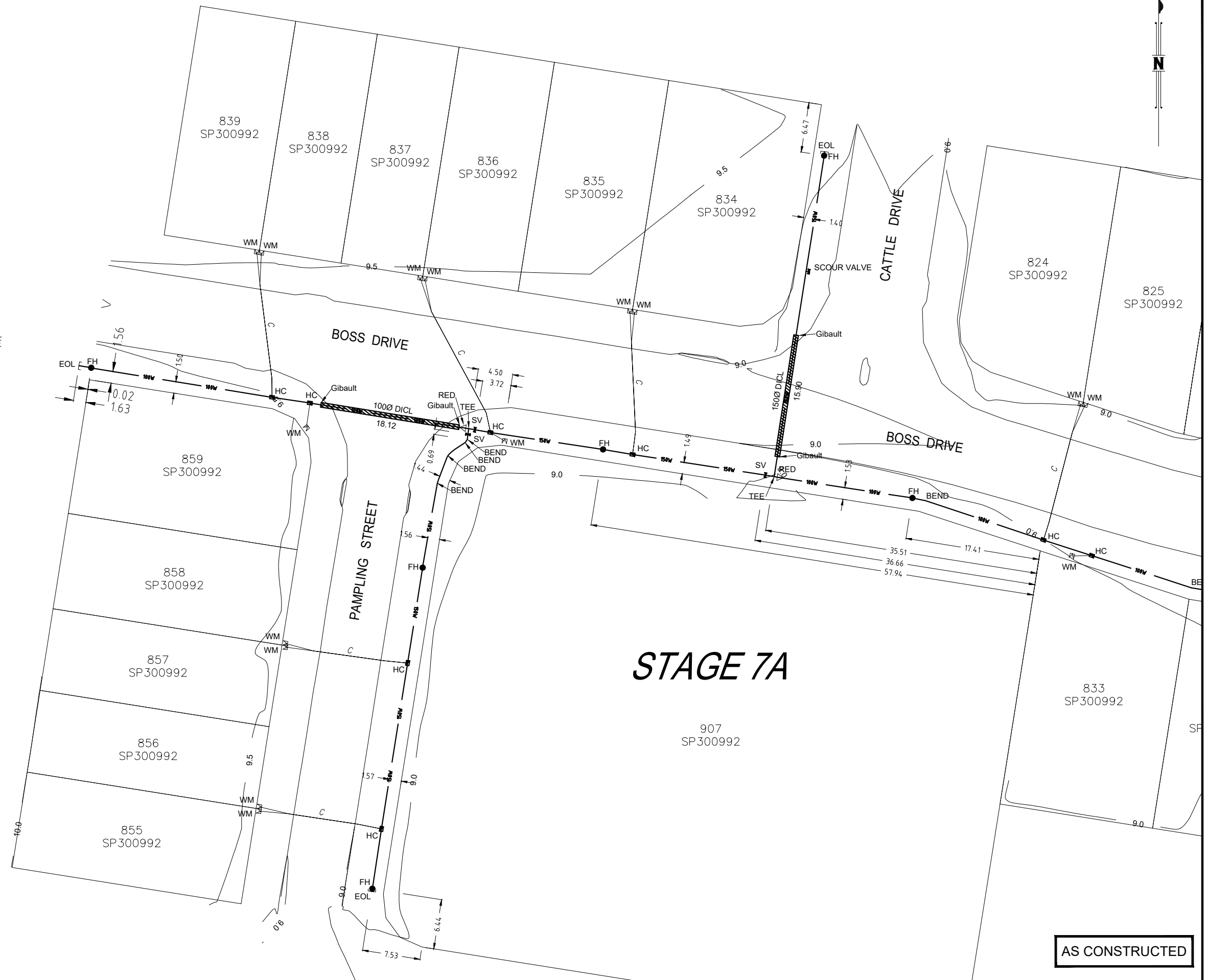

STAGE 7A

ENGINEER'S CERTIFICATION

I, _____, hereby certify that:

- The information contained in this drawing / document is in compliance with approved drawings and design.
- The new water and sewerage works defined by this drawing have been designed and constructed in accordance with the SEQ Code.
- This represents an accurate record of as-constructed works.
- I accept responsibility for the information contained in this drawing / document.

RPEQ (signature) RPEQ No. _____ Date: _____

REGISTERED SURVEYOR'S CERTIFICATION

I, Andrew Robert Thurston, hereby certify that the vertical and horizontal locations and dimensions shown on this plan are a true and correct record and were located by survey.

AT
 Registered Surveyor (sig) Reg. Surveyor No. 3047 Date: 03/10/2018

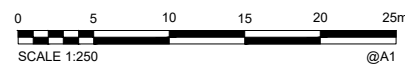

AS CONSTRUCTED

A1	A	26/09/2018	As Constructed	DM	ADH	AT
	INDEX	DATE	REVISIONS	DRAWN	CHECKED	PASSED

DRAWN	DM	03/10/2018
CHECKED	ADH	03/10/2018
PASSED	AT	03/10/2018
INITIALS	DATE	



Unitywater

17-002275.1
 RIVERBANK - STAGE 7A
 As-Constructed Water Reticulation
 2017011038 (7A)

SHEET 1 OF 2 SHEETS	SCALE 1:250
REVISION DATE 03/10/2018	REVISION A
DISCIPLINE CODE C	
DRAWING NO. U-2018-0767	

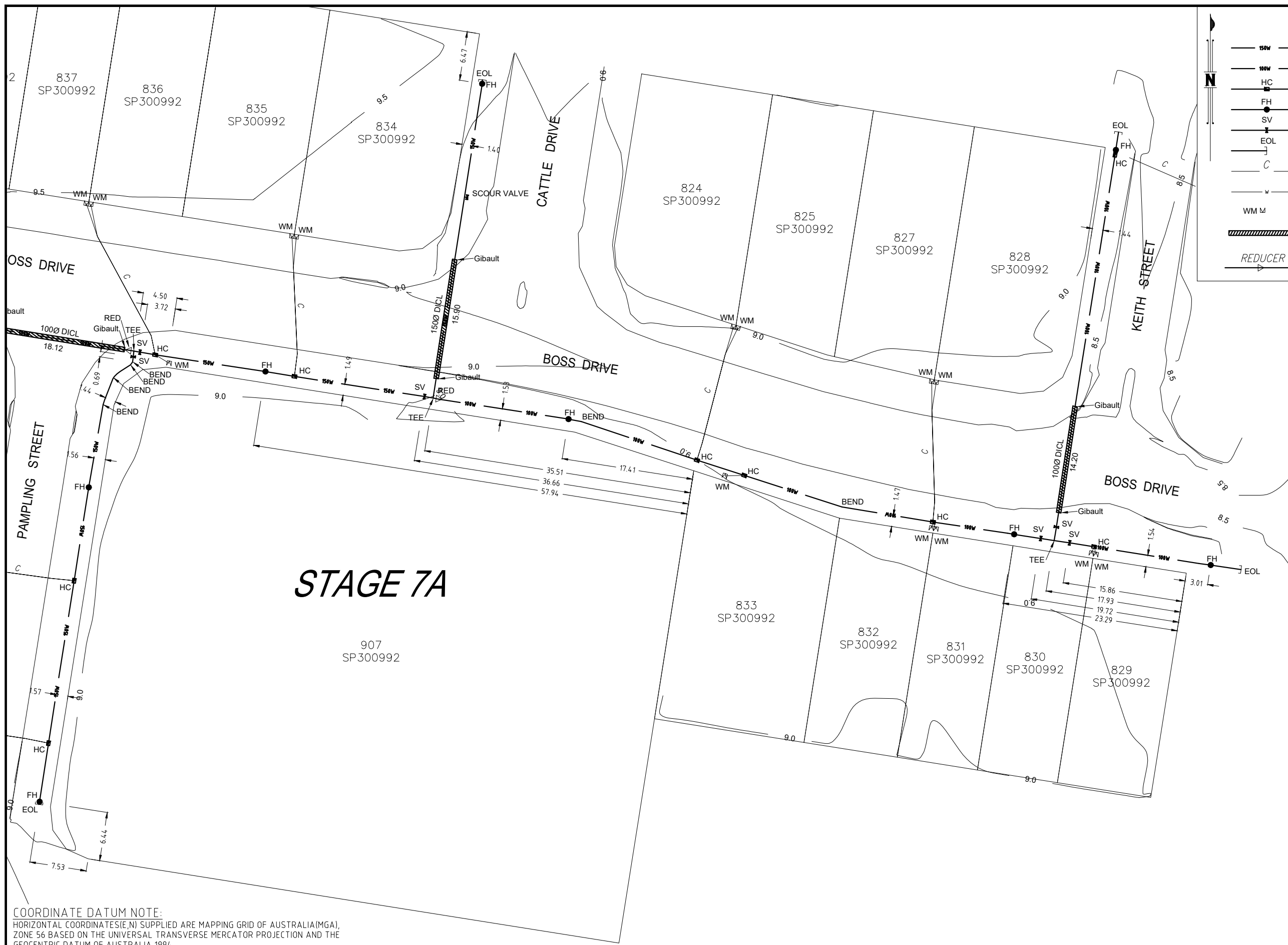

LEGEND:

- 150W — NEW Ø150 PVC-U CLASS PN16 WATERMAIN
- 100W — NEW Ø100 PVC-U CLASS PN16 WATERMAIN
- HC — NEW READY TAP HOUSE CONNECTION
- FH — NEW HYDRANT
- SV — NEW SLUICE VALVE
- EOL — NEW END CAP
- C — NEW WATER SERVICE CONDUIT 100Ø PVC-O
- WM — EXISTING WATER MAIN
- WM — NEW WATER SERVICE CONNECTION 20mm MANUFACTURER - ELSTER
- 100Ø DICL — DICL WATERMAIN
- REDUCER — NEW Ø150xØ100 REDUCER

STAGE 7A

PSM191027
 E: 4.95937.616
 N: 7003052.339
 RL: 8.767m

ENGINEER'S CERTIFICATION

I, _____ hereby certify that:

- The information contained in this drawing / document is in compliance with approved drawings and design.
- The new water and sewerage works defined by this drawing have been designed and constructed in accordance with the SEQ Code.
- This represents an accurate record of as-constructed works.
- I accept responsibility for the information contained in this drawing / document.

 RPEQ (signature) RPEQ No. _____ Date: _____

REGISTERED SURVEYOR'S CERTIFICATION

I, Andrew Robert Thurston, hereby certify that the vertical and horizontal locations and dimensions shown on this plan are a true and correct record and were located by survey.

ATG
 Registered Surveyor (sig) Reg. Surveyor No. 3047 Date: 03/10/2018

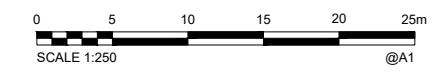

AS CONSTRUCTED

COORDINATE DATUM NOTE:
 HORIZONTAL COORDINATES (E, N) SUPPLIED ARE MAPPING GRID OF AUSTRALIA (MGA), ZONE 56 BASED ON THE UNIVERSAL TRANSVERSE MERCATOR PROJECTION AND THE GEOCENTRIC DATUM OF AUSTRALIA 1994.
 HORIZONTAL DATUM DERIVED FROM PSM191027, E 4.95937.616, N 7003052.339.
 LEVELS SUPPLIED ARE ON THE AUSTRALIAN HEIGHT DATUM (AHD)
 LEVEL DATUM DERIVED FROM PSM191027 RL 8.767 (AHD)

A1	INDEX	DATE	REVISIONS	DRAWN	CHECKED	PASSED	INITIALS	DATE
	A	03/10/2018	As Constructed	DM	ADH	AT		

WOLTER consulting group

Planning Urban Design Landscape Environment Surveying

Brisbane Level 2, 1 Breakfast Ck Road, Newstead, QLD 4006 Phone: (07) 3666 5200



Unitywater

17-002275.1
 RIVERBANK - STAGE 7A
 As-Constructed Water Reticulation
 2017011038 (7A)

SHEET 2 OF 2 SHEETS	SCALE 1:250
REVISION DATE 03/10/2018	REVISION A
DISCIPLINE CODE C	
DRAWING NO. U-2018-0767	