

**ENGINEER'S CERTIFICATION**  
 I, \_\_\_\_\_, hereby certify that:  
 1. The information contained in this drawing / document is in compliance with approved drawings and design.  
 2. The new drainage and transport works defined by this drawing have been designed and constructed in accordance with Council Standards.  
 3. This represents an accurate record of as-constructed works.  
 4. I accept responsibility for the information contained in this drawing / document.

RPEQ (signature) RPEQ No. \_\_\_\_\_ Date: \_\_\_\_\_

**REGISTERED SURVEYOR'S CERTIFICATION**  
 I, Andrew Robert Thurston (Cad. Surv.), hereby certify that the vertical and horizontal locations and dimensions shown on this plan are a true and correct record and were located by survey.

Registered Surveyor (sig.) Reg. Surveyor No. 3047 Date: 27/06/2018

**LEGEND:**

- NEW STORMWATER LINE
- TOP OF BANK
- - - BOTTOM OF BANK
- CONTOURS
- SW — EXISTING STORMWATER LINE
- NEW STORMWATER MANHOLE
- NEW STORMWATER GULLY PIT
- NEW RETAINING WALL

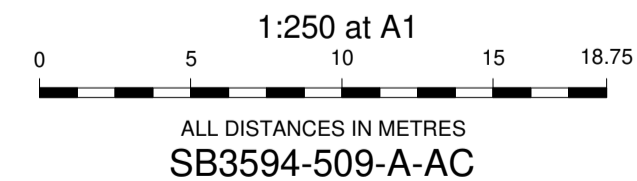

DRAWING REVISIONS		REFERENCE DRAWINGS		DESIGN FILE No.		DESIGNED	
REV.	REVISION DESCRIPTION	DRG. No.	DESCRIPTION	CONSTRUCT. No.	Ref	DATE	KM
A	AS CONSTRUCTED					27.06.2018	
B	MINOR AMENDMENTS						

FIELD BOOK		CHECKED		DATE	
					27.06.2018

LEVEL DATUM		DATE	
			27.06.2018

**THIS WORK WAS PREPARED BY:**

**WOLTER consulting group**

SCALE 1:250 ORIGINAL SIZE A1

**Moreton Bay Regional Council**

MORETON BAY REGIONAL COUNCIL  
 CABOOLTURE DISTRICT OFFICE  
 2 HASKING STREET CABOOLTURE QLD 4510  
 PO BOX 159 CABOOLTURE QLD 4510  
 Telephone: (07) 5433 0100  
 Fax: (07) 5433 4000

**RIVERBANK**  
 STAGE 12B  
 AS CONSTRUCTED  
 ROADS AND DRAINAGE

CSC SUBDIVISION REFERENCE  
 DA/31022/2015/V3RL

No. 1 OF 3 PLANS  
 ASCON GRID NUMBER

REV. **B**

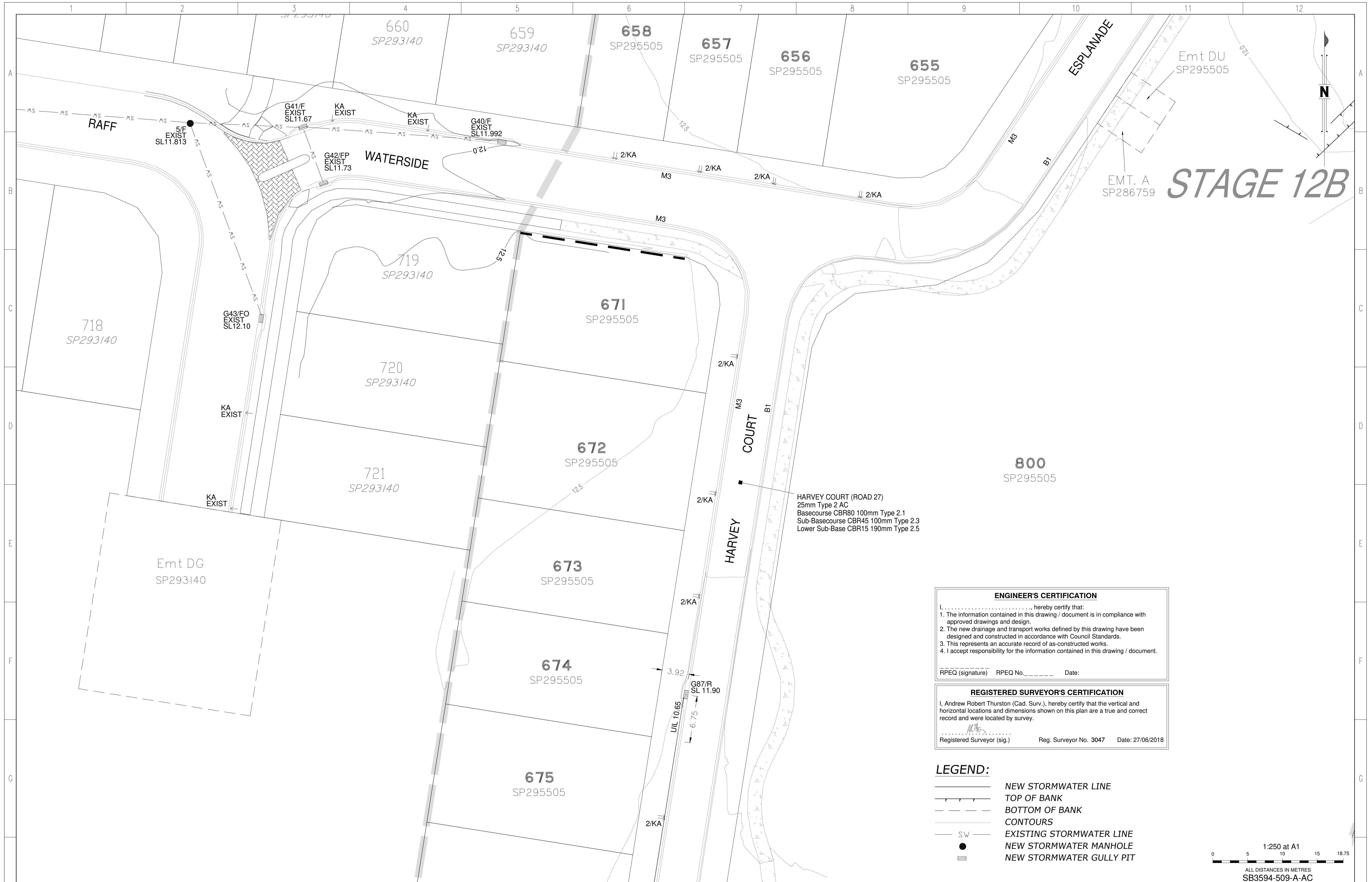

# STAGE 12B

**ENGINEER'S CERTIFICATION**  
 I, \_\_\_\_\_, hereby certify that:  
 1. The information contained in this drawing / document is in compliance with approved drawings and design.  
 2. The new drainage and transport works defined by this drawing have been designed and constructed in accordance with Council Standards.  
 3. This represents an accurate record of as-constructed works.  
 4. I accept responsibility for the information contained in this drawing / document.  
 RPEQ (signature) RPEQ No. \_\_\_\_\_ Date: \_\_\_\_\_

**REGISTERED SURVEYOR'S CERTIFICATION**  
 I, Andrew Robert Thurston (Cad. Surv.), hereby certify that the vertical and horizontal locations and dimensions shown on this plan are a true and correct record and were located by survey.  
 \_\_\_\_\_  
 Registered Surveyor (sig.) Reg. Surveyor No. 3047 Date: 27/06/2018

- LEGEND:**
- NEW STORMWATER LINE
  - TOP OF BANK
  - - - BOTTOM OF BANK
  - CONTOURS
  - SW — EXISTING STORMWATER LINE
  - NEW STORMWATER MANHOLE
  - ≡ NEW STORMWATER GULLY PIT

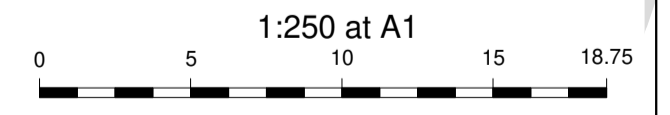

DRAWING REVISIONS		REFERENCE DRAWINGS		DESIGN FILE No.	DESIGNED	
REV.	REVISION DESCRIPTION	DRG. No.	DESCRIPTION	CONSTRUCT. No.	DATE	
A	AS CONSTRUCTED				DRAWN	KM
B	MINOR AMENDMENTS				DATE	27.06.2018
					CHECKED	ADH
					DATE	27.06.2018

**THIS WORK WAS PREPARED BY:**

**WOLTER**  
 consulting group

SCALE 1:250 ORIGINAL SIZE A1



MORETON BAY REGIONAL COUNCIL  
 CABOOLTURE DISTRICT OFFICE  
 2 HASKING STREET CABOOLTURE QLD 4510  
 PO BOX 159 CABOOLTURE QLD 4510  
 Telephone: (07) 5433 0100  
 Fax: (07) 5433 4000

**RIVERBANK**  
 STAGE 12B  
 AS CONSTRUCTED  
 ROADS AND DRAINAGE

ALL DISTANCES IN METRES  
**SB3594-509-A-AC**

CSC SUBDIVISION REFERENCE	
DA/31022/2015/V3RL	
No. 2 OF 3 PLANS	
ASCAN GRID NUMBER	REV.
	B

**ENGINEER'S CERTIFICATION**  
 I, \_\_\_\_\_, hereby certify that:  
 1. The information contained in this drawing / document is in compliance with approved drawings and design.  
 2. The new drainage and transport works defined by this drawing have been designed and constructed in accordance with Council Standards.  
 3. This represents an accurate record of as-constructed works.  
 4. I accept responsibility for the information contained in this drawing / document.

RPEQ (signature) RPEQ No. \_\_\_\_\_ Date: \_\_\_\_\_

**REGISTERED SURVEYOR'S CERTIFICATION**  
 I, Andrew Robert Thurston (Cad. Surv.), hereby certify that the vertical and horizontal locations and dimensions shown on this plan are a true and correct record and were located by survey.

Registered Surveyor (sig.) Reg. Surveyor No. 3047 Date: 27/06/2018

- LEGEND:**
- NEW STORMWATER LINE
  - TOP OF BANK
  - BOTTOM OF BANK
  - CONTOURS
  - SW — EXISTING STORMWATER LINE
  - NEW STORMWATER MANHOLE
  - ≡ NEW STORMWATER GULLY PIT

Emt DS  
 SP295505

Emt.BX  
 SP257102

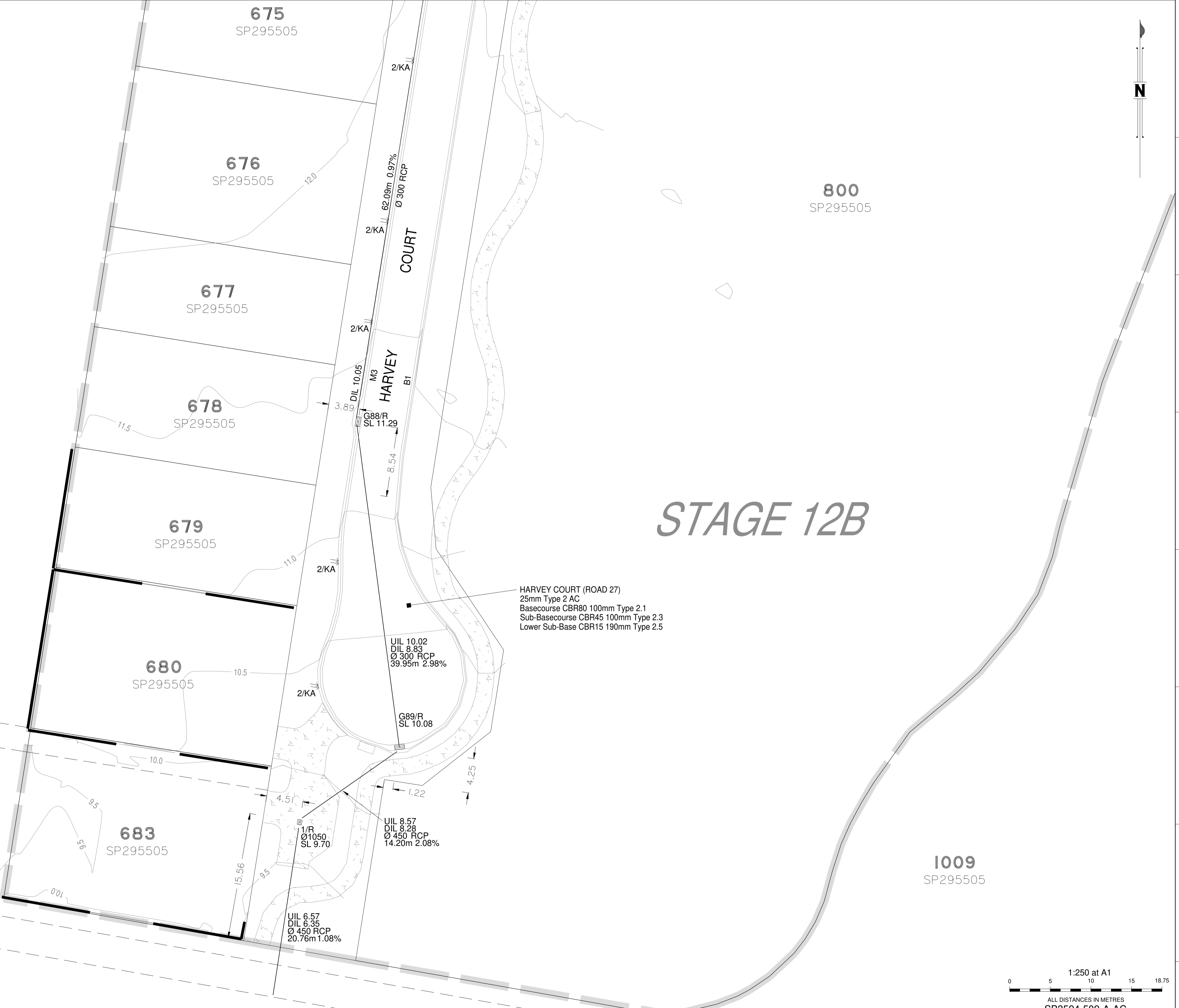

**STAGE 12B**

HARVEY COURT (ROAD 27)  
 25mm Type 2 AC  
 Basecourse CBR80 100mm Type 2.1  
 Sub-Basecourse CBR45 100mm Type 2.3  
 Lower Sub-Base CBR15 190mm Type 2.5

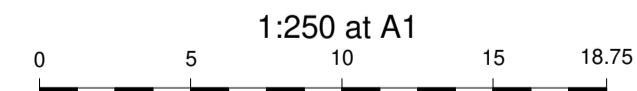

ALL DISTANCES IN METRES  
**SB3594-509-A-AC**

DRAWING REVISIONS		REFERENCE DRAWINGS		DESIGN FILE No.	DESIGNED	
REV.	REVISION DESCRIPTION	DRG. No.	DESCRIPTION	CONSTRUCT. No.	DATE	
A	AS CONSTRUCTED					
B	MINOR AMENDMENTS					

FIELD BOOK	LOG BOOK	LEVEL DATUM	DATUM	Lev. datum	DATE
					27.06.2018

**THIS WORK WAS PREPARED BY:**



MORETON BAY REGIONAL COUNCIL  
 CABOOLTURE DISTRICT OFFICE  
 2 HASKING STREET CABOOLTURE QLD 4510  
 PO BOX 159 CABOOLTURE QLD 4510  
 Telephone: (07) 5433 0100  
 Fax: (07) 5433 4000

**RIVERBANK**  
**STAGE 12B**  
**AS CONSTRUCTED**  
**ROADS AND DRAINAGE**

CSC SUBDIVISION REFERENCE	
DA/31022/2015/V3RL	
No. 3 OF 3 PLANS	
ASCAN GRID NUMBER	REV.
-	B

SCALE 1:250 ORIGINAL SIZE A1

PSM191027  
 E: 495937.616  
 N: 7003052.339  
 RL: 8.767m

**LEGEND:**

- NEW SEWER MAIN
- EXISTING SEWER MAIN
- NEW HOUSE CONNECTION
- SEWER MAINTENANCE HOLE
- SEWER MAINTENANCE SHAFT U.N.O.
- SEWER EOL

**NOTE:**

- ALL SEWER MAINS DN160 PE100 CLASS SDR21 U.N.O.
- ALL MAINTENANCE HOLES (MH) 1200Ø CONCRETE INSITU U.N.O.
- ALL MAINTENANCE SHAFTS (MS) 600Ø SERVICESTREAM PE100

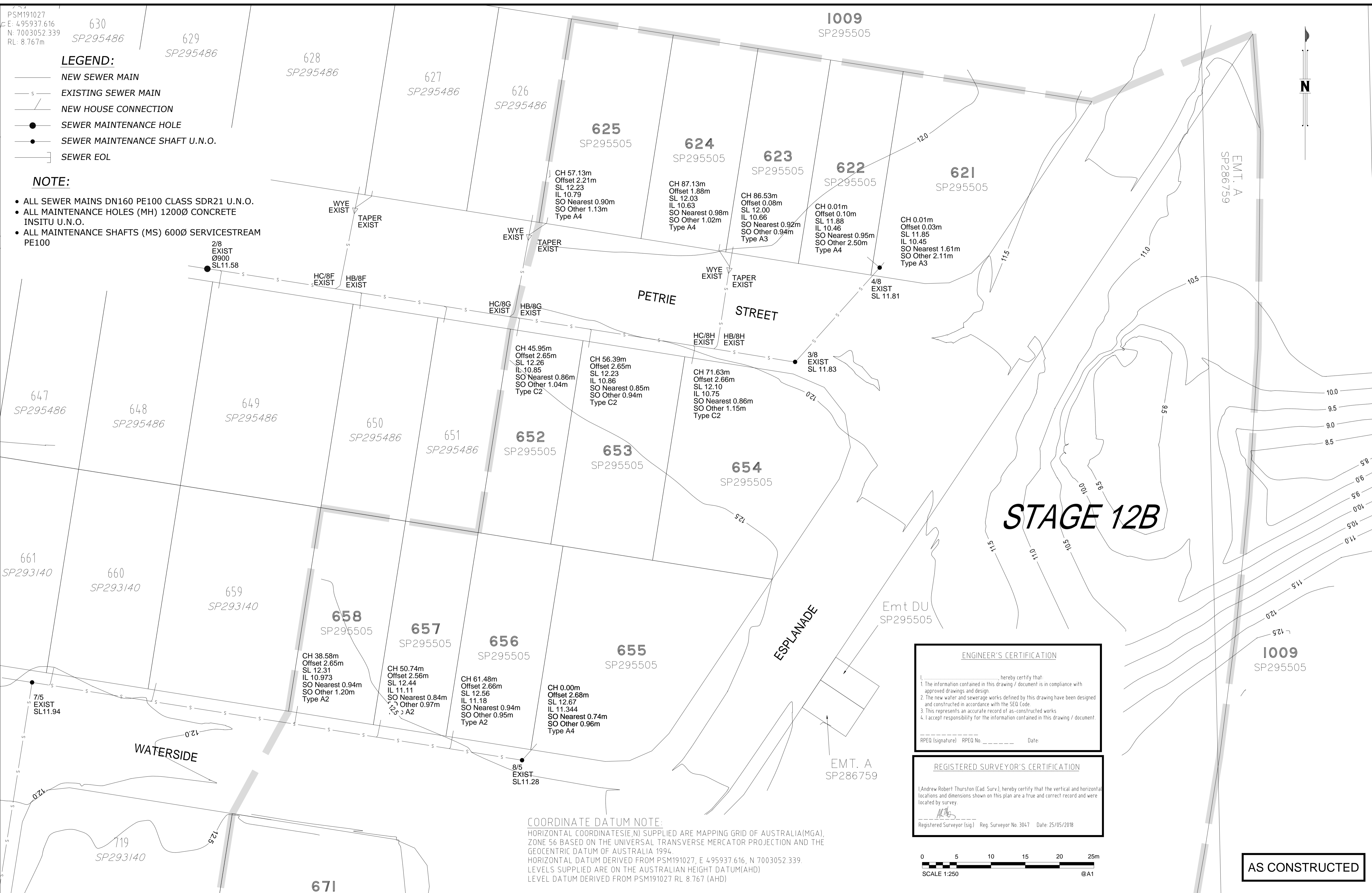

**STAGE 12B**

**ENGINEER'S CERTIFICATION**

I, \_\_\_\_\_, hereby certify that:  
 1. The information contained in this drawing / document is in compliance with approved drawings and design.  
 2. The new water and sewerage works defined by this drawing have been designed and constructed in accordance with the SEQ Code.  
 3. This represents an accurate record of as-constructed works.  
 4. I accept responsibility for the information contained in this drawing / document.

RPEQ (signature) RPEQ No. \_\_\_\_\_ Date: \_\_\_\_\_

**REGISTERED SURVEYOR'S CERTIFICATION**

(Andrew Robert Thurston (Cad. Surv.), hereby certify that the vertical and horizontal locations and dimensions shown on this plan are a true and correct record and were located by survey.

*AT*  
 Registered Surveyor (sig) Reg. Surveyor No. 3047 Date: 25/05/2018

**COORDINATE DATUM NOTE:**  
 HORIZONTAL COORDINATES(E,N) SUPPLIED ARE MAPPING GRID OF AUSTRALIA(MGA), ZONE 56 BASED ON THE UNIVERSAL TRANSVERSE MERCATOR PROJECTION AND THE GEOCENTRIC DATUM OF AUSTRALIA 1994.  
 HORIZONTAL DATUM DERIVED FROM PSM191027, E 495937.616, N 7003052.339.  
 LEVELS SUPPLIED ARE ON THE AUSTRALIAN HEIGHT DATUM(AHD)  
 LEVEL DATUM DERIVED FROM PSM191027 RL 8.767 (AHD)

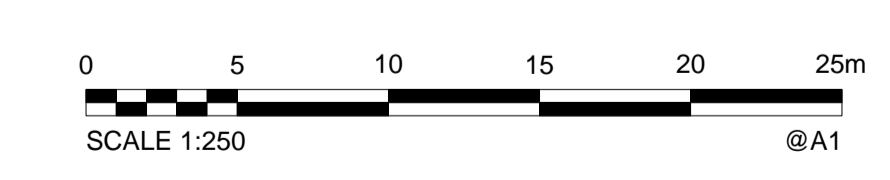

**AS CONSTRUCTED**

<b>A1</b>	0	25/05/2018	As Constructed	JTC	ADH	AT	PASSED	AT	25/05/2018
	INDEX	DATE	REVISIONS	DRAWN	CHECKED	PASSED	INITIALS	DATE	

**WOLTER consulting group**

Planning Urban Design Landscape Environment Surveying

Brisbane, Level 2, 1 Breakfast Ck Road, Newstead, QLD 4006 Phone: (07) 3666 5200



**Unitywater**

16-002635  
 RIVERBANK - STAGE 12B  
 As-Constructed Sewer Reticulation  
 DA/31022/2015/V3RL

SHEET 1 OF 5 SHEETS	SCALE 1:250
REVISION DATE 25/05/2018	REVISION 0
DISCIPLINE CODE C	
DRAWING NO. U-2018-0663	

PSM191027  
 E: 495937.616  
 N: 7003052.339  
 RL: 8.767m



# STAGE 12B

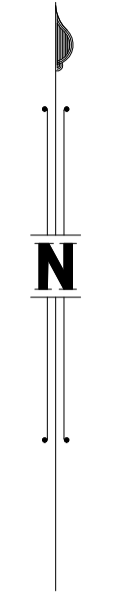

### LEGEND:

- NEW SEWER MAIN
- EXISTING SEWER MAIN
- NEW HOUSE CONNECTION
- SEWER MAINTENANCE HOLE
- SEWER MAINTENANCE SHAFT U.N.O.
- SEWER EOL

### NOTE:

- ALL SEWER MAINS DN160 PE100 CLASS SDR21 U.N.O.
- ALL MAINTENANCE HOLES (MH) 1200Ø CONCRETE INSITU U.N.O.
- ALL MAINTENANCE SHAFTS (MS) 600Ø SERVICESTREAM PE100

**ENGINEER'S CERTIFICATION**  
 I, \_\_\_\_\_, hereby certify that:  
 1. The information contained in this drawing / document is in compliance with approved drawings and design.  
 2. The new water and sewerage works defined by this drawing have been designed and constructed in accordance with the SEQ Code.  
 3. This represents an accurate record of as-constructed works.  
 4. I accept responsibility for the information contained in this drawing / document.  
 RPEQ (signature) RPEQ No. \_\_\_\_\_ Date: \_\_\_\_\_

**REGISTERED SURVEYOR'S CERTIFICATION**  
 I, Andrew Robert Thurston (Cad. Surv.), hereby certify that the vertical and horizontal locations and dimensions shown on this plan are a true and correct record and were located by survey.  
 Registered Surveyor (sig) Reg. Surveyor No. 3047 Date: 25/05/2018

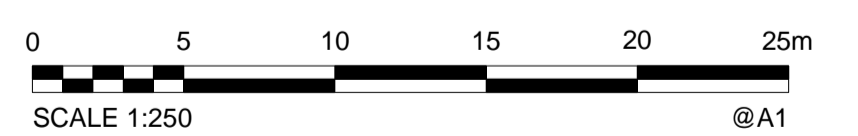

**COORDINATE DATUM NOTE:**  
 HORIZONTAL COORDINATES (E, N) SUPPLIED ARE MAPPING GRID OF AUSTRALIA (MGA), ZONE 56 BASED ON THE UNIVERSAL TRANSVERSE MERCATOR PROJECTION AND THE GEOCENTRIC DATUM OF AUSTRALIA 1994.  
 HORIZONTAL DATUM DERIVED FROM PSM191027, E 495937.616, N 7003052.339.  
 LEVELS SUPPLIED ARE ON THE AUSTRALIAN HEIGHT DATUM (AHD).  
 LEVEL DATUM DERIVED FROM PSM191027 RL 8.767 (AHD).

**AS CONSTRUCTED**

<b>A1</b>	0	25/05/2018	As Constructed	JTC	ADH	AT	PASSED	AT	25/05/2018
	INDEX	DATE	REVISIONS	DRAWN	CHECKED	PASSED	INITIALS	DATE	

**WOLTER consulting group**  
 Planning Urban Design Landscape Environment Surveying  
 Brisbane Level 2, 1 Breakfast Ck Road, Newstead, QLD 4006 Phone: (07) 3666 5200



**Unitywater**  
 16-002635  
 RIVERBANK - STAGE 12B  
 As-Constructed Sewer Reticulation  
 DA/31022/2015/V3RL

SHEET 2 OF 5 SHEETS	SCALE 1:250
REVISION DATE 25/05/2018	REVISION 0
DISCIPLINE CODE C	
DRAWING NO. U-2018-0663	



# STAGE 12B

- LEGEND:**
- NEW SEWER MAIN
  - s- EXISTING SEWER MAIN
  - NEW HOUSE CONNECTION
  - SEWER MAINTENANCE HOLE
  - SEWER MAINTENANCE SHAFT U.N.O.
  - SEWER EOL

- NOTE:**
- ALL SEWER MAINS DN160 PE100 CLASS SDR21 U.N.O.
  - ALL MAINTENANCE HOLES (MH) 1200Ø CONCRETE INSITU U.N.O.
  - ALL MAINTENANCE SHAFTS (MS) 600Ø SERVICESTREAM PE100

**COORDINATE DATUM NOTE:**  
 HORIZONTAL COORDINATES (E, N) SUPPLIED ARE MAPPING GRID OF AUSTRALIA (MGA), ZONE 56 BASED ON THE UNIVERSAL TRANSVERSE MERCATOR PROJECTION AND THE GEOCENTRIC DATUM OF AUSTRALIA 1994.  
 HORIZONTAL DATUM DERIVED FROM PSM191027, E 495937 616, N 7003052 339.  
 LEVELS SUPPLIED ARE ON THE AUSTRALIAN HEIGHT DATUM (AHD)  
 LEVEL DATUM DERIVED FROM PSM191027 RL 8.767 (AHD)

**ENGINEER'S CERTIFICATION**

I, \_\_\_\_\_, hereby certify that:  
 1. The information contained in this drawing / document is in compliance with approved drawings and design.  
 2. The new water and sewerage works defined by this drawing have been designed and constructed in accordance with the SED Code.  
 3. This represents an accurate record of as-constructed works.  
 4. I accept responsibility for the information contained in this drawing / document.

RPEQ (Signature) RPEQ No. \_\_\_\_\_ Date: \_\_\_\_\_

**REGISTERED SURVEYOR'S CERTIFICATION**

I, Andrew Robert Thurston (Cad. Surv.), hereby certify that the vertical and horizontal locations and dimensions shown on this plan are a true and correct record and were located by survey.

Registered Surveyor (Sig) Reg. Surveyor No. 3047 Date: 25/05/2018

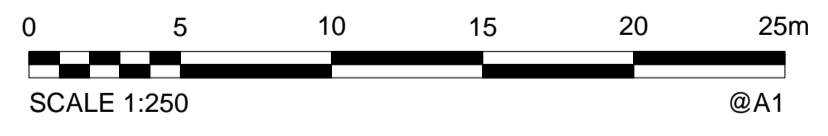

**AS CONSTRUCTED**

<b>A1</b>	0	25/05/2018	As Constructed	JTC	ADH	AT	PASSED	AT	25/05/2018
	INDEX	DATE	REVISIONS	DRAWN	CHECKED	PASSED	INITIALS	DATE	

**WOLTER consulting group**

Planning Urban Design Landscape Environment Surveying

Brisbane Level 2, 1 Breakfast Ck Road, Newstead, QLD 4006 Phone: (07) 3666 5200



**Unitywater**

16-002635  
 RIVERBANK - STAGE 12B  
 As-Constructed Sewer Reticulation  
 DA/31022/2015/V3RL

SHEET 3 OF 5 SHEETS	SCALE 1:250
REVISION DATE 25/05/2018	REVISION 0
DISCIPLINE CODE C	
DRAWING NO. U-2018-0663	

PSM191027  
 E: 495937.616  
 N: 7003052.339  
 RL: 8.767m

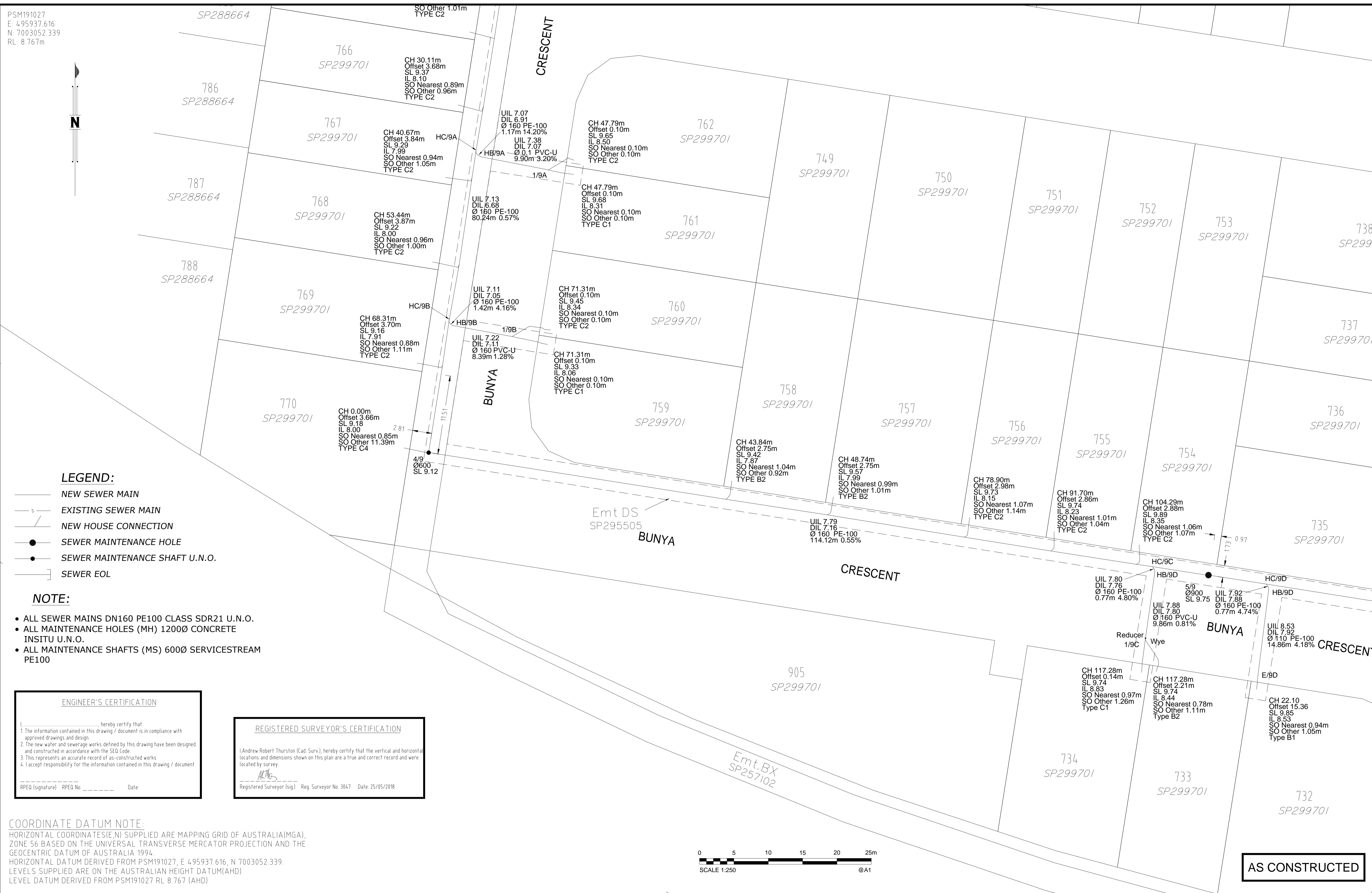

**LEGEND:**

- NEW SEWER MAIN
- EXISTING SEWER MAIN
- NEW HOUSE CONNECTION
- SEWER MAINTENANCE HOLE
- SEWER MAINTENANCE SHAFT U.N.O.
- SEWER EOL

**NOTE:**

- ALL SEWER MAINS DN160 PE100 CLASS SDR21 U.N.O.
- ALL MAINTENANCE HOLES (MH) 1200Ø CONCRETE INSITU U.N.O.
- ALL MAINTENANCE SHAFTS (MS) 600Ø SERVICESTREAM PE100

**ENGINEER'S CERTIFICATION**

I, \_\_\_\_\_, hereby certify that:  
 1. The information contained in this drawing / document is in compliance with approved drawings and design.  
 2. The new water and sewerage works defined by this drawing have been designed and constructed in accordance with the SEQ Code.  
 3. This represents an accurate record of as-constructed works.  
 4. I accept responsibility for the information contained in this drawing / document.

RPEQ (signature) RPEQ No. \_\_\_\_\_ Date: \_\_\_\_\_

**REGISTERED SURVEYOR'S CERTIFICATION**

I, Andrew Robert Thurston (Cad. Surv.), hereby certify that the vertical and horizontal locations and dimensions shown on this plan are a true and correct record and were located by survey.

Registered Surveyor (sig) Reg. Surveyor No. 3047 Date: 25/05/2018

**COORDINATE DATUM NOTE:**

HORIZONTAL COORDINATES (E, N) SUPPLIED ARE MAPPING GRID OF AUSTRALIA (MGA), ZONE 56 BASED ON THE UNIVERSAL TRANSVERSE MERCATOR PROJECTION AND THE GEOCENTRIC DATUM OF AUSTRALIA 1994.  
 HORIZONTAL DATUM DERIVED FROM PSM191027, E 495937.616, N 7003052.339.  
 LEVELS SUPPLIED ARE ON THE AUSTRALIAN HEIGHT DATUM (AHD)  
 LEVEL DATUM DERIVED FROM PSM191027 RL 8.767 (AHD)

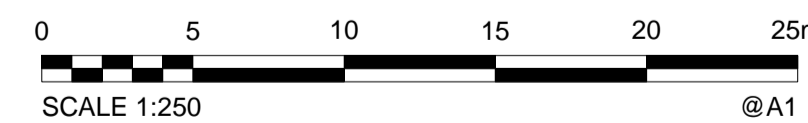

**AS CONSTRUCTED**

A1	0	25/05/2018	As Constructed	JTC	ADH	AT	DRAWN	CHECKED	PASSED
	INDEX	DATE	REVISIONS	DRAWN	CHECKED	PASSED	INITIALS	DATE	

**WOLTER consulting group**  
 Planning Urban Design Landscape Environment Surveying  
 Brisbane Level 2, 1 Breakfast Ck Road, Newstead, QLD 4006 Phone: (07) 3666 5200



**Unitywater**  
 16-002635  
 RIVERBANK - STAGE 12B  
 As-Constructed Sewer Reticulation  
 DA/31022/2015/V3RL

SHEET 1 OF 5 SHEETS	SCALE 1:250
REVISION DATE 25/05/2018	REVISION 0
DISCIPLINE CODE C	
DRAWING NO. U-2018-0663	

PSM191027  
 E: 495937.616  
 N: 7003052.339  
 RL: 8.767m

**LEGEND:**

- NEW SEWER MAIN
- EXISTING SEWER MAIN
- NEW HOUSE CONNECTION
- SEWER MAINTENANCE HOLE
- SEWER MAINTENANCE SHAFT U.N.O.
- SEWER EOL

**NOTE:**

- ALL SEWER MAINS DN160 PE100 CLASS SDR21 U.N.O.
- ALL MAINTENANCE HOLES (MH) 1200Ø CONCRETE INSITU U.N.O.
- ALL MAINTENANCE SHAFTS (MS) 600Ø SERVICESTREAM PE100

**ENGINEER'S CERTIFICATION**

I, \_\_\_\_\_, hereby certify that:  
 1. The information contained in this drawing / document is in compliance with approved drawings and design.  
 2. The new water and sewerage works defined by this drawing have been designed and constructed in accordance with the SED Code.  
 3. This represents an accurate record of as-constructed works.  
 4. I accept responsibility for the information contained in this drawing / document.

RPEQ (signature) RPEQ No. \_\_\_\_\_ Date: \_\_\_\_\_

**REGISTERED SURVEYOR'S CERTIFICATION**

I, Andrew Robert Thurston (Cad. Surv.), hereby certify that the vertical and horizontal locations and dimensions shown on this plan are a true and correct record and were located by survey.

Registered Surveyor (Sig) Reg. Surveyor No. 3047 Date: 25/05/2018



**AS CONSTRUCTED**

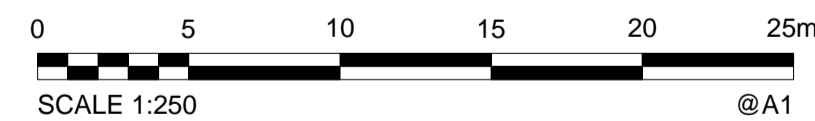

**COORDINATE DATUM NOTE:**

HORIZONTAL COORDINATES (E,N) SUPPLIED ARE MAPPING GRID OF AUSTRALIA (MGA), ZONE 56 BASED ON THE UNIVERSAL TRANSVERSE MERCATOR PROJECTION AND THE GEOCENTRIC DATUM OF AUSTRALIA 1994.  
 HORIZONTAL DATUM DERIVED FROM PSM191027, E 495937.616, N 7003052.339.  
 LEVELS SUPPLIED ARE ON THE AUSTRALIAN HEIGHT DATUM (AHD)  
 LEVEL DATUM DERIVED FROM PSM191027 RL 8.767 (AHD)



A1	0	25/05/2018	As Constructed	JTC	ADH	AT	PASSED	AT	25/05/2018
	INDEX	DATE	REVISIONS	DRAWN	CHECKED	PASSED	INITIALS	DATE	

**WOLTER consulting group**

Planning Urban Design Landscape Environment Surveying

Brisbane Level 2, 1 Breakfast Ck Road, Newstead, QLD 4006 Phone: (07) 3666 5200



**Unitywater**

16-002635  
 RIVERBANK - STAGE 12B  
 As-Constructed Sewer Reticulation  
 DA/31022/2015/V3RL

SHEET 1 OF 5 SHEETS	SCALE 1:250
REVISION DATE 25/05/2018	REVISION 0
DISCIPLINE CODE C	
DRAWING NO. U-2018-0663	



PSM191027  
 E: 495937.616  
 N: 7003052.339  
 RL: 8.767m

**LEGEND:**

- 150W NEW Ø150 PVC-U CLASS PN16 WATERMAIN
- 100W NEW Ø100 PVC-U CLASS PN16 WATERMAIN
- HC NEW READY TAP HOUSE CONNECTION
- FH NEW HYDRANT
- SV NEW SLUICE VALVE
- EOL NEW END CAP
- C NEW WATER SERVICE CONDUIT 100Ø PVC-O
- W EXISTING WATER MAIN
- WM NEW WATER SERVICE CONNECTION 20mm MANUFACTURER - ELSTER
- DICL WATERMAIN

**COORDINATE DATUM NOTE:**

HORIZONTAL COORDINATES(E,N) SUPPLIED ARE MAPPING GRID OF AUSTRALIA(MGA), ZONE 56 BASED ON THE UNIVERSAL TRANSVERSE MERCATOR PROJECTION AND THE GEOCENTRIC DATUM OF AUSTRALIA 1994.  
 HORIZONTAL DATUM DERIVED FROM PSM191027, E 495937.616, N 7003052.339.  
 LEVELS SUPPLIED ARE ON THE AUSTRALIAN HEIGHT DATUM(AHD)  
 LEVEL DATUM DERIVED FROM PSM191027 RL 8.767 (AHD)

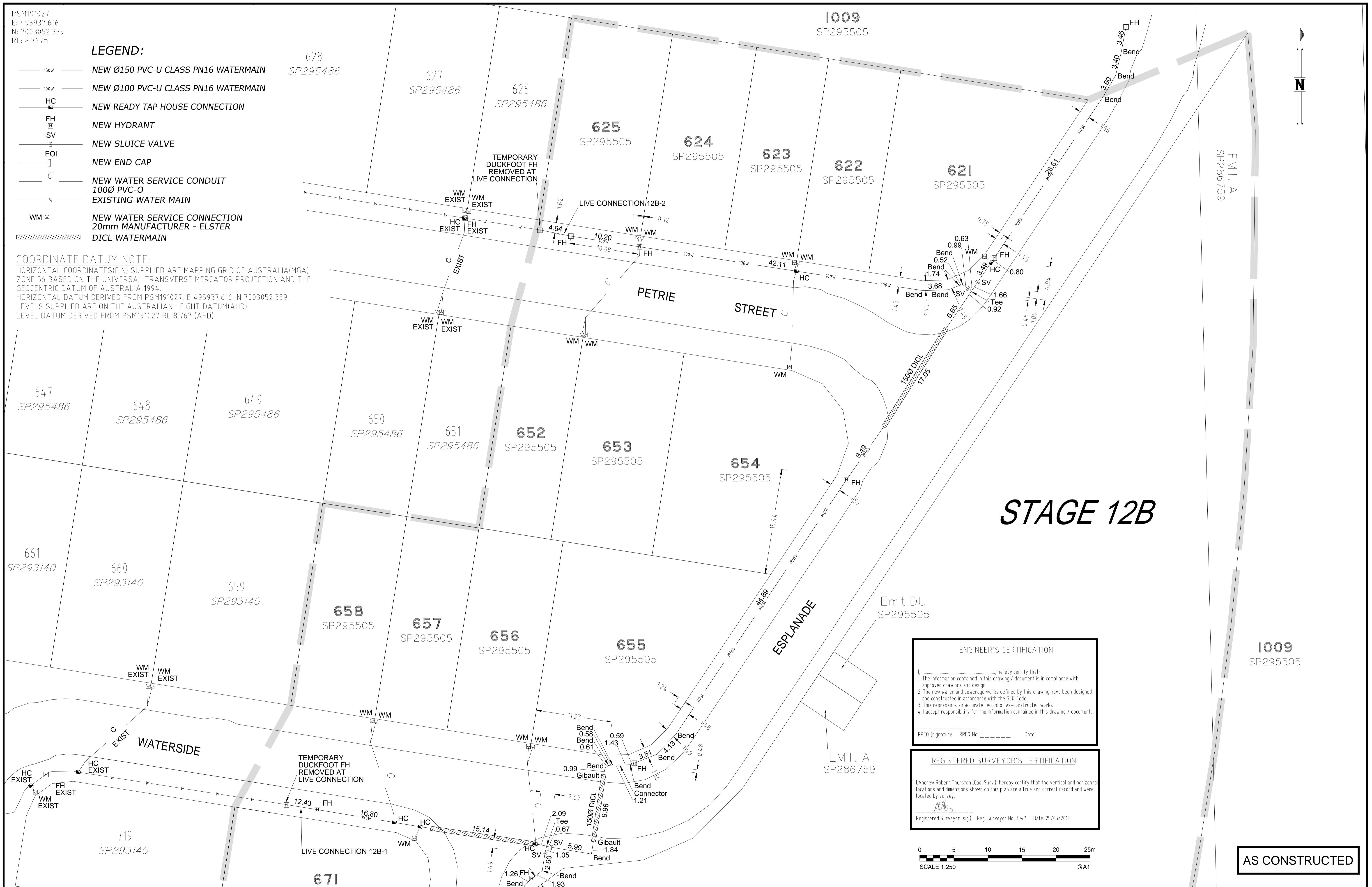

**STAGE 12B**

**ENGINEER'S CERTIFICATION**

I, \_\_\_\_\_, hereby certify that:  
 1. The information contained in this drawing / document is in compliance with approved drawings and design.  
 2. The new water and sewerage works defined by this drawing have been designed and constructed in accordance with the SEQ Code.  
 3. This represents an accurate record of as-constructed works  
 4. I accept responsibility for the information contained in this drawing / document.

RPEQ (Signature) RPEQ No. \_\_\_\_\_ Date: \_\_\_\_\_

**REGISTERED SURVEYOR'S CERTIFICATION**

I, Andrew Robert Thurston (Cad. Surv.), hereby certify that the vertical and horizontal locations and dimensions shown on this plan are a true and correct record and were located by survey.

Registered Surveyor (Sig) Reg. Surveyor No. 3047 Date: 25/05/2018

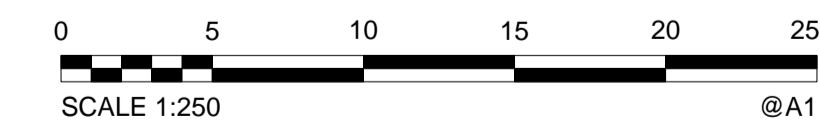

**AS CONSTRUCTED**

<b>A1</b>	0	25/05/2018	As Constructed	JTC	ADH	AT
	INDEX	DATE	REVISIONS	DRAWN	CHECKED	PASSED

DRAWN	JTC	25/05/2018
CHECKED	ADH	25/05/2018
PASSED	AT	25/05/2018
INITIALS	DATE	

**WOLTER consulting group**

Planning Urban Design Landscape Environment Surveying

Brisbane, Level 2, 1 Breakfast Ck Road, Newstead, QLD 4006 Phone: (07) 3666 5200









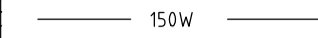
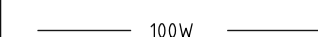

**Unitywater**

16-002635  
 RIVERBANK - STAGE 12B  
 As-Constructed Water Reticalation  
 DA/31022/2015/V3RL

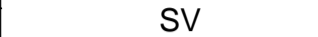
SHEET 1 OF 3 SHEETS	SCALE 1:250
REVISION DATE 25/05/2018	REVISION 0
DISCIPLINE CODE C	
DRAWING NO. U-2018-0663	

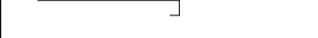
PSM191027  
 E: 495937.616  
 N: 7003052.339  
 RL: 8.767m

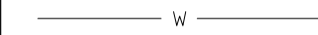
**LEGEND:**

-  NEW Ø150 PVC-U CLASS PN16 WATERMAIN
-  NEW Ø100 PVC-U CLASS PN16 WATERMAIN
-  NEW READY TAP HOUSE CONNECTION
-  NEW HYDRANT
-  NEW SLUICE VALVE
-  NEW END CAP
-  NEW WATER SERVICE CONDUIT 100Ø PVC-O
-  EXISTING WATER MAIN
-  NEW WATER SERVICE CONNECTION 20mm MANUFACTURER - ELSTER
-  DICL WATERMAIN

**COORDINATE DATUM NOTE:**

HORIZONTAL COORDINATES(E,N) SUPPLIED ARE MAPPING GRID OF AUSTRALIA(MGA), ZONE 56 BASED ON THE UNIVERSAL TRANSVERSE MERCATOR PROJECTION AND THE GEOCENTRIC DATUM OF AUSTRALIA 1994.  
 HORIZONTAL DATUM DERIVED FROM PSM191027, E 495937.616, N 7003052.339.  
 LEVELS SUPPLIED ARE ON THE AUSTRALIAN HEIGHT DATUM(AHD)  
 LEVEL DATUM DERIVED FROM PSM191027 RL 8.767 (AHD)



**STAGE 12B**

**ENGINEER'S CERTIFICATION**

I, \_\_\_\_\_, hereby certify that:  
 1. The information contained in this drawing / document is in compliance with approved drawings and design.  
 2. The new water and sewerage works defined by this drawing have been designed and constructed in accordance with the SEQ Code.  
 3. This represents an accurate record of as-constructed works  
 4. I accept responsibility for the information contained in this drawing / document.

RPEQ (signature) RPEQ No. \_\_\_\_\_ Date: \_\_\_\_\_

**REGISTERED SURVEYOR'S CERTIFICATION**

I, Andrew Robert Thurston (Cad. Surv.), hereby certify that the vertical and horizontal locations and dimensions shown on this plan are a true and correct record and were located by survey.

*ATG*  
 Registered Surveyor (sig) Reg. Surveyor No. 3047 Date: 25/05/2018



**AS CONSTRUCTED**

<b>A1</b>	0	25/05/2018	As Constructed	JTC	ADH	AT	DRAWN	CHECKED	PASSED
	INDEX	DATE	REVISIONS	DRAWN	CHECKED	PASSED	INITIALS	DATE	

**WOLTER consulting group**

Planning Urban Design Landscape Environment Surveying

Brisbane: Level 2, 1 Breakfast Ck Road, Newstead, QLD 4006 Phone: (07) 3666 5200











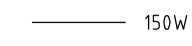

**Unitywater**

16-002635  
 RIVERBANK - STAGE 12B  
 As-Constructed Water Reticulation  
 DA/31022/2015/V3RL

SHEET 2 OF 3 SHEETS	SCALE 1:250
REVISION DATE 25/05/2018	REVISION 0
DISCIPLINE CODE C	
DRAWING NO. U-2018-0663	

PSM191027  
 E: 495937.616  
 N: 7003052.339  
 RL: 8.767m

**LEGEND:**

-  NEW Ø150 PVC-U CLASS PN16 WATERMAIN
-  NEW Ø100 PVC-U CLASS PN16 WATERMAIN
-  NEW READY TAP HOUSE CONNECTION
-  NEW HYDRANT
-  NEW SLUICE VALVE
-  NEW END CAP
-  NEW WATER SERVICE CONDUIT 100Ø PVC-O
-  EXISTING WATER MAIN
-  NEW WATER SERVICE CONNECTION 20mm MANUFACTURER - ELSTER
-  DICL WATERMAIN

**COORDINATE DATUM NOTE:**

HORIZONTAL COORDINATES (E, N) SUPPLIED ARE MAPPING GRID OF AUSTRALIA (MGA), ZONE 56 BASED ON THE UNIVERSAL TRANSVERSE MERCATOR PROJECTION AND THE GEOCENTRIC DATUM OF AUSTRALIA 1994.  
 HORIZONTAL DATUM DERIVED FROM PSM191027, E 495937.616, N 7003052.339.  
 LEVELS SUPPLIED ARE ON THE AUSTRALIAN HEIGHT DATUM (AHD).  
 LEVEL DATUM DERIVED FROM PSM191027 RL 8.767 (AHD)



**ENGINEER'S CERTIFICATION**

I, \_\_\_\_\_, hereby certify that:

- The information contained in this drawing / document is in compliance with approved drawings and design.
- The new water and sewerage works defined by this drawing have been designed and constructed in accordance with the SEQ Code.
- This represents an accurate record of as-constructed works.
- I accept responsibility for the information contained in this drawing / document.

RPED (signature) RPED No. \_\_\_\_\_ Date: \_\_\_\_\_

**REGISTERED SURVEYOR'S CERTIFICATION**

I, Andrew Robert Thurston (Cad. Surv.), hereby certify that the vertical and horizontal locations and dimensions shown on this plan are a true and correct record and were located by survey.

*ATM*  
 Registered Surveyor (sig) Reg. Surveyor No. 3047 Date: 25/05/2018

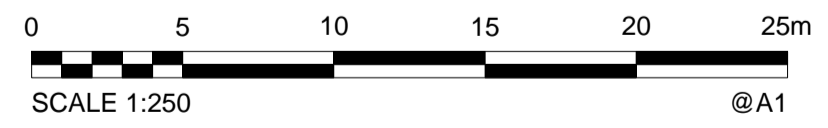

**AS CONSTRUCTED**

<b>A1</b>	0	25/05/2018	As Constructed	JTC	ADH	AT
	INDEX	DATE	REVISIONS	DRAWN	CHECKED	PASSED

DRAWN	JTC	25/05/2018
CHECKED	ADH	25/05/2018
PASSED	AT	25/05/2018
INITIALS	DATE	



**Unitywater**  
 16-002635  
 RIVERBANK - STAGE 12B  
 As-Constructed Water Reticulation  
 DA/31022/2015/V3RL

SHEET 3 OF 3	SHEETS	SCALE 1:250
REVISION DATE	25/05/2018	REVISION 0
DISCIPLINE CODE	C	
DRAWING NO.	U-2018-0663	