

Retaining Wall Lot 2156
 Min Height:- 0.5m
 Max Height:- 1.5m
 Average Height:- 1.0m

Retaining Wall Lot 2156
 Min Height:- 0.3m
 Max Height:- 1.5m
 Average Height:- 0.9m

ADDITIONAL NOTES:

The LOT dimensions and area shown hereon are subject to final field survey and also to the requirements of Council and any other authority which may have requirements under any relevant legislation

Final surface contours shown hereon have been supplied by Colliers.

Location of retaining walls are as shown on Engineering design drawings. Their as-constructed location may differ from their design location. Retaining wall heights have been supplied by Colliers.

Compaction of any fill material placed on this site shall be completed to level one inspection and testing services in accordance with AS3798-2007.

Depth of fill values are calculated to the pre-development surface.

Copyright © Veris Australia Pty Ltd
 06/07/2023.

**FLAGSTONE
 PRECINCT 1 STAGE 5E**
 For
**PEET FLAGSTONE
 CITY PTY LTD**

IMPORTANT NOTES:

(These notes are an integral part of this plan)

This plan has been prepared for PEET FLAGSTONE CITY PTY LTD for the purposes of **A Disclosure Plan Under the Land Sales Act 1984 (as amended)**.

It is not to be used by any other person or corporation or for any other purposes and is subject to the following limitations:

Please refer to the approved Development Application for conditions relating to the LOT and to approved Operational Works drawings for services location and possible easements.

THESE DESIGNS AND DRAWINGS ARE COPYRIGHT AND ARE NOT TO BE USED OR REPRODUCED WITHOUT THE WRITTEN PERMISSION OF VERIS

Data Sources
 Cadastral Boundaries
 30109-LC-Master(D0) F594 2014.dwg
 Engineering Design
 STAGE 5E BASE - 02 05 2023.dwg
 Final Surface Contours
 FLAGSTONE - STAGE 5 - DISCLOSURE INFO - 02 05 2023 - Design Tm.dxf
 Depth of Fill
 FLAGSTONE - STAGE 5 - DISCLOSURE INFO - 02 05 2023 -
 Retaining Wall
 FLAGSTONE - 5 BEW - OPW - DRAFTSET - 27.04.23

Issue/Revisions	Date	By	Drawn
A Original	06.07.2023	BK	

Locality: FLAGSTONE
 Local Authority: LOGAN CITY COUNCIL
 Horizontal Meridian: MGA Zone 56
 Vertical Level Datum: AHD D
 Scale: 1:250 @ A4
 Designed: Colliers
 Drawn: BK 06/07/2023
 Checked: DE 06/07/2023
 Plot Date: 06 Jul, 2023
 Computer File Ref: 30109-SISE-DP-(A).dwg

**DISCLOSURE PLAN
 of Proposed LOT 2156
 being part of
 Lot 911
 on SP335845**



BRISBANE (07) 3686 4700 WHITSUNDAYS (07) 4945 6600

MACKAY (07) 4957 9700 CAIRNS (07) 4252 9400

veris.com.au
 ACN 615 735 727
 Veris Australia Pty Ltd

Drawing No 30109-DP- 2156 Issue A

LEGEND

Final surface contours based on A.H.D. datum at an interval of 0.5m, shown as: — 15.5 —

Where applicable, areas to be filled are shown as:

Depth of fill, in metres, shown as:- + [0.5]

Retaining wall and retaining wall height, shown on the lower side of the wall, have been taken from plans supplied by Colliers and shown as:

Bin Pad Location shown as: *



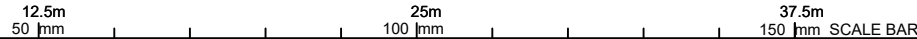
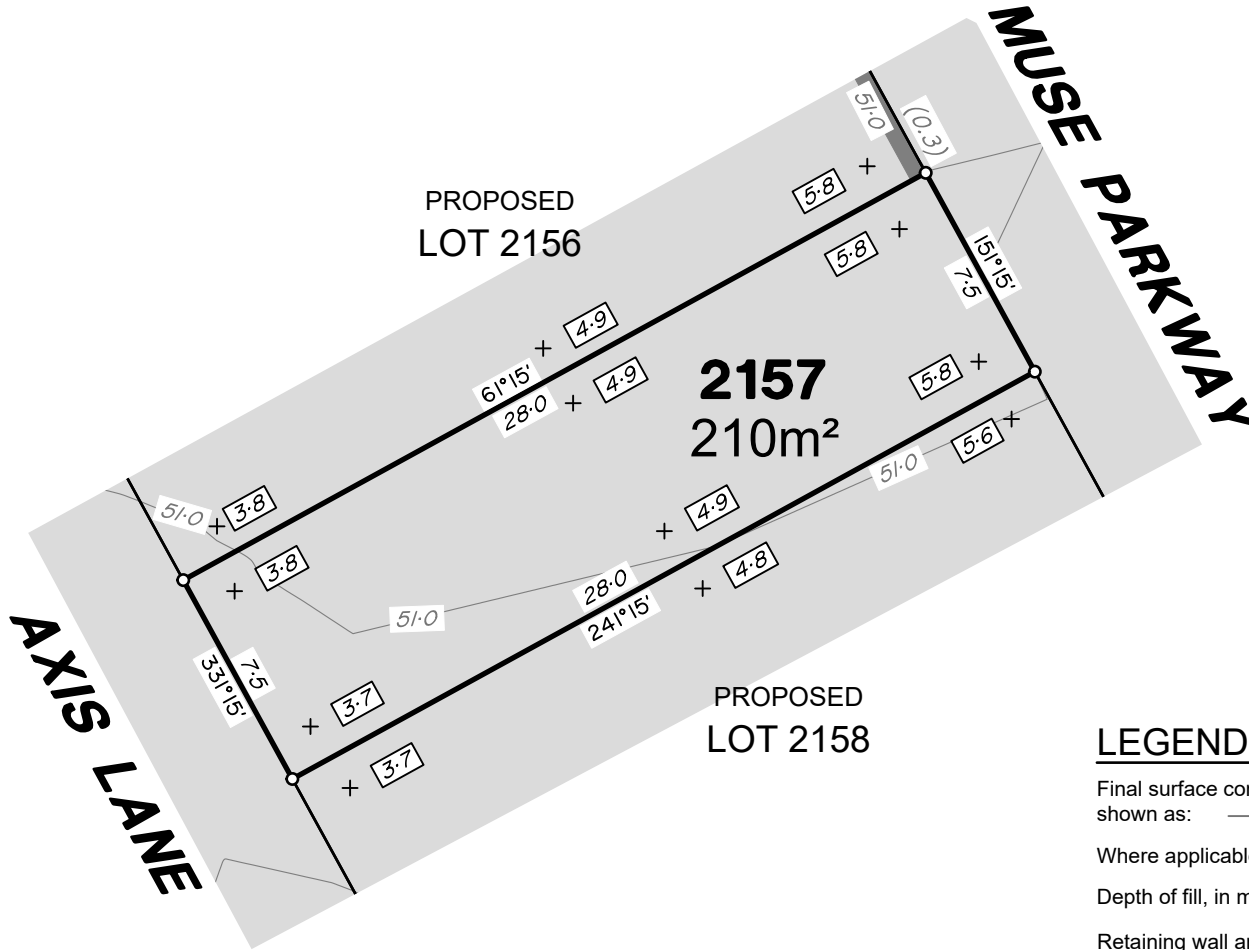

ADDITIONAL NOTES:

The LOT dimensions and area shown hereon are subject to final field survey and also to the requirements of Council and any other authority which may have requirements under any relevant legislation

Final surface contours shown hereon have been supplied by Colliers.

Location of retaining walls are as shown on Engineering design drawings. Their as-constructed location may differ from their design location. Retaining wall heights have been supplied by Colliers.

Compaction of any fill material placed on this site shall be completed to level one inspection and testing services in accordance with AS3798-2007.

Depth of fill values are calculated to the pre-development surface.

Copyright © Veris Australia Pty Ltd
06/07/2023.

LEGEND

Final surface contours based on A.H.D. datum at an interval of 0.5m, shown as: $\text{--- } 15.5 \text{ ---}$

Where applicable, areas to be filled are shown as:

Depth of fill, in metres, shown as: $\text{--- } +[0.5] \text{ ---}$

Retaining wall and retaining wall height, shown on the lower side of the wall, have been taken from plans supplied by Colliers and shown as: $\text{--- } (1.2) \text{ ---}$

Bin Pad Location shown as: *

**FLAGSTONE
PRECINCT 1 STAGE 5E**

For
**PEET FLAGSTONE
CITY PTY LTD**

IMPORTANT NOTES:

(These notes are an integral part of this plan)

This plan has been prepared for PEET FLAGSTONE CITY PTY LTD for the purposes of **A Disclosure Plan Under the Land Sales Act 1984 (as amended).**

It is not to be used by any other person or corporation or for any other purposes and is subject to the following limitations:

Please refer to the approved Development Application for conditions relating to the LOT and to approved Operational Works drawings for services location and possible easements.

THESE DESIGNS AND DRAWINGS ARE COPYRIGHT AND ARE NOT TO BE USED OR REPRODUCED WITHOUT THE WRITTEN PERMISSION OF VERIS

Data Sources

Cadastral Boundaries
30109-LC-Master(D0) F594 2014.dwg
Engineering Design
STAGE 5E BASE - 02 05 2023.dwg

Final Surface Contours

FLAGSTONE - STAGE 5 - DISCLOSURE INFO - 02 05 2023 - Design Tm.dxf

Depth of Fill

FLAGSTONE - STAGE 5 - DISCLOSURE INFO - 02 05 2023 -

Retaining Wall

FLAGSTONE - 5 BEW - OPW - DRAFTSET - 27.04.23

Issue	Revisions	Date	Drawn
A	Original	06.07.2023	BK

Locality: FLAGSTONE
 Local Authority: LOGAN CITY COUNCIL
 Horizontal Meridian: MGA Zone 56
 Vertical Level Datum: AHD D
 Scale: 1:250 @ A4
 Designed: Colliers
 Drawn: BK 06/07/2023
 Checked: DE 06/07/2023
 Plot Date: 06 Jul, 2023
 Computer File Ref: 30109-St5E-DP-(A).dwg

**DISCLOSURE PLAN
of Proposed LOT 2157
being part of
Lot 911
on SP335845**



BRISBANE (07) 3686 4700 WHITSUNDAYS (07) 4945 6600

MACKAY (07) 4957 9700 CAIRNS (07) 4252 9400

veris.com.au
ACN 615 735 727
Veris Australia Pty Ltd

Drawing No
30109-DP- 2157

Issue
A

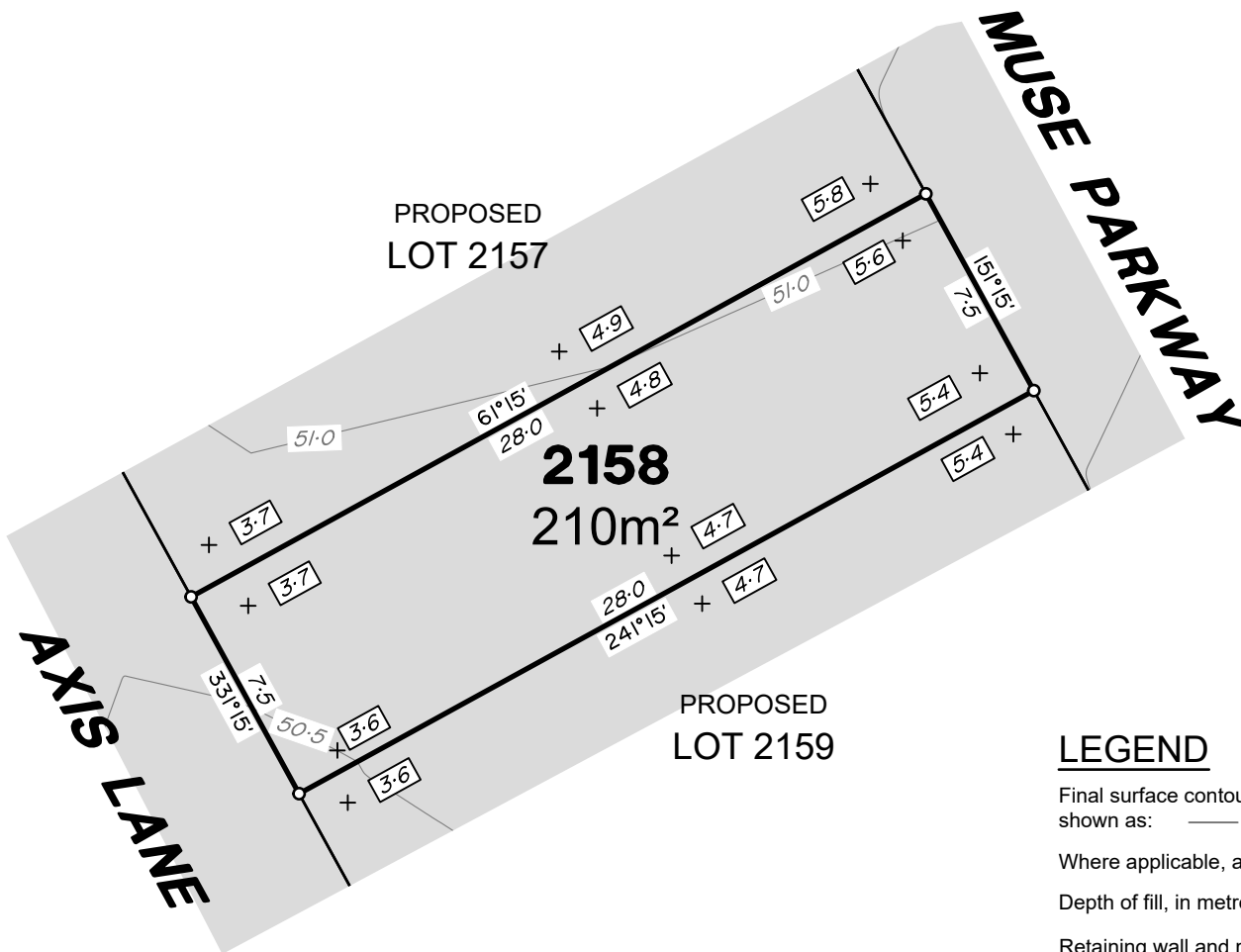

ADDITIONAL NOTES:

The LOT dimensions and area shown hereon are subject to final field survey and also to the requirements of Council and any other authority which may have requirements under any relevant legislation

Final surface contours shown hereon have been supplied by Colliers.

Location of retaining walls are as shown on Engineering design drawings. Their as-constructed location may differ from their design location. Retaining wall heights have been supplied by Colliers.

Compaction of any fill material placed on this site shall be completed to level one inspection and testing services in accordance with AS3798-2007.

Depth of fill values are calculated to the pre-development surface.

Copyright © Veris Australia Pty Ltd
06/07/2023.

LEGEND

Final surface contours based on A.H.D. datum at an interval of 0.5m, shown as: 15.5

Where applicable, areas to be filled are shown as:

Depth of fill, in metres, shown as:- +0.5

Retaining wall and retaining wall height, shown on the lower side of the wall, have been taken from plans supplied by Colliers and shown as: (1.2)

Bin Pad Location shown as:



**FLAGSTONE
PRECINCT 1 STAGE 5E**
For
**PEET FLAGSTONE
CITY PTY LTD**

IMPORTANT NOTES:

(These notes are an integral part of this plan)

This plan has been prepared for PEET FLAGSTONE CITY PTY LTD for the purposes of **A Disclosure Plan Under the Land Sales Act 1984 (as amended)**.

It is not to be used by any other person or corporation or for any other purposes and is subject to the following limitations:

Please refer to the approved Development Application for conditions relating to the LOT and to approved Operational Works drawings for services location and possible easements.

THESE DESIGNS AND DRAWINGS ARE COPYRIGHT AND ARE NOT TO BE USED OR REPRODUCED WITHOUT THE WRITTEN PERMISSION OF VERIS

Data Sources
Cadastral Boundaries
30109-LC-Master(D0) F594 2014.dwg
Engineering Design
STAGE 5E BASE - 02 05 2023.dwg
Final Surface Contours
FLAGSTONE - STAGE 5 - DISCLOSURE INFO - 02 05 2023 - Design Tm.dxf
Depth of Fill
FLAGSTONE - STAGE 5 - DISCLOSURE INFO - 02 05 2023 -
Retaining Wall
FLAGSTONE - 5 BEW - OPW - DRAFTSET - 27.04.23

A	Original	06.07.2023	BK
Issue	Revisions	Date	Drawn

Locality: FLAGSTONE
Local Authority: LOGAN CITY COUNCIL
Horizontal Meridian: MGA Zone 56
Vertical Level Datum: AHD D
Scale: 1:250 @ A4
Designed: Colliers
Drawn: BK 06/07/2023
Checked: DE 06/07/2023
Plot Date: 06 Jul, 2023
Computer File Ref: 30109-SISE-DP-(A).dwg

DISCLOSURE PLAN
of Proposed LOT 2158
being part of
Lot 911
on SP335845



BRISBANE WHITSUNDAYS
(07) 3686 4700 (07) 4945 6600

MACKAY CAIRNS
(07) 4957 9700 (07) 4252 9400

veris.com.au
ACN 615 735 727
Veris Australia Pty Ltd

Drawing No Issue
30109-DP- 2158 A

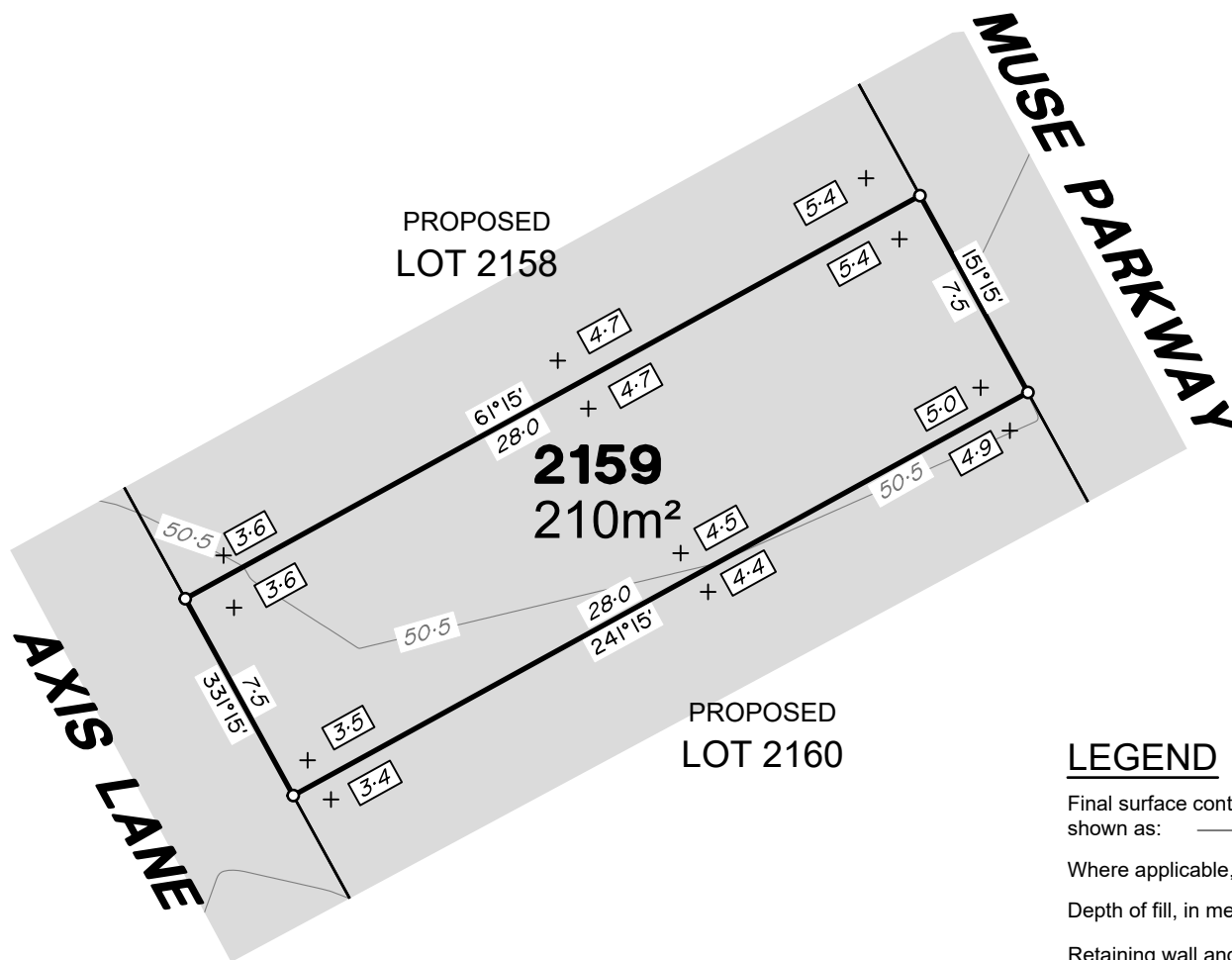
**ADDITIONAL NOTES:**

The LOT dimensions and area shown hereon are subject to final field survey and also to the requirements of Council and any other authority which may have requirements under any relevant legislation

Final surface contours shown hereon have been supplied by Colliers.

Location of retaining walls are as shown on Engineering design drawings. Their as-constructed location may differ from their design location. Retaining wall heights have been supplied by Colliers.

Compaction of any fill material placed on this site shall be completed to level one inspection and testing services in accordance with AS3798-2007.

Depth of fill values are calculated to the pre-development surface.

Copyright © Veris Australia Pty Ltd
06/07/2023.

LEGEND

Final surface contours based on A.H.D. datum at an interval of 0.5m, shown as: 15.5

Where applicable, areas to be filled are shown as:

Depth of fill, in metres, shown as: -

Retaining wall and retaining wall height, shown on the lower side of the wall, have been taken from plans supplied by Colliers and shown as: (1.2)

Bin Pad Location shown as:



**FLAGSTONE
PRECINCT 1 STAGE 5E**
For
**PEET FLAGSTONE
CITY PTY LTD**

IMPORTANT NOTES:

(These notes are an integral part of this plan)

This plan has been prepared for **PEET FLAGSTONE CITY PTY LTD** for the purposes of **A Disclosure Plan Under the Land Sales Act 1984 (as amended)**.

It is not to be used by any other person or corporation or for any other purposes and is subject to the following limitations:

Please refer to the approved Development Application for conditions relating to the LOT and to approved Operational Works drawings for services location and possible easements.

THESE DESIGNS AND DRAWINGS ARE COPYRIGHT AND ARE NOT TO BE USED OR REPRODUCED WITHOUT THE WRITTEN PERMISSION OF VERIS

Data Sources
Cadastral Boundaries
30109-LC-Master(D0) F594 2014.dwg
Engineering Design
STAGE 5E BASE - 02 05 2023.dwg
Final Surface Contours
FLAGSTONE - STAGE 5 - DISCLOSURE INFO - 02 05 2023 - Design Tm.dxf
Depth of Fill
FLAGSTONE - STAGE 5 - DISCLOSURE INFO - 02 05 2023 -
Retaining Wall
FLAGSTONE - 5 BEW - OPW - DRAFTSET - 27.04.23

A	Original	06.07.2023	BK
Issue	Revisions	Date	Drawn

Locality: FLAGSTONE
Local Authority: LOGAN CITY COUNCIL
Horizontal Meridian: MGA Zone 56
Vertical Level Datum: AHD D
Scale: 1:250 @ A4
Designed: Colliers
Drawn: BK 06/07/2023
Checked: DE 06/07/2023
Plot Date: 06 Jul, 2023
Computer File Ref: 30109-St5E-DP-(A).dwg

DISCLOSURE PLAN
of Proposed LOT 2159
being part of
Lot 911
on SP335845



veris

BRISBANE (07) 3686 4700 WHITSUNDAYS (07) 4945 6600

MACKAY (07) 4957 9700 CAIRNS (07) 4252 9400

veris.com.au
ACN 615 735 727
Veris Australia Pty Ltd

Drawing No
30109-DP- 2159

Issue
A

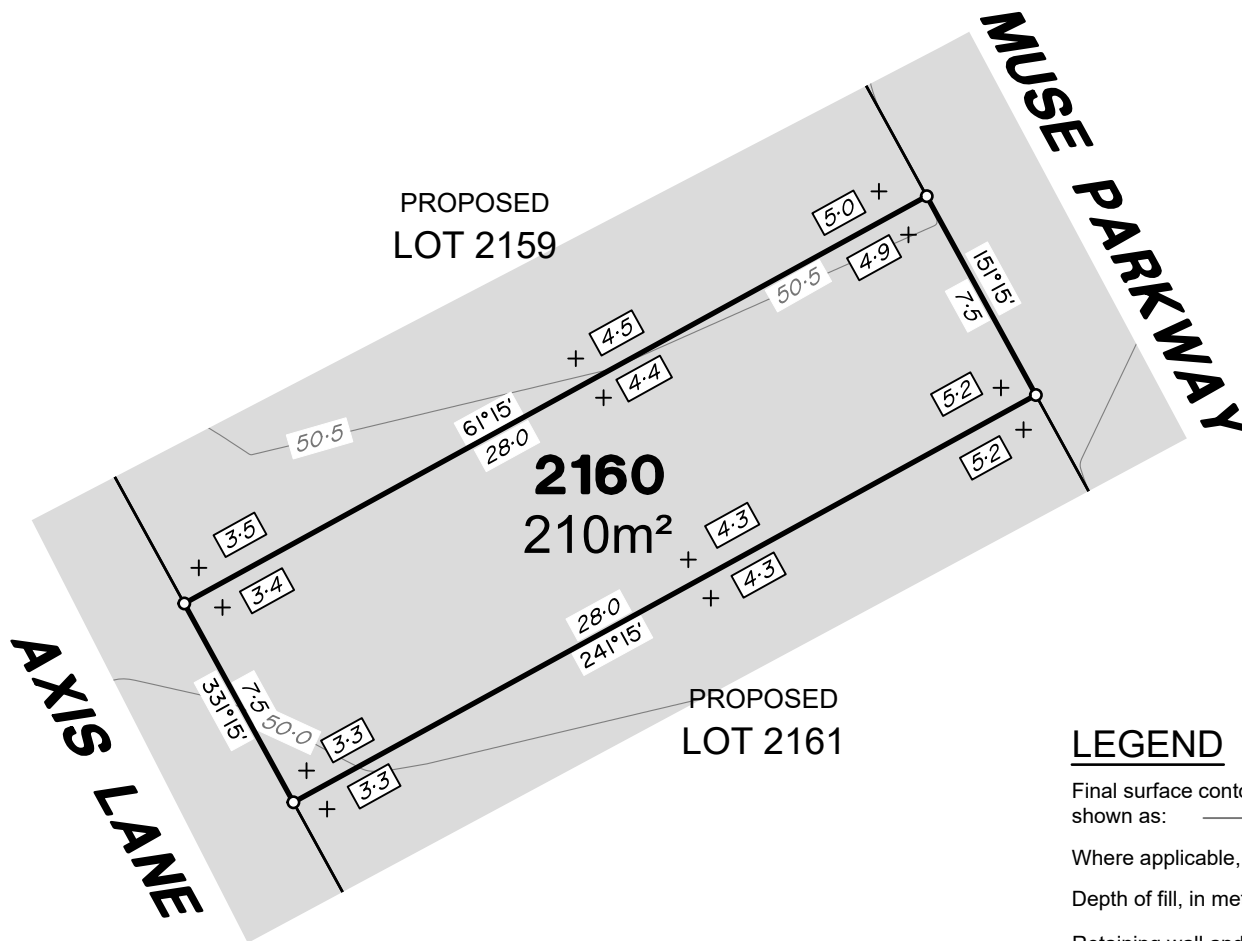

ADDITIONAL NOTES:

The LOT dimensions and area shown hereon are subject to final field survey and also to the requirements of Council and any other authority which may have requirements under any relevant legislation

Final surface contours shown hereon have been supplied by Colliers.

Location of retaining walls are as shown on Engineering design drawings. Their as-constructed location may differ from their design location. Retaining wall heights have been supplied by Colliers.

Compaction of any fill material placed on this site shall be completed to level one inspection and testing services in accordance with AS3798-2007.

Depth of fill values are calculated to the pre-development surface.

Copyright © Veris Australia Pty Ltd
06/07/2023.

**FLAGSTONE
PRECINCT 1 STAGE 5E**
For
**PEET FLAGSTONE
CITY PTY LTD**

IMPORTANT NOTES:

(These notes are an integral part of this plan)

This plan has been prepared for **PEET FLAGSTONE CITY PTY LTD** for the purposes of **A Disclosure Plan Under the Land Sales Act 1984 (as amended)**.

It is not to be used by any other person or corporation or for any other purposes and is subject to the following limitations:

Please refer to the approved Development Application for conditions relating to the LOT and to approved Operational Works drawings for services location and possible easements.

THESE DESIGNS AND DRAWINGS ARE COPYRIGHT AND ARE NOT TO BE USED OR REPRODUCED WITHOUT THE WRITTEN PERMISSION OF VERIS

Data Sources
Cadastral Boundaries
30109-LC-Master(D0) F594 2014.dwg
Engineering Design
STAGE 5E BASE - 02 05 2023.dwg
Final Surface Contours
FLAGSTONE - STAGE 5 - DISCLOSURE INFO - 02 05 2023 - Design Tm.dxf
Depth of Fill
FLAGSTONE - STAGE 5 - DISCLOSURE INFO - 02 05 2023 -
Retaining Wall
FLAGSTONE - 5 BEW - OPW - DRAFTSET - 27.04.23

Issue	Revisions	Date	Drawn
A	Original	06.07.2023	BK

Locality: FLAGSTONE
Local Authority: LOGAN CITY COUNCIL
Horizontal Meridian: MGA Zone 56
Vertical Level Datum: AHD D
Scale: 1:250 @ A4
Designed: Colliers
Drawn: BK 06/07/2023
Checked: DE 06/07/2023
Plot Date: 06 Jul, 2023
Computer File Ref: 30109-St5E-DP-(A).dwg

DISCLOSURE PLAN
of Proposed LOT 2160
being part of
Lot 911
on SP335845



veris

BRISBANE (07) 3686 4700 WHITSUNDAYS (07) 4945 6600

MACKAY (07) 4957 9700 CAIRNS (07) 4252 9400

veris.com.au
ACN 615 735 727
Veris Australia Pty Ltd

Drawing No
30109-DP- 2160

Issue
A

LEGEND

Final surface contours based on A.H.D. datum at an interval of 0.5m, shown as: 15.5

Where applicable, areas to be filled are shown as:

Depth of fill, in metres, shown as:- 0.5

Retaining wall and retaining wall height, shown on the lower side of the wall, have been taken from plans supplied by Colliers and shown as: (1.2)

Bin Pad Location shown as:



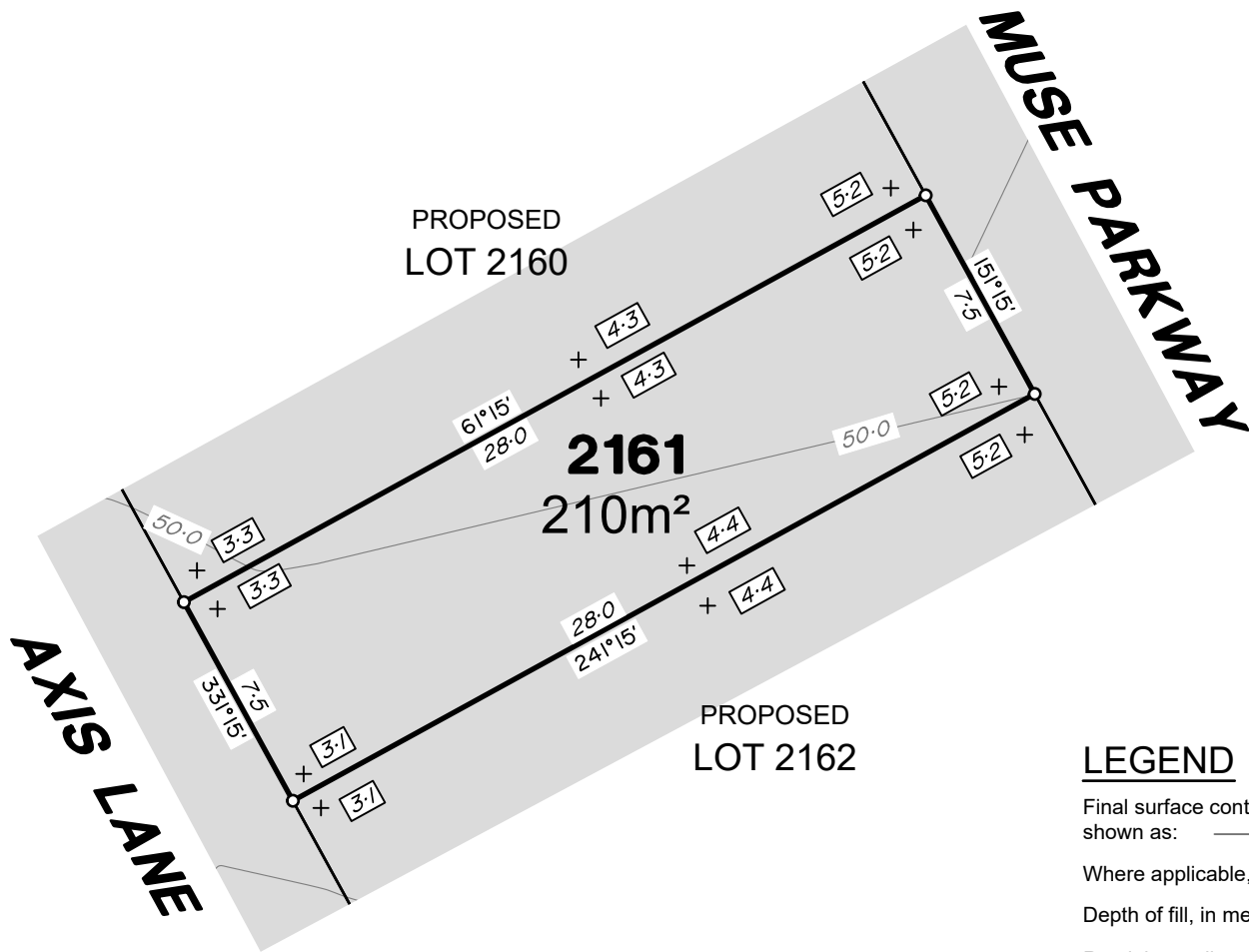

ADDITIONAL NOTES:

The LOT dimensions and area shown hereon are subject to final field survey and also to the requirements of Council and any other authority which may have requirements under any relevant legislation

Final surface contours shown hereon have been supplied by Colliers.

Location of retaining walls are as shown on Engineering design drawings. Their as-constructed location may differ from their design location. Retaining wall heights have been supplied by Colliers.

Compaction of any fill material placed on this site shall be completed to level one inspection and testing services in accordance with AS3798-2007.

Depth of fill values are calculated to the pre-development surface.

Copyright © Veris Australia Pty Ltd
06/07/2023.

**FLAGSTONE
PRECINCT 1 STAGE 5E**
For
**PEET FLAGSTONE
CITY PTY LTD**

IMPORTANT NOTES:
(These notes are an integral part of this plan)
This plan has been prepared for PEET FLAGSTONE CITY PTY LTD for the purposes of A Disclosure Plan Under the Land Sales Act 1984 (as amended).
It is not to be used by any other person or corporation or for any other purposes and is subject to the following limitations:

Please refer to the approved Development Application for conditions relating to the LOT and to approved Operational Works drawings for services location and possible easements.

THESE DESIGNS AND DRAWINGS ARE COPYRIGHT AND ARE NOT TO BE USED OR REPRODUCED WITHOUT THE WRITTEN PERMISSION OF VERIS

- Data Sources**
- Cadastral Boundaries
30109-LC-Master(D0) F594 2014.dwg
 - Engineering Design
STAGE 5E BASE - 02 05 2023.dwg
 - Final Surface Contours
FLAGSTONE - STAGE 5 - DISCLOSURE INFO - 02 05 2023 - Design Tm.dxf
 - Depth of Fill
FLAGSTONE - STAGE 5 - DISCLOSURE INFO - 02 05 2023 -
 - Retaining Wall
FLAGSTONE - 5 BEW - OPW - DRAFTSET - 27.04.23

A	Original	06.07.2023	BK
Issue	Revisions	Date	Drawn

Locality: FLAGSTONE
 Local Authority: LOGAN CITY COUNCIL
 Horizontal Meridian: MGA Zone 56
 Vertical Level Datum: AHD D
 Scale: 1:250 @ A4
 Designed: Colliers
 Drawn: BK 06/07/2023
 Checked: DE 06/07/2023
 Plot Date: 06 Jul, 2023
 Computer File Ref: 30109-SISE-DP-(A).dwg

**DISCLOSURE PLAN
of Proposed LOT 2161
being part of
Lot 911
on SP335845**



BRISBANE (07) 3686 4700 WHITSUNDAYS (07) 4945 6600
 MACKAY (07) 4957 9700 CAIRNS (07) 4252 9400
 veris.com.au
 ACN 615 735 727
 Veris Australia Pty Ltd

Drawing No
30109-DP- 2161

Issue
A

LEGEND

Final surface contours based on A.H.D. datum at an interval of 0.5m, shown as: — 15.5 —

Where applicable, areas to be filled are shown as:

Depth of fill, in metres, shown as:- +[0.5]

Retaining wall and retaining wall height, shown on the lower side of the wall, have been taken from plans supplied by Colliers and shown as:

Bin Pad Location shown as: *

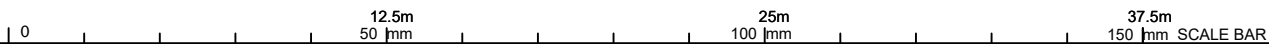

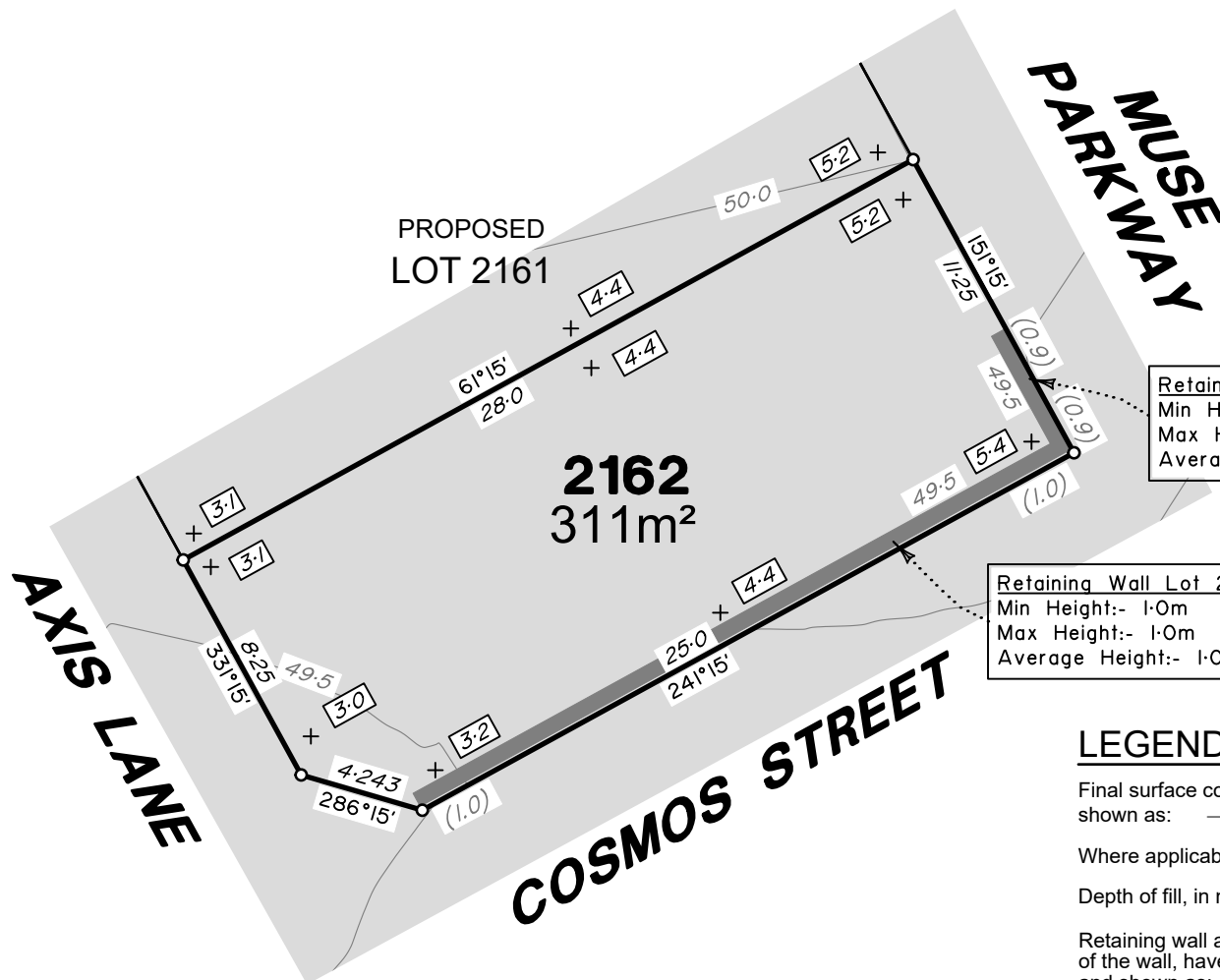

Retaining Wall Lot 2162
 Min Height:- 0.9m
 Max Height:- 0.9m
 Average Height:- 0.9m

Retaining Wall Lot 2162
 Min Height:- 1.0m
 Max Height:- 1.0m
 Average Height:- 1.0m

ADDITIONAL NOTES:

The LOT dimensions and area shown hereon are subject to final field survey and also to the requirements of Council and any other authority which may have requirements under any relevant legislation

Final surface contours shown hereon have been supplied by Colliers.

Location of retaining walls are as shown on Engineering design drawings. Their as-constructed location may differ from their design location. Retaining wall heights have been supplied by Colliers.

Compaction of any fill material placed on this site shall be completed to level one inspection and testing services in accordance with AS3798-2007.

Depth of fill values are calculated to the pre-development surface.

Copyright © Veris Australia Pty Ltd
 06/07/2023.

**FLAGSTONE
 PRECINCT 1 STAGE 5E**
 For
**PEET FLAGSTONE
 CITY PTY LTD**

IMPORTANT NOTES:
 (These notes are an integral part of this plan)

This plan has been prepared for PEET FLAGSTONE CITY PTY LTD for the purposes of **A Disclosure Plan Under the Land Sales Act 1984 (as amended)**.

It is not to be used by any other person or corporation or for any other purposes and is subject to the following limitations:

Please refer to the approved Development Application for conditions relating to the LOT and to approved Operational Works drawings for services location and possible easements.

THESE DESIGNS AND DRAWINGS ARE COPYRIGHT AND ARE NOT TO BE USED OR REPRODUCED WITHOUT THE WRITTEN PERMISSION OF VERIS

Data Sources

Cadastral Boundaries	30109-LC-Master(D0) F594 2014.dwg
Engineering Design	STAGE 5E BASE - 02 05 2023.dwg
Final Surface Contours	FLAGSTONE - STAGE 5 - DISCLOSURE INFO - 02 05 2023 - Design Tm.dxf
Depth of Fill	FLAGSTONE - STAGE 5 - DISCLOSURE INFO - 02 05 2023 - Retaining Wall
Retaining Wall	FLAGSTONE - 5 BEW - OPW - DRAFTSET - 27.04.23

A	Original	06.07.2023	BK
Issue	Revisions	Date	Drawn

Locality:	FLAGSTONE
Local Authority:	LOGAN CITY COUNCIL
Horizontal Meridian:	MGA Zone 56
Vertical Level Datum:	AHD D
Scale:	1:250 @ A4
Designed:	Colliers
Drawn:	BK 06/07/2023
Checked:	DE 06/07/2023
Plot Date:	06 Jul, 2023
Computer File Ref:	30109-St5E-DP-(A).dwg

**DISCLOSURE PLAN
 of Proposed LOT 2162
 being part of
 Lot 911
 on SP335845**



BRISBANE WHITSUNDAYS
 (07) 3686 4700 (07) 4945 6600
MACKAY CAIRNS
 (07) 4957 9700 (07) 4252 9400
 veris.com.au
 ACN 615 735 727
 Veris Australia Pty Ltd

Drawing No 30109-DP- 2162 Issue A

LEGEND

Final surface contours based on A.H.D. datum at an interval of 0.5m, shown as: 15.5

Where applicable, areas to be filled are shown as:

Depth of fill, in metres, shown as:- +0.5

Retaining wall and retaining wall height, shown on the lower side of the wall, have been taken from plans supplied by Colliers and shown as: (1.2)

Bin Pad Location shown as:

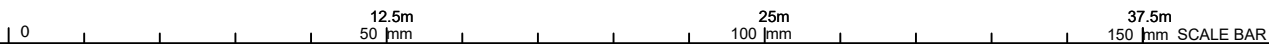



Retaining Wall Lot 2163
 Min Height:- 1.7m
 Max Height:- 1.7m
 Average Height:- 1.7m

PROPOSED
 LOT 2087

PROPOSED
 LOT 2086

PROPOSED
 LOT 2164

2163
428m²

AXIS LANE

COSMOS STREET

ADDITIONAL NOTES:

The LOT dimensions and area shown hereon are subject to final field survey and also to the requirements of Council and any other authority which may have requirements under any relevant legislation

Final surface contours shown hereon have been supplied by Colliers.

Location of retaining walls are as shown on Engineering design drawings. Their as-constructed location may differ from their design location. Retaining wall heights have been supplied by Colliers.

Compaction of any fill material placed on this site shall be completed to level one inspection and testing services in accordance with AS3798-2007.

Depth of fill values are calculated to the pre-development surface.

Copyright © Veris Australia Pty Ltd
 06/07/2023.

**FLAGSTONE
 PRECINCT 1 STAGE 5E**
 For
**PEET FLAGSTONE
 CITY PTY LTD**

IMPORTANT NOTES:

(These notes are an integral part of this plan)

This plan has been prepared for **PEET FLAGSTONE CITY PTY LTD** for the purposes of **A Disclosure Plan Under the Land Sales Act 1984 (as amended)**.

It is not to be used by any other person or corporation or for any other purposes and is subject to the following limitations:

Please refer to the approved Development Application for conditions relating to the LOT and to approved Operational Works drawings for services location and possible easements.

THESE DESIGNS AND DRAWINGS ARE COPYRIGHT AND ARE NOT TO BE USED OR REPRODUCED WITHOUT THE WRITTEN PERMISSION OF VERIS

Data Sources
 Cadastral Boundaries
 30109-LC-Master(D0) F594 2014.dwg
 Engineering Design
 STAGE 5E BASE - 02 05 2023.dwg
 Final Surface Contours
 FLAGSTONE - STAGE 5 - DISCLOSURE INFO - 02 05 2023 - Design Tm.dxf
 Depth of Fill
 FLAGSTONE - STAGE 5 - DISCLOSURE INFO - 02 05 2023 -
 Retaining Wall
 FLAGSTONE - 5 BEW - OPW - DRAFTSET - 27.04.23

Issue	Revisions	Date	Drawn
A	Original	06.07.2023	BK

Locality: FLAGSTONE
 Local Authority: LOGAN CITY COUNCIL
 Horizontal Meridian: MGA Zone 56
 Vertical Level Datum: AHD D
 Scale: 1:250 @ A4
 Designed: Colliers
 Drawn: BK 06/07/2023
 Checked: DE 06/07/2023
 Plot Date: 06 Jul, 2023
 Computer File Ref: 30109-SISE-DP-(A).dwg

DISCLOSURE PLAN
 of Proposed LOT 2163
 being part of
 Lot 911
 on SP335845



veris

BRISBANE (07) 3686 4700
 WHITSUNDAYS (07) 4945 6600
 MACKAY (07) 4957 9700
 CAIRNS (07) 4252 9400

veris.com.au
 ACN 615 735 727
 Veris Australia Pty Ltd

Drawing No
30109-DP- 2163
 Issue
A

LEGEND

Final surface contours based on A.H.D. datum at an interval of 0.5m, shown as: 15.5

Where applicable, areas to be filled are shown as:

Depth of fill, in metres, shown as:- 0.5

Retaining wall and retaining wall height, shown on the lower side of the wall, have been taken from plans supplied by Colliers and shown as:

Bin Pad Location shown as:





PROPOSED LOT 2087

PROPOSED LOT 2086

Retaining Wall Lot 2164
Min Height:- 1.8m
Max Height:- 1.8m
Average Height:- 1.8m

PROPOSED LOT 2085

Retaining Wall Lot 2164
Min Height:- 0.6m
Max Height:- 0.6m
Average Height:- 0.6m

2164
600m²

PROPOSED LOT 2163

PROPOSED LOT 2165

COSMOS STREET

ADDITIONAL NOTES:

The LOT dimensions and area shown hereon are subject to final field survey and also to the requirements of Council and any other authority which may have requirements under any relevant legislation

Final surface contours shown hereon have been supplied by Colliers.

Location of retaining walls are as shown on Engineering design drawings. Their as-constructed location may differ from their design location. Retaining wall heights have been supplied by Colliers.

Compaction of any fill material placed on this site shall be completed to level one inspection and testing services in accordance with AS3798-2007.

Depth of fill values are calculated to the pre-development surface.

Copyright © Veris Australia Pty Ltd
06/07/2023.

FLAGSTONE
PRECINCT 1 STAGE 5E
For
PEET FLAGSTONE
CITY PTY LTD

IMPORTANT NOTES:

(These notes are an integral part of this plan)

This plan has been prepared for PEET FLAGSTONE CITY PTY LTD for the purposes of **A Disclosure Plan Under the Land Sales Act 1984 (as amended)**.

It is not to be used by any other person or corporation or for any other purposes and is subject to the following limitations:

Please refer to the approved Development Application for conditions relating to the LOT and to approved Operational Works drawings for services location and possible easements.

THESE DESIGNS AND DRAWINGS ARE COPYRIGHT AND ARE NOT TO BE USED OR REPRODUCED WITHOUT THE WRITTEN PERMISSION OF VERIS

Data Sources
Cadastral Boundaries
30109-LC-Master(D0) F594 2014.dwg
Engineering Design
STAGE 5E BASE - 02 05 2023.dwg
Final Surface Contours
FLAGSTONE - STAGE 5 - DISCLOSURE INFO - 02 05 2023 - Design Tm.dxf
Depth of Fill
FLAGSTONE - STAGE 5 - DISCLOSURE INFO - 02 05 2023 - Retaining Wall
FLAGSTONE - 5 BEW - OPW - DRAFTSET - 27.04.23

Issue	Revisions	Date	Drawn
A	Original	06.07.2023	BK

Locality: FLAGSTONE
Local Authority: LOGAN CITY COUNCIL
Horizontal Meridian: MGA Zone 56
Vertical Level Datum: AHD D
Scale: 1:250 @ A4
Designed: Colliers
Drawn: BK 06/07/2023
Checked: DE 06/07/2023
Plot Date: 06 Jul, 2023
Computer File Ref: 30109-SISE-DP-(A).dwg

DISCLOSURE PLAN
of Proposed LOT 2164
being part of
Lot 911
on SP335845



veris

BRISBANE (07) 3686 4700
WHITSUNDAYS (07) 4945 6600
MACKAY (07) 4957 9700
CAIRNS (07) 4252 9400

veris.com.au
ACN 615 735 727
Veris Australia Pty Ltd

Drawing No
30109-DP- 2164
Issue
A

LEGEND

Final surface contours based on A.H.D. datum at an interval of 0.5m, shown as: — 15.5 —

Where applicable, areas to be filled are shown as:

Depth of fill, in metres, shown as:- +0.5

Retaining wall and retaining wall height, shown on the lower side of the wall, have been taken from plans supplied by Colliers and shown as:

Bin Pad Location shown as: *





PROPOSED LOT 2086

PROPOSED LOT 2085

Retaining Wall Lot 2165
Min Height:- 1.7m
Max Height:- 1.7m
Average Height:- 1.7m

PROPOSED LOT 2084

PROPOSED LOT 2164

2165
375m²

Retaining Wall Lot 2164
Min Height:- 0.6m
Max Height:- 0.6m
Average Height:- 0.6m

PROPOSED LOT 2166

COSMOS STREET

ADDITIONAL NOTES:

The LOT dimensions and area shown hereon are subject to final field survey and also to the requirements of Council and any other authority which may have requirements under any relevant legislation

Final surface contours shown hereon have been supplied by Colliers.

Location of retaining walls are as shown on Engineering design drawings. Their as-constructed location may differ from their design location. Retaining wall heights have been supplied by Colliers.

Compaction of any fill material placed on this site shall be completed to level one inspection and testing services in accordance with AS3798-2007.

Depth of fill values are calculated to the pre-development surface.

Copyright © Veris Australia Pty Ltd
06/07/2023.

**FLAGSTONE
PRECINCT 1 STAGE 5E**
For
**PEET FLAGSTONE
CITY PTY LTD**

IMPORTANT NOTES:

(These notes are an integral part of this plan)

This plan has been prepared for PEET FLAGSTONE CITY PTY LTD for the purposes of **A Disclosure Plan Under the Land Sales Act 1984 (as amended)**.

It is not to be used by any other person or corporation or for any other purposes and is subject to the following limitations:

Please refer to the approved Development Application for conditions relating to the LOT and to approved Operational Works drawings for services location and possible easements.

THESE DESIGNS AND DRAWINGS ARE COPYRIGHT AND ARE NOT TO BE USED OR REPRODUCED WITHOUT THE WRITTEN PERMISSION OF VERIS

Data Sources

Cadastral Boundaries
30109-LC-Master(D0) F594 2014.dwg
Engineering Design
STAGE 5E BASE - 02 05 2023.dwg

Final Surface Contours

FLAGSTONE - STAGE 5 - DISCLOSURE INFO - 02 05 2023 - Design Tm.dxf

Depth of Fill

FLAGSTONE - STAGE 5 - DISCLOSURE INFO - 02 05 2023 - Retaining Wall
FLAGSTONE - 5 BEW - OPW - DRAFTSET - 27.04.23

Issue	Revisions	Date	Drawn
A	Original	06.07.2023	BK

Locality: FLAGSTONE
Local Authority: LOGAN CITY COUNCIL
Horizontal Meridian: MGA Zone 56
Vertical Level Datum: AHD D
Scale: 1:250 @ A4
Designed: Colliers
Drawn: BK 06/07/2023
Checked: DE 06/07/2023
Plot Date: 06 Jul, 2023
Computer File Ref: 30109-SISE-DP-(A).dwg

DISCLOSURE PLAN
of Proposed LOT 2165
being part of
Lot 911
on SP335845



veris

BRISBANE (07) 3686 4700 WHITSUNDAYS (07) 4945 6600

MACKAY (07) 4957 9700 CAIRNS (07) 4252 9400

veris.com.au
ACN 615 735 727
Veris Australia Pty Ltd

Drawing No
30109-DP- 2165

Issue
A

LEGEND

Final surface contours based on A.H.D. datum at an interval of 0.5m, shown as: 15.5

Where applicable, areas to be filled are shown as:

Depth of fill, in metres, shown as:- 0.5

Retaining wall and retaining wall height, shown on the lower side of the wall, have been taken from plans supplied by Colliers and shown as: (1.2)

Bin Pad Location shown as:





PROPOSED
LOT 2085

PROPOSED
LOT 2084

Retaining Wall Lot 2166
Min Height:- 1.6m
Max Height:- 1.6m
Average Height:- 1.6m

PROPOSED
LOT 2083

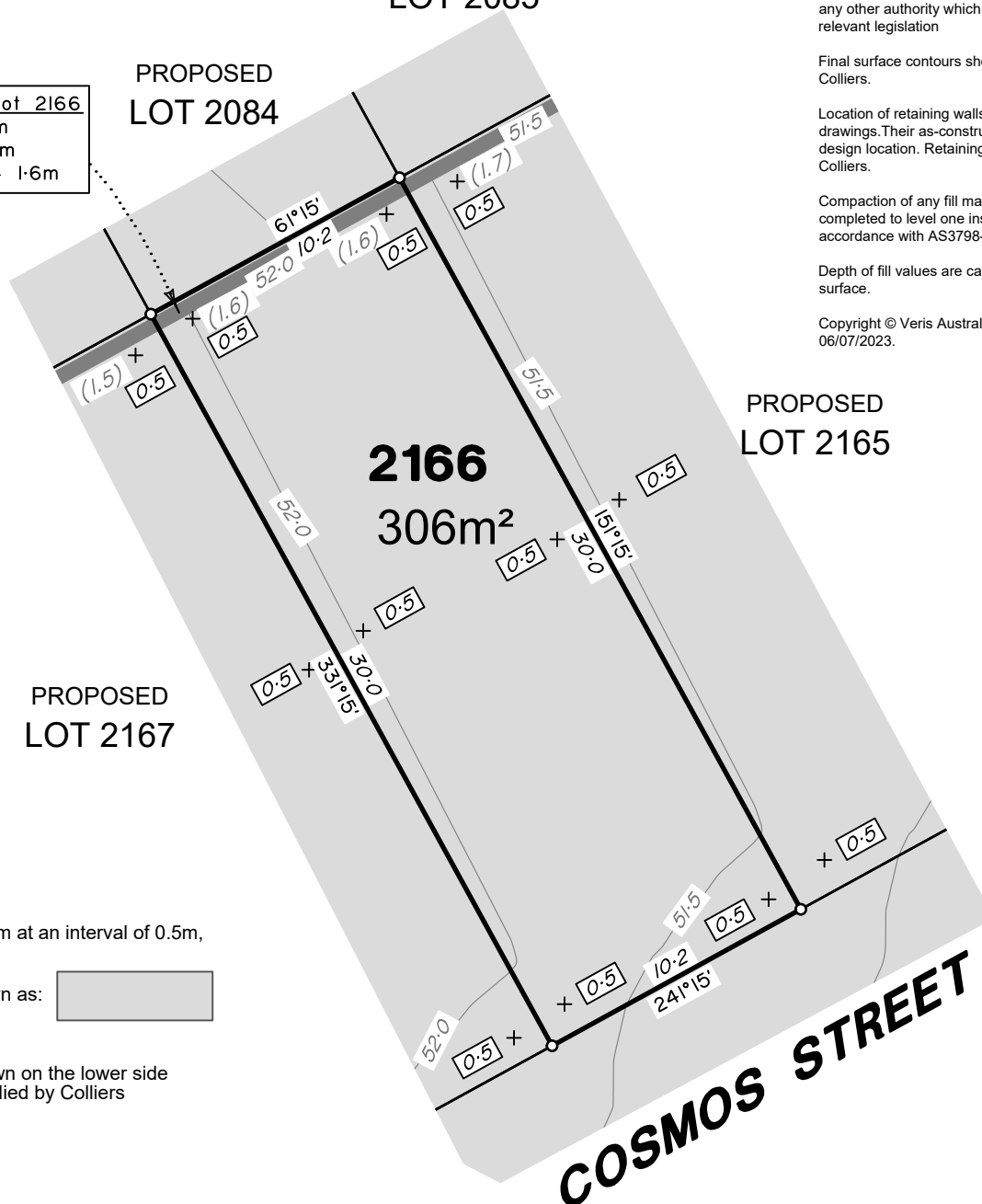

ADDITIONAL NOTES:

The LOT dimensions and area shown hereon are subject to final field survey and also to the requirements of Council and any other authority which may have requirements under any relevant legislation

Final surface contours shown hereon have been supplied by Colliers.

Location of retaining walls are as shown on Engineering design drawings. Their as-constructed location may differ from their design location. Retaining wall heights have been supplied by Colliers.

Compaction of any fill material placed on this site shall be completed to level one inspection and testing services in accordance with AS3798-2007.

Depth of fill values are calculated to the pre-development surface.

Copyright © Veris Australia Pty Ltd
06/07/2023.

FLAGSTONE
PRECINCT 1 STAGE 5E
For
PEET FLAGSTONE
CITY PTY LTD

IMPORTANT NOTES:

(These notes are an integral part of this plan)

This plan has been prepared for PEET FLAGSTONE CITY PTY LTD for the purposes of **A Disclosure Plan Under the Land Sales Act 1984 (as amended)**.

It is not to be used by any other person or corporation or for any other purposes and is subject to the following limitations:

Please refer to the approved Development Application for conditions relating to the LOT and to approved Operational Works drawings for services location and possible easements.

THESE DESIGNS AND DRAWINGS ARE COPYRIGHT AND ARE NOT TO BE USED OR REPRODUCED WITHOUT THE WRITTEN PERMISSION OF VERIS

Data Sources
Cadastral Boundaries
30109-LC-Master(D0) F594 2014.dwg
Engineering Design
STAGE 5E BASE - 02 05 2023.dwg
Final Surface Contours
FLAGSTONE - STAGE 5 - DISCLOSURE INFO - 02 05 2023 - Design Tm.dxf
Depth of Fill
FLAGSTONE - STAGE 5 - DISCLOSURE INFO - 02 05 2023 -
Retaining Wall
FLAGSTONE - 5 BEW - OPW - DRAFTSET - 27.04.23

Issue	Revisions	Date	Drawn
A	Original	06.07.2023	BK

Locality: FLAGSTONE
Local Authority: LOGAN CITY COUNCIL
Horizontal Meridian: MGA Zone 56
Vertical Level Datum: AHD D
Scale: 1:250 @ A4
Designed: Colliers
Drawn: BK 06/07/2023
Checked: DE 06/07/2023
Plot Date: 06 Jul, 2023
Computer File Ref: 30109-St5E-DP-(A).dwg

DISCLOSURE PLAN
of Proposed LOT 2166
being part of
Lot 911
on SP335845



veris

BRISBANE (07) 3686 4700 WHITSUNDAYS (07) 4945 6600

MACKAY (07) 4957 9700 CAIRNS (07) 4252 9400

veris.com.au
ACN 615 735 727
Veris Australia Pty Ltd

Drawing No
30109-DP- 2166
Issue
A

LEGEND

Final surface contours based on A.H.D. datum at an interval of 0.5m, shown as: — 15.5 —

Where applicable, areas to be filled are shown as:

Depth of fill, in metres, shown as:- +0.5

Retaining wall and retaining wall height, shown on the lower side of the wall, have been taken from plans supplied by Colliers and shown as:

(1.2)

Bin Pad Location shown as: *





PROPOSED LOT 2084

PROPOSED LOT 2083

PROPOSED LOT 2082

PROPOSED LOT 2166

PROPOSED LOT 2168

2167
306m²

Retaining Wall Lot 2167
Min Height:- 1.5m
Max Height:- 1.5m
Average Height:- 1.5m

ADDITIONAL NOTES:

The LOT dimensions and area shown hereon are subject to final field survey and also to the requirements of Council and any other authority which may have requirements under any relevant legislation

Final surface contours shown hereon have been supplied by Colliers.

Location of retaining walls are as shown on Engineering design drawings. Their as-constructed location may differ from their design location. Retaining wall heights have been supplied by Colliers.

Compaction of any fill material placed on this site shall be completed to level one inspection and testing services in accordance with AS3798-2007.

Depth of fill values are calculated to the pre-development surface.

Copyright © Veris Australia Pty Ltd
06/07/2023.

FLAGSTONE
PRECINCT 1 STAGE 5E
For
PEET FLAGSTONE
CITY PTY LTD

IMPORTANT NOTES:

(These notes are an integral part of this plan)

This plan has been prepared for PEET FLAGSTONE CITY PTY LTD for the purposes of **A Disclosure Plan Under the Land Sales Act 1984 (as amended)**.

It is not to be used by any other person or corporation or for any other purposes and is subject to the following limitations:

Please refer to the approved Development Application for conditions relating to the LOT and to approved Operational Works drawings for services location and possible easements.

THESE DESIGNS AND DRAWINGS ARE COPYRIGHT AND ARE NOT TO BE USED OR REPRODUCED WITHOUT THE WRITTEN PERMISSION OF VERIS

Data Sources
Cadastral Boundaries
30109-LC-Master(D0) F594 2014.dwg
Engineering Design
STAGE 5E BASE - 02 05 2023.dwg
Final Surface Contours
FLAGSTONE - STAGE 5 - DISCLOSURE INFO - 02 05 2023 - Design Tm.dxf
Depth of Fill
FLAGSTONE - STAGE 5 - DISCLOSURE INFO - 02 05 2023 -
Retaining Wall
FLAGSTONE - 5 BEW - OPW - DRAFTSET - 27.04.23

Issue	Revisions	Date	Drawn
A	Original	06.07.2023	BK

Locality: FLAGSTONE
Local Authority: LOGAN CITY COUNCIL
Horizontal Meridian: MGA Zone 56
Vertical Level Datum: AHD D
Scale: 1:250 @ A4
Designed: Colliers
Drawn: BK 06/07/2023
Checked: DE 06/07/2023
Plot Date: 06 Jul, 2023
Computer File Ref: 30109-SISE-DP-(A).dwg

DISCLOSURE PLAN
of Proposed LOT 2167
being part of
Lot 911
on SP335845



veris

BRISBANE (07) 3686 4700
WHITSUNDAYS (07) 4945 6600
MACKAY (07) 4957 9700
CAIRNS (07) 4252 9400

veris.com.au
ACN 615 735 727
Veris Australia Pty Ltd

Drawing No
30109-DP- 2167
Issue
A

LEGEND

Final surface contours based on A.H.D. datum at an interval of 0.5m, shown as: 15.5

Where applicable, areas to be filled are shown as:

Depth of fill, in metres, shown as:- 0.5

Retaining wall and retaining wall height, shown on the lower side of the wall, have been taken from plans supplied by Colliers and shown as: (1.2)

Bin Pad Location shown as:

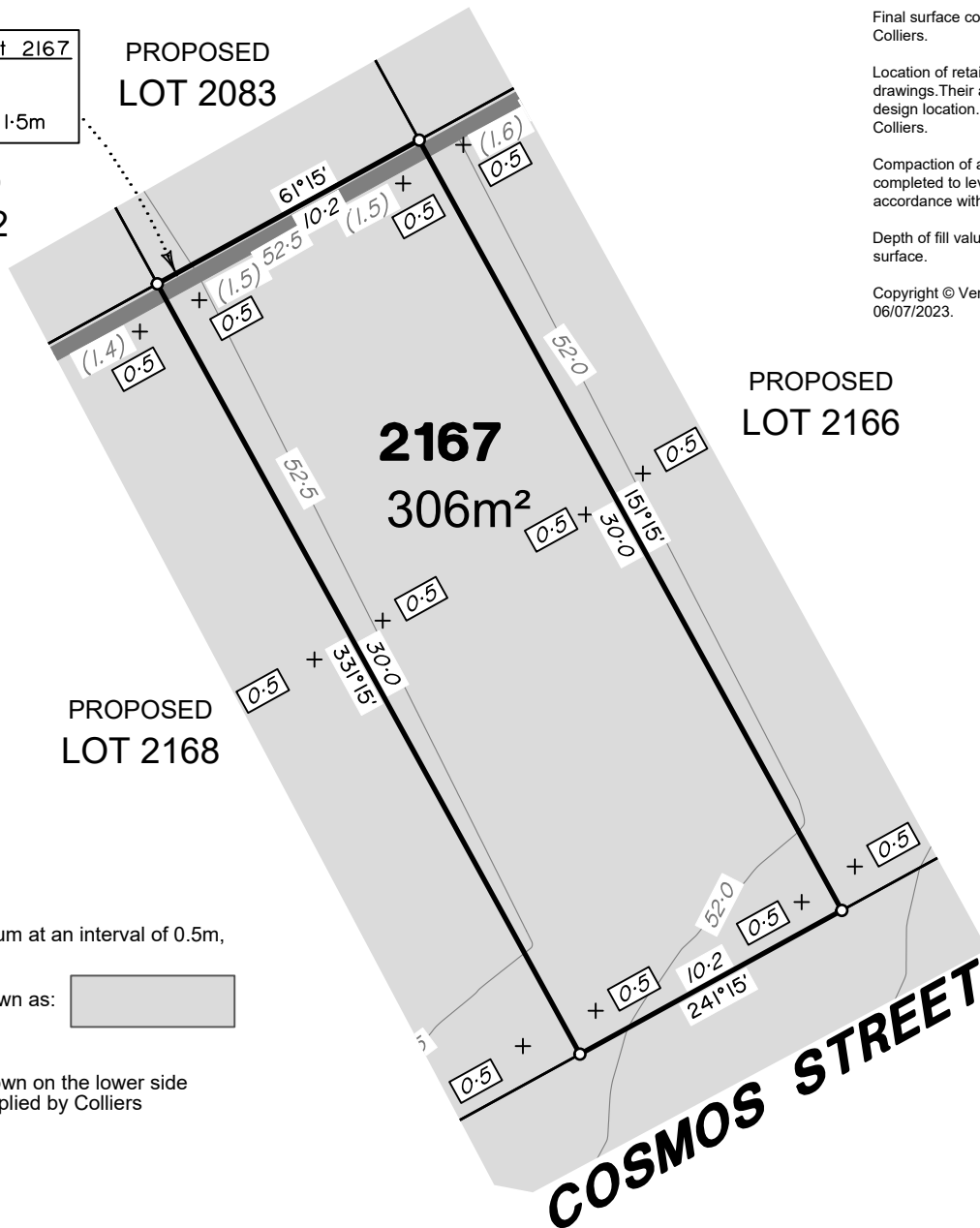



Retaining Wall Lot 2168
 Min Height:- 1.4m
 Max Height:- 1.4m
 Average Height:- 1.4m

PROPOSED
 LOT 2083

PROPOSED
 LOT 2082

PROPOSED
 LOT 2081

PROPOSED
 LOT 2167

2168
 375m²

PROPOSED
 LOT 2169

COSMOS STREET

ADDITIONAL NOTES:

The LOT dimensions and area shown hereon are subject to final field survey and also to the requirements of Council and any other authority which may have requirements under any relevant legislation

Final surface contours shown hereon have been supplied by Colliers.

Location of retaining walls are as shown on Engineering design drawings. Their as-constructed location may differ from their design location. Retaining wall heights have been supplied by Colliers.

Compaction of any fill material placed on this site shall be completed to level one inspection and testing services in accordance with AS3798-2007.

Depth of fill values are calculated to the pre-development surface.

Copyright © Veris Australia Pty Ltd
 06/07/2023.

**FLAGSTONE
 PRECINCT 1 STAGE 5E**
 For
**PEET FLAGSTONE
 CITY PTY LTD**

IMPORTANT NOTES:

(These notes are an integral part of this plan)

This plan has been prepared for **PEET FLAGSTONE CITY PTY LTD** for the purposes of **A Disclosure Plan Under the Land Sales Act 1984 (as amended)**.

It is not to be used by any other person or corporation or for any other purposes and is subject to the following limitations:

Please refer to the approved Development Application for conditions relating to the LOT and to approved Operational Works drawings for services location and possible easements.

THESE DESIGNS AND DRAWINGS ARE COPYRIGHT AND ARE NOT TO BE USED OR REPRODUCED WITHOUT THE WRITTEN PERMISSION OF VERIS

Data Sources

Cadastral Boundaries
 30109-LC-Master(D0) F594 2014.dwg
 Engineering Design
 STAGE 5E BASE - 02 05 2023.dwg

Final Surface Contours

FLAGSTONE - STAGE 5 - DISCLOSURE INFO - 02 05 2023 - Design Tm.dxf

Depth of Fill

FLAGSTONE - STAGE 5 - DISCLOSURE INFO - 02 05 2023 -

Retaining Wall

FLAGSTONE - 5 BEW - OPW - DRAFTSET - 27.04.23

Issue	Revisions	Date	Drawn
A	Original	06.07.2023	BK

Locality: FLAGSTONE
 Local Authority: LOGAN CITY COUNCIL
 Horizontal Meridian: MGA Zone 56
 Vertical Level Datum: AHD D
 Scale: 1:250 @ A4
 Designed: Colliers
 Drawn: BK 06/07/2023
 Checked: DE 06/07/2023
 Plot Date: 06 Jul, 2023
 Computer File Ref: 30109-St5E-DP-(A).dwg

DISCLOSURE PLAN
 of Proposed LOT 2168
 being part of
 Lot 911
 on SP335845



veris

BRISBANE (07) 3686 4700 WHITSUNDAYS (07) 4945 6600

MACKAY (07) 4957 9700 CAIRNS (07) 4252 9400

veris.com.au
 ACN 615 735 727
 Veris Australia Pty Ltd

Drawing No
30109-DP- 2168

Issue
A

LEGEND

Final surface contours based on A.H.D. datum at an interval of 0.5m, shown as: 15.5

Where applicable, areas to be filled are shown as:

Depth of fill, in metres, shown as:- 0.5

Retaining wall and retaining wall height, shown on the lower side of the wall, have been taken from plans supplied by Colliers and shown as:

Bin Pad Location shown as:





Retaining Wall Lot 2169
 Min Height:- 1.3m
 Max Height:- 1.3m
 Average Height:- 1.3m

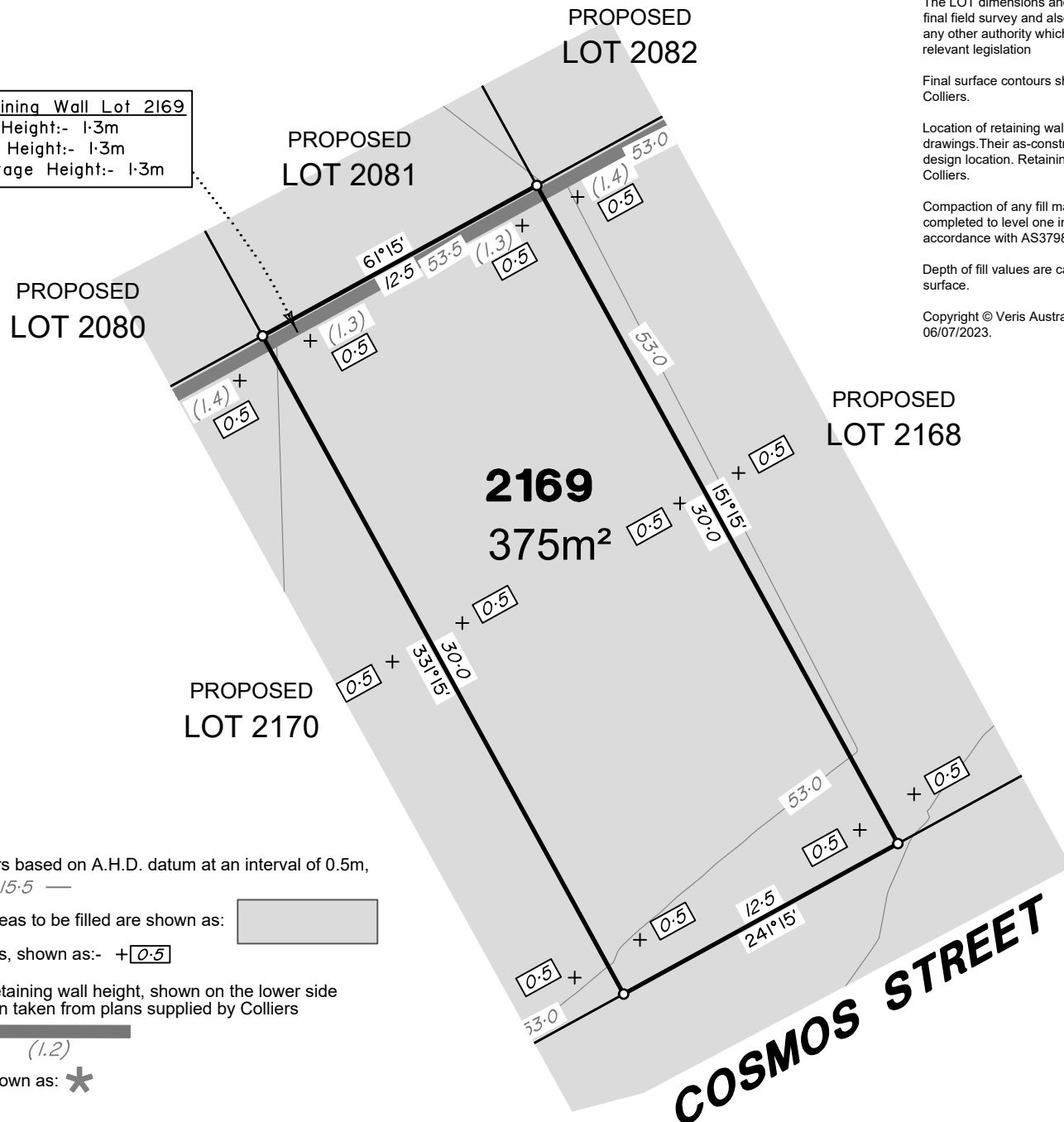

ADDITIONAL NOTES:

The LOT dimensions and area shown hereon are subject to final field survey and also to the requirements of Council and any other authority which may have requirements under any relevant legislation

Final surface contours shown hereon have been supplied by Colliers.

Location of retaining walls are as shown on Engineering design drawings. Their as-constructed location may differ from their design location. Retaining wall heights have been supplied by Colliers.

Compaction of any fill material placed on this site shall be completed to level one inspection and testing services in accordance with AS3798-2007.

Depth of fill values are calculated to the pre-development surface.

Copyright © Veris Australia Pty Ltd
 06/07/2023.

**FLAGSTONE
 PRECINCT 1 STAGE 5E**
 For
**PEET FLAGSTONE
 CITY PTY LTD**

IMPORTANT NOTES:

(These notes are an integral part of this plan)

This plan has been prepared for **PEET FLAGSTONE CITY PTY LTD** for the purposes of **A Disclosure Plan Under the Land Sales Act 1984 (as amended)**.

It is not to be used by any other person or corporation or for any other purposes and is subject to the following limitations:

Please refer to the approved Development Application for conditions relating to the LOT and to approved Operational Works drawings for services location and possible easements.

THESE DESIGNS AND DRAWINGS ARE COPYRIGHT AND ARE NOT TO BE USED OR REPRODUCED WITHOUT THE WRITTEN PERMISSION OF VERIS

Data Sources
 Cadastral Boundaries
 30109-LC-Master(D0) F594 2014.dwg
 Engineering Design
 STAGE 5E BASE - 02 05 2023.dwg
 Final Surface Contours
 FLAGSTONE - STAGE 5 - DISCLOSURE INFO - 02 05 2023 - Design Tm.dxf
 Depth of Fill
 FLAGSTONE - STAGE 5 - DISCLOSURE INFO - 02 05 2023 -
 Retaining Wall
 FLAGSTONE - 5 BEW - OPW - DRAFTSET - 27.04.23

Issue	Revisions	Date	Drawn
A	Original	06.07.2023	BK

Locality: FLAGSTONE
 Local Authority: LOGAN CITY COUNCIL
 Horizontal Meridian: MGA Zone 56
 Vertical Level Datum: AHD D
 Scale: 1:250 @ A4
 Designed: Colliers
 Drawn: BK 06/07/2023
 Checked: DE 06/07/2023
 Plot Date: 06 Jul, 2023
 Computer File Ref: 30109-SISE-DP-(A).dwg

DISCLOSURE PLAN
 of Proposed LOT 2169
 being part of
 Lot 911
 on SP335845



veris

BRISBANE (07) 3686 4700
 WHITSUNDAYS (07) 4945 6600
 MACKAY (07) 4957 9700
 CAIRNS (07) 4252 9400

veris.com.au
 ACN 615 735 727
 Veris Australia Pty Ltd

Drawing No
30109-DP- 2169
 Issue
A

LEGEND

Final surface contours based on A.H.D. datum at an interval of 0.5m, shown as: — 15.5 —

Where applicable, areas to be filled are shown as:

Depth of fill, in metres, shown as:- +0.5

Retaining wall and retaining wall height, shown on the lower side of the wall, have been taken from plans supplied by Colliers and shown as:

(1.2)

Bin Pad Location shown as: *

0 12.5m 50 mm 25m 100 mm 37.5m 150 mm SCALE BAR



PROPOSED LOT 2081

Retaining Wall Lot 2170
 Min Height:- 1.4m
 Max Height:- 1.4m
 Average Height:- 1.4m

PROPOSED LOT 2080

PROPOSED LOT 2079

PROPOSED LOT 2169

PROPOSED LOT 2171

2170
 420m²

ADDITIONAL NOTES:

The LOT dimensions and area shown hereon are subject to final field survey and also to the requirements of Council and any other authority which may have requirements under any relevant legislation

Final surface contours shown hereon have been supplied by Colliers.

Location of retaining walls are as shown on Engineering design drawings. Their as-constructed location may differ from their design location. Retaining wall heights have been supplied by Colliers.

Compaction of any fill material placed on this site shall be completed to level one inspection and testing services in accordance with AS3798-2007.

Depth of fill values are calculated to the pre-development surface.

Copyright © Veris Australia Pty Ltd
 06/07/2023.

FLAGSTONE PRECINCT 1 STAGE 5E

For
**PEET FLAGSTONE
 CITY PTY LTD**

IMPORTANT NOTES:
 (These notes are an integral part of this plan)
 This plan has been prepared for PEET FLAGSTONE CITY PTY LTD for the purposes of **A Disclosure Plan Under the Land Sales Act 1984 (as amended)**.
 It is not to be used by any other person or corporation or for any other purposes and is subject to the following limitations:

Please refer to the approved Development Application for conditions relating to the LOT and to approved Operational Works drawings for services location and possible easements.

THESE DESIGNS AND DRAWINGS ARE COPYRIGHT AND ARE NOT TO BE USED OR REPRODUCED WITHOUT THE WRITTEN PERMISSION OF VERIS

Data Sources
 Cadastral Boundaries
 30109-LC-Master(D0) F594 2014.dwg
 Engineering Design
 STAGE 5E BASE - 02 05 2023.dwg
 Final Surface Contours
 FLAGSTONE - STAGE 5 - DISCLOSURE INFO - 02 05 2023 - Design Tm.dxf
 Depth of Fill
 FLAGSTONE - STAGE 5 - DISCLOSURE INFO - 02 05 2023 -
 Retaining Wall
 FLAGSTONE - 5 BEW - OPW - DRAFTSET - 27.04.23

Issue	Revisions	Date	Drawn
A	Original	06.07.2023	BK

Locality: FLAGSTONE
 Local Authority: LOGAN CITY COUNCIL
 Horizontal Meridian: MGA Zone 56
 Vertical Level Datum: AHD D
 Scale: 1:250 @ A4
 Designed: Colliers
 Drawn: BK 06/07/2023
 Checked: DE 06/07/2023
 Plot Date: 06 Jul, 2023
 Computer File Ref: 30109-SISE-DP-(A).dwg

DISCLOSURE PLAN of Proposed LOT 2170 being part of Lot 911 on SP335845



BRISBANE (07) 3686 4700 WHITSUNDAYS (07) 4945 6600

MACKAY (07) 4957 9700 CAIRNS (07) 4252 9400

veris.com.au
 ACN 615 735 727
 Veris Australia Pty Ltd

Drawing No
30109-DP- 2170

Issue
A

LEGEND

Final surface contours based on A.H.D. datum at an interval of 0.5m, shown as: 15.5

Where applicable, areas to be filled are shown as:

Depth of fill, in metres, shown as:- +0.5

Retaining wall and retaining wall height, shown on the lower side of the wall, have been taken from plans supplied by Colliers and shown as:

Bin Pad Location shown as:



COSMOS STREET



PROPOSED
LOT 2080

PROPOSED
LOT 2079

PROPOSED
LOT 2170

2171
624m²

MESPAR ROAD

COSMOS STREET

Retaining Wall Lot 2171
Min Height:- 1.5m
Max Height:- 1.5m
Average Height:- 1.5m

Retaining Wall Lot 2171
Min Height:- 0.6m
Max Height:- 0.6m
Average Height:- 0.6m

ADDITIONAL NOTES:

The LOT dimensions and area shown hereon are subject to final field survey and also to the requirements of Council and any other authority which may have requirements under any relevant legislation

Final surface contours shown hereon have been supplied by Colliers.

Location of retaining walls are as shown on Engineering design drawings. Their as-constructed location may differ from their design location. Retaining wall heights have been supplied by Colliers.

Compaction of any fill material placed on this site shall be completed to level one inspection and testing services in accordance with AS3798-2007.

Depth of fill values are calculated to the pre-development surface.

Copyright © Veris Australia Pty Ltd
06/07/2023.

FLAGSTONE
PRECINCT 1 STAGE 5E
For
PEET FLAGSTONE
CITY PTY LTD

IMPORTANT NOTES:

(These notes are an integral part of this plan)

This plan has been prepared for PEET FLAGSTONE CITY PTY LTD for the purposes of **A Disclosure Plan Under the Land Sales Act 1984 (as amended)**.

It is not to be used by any other person or corporation or for any other purposes and is subject to the following limitations:

Please refer to the approved Development Application for conditions relating to the LOT and to approved Operational Works drawings for services location and possible easements.

THESE DESIGNS AND DRAWINGS ARE COPYRIGHT AND ARE NOT TO BE USED OR REPRODUCED WITHOUT THE WRITTEN PERMISSION OF VERIS

Data Sources
Cadastral Boundaries
30109-LC-Master(D0) F594 2014.dwg
Engineering Design
STAGE 5E BASE - 02 05 2023.dwg
Final Surface Contours
FLAGSTONE - STAGE 5 - DISCLOSURE INFO - 02 05 2023 - Design Tm.dxf
Depth of Fill
FLAGSTONE - STAGE 5 - DISCLOSURE INFO - 02 05 2023 -
Retaining Wall
FLAGSTONE - 5 BEW - OPW - DRAFTSET - 27.04.23

Issue	Revisions	Date	Drawn
A	Original	06.07.2023	BK

Locality: FLAGSTONE
Local Authority: LOGAN CITY COUNCIL
Horizontal Meridian: MGA Zone 56
Vertical Level Datum: AHD D
Scale: 1:250 @ A4
Designed: Colliers
Drawn: BK 06/07/2023
Checked: DE 06/07/2023
Plot Date: 06 Jul, 2023
Computer File Ref: 30109-SISE-DP-(A).dwg

DISCLOSURE PLAN
of Proposed LOT 2171
being part of
Lot 911
on SP335845



veris

BRISBANE (07) 3686 4700 WHITSUNDAYS (07) 4945 6600

MACKAY (07) 4957 9700 CAIRNS (07) 4252 9400

veris.com.au
ACN 615 735 727
Veris Australia Pty Ltd

Drawing No
30109-DP- 2171
Issue
A

LEGEND

Final surface contours based on A.H.D. datum at an interval of 0.5m, shown as: 15.5

Where applicable, areas to be filled are shown as:

Depth of fill, in metres, shown as:- +0.5

Retaining wall and retaining wall height, shown on the lower side of the wall, have been taken from plans supplied by Colliers and shown as:

Bin Pad Location shown as:



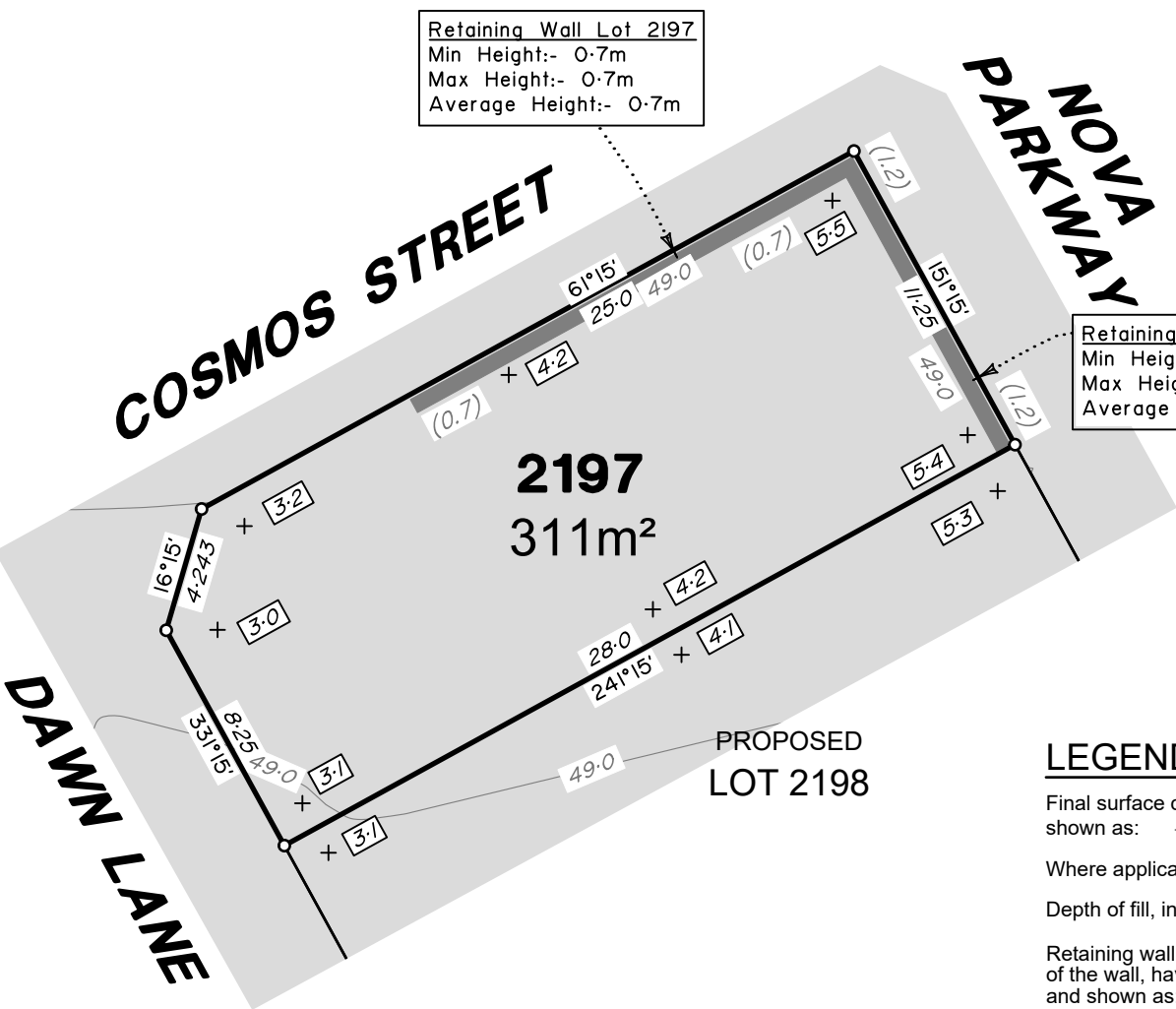

Retaining Wall Lot 2197
 Min Height:- 0.7m
 Max Height:- 0.7m
 Average Height:- 0.7m

Retaining Wall Lot 2197
 Min Height:- 1.2m
 Max Height:- 1.2m
 Average Height:- 1.2m

ADDITIONAL NOTES:

The LOT dimensions and area shown hereon are subject to final field survey and also to the requirements of Council and any other authority which may have requirements under any relevant legislation

Final surface contours shown hereon have been supplied by Colliers.

Location of retaining walls are as shown on Engineering design drawings. Their as-constructed location may differ from their design location. Retaining wall heights have been supplied by Colliers.

Compaction of any fill material placed on this site shall be completed to level one inspection and testing services in accordance with AS3798-2007.

Depth of fill values are calculated to the pre-development surface.

Copyright © Veris Australia Pty Ltd
 06/07/2023.

**FLAGSTONE
 PRECINCT 1 STAGE 5E**
 For
**PEET FLAGSTONE
 CITY PTY LTD**

IMPORTANT NOTES:
 (These notes are an integral part of this plan)
 This plan has been prepared for PEET FLAGSTONE CITY PTY LTD for the purposes of **A Disclosure Plan Under the Land Sales Act 1984 (as amended)**.
 It is not to be used by any other person or corporation or for any other purposes and is subject to the following limitations:

Please refer to the approved Development Application for conditions relating to the LOT and to approved Operational Works drawings for services location and possible easements.

THESE DESIGNS AND DRAWINGS ARE COPYRIGHT AND ARE NOT TO BE USED OR REPRODUCED WITHOUT THE WRITTEN PERMISSION OF VERIS

Data Sources
 Cadastral Boundaries
 30109-LC-Master(D0) F594 2014.dwg
 Engineering Design
 STAGE 5E BASE - 02 05 2023.dwg
 Final Surface Contours
 FLAGSTONE - STAGE 5 - DISCLOSURE INFO - 02 05 2023 - Design Tm.dxf
 Depth of Fill
 FLAGSTONE - STAGE 5 - DISCLOSURE INFO - 02 05 2023 -
 Retaining Wall
 FLAGSTONE - 5 BEW - OPW - DRAFTSET - 27.04.23

A	Original	06.07.2023	BK
Issue	Revisions	Date	Drawn

Locality: FLAGSTONE
 Local Authority: LOGAN CITY COUNCIL
 Horizontal Meridian: MGA Zone 56
 Vertical Level Datum: AHD D
 Scale: 1:250 @ A4
 Designed: Colliers
 Drawn: BK 06/07/2023
 Checked: DE 06/07/2023
 Plot Date: 06 Jul, 2023
 Computer File Ref: 30109-SISE-DP-(A).dwg

**DISCLOSURE PLAN
 of Proposed LOT 2197
 being part of
 Lot 911
 on SP335845**



BRISBANE (07) 3686 4700 WHITSUNDAYS (07) 4945 6600
 MACKAY (07) 4957 9700 CAIRNS (07) 4252 9400
 veris.com.au
 ACN 615 735 727
 Veris Australia Pty Ltd

Drawing No 30109-DP- 2197 Issue A

LEGEND

Final surface contours based on A.H.D. datum at an interval of 0.5m, shown as: 15.5

Where applicable, areas to be filled are shown as:

Depth of fill, in metres, shown as:- +0.5

Retaining wall and retaining wall height, shown on the lower side of the wall, have been taken from plans supplied by Colliers and shown as: (1.2)

Bin Pad Location shown as:

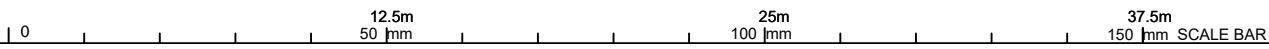

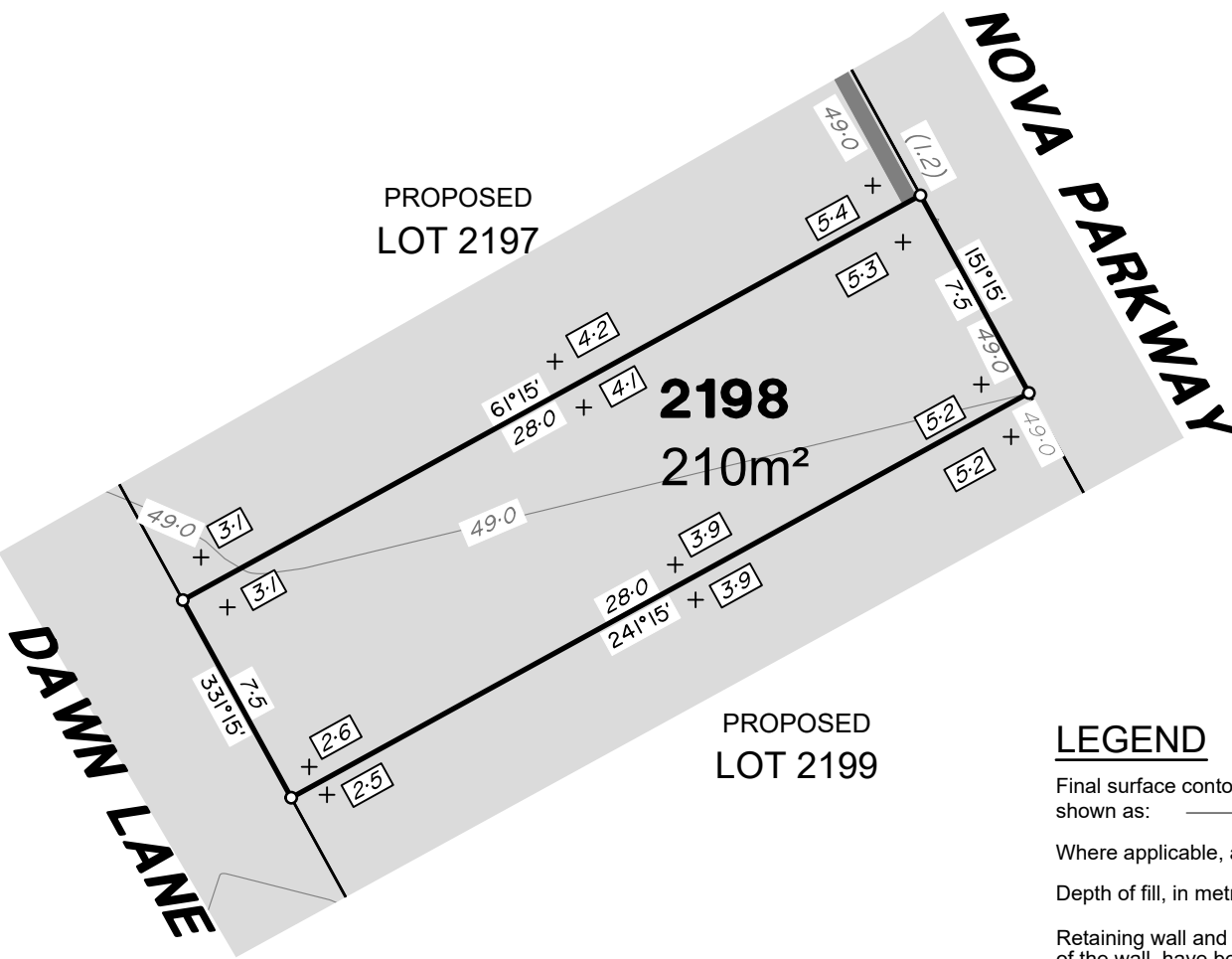

ADDITIONAL NOTES:

The LOT dimensions and area shown hereon are subject to final field survey and also to the requirements of Council and any other authority which may have requirements under any relevant legislation

Final surface contours shown hereon have been supplied by Colliers.

Location of retaining walls are as shown on Engineering design drawings. Their as-constructed location may differ from their design location. Retaining wall heights have been supplied by Colliers.

Compaction of any fill material placed on this site shall be completed to level one inspection and testing services in accordance with AS3798-2007.

Depth of fill values are calculated to the pre-development surface.

Copyright © Veris Australia Pty Ltd
06/07/2023.

**FLAGSTONE
PRECINCT 1 STAGE 5E**
For
**PEET FLAGSTONE
CITY PTY LTD**

IMPORTANT NOTES:
(These notes are an integral part of this plan)
This plan has been prepared for PEET FLAGSTONE CITY PTY LTD for the purposes of **A Disclosure Plan Under the Land Sales Act 1984 (as amended)**.
It is not to be used by any other person or corporation or for any other purposes and is subject to the following limitations:

Please refer to the approved Development Application for conditions relating to the LOT and to approved Operational Works drawings for services location and possible easements.

THESE DESIGNS AND DRAWINGS ARE COPYRIGHT AND ARE NOT TO BE USED OR REPRODUCED WITHOUT THE WRITTEN PERMISSION OF VERIS

- Data Sources**
Cadastral Boundaries
30109-LC-Master(D0) F594 2014.dwg
Engineering Design
STAGE 5E BASE - 02 05 2023.dwg
Final Surface Contours
FLAGSTONE - STAGE 5 - DISCLOSURE INFO - 02 05 2023 - Design Tm.dxf
Depth of Fill
FLAGSTONE - STAGE 5 - DISCLOSURE INFO - 02 05 2023 -
Retaining Wall
FLAGSTONE - 5 BEW - OPW - DRAFTSET - 27.04.23

Issue	Revisions	Date	BK	Drawn
A	Original	06.07.2023	BK	

Locality: FLAGSTONE
Local Authority: LOGAN CITY COUNCIL
Horizontal Meridian: MGA Zone 56
Vertical Level Datum: AHD D
Scale: 1:250 @ A4
Designed: Colliers
Drawn: BK 06/07/2023
Checked: DE 06/07/2023
Plot Date: 06 Jul, 2023
Computer File Ref: 30109-St5E-DP-(A).dwg

**DISCLOSURE PLAN
of Proposed LOT 2198
being part of
Lot 911
on SP335845**



BRISBANE (07) 3686 4700 WHITSUNDAYS (07) 4945 6600
MACKAY (07) 4957 9700 CAIRNS (07) 4252 9400
veris.com.au
ACN 615 735 727
Veris Australia Pty Ltd

Drawing No: 30109-DP- 2198 Issue: A

LEGEND

Final surface contours based on A.H.D. datum at an interval of 0.5m, shown as: 15.5

Where applicable, areas to be filled are shown as:

Depth of fill, in metres, shown as:- 0.5

Retaining wall and retaining wall height, shown on the lower side of the wall, have been taken from plans supplied by Colliers and shown as: (1.2)

Bin Pad Location shown as:



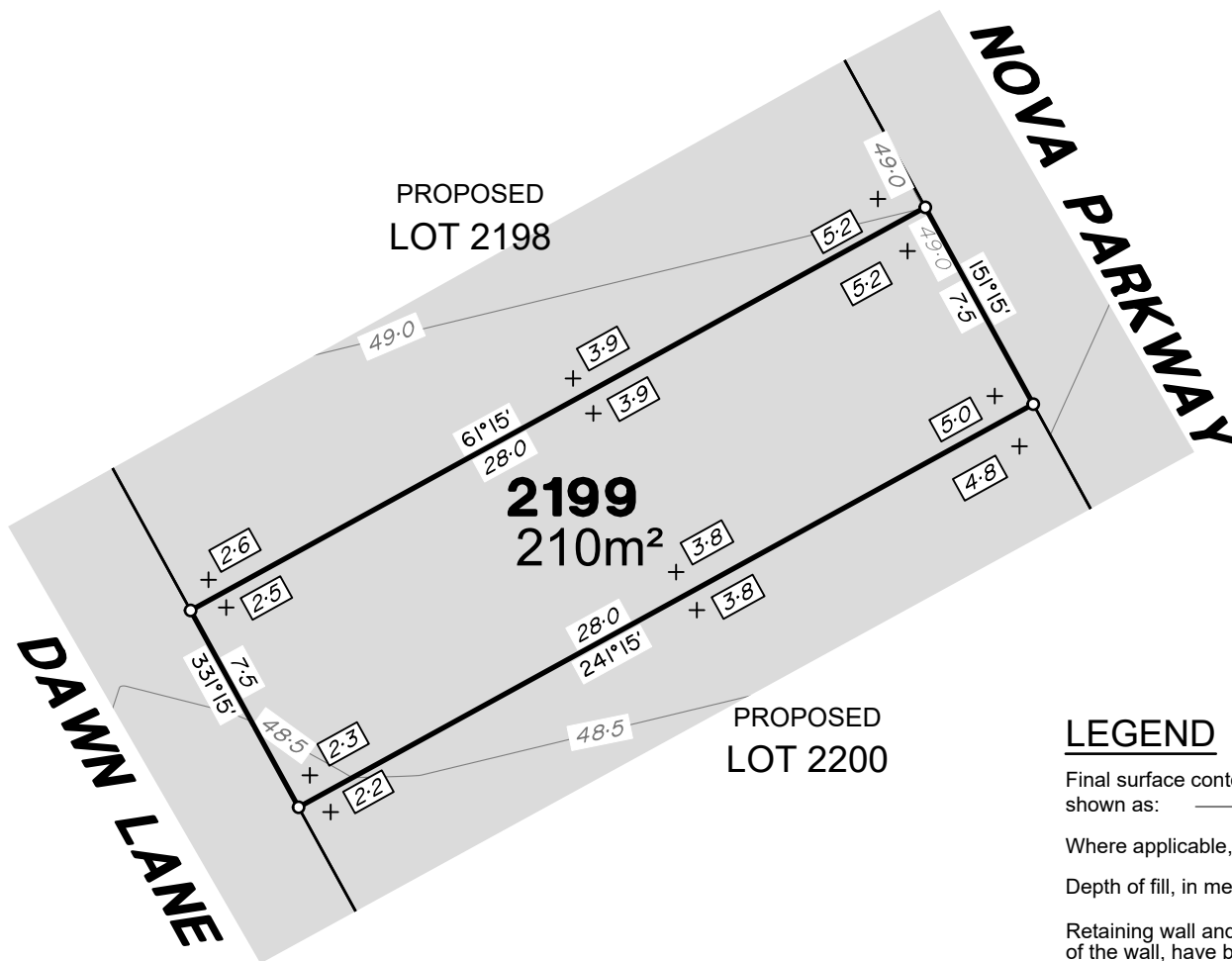

ADDITIONAL NOTES:

The LOT dimensions and area shown hereon are subject to final field survey and also to the requirements of Council and any other authority which may have requirements under any relevant legislation

Final surface contours shown hereon have been supplied by Colliers.

Location of retaining walls are as shown on Engineering design drawings. Their as-constructed location may differ from their design location. Retaining wall heights have been supplied by Colliers.

Compaction of any fill material placed on this site shall be completed to level one inspection and testing services in accordance with AS3798-2007.

Depth of fill values are calculated to the pre-development surface.

Copyright © Veris Australia Pty Ltd
06/07/2023.

**FLAGSTONE
PRECINCT 1 STAGE 5E**
For
**PEET FLAGSTONE
CITY PTY LTD**

IMPORTANT NOTES:

(These notes are an integral part of this plan)

This plan has been prepared for **PEET FLAGSTONE CITY PTY LTD** for the purposes of **A Disclosure Plan Under the Land Sales Act 1984 (as amended)**.

It is not to be used by any other person or corporation or for any other purposes and is subject to the following limitations:

Please refer to the approved Development Application for conditions relating to the LOT and to approved Operational Works drawings for services location and possible easements.

THESE DESIGNS AND DRAWINGS ARE COPYRIGHT AND ARE NOT TO BE USED OR REPRODUCED WITHOUT THE WRITTEN PERMISSION OF VERIS

Data Sources
Cadastral Boundaries
30109-LC-Master(D0) F594 2014.dwg
Engineering Design
STAGE 5E BASE - 02 05 2023.dwg
Final Surface Contours
FLAGSTONE - STAGE 5 - DISCLOSURE INFO - 02 05 2023 - Design Tm.dxf
Depth of Fill
FLAGSTONE - STAGE 5 - DISCLOSURE INFO - 02 05 2023 -
Retaining Wall
FLAGSTONE - 5 BEW - OPW - DRAFTSET - 27.04.23

Issue	Revisions	Date	Drawn
A	Original	06.07.2023	BK

Locality: FLAGSTONE
Local Authority: LOGAN CITY COUNCIL
Horizontal Meridian: MGA Zone 56
Vertical Level Datum: AHD D
Scale: 1:250 @ A4
Designed: Colliers
Drawn: BK 06/07/2023
Checked: DE 06/07/2023
Plot Date: 06 Jul, 2023
Computer File Ref: 30109-St5E-DP-(A).dwg

**DISCLOSURE PLAN
of Proposed LOT 2199
being part of
Lot 911
on SP335845**



BRISBANE (07) 3686 4700 WHITSUNDAYS (07) 4945 6600

MACKAY (07) 4957 9700 CAIRNS (07) 4252 9400

veris.com.au
ACN 615 735 727
Veris Australia Pty Ltd

Drawing No 30109-DP- 2199 Issue A

LEGEND

Final surface contours based on A.H.D. datum at an interval of 0.5m, shown as: 15.5

Where applicable, areas to be filled are shown as:

Depth of fill, in metres, shown as:- 0.5

Retaining wall and retaining wall height, shown on the lower side of the wall, have been taken from plans supplied by Colliers and shown as: (1.2)

Bin Pad Location shown as:



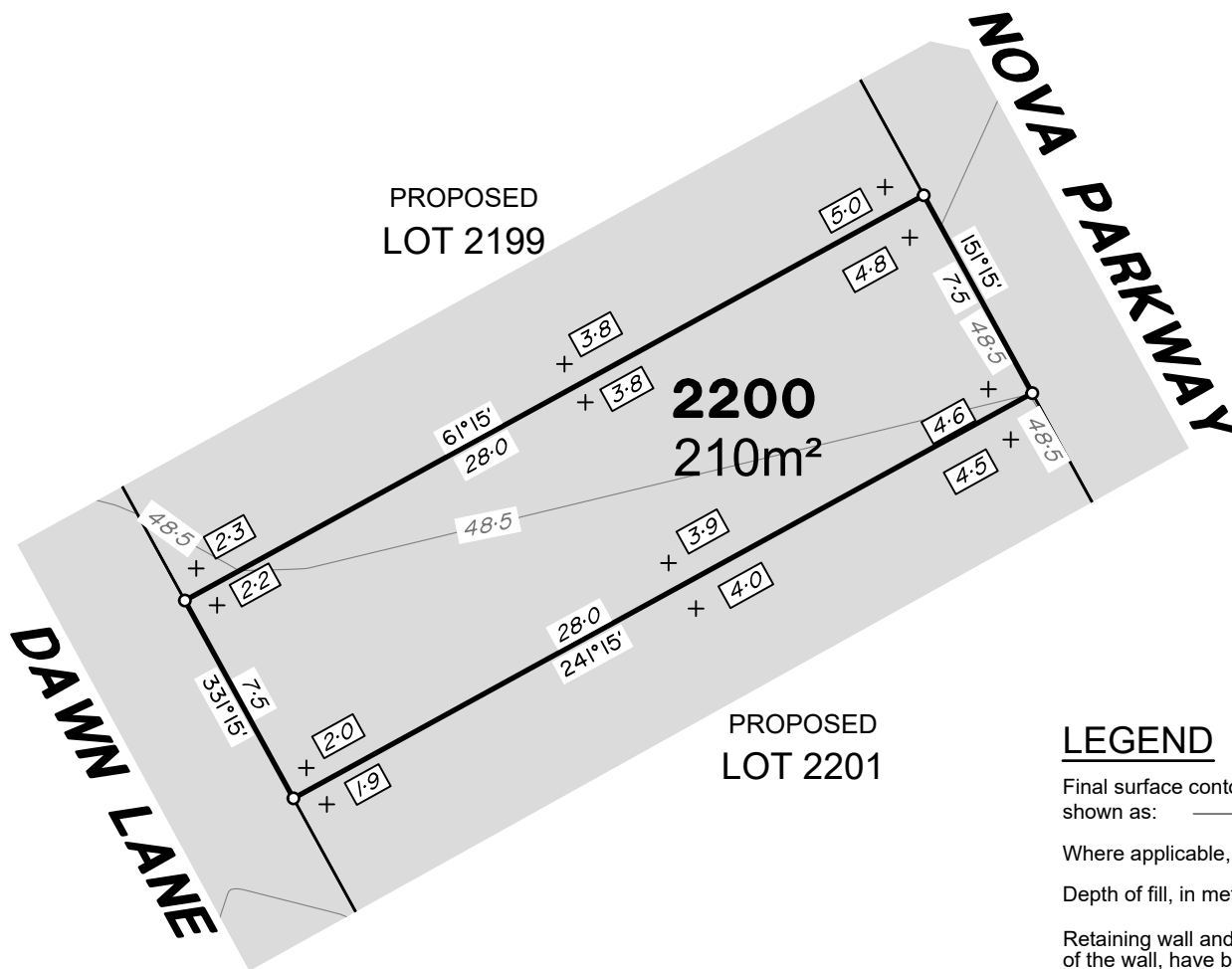

LEGEND

Final surface contours based on A.H.D. datum at an interval of 0.5m, shown as: 15.5

Where applicable, areas to be filled are shown as:

Depth of fill, in metres, shown as:- +0.5

Retaining wall and retaining wall height, shown on the lower side of the wall, have been taken from plans supplied by Colliers and shown as: (1.2)

Bin Pad Location shown as:

ADDITIONAL NOTES:

The LOT dimensions and area shown hereon are subject to final field survey and also to the requirements of Council and any other authority which may have requirements under any relevant legislation

Final surface contours shown hereon have been supplied by Colliers.

Location of retaining walls are as shown on Engineering design drawings. Their as-constructed location may differ from their design location. Retaining wall heights have been supplied by Colliers.

Compaction of any fill material placed on this site shall be completed to level one inspection and testing services in accordance with AS3798-2007.

Depth of fill values are calculated to the pre-development surface.

Copyright © Veris Australia Pty Ltd
06/07/2023.

FLAGSTONE PRECINCT 1 STAGE 5E

For
**PEET FLAGSTONE
CITY PTY LTD**

IMPORTANT NOTES:

(These notes are an integral part of this plan)

This plan has been prepared for **PEET FLAGSTONE CITY PTY LTD** for the purposes of **A Disclosure Plan Under the Land Sales Act 1984 (as amended)**.

It is not to be used by any other person or corporation or for any other purposes and is subject to the following limitations:

Please refer to the approved Development Application for conditions relating to the LOT and to approved Operational Works drawings for services location and possible easements.

THESE DESIGNS AND DRAWINGS ARE COPYRIGHT AND ARE NOT TO BE USED OR REPRODUCED WITHOUT THE WRITTEN PERMISSION OF VERIS

Data Sources
 Cadastral Boundaries
 30109-LC-Master(D0) F594 2014.dwg
 Engineering Design
 STAGE 5E BASE - 02 05 2023.dwg
 Final Surface Contours
 FLAGSTONE - STAGE 5 - DISCLOSURE INFO - 02 05 2023 - Design Tm.dxf
 Depth of Fill
 FLAGSTONE - STAGE 5 - DISCLOSURE INFO - 02 05 2023 -
 Retaining Wall
 FLAGSTONE - 5 BEW - OPW - DRAFTSET - 27.04.23

Issue/Revisions	Date	BK	Drawn
A	Original	06.07.2023	BK

Locality: FLAGSTONE
 Local Authority: LOGAN CITY COUNCIL
 Horizontal Meridian: MGA Zone 56
 Vertical Level Datum: AHD D
 Scale: 1:250 @ A4
 Designed: Colliers
 Drawn: BK 06/07/2023
 Checked: DE 06/07/2023
 Plot Date: 06 Jul, 2023
 Computer File Ref: 30109-St5E-DP-(A).dwg

DISCLOSURE PLAN
 of Proposed LOT 2200
 being part of
 Lot 911
 on SP335845



veris

BRISBANE (07) 3686 4700 WHITSUNDAYS (07) 4945 6600

MACKAY (07) 4957 9700 CAIRNS (07) 4252 9400

veris.com.au
 ACN 615 735 727
 Veris Australia Pty Ltd

Drawing No
30109-DP- 2200

Issue
A



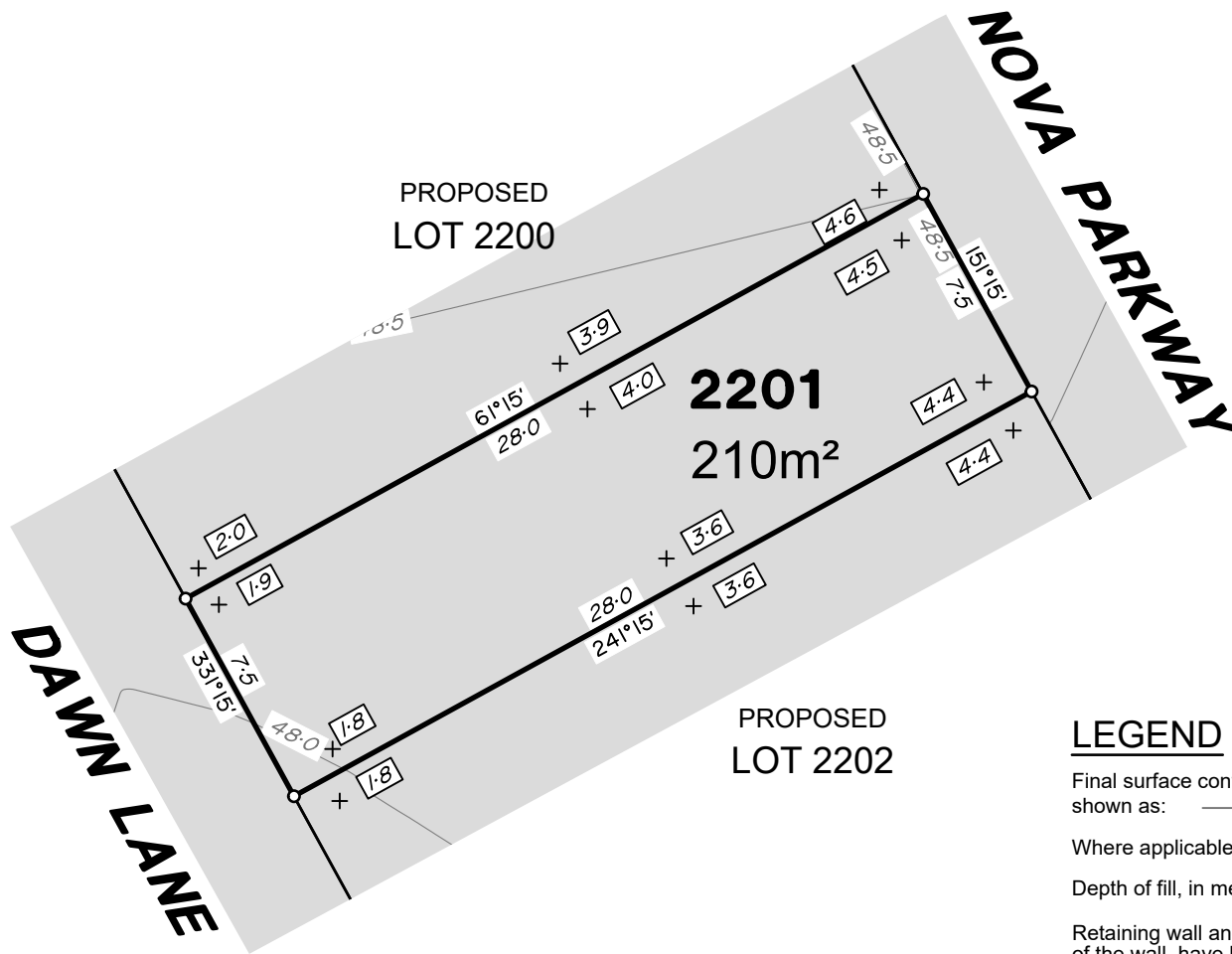

ADDITIONAL NOTES:

The LOT dimensions and area shown hereon are subject to final field survey and also to the requirements of Council and any other authority which may have requirements under any relevant legislation

Final surface contours shown hereon have been supplied by Colliers.

Location of retaining walls are as shown on Engineering design drawings. Their as-constructed location may differ from their design location. Retaining wall heights have been supplied by Colliers.

Compaction of any fill material placed on this site shall be completed to level one inspection and testing services in accordance with AS3798-2007.

Depth of fill values are calculated to the pre-development surface.

Copyright © Veris Australia Pty Ltd
06/07/2023.

**FLAGSTONE
PRECINCT 1 STAGE 5E**
For
**PEET FLAGSTONE
CITY PTY LTD**

IMPORTANT NOTES:

(These notes are an integral part of this plan)

This plan has been prepared for **PEET FLAGSTONE CITY PTY LTD** for the purposes of **A Disclosure Plan Under the Land Sales Act 1984 (as amended)**.

It is not to be used by any other person or corporation or for any other purposes and is subject to the following limitations:

Please refer to the approved Development Application for conditions relating to the LOT and to approved Operational Works drawings for services location and possible easements.

THESE DESIGNS AND DRAWINGS ARE COPYRIGHT AND ARE NOT TO BE USED OR REPRODUCED WITHOUT THE WRITTEN PERMISSION OF VERIS

Data Sources
 Cadastral Boundaries
 30109-LC-Master(D0) F594 2014.dwg
 Engineering Design
 STAGE 5E BASE - 02 05 2023.dwg
 Final Surface Contours
 FLAGSTONE - STAGE 5 - DISCLOSURE INFO - 02 05 2023 - Design Tm.dxf
 Depth of Fill
 FLAGSTONE - STAGE 5 - DISCLOSURE INFO - 02 05 2023 -
 Retaining Wall
 FLAGSTONE - 5 BEW - OPW - DRAFTSET - 27.04.23

Issue	Revisions	Date	Drawn
A	Original	06.07.2023	BK

Locality: FLAGSTONE
 Local Authority: LOGAN CITY COUNCIL
 Horizontal Meridian: MGA Zone 56
 Vertical Level Datum: AHD D
 Scale: 1:250 @ A4
 Designed: Colliers
 Drawn: BK 06/07/2023
 Checked: DE 06/07/2023
 Plot Date: 06 Jul, 2023
 Computer File Ref: 30109-St5E-DP-(A).dwg

**DISCLOSURE PLAN
of Proposed LOT 2201
being part of
Lot 911
on SP335845**



BRISBANE (07) 3686 4700 WHITSUNDAYS (07) 4945 6600

MACKAY (07) 4957 9700 CAIRNS (07) 4252 9400

veris.com.au
ACN 615 735 727
Veris Australia Pty Ltd

Drawing No
30109-DP- 2201

Issue
A

LEGEND

Final surface contours based on A.H.D. datum at an interval of 0.5m, shown as: 15.5

Where applicable, areas to be filled are shown as:

Depth of fill, in metres, shown as:- +0.5

Retaining wall and retaining wall height, shown on the lower side of the wall, have been taken from plans supplied by Colliers and shown as: (1.2)

Bin Pad Location shown as:



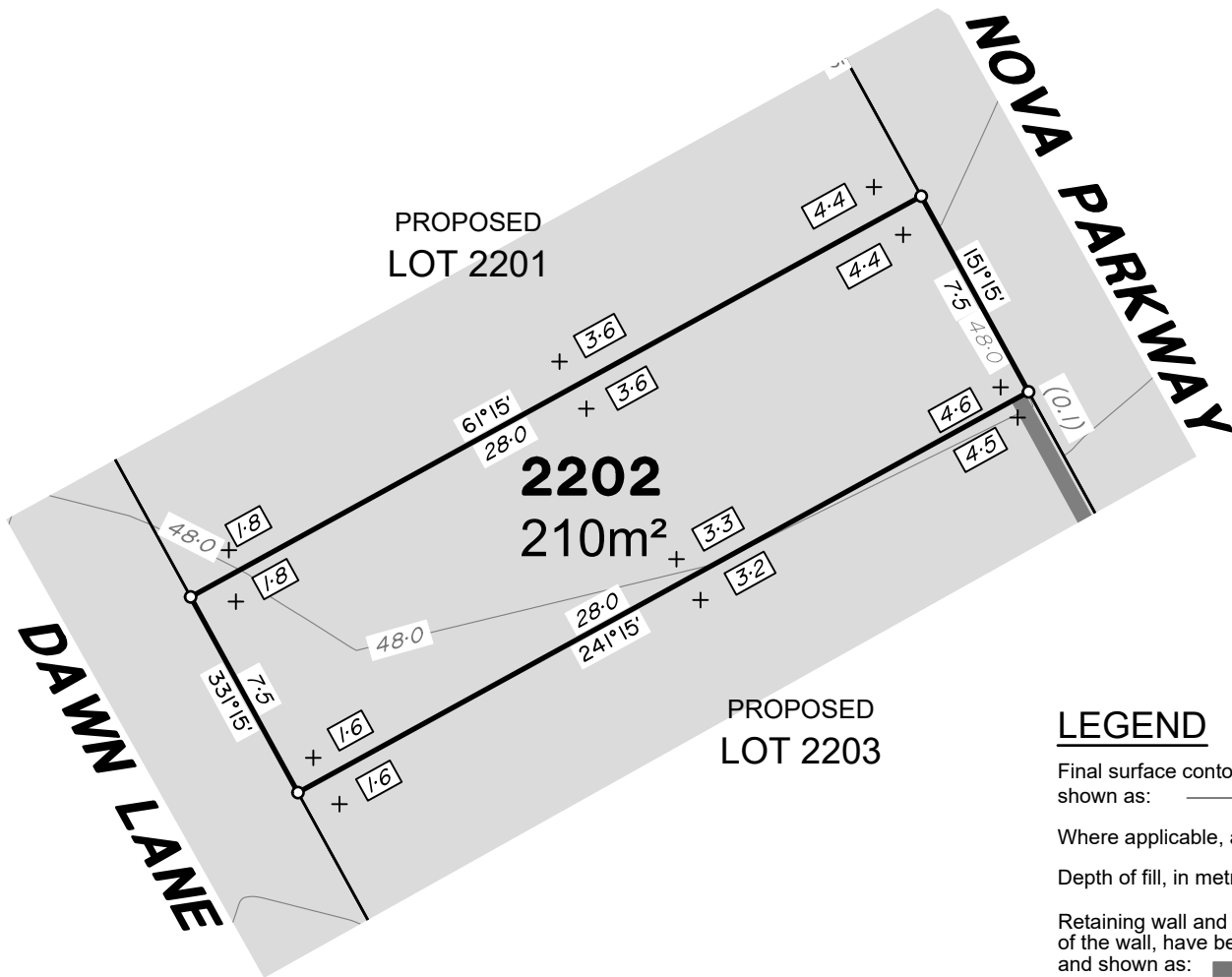

ADDITIONAL NOTES:

The LOT dimensions and area shown hereon are subject to final field survey and also to the requirements of Council and any other authority which may have requirements under any relevant legislation

Final surface contours shown hereon have been supplied by Colliers.

Location of retaining walls are as shown on Engineering design drawings. Their as-constructed location may differ from their design location. Retaining wall heights have been supplied by Colliers.

Compaction of any fill material placed on this site shall be completed to level one inspection and testing services in accordance with AS3798-2007.

Depth of fill values are calculated to the pre-development surface.

Copyright © Veris Australia Pty Ltd
06/07/2023.

LEGEND

Final surface contours based on A.H.D. datum at an interval of 0.5m, shown as: 15.5

Where applicable, areas to be filled are shown as:

Depth of fill, in metres, shown as:- +0.5

Retaining wall and retaining wall height, shown on the lower side of the wall, have been taken from plans supplied by Colliers and shown as: (1.2)

Bin Pad Location shown as:

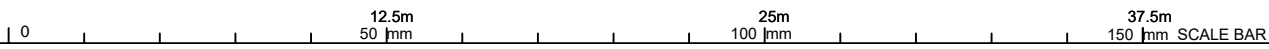

**FLAGSTONE
PRECINCT 1 STAGE 5E**
For
**PEET FLAGSTONE
CITY PTY LTD**

IMPORTANT NOTES:
(These notes are an integral part of this plan)

This plan has been prepared for PEET FLAGSTONE CITY PTY LTD for the purposes of **A Disclosure Plan Under the Land Sales Act 1984 (as amended)**.

It is not to be used by any other person or corporation or for any other purposes and is subject to the following limitations:

Please refer to the approved Development Application for conditions relating to the LOT and to approved Operational Works drawings for services location and possible easements.

THESE DESIGNS AND DRAWINGS ARE COPYRIGHT AND ARE NOT TO BE USED OR REPRODUCED WITHOUT THE WRITTEN PERMISSION OF VERIS

Data Sources

Cadastral Boundaries
30109-LC-Master(D0) F594 2014.dwg

Engineering Design
STAGE 5E BASE - 02 05 2023.dwg

Final Surface Contours
FLAGSTONE - STAGE 5 - DISCLOSURE INFO - 02 05 2023 - Design Tm.dxf

Depth of Fill
FLAGSTONE - STAGE 5 - DISCLOSURE INFO - 02 05 2023 -

Retaining Wall
FLAGSTONE - 5 BEW - OPW - DRAFTSET - 27.04.23

Issue	Revisions	Date	Drawn
A	Original	06.07.2023	BK

Locality: FLAGSTONE
Local Authority: LOGAN CITY COUNCIL
Horizontal Meridian: MGA Zone 56
Vertical Level Datum: AHD D
Scale: 1:250 @ A4
Designed: Colliers
Drawn: BK 06/07/2023
Checked: DE 06/07/2023
Plot Date: 06 Jul, 2023
Computer File Ref: 30109-St5E-DP-(A).dwg

**DISCLOSURE PLAN
of Proposed LOT 2202
being part of
Lot 911
on SP335845**



veris

BRISBANE (07) 3686 4700 WHITSUNDAYS (07) 4945 6600
MACKAY (07) 4957 9700 CAIRNS (07) 4252 9400

veris.com.au
ACN 615 735 727
Veris Australia Pty Ltd

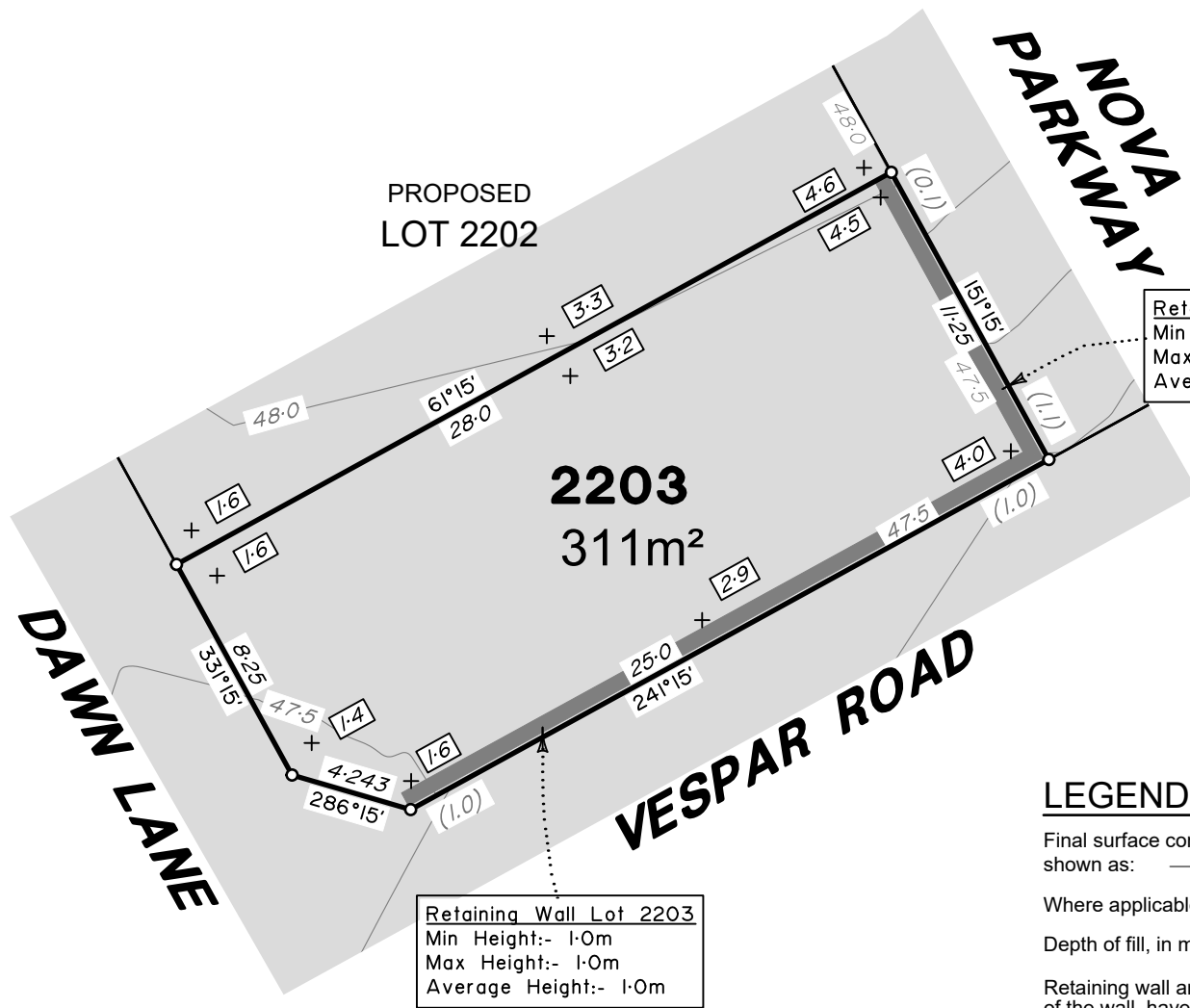

PROPOSED
LOT 2202

2203
311m²

Retaining Wall Lot 2203
Min Height:- 0.1m
Max Height:- 1.1m
Average Height:- 0.6m

Retaining Wall Lot 2203
Min Height:- 1.0m
Max Height:- 1.0m
Average Height:- 1.0m

ADDITIONAL NOTES:

The LOT dimensions and area shown hereon are subject to final field survey and also to the requirements of Council and any other authority which may have requirements under any relevant legislation

Final surface contours shown hereon have been supplied by Colliers.

Location of retaining walls are as shown on Engineering design drawings. Their as-constructed location may differ from their design location. Retaining wall heights have been supplied by Colliers.

Compaction of any fill material placed on this site shall be completed to level one inspection and testing services in accordance with AS3798-2007.

Depth of fill values are calculated to the pre-development surface.

Copyright © Veris Australia Pty Ltd
06/07/2023.

LEGEND

Final surface contours based on A.H.D. datum at an interval of 0.5m, shown as: 15.5

Where applicable, areas to be filled are shown as:

Depth of fill, in metres, shown as:- 0.5

Retaining wall and retaining wall height, shown on the lower side of the wall, have been taken from plans supplied by Colliers and shown as: (1.2)

Bin Pad Location shown as:

**FLAGSTONE
PRECINCT 1 STAGE 5E**
For
**PEET FLAGSTONE
CITY PTY LTD**

IMPORTANT NOTES:

(These notes are an integral part of this plan)

This plan has been prepared for PEET FLAGSTONE CITY PTY LTD for the purposes of **A Disclosure Plan Under the Land Sales Act 1984 (as amended)**.

It is not to be used by any other person or corporation or for any other purposes and is subject to the following limitations:

Please refer to the approved Development Application for conditions relating to the LOT and to approved Operational Works drawings for services location and possible easements.

THESE DESIGNS AND DRAWINGS ARE COPYRIGHT AND ARE NOT TO BE USED OR REPRODUCED WITHOUT THE WRITTEN PERMISSION OF VERIS

Data Sources
Cadastral Boundaries
30109-LC-Master(D0) F594 2014.dwg
Engineering Design
STAGE 5E BASE - 02 05 2023.dwg
Final Surface Contours
FLAGSTONE - STAGE 5 - DISCLOSURE INFO - 02 05 2023 - Design Tm.dxf
Depth of Fill
FLAGSTONE - STAGE 5 - DISCLOSURE INFO - 02 05 2023 - Retaining Wall
FLAGSTONE - 5 BEW - OPW - DRAFTSET - 27.04.23

Issue	Revisions	Date	BK	Drawn
A	Original	06.07.2023	BK	

Locality: FLAGSTONE
Local Authority: LOGAN CITY COUNCIL
Horizontal Meridian: MGA Zone 56
Vertical Level Datum: AHD D
Scale: 1:250 @ A4
Designed: Colliers
Drawn: BK 06/07/2023
Checked: DE 06/07/2023
Plot Date: 06 Jul, 2023
Computer File Ref: 30109-SISE-DP-(A).dwg

DISCLOSURE PLAN
of Proposed LOT 2203
being part of
Lot 911
on SP335845



veris

BRISBANE (07) 3686 4700 WHITSUNDAYS (07) 4945 6600

MACKAY (07) 4957 9700 CAIRNS (07) 4252 9400

veris.com.au
ACN 615 735 727
Veris Australia Pty Ltd

Drawing No
30109-DP- 2203

Issue
A





COSMOS STREET

VESPAR ROAD



2345
479m²

**PROPOSED
LOT 2346**

Retaining Wall Lot 2346
Min Height:- 0.6m
Max Height:- 0.6m
Average Height:- 0.6m

Retaining Wall Lot 2267
Min Height:- 1.4m
Max Height:- 1.4m
Average Height:- 1.4m

ADDITIONAL NOTES:

The LOT dimensions and area shown hereon are subject to final field survey and also to the requirements of Council and any other authority which may have requirements under any relevant legislation

Final surface contours shown hereon have been supplied by Colliers.

Location of retaining walls are as shown on Engineering design drawings. Their as-constructed location may differ from their design location. Retaining wall heights have been supplied by Colliers.

Compaction of any fill material placed on this site shall be completed to level one inspection and testing services in accordance with AS3798-2007.

Depth of fill values are calculated to the pre-development surface.

Copyright © Veris Australia Pty Ltd
06/07/2023.

**FLAGSTONE
PRECINCT 1 STAGE 5E**

For
**PEET FLAGSTONE
CITY PTY LTD**

IMPORTANT NOTES:

(These notes are an integral part of this plan)

This plan has been prepared for **PEET FLAGSTONE CITY PTY LTD** for the purposes of **A Disclosure Plan Under the Land Sales Act 1984 (as amended)**.

It is not to be used by any other person or corporation or for any other purposes and is subject to the following limitations:

Please refer to the approved Development Application for conditions relating to the LOT and to approved Operational Works drawings for services location and possible easements.

THESE DESIGNS AND DRAWINGS ARE COPYRIGHT AND ARE NOT TO BE USED OR REPRODUCED WITHOUT THE WRITTEN PERMISSION OF VERIS

Data Sources
Cadastral Boundaries
30109-LC-Master(D0) F594 2014.dwg
Engineering Design
STAGE 5E BASE - 02 05 2023.dwg
Final Surface Contours
FLAGSTONE - STAGE 5 - DISCLOSURE INFO - 02 05 2023 - Design Tm.dxf
Depth of Fill
FLAGSTONE - STAGE 5 - DISCLOSURE INFO - 02 05 2023 -
Retaining Wall
FLAGSTONE - 5 BEW - OPW - DRAFTSET - 27.04.23

A	Original	06.07.2023	BK
Issue	Revisions	Date	Drawn

Locality: FLAGSTONE
Local Authority: LOGAN CITY COUNCIL
Horizontal Meridian: MGA Zone 56
Vertical Level Datum: AHD D
Scale: 1:250 @ A4
Designed: Colliers
Drawn: BK 06/07/2023
Checked: DE 06/07/2023
Plot Date: 06 Jul, 2023
Computer File Ref: 30109-St5E-DP-(A).dwg

**DISCLOSURE PLAN
of Proposed LOT 2345
being part of
Lot 911
on SP335845**



veris

BRISBANE (07) 3686 4700 WHITSUNDAYS (07) 4945 6600

MACKAY (07) 4957 9700 CAIRNS (07) 4252 9400

veris.com.au
ACN 615 735 727
Veris Australia Pty Ltd

Drawing No
30109-DP- 2345

Issue
A

LEGEND

Final surface contours based on A.H.D. datum at an interval of 0.5m, shown as: 15.5

Where applicable, areas to be filled are shown as:

Depth of fill, in metres, shown as:- 0.5

Retaining wall and retaining wall height, shown on the lower side of the wall, have been taken from plans supplied by Colliers and shown as: (1.2)

Bin Pad Location shown as:





COSMOS STREET

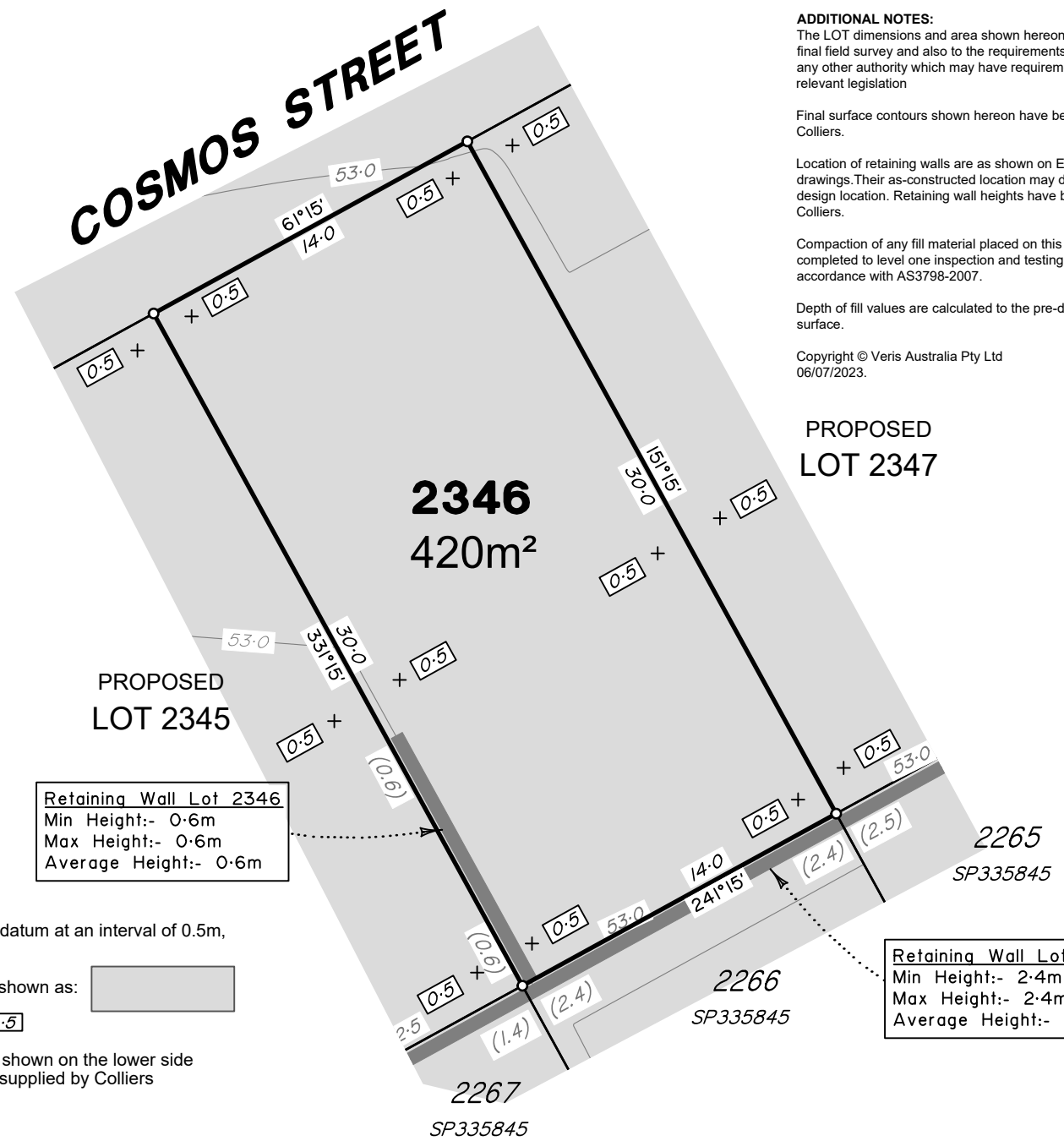

ADDITIONAL NOTES:
The LOT dimensions and area shown hereon are subject to final field survey and also to the requirements of Council and any other authority which may have requirements under any relevant legislation

Final surface contours shown hereon have been supplied by Colliers.

Location of retaining walls are as shown on Engineering design drawings. Their as-constructed location may differ from their design location. Retaining wall heights have been supplied by Colliers.

Compaction of any fill material placed on this site shall be completed to level one inspection and testing services in accordance with AS3798-2007.

Depth of fill values are calculated to the pre-development surface.

Copyright © Veris Australia Pty Ltd
06/07/2023.

PROPOSED LOT 2347

LEGEND

Final surface contours based on A.H.D. datum at an interval of 0.5m, shown as: 15.5

Where applicable, areas to be filled are shown as:

Depth of fill, in metres, shown as:- 0.5

Retaining wall and retaining wall height, shown on the lower side of the wall, have been taken from plans supplied by Colliers and shown as: (1.2)

Bin Pad Location shown as:

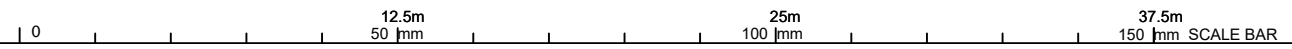

FLAGSTONE PRECINCT 1 STAGE 5E

For
**PEET FLAGSTONE
CITY PTY LTD**

IMPORTANT NOTES:
(These notes are an integral part of this plan)
This plan has been prepared for **PEET FLAGSTONE CITY PTY LTD** for the purposes of **A Disclosure Plan Under the Land Sales Act 1984 (as amended)**.
It is not to be used by any other person or corporation or for any other purposes and is subject to the following limitations:

Please refer to the approved Development Application for conditions relating to the LOT and to approved Operational Works drawings for services location and possible easements.

THESE DESIGNS AND DRAWINGS ARE COPYRIGHT AND ARE NOT TO BE USED OR REPRODUCED WITHOUT THE WRITTEN PERMISSION OF VERIS

Data Sources
Cadastral Boundaries
30109-LC-Master(D0) F594 2014.dwg
Engineering Design
STAGE 5E BASE - 02 05 2023.dwg
Final Surface Contours
FLAGSTONE - STAGE 5 - DISCLOSURE INFO - 02 05 2023 - Design Tm.dxf
Depth of Fill
FLAGSTONE - STAGE 5 - DISCLOSURE INFO - 02 05 2023 -
Retaining Wall
FLAGSTONE - 5 BEW - OPW - DRAFTSET - 27.04.23

Issue	Revisions	Date	BK	Drawn
A	Original	06.07.2023		

Locality: FLAGSTONE
Local Authority: LOGAN CITY COUNCIL
Horizontal Meridian: MGA Zone 56
Vertical Level Datum: AHD D
Scale: 1:250 @ A4
Designed: Colliers
Drawn: BK 06/07/2023
Checked: DE 06/07/2023
Plot Date: 06 Jul, 2023
Computer File Ref: 30109-SISE-DP-(A).dwg

DISCLOSURE PLAN of Proposed LOT 2346 being part of Lot 911 on SP335845



BRISBANE (07) 3686 4700 WHITSUNDAYS (07) 4945 6600
MACKAY (07) 4957 9700 CAIRNS (07) 4252 9400
veris.com.au
ACN 615 735 727
Veris Australia Pty Ltd



COSMOS STREET

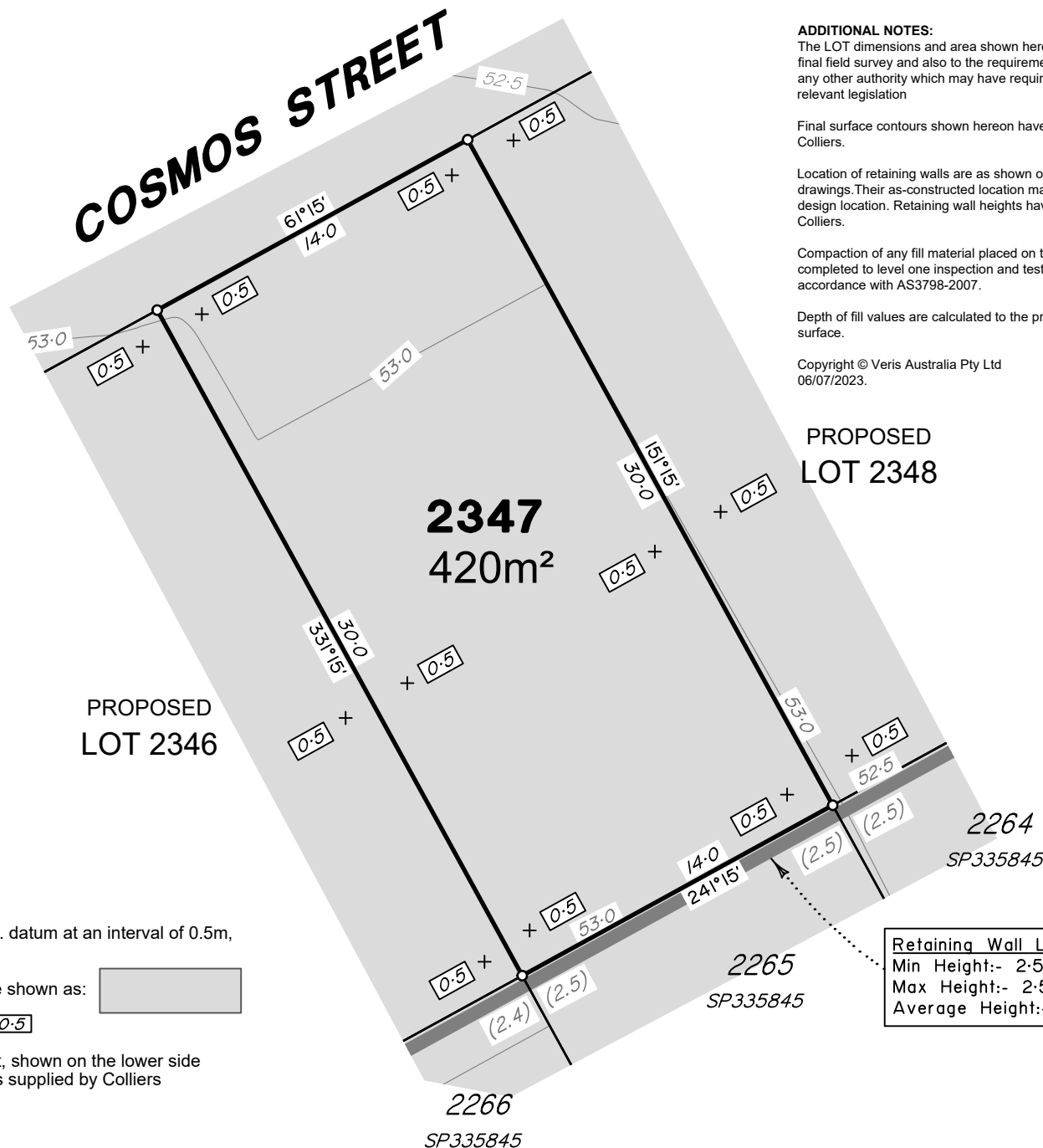

ADDITIONAL NOTES:

The LOT dimensions and area shown hereon are subject to final field survey and also to the requirements of Council and any other authority which may have requirements under any relevant legislation

Final surface contours shown hereon have been supplied by Colliers.

Location of retaining walls are as shown on Engineering design drawings. Their as-constructed location may differ from their design location. Retaining wall heights have been supplied by Colliers.

Compaction of any fill material placed on this site shall be completed to level one inspection and testing services in accordance with AS3798-2007.

Depth of fill values are calculated to the pre-development surface.

Copyright © Veris Australia Pty Ltd
06/07/2023.

FLAGSTONE PRECINCT 1 STAGE 5E

For
**PEET FLAGSTONE
CITY PTY LTD**

IMPORTANT NOTES:

(These notes are an integral part of this plan)

This plan has been prepared for **PEET FLAGSTONE CITY PTY LTD** for the purposes of **A Disclosure Plan Under the Land Sales Act 1984 (as amended)**.

It is not to be used by any other person or corporation or for any other purposes and is subject to the following limitations:

Please refer to the approved Development Application for conditions relating to the LOT and to approved Operational Works drawings for services location and possible easements.

THESE DESIGNS AND DRAWINGS ARE COPYRIGHT AND ARE NOT TO BE USED OR REPRODUCED WITHOUT THE WRITTEN PERMISSION OF VERIS

Data Sources
Cadastral Boundaries
30109-LC-Master(D0) F594 2014.dwg
Engineering Design
STAGE 5E BASE - 02 05 2023.dwg
Final Surface Contours
FLAGSTONE - STAGE 5 - DISCLOSURE INFO - 02 05 2023 - Design Tm.dxf
Depth of Fill
FLAGSTONE - STAGE 5 - DISCLOSURE INFO - 02 05 2023 -
Retaining Wall
FLAGSTONE - 5 BEW - OPW - DRAFTSET - 27.04.23

Issue	Revisions	Date	BK	Drawn
A	Original	06.07.2023	BK	

Locality: FLAGSTONE
Local Authority: LOGAN CITY COUNCIL
Horizontal Meridian: MGA Zone 56
Vertical Level Datum: AHD D
Scale: 1:250 @ A4
Designed: Colliers
Drawn: BK 06/07/2023
Checked: DE 06/07/2023
Plot Date: 06 Jul, 2023
Computer File Ref: 30109-St5E-DP-(A).dwg

DISCLOSURE PLAN
of Proposed LOT 2347
being part of
Lot 911
on SP335845



veris

BRISBANE (07) 3686 4700 WHITSUNDAYS (07) 4945 6600

MACKAY (07) 4957 9700 CAIRNS (07) 4252 9400

veris.com.au
ACN 615 735 727
Veris Australia Pty Ltd

Drawing No
30109-DP- 2347

Issue
A

LEGEND

Final surface contours based on A.H.D. datum at an interval of 0.5m, shown as: 15.5

Where applicable, areas to be filled are shown as:

Depth of fill, in metres, shown as:- 0.5

Retaining wall and retaining wall height, shown on the lower side of the wall, have been taken from plans supplied by Colliers and shown as: (1.2)

Bin Pad Location shown as:





COSMOS STREET

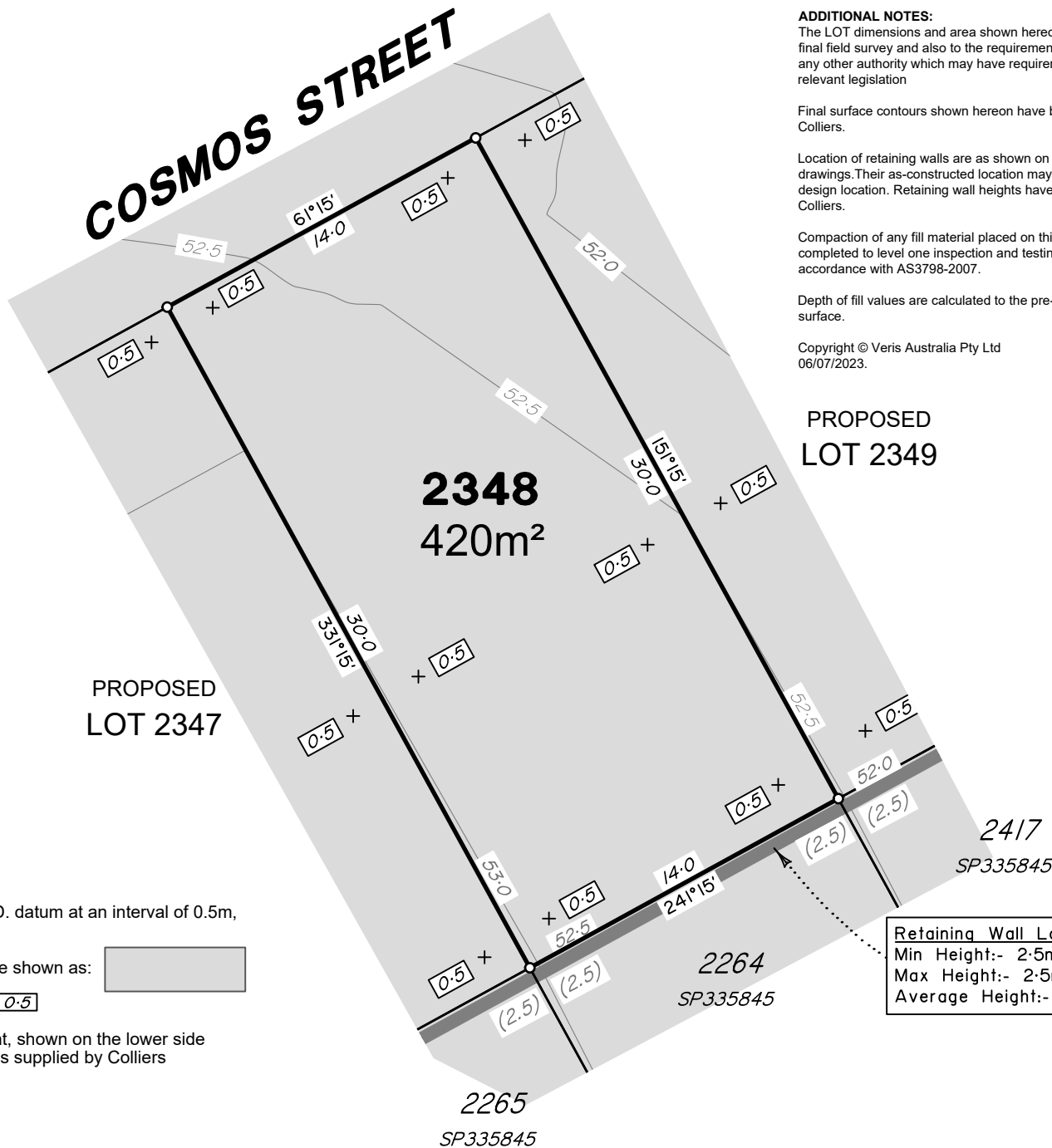

ADDITIONAL NOTES:

The LOT dimensions and area shown hereon are subject to final field survey and also to the requirements of Council and any other authority which may have requirements under any relevant legislation

Final surface contours shown hereon have been supplied by Colliers.

Location of retaining walls are as shown on Engineering design drawings. Their as-constructed location may differ from their design location. Retaining wall heights have been supplied by Colliers.

Compaction of any fill material placed on this site shall be completed to level one inspection and testing services in accordance with AS3798-2007.

Depth of fill values are calculated to the pre-development surface.

Copyright © Veris Australia Pty Ltd
06/07/2023.

PROPOSED LOT 2348

LEGEND

Final surface contours based on A.H.D. datum at an interval of 0.5m, shown as: 15.5

Where applicable, areas to be filled are shown as:

Depth of fill, in metres, shown as:- 0.5

Retaining wall and retaining wall height, shown on the lower side of the wall, have been taken from plans supplied by Colliers and shown as: (1.2)

Bin Pad Location shown as:

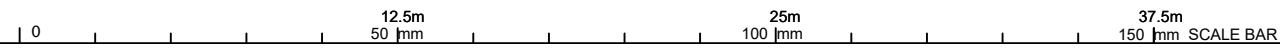

FLAGSTONE PRECINCT 1 STAGE 5E
For
PEET FLAGSTONE CITY PTY LTD

IMPORTANT NOTES:
(These notes are an integral part of this plan)
This plan has been prepared for PEET FLAGSTONE CITY PTY LTD for the purposes of **A Disclosure Plan Under the Land Sales Act 1984 (as amended)**.
It is not to be used by any other person or corporation or for any other purposes and is subject to the following limitations:

Please refer to the approved Development Application for conditions relating to the LOT and to approved Operational Works drawings for services location and possible easements.

THESE DESIGNS AND DRAWINGS ARE COPYRIGHT AND ARE NOT TO BE USED OR REPRODUCED WITHOUT THE WRITTEN PERMISSION OF VERIS

Data Sources
Cadastral Boundaries
30109-LC-Master(D0) F594 2014.dwg
Engineering Design
STAGE 5E BASE - 02 05 2023.dwg
Final Surface Contours
FLAGSTONE - STAGE 5 - DISCLOSURE INFO - 02 05 2023 - Design Tm.dxf
Depth of Fill
FLAGSTONE - STAGE 5 - DISCLOSURE INFO - 02 05 2023 -
Retaining Wall
FLAGSTONE - 5 BEW - OPW - DRAFTSET - 27.04.23

Issue	Revisions	Date	BK	Drawn
A	Original	06.07.2023	BK	

Locality: FLAGSTONE
Local Authority: LOGAN CITY COUNCIL
Horizontal Meridian: MGA Zone 56
Vertical Level Datum: AHD D
Scale: 1:250 @ A4
Designed: Colliers
Drawn: BK 06/07/2023
Checked: DE 06/07/2023
Plot Date: 06 Jul, 2023
Computer File Ref: 30109-SISE-DP-(A).dwg

DISCLOSURE PLAN
of Proposed LOT 2348
being part of
Lot 911
on SP335845



BRISBANE (07) 3686 4700 WHITSUNDAYS (07) 4945 6600
MACKAY (07) 4957 9700 CAIRNS (07) 4252 9400
veris.com.au
ACN 615 735 727
Veris Australia Pty Ltd

Drawing No 30109-DP- 2348 Issue A



COSMOS STREET

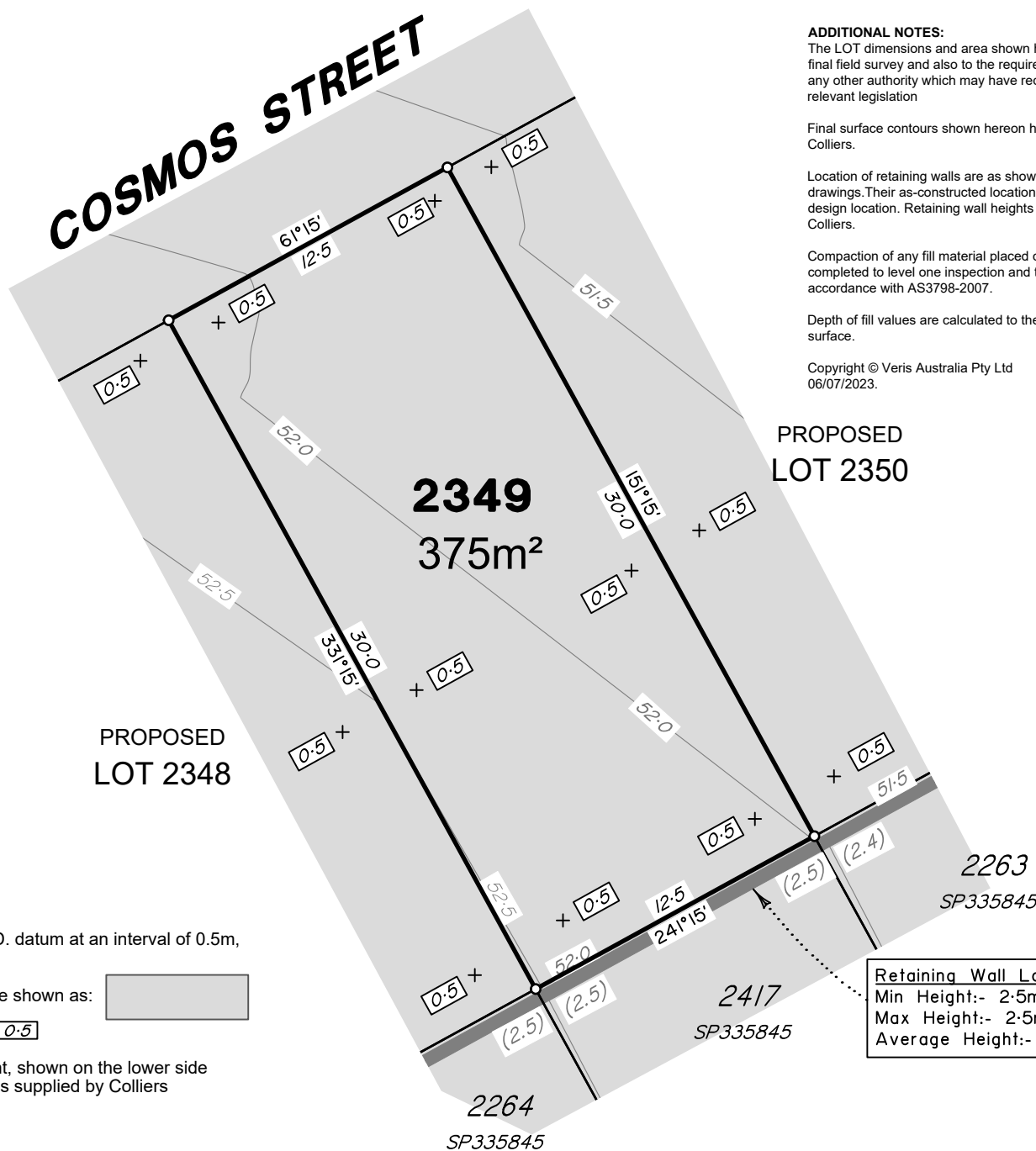

ADDITIONAL NOTES:

The LOT dimensions and area shown hereon are subject to final field survey and also to the requirements of Council and any other authority which may have requirements under any relevant legislation

Final surface contours shown hereon have been supplied by Colliers.

Location of retaining walls are as shown on Engineering design drawings. Their as-constructed location may differ from their design location. Retaining wall heights have been supplied by Colliers.

Compaction of any fill material placed on this site shall be completed to level one inspection and testing services in accordance with AS3798-2007.

Depth of fill values are calculated to the pre-development surface.

Copyright © Veris Australia Pty Ltd
06/07/2023.

FLAGSTONE PRECINCT 1 STAGE 5E

For
**PEET FLAGSTONE
CITY PTY LTD**

IMPORTANT NOTES:

(These notes are an integral part of this plan)

This plan has been prepared for **PEET FLAGSTONE CITY PTY LTD** for the purposes of **A Disclosure Plan Under the Land Sales Act 1984 (as amended)**.

It is not to be used by any other person or corporation or for any other purposes and is subject to the following limitations:

Please refer to the approved Development Application for conditions relating to the LOT and to approved Operational Works drawings for services location and possible easements.

THESE DESIGNS AND DRAWINGS ARE COPYRIGHT AND ARE NOT TO BE USED OR REPRODUCED WITHOUT THE WRITTEN PERMISSION OF VERIS

Data Sources

Cadastral Boundaries
30109-LC-Master(D0) F594 2014.dwg
Engineering Design
STAGE 5E BASE - 02 05 2023.dwg

Final Surface Contours

FLAGSTONE - STAGE 5 - DISCLOSURE INFO - 02 05 2023 - Design Tm.dxf

Depth of Fill

FLAGSTONE - STAGE 5 - DISCLOSURE INFO - 02 05 2023 -

Retaining Wall

FLAGSTONE - 5 BEW - OPW - DRAFTSET - 27.04.23

Issue	Revisions	Date	BK	Drawn
A	Original	06.07.2023	BK	

Locality: FLAGSTONE
Local Authority: LOGAN CITY COUNCIL
Horizontal Meridian: MGA Zone 56
Vertical Level Datum: AHD D
Scale: 1:250 @ A4
Designed: Colliers
Drawn: BK 06/07/2023
Checked: DE 06/07/2023
Plot Date: 06 Jul, 2023
Computer File Ref: 30109-ST5E-DP-(A).dwg

DISCLOSURE PLAN
of Proposed LOT 2349
being part of
Lot 911
on SP335845



veris

BRISBANE (07) 3686 4700
WHITSUNDAYS (07) 4945 6600
MACKAY (07) 4957 9700
CAIRNS (07) 4252 9400

veris.com.au
ACN 615 735 727
Veris Australia Pty Ltd

Drawing No
30109-DP- 2349

Issue
A

LEGEND

Final surface contours based on A.H.D. datum at an interval of 0.5m, shown as: 15.5

Where applicable, areas to be filled are shown as:

Depth of fill, in metres, shown as:- 0.5

Retaining wall and retaining wall height, shown on the lower side of the wall, have been taken from plans supplied by Colliers and shown as: (1.2)

Bin Pad Location shown as:





COSMOS STREET

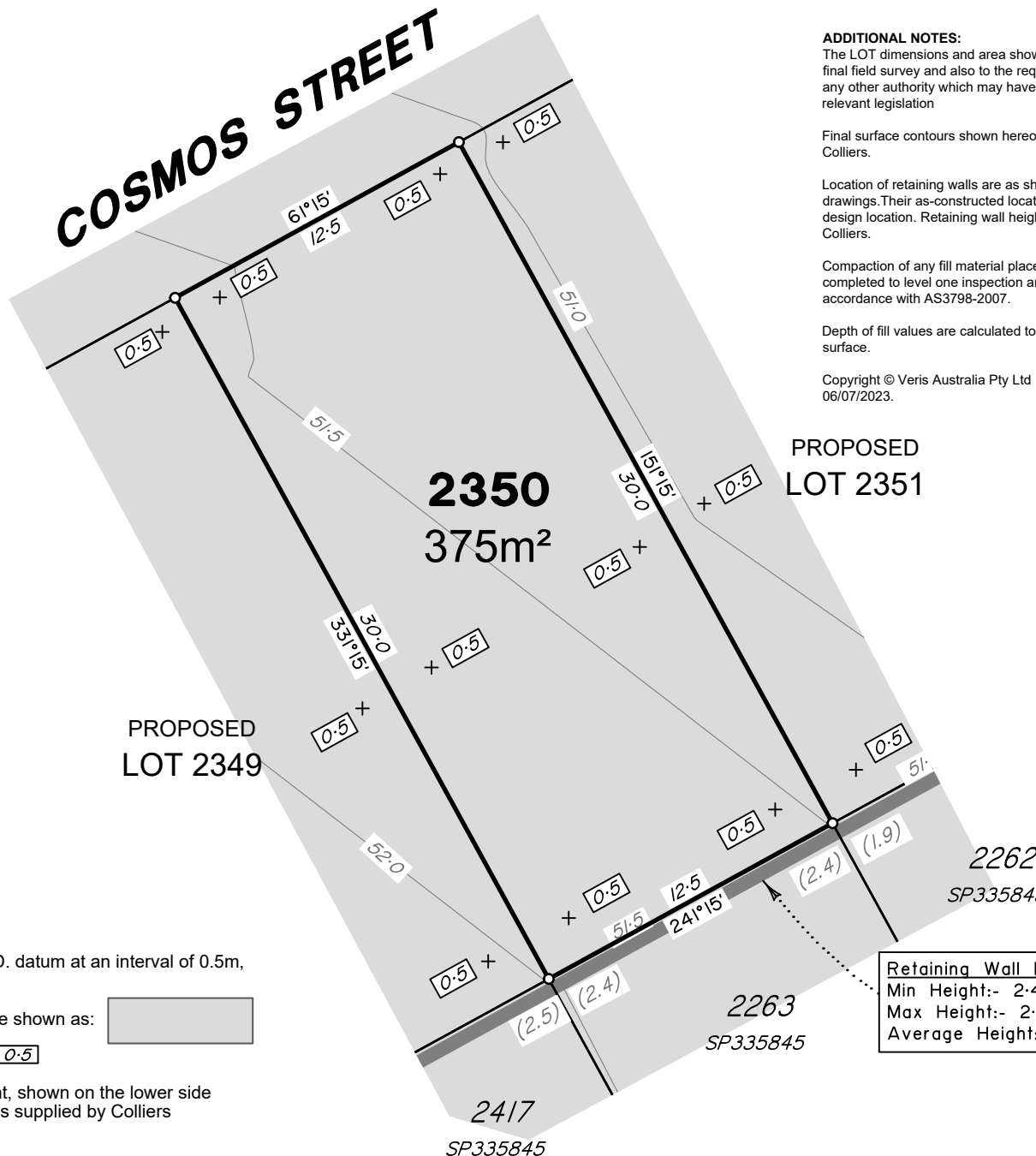

ADDITIONAL NOTES:

The LOT dimensions and area shown hereon are subject to final field survey and also to the requirements of Council and any other authority which may have requirements under any relevant legislation

Final surface contours shown hereon have been supplied by Colliers.

Location of retaining walls are as shown on Engineering design drawings. Their as-constructed location may differ from their design location. Retaining wall heights have been supplied by Colliers.

Compaction of any fill material placed on this site shall be completed to level one inspection and testing services in accordance with AS3798-2007.

Depth of fill values are calculated to the pre-development surface.

Copyright © Veris Australia Pty Ltd
06/07/2023.

PROPOSED
LOT 2351

2350
375m²

PROPOSED
LOT 2349

Retaining Wall Lot 2263
Min Height:- 2.4m
Max Height:- 2.4m
Average Height:- 2.4m

LEGEND

Final surface contours based on A.H.D. datum at an interval of 0.5m, shown as: 15.5

Where applicable, areas to be filled are shown as:

Depth of fill, in metres, shown as:- 0.5

Retaining wall and retaining wall height, shown on the lower side of the wall, have been taken from plans supplied by Colliers and shown as: (1.2)

Bin Pad Location shown as:



FLAGSTONE PRECINCT 1 STAGE 5E

For
**PEET FLAGSTONE
CITY PTY LTD**

IMPORTANT NOTES:

(These notes are an integral part of this plan)

This plan has been prepared for **PEET FLAGSTONE CITY PTY LTD** for the purposes of **A Disclosure Plan Under the Land Sales Act 1984 (as amended)**.

It is not to be used by any other person or corporation or for any other purposes and is subject to the following limitations:

Please refer to the approved Development Application for conditions relating to the LOT and to approved Operational Works drawings for services location and possible easements.

THESE DESIGNS AND DRAWINGS ARE COPYRIGHT AND ARE NOT TO BE USED OR REPRODUCED WITHOUT THE WRITTEN PERMISSION OF VERIS

Data Sources
Cadastral Boundaries
30109-LC-Master(D0) F594 2014.dwg
Engineering Design
STAGE 5E BASE - 02 05 2023.dwg
Final Surface Contours
FLAGSTONE - STAGE 5 - DISCLOSURE INFO - 02 05 2023 - Design Tm.dxf
Depth of Fill
FLAGSTONE - STAGE 5 - DISCLOSURE INFO - 02 05 2023 -
Retaining Wall
FLAGSTONE - 5 BEW - OPW - DRAFTSET - 27.04.23

Issue	Revisions	Date	BK	Drawn
A	Original	06.07.2023	BK	

Locality: FLAGSTONE
Local Authority: LOGAN CITY COUNCIL
Horizontal Meridian: MGA Zone 56
Vertical Level Datum: AHD D
Scale: 1:250 @ A4
Designed: Colliers
Drawn: BK 06/07/2023
Checked: DE 06/07/2023
Plot Date: 06 Jul, 2023
Computer File Ref: 30109-St5E-DP-(A).dwg

DISCLOSURE PLAN
of Proposed LOT 2350
being part of
Lot 911
on SP335845



veris

BRISBANE WHITSUNDAYS
(07) 3686 4700 (07) 4945 6600

MACKAY CAIRNS
(07) 4957 9700 (07) 4252 9400

veris.com.au
ACN 615 735 727
Veris Australia Pty Ltd

Drawing No Issue
30109-DP- 2350 A



COSMOS STREET

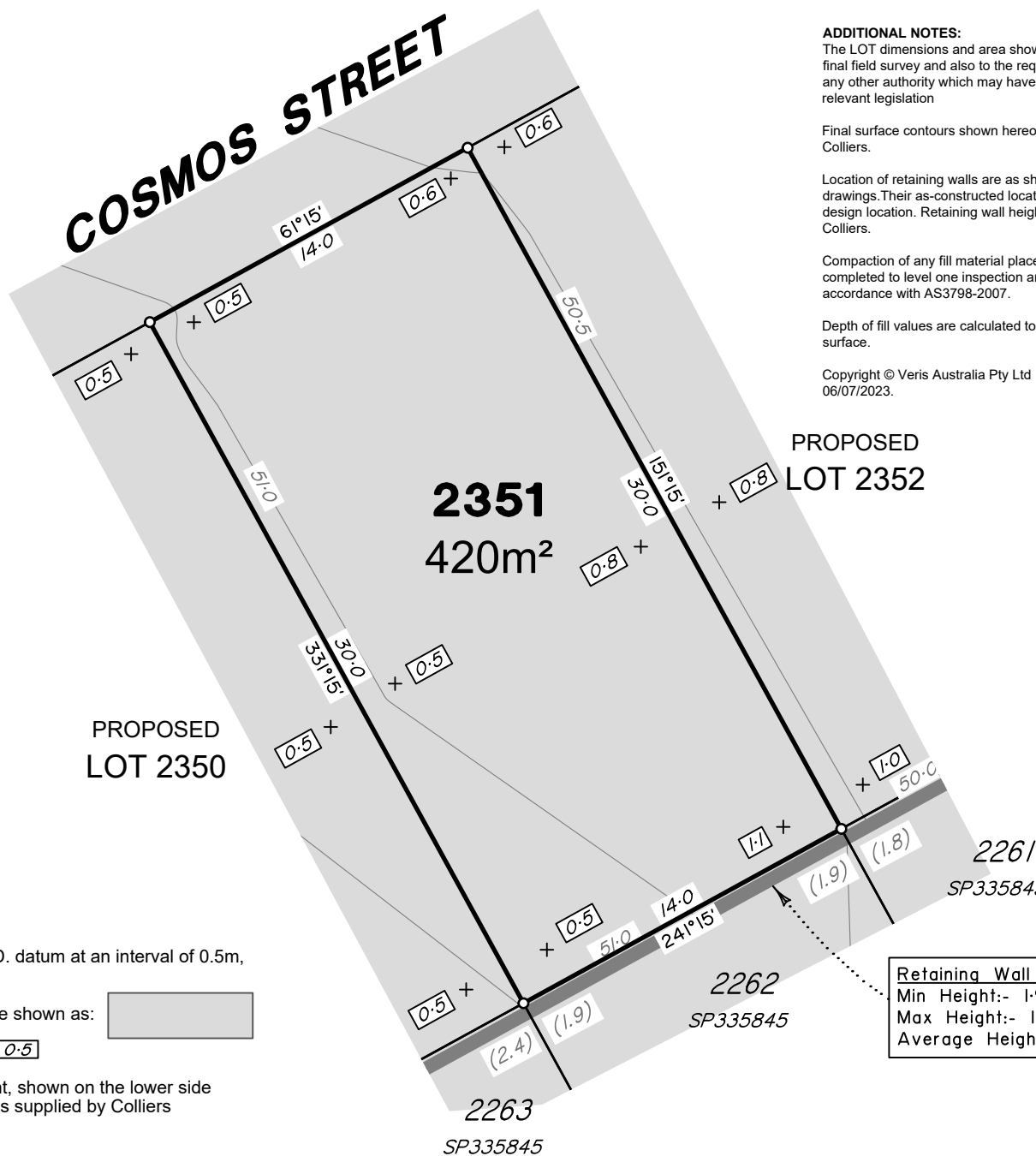

ADDITIONAL NOTES:

The LOT dimensions and area shown hereon are subject to final field survey and also to the requirements of Council and any other authority which may have requirements under any relevant legislation

Final surface contours shown hereon have been supplied by Colliers.

Location of retaining walls are as shown on Engineering design drawings. Their as-constructed location may differ from their design location. Retaining wall heights have been supplied by Colliers.

Compaction of any fill material placed on this site shall be completed to level one inspection and testing services in accordance with AS3798-2007.

Depth of fill values are calculated to the pre-development surface.

Copyright © Veris Australia Pty Ltd
06/07/2023.

PROPOSED
LOT 2352

2351
420m²

PROPOSED
LOT 2350

2261
SP335845

2262
SP335845

2263
SP335845

Retaining Wall Lot 2262
Min Height:- 1.9m
Max Height:- 1.9m
Average Height:- 1.9m

LEGEND

Final surface contours based on A.H.D. datum at an interval of 0.5m, shown as: 15.5

Where applicable, areas to be filled are shown as:

Depth of fill, in metres, shown as:- +0.5

Retaining wall and retaining wall height, shown on the lower side of the wall, have been taken from plans supplied by Colliers and shown as: (1.2)

Bin Pad Location shown as:



FLAGSTONE
PRECINCT 1 STAGE 5E
For
PEET FLAGSTONE
CITY PTY LTD

IMPORTANT NOTES:

(These notes are an integral part of this plan)

This plan has been prepared for PEET FLAGSTONE CITY PTY LTD for the purposes of **A Disclosure Plan Under the Land Sales Act 1984 (as amended)**.

It is not to be used by any other person or corporation or for any other purposes and is subject to the following limitations:

Please refer to the approved Development Application for conditions relating to the LOT and to approved Operational Works drawings for services location and possible easements.

THESE DESIGNS AND DRAWINGS ARE COPYRIGHT AND ARE NOT TO BE USED OR REPRODUCED WITHOUT THE WRITTEN PERMISSION OF VERIS

Data Sources
Cadastral Boundaries
30109-LC-Master(D0) F594 2014.dwg
Engineering Design
STAGE 5E BASE - 02 05 2023.dwg
Final Surface Contours
FLAGSTONE - STAGE 5 - DISCLOSURE INFO - 02 05 2023 - Design Tm.dxf
Depth of Fill
FLAGSTONE - STAGE 5 - DISCLOSURE INFO - 02 05 2023 -
Retaining Wall
FLAGSTONE - 5 BEW - OPW - DRAFTSET - 27.04.23

Issue	Revisions	Date	BK	Drawn
A	Original	06.07.2023	BK	

Locality: FLAGSTONE
Local Authority: LOGAN CITY COUNCIL
Horizontal Meridian: MGA Zone 56
Vertical Level Datum: AHD D
Scale: 1:250 @ A4
Designed: Colliers
Drawn: BK 06/07/2023
Checked: DE 06/07/2023
Plot Date: 06 Jul, 2023
Computer File Ref: 30109-SISE-DP-(A).dwg

DISCLOSURE PLAN
of Proposed LOT 2351
being part of
Lot 911
on SP335845



veris

BRISBANE (07) 3686 4700 WHITSUNDAYS (07) 4945 6600

MACKAY (07) 4957 9700 CAIRNS (07) 4252 9400

veris.com.au
ACN 615 735 727
Veris Australia Pty Ltd

Drawing No 30109-DP- 2351 Issue A



COSMOS STREET

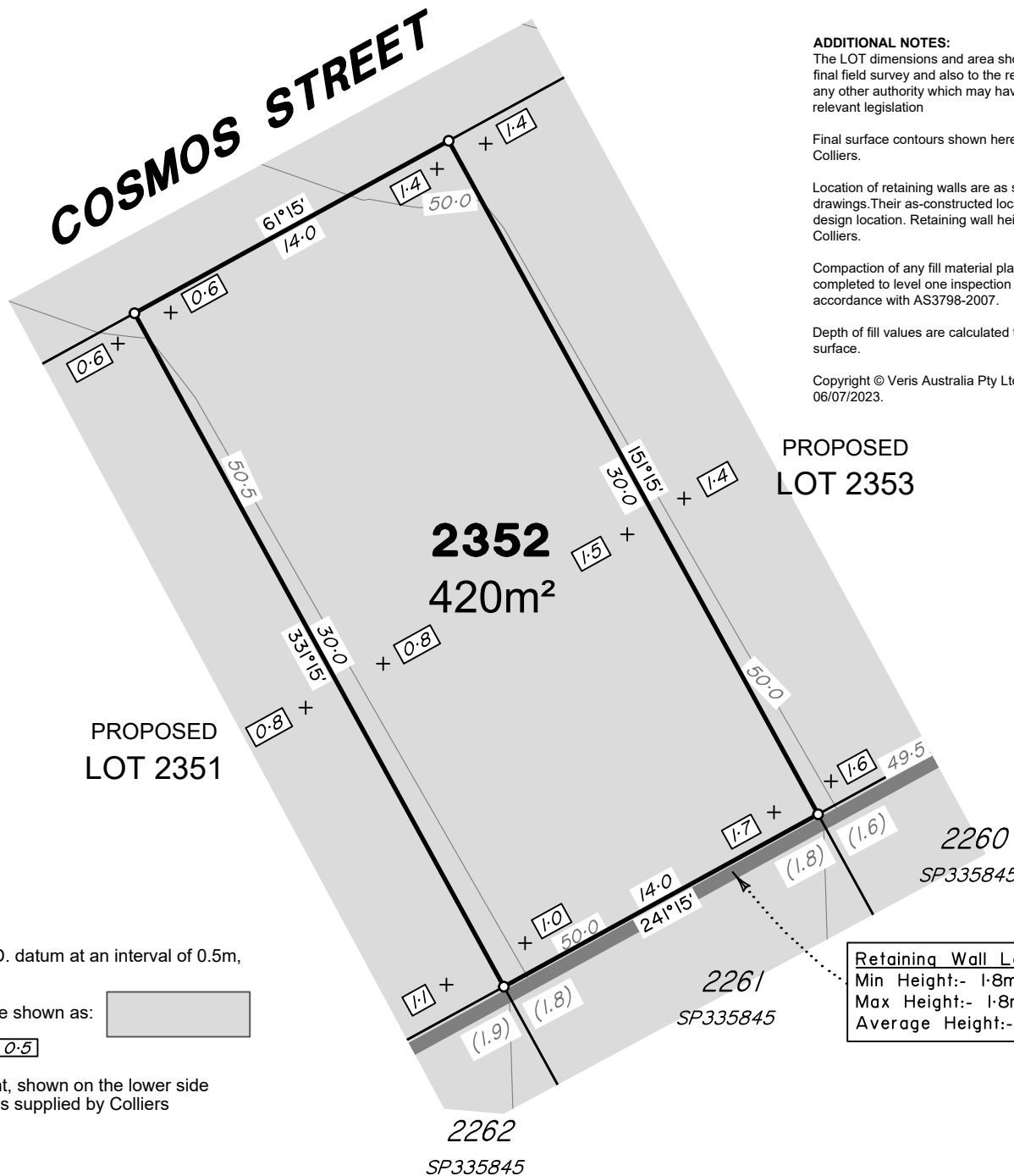

ADDITIONAL NOTES:

The LOT dimensions and area shown hereon are subject to final field survey and also to the requirements of Council and any other authority which may have requirements under any relevant legislation

Final surface contours shown hereon have been supplied by Colliers.

Location of retaining walls are as shown on Engineering design drawings. Their as-constructed location may differ from their design location. Retaining wall heights have been supplied by Colliers.

Compaction of any fill material placed on this site shall be completed to level one inspection and testing services in accordance with AS3798-2007.

Depth of fill values are calculated to the pre-development surface.

Copyright © Veris Australia Pty Ltd
06/07/2023.

PROPOSED LOT 2353

LEGEND

Final surface contours based on A.H.D. datum at an interval of 0.5m, shown as: 15.5

Where applicable, areas to be filled are shown as:

Depth of fill, in metres, shown as:- 0.5

Retaining wall and retaining wall height, shown on the lower side of the wall, have been taken from plans supplied by Colliers and shown as: (1.2)

Bin Pad Location shown as:

Retaining Wall Lot 2261
Min Height:- 1.8m
Max Height:- 1.8m
Average Height:- 1.8m



FLAGSTONE PRECINCT 1 STAGE 5E

For
**PEET FLAGSTONE
CITY PTY LTD**

IMPORTANT NOTES:

(These notes are an integral part of this plan)

This plan has been prepared for PEET FLAGSTONE CITY PTY LTD for the purposes of **A Disclosure Plan Under the Land Sales Act 1984 (as amended)**.

It is not to be used by any other person or corporation or for any other purposes and is subject to the following limitations:

Please refer to the approved Development Application for conditions relating to the LOT and to approved Operational Works drawings for services location and possible easements.

THESE DESIGNS AND DRAWINGS ARE COPYRIGHT AND ARE NOT TO BE USED OR REPRODUCED WITHOUT THE WRITTEN PERMISSION OF VERIS

Data Sources
Cadastral Boundaries
30109-LC-Master(D0) F594 2014.dwg
Engineering Design
STAGE 5E BASE - 02 05 2023.dwg
Final Surface Contours
FLAGSTONE - STAGE 5 - DISCLOSURE INFO - 02 05 2023 - Design Tm.dxf
Depth of Fill
FLAGSTONE - STAGE 5 - DISCLOSURE INFO - 02 05 2023 -
Retaining Wall
FLAGSTONE - 5 BEW - OPW - DRAFTSET - 27.04.23

Issue	Revisions	Date	BK	Drawn
A	Original	06.07.2023	BK	

Locality: FLAGSTONE
Local Authority: LOGAN CITY COUNCIL
Horizontal Meridian: MGA Zone 56
Vertical Level Datum: AHD D
Scale: 1:250 @ A4
Designed: Colliers
Drawn: BK 06/07/2023
Checked: DE 06/07/2023
Plot Date: 06 Jul, 2023
Computer File Ref: 30109-St5E-DP-(A).dwg

DISCLOSURE PLAN
of Proposed LOT 2352
being part of
Lot 911
on SP335845



veris

BRISBANE (07) 3686 4700 WHITSUNDAYS (07) 4945 6600

MACKAY (07) 4957 9700 CAIRNS (07) 4252 9400

veris.com.au
ACN 615 735 727
Veris Australia Pty Ltd

Drawing No
30109-DP- 2352

Issue
A



COSMOS STREET

DAWN LANE

2353

480m²

PROPOSED LOT 2352

Retaining Wall Lot 2353
Min Height:- 0.4m
Max Height:- 1.4m
Average Height:- 0.9m

Retaining Wall Lot 2260
Min Height:- 1.6m
Max Height:- 1.6m
Average Height:- 1.6m

ADDITIONAL NOTES:

The LOT dimensions and area shown hereon are subject to final field survey and also to the requirements of Council and any other authority which may have requirements under any relevant legislation

Final surface contours shown hereon have been supplied by Colliers.

Location of retaining walls are as shown on Engineering design drawings. Their as-constructed location may differ from their design location. Retaining wall heights have been supplied by Colliers.

Compaction of any fill material placed on this site shall be completed to level one inspection and testing services in accordance with AS3798-2007.

Depth of fill values are calculated to the pre-development surface.

Copyright © Veris Australia Pty Ltd
06/07/2023.

**FLAGSTONE
PRECINCT 1 STAGE 5E**
For
**PEET FLAGSTONE
CITY PTY LTD**

IMPORTANT NOTES:

(These notes are an integral part of this plan)

This plan has been prepared for **PEET FLAGSTONE CITY PTY LTD** for the purposes of **A Disclosure Plan Under the Land Sales Act 1984 (as amended)**.

It is not to be used by any other person or corporation or for any other purposes and is subject to the following limitations:

Please refer to the approved Development Application for conditions relating to the LOT and to approved Operational Works drawings for services location and possible easements.

THESE DESIGNS AND DRAWINGS ARE COPYRIGHT AND ARE NOT TO BE USED OR REPRODUCED WITHOUT THE WRITTEN PERMISSION OF VERIS

Data Sources
Cadastral Boundaries
30109-LC-Master(D0) F594 2014.dwg
Engineering Design
STAGE 5E BASE - 02 05 2023.dwg
Final Surface Contours
FLAGSTONE - STAGE 5 - DISCLOSURE INFO - 02 05 2023 - Design Tm.dxf
Depth of Fill
FLAGSTONE - STAGE 5 - DISCLOSURE INFO - 02 05 2023 -
Retaining Wall
FLAGSTONE - 5 BEW - OPW - DRAFTSET - 27.04.23

Issue	Revisions	Date	BK	Drawn
A	Original	06.07.2023	BK	

Locality: FLAGSTONE
Local Authority: LOGAN CITY COUNCIL
Horizontal Meridian: MGA Zone 56
Vertical Level Datum: AHD D
Scale: 1:250 @ A4
Designed: Colliers
Drawn: BK 06/07/2023
Checked: DE 06/07/2023
Plot Date: 06 Jul, 2023
Computer File Ref: 30109-SISE-DP-(A).dwg

DISCLOSURE PLAN
of Proposed LOT 2353
being part of
Lot 911
on SP335845



veris

BRISBANE (07) 3686 4700 WHITSUNDAYS (07) 4945 6600

MACKAY (07) 4957 9700 CAIRNS (07) 4252 9400

veris.com.au
ACN 615 735 727
Veris Australia Pty Ltd

Drawing No
30109-DP- 2353

Issue
A

LEGEND

Final surface contours based on A.H.D. datum at an interval of 0.5m, shown as: 15.5

Where applicable, areas to be filled are shown as:

Depth of fill, in metres, shown as:- +0.5

Retaining wall and retaining wall height, shown on the lower side of the wall, have been taken from plans supplied by Colliers and shown as:

Bin Pad Location shown as:

