

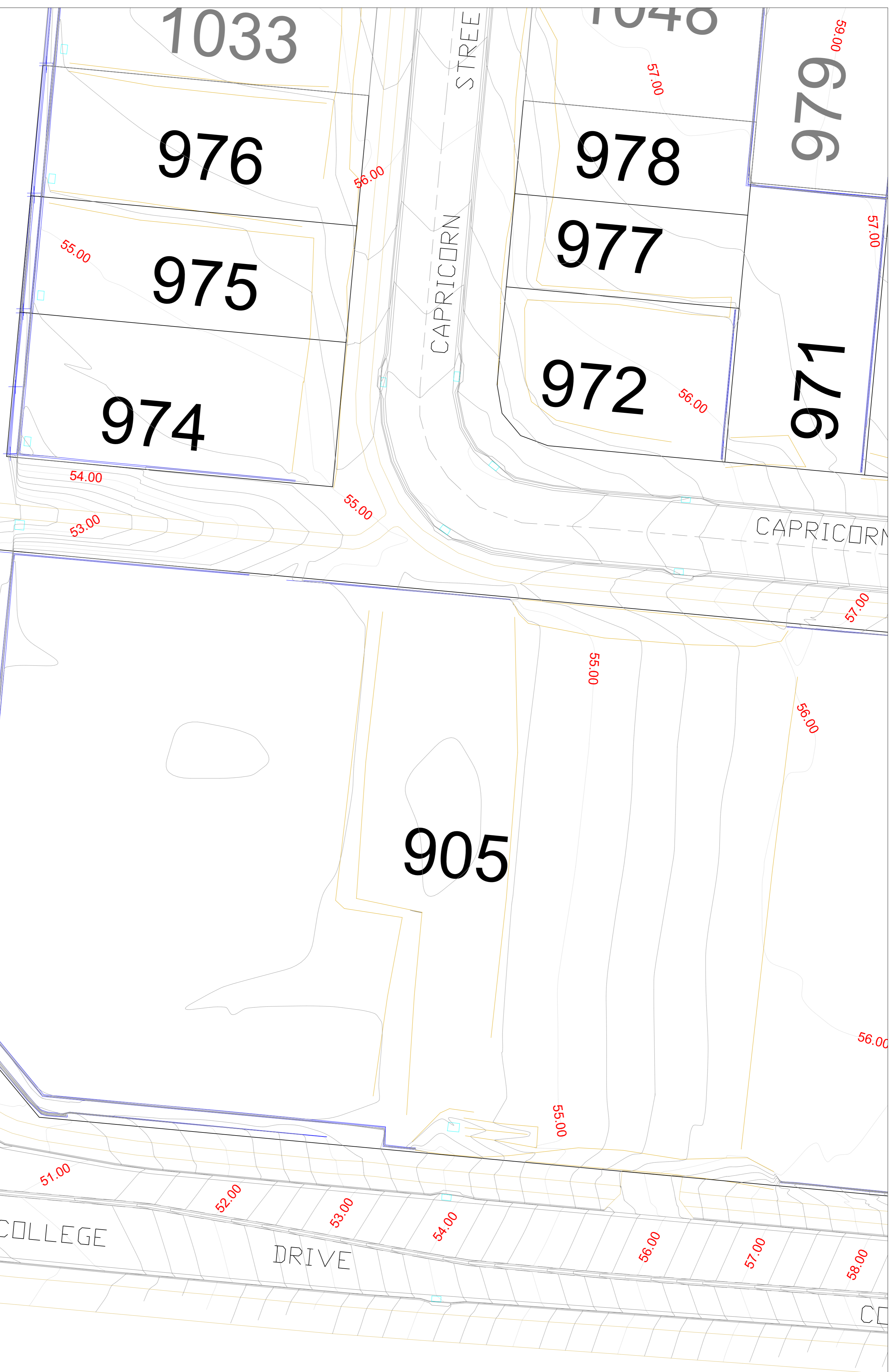

LEGEND

6.25 — AS CONSTRUCTED CONTOURS
(Interval 0.25m)

— RETAINING WALL



FLAGSTONE STAGE 2D
For
PEET FLAGSTONE CITY PTY LTD

IMPORTANT NOTES:
This Plan has been prepared for PEET FLAGSTONE CITY PTY LTD by Logan & Partners, for the purpose of recording the As Constructed details of a new service constructed under a specific Council Approval and should not be used for any other purpose.
No report to be made on any other services, not any services that may exist before or be constructed after survey, or constructed under any other approval.
The property boundaries, dimensions and lot numbers shown herein may be proposed only and subject to registration by the Department of Natural Resources. All property information should be determined from the registered Survey Plans.
All dimensions should be verified and confirmed against the latest information prior to commencement by any person using this plan for building purposes.
Veris Australia Pty Ltd accepts no responsibility for any changes made to construction or otherwise, after the date of this plan, any discrepancies should be clarified in writing with the relevant Authority prior to commencement of the work.
Copyright © Veris Australia Pty Ltd, January 2021.

THESE DESIGNS AND DRAWINGS ARE COPYRIGHT AND ARE NOT TO BE USED OR REPRODUCED WITHOUT THE WRITTEN PERMISSION OF VERIS

Data Source:	3D/08-12-Master/010/FSM 2014.dwg
Coordinate System:	Veris
As-con survey:	Veris
Engineering Design:	Menhardt

A	Original	20/09/2021	JMc
Issue	Revision	Date	Drawn

Local Authority: LCC
Horizontal Meridian: MGA
Vertical Level Datum: AHD D
Level Origin: PM107142/RL 38.078
Scale: 1:250 @ A1
Surveyed: DE ILS
Designed: MENHARDT
Drawn: JMc
Checked:
Plot Date: 30 Sep. 2021

Computer File Ref:
430109-12041-AE01-A MGAS6.dwg

AS-CONSTRUCTED FINAL SURFACE
SHEET 1 OF 2

BRISBANE 071 462 8700 WHITSUNDAYS 071 462 8700
MACKAY 071 462 8700 CAIRNS 071 462 8700
veris.com.au
ACN 615 738 727
Veris Australia Pty Ltd

Drawing No. 430109-1241-AE01 Issue A

Consulting Engineer's Certification.

I, hereby certify that the As Constructed information shown on this plan is a true and correct record of the sizes, types, materials, classes etc., and it corresponds with the relevant approved Engineering Drawings.

Signed..... RPEQ No
Dated.....

Registered Surveyor's Certification.

We, VERIS AUSTRALIA P/L, hereby certify that the horizontal and vertical locations, and dimensions shown on this plan are a true and correct record of the As Constructed information.

Signed *Alistair Byrom* 6448 Dated 30/09/2021
Cadastal Surveyor Delegate

FLAGSTONIAN DRIVE

COLLEGE DRIVE

CAPRICORN STREET

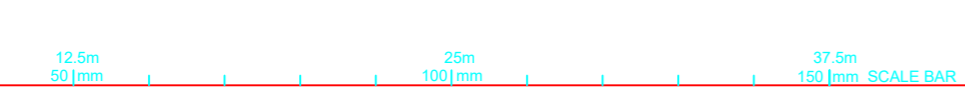

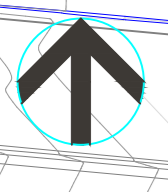

Consulting Engineer's Certification.

I, hereby certify that the As Constructed information shown on this plan is a true and correct record of the sizes, types, materials, classes etc., and it corresponds with the relevant approved Engineering Drawings.

Signed..... RPEQ No
Dated.....

Registered Surveyor's Certification.

We, VERIS AUSTRALIA P/L hereby certify that the horizontal and vertical locations, and dimensions shown on this plan are a true and correct record of the As Constructed information.

Signed *Alistair Byron* Reg. No 6448 Dated 30/09/2021
Cadastre Surveyor Delegate

LEGEND

6.25 — AS CONSTRUCTED CONTOURS (Interval 0.25m)

— RETAINING WALL



FLAGSTONE STAGE 2D
For PEET FLAGSTONE CITY PTY LTD

IMPORTANT NOTES:
This Plan has been prepared for PEET FLAGSTONE CITY PTY LTD to support its operations for the purpose of recording the As Constructed details of a new service constructed under a specific Council Approval and should not be used for any other purpose.
No report to be made on any other services, not any services that may exist before or be constructed after the time of survey, or constructed under any other approval.
The property boundaries, dimensions and lot numbers shown herein may be proposed only and subject to registration by the Department of Natural Resources. All property information should be determined from the registered Survey Plans.
All dimensions should be verified and confirmed against the latest information prior to commencement by any person using this plan for building purposes.
Veris Australia Pty Ltd accepts no responsibility for any changes made to construction or otherwise, after the date of this plan. Any discrepancies should be clarified in writing with the relevant Authority prior to commencement of the work.
Copyright © Veris Australia Pty Ltd, January 2021.

THESE DESIGNS AND DRAWINGS ARE COPYRIGHT AND ARE NOT TO BE USED OR REPRODUCED WITHOUT THE WRITTEN PERMISSION OF VERIS

Data Sources: 30109-LC-Master(01) FSR 2014.dwg
Coordinate System: Veris
As-con survey: Veris
Engineering Design: Menhardt

Rev	Description	Date	By	Check
A	Original	20/09/2021	JM	
B	Revised			

Local Authority: LCC
Horizontal Method: MGA
Vertical Level Datum: AHD D
Level Origin: PM107142(PL38.078)
Scale: 1:250 (G1 A1)
Surveyed: DE I.L.S.
Designed: MENHARDT
Drawn: JM
Checked: JM
Plot Date: 30 Sep. 2021

Computer File Ref:
430109-12041-AE01-A MGA56.dwg

AS-CONSTRUCTED FINAL SURFACE
SHEET 2 OF 2

veris

BRISBANE 071 462 8700 WHITSUNDAYS 071 462 8000
MACKAY 071 462 8700 CAIRNS 071 462 8000

veris.com.au
ACN 615 738 727
Veris Australia Pty Ltd

Drawing No. 430109-1241-AE01 Issue A

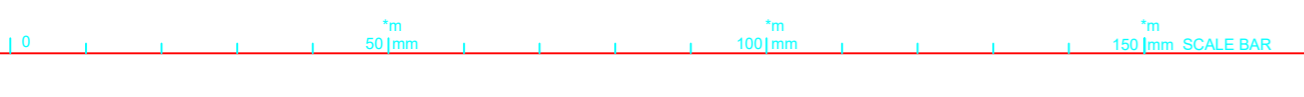

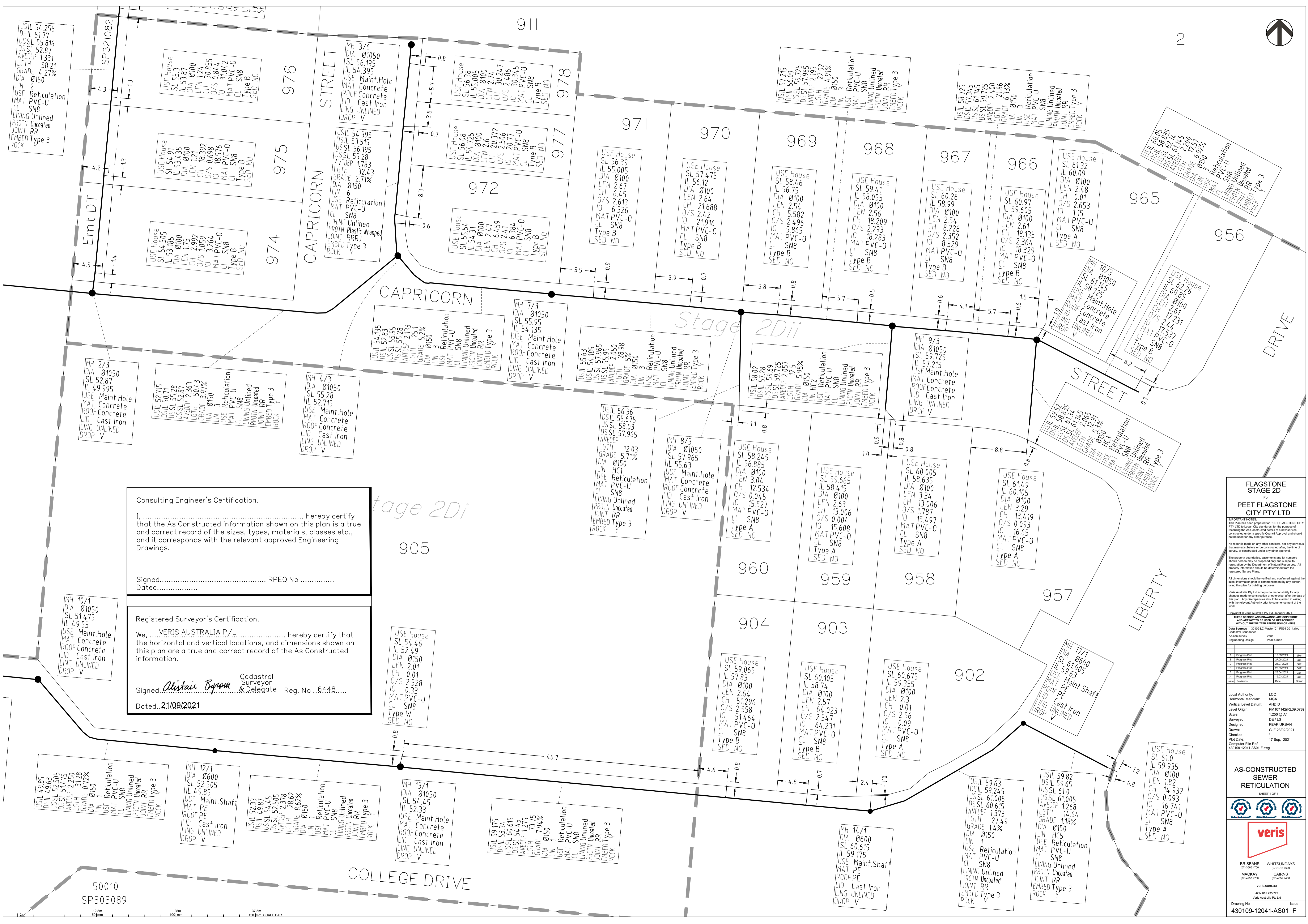
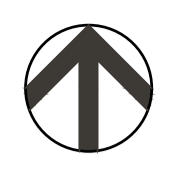

Consulting Engineer's Certification.

I, hereby certify that the As Constructed information shown on this plan is a true and correct record of the sizes, types, materials, classes etc., and it corresponds with the relevant approved Engineering Drawings.

Signed..... RPEQ No
Dated.....

Registered Surveyor's Certification.

We, VERIS AUSTRALIA P/L hereby certify that the horizontal and vertical locations, and dimensions shown on this plan are a true and correct record of the As Constructed information.

Signed, *Alistair Byrom*
Cadastral Surveyor & Delegate Reg. No ..6448.....

Dated, 21/09/2021

FLAGSTONE STAGE 2D

PEET FLAGSTONE CITY PTY LTD

IMPORTANT NOTES

This Plan has been prepared for PEET FLAGSTONE CITY PTY LTD to be used for the purpose of recording the As Constructed details of a new service constructed under a specific Council Approval and should not be used for any other purpose.

No report is made on any other services, nor any services that may exist before or be constructed after the time of survey, or constructed under any other approval.

The property boundaries, assessments and lot numbers shown herein may be proposed only and subject to registration by the Department of Natural Resources. All property information should be determined from the registered Survey Plans.

All dimensions should be verified and confirmed against the latest information prior to commencement by any person using this plan for building purposes.

Veris Australia Pty Ltd accepts no responsibility for any changes made to construction or otherwise, after the date of this plan. Any discrepancies should be clarified in writing with the relevant Authority prior to commencement of the work.

Copyright © Veris Australia Pty Ltd, January 2021

These drawings and information are copyright and are not to be used or reproduced without the written permission of Veris.

Date	By	Description
11/09/2021	AB	A - Progress Plan
27/09/2021	AB	B - Progress Plan
28/07/2021	CLP	C - Progress Plan
28/08/2021	CLP	D - Progress Plan
28/04/2021	CLP	E - Progress Plan
10/03/2021	CLP	F - Progress Plan

Local Authority: LCC
Horizontal Meridian: MGA
Vertical Level Datum: AHD 10
Level Origin: PM107142(RL98.078)
Scale: 1:250 @ A1
Drawn: PEAK URBAN
Checked: GJF 23/02/2021
17 Sep, 2021
Computer File Ref: 430109-12041-AS01-F.dwg

AS-CONSTRUCTED SEWER RETICULATION

SHEET 1 OF 4

veris

BRISBANE 071 966 4700
MACKAY 071 4927 9700
WHITSUNDAYS 071 4940 6000
CAIRNS 071 4922 9400

veris.com.au
ACN 615 735 727
Veris Australia Pty Ltd

Drawing No. 430109-12041-AS01 F Issue

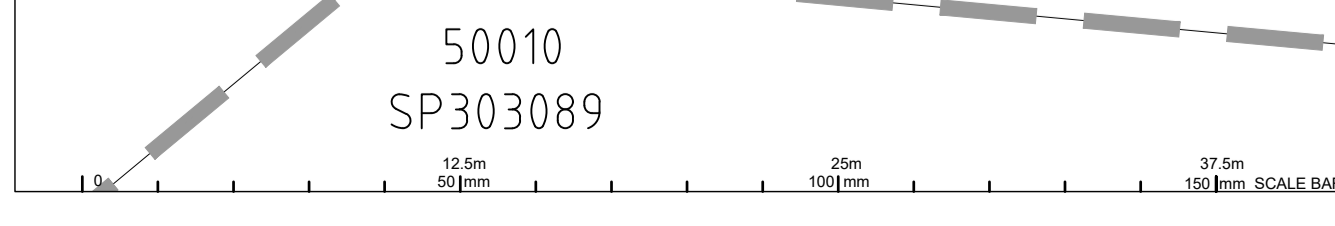



Consulting Engineer's Certification.
 I, hereby certify that the As Constructed information shown on this plan is a true and correct record of the sizes, types, materials, classes etc., and it corresponds with the relevant approved Engineering Drawings.

Signed..... RPEQ No
 Dated.....

Registered Surveyor's Certification.
 We, hereby certify that the horizontal and vertical locations, and dimensions shown on this plan are a true and correct record of the As Constructed information.

Cadastral Surveyor & Delegate
 Signed *Alister Byrom* Reg. No. 6448.....
 Dated 21/09/2021



FLAGSTONE STAGE 2D
PEET FLAGSTONE CITY PTY LTD
 IMPORTANT NOTES
 This Plan has been prepared for PEET FLAGSTONE CITY PTY LTD in accordance with the requirements of the City of Brisbane for the purpose of recording the As Constructed details of a new service installed under a specific Council Approval and should not be used for any other purpose.
 No report is made on any other services, nor any services that may exist before or be constructed after the time of survey, or constructed under any other approval.
 The property boundaries, easements and lot numbers shown herein may be proposed only and subject to registration by the Department of Natural Resources. All property information should be determined from the registered Survey Plans.
 All dimensions should be verified and confirmed against the latest information prior to commencement by any person using this plan for building purposes.
 Veris Australia Pty Ltd accepts no responsibility for any changes made to construction or otherwise, after the date of this plan. Any discrepancies should be clarified in writing with the relevant Authority prior to commencement of the work.
 Copyright © Veris Australia Pty Ltd, January 2021
 THESE DETAILS AND DRAWINGS ARE COPYRIGHT AND ARE NOT TO BE USED OR REPRODUCED WITHOUT THE WRITTEN PERMISSION OF VERIS
 Data Sources: 30109-CC Master(C) FSR4 2014.dwg
 As-con survey: Veris
 Engineering Design: Peak Urban

Rev	Description	Date	Drawn
1	Progress File	11/09/2021	AK
2	Progress File	27/08/2021	GP
3	Progress File	28/07/2021	GP
4	Progress File	25/05/2021	GP
5	Progress File	28/04/2021	GP
6	Progress File	10/03/2021	GP
7	Revision		

Local Authority: LCC
 Horizontal Meridian: MGA
 Vertical Level Datum: AHD D
 Level Origin: PM107142(RL98.078)
 Scale: 1:250 @ A1
 Surveyed: DE/LS
 Designed: PEAK URBAN
 Drawn: GJF 23/02/2021
 Checked:
 Plot Date: 17 Sep, 2021
 Computer File Ref: 430109-12041-AS01-F.dwg

AS-CONSTRUCTED SEWER RETICULATION
 SHEET 2 OF 4

veris
 BRISBANE 071 966 4700 WHITSUNDAYS 071 466 6600
 MACKAY 071 4927 9700 CAIRNS 071 4052 9400
 veris.com.au
 ACN 615 735 727
 Veris Australia Pty Ltd
 Drawing No. Issue
 430109-12041-AS01 F

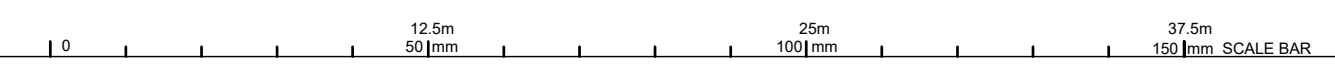

Consulting Engineer's Certification.

I, hereby certify that the As Constructed information shown on this plan is a true and correct record of the sizes, types, materials, classes etc., and it corresponds with the relevant approved Engineering Drawings.

Signed..... RPEQ No
Dated.....

Registered Surveyor's Certification.

We, VERIS AUSTRALIA P/L hereby certify that the horizontal and vertical locations, and dimensions shown on this plan are a true and correct record of the As Constructed information.

Signed *Alistair Byrom*
Dated..21/09/2021

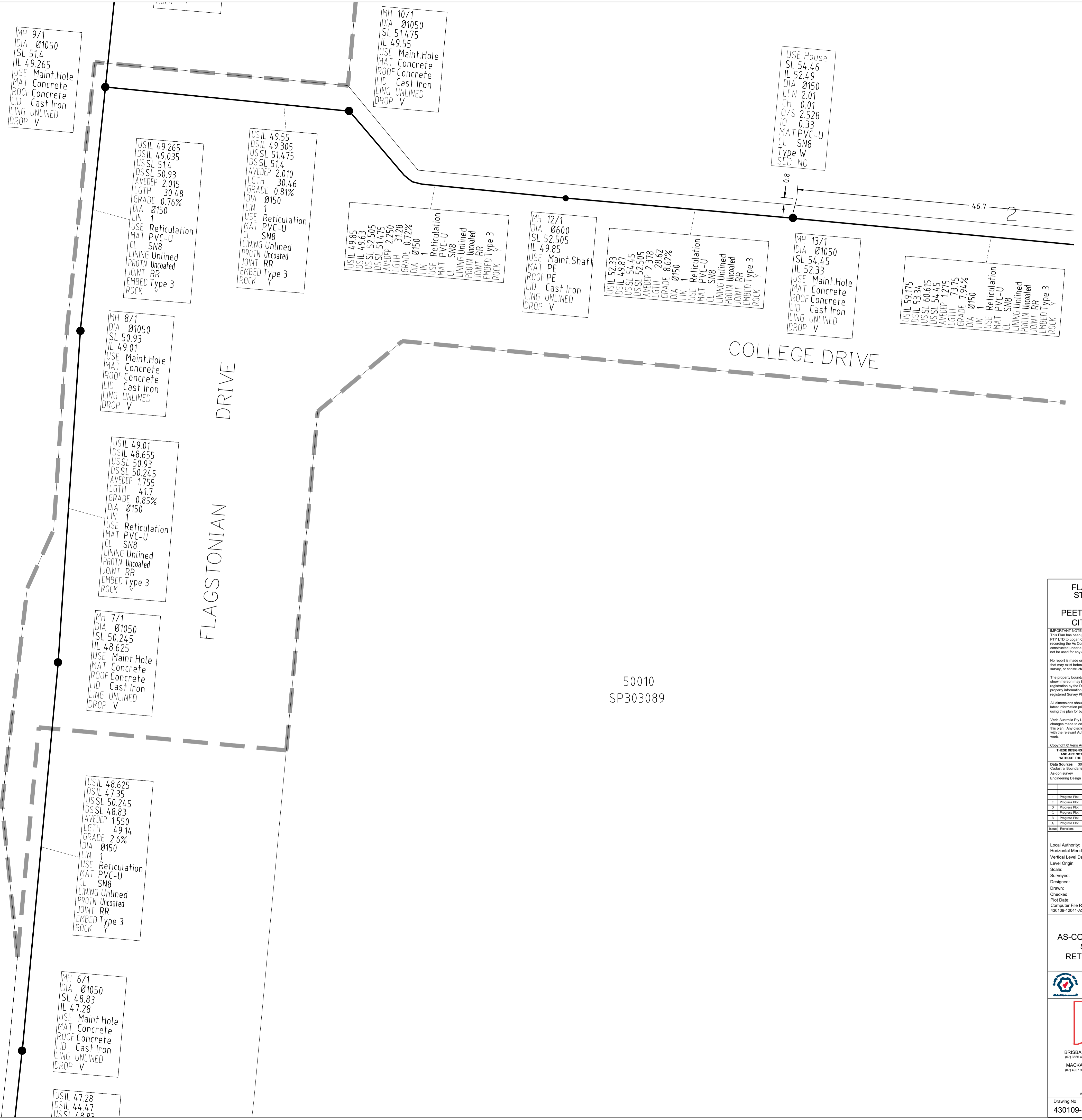

911

FLAGSTONE STAGE 2D
PEET FLAGSTONE CITY PTY LTD

IMPORTANT NOTES
This Plan has been prepared for PEET FLAGSTONE CITY PTY LTD to Logon City elements for the purpose of recording the As Constructed details of a new service constructed under a specific Council Approval and should not be used for any other purpose.
No report is made on any other services, nor any services that may exist before or be constructed after, the time of survey, or constructed under any other approval.
The property boundaries, assessments and lot numbers shown herein may be proposed only and subject to registration by the Department of Natural Resources. All property information should be determined from the registered Survey Plans.
All dimensions should be verified and confirmed against the latest information prior to commencement by any person using this plan for building purposes.
Veris Australia Pty Ltd accepts no responsibility for any changes made to construction or otherwise, after the date of this plan. Any discrepancies should be clarified in writing with the relevant Authority prior to commencement of the work.
Copyright © Veris Australia Pty Ltd, January 2021
THESE DESIGNS AND DRAWINGS ARE COPYRIGHT AND ARE NOT TO BE USED OR REPRODUCED WITHOUT THE WRITTEN PERMISSION OF VERIS AUSTRALIA PTY LTD
Data Source: 30109-LC-Master(C) FSR 2014.dwg
As-con survey: Veris
Engineering Design: Peak Urban

Revision	Date	Drawn
1	13/09/2021	AK
2	27/08/2021	CUF
3	28/07/2021	CUF
4	28/08/2021	CUF
5	28/04/2021	CUF
6	10/03/2021	CUF
7	17/09/2021	CUF

Local Authority: LCC
Horizontal Meridian: MGA
Vertical Level Datum: AHD D
Level Origin: PM107142(RL98.078)
Scale: 1:250 @ A1
Surveyed: DE/LS
Designed: PEAK URBAN
Drawn: GJF 23/02/2021
Checked: 17 Sep, 2021
Plot Date:
Computer File Ref: 430109-12041-AS01-F.dwg

AS-CONSTRUCTED SEWER RETICULATION
SHEET 3 OF 4

BRISBANE (07) 9664 4700
WHITSUNDAYS (07) 4664 6600
MACKAY (07) 4927 9700
CAIRNS (07) 4052 9400
veris.com.au
ACN 615 735 727
Veris Australia Pty Ltd

Drawing No. 430109-12041-AS01 F Issue

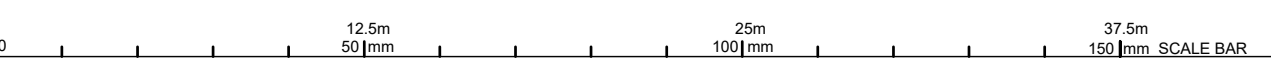

Consulting Engineer's Certification.

I, hereby certify that the As Constructed information shown on this plan is a true and correct record of the sizes, types, materials, classes etc., and it corresponds with the relevant approved Engineering Drawings.

Signed..... RPEQ No Dated.....

Registered Surveyor's Certification.

We, VERIS AUSTRALIA P/L hereby certify that the horizontal and vertical locations, and dimensions shown on this plan are a true and correct record of the As Constructed information.

Signed *Alistair Byrom* Cadastral Surveyor & Delegate Reg No .6448..

Dated: 21/09/2021

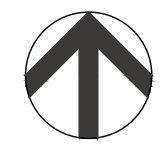

FLAGSTONE STAGE 2D
For
PEET FLAGSTONE CITY PTY LTD

IMPORTANT NOTES
This Plan has been prepared for PEET FLAGSTONE CITY PTY LTD to Logon City elements for the purpose of recording the As Constructed details of a new service considered under a specific Council Approval and should not be used for any other purpose.
No report is made on any other services, nor any services that may exist before or be constructed after the time of survey, or constructed under any other approval.
The property boundaries, assessments and lot numbers shown herein may be proposed only and subject to registration by the Department of Natural Resources. All property information should be determined from the registered Survey Plans.
All dimensions should be verified and confirmed against the latest information prior to commencement by any person using this plan for building purposes.
Veris Australia Pty Ltd accepts no responsibility for any changes made to construction or otherwise, after the date of this plan. Any discrepancies should be clarified in writing with the relevant Authority prior to commencement of the work.
Copyright © Veris Australia Pty Ltd, January 2021
THESE DESIGNS AND DRAWINGS ARE CONFIDENTIAL AND ARE NOT TO BE USED OR REPRODUCED WITHOUT THE WRITTEN PERMISSION OF VERIS

Revision	Date	Drawn
D	28/07/2021	CLP
C	26/05/2021	CLP
B	26/05/2021	CLP
A	28/04/2021	CLP

Local Authority: LCC
Horizontal Meridian: MGA
Vertical Level Datum: AHD D
Level Origin: PM107142(RL98.078)
Scale: 1:250 @ A1
Surveyed: DE / LS
Designed: MEINHARDT
Drawn: GJF 28/04/2021
Checked: 17 Sep, 2021
Plot Date:
Computer File Ref: 430109-12041-AW01-D.dwg

AS-CONSTRUCTED WATER RETICULATION
SHEET 1 OF 3



veris
BRISBANE (07) 9668 4700
MACKAY (07) 4927 9700
WHITSUNDAYS (07) 4460 4600
CAIRNS (07) 4052 9400
veris.com.au
ACN 615 735 727
Veris Australia Pty Ltd

Drawing No. 430109-12041-AW01 D Issue

- LEGEND**
- NEW HYDRANT
 - NEW SLUICE VALVE
 - NEW TEE
 - NEW END CAP
 - NEW TAPER
 - NEW WATER SERVICE CONDUIT (ø100 PVC-O PN16)
 - NEW WATER METER
 - NEW WATER HOUSE CONNECTION (TAPPING BAND)
 - EXISTING HYDRANT
 - EXISTING SLUICE VALVE
 - EXISTING TEE
 - EXISTING WATER HOUSE CONNECTION (TAPPING BAND)
 - EXISTING WATER MAIN
 - NEW WATER MAIN (ø100 PVC-M PN16)
 - NEW WATER MAIN (ø150 PVC-M PN16)
 - NEW WATER MAIN (ø250 PVC-M PN16)
 - NEW WATER MAIN (ø100, ø150 or ø225 DICL PN35)



Consulting Engineer's Certification.

I, hereby certify that the As Constructed information shown on this plan is a true and correct record of the sizes, types, materials, classes etc., and it corresponds with the relevant approved Engineering Drawings.

Signed..... RPEQ No..... Dated.....

Registered Surveyor's Certification.

We, VERIS AUSTRALIA P/L hereby certify that the horizontal and vertical locations, and dimensions shown on this plan are a true and correct record of the As Constructed information.

Signed *Alistair Byron* Cadastral Surveyor & Delegate Reg. No. 6448.
Dated 21/09/2021

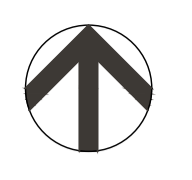
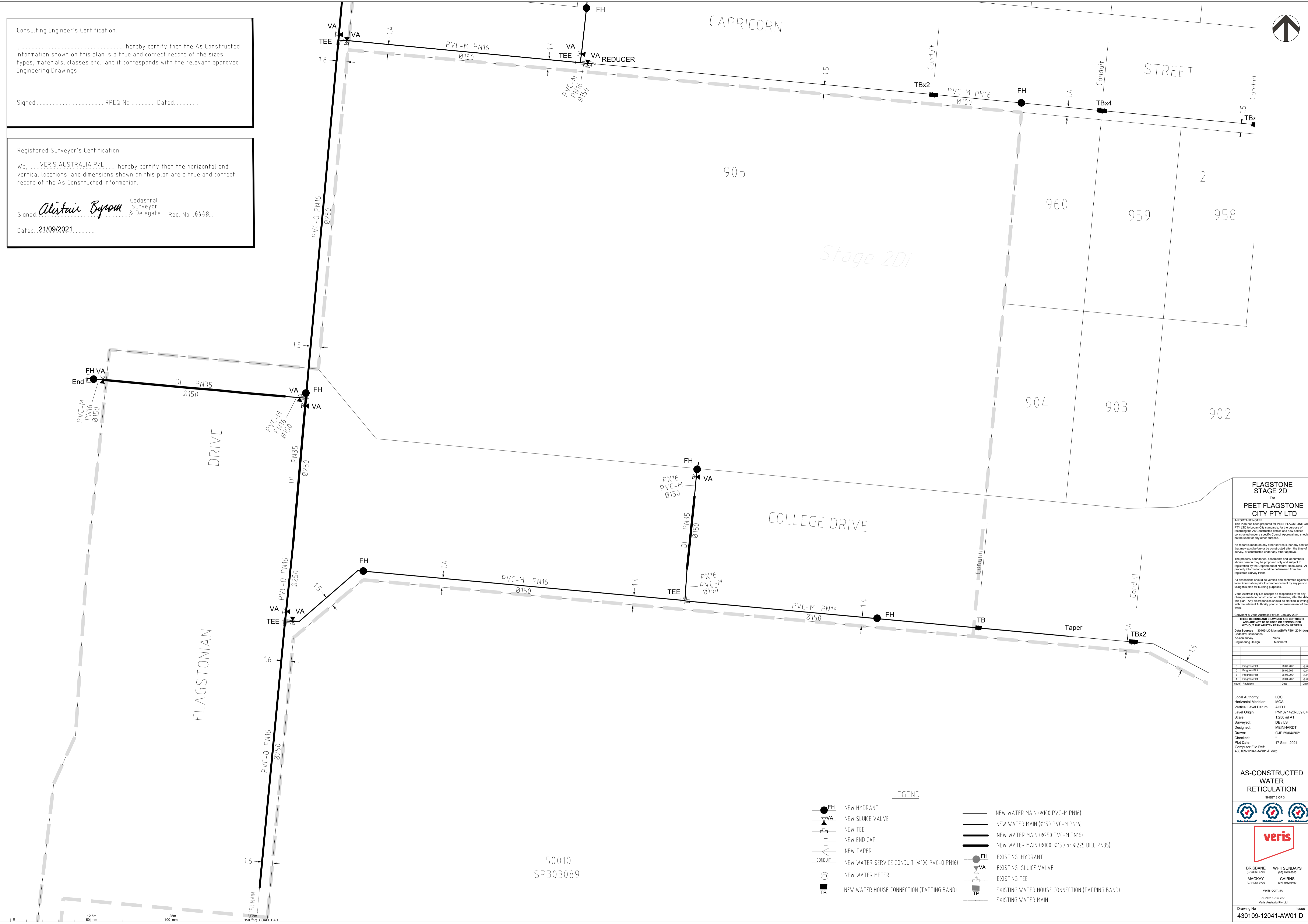

FLAGSTONE STAGE 2D
PEET FLAGSTONE CITY PTY LTD

IMPORTANT NOTES
This Plan has been prepared for PEET FLAGSTONE CITY PTY LTD in Logan City shire for the purpose of recording the As Constructed details of a new service constructed under a specific Council Approval and should not be used for any other purpose.
No report is made on any other services, nor any services that may exist before or be constructed after the time of survey, or constructed under any other approval.
The property boundaries, assessments and lot numbers shown herein may be proposed only and subject to registration by the Department of Natural Resources. All property information should be determined from the registered Survey Plans.
All dimensions should be verified and confirmed against the latest information prior to commencement by any person using this plan for building purposes.
Veris Australia Pty Ltd accepts no responsibility for any changes made to construction or otherwise, after the date of this plan. Any discrepancies should be clarified in writing with the relevant Authority prior to commencement of the work.
Copyright © Veris Australia Pty Ltd, January 2021.
THESE DESIGNS AND DRAWINGS ARE COPYRIGHT AND ARE NOT TO BE USED OR REPRODUCED WITHOUT THE WRITTEN PERMISSION OF VERIS.

Data Sources 30109-LC Master (R) F504 2014.dwg
As-con survey Veris
Engineering Design Meinhardt

Rev	Revision	Date	Drawn
0	Progress File	28.07.2021	CLP
1	Progress File	26.05.2021	CLP
2	Progress File	26.05.2021	CLP
3	Progress File	28.04.2021	CLP

Local Authority: LCC
Horizontal Meridian: MGA
Vertical Level Datum: AHD D
Level Origin: PM107142(RL98.078)
Scale: 1:250 @ A1
Surveyed: DE / LS
Designed: MEINHARDT
Drawn: GJF 28/04/2021
Checked: 17 Sep, 2021
Plot Date:
Computer File Ref: 430109-12041-AW01-D.dwg

AS-CONSTRUCTED WATER RETICULATION
SHEET 2 OF 3

BRISBANE (07) 9664 4700
MACKAY (07) 4927 9700
WHITSUNDAYS (07) 4461 6000
CAIRNS (07) 4052 9400
veris.com.au
ACN 615 735 727
Veris Australia Pty Ltd

Drawing No. 430109-12041-AW01 D Issue

- LEGEND**
- NEW HYDRANT
 - NEW SLUICE VALVE
 - NEW TEE
 - NEW END CAP
 - NEW TAPER
 - NEW WATER SERVICE CONDUIT (Ø100 PVC-O PN16)
 - NEW WATER METER
 - NEW WATER HOUSE CONNECTION (TAPPING BAND)
 - NEW WATER MAIN (Ø100 PVC-M PN16)
 - NEW WATER MAIN (Ø150 PVC-M PN16)
 - NEW WATER MAIN (Ø250 PVC-M PN16)
 - NEW WATER MAIN (Ø100, Ø150 or Ø225 DI CL PN35)
 - EXISTING HYDRANT
 - EXISTING SLUICE VALVE
 - EXISTING TEE
 - EXISTING WATER HOUSE CONNECTION (TAPPING BAND)
 - EXISTING WATER MAIN

50010
SP303089

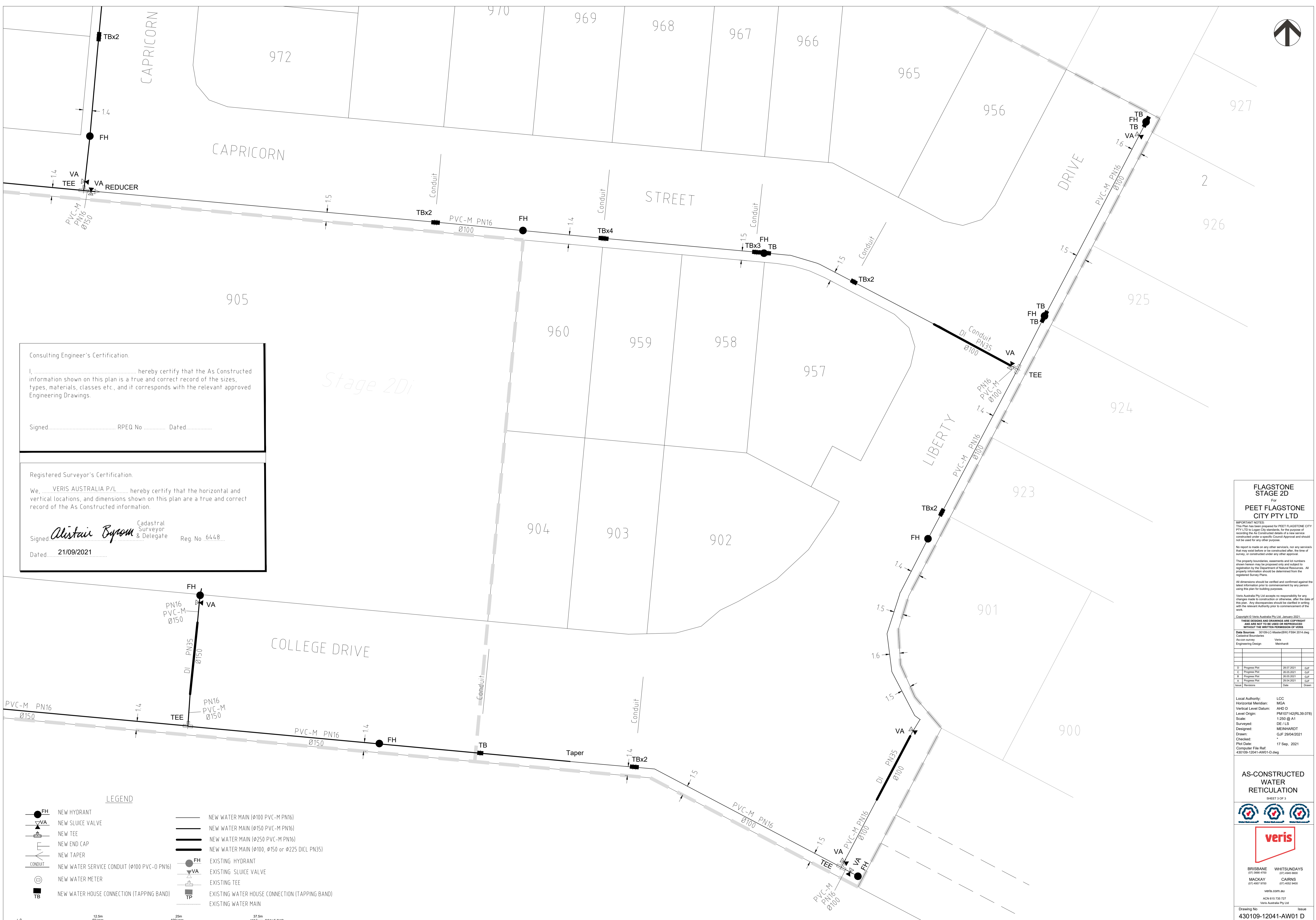
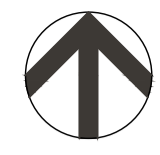

Stage 2 Di

Consulting Engineer's Certification.

I, hereby certify that the As Constructed information shown on this plan is a true and correct record of the sizes, types, materials, classes etc., and it corresponds with the relevant approved Engineering Drawings.

Signed..... RPEQ No Dated.....

Registered Surveyor's Certification.

We, VERIS AUSTRALIA P/L hereby certify that the horizontal and vertical locations, and dimensions shown on this plan are a true and correct record of the As Constructed information.

Signed *Alistair Byron* Cadastrol Surveyor & Delegate Reg. No. 6448
Dated 21/09/2021

- LEGEND**
- NEW HYDRANT
 - NEW SLUICE VALVE
 - NEW TEE
 - NEW END CAP
 - NEW TAPER
 - NEW WATER SERVICE CONDUIT (ø100 PVC-M PN16)
 - NEW WATER METER
 - NEW WATER HOUSE CONNECTION (TAPPING BAND)
 - EXISTING HYDRANT
 - EXISTING SLUICE VALVE
 - EXISTING TEE
 - EXISTING WATER HOUSE CONNECTION (TAPPING BAND)
 - EXISTING WATER MAIN
 - NEW WATER MAIN (ø100 PVC-M PN16)
 - NEW WATER MAIN (ø150 PVC-M PN16)
 - NEW WATER MAIN (ø250 PVC-M PN16)
 - NEW WATER MAIN (ø100, ø150 or ø225 DI CL PN35)

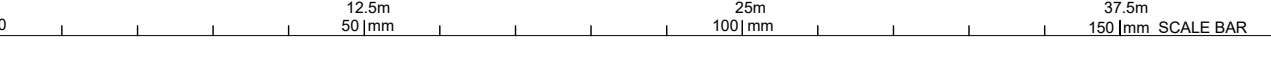

FLAGSTONE STAGE 2D

PEET FLAGSTONE CITY PTY LTD

IMPORTANT NOTES
This Plan has been prepared for PEET FLAGSTONE CITY PTY LTD in order to record the As Constructed details of a new service installed under a specific Council Approval and should not be used for any other purpose.
No report is made on any other services, nor any services that may exist before or be constructed after the time of survey, or constructed under any other approval.
The property boundaries, assessments and lot numbers shown herein may be proposed only and subject to registration by the Department of Natural Resources. All property information should be determined from the registered Survey Plans.
All dimensions should be verified and confirmed against the latest information prior to commencement by any person using this plan for building purposes.
Veris Australia Pty Ltd accepts no responsibility for any changes made to construction or otherwise, after the date of this plan. Any discrepancies should be clarified in writing with the relevant Authority prior to commencement of the work.
Copyright © Veris Australia Pty Ltd, January 2021
THESE DESIGNS AND DRAWINGS ARE COPYRIGHT AND ARE NOT TO BE USED OR REPRODUCED WITHOUT THE WRITTEN PERMISSION OF VERIS
Data Sources: 30109-12041-AW01-FS04 2014.dwg
As-con survey Veris
Engineering Design Member

D	Progress Plan	28/07/2021	CJP
E	Progress Plan	26/05/2021	CJP
B	Progress Plan	26/05/2021	CJP
A	Progress Plan	28/04/2021	CJP
Rev	Revisions	Date	Drawn

Local Authority: LCC
Horizontal Meridian: MGA
Vertical Level Datum: AHD D
Level Origin: PM107142(RL98.078)
Scale: 1:250 @ A1
Surveyed: DE JLS
Designed: MEINHARDT
Drawn: GJF 28/04/2021
Checked: 17 Sep, 2021
Plot Date:
Computer File Ref: 430109-12041-AW01-D.dwg

AS-CONSTRUCTED WATER RETICULATION

Sheet 3 of 3

BRISBANE 071 966 4700 WHITSUNDAYS 071 466 4600
MACKAY 071 4937 9700 CAIRNS 071 4052 9400
veris.com.au
ACN 615 735 727
Veris Australia Pty Ltd

Drawing No. 430109-12041-AW01 D Issue

Consulting Engineer's Certification.

I, hereby certify that the As Constructed information shown on this plan is a true and correct record of the sizes, types, materials, classes etc., and it corresponds with the relevant approved Engineering Drawings.

Signed..... RPEQ No Dated.....

Registered Surveyor's Certification.

We, VERIS AUSTRALIA Pty Ltd, hereby certify that the horizontal and vertical locations, and dimensions shown on this plan are a true and correct record of the As Constructed information.

Signed, *Alistair Byrom* Reg. No. 6448 Dated 30/09/2021
Cadastral Surveyor /Delegate

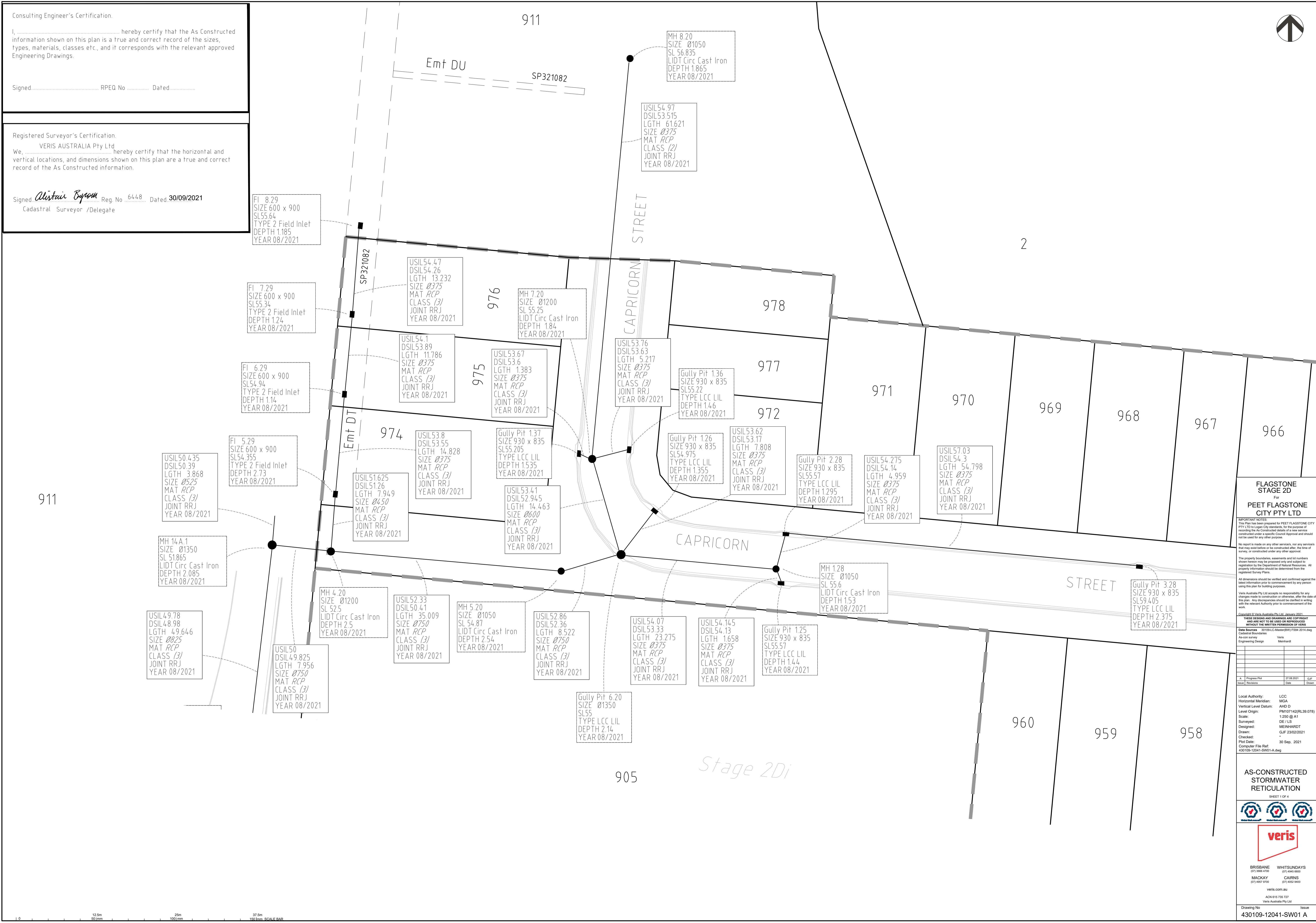

FLAGSTONE STAGE 2D
For
PEET FLAGSTONE CITY PTY LTD

IMPORTANT NOTES
This Plan has been prepared for PEET FLAGSTONE CITY PTY LTD in Logan City shire for the purpose of recording the As Constructed details of a new service constructed under a specific Council Approval and should not be used for any other purpose.
No report is made on any other services, nor any services that may exist before or be constructed after the time of survey, or constructed under any other approval.
The property boundaries, assessments and lot numbers shown herein may be proposed only and subject to registration by the Department of Natural Resources. All property information should be determined from the registered Survey Plans.
All dimensions should be verified and confirmed against the latest information prior to commencement by any person using this plan for building purposes.
Veris Australia Pty Ltd accepts no responsibility for any changes made to construction or otherwise, after the date of this plan. Any discrepancies should be clarified in writing with the relevant Authority prior to commencement of the work.
Copyright © Veris Australia Pty Ltd, January 2021
THIS DESIGN AND DRAWING ARE COPYRIGHT AND ARE NOT TO BE USED OR REPRODUCED WITHOUT THE WRITTEN PERMISSION OF VERIS AUSTRALIA PTY LTD

Data Sources 30109-LC-Master(01) FSH 2014.dwg
As-con survey Veris
Engineering Design Meinhart

Rev	Description	Date	Drawn
1	Progress Plot	27/08/2021	GP

Local Authority: LCC
Horizontal Meridian: MGA
Vertical Level Datum: AHD D
Level Origin: PM107142(RL98.078)
Scale: 1:250 @ A1
DE/LS
Surveyed: MEINHARDT
Designed: GJF 23/02/2021
Drawn:
Checked: 30 Sep, 2021
Computer File Ref: 430109-12041-SW01-A.dwg

AS-CONSTRUCTED STORMWATER RETICULATION
SHEET 1 OF 4



BRISBANE (07) 966 4700
MACKAY (07) 4927 9700
WHITSUNDAYS (07) 492 9400
CAIRNS (07) 402 9400
veris.com.au
ACN 615 735 727
Veris Australia Pty Ltd

Drawing No. 430109-12041-SW01 A Issue

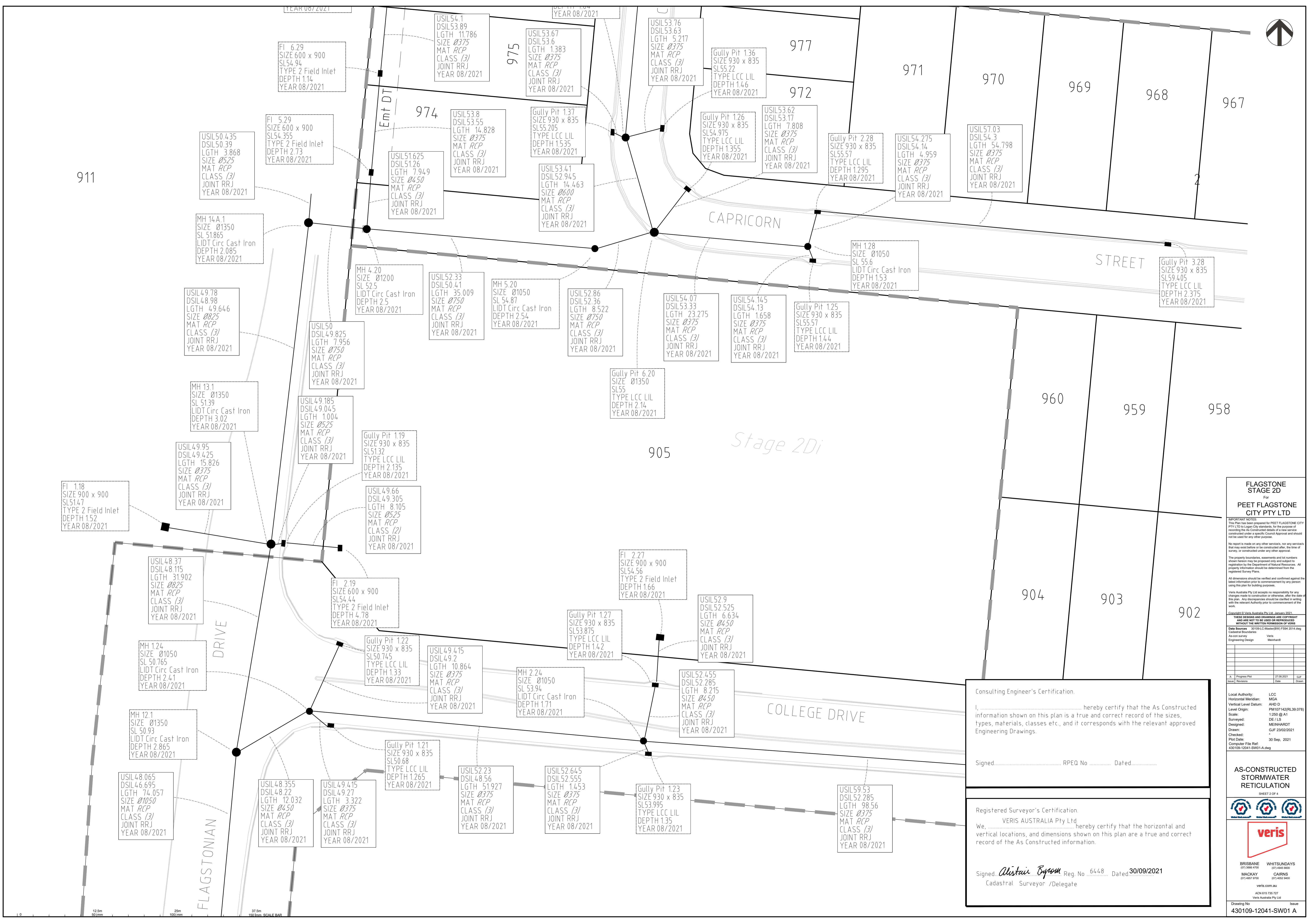
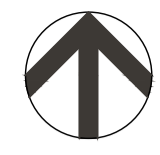

FLAGSTONE STAGE 2D
PEET FLAGSTONE CITY PTY LTD

IMPORTANT NOTES
This Plan has been prepared for PEET FLAGSTONE CITY PTY LTD in Logan City shire for the purpose of recording the As Constructed details of a new service constructed under a specific Council Approval and should not be used for any other purpose.
No report is made on any other services, nor any services that may exist before or be constructed after the time of survey, or constructed under any other approval.
The property boundaries, assessments and lot numbers shown herein may be proposed only and subject to registration by the Department of Natural Resources. All property information should be determined from the registered Survey Plans.
All dimensions should be verified and confirmed against the latest information prior to commencement by any person using this plan for building purposes.
Veris Australia Pty Ltd accepts no responsibility for any changes made to construction or otherwise, after the date of this plan. Any discrepancies should be clarified in writing with the relevant Authority prior to commencement of the work.

Copyright © Veris Australia Pty Ltd, January 2021

These drawings and drawings are copyright and are not to be used or reproduced without the written permission of Veris.

Data Sources: 30109-12041-SW01-A.dwg
As-con survey: Veris
Engineering Design: Meinhardt

A	Progress Plan	27/08/2021	02
Issue	Revision	Date	Drawn

Consulting Engineer's Certification.

I,, hereby certify that the As Constructed information shown on this plan is a true and correct record of the sizes, types, materials, classes etc., and it corresponds with the relevant approved Engineering Drawings.

Signed..... RPEQ No Dated.....

Registered Surveyor's Certification.

We, VERIS AUSTRALIA Pty Ltd, hereby certify that the horizontal and vertical locations, and dimensions shown on this plan are a true and correct record of the As Constructed information.

Signed, *Alistair Byrom* Reg. No. 6448 Dated 30/09/2021
Cadastral Surveyor /Delegate

AS-CONSTRUCTED STORMWATER RETICULATION

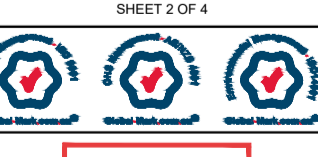

BRISBANE (07) 966 4700 WHITSUNDAYS (07) 466 6600
MACKAY (07) 4927 9700 CAIRNS (07) 4022 9400

veris.com.au
ACN 615 735 727
Veris Australia Pty Ltd
Drawing No. Issue
430109-12041-SW01 A

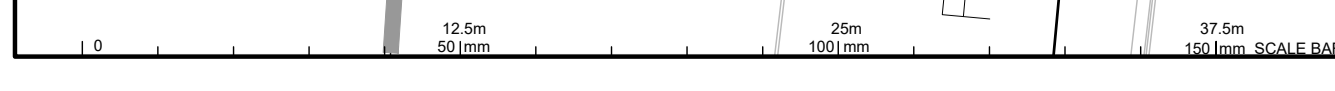

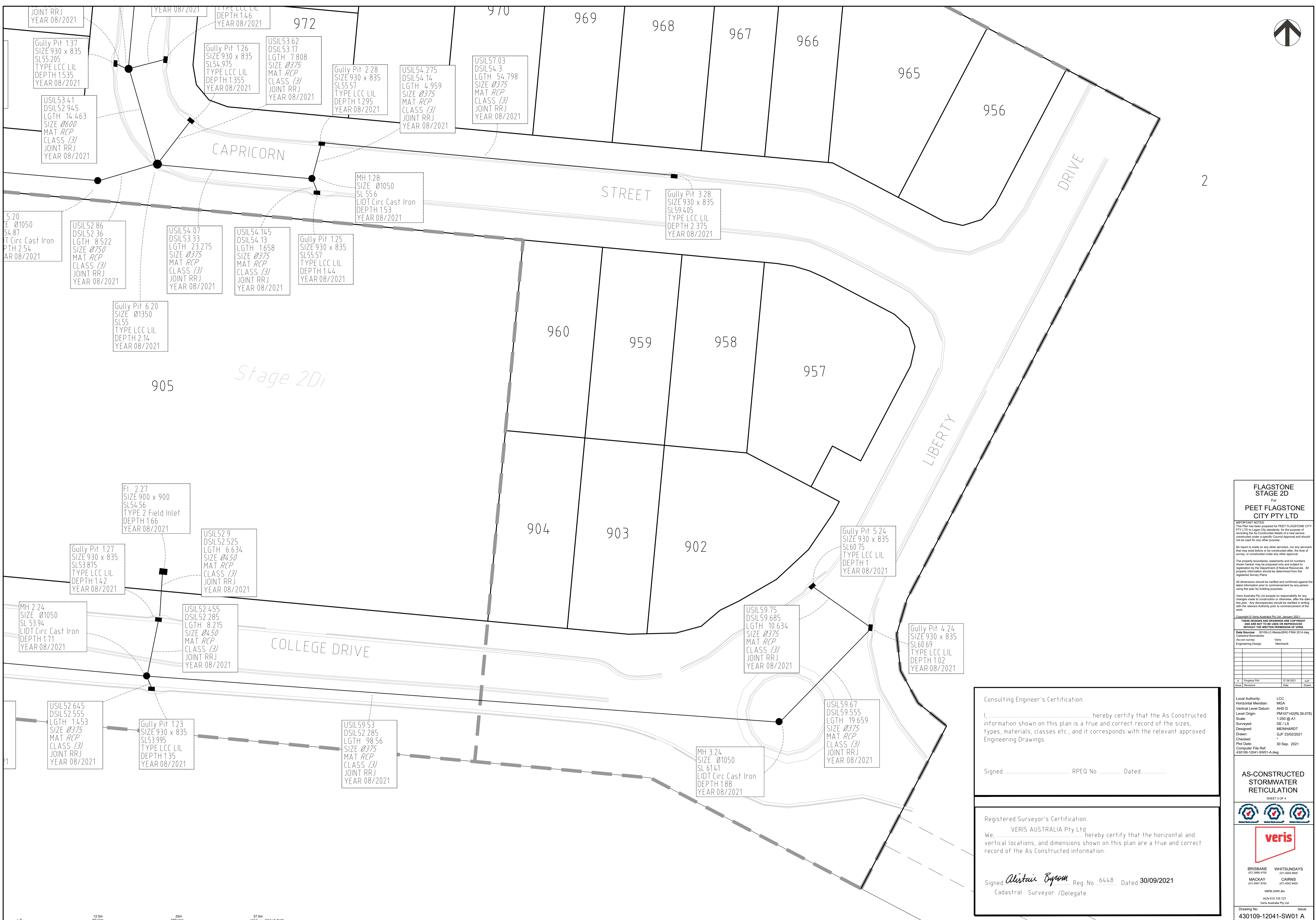
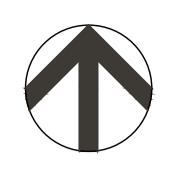

2

Stage 2Di

FLAGSTONE STAGE 2D
PEET FLAGSTONE CITY PTY LTD

IMPORTANT NOTES
This Plan has been prepared for PEET FLAGSTONE CITY PTY LTD in order to record the details of a new service constructed under a specific Council Approval and should not be used for any other purpose.
No report is made on any other services, nor any services that may exist before or be constructed after the time of survey, or constructed under any other approval.
The property boundaries, assessments and lot numbers shown herein may be proposed only and subject to registration by the Department of Natural Resources. All property information should be determined from the registered Survey Plans.
All dimensions should be verified and confirmed against the latest information prior to commencement by any person using this plan for building purposes.
Veris Australia Pty Ltd accepts no responsibility for any changes made to construction or otherwise, after the date of this plan. Any discrepancies should be clarified in writing with the relevant Authority prior to commencement of the work.
Copyright © Veris Australia Pty Ltd, January 2021
THIS DESIGN AND DRAWING ARE COPYRIGHT AND ARE NOT TO BE USED OR REPRODUCED WITHOUT THE WRITTEN PERMISSION OF VERIS AUSTRALIA PTY LTD
Data Sources: 30109-12041-SW01-RV-FS4 2014.dwg
As-con survey: Veris
Engineering Design: Memberit

Rev	Description	Date	By
A	Progress Plan	27/08/2021	GP
B	Final		

Local Authority: LCC
Horizontal Meridian: MGA
Vertical Level Datum: AHD D
Level Origin: PM107142(RL98.078)
Scale: 1:250 @ A1
Surveyed: DE JLS
Designed: MEINHARDT
Drawn: GJF 23/02/2021
Checked: 30 Sep, 2021
Plot Date:
Computer File Ref: 430109-12041-SW01-A.dwg

AS-CONSTRUCTED STORMWATER RETICULATION
SHEET 3 OF 4

BRISBANE (07) 966 4700
MACKAY (07) 4927 9700
CAIRNS (07) 4052 9400
WHITBY (07) 4052 9400
veris.com.au
ACN 615 735 727
Veris Australia Pty Ltd
Drawing No. 430109-12041-SW01 A Issue

Consulting Engineer's Certification.
I, hereby certify that the As Constructed information shown on this plan is a true and correct record of the sizes, types, materials, classes etc., and it corresponds with the relevant approved Engineering Drawings.
Signed RPEQ No Dated.....

Registered Surveyor's Certification.
We, VERIS AUSTRALIA Pty Ltd, hereby certify that the horizontal and vertical locations, and dimensions shown on this plan are a true and correct record of the As Constructed information.
Signed *Alistair Byron* Reg. No. 6448 Dated 30/09/2021
Cadastral Surveyor /Delegate

