

LEGEND

Final surface contours based on A.H.D. datum at an interval of 0.5m, shown as: 15.5

Where applicable, areas to be filled are shown as:

Depth of fill, in metres, shown as:- +0.5

Retaining wall and retaining wall height, shown on the lower side of the wall, have been taken from plans supplied by Peak Urban and shown as: (1.2)

Bin Pad Location shown as:

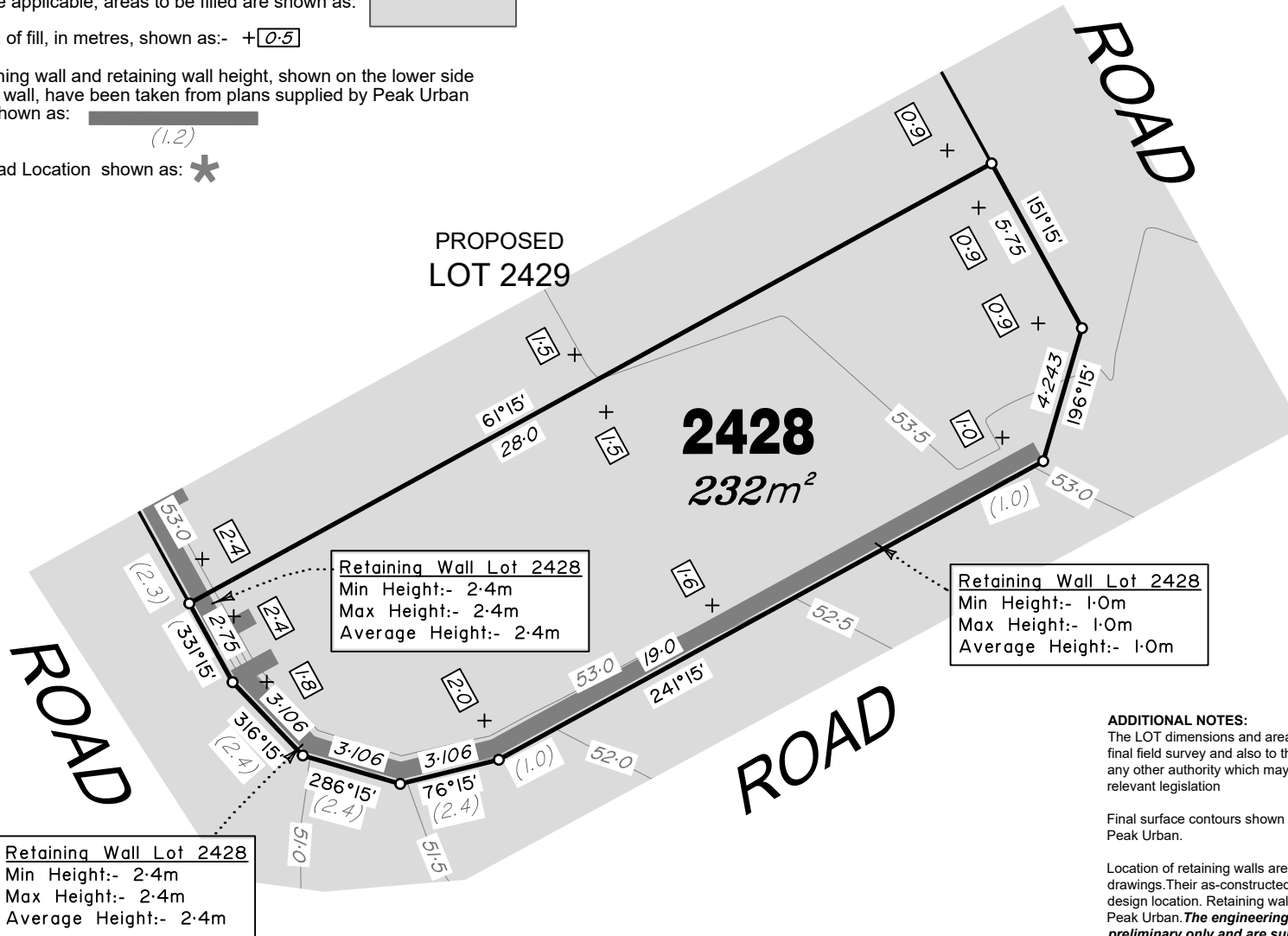

Retaining Wall Lot 2428
Min Height:- 2.4m
Max Height:- 2.4m
Average Height:- 2.4m

Retaining Wall Lot 2428
Min Height:- 2.4m
Max Height:- 2.4m
Average Height:- 2.4m

Retaining Wall Lot 2428
Min Height:- 1.0m
Max Height:- 1.0m
Average Height:- 1.0m

ADDITIONAL NOTES:
The LOT dimensions and area shown hereon are subject to final field survey and also to the requirements of Council and any other authority which may have requirements under any relevant legislation

Final surface contours shown hereon have been supplied by Peak Urban.

Location of retaining walls are as shown on Engineering design drawings. Their as-constructed location may differ from their design location. Retaining wall heights have been supplied by Peak Urban. **The engineering detail shown hereon are preliminary only and are subject to change in final design and statutory approvals**

Compaction of any fill material placed on this site shall be completed to level one inspection and testing services in accordance with AS3798-2007.

Depth of fill values are calculated to the pre-development surface.
Copyright © Veris Australia Pty Ltd
20/04/2022.



FLAGSTONE PRECINCT 1 STAGE 5J For PEET FLAGSTONE CITY PTY LTD

IMPORTANT NOTES:
(These notes are an integral part of this plan)
This plan has been prepared for PEET FLAGSTONE CITY PTY LTD for the purposes of **A Disclosure Plan Under the Land Sales Act 1984 (as amended)**.
It is not to be used by any other person or corporation or for any other purposes and is subject to the following limitations:
Please refer to the approved Development Application for conditions relating to the LOT and to approved Operational Works drawings for services location and possible easements.

THESE DESIGNS AND DRAWINGS ARE COPYRIGHT AND ARE NOT TO BE USED OR REPRODUCED WITHOUT THE WRITTEN PERMISSION OF VERIS

Data Sources
Cadastral Boundaries
30109-C-Master(CX) F394 2014.dwg
Engineering Design
BASE FILE - Stage 5J SK 5J - 11 03 2022.dwg
Final Surface Contours
FLAGSTONE - STAGE 5J - DISCLOSURE
INFO - 11 03 2022 - Design Tin.dxf
Depth of Fill
FLAGSTONE - STAGE 5J - DISCLOSURE
INFO - 11 03 2022 - Depth Contours.dwg

B	Wall Heights Updated	19/04/2022	BK
A	Original	08/04/2022	BK
Issue	Revisions	Date	Drawn

Locality: FLAGSTONE
Local Authority: LOGAN CITY COUNCIL
Horizontal Meridian: MGA Zone 56
Vertical Level Datum: AHD D
Scale: 1:200 @ A4
Designed: Peak Urban
Drawn: BK 08/04/2022
Checked: DE 08/04/2022
Plot Date: 08 May, 2022
Computer File Ref: 30109-S15J-DP-(B).dwg

DISCLOSURE PLAN of Proposed LOT 2428 being part of Lot 911 on SP321079



BRISBANE (07) 3666 4700
WHITSUNDAYS (07) 4945 6600
MACKAY (07) 4957 9700
CAIRNS (07) 4252 9400

veris.com.au
ACN 615 735 727
Veris Australia Pty Ltd

Drawing No 30109-DP-2428 Issue B

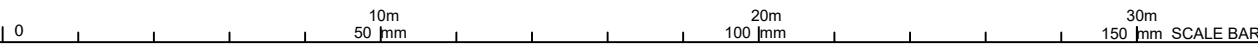

LEGEND

Final surface contours based on A.H.D. datum at an interval of 0.5m, shown as: 15.5

Where applicable, areas to be filled are shown as:

Depth of fill, in metres, shown as:- +0.5

Retaining wall and retaining wall height, shown on the lower side of the wall, have been taken from plans supplied by Peak Urban and shown as: (1.2)

Bin Pad Location shown as:

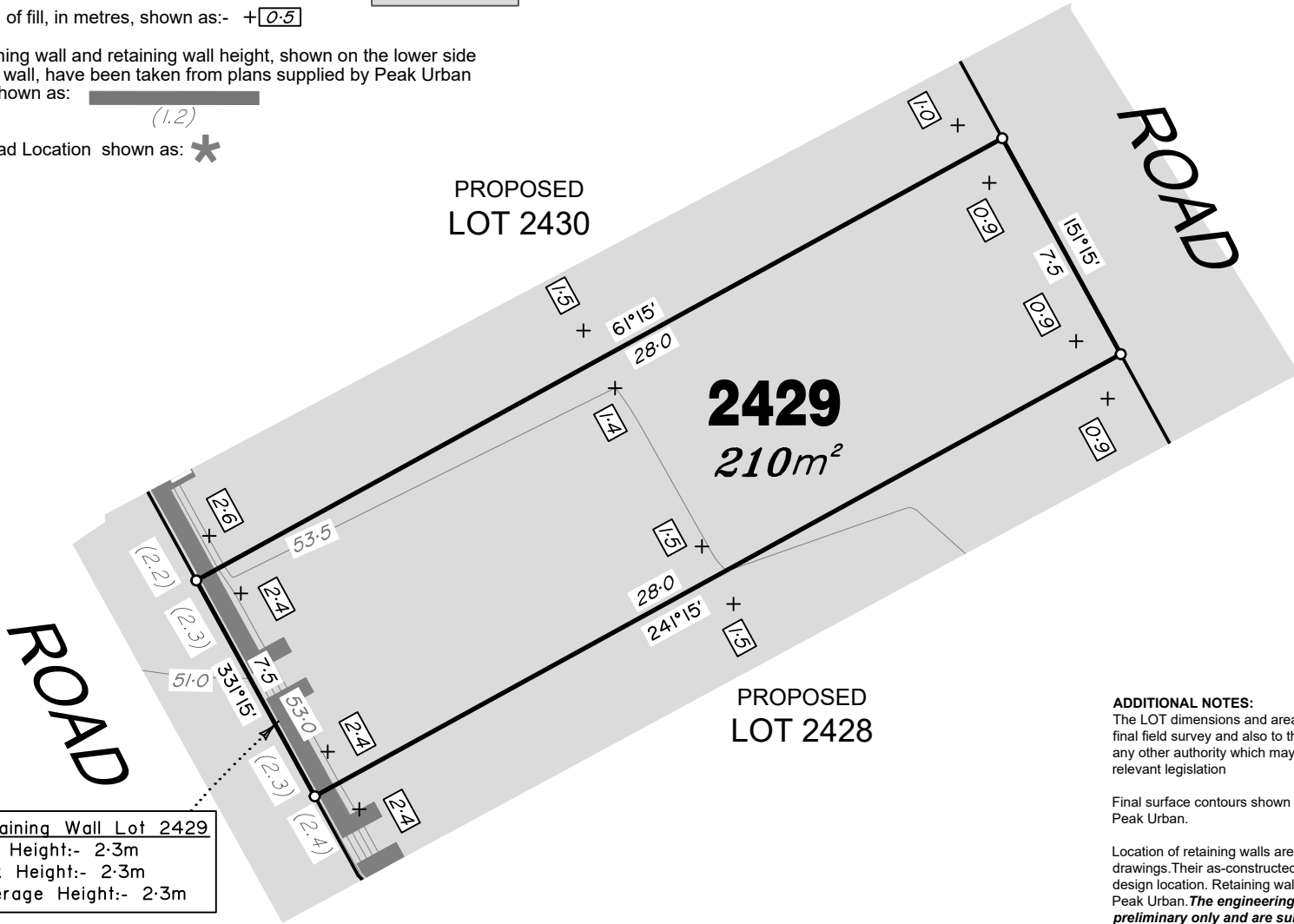

Retaining Wall Lot 2429
 Min Height:- 2.3m
 Max Height:- 2.3m
 Average Height:- 2.3m



FLAGSTONE PRECINCT 1 STAGE 5J For PEET FLAGSTONE CITY PTY LTD

IMPORTANT NOTES:
 (These notes are an integral part of this plan)
 This plan has been prepared for PEET FLAGSTONE CITY PTY LTD for the purposes of **A Disclosure Plan Under the Land Sales Act 1984 (as amended)**.
 It is not to be used by any other person or corporation or for any other purposes and is subject to the following limitations:

Please refer to the approved Development Application for conditions relating to the LOT and to approved Operational Works drawings for services location and possible easements.

THESE DESIGNS AND DRAWINGS ARE COPYRIGHT AND ARE NOT TO BE USED OR REPRODUCED WITHOUT THE WRITTEN PERMISSION OF VERIS

Data Sources
 Cadastral Boundaries
 30109-C-Master(CX) FS94 2014.dwg
 Engineering Design
 BASE FILE - Stage 5J SK 5I - 11 03 2022.dwg
 Final Surface Contours
 FLAGSTONE - STAGE 5J - DISCLOSURE
 INFO - 11 03 2022 - Design Tin.dxf
 Depth of Fill
 FLAGSTONE - STAGE 5J - DISCLOSURE
 INFO - 11 03 2022 - Depth Contours.dwg

B	Wall Heights Updated	19/04/2022	BK
A	Original	08/04/2022	BK
Issue	Revisions	Date	Drawn

Locality: FLAGSTONE
 Local Authority: LOGAN CITY COUNCIL
 Horizontal Meridian: MGA Zone 56
 Vertical Level Datum: AHD D
 Scale: 1:200 @ A4
 Designed: Peak Urban
 Drawn: BK 08/04/2022
 Checked: DE 08/04/2022
 Plot Date: 08 May, 2022
 Computer File Ref: 30109-St5J-DP-(B).dwg

DISCLOSURE PLAN of Proposed LOT 2429 being part of Lot 911 on SP321079



BRISBANE WHITSUNDAYS
 (07) 3666 4700 (07) 4945 6600
 MACKAY CAIRNS
 (07) 4957 9700 (07) 4252 9400

veris.com.au
 ACN 615 735 727
 Veris Australia Pty Ltd

Drawing No Issue
 30109-DP-2429 B

ADDITIONAL NOTES:
 The LOT dimensions and area shown hereon are subject to final field survey and also to the requirements of Council and any other authority which may have requirements under any relevant legislation

Final surface contours shown hereon have been supplied by Peak Urban.

Location of retaining walls are as shown on Engineering design drawings. Their as-constructed location may differ from their design location. Retaining wall heights have been supplied by Peak Urban. **The engineering detail shown hereon are preliminary only and are subject to change in final design and statutory approvals**

Compaction of any fill material placed on this site shall be completed to level one inspection and testing services in accordance with AS3798-2007.

Depth of fill values are calculated to the pre-development surface.
 Copyright © Veris Australia Pty Ltd
 20/04/2022.

LEGEND

Final surface contours based on A.H.D. datum at an interval of 0.5m, shown as: 15.5

Where applicable, areas to be filled are shown as:

Depth of fill, in metres, shown as:- +0.5

Retaining wall and retaining wall height, shown on the lower side of the wall, have been taken from plans supplied by Peak Urban and shown as: (1.2)

Bin Pad Location shown as:



FLAGSTONE PRECINCT 1 STAGE 5J For PEET FLAGSTONE CITY PTY LTD

IMPORTANT NOTES:
(These notes are an integral part of this plan)
This plan has been prepared for PEET FLAGSTONE CITY PTY LTD for the purposes of **A Disclosure Plan Under the Land Sales Act 1984 (as amended)**.

It is not to be used by any other person or corporation or for any other purposes and is subject to the following limitations:

Please refer to the approved Development Application for conditions relating to the LOT and to approved Operational Works drawings for services location and possible easements.

THESE DESIGNS AND DRAWINGS ARE COPYRIGHT AND ARE NOT TO BE USED OR REPRODUCED WITHOUT THE WRITTEN PERMISSION OF VERIS

Data Sources
Cadastral Boundaries
30109-C-Master(CX) FS94 2014.dwg
Engineering Design
BASE FILE - Stage 5J SK 5J - 11 03 2022.dwg
Final Surface Contours
FLAGSTONE - STAGE 5J - DISCLOSURE
INFO - 11 03 2022 - Design Tin.dxf
Depth of Fill
FLAGSTONE - STAGE 5J - DISCLOSURE
INFO - 11 03 2022 - Depth Contours.dwg

B	Wall Heights Updated	19/04/2022	BK
A	Original	08/04/2022	BK
Issue	Revisions	Date	Drawn

Locality: FLAGSTONE
Local Authority: LOGAN CITY COUNCIL
Horizontal Meridian: MGA Zone 56
Vertical Level Datum: AHD D
Scale: 1:200 @ A4
Designed: Peak Urban
Drawn: BK 08/04/2022
Checked: DE 08/04/2022
Plot Date: 08 May, 2022
Computer File Ref: 30109-St5J-DP-(B).dwg

DISCLOSURE PLAN of Proposed LOT 2430 being part of Lot 911 on SP321079



veris

BRISBANE WHITSUNDAYS
(07) 3666 4700 (07) 4945 6600
MACKAY CAIRNS
(07) 4957 9700 (07) 4252 9400

veris.com.au
ACN 615 735 727
Veris Australia Pty Ltd

Drawing No 30109-DP-2430 Issue B

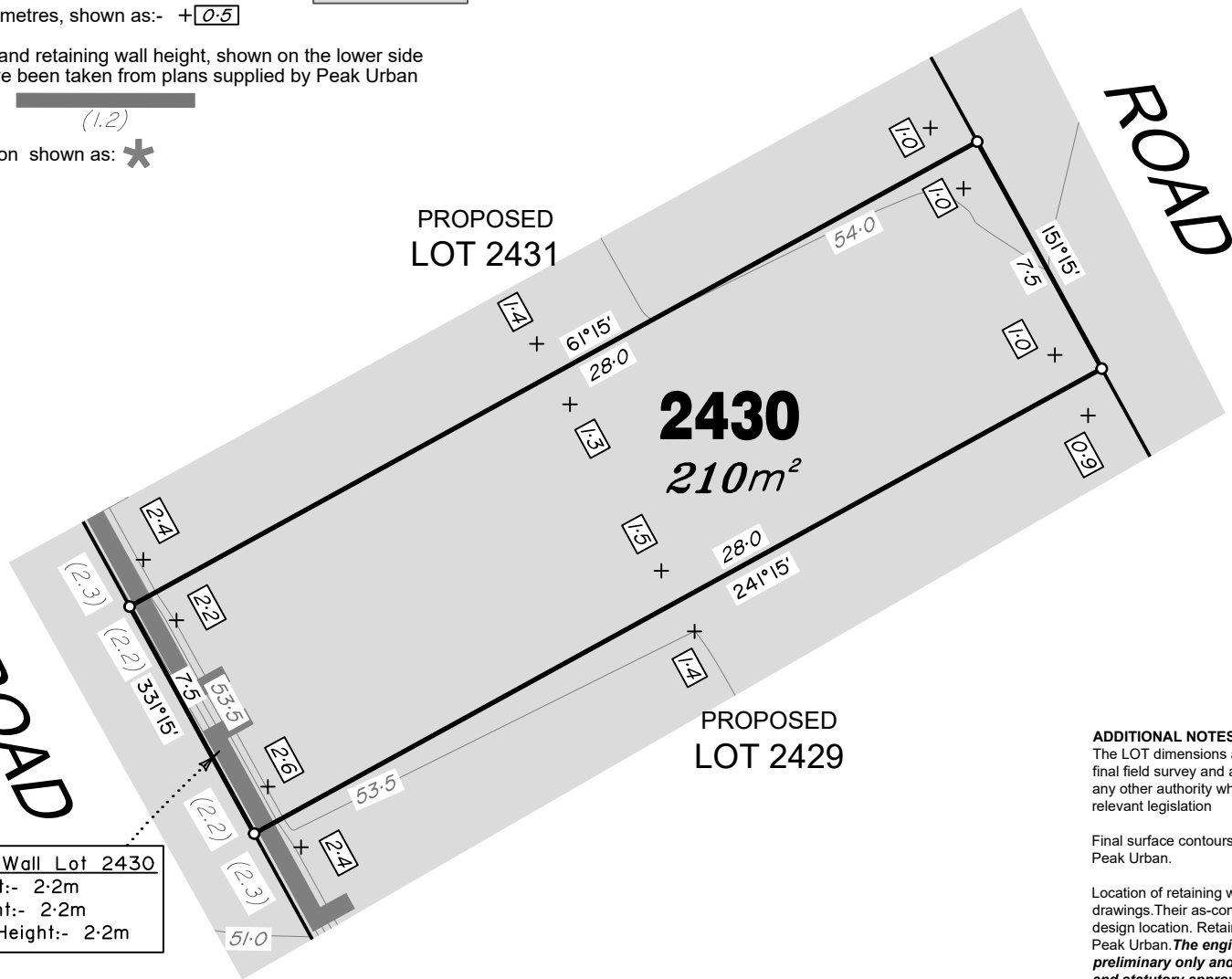

Retaining Wall Lot 2430
Min Height:- 2.2m
Max Height:- 2.2m
Average Height:- 2.2m

ADDITIONAL NOTES:

The LOT dimensions and area shown hereon are subject to final field survey and also to the requirements of Council and any other authority which may have requirements under any relevant legislation

Final surface contours shown hereon have been supplied by Peak Urban.

Location of retaining walls are as shown on Engineering design drawings. Their as-constructed location may differ from their design location. Retaining wall heights have been supplied by Peak Urban. **The engineering detail shown hereon are preliminary only and are subject to change in final design and statutory approvals**

Compaction of any fill material placed on this site shall be completed to level one inspection and testing services in accordance with AS3798-2007.

Depth of fill values are calculated to the pre-development surface.
Copyright © Veris Australia Pty Ltd
20/04/2022.



LEGEND

Final surface contours based on A.H.D. datum at an interval of 0.5m, shown as: 15.5

Where applicable, areas to be filled are shown as:

Depth of fill, in metres, shown as:- +0.5

Retaining wall and retaining wall height, shown on the lower side of the wall, have been taken from plans supplied by Peak Urban and shown as: (1.2)

Bin Pad Location shown as: *



FLAGSTONE PRECINCT 1 STAGE 5J For PEET FLAGSTONE CITY PTY LTD

IMPORTANT NOTES:
(These notes are an integral part of this plan)
This plan has been prepared for PEET FLAGSTONE CITY PTY LTD for the purposes of **A Disclosure Plan Under the Land Sales Act 1984 (as amended)**.
It is not to be used by any other person or corporation or for any other purposes and is subject to the following limitations:

Please refer to the approved Development Application for conditions relating to the LOT and to approved Operational Works drawings for services location and possible easements.

THESE DESIGNS AND DRAWINGS ARE COPYRIGHT AND ARE NOT TO BE USED OR REPRODUCED WITHOUT THE WRITTEN PERMISSION OF VERIS

Data Sources
Cadastral Boundaries
30109-C-Master(CX) FS94 2014.dwg
Engineering Design
BASE FILE - Stage 5J SK 5J - 11 03 2022.dwg
Final Surface Contours
FLAGSTONE - STAGE 5J - DISCLOSURE
INFO - 11 03 2022 - Design Tin.dwg
Depth of Fill
FLAGSTONE - STAGE 5J - DISCLOSURE
INFO - 11 03 2022 - Depth Contours.dwg

B	Wall Heights Updated	10/04/2022	BK
A	Original	08/04/2022	BK
Issue	Revisions	Date	Drawn

Locality: FLAGSTONE
Local Authority: LOGAN CITY COUNCIL
Horizontal Meridian: MGA Zone 56
Vertical Level Datum: AHD D
Scale: 1:200 @ A4
Designed: Peak Urban
Drawn: BK 08/04/2022
Checked: DE 08/04/2022
Plot Date: 08 May, 2022
Computer File Ref: 30109-St5J-DP-(B).dwg

DISCLOSURE PLAN of Proposed LOT 2431 being part of Lot 911 on SP321079



BRISBANE WHITSUNDAYS
(07) 3666 4700 (07) 4945 6600
MACKAY CAIRNS
(07) 4957 9700 (07) 4252 9400

veris.com.au
ACN 615 735 727
Veris Australia Pty Ltd

Drawing No 30109-DP-2431 Issue B

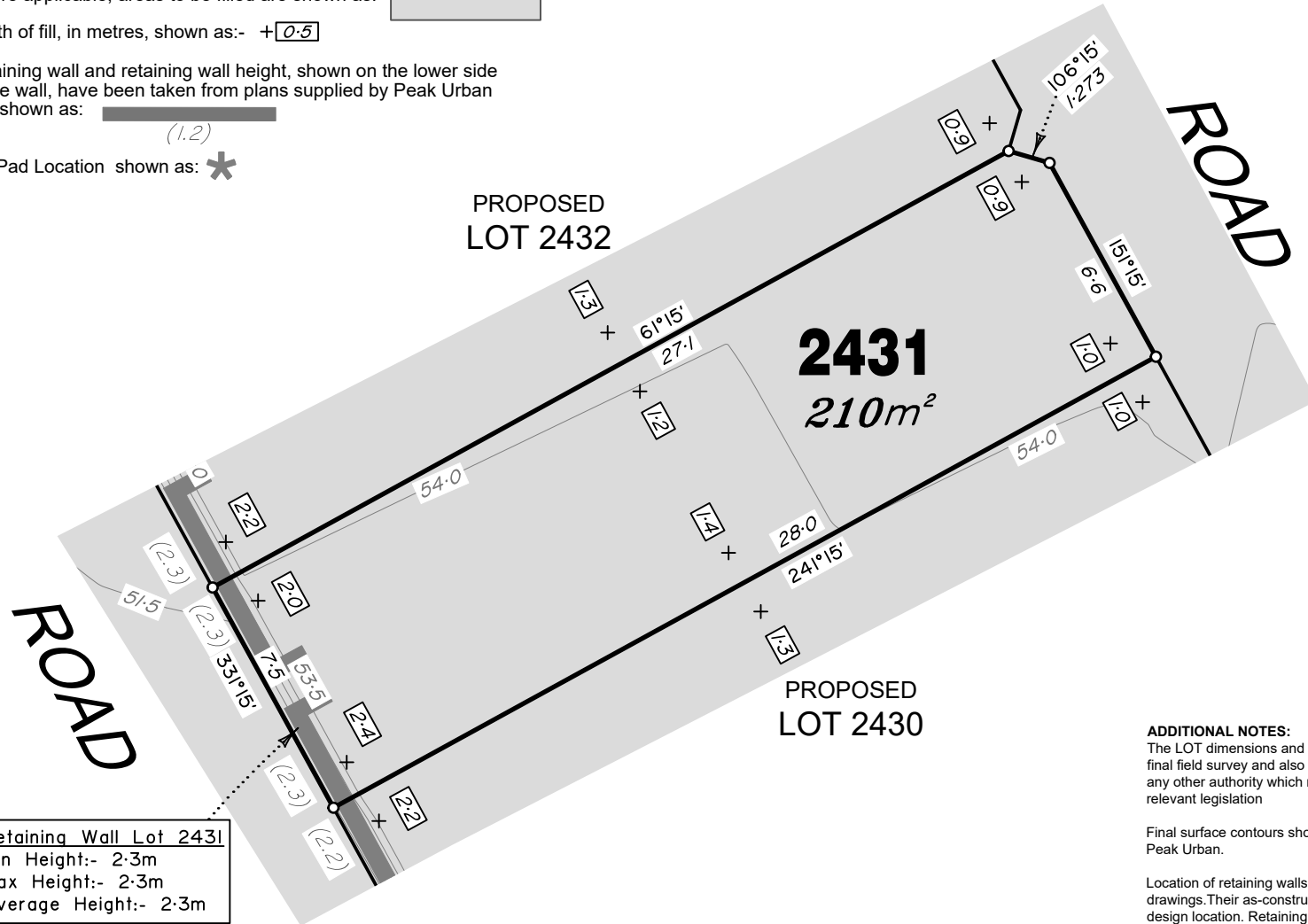

Retaining Wall Lot 2431
Min Height:- 2.3m
Max Height:- 2.3m
Average Height:- 2.3m

ADDITIONAL NOTES:
The LOT dimensions and area shown hereon are subject to final field survey and also to the requirements of Council and any other authority which may have requirements under any relevant legislation

Final surface contours shown hereon have been supplied by Peak Urban.

Location of retaining walls are as shown on Engineering design drawings. Their as-constructed location may differ from their design location. Retaining wall heights have been supplied by Peak Urban. **The engineering detail shown hereon are preliminary only and are subject to change in final design and statutory approvals**

Compaction of any fill material placed on this site shall be completed to level one inspection and testing services in accordance with AS3798-2007.

Depth of fill values are calculated to the pre-development surface.
Copyright © Veris Australia Pty Ltd
20/04/2022.



LEGEND

Final surface contours based on A.H.D. datum at an interval of 0.5m, shown as: 15.5

Where applicable, areas to be filled are shown as:

Depth of fill, in metres, shown as:- +0.5

Retaining wall and retaining wall height, shown on the lower side of the wall, have been taken from plans supplied by Peak Urban and shown as: (1.2)

Bin Pad Location shown as: *



FLAGSTONE PRECINCT 1 STAGE 5J For PEET FLAGSTONE CITY PTY LTD

IMPORTANT NOTES:
(These notes are an integral part of this plan)
This plan has been prepared for PEET FLAGSTONE CITY PTY LTD for the purposes of **A Disclosure Plan Under the Land Sales Act 1984 (as amended)**.
It is not to be used by any other person or corporation or for any other purposes and is subject to the following limitations:

Please refer to the approved Development Application for conditions relating to the LOT and to approved Operational Works drawings for services location and possible easements.

THESE DESIGNS AND DRAWINGS ARE COPYRIGHT AND ARE NOT TO BE USED OR REPRODUCED WITHOUT THE WRITTEN PERMISSION OF VERIS

Data Sources
Cadastral Boundaries
30109-C-Master(CX) F394 2014.dwg
Engineering Design
BASE FILE - Stage 5J SK 5J - 11 03 2022.dwg
Final Surface Contours
FLAGSTONE - STAGE 5J - DISCLOSURE
INFO - 11 03 2022 - Design Tin.dxf
Depth of Fill
FLAGSTONE - STAGE 5J - DISCLOSURE
INFO - 11 03 2022 - Depth Contours.dwg

B	Wall Heights Updated	19/04/2022	BK
A	Original	08/04/2022	BK
Issue	Revisions	Date	Drawn

Locality: FLAGSTONE
Local Authority: LOGAN CITY COUNCIL
Horizontal Meridian: MGA Zone 56
Vertical Level Datum: AHD D
Scale: 1:200 @ A4
Designed: Peak Urban
Drawn: BK 08/04/2022
Checked: DE 08/04/2022
Plot Date: 08 May, 2022
Computer File Ref: 30109-St5J-DP-(B).dwg

DISCLOSURE PLAN of Proposed LOT 2432 being part of Lot 911 on SP321079



BRISBANE WHITSUNDAYS
(07) 3666 4700 (07) 4945 6600
MACKAY CAIRNS
(07) 4957 9700 (07) 4252 9400

veris.com.au
ACN 615 735 727
Veris Australia Pty Ltd

Drawing No 30109-DP-2432 Issue B

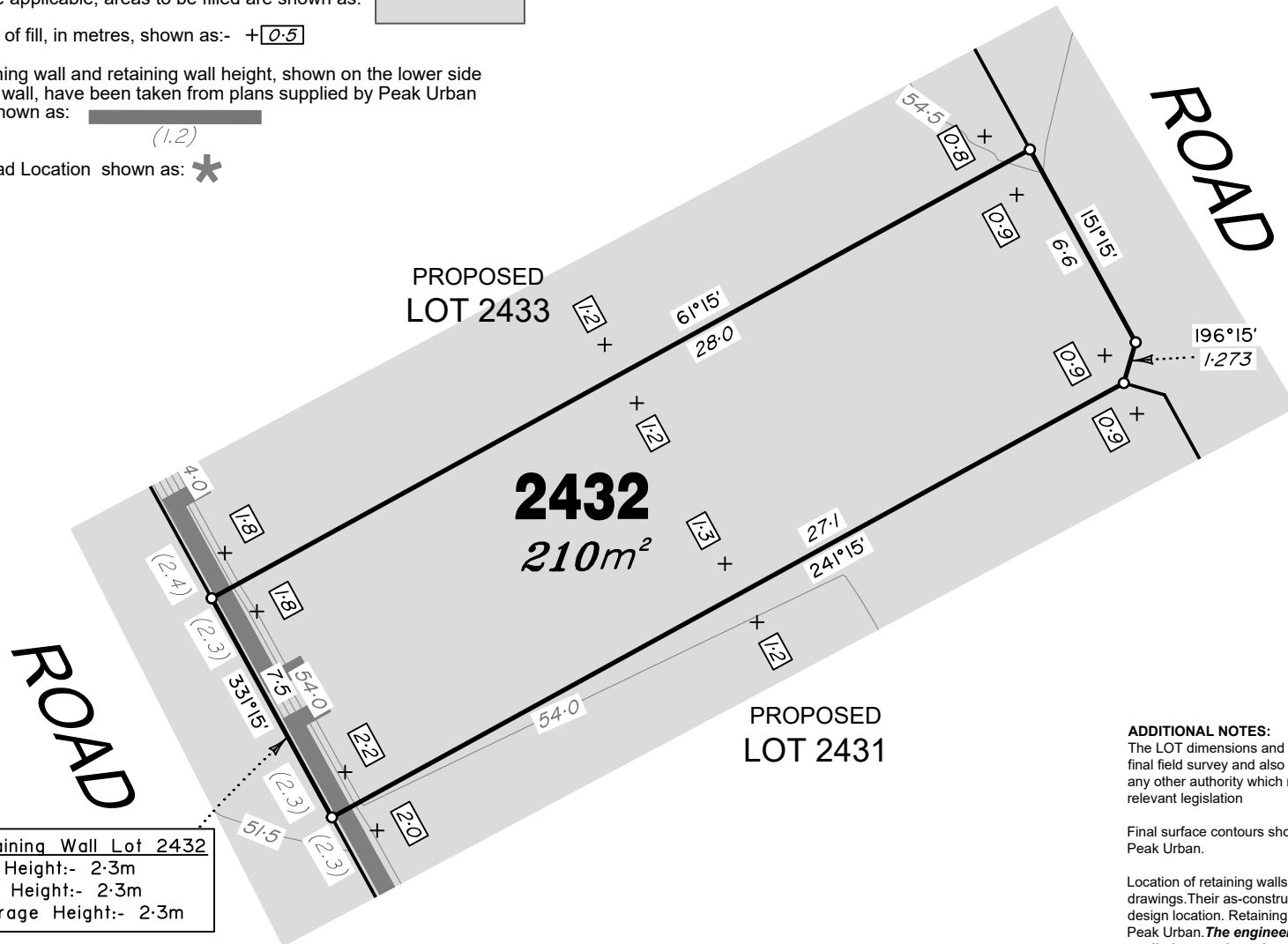

Retaining Wall Lot 2432
Min Height:- 2.3m
Max Height:- 2.3m
Average Height:- 2.3m

ADDITIONAL NOTES:
The LOT dimensions and area shown hereon are subject to final field survey and also to the requirements of Council and any other authority which may have requirements under any relevant legislation

Final surface contours shown hereon have been supplied by Peak Urban.

Location of retaining walls are as shown on Engineering design drawings. Their as-constructed location may differ from their design location. Retaining wall heights have been supplied by Peak Urban. **The engineering detail shown hereon are preliminary only and are subject to change in final design and statutory approvals**

Compaction of any fill material placed on this site shall be completed to level one inspection and testing services in accordance with AS3798-2007.

Depth of fill values are calculated to the pre-development surface.
Copyright © Veris Australia Pty Ltd
20/04/2022.





LEGEND

Final surface contours based on A.H.D. datum at an interval of 0.5m, shown as:  15.5

Where applicable, areas to be filled are shown as: 

Depth of fill, in metres, shown as:- + 0.5 

Retaining wall and retaining wall height, shown on the lower side of the wall, have been taken from plans supplied by Peak Urban and shown as:  (1.2)

Bin Pad Location shown as: * 



FLAGSTONE PRECINCT 1 STAGE 5J For PEET FLAGSTONE CITY PTY LTD

IMPORTANT NOTES:
(These notes are an integral part of this plan)
This plan has been prepared for PEET FLAGSTONE CITY PTY LTD for the purposes of **A Disclosure Plan Under the Land Sales Act 1984 (as amended)**.
It is not to be used by any other person or corporation or for any other purposes and is subject to the following limitations:

Please refer to the approved Development Application for conditions relating to the LOT and to approved Operational Works drawings for services location and possible easements.

THESE DESIGNS AND DRAWINGS ARE COPYRIGHT AND ARE NOT TO BE USED OR REPRODUCED WITHOUT THE WRITTEN PERMISSION OF VERIS

Data Sources
Cadastral Boundaries
30109-C-Master(CX) F394 2014.dwg
Engineering Design
BASE FILE - Stage 5J SK 5J - 11 03 2022.dwg
Final Surface Contours
FLAGSTONE - STAGE 5J - DISCLOSURE
INFO - 11 03 2022 - Design Tin.dxf
Depth of Fill
FLAGSTONE - STAGE 5J - DISCLOSURE
INFO - 11 03 2022 - Depth Contours.dwg

B	Wall Heights Updated	19/04/2022	BK
A	Original	08/04/2022	BK
Issue	Revisions	Date	Drawn

Locality: FLAGSTONE
Local Authority: LOGAN CITY COUNCIL
Horizontal Meridian: MGA Zone 56
Vertical Level Datum: AHD D
Scale: 1:200 @ A4
Designed: Peak Urban
Drawn: BK 08/04/2022
Checked: DE 08/04/2022
Plot Date: 08 May, 2022
Computer File Ref: 30109-St5J-DP-(B).dwg

DISCLOSURE PLAN of Proposed LOT 2433 being part of Lot 911 on SP321079



veris

BRISBANE WHITSUNDAYS
(07) 3666 4700 (07) 4945 6600
MACKAY CAIRNS
(07) 4957 9700 (07) 4252 9400

veris.com.au
ACN 615 735 727
Veris Australia Pty Ltd

Drawing No Issue
30109-DP-2433 B

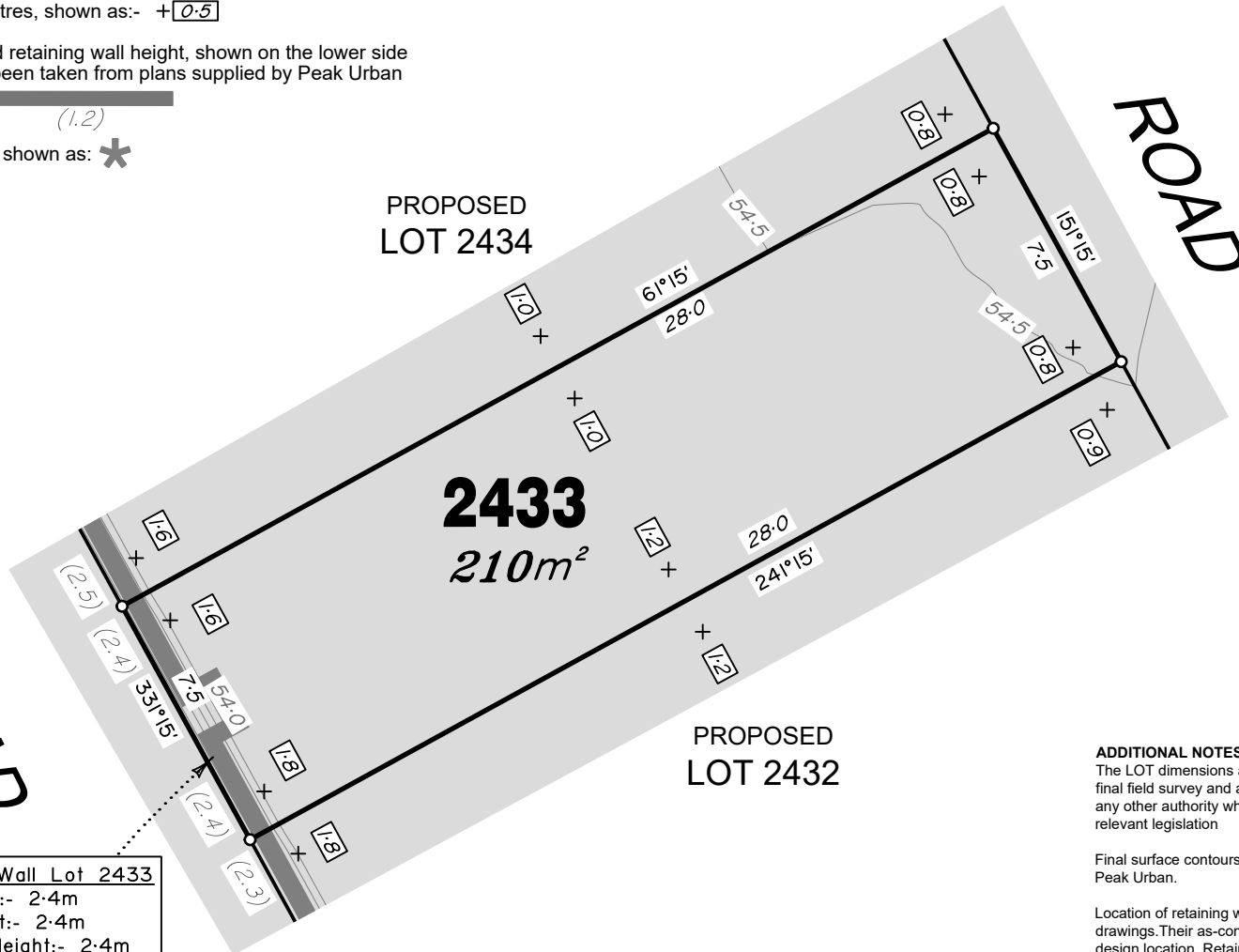

Retaining Wall Lot 2433
Min Height:- 2.4m
Max Height:- 2.4m
Average Height:- 2.4m

ADDITIONAL NOTES:
The LOT dimensions and area shown hereon are subject to final field survey and also to the requirements of Council and any other authority which may have requirements under any relevant legislation

Final surface contours shown hereon have been supplied by Peak Urban.

Location of retaining walls are as shown on Engineering design drawings. Their as-constructed location may differ from their design location. Retaining wall heights have been supplied by Peak Urban. **The engineering detail shown hereon are preliminary only and are subject to change in final design and statutory approvals**

Compaction of any fill material placed on this site shall be completed to level one inspection and testing services in accordance with AS3798-2007.

Depth of fill values are calculated to the pre-development surface.
Copyright © Veris Australia Pty Ltd
20/04/2022.





LEGEND

Final surface contours based on A.H.D. datum at an interval of 0.5m, shown as:  15.5

Where applicable, areas to be filled are shown as: 

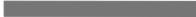
Depth of fill, in metres, shown as:-  +0.5

Retaining wall and retaining wall height, shown on the lower side of the wall, have been taken from plans supplied by Peak Urban and shown as:  (1.2)

Bin Pad Location shown as: 



FLAGSTONE PRECINCT 1 STAGE 5J For PEET FLAGSTONE CITY PTY LTD

IMPORTANT NOTES:
(These notes are an integral part of this plan)
This plan has been prepared for PEET FLAGSTONE CITY PTY LTD for the purposes of **A Disclosure Plan Under the Land Sales Act 1984 (as amended)**.
It is not to be used by any other person or corporation or for any other purposes and is subject to the following limitations:

Please refer to the approved Development Application for conditions relating to the LOT and to approved Operational Works drawings for services location and possible easements.

THESE DESIGNS AND DRAWINGS ARE COPYRIGHT AND ARE NOT TO BE USED OR REPRODUCED WITHOUT THE WRITTEN PERMISSION OF VERIS

Data Sources
Cadastral Boundaries
30109-C-Master(CX) F394 2014.dwg
Engineering Design
BASE FILE - Stage 5J SK 5I - 11 03 2022.dwg
Final Surface Contours
FLAGSTONE - STAGE 5J - DISCLOSURE
INFO - 11 03 2022 - Design Tin.dxf
Depth of Fill
FLAGSTONE - STAGE 5J - DISCLOSURE
INFO - 11 03 2022 - Depth Contours.dwg

B	Wall Heights Updated	19/04/2022	BK
A	Original	08/04/2022	BK
Issue	Revisions	Date	Drawn

Locality: FLAGSTONE
Local Authority: LOGAN CITY COUNCIL
Horizontal Meridian: MGA Zone 56
Vertical Level Datum: AHD D
Scale: 1:200 @ A4
Designed: Peak Urban
Drawn: BK 08/04/2022
Checked: DE 08/04/2022
Plot Date: 08 May, 2022
Computer File Ref: 30109-SI5J-DP-(B).dwg

DISCLOSURE PLAN of Proposed LOT 2435 being part of Lot 911 on SP321079



BRISBANE WHITSUNDAYS
(07) 3666 4700 (07) 4945 6600
MACKAY CAIRNS
(07) 4957 9700 (07) 4252 9400

veris.com.au
ACN 615 735 727
Veris Australia Pty Ltd

Drawing No 30109-DP-2435 Issue B



Retaining Wall Lot 2435
Min Height:- 1.0m
Max Height:- 1.0m
Average Height:- 1.0m

Retaining Wall Lot 2435
Min Height:- 2.5m
Max Height:- 2.5m
Average Height:- 2.5m

ADDITIONAL NOTES:
The LOT dimensions and area shown hereon are subject to final field survey and also to the requirements of Council and any other authority which may have requirements under any relevant legislation

Final surface contours shown hereon have been supplied by Peak Urban.

Location of retaining walls are as shown on Engineering design drawings. Their as-constructed location may differ from their design location. Retaining wall heights have been supplied by Peak Urban. **The engineering detail shown hereon are preliminary only and are subject to change in final design and statutory approvals**

Compaction of any fill material placed on this site shall be completed to level one inspection and testing services in accordance with AS3798-2007.

Depth of fill values are calculated to the pre-development surface.
Copyright © Veris Australia Pty Ltd
20/04/2022.



SANDY CREEK ROAD



Retaining Wall Lot 2436
 Min Height:- 0.5m
 Max Height:- 0.5m
 Average Height:- 0.5m

PROPOSED LOT 2437

2436
307m²

LEGEND

Final surface contours based on A.H.D. datum at an interval of 0.5m, shown as: $\text{---} 15.5 \text{---}$

Where applicable, areas to be filled are shown as:

Depth of fill, in metres, shown as:- $\text{+} 0.5$

Retaining wall and retaining wall height, shown on the lower side of the wall, have been taken from plans supplied by Peak Urban and shown as: $\text{---} (1.2) \text{---}$

Bin Pad Location shown as:

ADDITIONAL NOTES:

The LOT dimensions and area shown hereon are subject to final field survey and also to the requirements of Council and any other authority which may have requirements under any relevant legislation

Final surface contours shown hereon have been supplied by Peak Urban.

Location of retaining walls are as shown on Engineering design drawings. Their as-constructed location may differ from their design location. Retaining wall heights have been supplied by Peak Urban. **The engineering detail shown hereon are preliminary only and are subject to change in final design and statutory approvals**

Compaction of any fill material placed on this site shall be completed to level one inspection and testing services in accordance with AS3798-2007.

Depth of fill values are calculated to the pre-development surface.

Copyright © Veris Australia Pty Ltd
 20/04/2022.

FLAGSTONE PRECINCT 1 STAGE 5J For PEET FLAGSTONE CITY PTY LTD

IMPORTANT NOTES:
 (These notes are an integral part of this plan)
 This plan has been prepared for PEET FLAGSTONE CITY PTY LTD for the purposes of **A Disclosure Plan Under the Land Sales Act 1984 (as amended)**.
 It is not to be used by any other person or corporation or for any other purposes and is subject to the following limitations:

Please refer to the approved Development Application for conditions relating to the LOT and to approved Operational Works drawings for services location and possible easements.

THESE DESIGNS AND DRAWINGS ARE COPYRIGHT AND ARE NOT TO BE USED OR REPRODUCED WITHOUT THE WRITTEN PERMISSION OF VERIS.

Data Sources
 Cadastral Boundaries
 30109-C-Master(CX) F394 2014.dwg
 Engineering Design
 BASE FILE - Stage 5J SK 5I - 11 03 2022.dwg
 Final Surface Contours
 FLAGSTONE - STAGE 5J - DISCLOSURE
 INFO - 11 03 2022 - Design Tin.dxf
 Depth of Fill
 FLAGSTONE - STAGE 5J - DISCLOSURE
 INFO - 11 03 2022 - Depth Contours.dwg

Issue	Revisions	Date	Drawn
B	Wall Heights Updated	19/04/2022	BK
A	Original	08/04/2022	BK

Locality: FLAGSTONE
 Local Authority: LOGAN CITY COUNCIL
 Horizontal Meridian: MGA Zone 56
 Vertical Level Datum: AHD D
 Scale: 1:200 @ A4
 Designed: Peak Urban
 Drawn: BK 08/04/2022
 Checked: DE 08/04/2022
 Plot Date: 08 May, 2022
 Computer File Ref: 30109-St5J-DP-(B).dwg

DISCLOSURE PLAN of Proposed LOT 2436 being part of Lot 911 on SP321079



BRISBANE WHITSUNDAYS
 (07) 3666 4700 (07) 4945 6600
 MACKAY CAIRNS
 (07) 4957 9700 (07) 4252 9400

veris.com.au
 ACN 615 735 727
 Veris Australia Pty Ltd

Drawing No 30109-DP-2436 Issue B





SANDY CREEK ROAD

Retaining Wall Lot 2437
 Min Height:- 0.9m
 Max Height:- 0.9m
 Average Height:- 0.9m

PROPOSED LOT 2436

2437

210m²

PROPOSED LOT 2438

ROAD

LEGEND

Final surface contours based on A.H.D. datum at an interval of 0.5m, shown as: — 15.5 —

Where applicable, areas to be filled are shown as:

Depth of fill, in metres, shown as:- + 0.5

Retaining wall and retaining wall height, shown on the lower side of the wall, have been taken from plans supplied by Peak Urban and shown as:

(1.2)

Bin Pad Location shown as: *

FLAGSTONE PRECINCT 1 STAGE 5J

For
**PEET FLAGSTONE
CITY PTY LTD**

IMPORTANT NOTES:
(These notes are an integral part of this plan)
This plan has been prepared for PEET FLAGSTONE CITY PTY LTD for the purposes of **A Disclosure Plan Under the Land Sales Act 1984 (as amended)**.
It is not to be used by any other person or corporation or for any other purposes and is subject to the following limitations:

Please refer to the approved Development Application for conditions relating to the LOT and to approved Operational Works drawings for services location and possible easements.

THESE DESIGNS AND DRAWINGS ARE COPYRIGHT AND ARE NOT TO BE USED OR REPRODUCED WITHOUT THE WRITTEN PERMISSION OF VERIS.

Data Sources
Cadastral Boundaries
30109-C-Master(CX) F394 2014.dwg
Engineering Design
BASE FILE - Stage 5J SK 5J - 11 03 2022.dwg
Final Surface Contours
FLAGSTONE - STAGE 5J - DISCLOSURE
INFO - 11 03 2022 - Design Tin.dxf
Depth of Fill
FLAGSTONE - STAGE 5J - DISCLOSURE
INFO - 11 03 2022 - Depth Contours.dwg

Issue	Revisions	Date	Drawn
B	Wall Heights Updated	19/04/2022	BK
A	Original	08/04/2022	BK

Locality: FLAGSTONE
Local Authority: LOGAN CITY COUNCIL
Horizontal Meridian: MGA Zone 56
Vertical Level Datum: AHD D
Scale: 1:200 @ A4
Designed: Peak Urban
Drawn: BK 08/04/2022
Checked: DE 08/04/2022
Plot Date: 08 May, 2022
Computer File Ref: 30109-St5J-DP-(B).dwg

DISCLOSURE PLAN of Proposed LOT 2437 being part of Lot 911 on SP321079



veris

BRISBANE WHITSUNDAYS
(07) 3666 4700 (07) 4945 6600

MACKAY CAIRNS
(07) 4957 9700 (07) 4252 9400

veris.com.au

ACN 615 735 727
Veris Australia Pty Ltd

Drawing No 30109-DP-2437 Issue B

ADDITIONAL NOTES:

The LOT dimensions and area shown hereon are subject to final field survey and also to the requirements of Council and any other authority which may have requirements under any relevant legislation

Final surface contours shown hereon have been supplied by Peak Urban.

Location of retaining walls are as shown on Engineering design drawings. Their as-constructed location may differ from their design location. Retaining wall heights have been supplied by Peak Urban. **The engineering detail shown hereon are preliminary only and are subject to change in final design and statutory approvals**

Compaction of any fill material placed on this site shall be completed to level one inspection and testing services in accordance with AS3798-2007.

Depth of fill values are calculated to the pre-development surface.

Copyright © Veris Australia Pty Ltd
20/04/2022.



SANDY CREEK ROAD



Retaining Wall Lot 2438
 Min Height:- 1.0m
 Max Height:- 1.0m
 Average Height:- 1.0m

2438
210m²

PROPOSED LOT 2439

PROPOSED LOT 2437

ROAD

LEGEND

Final surface contours based on A.H.D. datum at an interval of 0.5m, shown as: — 15.5 —

Where applicable, areas to be filled are shown as:

Depth of fill, in metres, shown as:- + 0.5

Retaining wall and retaining wall height, shown on the lower side of the wall, have been taken from plans supplied by Peak Urban and shown as:

Bin Pad Location shown as: *

ADDITIONAL NOTES:

The LOT dimensions and area shown hereon are subject to final field survey and also to the requirements of Council and any other authority which may have requirements under any relevant legislation

Final surface contours shown hereon have been supplied by Peak Urban.

Location of retaining walls are as shown on Engineering design drawings. Their as-constructed location may differ from their design location. Retaining wall heights have been supplied by Peak Urban. **The engineering detail shown hereon are preliminary only and are subject to change in final design and statutory approvals**

Compaction of any fill material placed on this site shall be completed to level one inspection and testing services in accordance with AS3798-2007.

Depth of fill values are calculated to the pre-development surface.

Copyright © Veris Australia Pty Ltd
 20/04/2022.

FLAGSTONE PRECINCT 1 STAGE 5J For PEET FLAGSTONE CITY PTY LTD

IMPORTANT NOTES:
 (These notes are an integral part of this plan)

This plan has been prepared for PEET FLAGSTONE CITY PTY LTD for the purposes of **A Disclosure Plan Under the Land Sales Act 1984 (as amended)**.

It is not to be used by any other person or corporation or for any other purposes and is subject to the following limitations:

Please refer to the approved Development Application for conditions relating to the LOT and to approved Operational Works drawings for services location and possible easements.

THESE DESIGNS AND DRAWINGS ARE COPYRIGHT AND ARE NOT TO BE USED OR REPRODUCED WITHOUT THE WRITTEN PERMISSION OF VERIS

Data Sources
 Cadastral Boundaries
 30109-C-Master(CX) F394 2014.dwg
 Engineering Design
 BASE FILE - Stage 5J SK 5J - 11 03 2022.dwg
 Final Surface Contours
 FLAGSTONE - STAGE 5J - DISCLOSURE
 INFO - 11 03 2022 - Design Tin.dxf
 Depth of Fill
 FLAGSTONE - STAGE 5J - DISCLOSURE
 INFO - 11 03 2022 - Depth Contours.dwg

B	Wall Heights Updated	19/04/2022	BK
A	Original	08/04/2022	BK
Issue	Revisions	Date	Drawn

Locality: FLAGSTONE
 Local Authority: LOGAN CITY COUNCIL
 Horizontal Meridian: MGA Zone 56
 Vertical Level Datum: AHD D
 Scale: 1:200 @ A4
 Designed: Peak Urban
 Drawn: BK 08/04/2022
 Checked: DE 08/04/2022
 Plot Date: 08 May, 2022
 Computer File Ref: 30109-St5J-DP-(B).dwg

DISCLOSURE PLAN of Proposed LOT 2438 being part of Lot 911 on SP321079



BRISBANE (07) 3666 4700
 WHITSUNDAYS (07) 4945 6600
 MACKAY (07) 4957 9700
 CAIRNS (07) 4252 9400

veris.com.au
 ACN 615 735 727
 Veris Australia Pty Ltd

Drawing No 30109-DP-2438 Issue B

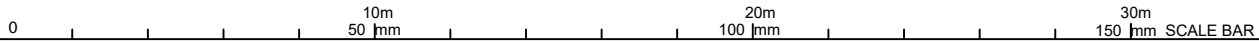

SANDY CREEK ROAD



Retaining Wall Lot 2439
 Min Height:- 1.0m
 Max Height:- 1.0m
 Average Height:- 1.0m

PROPOSED LOT 2438

2439
210m²

PROPOSED LOT 2440

ROAD

LEGEND

Final surface contours based on A.H.D. datum at an interval of 0.5m, shown as: — 15.5 —

Where applicable, areas to be filled are shown as:

Depth of fill, in metres, shown as:- + 0.5

Retaining wall and retaining wall height, shown on the lower side of the wall, have been taken from plans supplied by Peak Urban and shown as:

Bin Pad Location shown as: *



ADDITIONAL NOTES:

The LOT dimensions and area shown hereon are subject to final field survey and also to the requirements of Council and any other authority which may have requirements under any relevant legislation

Final surface contours shown hereon have been supplied by Peak Urban.

Location of retaining walls are as shown on Engineering design drawings. Their as-constructed location may differ from their design location. Retaining wall heights have been supplied by Peak Urban. **The engineering detail shown hereon are preliminary only and are subject to change in final design and statutory approvals**

Compaction of any fill material placed on this site shall be completed to level one inspection and testing services in accordance with AS3798-2007.

Depth of fill values are calculated to the pre-development surface.

Copyright © Veris Australia Pty Ltd
 20/04/2022.

FLAGSTONE PRECINCT 1 STAGE 5J For PEET FLAGSTONE CITY PTY LTD

IMPORTANT NOTES:

(These notes are an integral part of this plan)
 This plan has been prepared for PEET FLAGSTONE CITY PTY LTD for the purposes of **A Disclosure Plan Under the Land Sales Act 1984 (as amended)**.
 It is not to be used by any other person or corporation or for any other purposes and is subject to the following limitations:

Please refer to the approved Development Application for conditions relating to the LOT and to approved Operational Works drawings for services location and possible easements.

THESE DESIGNS AND DRAWINGS ARE COPYRIGHT AND ARE NOT TO BE USED OR REPRODUCED WITHOUT THE WRITTEN PERMISSION OF VERIS.

Data Sources

Cadastral Boundaries
 30109-C-Master(CX) FSS4 2014.dwg

Engineering Design
 BASE FILE - Stage 5J 5K 5L - 11 03 2022.dwg

Final Surface Contours
 FLAGSTONE - STAGE 5J - DISCLOSURE INFO - 11 03 2022 - Design Tin.dxf

Depth of Fill
 FLAGSTONE - STAGE 5J - DISCLOSURE INFO - 11 03 2022 - Depth Contours.dwg

B	Wall Heights Updated	19/04/2022	BK
A	Original	08/04/2022	BK
Issue	Revisions	Date	Drawn

Locality:	FLAGSTONE
Local Authority:	LOGAN CITY COUNCIL
Horizontal Meridian:	MGA Zone 56
Vertical Level Datum:	AHD D
Scale:	1:200 @ A4
Designed:	Peak Urban
Drawn:	BK 08/04/2022
Checked:	DE 08/04/2022
Plot Date:	08 May, 2022
Computer File Ref:	30109-St5J-DP-(B).dwg

DISCLOSURE PLAN of Proposed LOT 2439 being part of Lot 911 on SP321079



BRISBANE (07) 3666 4700
 WHITSUNDAYS (07) 4945 6600
 MACKAY (07) 4957 9700
 CAIRNS (07) 4252 9400

veris.com.au
 ACN 615 735 727
 Veris Australia Pty Ltd

Drawing No
30109-DP-2439
 Issue
B

SANDY CREEK ROAD



Retaining Wall Lot 2440
 Min Height:- 1.0m
 Max Height:- 1.0m
 Average Height:- 1.0m

PROPOSED LOT 2439

2440
210m²

PROPOSED LOT 2441

ROAD

LEGEND

Final surface contours based on A.H.D. datum at an interval of 0.5m, shown as: — 15.5 —

Where applicable, areas to be filled are shown as:

Depth of fill, in metres, shown as:- + 0.5

Retaining wall and retaining wall height, shown on the lower side of the wall, have been taken from plans supplied by Peak Urban and shown as:

Bin Pad Location shown as: *



ADDITIONAL NOTES:

The LOT dimensions and area shown hereon are subject to final field survey and also to the requirements of Council and any other authority which may have requirements under any relevant legislation

Final surface contours shown hereon have been supplied by Peak Urban.

Location of retaining walls are as shown on Engineering design drawings. Their as-constructed location may differ from their design location. Retaining wall heights have been supplied by Peak Urban. **The engineering detail shown hereon are preliminary only and are subject to change in final design and statutory approvals**

Compaction of any fill material placed on this site shall be completed to level one inspection and testing services in accordance with AS3798-2007.

Depth of fill values are calculated to the pre-development surface.

Copyright © Veris Australia Pty Ltd
 20/04/2022.

FLAGSTONE PRECINCT 1 STAGE 5J For PEET FLAGSTONE CITY PTY LTD

IMPORTANT NOTES:
 (These notes are an integral part of this plan)
 This plan has been prepared for PEET FLAGSTONE CITY PTY LTD for the purposes of **A Disclosure Plan Under the Land Sales Act 1984 (as amended)**.
 It is not to be used by any other person or corporation or for any other purposes and is subject to the following limitations:

Please refer to the approved Development Application for conditions relating to the LOT and to approved Operational Works drawings for services location and possible easements.

THESE DESIGNS AND DRAWINGS ARE COPYRIGHT AND ARE NOT TO BE USED OR REPRODUCED WITHOUT THE WRITTEN PERMISSION OF VERIS.

Data Sources
 Cadastral Boundaries
 30109-C-Master(03) F394 2014.dwg
 Engineering Design
 BASE FILE - Stage 5J SK 5J - 11 03 2022.dwg
 Final Surface Contours
 FLAGSTONE - STAGE 5J - DISCLOSURE
 INFO - 11 03 2022 - Design Tin.dxf
 Depth of Fill
 FLAGSTONE - STAGE 5J - DISCLOSURE
 INFO - 11 03 2022 - Depth Contours.dwg

B	Wall Heights Updated	19/04/2022	BK
A	Original	08/04/2022	BK
Issue	Revisions	Date	Drawn

Locality: FLAGSTONE
 Local Authority: LOGAN CITY COUNCIL
 Horizontal Meridian: MGA Zone 56
 Vertical Level Datum: AHD D
 Scale: 1:200 @ A4
 Designed: Peak Urban
 Drawn: BK 08/04/2022
 Checked: DE 08/04/2022
 Plot Date: 08 May, 2022
 Computer File Ref: 30109-St5J-DP-(B).dwg

DISCLOSURE PLAN of Proposed LOT 2440 being part of Lot 911 on SP321079



BRISBANE WHITSUNDAYS
 (07) 3666 4700 (07) 4945 6600

MACKAY CAIRNS
 (07) 4957 9700 (07) 4252 9400

veris.com.au

ACN 615 735 727
 Veris Australia Pty Ltd

Drawing No Issue
 30109-DP-2440 B



LEGEND

Final surface contours based on A.H.D. datum at an interval of 0.5m, shown as: — 15.5 —

Where applicable, areas to be filled are shown as:

Depth of fill, in metres, shown as:- + 0.5

Retaining wall and retaining wall height, shown on the lower side of the wall, have been taken from plans supplied by Peak Urban and shown as: (1.2)

Bin Pad Location shown as: *



ADDITIONAL NOTES:
 The LOT dimensions and area shown hereon are subject to final field survey and also to the requirements of Council and any other authority which may have requirements under any relevant legislation

Final surface contours shown hereon have been supplied by Peak Urban.

Location of retaining walls are as shown on Engineering design drawings. Their as-constructed location may differ from their design location. Retaining wall heights have been supplied by Peak Urban. **The engineering detail shown hereon are preliminary only and are subject to change in final design and statutory approvals**

Compaction of any fill material placed on this site shall be completed to level one inspection and testing services in accordance with AS3798-2007.

Depth of fill values are calculated to the pre-development surface.
 Copyright © Veris Australia Pty Ltd
 20/04/2022.

**FLAGSTONE
 PRECINCT 1 STAGE 5J**
 For
**PEET FLAGSTONE
 CITY PTY LTD**

IMPORTANT NOTES:
 (These notes are an integral part of this plan)
 This plan has been prepared for PEET FLAGSTONE CITY PTY LTD for the purposes of **A Disclosure Plan Under the Land Sales Act 1984 (as amended)**.
 It is not to be used by any other person or corporation or for any other purposes and is subject to the following limitations:

Please refer to the approved Development Application for conditions relating to the LOT and to approved Operational Works drawings for services location and possible easements.

THESE DESIGNS AND DRAWINGS ARE COPYRIGHT AND ARE NOT TO BE USED OR REPRODUCED WITHOUT THE WRITTEN PERMISSION OF VERIS

Data Sources
 Cadastral Boundaries
 30109-C-Master(CA) F394 2014.dwg
 Engineering Design
 BASE FILE - Stage 5J SK 5J - 11 03 2022.dwg
 Final Surface Contours
 FLAGSTONE - STAGE 5J - DISCLOSURE
 INFO - 11 03 2022 - Design Tin.dxf
 Depth of Fill
 FLAGSTONE - STAGE 5J - DISCLOSURE
 INFO - 11 03 2022 - Depth Contours.dwg

Issue	Revisions	Date	Drawn
B	Wall Heights Updated	19/04/2022	BK
A	Original	08/04/2022	BK

Locality: FLAGSTONE
 Local Authority: LOGAN CITY COUNCIL
 Horizontal Meridian: MGA Zone 56
 Vertical Level Datum: AHD D
 Scale: 1:200 @ A4
 Designed: Peak Urban
 Drawn: BK 08/04/2022
 Checked: DE 08/04/2022
 Plot Date: 08 May, 2022
 Computer File Ref: 30109-St5J-DP-(B).dwg

**DISCLOSURE PLAN
 of Proposed LOT 2441
 being part of
 Lot 911 on SP321079**



BRISBANE WHITSUNDAYS
 (07) 3666 4700 (07) 4945 6600
MACKAY CAIRNS
 (07) 4957 9700 (07) 4252 9400

veris.com.au

ACN 615 735 727
 Veris Australia Pty Ltd

Drawing No 30109-DP-2441 Issue B

SANDY CREEK ROAD



Retaining Wall Lot 2442
 Min Height:- 1.0m
 Max Height:- 1.0m
 Average Height:- 1.0m

2442
 210m²

PROPOSED LOT 2443

PROPOSED LOT 2441

ROAD

LEGEND

Final surface contours based on A.H.D. datum at an interval of 0.5m, shown as: — 15.5 —

Where applicable, areas to be filled are shown as:

Depth of fill, in metres, shown as:- + 0.5

Retaining wall and retaining wall height, shown on the lower side of the wall, have been taken from plans supplied by Peak Urban and shown as:

Bin Pad Location shown as: *

ADDITIONAL NOTES:

The LOT dimensions and area shown hereon are subject to final field survey and also to the requirements of Council and any other authority which may have requirements under any relevant legislation

Final surface contours shown hereon have been supplied by Peak Urban.

Location of retaining walls are as shown on Engineering design drawings. Their as-constructed location may differ from their design location. Retaining wall heights have been supplied by Peak Urban. **The engineering detail shown hereon are preliminary only and are subject to change in final design and statutory approvals**

Compaction of any fill material placed on this site shall be completed to level one inspection and testing services in accordance with AS3798-2007.

Depth of fill values are calculated to the pre-development surface.

Copyright © Veris Australia Pty Ltd
 20/04/2022.

FLAGSTONE PRECINCT 1 STAGE 5J For PEET FLAGSTONE CITY PTY LTD

IMPORTANT NOTES:
 (These notes are an integral part of this plan)
 This plan has been prepared for PEET FLAGSTONE CITY PTY LTD for the purposes of **A Disclosure Plan Under the Land Sales Act 1984 (as amended)**.
 It is not to be used by any other person or corporation or for any other purposes and is subject to the following limitations:

Please refer to the approved Development Application for conditions relating to the LOT and to approved Operational Works drawings for services location and possible easements.

THESE DESIGNS AND DRAWINGS ARE COPYRIGHT AND ARE NOT TO BE USED OR REPRODUCED WITHOUT THE WRITTEN PERMISSION OF VERIS

Data Sources
 Cadastral Boundaries
 30109-C-Master(03) F394 2014.dwg
 Engineering Design
 BASE FILE - Stage 5J SK 5J - 11 03 2022.dwg
 Final Surface Contours
 FLAGSTONE - STAGE 5J - DISCLOSURE INFO - 11 03 2022 - Design Tin.dxf
 Depth of Fill
 FLAGSTONE - STAGE 5J - DISCLOSURE INFO - 11 03 2022 - Depth Contours.dwg

Issue	Revisions	Date	Drawn
B	Wall Heights Updated	19/04/2022	BK
A	Original	08/04/2022	BK

Locality: FLAGSTONE
 Local Authority: LOGAN CITY COUNCIL
 Horizontal Meridian: MGA Zone 56
 Vertical Level Datum: AHD D
 Scale: 1:200 @ A4
 Designed: Peak Urban
 Drawn: BK 08/04/2022
 Checked: DE 08/04/2022
 Plot Date: 08 May, 2022
 Computer File Ref: 30109-St5J-DP-(B).dwg

DISCLOSURE PLAN of Proposed LOT 2442 being part of Lot 911 on SP321079



BRISBANE WHITSUNDAYS
 (07) 3666 4700 (07) 4945 6600
 MACKAY CAIRNS
 (07) 4957 9700 (07) 4252 9400

veris.com.au
 ACN 615 735 727
 Veris Australia Pty Ltd

Drawing No 30109-DP-2442 Issue B



SANDY CREEK ROAD

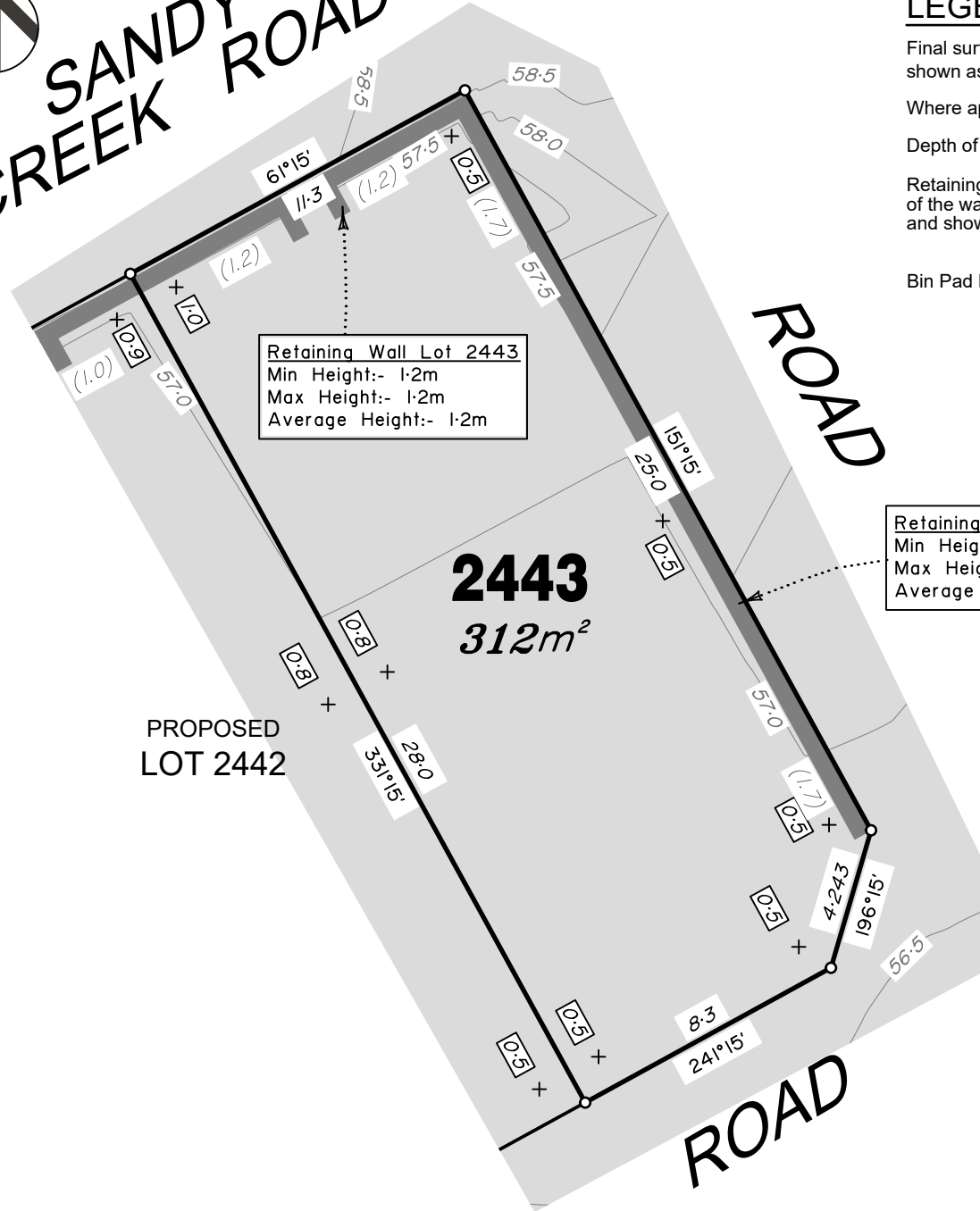

Retaining Wall Lot 2443
 Min Height:- 1.2m
 Max Height:- 1.2m
 Average Height:- 1.2m

Retaining Wall Lot 2443
 Min Height:- 1.7m
 Max Height:- 1.7m
 Average Height:- 1.7m

LEGEND

Final surface contours based on A.H.D. datum at an interval of 0.5m, shown as: — 15.5 —

Where applicable, areas to be filled are shown as: [shaded box]

Depth of fill, in metres, shown as:- + 0.5

Retaining wall and retaining wall height, shown on the lower side of the wall, have been taken from plans supplied by Peak Urban and shown as: [line with height] (1.2)

Bin Pad Location shown as: *

PROPOSED LOT 2442

2443
312m²

ADDITIONAL NOTES:

The LOT dimensions and area shown hereon are subject to final field survey and also to the requirements of Council and any other authority which may have requirements under any relevant legislation

Final surface contours shown hereon have been supplied by Peak Urban.

Location of retaining walls are as shown on Engineering design drawings. Their as-constructed location may differ from their design location. Retaining wall heights have been supplied by Peak Urban. **The engineering detail shown hereon are preliminary only and are subject to change in final design and statutory approvals**

Compaction of any fill material placed on this site shall be completed to level one inspection and testing services in accordance with AS3798-2007.

Depth of fill values are calculated to the pre-development surface.

Copyright © Veris Australia Pty Ltd
 20/04/2022.

FLAGSTONE PRECINCT 1 STAGE 5J For PEET FLAGSTONE CITY PTY LTD

IMPORTANT NOTES:
 (These notes are an integral part of this plan)
 This plan has been prepared for PEET FLAGSTONE CITY PTY LTD for the purposes of **A Disclosure Plan Under the Land Sales Act 1984 (as amended)**.
 It is not to be used by any other person or corporation or for any other purposes and is subject to the following limitations:

Please refer to the approved Development Application for conditions relating to the LOT and to approved Operational Works drawings for services location and possible easements.

THESE DESIGNS AND DRAWINGS ARE COPYRIGHT AND ARE NOT TO BE USED OR REPRODUCED WITHOUT THE WRITTEN PERMISSION OF VERIS.

Data Sources
 Cadastral Boundaries
 30109-C-Master(CX) F394 2014.dwg
 Engineering Design
 BASE FILE - Stage 5J SK 5J - 11 03 2022.dwg
 Final Surface Contours
 FLAGSTONE - STAGE 5J - DISCLOSURE
 INFO - 11 03 2022 - Design Tin.dxf
 Depth of Fill
 FLAGSTONE - STAGE 5J - DISCLOSURE
 INFO - 11 03 2022 - Depth Contours.dwg

Issue	Revisions	Date	Drawn
B	Wall Heights Updated	19/04/2022	BK
A	Original	08/04/2022	BK

Locality: FLAGSTONE
 Local Authority: LOGAN CITY COUNCIL
 Horizontal Meridian: MGA Zone 56
 Vertical Level Datum: AHD D
 Scale: 1:200 @ A4
 Designed: Peak Urban
 Drawn: BK 08/04/2022
 Checked: DE 08/04/2022
 Plot Date: 08 May, 2022
 Computer File Ref: 30109-St5J-DP-(B).dwg

DISCLOSURE PLAN of Proposed LOT 2443 being part of Lot 911 on SP321079



BRISBANE WHITSUNDAYS
 (07) 3666 4700 (07) 4945 6600
 MACKAY CAIRNS
 (07) 4957 9700 (07) 4252 9400

veris.com.au
 ACN 615 735 727
 Veris Australia Pty Ltd

Drawing No 30109-DP-2443 Issue B

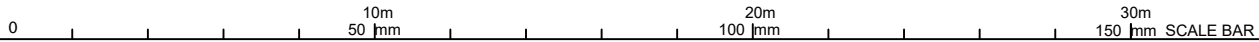

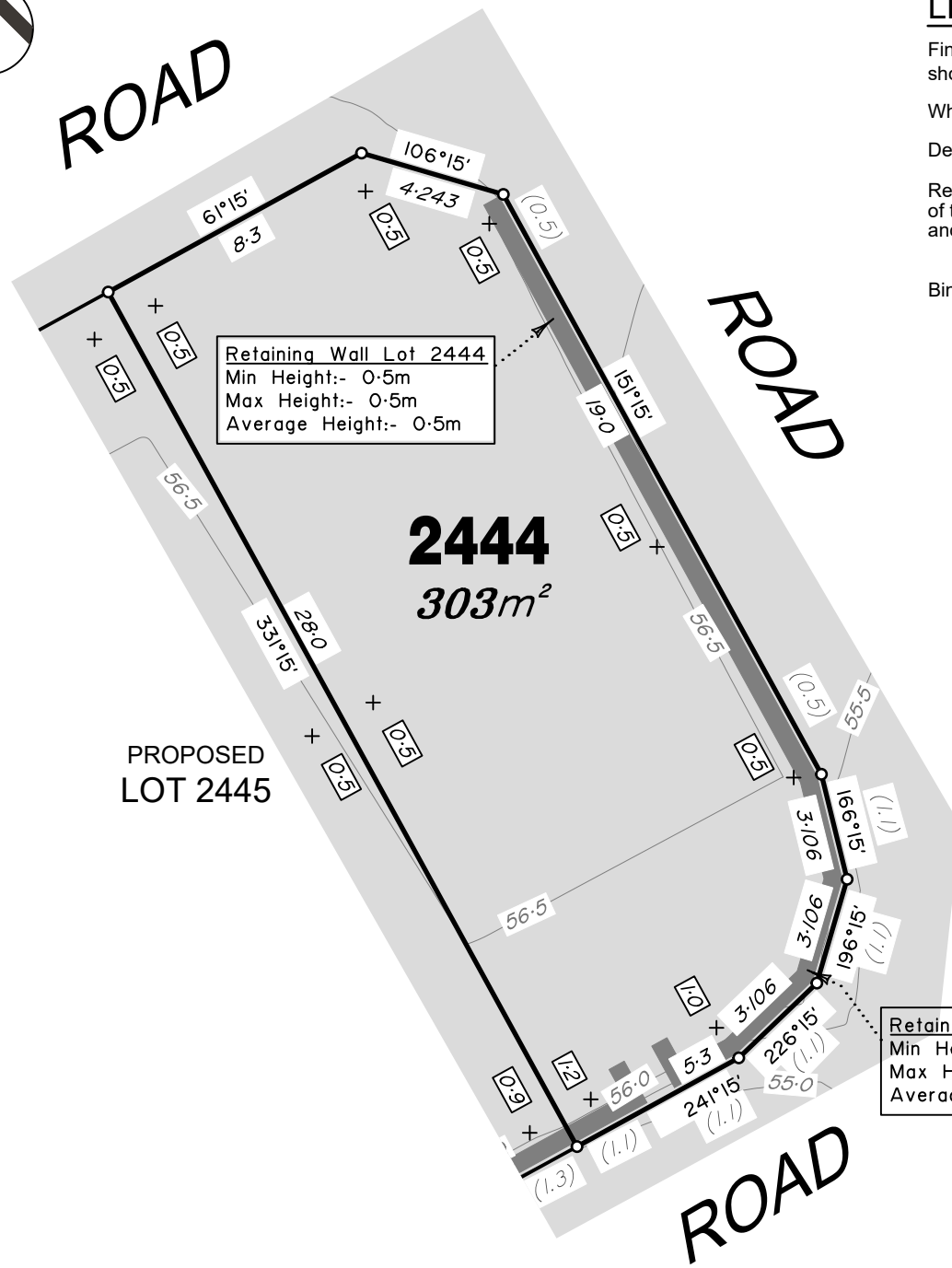

Retaining Wall Lot 2444
 Min Height:- 0.5m
 Max Height:- 0.5m
 Average Height:- 0.5m

2444
303m²

PROPOSED
 LOT 2445

Retaining Wall Lot 2444
 Min Height:- 1.1m
 Max Height:- 1.1m
 Average Height:- 1.1m

LEGEND

Final surface contours based on A.H.D. datum at an interval of 0.5m, shown as: — 15.5 —

Where applicable, areas to be filled are shown as:

Depth of fill, in metres, shown as:- + 0.5

Retaining wall and retaining wall height, shown on the lower side of the wall, have been taken from plans supplied by Peak Urban and shown as:

Bin Pad Location shown as: *

ADDITIONAL NOTES:

The LOT dimensions and area shown hereon are subject to final field survey and also to the requirements of Council and any other authority which may have requirements under any relevant legislation

Final surface contours shown hereon have been supplied by Peak Urban.

Location of retaining walls are as shown on Engineering design drawings. Their as-constructed location may differ from their design location. Retaining wall heights have been supplied by Peak Urban. **The engineering detail shown hereon are preliminary only and are subject to change in final design and statutory approvals**

Compaction of any fill material placed on this site shall be completed to level one inspection and testing services in accordance with AS3798-2007.

Depth of fill values are calculated to the pre-development surface.

Copyright © Veris Australia Pty Ltd
 20/04/2022.

FLAGSTONE PRECINCT 1 STAGE 5J For PEET FLAGSTONE CITY PTY LTD

IMPORTANT NOTES:
 (These notes are an integral part of this plan)

This plan has been prepared for PEET FLAGSTONE CITY PTY LTD for the purposes of **A Disclosure Plan Under the Land Sales Act 1984 (as amended)**.

It is not to be used by any other person or corporation or for any other purposes and is subject to the following limitations:

Please refer to the approved Development Application for conditions relating to the LOT and to approved Operational Works drawings for services location and possible easements.

THESE DESIGNS AND DRAWINGS ARE COPYRIGHT AND ARE NOT TO BE USED OR REPRODUCED WITHOUT THE WRITTEN PERMISSION OF VERIS

Data Sources

Cadastral Boundaries
 30109-C-Master(CX) F394 2014.dwg

Engineering Design
 BASE FILE - Stage 5J SK 5J - 11 03 2022.dwg

Final Surface Contours
 FLAGSTONE - STAGE 5J - DISCLOSURE
 INFO - 11 03 2022 - Design Tin.dxf

Depth of Fill
 FLAGSTONE - STAGE 5J - DISCLOSURE
 INFO - 11 03 2022 - Depth Contours.dwg

Issue	Revisions	Date	Drawn
B	Wall Heights Updated	19/04/2022	BK
A	Original	08/04/2022	BK

Locality:	FLAGSTONE
Local Authority:	LOGAN CITY COUNCIL
Horizontal Meridian:	MGA Zone 56
Vertical Level Datum:	AHD D
Scale:	1:200 @ A4
Designed:	Peak Urban
Drawn:	BK 08/04/2022
Checked:	DE 08/04/2022
Plot Date:	08 May, 2022
Computer File Ref:	30109-St5J-DP-(B).dwg

DISCLOSURE PLAN of Proposed LOT 2444 being part of Lot 911 on SP321079



BRISBANE WHITSUNDAYS
 (07) 3666 4700 (07) 4945 6600
 MACKAY CAIRNS
 (07) 4957 9700 (07) 4252 9400

veris.com.au
 ACN 615 735 727
 Veris Australia Pty Ltd

Drawing No Issue
 30109-DP-2444 B

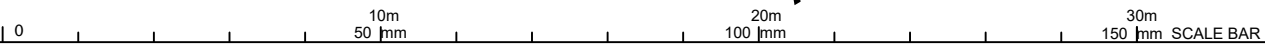



ROAD

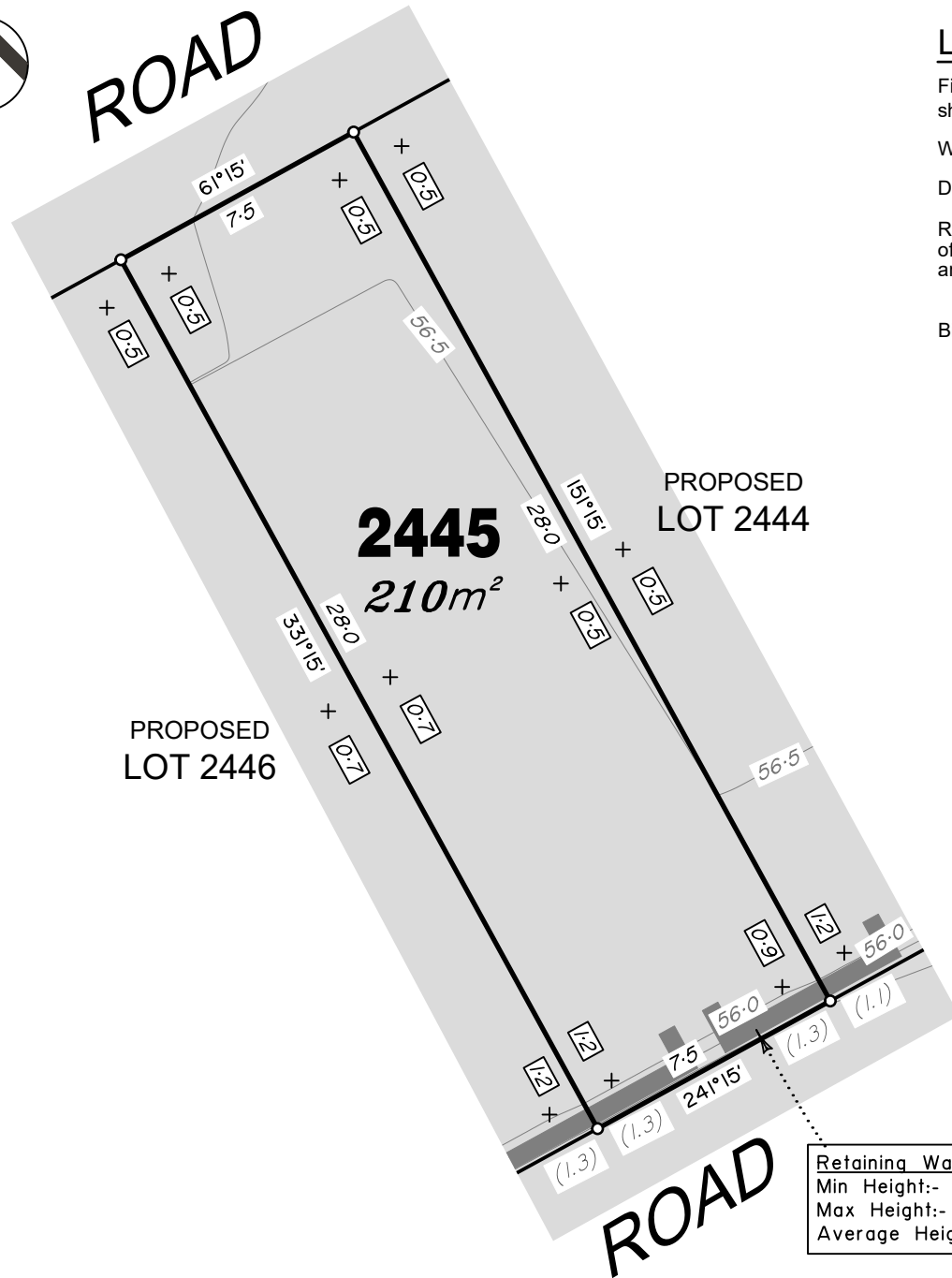

2445

210m²

PROPOSED LOT 2444

PROPOSED LOT 2446

ROAD

Retaining Wall Lot 2445
 Min Height:- 1.3m
 Max Height:- 1.3m
 Average Height:- 1.3m

LEGEND

Final surface contours based on A.H.D. datum at an interval of 0.5m, shown as: — 15.5 —

Where applicable, areas to be filled are shown as:

Depth of fill, in metres, shown as:- + 0.5

Retaining wall and retaining wall height, shown on the lower side of the wall, have been taken from plans supplied by Peak Urban and shown as:

(1.2)

Bin Pad Location shown as: *

ADDITIONAL NOTES:

The LOT dimensions and area shown hereon are subject to final field survey and also to the requirements of Council and any other authority which may have requirements under any relevant legislation

Final surface contours shown hereon have been supplied by Peak Urban.

Location of retaining walls are as shown on Engineering design drawings. Their as-constructed location may differ from their design location. Retaining wall heights have been supplied by Peak Urban. **The engineering detail shown hereon are preliminary only and are subject to change in final design and statutory approvals**

Compaction of any fill material placed on this site shall be completed to level one inspection and testing services in accordance with AS3798-2007.

Depth of fill values are calculated to the pre-development surface.

Copyright © Veris Australia Pty Ltd
 20/04/2022.

**FLAGSTONE
 PRECINCT 1 STAGE 5J**
 For
**PEET FLAGSTONE
 CITY PTY LTD**

IMPORTANT NOTES:
 (These notes are an integral part of this plan)
 This plan has been prepared for PEET FLAGSTONE CITY PTY LTD for the purposes of **A Disclosure Plan Under the Land Sales Act 1984 (as amended)**.
 It is not to be used by any other person or corporation or for any other purposes and is subject to the following limitations:

Please refer to the approved Development Application for conditions relating to the LOT and to approved Operational Works drawings for services location and possible easements.

THESE DESIGNS AND DRAWINGS ARE COPYRIGHT AND ARE NOT TO BE USED OR REPRODUCED WITHOUT THE WRITTEN PERMISSION OF VERIS

Data Sources
 Cadastral Boundaries
 30109-C-Master(03) FS94 2014.dwg
 Engineering Design
 BASE FILE - Stage 5J SK 5J - 11 03 2022.dwg
 Final Surface Contours
 FLAGSTONE - STAGE 5J - DISCLOSURE
 INFO - 11 03 2022 - Design Tin.dxf
 Depth of Fill
 FLAGSTONE - STAGE 5J - DISCLOSURE
 INFO - 11 03 2022 - Depth Contours.dwg

B	Wall Heights Updated	19/04/2022	BK
A	Original	08/04/2022	BK
Issue	Revisions	Date	Drawn

Locality: FLAGSTONE
 Local Authority: LOGAN CITY COUNCIL
 Horizontal Meridian: MGA Zone 56
 Vertical Level Datum: AHD D
 Scale: 1:200 @ A4
 Designed: Peak Urban
 Drawn: BK 08/04/2022
 Checked: DE 08/04/2022
 Plot Date: 08 May, 2022
 Computer File Ref: 30109-St5J-DP-(B).dwg

**DISCLOSURE PLAN
 of Proposed LOT 2445
 being part of
 Lot 911 on SP321079**



veris

BRISBANE (07) 3666 4700 WHITSUNDAYS (07) 4945 6600
 MACKAY (07) 4957 9700 CAIRNS (07) 4252 9400

veris.com.au
 ACN 615 735 727
 Veris Australia Pty Ltd

Drawing No 30109-DP-2445 Issue B





ROAD

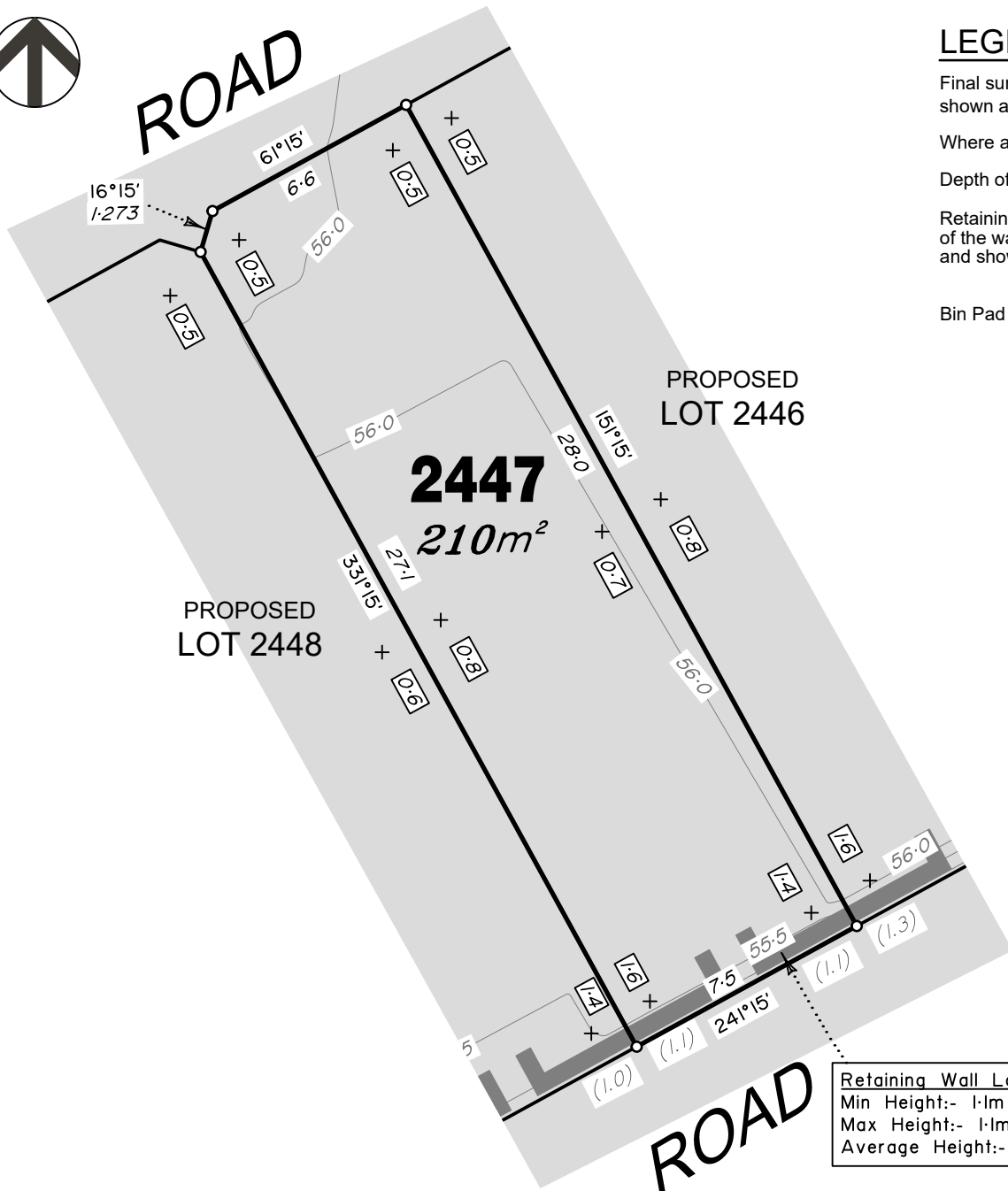

LEGEND

Final surface contours based on A.H.D. datum at an interval of 0.5m, shown as: — 15.5 —

Where applicable, areas to be filled are shown as:

Depth of fill, in metres, shown as:- + 0.5

Retaining wall and retaining wall height, shown on the lower side of the wall, have been taken from plans supplied by Peak Urban and shown as: (1.2)

Bin Pad Location shown as: *

ADDITIONAL NOTES:

The LOT dimensions and area shown hereon are subject to final field survey and also to the requirements of Council and any other authority which may have requirements under any relevant legislation

Final surface contours shown hereon have been supplied by Peak Urban.

Location of retaining walls are as shown on Engineering design drawings. Their as-constructed location may differ from their design location. Retaining wall heights have been supplied by Peak Urban. **The engineering detail shown hereon are preliminary only and are subject to change in final design and statutory approvals**

Compaction of any fill material placed on this site shall be completed to level one inspection and testing services in accordance with AS3798-2007.

Depth of fill values are calculated to the pre-development surface.

Copyright © Veris Australia Pty Ltd
20/04/2022.

FLAGSTONE PRECINCT 1 STAGE 5J For PEET FLAGSTONE CITY PTY LTD

IMPORTANT NOTES:

(These notes are an integral part of this plan)

This plan has been prepared for PEET FLAGSTONE CITY PTY LTD for the purposes of **A Disclosure Plan Under the Land Sales Act 1984 (as amended)**.

It is not to be used by any other person or corporation or for any other purposes and is subject to the following limitations:

Please refer to the approved Development Application for conditions relating to the LOT and to approved Operational Works drawings for services location and possible easements.

THESE DESIGNS AND DRAWINGS ARE COPYRIGHT AND ARE NOT TO BE USED OR REPRODUCED WITHOUT THE WRITTEN PERMISSION OF VERIS

Data Sources

Cadastral Boundaries
30109-C-Master(03) FS94 2014.dwg

Engineering Design

BASE FILE - Stage 5J SK 5J - 11 03 2022.dwg

Final Surface Contours

FLAGSTONE - STAGE 5J - DISCLOSURE
INFO - 11 03 2022 - Design Tin.dxf

Depth of Fill

FLAGSTONE - STAGE 5J - DISCLOSURE
INFO - 11 03 2022 - Depth Contours.dwg

B	Wall Heights Updated	19/04/2022	BK
A	Original	08/04/2022	BK
Issue	Revisions	Date	Drawn

Locality: FLAGSTONE
Local Authority: LOGAN CITY COUNCIL
Horizontal Meridian: MGA Zone 56
Vertical Level Datum: AHD D
Scale: 1:200 @ A4
Designed: Peak Urban
Drawn: BK 08/04/2022
Checked: DE 08/04/2022
Plot Date: 08 May, 2022
Computer File Ref: 30109-St5J-DP-(B).dwg

DISCLOSURE PLAN of Proposed LOT 2447 being part of Lot 911 on SP321079



veris

BRISBANE (07) 3666 4700 WHITSUNDAYS (07) 4945 6600

MACKAY (07) 4957 9700 CAIRNS (07) 4252 9400

veris.com.au

ACN 615 735 727
Veris Australia Pty Ltd

Drawing No 30109-DP-2447 Issue B

0 10m 50mm 20m 100mm 30m 150mm SCALE BAR



ROAD

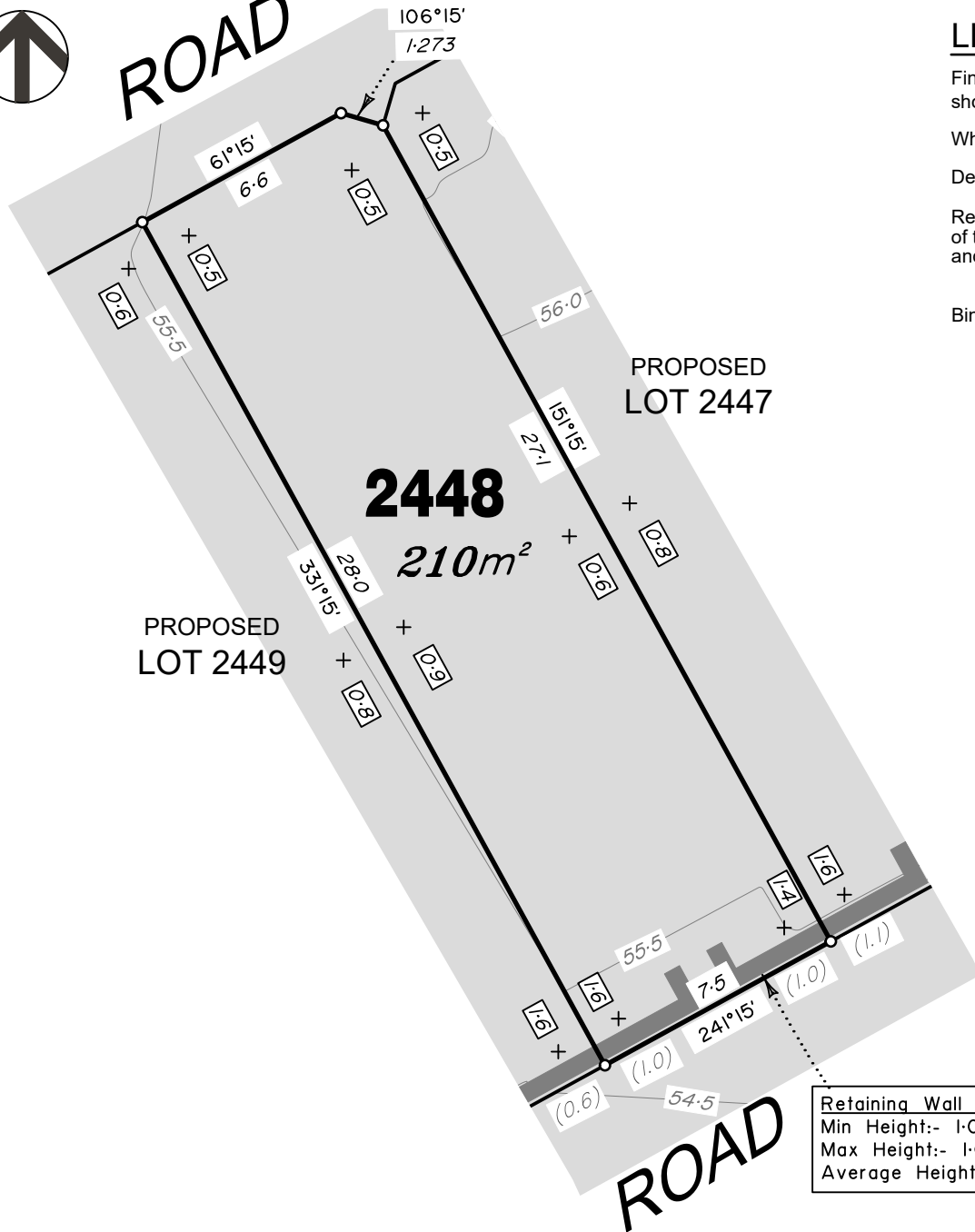

Retaining Wall Lot 2448
 Min Height:- 1.0m
 Max Height:- 1.0m
 Average Height:- 1.0m

LEGEND

Final surface contours based on A.H.D. datum at an interval of 0.5m, shown as: — 15.5 —

Where applicable, areas to be filled are shown as:

Depth of fill, in metres, shown as:- + 0.5

Retaining wall and retaining wall height, shown on the lower side of the wall, have been taken from plans supplied by Peak Urban and shown as:

(1.2)

Bin Pad Location shown as: *

ADDITIONAL NOTES:

The LOT dimensions and area shown hereon are subject to final field survey and also to the requirements of Council and any other authority which may have requirements under any relevant legislation

Final surface contours shown hereon have been supplied by Peak Urban.

Location of retaining walls are as shown on Engineering design drawings. Their as-constructed location may differ from their design location. Retaining wall heights have been supplied by Peak Urban. **The engineering detail shown hereon are preliminary only and are subject to change in final design and statutory approvals**

Compaction of any fill material placed on this site shall be completed to level one inspection and testing services in accordance with AS3798-2007.

Depth of fill values are calculated to the pre-development surface.

Copyright © Veris Australia Pty Ltd
 20/04/2022.

FLAGSTONE PRECINCT 1 STAGE 5J For PEET FLAGSTONE CITY PTY LTD

IMPORTANT NOTES:
 (These notes are an integral part of this plan)
 This plan has been prepared for PEET FLAGSTONE CITY PTY LTD for the purposes of **A Disclosure Plan Under the Land Sales Act 1984 (as amended)**.
 It is not to be used by any other person or corporation or for any other purposes and is subject to the following limitations:

Please refer to the approved Development Application for conditions relating to the LOT and to approved Operational Works drawings for services location and possible easements.

THESE DESIGNS AND DRAWINGS ARE COPYRIGHT AND ARE NOT TO BE USED OR REPRODUCED WITHOUT THE WRITTEN PERMISSION OF VERIS

Data Sources
 Cadastral Boundaries
 30109-C-Master(03) FS94 2014.dwg
 Engineering Design
 BASE FILE - Stage 5J SK 5I - 11 03 2022.dwg
 Final Surface Contours
 FLAGSTONE - STAGE 5J - DISCLOSURE
 INFO - 11 03 2022 - Design Tin.dxf
 Depth of Fill
 FLAGSTONE - STAGE 5J - DISCLOSURE
 INFO - 11 03 2022 - Depth Contours.dwg

B	Wall Heights Updated	19/04/2022	BK
A	Original	08/04/2022	BK
Issue	Revisions	Date	Drawn

Locality: FLAGSTONE
 Local Authority: LOGAN CITY COUNCIL
 Horizontal Meridian: MGA Zone 56
 Vertical Level Datum: AHD D
 Scale: 1:200 @ A4
 Designed: Peak Urban
 Drawn: BK 08/04/2022
 Checked: DE 08/04/2022
 Plot Date: 08 May, 2022
 Computer File Ref: 30109-St5J-DP-(B).dwg

DISCLOSURE PLAN of Proposed LOT 2448 being part of Lot 911 on SP321079



veris

BRISBANE WHITSUNDAYS
 (07) 3666 4700 (07) 4945 6600
 MACKAY CAIRNS
 (07) 4957 9700 (07) 4252 9400

veris.com.au
 ACN 615 735 727
 Veris Australia Pty Ltd

Drawing No
 30109-DP-2448
 Issue
 B





ROAD

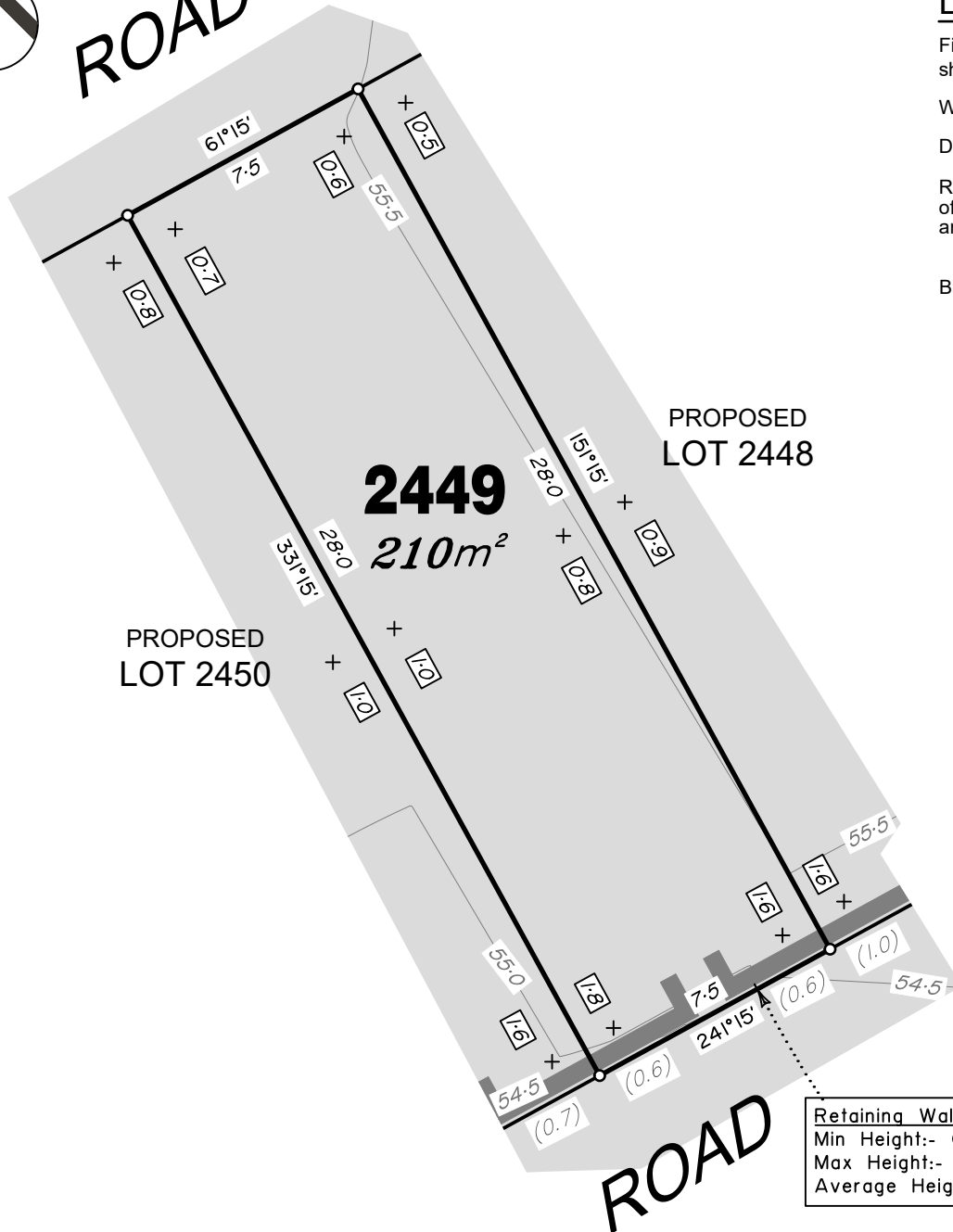

2449
210m²

PROPOSED
LOT 2448

PROPOSED
LOT 2450

Retaining Wall Lot 2449
Min Height:- 0.6m
Max Height:- 0.6m
Average Height:- 0.6m

LEGEND

Final surface contours based on A.H.D. datum at an interval of 0.5m, shown as: — 15.5 —

Where applicable, areas to be filled are shown as:

Depth of fill, in metres, shown as:- + 0.5

Retaining wall and retaining wall height, shown on the lower side of the wall, have been taken from plans supplied by Peak Urban and shown as:

(1.2)

Bin Pad Location shown as: *

ADDITIONAL NOTES:

The LOT dimensions and area shown hereon are subject to final field survey and also to the requirements of Council and any other authority which may have requirements under any relevant legislation

Final surface contours shown hereon have been supplied by Peak Urban.

Location of retaining walls are as shown on Engineering design drawings. Their as-constructed location may differ from their design location. Retaining wall heights have been supplied by Peak Urban. **The engineering detail shown hereon are preliminary only and are subject to change in final design and statutory approvals**

Compaction of any fill material placed on this site shall be completed to level one inspection and testing services in accordance with AS3798-2007.

Depth of fill values are calculated to the pre-development surface.

Copyright © Veris Australia Pty Ltd
20/04/2022.

FLAGSTONE PRECINCT 1 STAGE 5J For PEET FLAGSTONE CITY PTY LTD

IMPORTANT NOTES:

(These notes are an integral part of this plan)

This plan has been prepared for PEET FLAGSTONE CITY PTY LTD for the purposes of **A Disclosure Plan Under the Land Sales Act 1984 (as amended)**.

It is not to be used by any other person or corporation or for any other purposes and is subject to the following limitations:

Please refer to the approved Development Application for conditions relating to the LOT and to approved Operational Works drawings for services location and possible easements.

THESE DESIGNS AND DRAWINGS ARE COPYRIGHT AND ARE NOT TO BE USED OR REPRODUCED WITHOUT THE WRITTEN PERMISSION OF VERIS

Data Sources

Cadastral Boundaries
30109-C-Master(03) FS94 2014.dwg

Engineering Design

BASE FILE - Stage 5J SK 5J - 11 03 2022.dwg

Final Surface Contours

FLAGSTONE - STAGE 5J - DISCLOSURE
INFO - 11 03 2022 - Design Tin.dxf

Depth of Fill

FLAGSTONE - STAGE 5J - DISCLOSURE
INFO - 11 03 2022 - Depth Contours.dwg

Issue	Revisions	Date	Drawn
B	Wall Heights Updated	19/04/2022	BK
A	Original	08/04/2022	BK

Locality: FLAGSTONE
Local Authority: LOGAN CITY COUNCIL
Horizontal Meridian: MGA Zone 56
Vertical Level Datum: AHD D
Scale: 1:200 @ A4
Designed: Peak Urban
Drawn: BK 08/04/2022
Checked: DE 08/04/2022
Plot Date: 08 May, 2022
Computer File Ref: 30109-St5J-DP-(B).dwg

DISCLOSURE PLAN of Proposed LOT 2449 being part of Lot 911 on SP321079



veris

BRISBANE (07) 3666 4700 WHITSUNDAYS (07) 4945 6600

MACKAY (07) 4957 9700 CAIRNS (07) 4252 9400

veris.com.au

ACN 615 735 727

Veris Australia Pty Ltd

Drawing No 30109-DP-2449 Issue B

0 10m 50mm 20m 100mm 30m 150mm SCALE BAR



ROAD

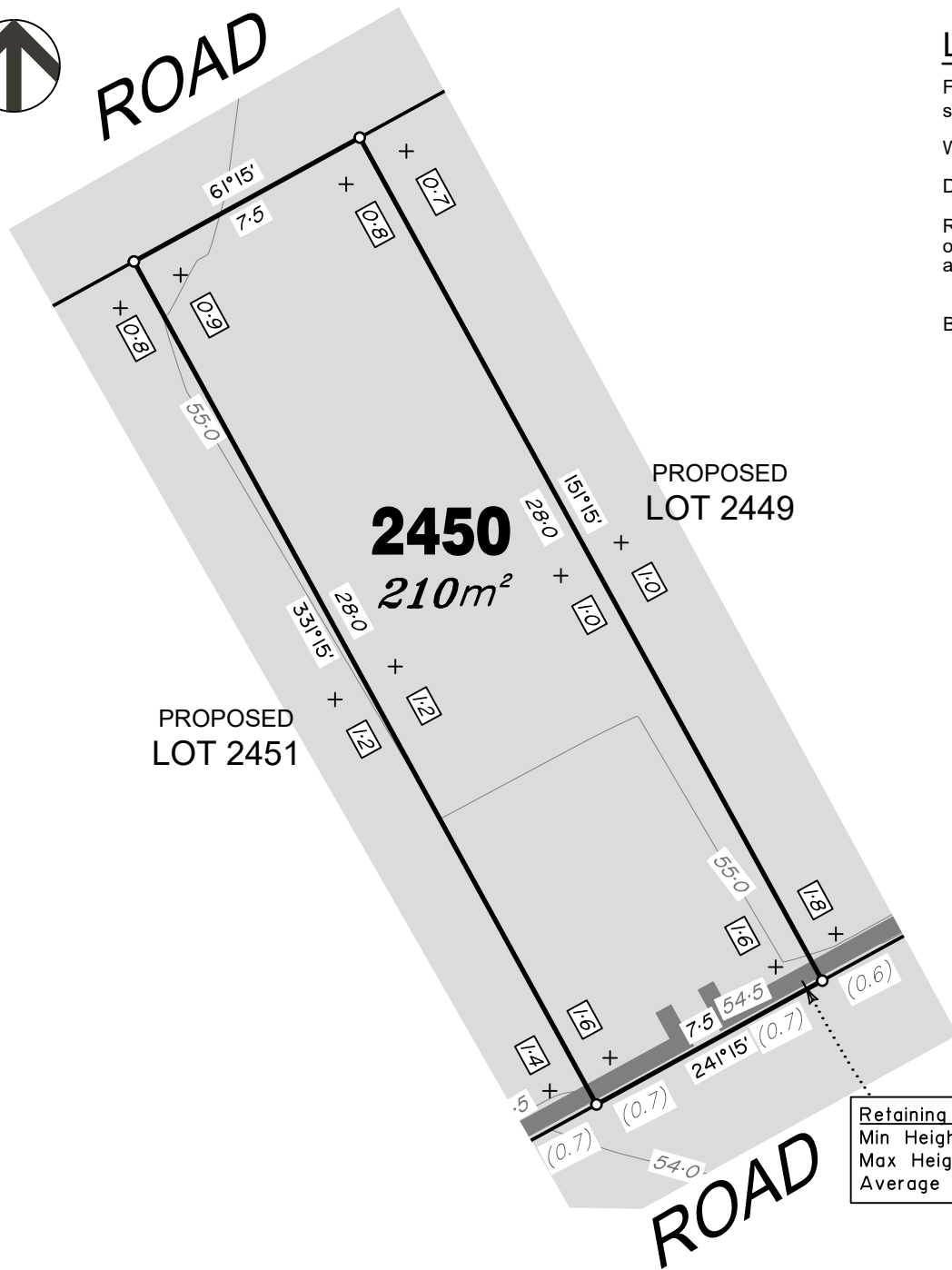

LEGEND

Final surface contours based on A.H.D. datum at an interval of 0.5m, shown as: — 15.5 —

Where applicable, areas to be filled are shown as:

Depth of fill, in metres, shown as:- + 0.5

Retaining wall and retaining wall height, shown on the lower side of the wall, have been taken from plans supplied by Peak Urban and shown as:

Bin Pad Location shown as: *

ADDITIONAL NOTES:

The LOT dimensions and area shown hereon are subject to final field survey and also to the requirements of Council and any other authority which may have requirements under any relevant legislation

Final surface contours shown hereon have been supplied by Peak Urban.

Location of retaining walls are as shown on Engineering design drawings. Their as-constructed location may differ from their design location. Retaining wall heights have been supplied by Peak Urban. **The engineering detail shown hereon are preliminary only and are subject to change in final design and statutory approvals**

Compaction of any fill material placed on this site shall be completed to level one inspection and testing services in accordance with AS3798-2007.

Depth of fill values are calculated to the pre-development surface.

Copyright © Veris Australia Pty Ltd
20/04/2022.

FLAGSTONE PRECINCT 1 STAGE 5J For PEET FLAGSTONE CITY PTY LTD

IMPORTANT NOTES:
(These notes are an integral part of this plan)
This plan has been prepared for PEET FLAGSTONE CITY PTY LTD for the purposes of **A Disclosure Plan Under the Land Sales Act 1984 (as amended)**.
It is not to be used by any other person or corporation or for any other purposes and is subject to the following limitations:

Please refer to the approved Development Application for conditions relating to the LOT and to approved Operational Works drawings for services location and possible easements.

THESE DESIGNS AND DRAWINGS ARE COPYRIGHT AND ARE NOT TO BE USED OR REPRODUCED WITHOUT THE WRITTEN PERMISSION OF VERIS

Data Sources
Cadastral Boundaries
30109-C-Master(C) FS94 2014.dwg
Engineering Design
BASE FILE - Stage 5J SK 5J - 11 03 2022.dwg
Final Surface Contours
FLAGSTONE - STAGE 5J - DISCLOSURE
INFO - 11 03 2022 - Design Tin.dxf
Depth of Fill
FLAGSTONE - STAGE 5J - DISCLOSURE
INFO - 11 03 2022 - Depth Contours.dwg

B	Wall Heights Updated	19/04/2022	BK
A	Original	08/04/2022	BK
Issue	Revisions	Date	Drawn

Locality: FLAGSTONE
Local Authority: LOGAN CITY COUNCIL
Horizontal Meridian: MGA Zone 56
Vertical Level Datum: AHD D
Scale: 1:200 @ A4
Designed: Peak Urban
Drawn: BK 08/04/2022
Checked: DE 08/04/2022
Plot Date: 08 May, 2022
Computer File Ref: 30109-St5J-DP-(B).dwg

DISCLOSURE PLAN of Proposed LOT 2450 being part of Lot 911 on SP321079



veris

BRISBANE (07) 3666 4700
WHITSUNDAYS (07) 4945 6600
MACKAY (07) 4957 9700
CAIRNS (07) 4252 9400

veris.com.au
ACN 615 735 727
Veris Australia Pty Ltd

Drawing No
30109-DP-2450
Issue
B



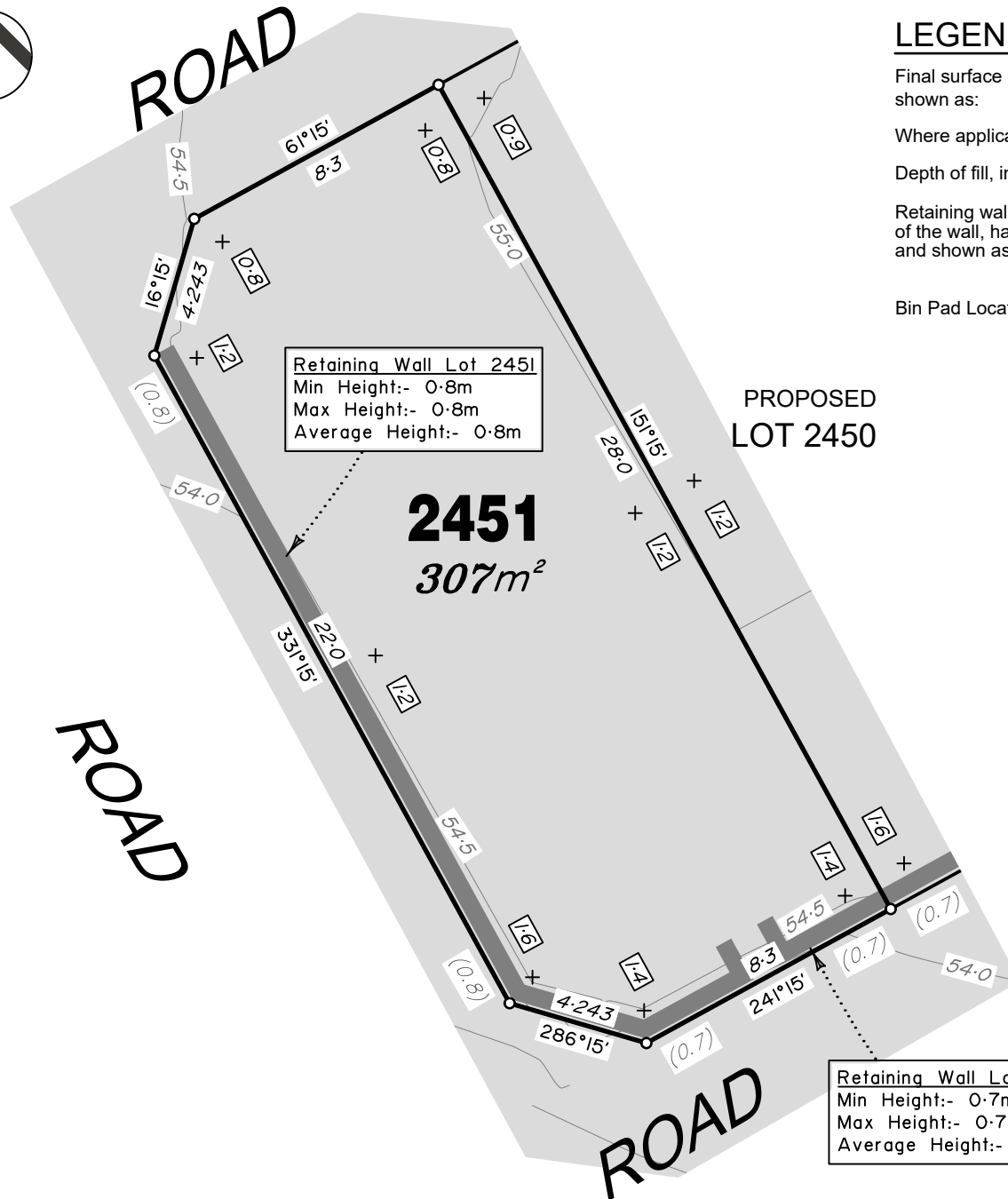

Retaining Wall Lot 2451
 Min Height:- 0.8m
 Max Height:- 0.8m
 Average Height:- 0.8m

2451
 307m²

Retaining Wall Lot 2451
 Min Height:- 0.7m
 Max Height:- 0.7m
 Average Height:- 0.7m

LEGEND

Final surface contours based on A.H.D. datum at an interval of 0.5m, shown as: — 15.5 —

Where applicable, areas to be filled are shown as:

Depth of fill, in metres, shown as:- + [0.5]

Retaining wall and retaining wall height, shown on the lower side of the wall, have been taken from plans supplied by Peak Urban and shown as:

Bin Pad Location shown as: *

ADDITIONAL NOTES:

The LOT dimensions and area shown hereon are subject to final field survey and also to the requirements of Council and any other authority which may have requirements under any relevant legislation

Final surface contours shown hereon have been supplied by Peak Urban.

Location of retaining walls are as shown on Engineering design drawings. Their as-constructed location may differ from their design location. Retaining wall heights have been supplied by Peak Urban. **The engineering detail shown hereon are preliminary only and are subject to change in final design and statutory approvals**

Compaction of any fill material placed on this site shall be completed to level one inspection and testing services in accordance with AS3798-2007.

Depth of fill values are calculated to the pre-development surface.

Copyright © Veris Australia Pty Ltd
 20/04/2022.

FLAGSTONE PRECINCT 1 STAGE 5J For PEET FLAGSTONE CITY PTY LTD

IMPORTANT NOTES:

(These notes are an integral part of this plan)
 This plan has been prepared for PEET FLAGSTONE CITY PTY LTD for the purposes of **A Disclosure Plan Under the Land Sales Act 1984 (as amended)**.
 It is not to be used by any other person or corporation or for any other purposes and is subject to the following limitations:

Please refer to the approved Development Application for conditions relating to the LOT and to approved Operational Works drawings for services location and possible easements.

THESE DESIGNS AND DRAWINGS ARE COPYRIGHT AND ARE NOT TO BE USED OR REPRODUCED WITHOUT THE WRITTEN PERMISSION OF VERIS

Data Sources
 Cadastral Boundaries
 30109-C-Master(CX) F394 2014.dwg
 Engineering Design
 BASE FILE - Stage 5J 5K 5L - 11 03 2022.dwg
 Final Surface Contours
 FLAGSTONE - STAGE 5J - DISCLOSURE
 INFO - 11 03 2022 - Design Tin.dxf
 Depth of Fill
 FLAGSTONE - STAGE 5J - DISCLOSURE
 INFO - 11 03 2022 - Depth Contours.dwg

Issue	Revisions	Date	Drawn
B	Wall Heights Updated	19/04/2022	BK
A	Original	08/04/2022	BK

Locality: FLAGSTONE
 Local Authority: LOGAN CITY COUNCIL
 Horizontal Meridian: MGA Zone 56
 Vertical Level Datum: AHD D
 Scale: 1:200 @ A4
 Designed: Peak Urban
 Drawn: BK 08/04/2022
 Checked: DE 08/04/2022
 Plot Date: 08 May, 2022
 Computer File Ref: 30109-St5J-DP-(B).dwg

DISCLOSURE PLAN of Proposed LOT 2451 being part of Lot 911 on SP321079



BRISBANE (07) 3666 4700
 WHITSUNDAYS (07) 4945 6600
 MACKAY (07) 4957 9700
 CAIRNS (07) 4252 9400

veris.com.au
 ACN 615 735 727
 Veris Australia Pty Ltd

Drawing No 30109-DP-2451 Issue B

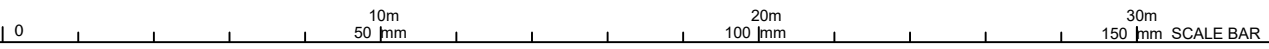

LEGEND

Final surface contours based on A.H.D. datum at an interval of 0.5m, shown as: 15.5

Where applicable, areas to be filled are shown as:

Depth of fill, in metres, shown as:- + 0.5

Retaining wall and retaining wall height, shown on the lower side of the wall, have been taken from plans supplied by Peak Urban and shown as: (1.2)

Bin Pad Location shown as: *

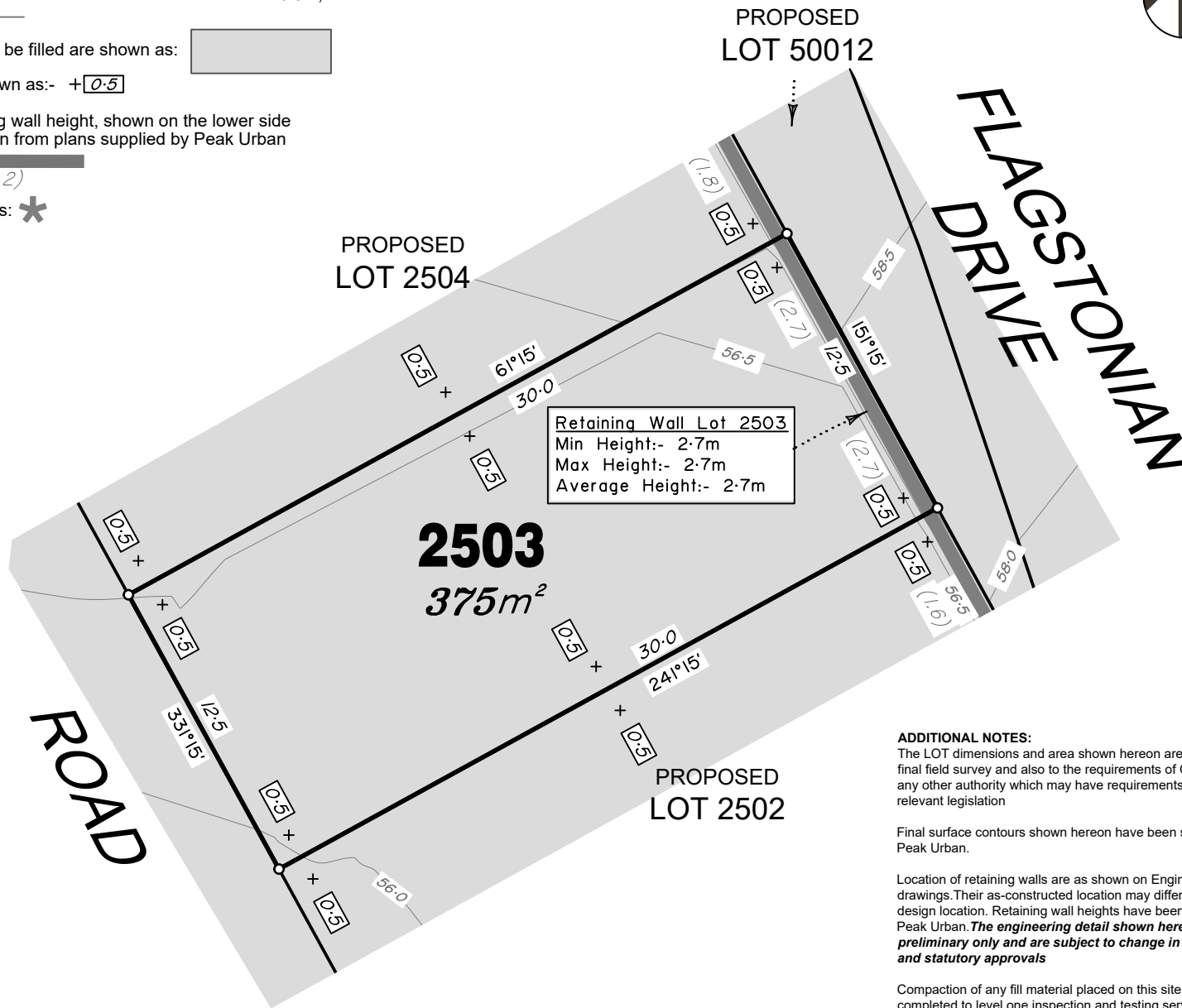

Retaining Wall Lot 2503
 Min Height:- 2.7m
 Max Height:- 2.7m
 Average Height:- 2.7m

ADDITIONAL NOTES:
 The LOT dimensions and area shown hereon are subject to final field survey and also to the requirements of Council and any other authority which may have requirements under any relevant legislation

Final surface contours shown hereon have been supplied by Peak Urban.

Location of retaining walls are as shown on Engineering design drawings. Their as-constructed location may differ from their design location. Retaining wall heights have been supplied by Peak Urban. **The engineering detail shown hereon are preliminary only and are subject to change in final design and statutory approvals**

Compaction of any fill material placed on this site shall be completed to level one inspection and testing services in accordance with AS3798-2007.

Depth of fill values are calculated to the pre-development surface.

Copyright © Veris Australia Pty Ltd
 20/04/2022.

FLAGSTONE PRECINCT 1 STAGE 5J For PEET FLAGSTONE CITY PTY LTD

IMPORTANT NOTES:
 (These notes are an integral part of this plan)
 This plan has been prepared for PEET FLAGSTONE CITY PTY LTD for the purposes of **A Disclosure Plan Under the Land Sales Act 1984 (as amended)**.
 It is not to be used by any other person or corporation or for any other purposes and is subject to the following limitations:
 Please refer to the approved Development Application for conditions relating to the LOT and to approved Operational Works drawings for services location and possible easements.

THESE DESIGNS AND DRAWINGS ARE COPYRIGHT AND ARE NOT TO BE USED OR REPRODUCED WITHOUT THE WRITTEN PERMISSION OF VERIS

Data Sources
 Cadastral Boundaries
 30109-C-Master(CX) F394 2014.dwg
 Engineering Design
 BASE FILE - Stage 5J 5K 5L - 11 03 2022.dwg
 Final Surface Contours
 FLAGSTONE - STAGE 5J - DISCLOSURE
 INFO - 11 03 2022 - Design Tin.dxf
 Depth of Fill
 FLAGSTONE - STAGE 5J - DISCLOSURE
 INFO - 11 03 2022 - Depth Contours.dwg

B	Wall Heights Updated	19/04/2022	BK
A	Original	08/04/2022	BK
Issue	Revisions	Date	Drawn

Locality: FLAGSTONE
 Local Authority: LOGAN CITY COUNCIL
 Horizontal Meridian: MGA Zone 56
 Vertical Level Datum: AHD D
 Scale: 1:250 @ A4
 Designed: Peak Urban
 Drawn: BK 08/04/2022
 Checked: DE 08/04/2022
 Plot Date: 08 May, 2022
 Computer File Ref: 30109-St5J-DP-(B).dwg

DISCLOSURE PLAN of Proposed LOT 2503 being part of Lot 911 on SP321079



BRISBANE WHITSUNDAYS
 (07) 3666 4700 (07) 4945 6600
 MACKAY CAIRNS
 (07) 4957 9700 (07) 4252 9400

veris.com.au
 ACN 615 735 727
 Veris Australia Pty Ltd

Drawing No 30109-DP-2503 Issue B



LEGEND

Final surface contours based on A.H.D. datum at an interval of 0.5m, shown as: 15.5

Where applicable, areas to be filled are shown as:

Depth of fill, in metres, shown as:- + [0.5]

Retaining wall and retaining wall height, shown on the lower side of the wall, have been taken from plans supplied by Peak Urban and shown as: (1.2)

Bin Pad Location shown as: *

Retaining Wall Lot 2504
Min Height:- 0.9m
Max Height:- 0.9m
Average Height:- 0.9m

Retaining Wall Lot 2504
Min Height:- 1.8m
Max Height:- 1.8m
Average Height:- 1.8m

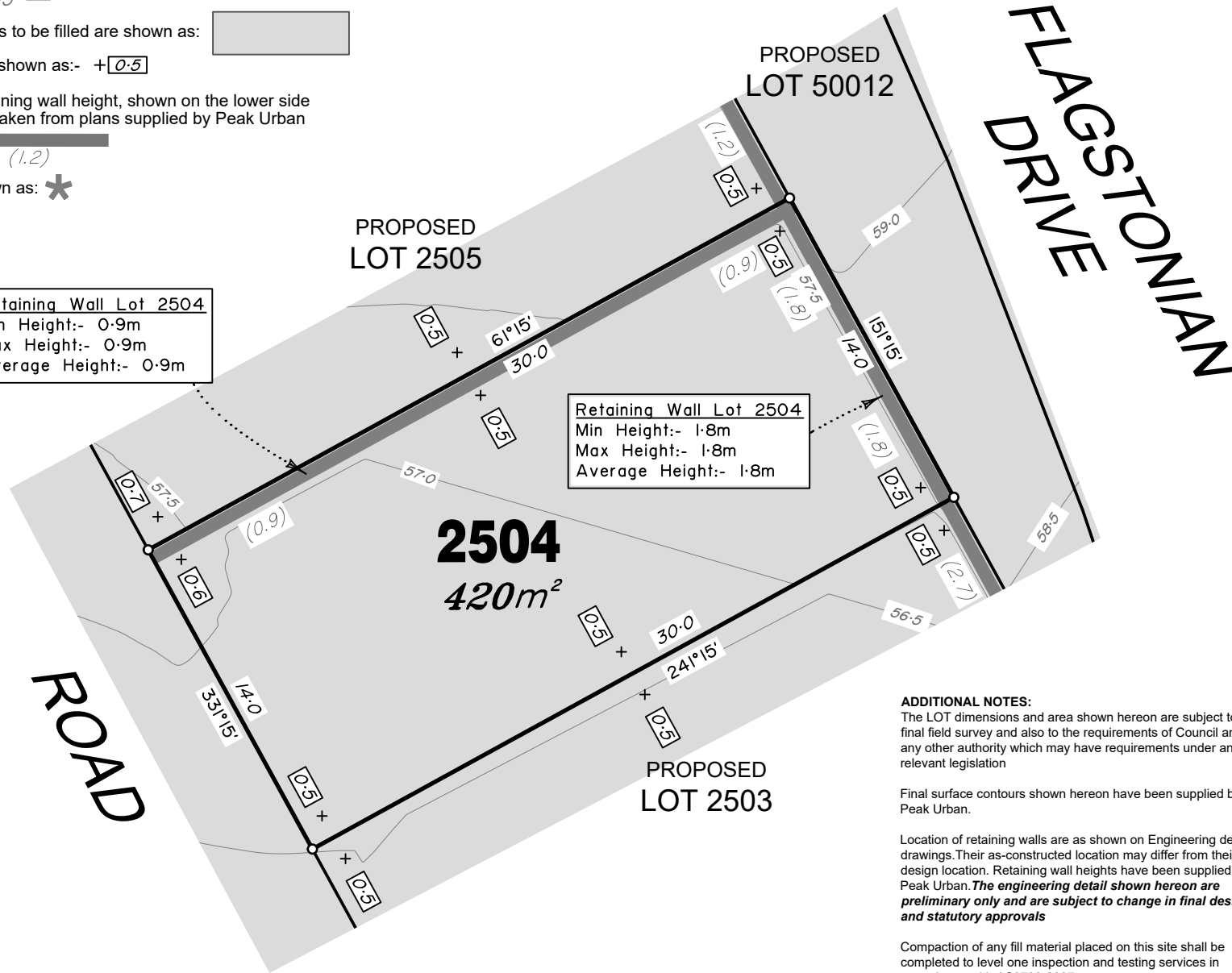

FLAGSTONE
PRECINCT 1 STAGE 5J
For
PEET FLAGSTONE
CITY PTY LTD

IMPORTANT NOTES:
(These notes are an integral part of this plan)
This plan has been prepared for PEET FLAGSTONE CITY PTY LTD for the purposes of **A Disclosure Plan Under the Land Sales Act 1984 (as amended)**.
It is not to be used by any other person or corporation or for any other purposes and is subject to the following limitations:

Please refer to the approved Development Application for conditions relating to the LOT and to approved Operational Works drawings for services location and possible easements.

THESE DESIGNS AND DRAWINGS ARE COPYRIGHT AND ARE NOT TO BE USED OR REPRODUCED WITHOUT THE WRITTEN PERMISSION OF VERIS

Data Sources
Cadastral Boundaries
30109-C-Master(CA) F394 2014.dwg
Engineering Design
BASE FILE - Stage 5J 5K 5L - 11 03 2022.dwg
Final Surface Contours
FLAGSTONE - STAGE 5J - DISCLOSURE
INFO - 11 03 2022 - Design Tin.dxf
Depth of Fill
FLAGSTONE - STAGE 5J - DISCLOSURE
INFO - 11 03 2022 - Depth Contours.dwg

B	Wall Heights Updated	19/04/2022	BK
A	Original	08/04/2022	BK
Issue	Revisions	Date	Drawn

Locality: FLAGSTONE
Local Authority: LOGAN CITY COUNCIL
Horizontal Meridian: MGA Zone 56
Vertical Level Datum: AHD D
Scale: 1:250 @ A4
Designed: Peak Urban
Drawn: BK 08/04/2022
Checked: DE 08/04/2022
Plot Date: 08 May, 2022
Computer File Ref: 30109-St5J-DP-(B).dwg

DISCLOSURE PLAN
of Proposed LOT 2504
being part of
Lot 911 on SP321079



BRISBANE WHITSUNDAYS
(07) 3666 4700 (07) 4945 6600
MACKAY CAIRNS
(07) 4957 9700 (07) 4252 9400

veris.com.au
ACN 615 735 727
Veris Australia Pty Ltd

Drawing No 30109-DP-2504 Issue B

ADDITIONAL NOTES:
The LOT dimensions and area shown hereon are subject to final field survey and also to the requirements of Council and any other authority which may have requirements under any relevant legislation

Final surface contours shown hereon have been supplied by Peak Urban.

Location of retaining walls are as shown on Engineering design drawings. Their as-constructed location may differ from their design location. Retaining wall heights have been supplied by Peak Urban. **The engineering detail shown hereon are preliminary only and are subject to change in final design and statutory approvals**

Compaction of any fill material placed on this site shall be completed to level one inspection and testing services in accordance with AS3798-2007.

Depth of fill values are calculated to the pre-development surface.
Copyright © Veris Australia Pty Ltd
20/04/2022.

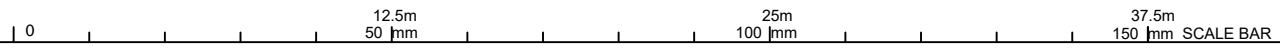

LEGEND

Final surface contours based on A.H.D. datum at an interval of 0.5m, shown as: 15.5

Where applicable, areas to be filled are shown as:

Depth of fill, in metres, shown as:- +0.5

Retaining wall and retaining wall height, shown on the lower side of the wall, have been taken from plans supplied by Peak Urban and shown as: (1.2)

Bin Pad Location shown as: *



**FLAGSTONE
PRECINCT 1 STAGE 5J**
For
**PEET FLAGSTONE
CITY PTY LTD**

IMPORTANT NOTES:
(These notes are an integral part of this plan)
This plan has been prepared for PEET FLAGSTONE CITY PTY LTD for the purposes of **A Disclosure Plan Under the Land Sales Act 1984 (as amended)**.
It is not to be used by any other person or corporation or for any other purposes and is subject to the following limitations:

Please refer to the approved Development Application for conditions relating to the LOT and to approved Operational Works drawings for services location and possible easements.

THESE DESIGNS AND DRAWINGS ARE COPYRIGHT AND ARE NOT TO BE USED OR REPRODUCED WITHOUT THE WRITTEN PERMISSION OF VERIS

Data Sources
Cadastral Boundaries
30109-C-Master(CA) F394 2014.dwg
Engineering Design
BASE FILE - Stage 5J SK 5J - 11 03 2022.dwg
Final Surface Contours
FLAGSTONE - STAGE 5J - DISCLOSURE
INFO - 11 03 2022 - Design Tin.dxf
Depth of Fill
FLAGSTONE - STAGE 5J - DISCLOSURE
INFO - 11 03 2022 - Depth Contours.dwg

B	Wall Heights Updated	19/04/2022	BK
A	Original	08/04/2022	BK
Issue	Revisions	Date	Drawn

Locality: FLAGSTONE
Local Authority: LOGAN CITY COUNCIL
Horizontal Meridian: MGA Zone 56
Vertical Level Datum: AHD D
Scale: 1:250 @ A4
Designed: Peak Urban
Drawn: BK 08/04/2022
Checked: DE 08/04/2022
Plot Date: 08 May, 2022
Computer File Ref: 30109-St5J-DP-(B).dwg

**DISCLOSURE PLAN
of Proposed LOT 2505
being part of
Lot 911 on SP321079**



veris

BRISBANE WHITSUNDAYS
(07) 3666 4700 (07) 4945 6600
MACKAY CAIRNS
(07) 4957 9700 (07) 4252 9400

veris.com.au
ACN 615 735 727
Veris Australia Pty Ltd

Drawing No 30109-DP-2505 Issue B

**SANDY
CREEK ROAD**

**FLAGSTONE
DRIVE**

ROAD

**2505
660m²**

**PROPOSED
LOT 50012**

**PROPOSED
LOT 2504**

Retaining Wall Lot 2505
Min Height:- 1.2m
Max Height:- 1.2m
Average Height:- 1.2m

Retaining Wall Lot 2505
Min Height:- 1.2m
Max Height:- 1.2m
Average Height:- 1.2m

Retaining Wall Lot 2504
Min Height:- 0.9m
Max Height:- 0.9m
Average Height:- 0.9m

ADDITIONAL NOTES:

The LOT dimensions and area shown hereon are subject to final field survey and also to the requirements of Council and any other authority which may have requirements under any relevant legislation

Final surface contours shown hereon have been supplied by Peak Urban.

Location of retaining walls are as shown on Engineering design drawings. Their as-constructed location may differ from their design location. Retaining wall heights have been supplied by Peak Urban. **The engineering detail shown hereon are preliminary only and are subject to change in final design and statutory approvals**

Compaction of any fill material placed on this site shall be completed to level one inspection and testing services in accordance with AS3798-2007.

Depth of fill values are calculated to the pre-development surface.

Copyright © Veris Australia Pty Ltd
20/04/2022.





LEGEND

Final surface contours based on A.H.D. datum at an interval of 0.5m, shown as: $\text{---} 15.5 \text{---}$

Where applicable, areas to be filled are shown as:

Depth of fill, in metres, shown as:- $\text{+} [0.5]$

Retaining wall and retaining wall height, shown on the lower side of the wall, have been taken from plans supplied by Colliers and shown as: $\text{---} (1.2) \text{---}$

Bin Pad Location shown as:

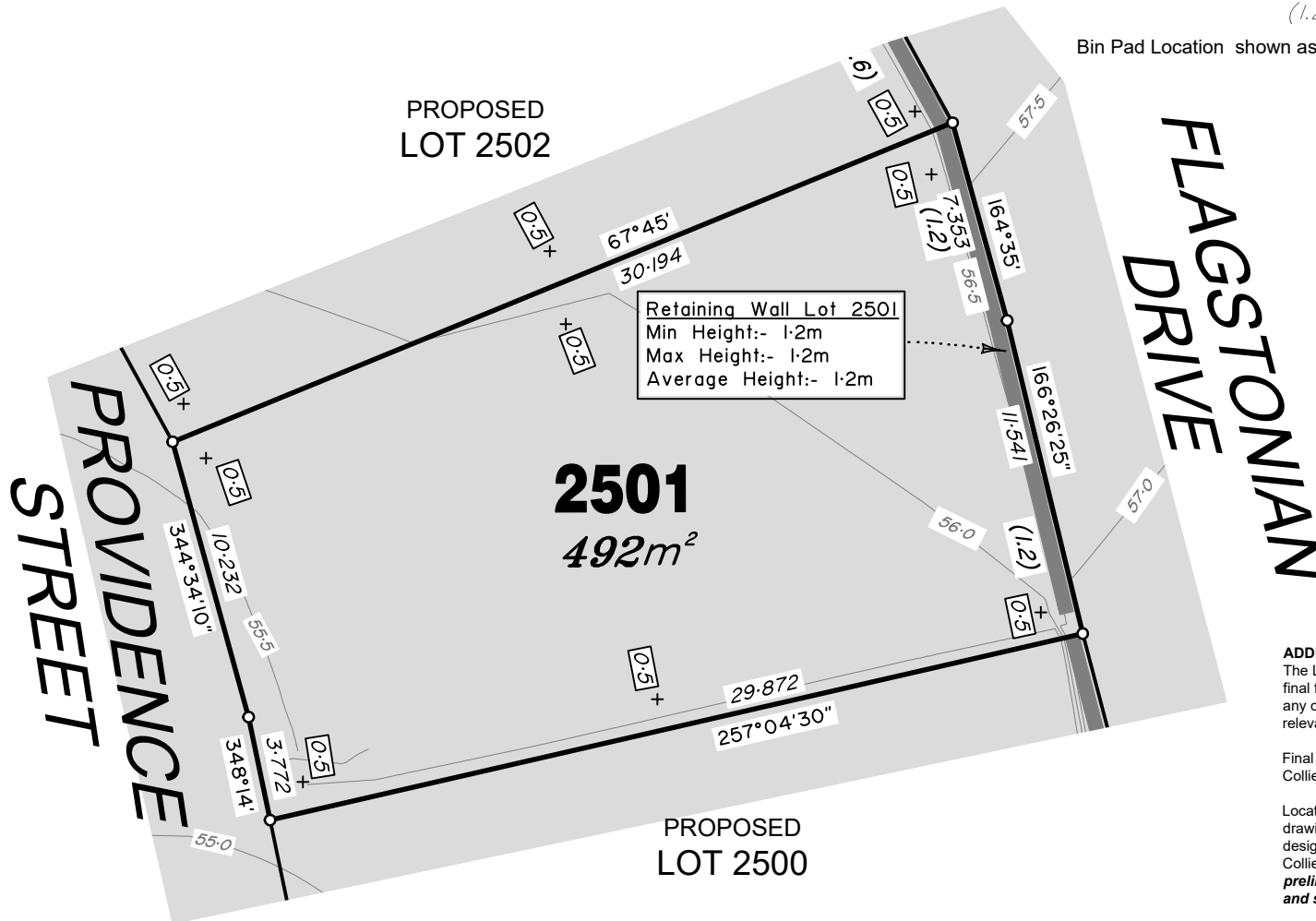

ADDITIONAL NOTES:

The LOT dimensions and area shown hereon are subject to final field survey and also to the requirements of Council and any other authority which may have requirements under any relevant legislation

Final surface contours shown hereon have been supplied by Colliers.

Location of retaining walls are as shown on Engineering design drawings. Their as-constructed location may differ from their design location. Retaining wall heights have been supplied by Colliers. **The engineering detail shown hereon are preliminary only and are subject to change in final design and statutory approvals**

Compaction of any fill material placed on this site shall be completed to level one inspection and testing services in accordance with AS3798-2007.

Depth of fill values are calculated to the pre-development surface.
Copyright © Veris Australia Pty Ltd
13/01/2023.

FLAGSTONE PRECINCT 1 STAGE 5J For PEET FLAGSTONE CITY PTY LTD

IMPORTANT NOTES:

(These notes are an integral part of this plan)
This plan has been prepared for PEET FLAGSTONE CITY PTY LTD for the purposes of **A Disclosure Plan Under the Land Sales Act 1984 (as amended)**.
It is not to be used by any other person or corporation for any other purposes and is subject to the following limitations:

Please refer to the approved Development Application for conditions relating to the LOT and to approved Operational Works drawings for services location and possible easements.

THESE DESIGNS AND DRAWINGS ARE COPYRIGHT AND ARE NOT TO BE USED OR REPRODUCED WITHOUT THE WRITTEN PERMISSION OF VERIS

Data Sources

Cadastral Boundaries
30109-LC-Master(DB) FS94 2014.dwg
Engineering Design
BASE FILE - Stage 5J 5K 5L - 11 03 2022.dwg

Final Surface Contours
FLAGSTONE - STAGE 5J - DISCLOSURE
INFO - 11 03 2022 - Design Tin.dwg

Depth of Fill
FLAGSTONE - STAGE 5J - DISCLOSURE
INFO - 11 03 2022 - Depth Contours.dwg

Issue	Revisions	Date	Drawn
C	Road Bdy amended	13.12.2022	AG
B	Wall Heights Updated	19.04.2022	BK
A	Original	08.04.2022	BK

Locality: FLAGSTONE
Local Authority: LOGAN CITY COUNCIL
Horizontal Meridian: MGA Zone 56
Vertical Level Datum: AHD D
Scale: 1:250 @ A4
Designed: Colliers
Drawn: BK 08/04/2022
Checked: DE 08/04/2022
Plot Date: 13 Jan, 2023
Computer File Ref: 30109-S15J-DP-(C).dwg

DISCLOSURE PLAN of Proposed LOT 2501 being part of Lot 911 on SP331193



veris

BRISBANE (07) 3866 4700 WHITSUNDAYS (07) 4945 6600
MACKAY (07) 4957 9700 CAIRNS (07) 4252 9400

veris.com.au
ACN 615 735 727
Veris Australia Pty Ltd

Drawing No Issue
30109-DP-2501 C





LEGEND

Final surface contours based on A.H.D. datum at an interval of 0.5m, shown as:  15.5

Where applicable, areas to be filled are shown as: 

Depth of fill, in metres, shown as:-  0.5

Retaining wall and retaining wall height, shown on the lower side of the wall, have been taken from plans supplied by Colliers and shown as:  (1.2)

Bin Pad Location shown as: 

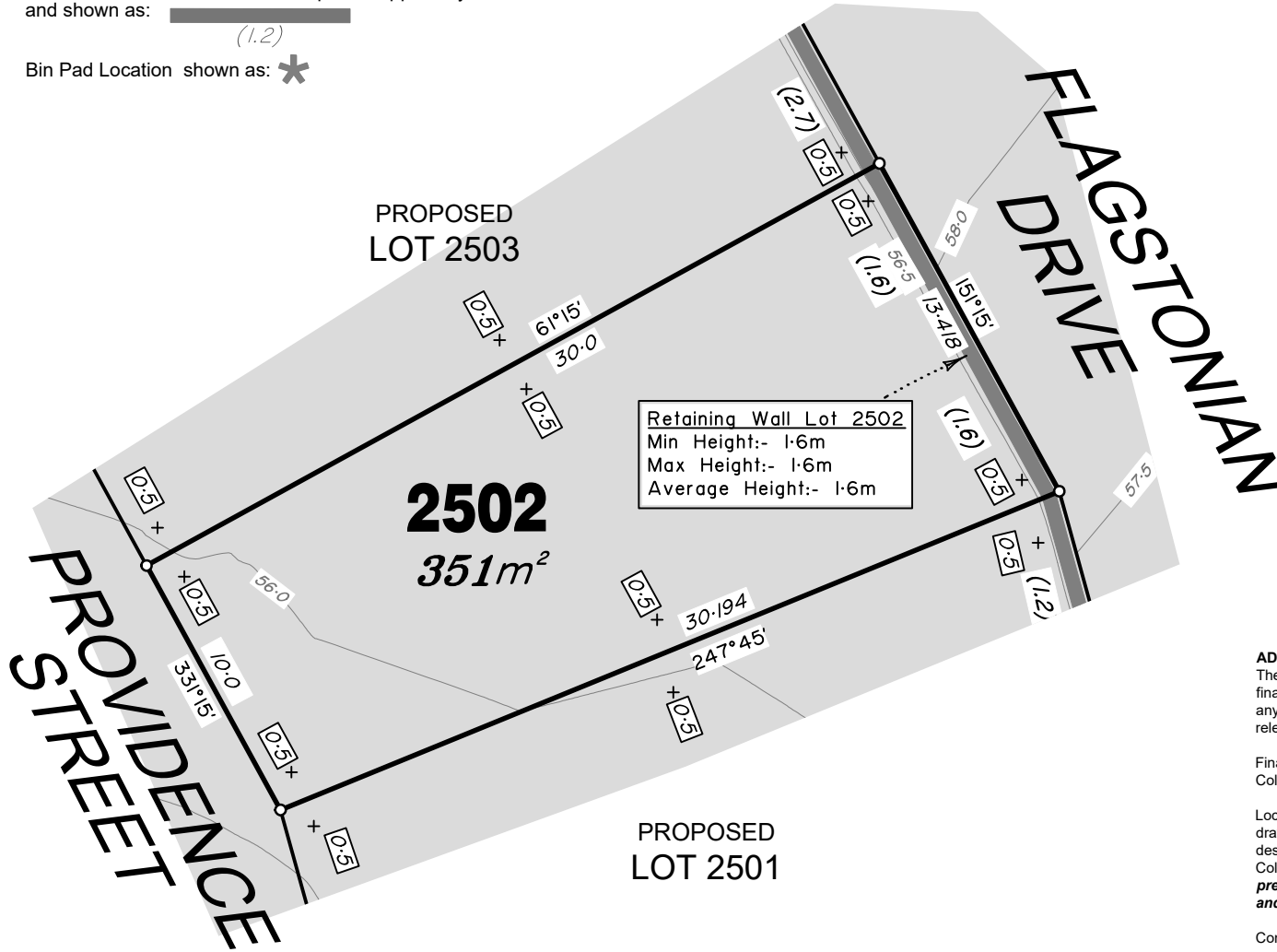

Retaining Wall Lot 2502
 Min Height:- 1.6m
 Max Height:- 1.6m
 Average Height:- 1.6m

ADDITIONAL NOTES:
 The LOT dimensions and area shown hereon are subject to final field survey and also to the requirements of Council and any other authority which may have requirements under any relevant legislation

Final surface contours shown hereon have been supplied by Colliers.

Location of retaining walls are as shown on Engineering design drawings. Their as-constructed location may differ from their design location. Retaining wall heights have been supplied by Colliers. **The engineering detail shown hereon are preliminary only and are subject to change in final design and statutory approvals**

Compaction of any fill material placed on this site shall be completed to level one inspection and testing services in accordance with AS3798-2007.

Depth of fill values are calculated to the pre-development surface.
 13/01/2023.

FLAGSTONE PRECINCT 1 STAGE 5J For PEET FLAGSTONE CITY PTY LTD

IMPORTANT NOTES:
 (These notes are an integral part of this plan)
 This plan has been prepared for PEET FLAGSTONE CITY PTY LTD for the purposes of **A Disclosure Plan Under the Land Sales Act 1984 (as amended)**.
 It is not to be used by any other person or corporation or for any other purposes and is subject to the following limitations:

Please refer to the approved Development Application for conditions relating to the LOT and to approved Operational Works drawings for services location and possible easements.

THESE DESIGNS AND DRAWINGS ARE COPYRIGHT AND ARE NOT TO BE USED OR REPRODUCED WITHOUT THE WRITTEN PERMISSION OF VERIS

Data Sources
 Cadastral Boundaries
 30109-LC-Master(DB) FS94 2014.dwg
 Engineering Design
 BASE FILE - Stage 5J 5K 5L - 11 03 2022.dwg

Final Surface Contours
 FLAGSTONE - STAGE 5J - DISCLOSURE
 INFO - 11 03 2022 - Design Tin.dxf

Depth of Fill
 FLAGSTONE - STAGE 5J - DISCLOSURE
 INFO - 11 03 2022 - Depth Contours.dwg

C	Road Bdy amended	13.12.2022	AG
B	Wall Heights Updated	19.04.2022	BK
A	Original	08.04.2022	BK
Issue	Revisions	Date	Drawn

Locality: FLAGSTONE
 Local Authority: LOGAN CITY COUNCIL
 Horizontal Meridian: MGA Zone 56
 Vertical Level Datum: AHD D
 Scale: 1:250 @ A4
 Designed: Colliers
 Drawn: BK 08/04/2022
 Checked: DE 08/04/2022
 Plot Date: 13 Jan. 2023
 Computer File Ref: 30109-S15J-DP-(C).dwg

DISCLOSURE PLAN of Proposed LOT 2502 being part of Lot 911 on SP331193



BRISBANE (07) 3866 4700 WHITSUNDAYS (07) 4945 6600
 MACKAY (07) 4957 9700 CAIRNS (07) 4252 9400

veris.com.au
 ACN 615 735 727
 Veris Australia Pty Ltd

Drawing No 30109-DP-2502 Issue C

