

LEGEND	
	Area of Fill
	Area of Cut
	Design Contours
	Zero Lot Boundary
	Retaining Wall
38.78	Finished Surface Design Level
RL 38.78	Finished Pad Design Level
1.0	Depth of Fill

(Not all items in this legend may be relevant to the lot shown hereon)

**NOTES**

This plan has been prepared from preliminary survey plan (SP302893) and engineering plans and mark-ups provided on the 08/08/18 & 03/10/18 by Premise Engineering & field survey conducted by Saunders Havill in July 2019.

Lot 656 is restricted to the depth of 15.24 metres below the surface, as defined on the plan M3172.

Development Approval for reconfiguration of a lot and material change of use (Application 1489/2017/CA) have been approved by Ipswich City Council (25/09/2017).

Development Approval has been granted for Operational Works for the proposed lot (17.09.18 - ref. OW - 6005/2018)

Scale 1:200 - Lengths are in Metres.

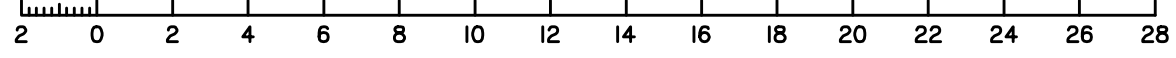

No.	by	Date	Description
A	TBG	05/10/18	Original Issue
B	TBG	08/08/19	Western Ret Wall height updated to 1.9m



Saunders Havill Group Pty Ltd ABN 24 144 972 949  
 Brisbane • Emerald • Rockhampton  
 head office 9 Thompson St Bowen Hills Q 4006  
 phone 1300 123 SHG web www.saundershavill.com  
 • surveying • town planning • urban design • environmental management • landscape architecture

This Disclosure Plan is prepared for the sole purpose of satisfying the Disclosure requirements of the Land Sales Act and SHOULD NOT be used for any other purpose, particularly As-constructed purposes. This information is compiled from Design plans only, unless otherwise stated, and therefore is subject to final survey and construction of operational works.

**Disclosure Plan for Proposed Lot 656 (Restricted) on SP302893**  
 Described as part of Lot 860 (Restricted) on SP300831  
 Existing Title Reference: 51156557  
 Locality of Redbank Plains (Ipswich City Council)

Level Datum: AHD der.  
 Origin of Levels: PM203226  
 RL of Origin: 75.312  
 Contour Interval: 0.25m  
 Scale @A3 1: 200  
 Dwg No. 8655 S 08 DP B\_656

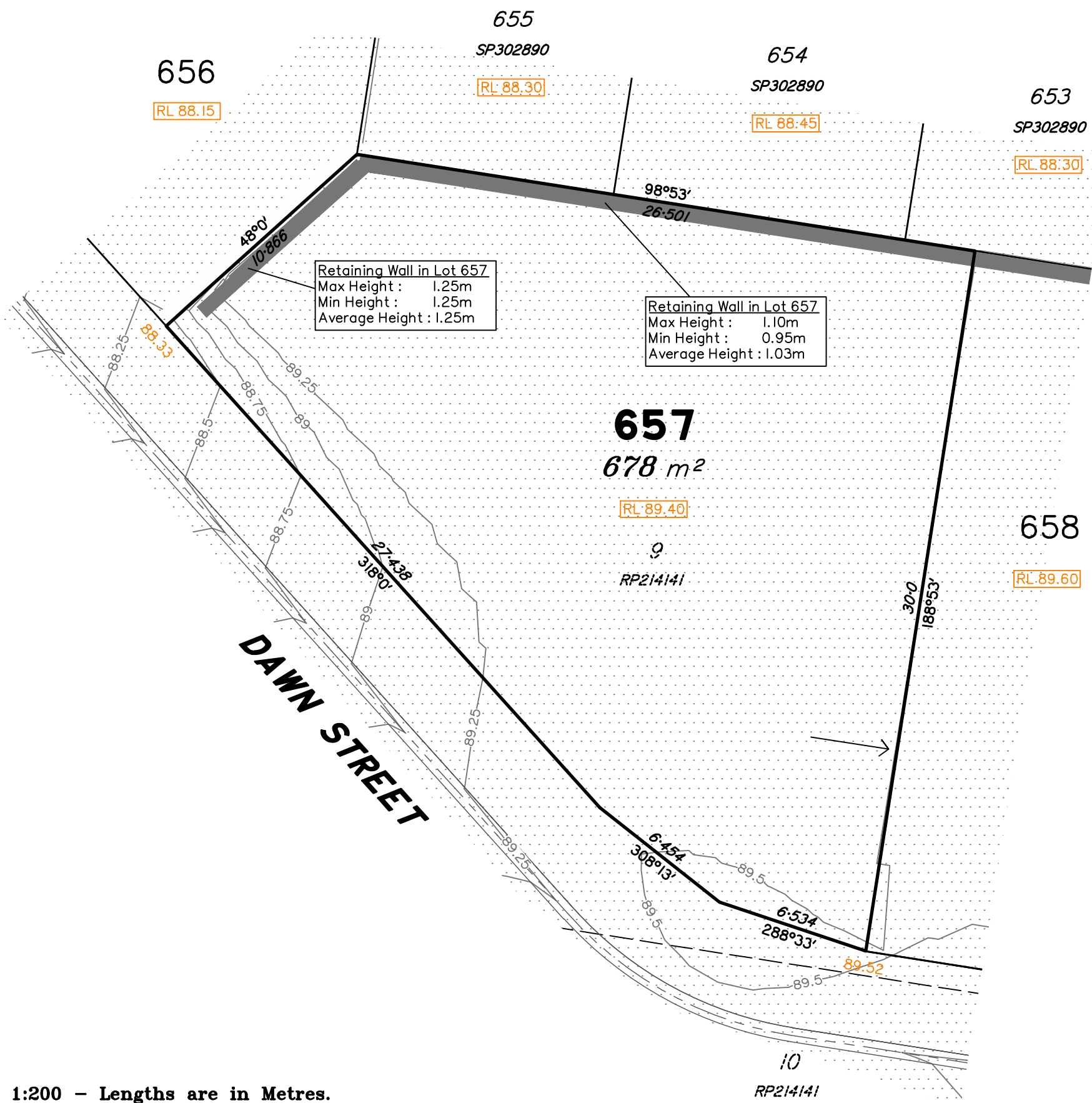

**LEGEND**

- Area of Fill
- Area of Cut
- Design Contours
- Zero Lot Boundary
- Retaining Wall
- 38.78 Finished Surface Design Level
- RL 38.78 Finished Pad Design Level
- 1.0 Depth of Fill

(Not all items in this legend may be relevant to the lot shown hereon)

**NOTES**

This plan has been prepared from preliminary survey plan (SP302893) and engineering plans and mark-ups provided on the 08/08/18 & 03/10/18 by Premise Engineering.

Lot 657 is restricted to the depth of 15.24 metres below the surface, as defined on the plan M3172.

Development Approval for reconfiguration of a lot and material change of use (Application 1489/2017/CA) have been approved by Ipswich City Council (25/09/2017).

Development Approval has been granted for Operational Works for the proposed lot (17.09.18 - ref: OW - 6005/2018)

Scale 1:200 – Lengths are in Metres.

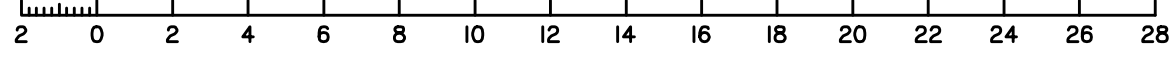

No.	by	Date	Description
A	TBG	05/10/18	Original Issue

**saunders havill group**  
 Saunders Havill Group Pty Ltd ABN 24 144 972 949  
 Brisbane • Emerald • Rockhampton  
 head office 9 Thompson St Bowen Hills Q 4006  
 phone 1300 123 SHG web www.saundershavill.com  
 • surveying • town planning • urban design • environmental management • landscape architecture

This Disclosure Plan is prepared for the sole purpose of satisfying the Disclosure requirements of the Land Sales Act and SHOULD NOT be used for any other purpose, particularly As-constructed purposes. This information is compiled from Design plans only, unless otherwise stated, and therefore is subject to final survey and construction of operational works.

**Disclosure Plan for Proposed Lot 657 (Restricted) on SP302893**  
 Described as part of Lot 860 (Restricted) on SP300831  
 Existing Title Reference: 51156557  
 Locality of Redbank Plains (Ipswich City Council)

Level Datum: AHD der.  
 Origin of Levels: PM203226  
 RL of Origin: 75.312  
 Contour Interval: 0.25m  
 Scale @A3 1: 200  
 Dwg No. 8655 S 08 DP A\_657

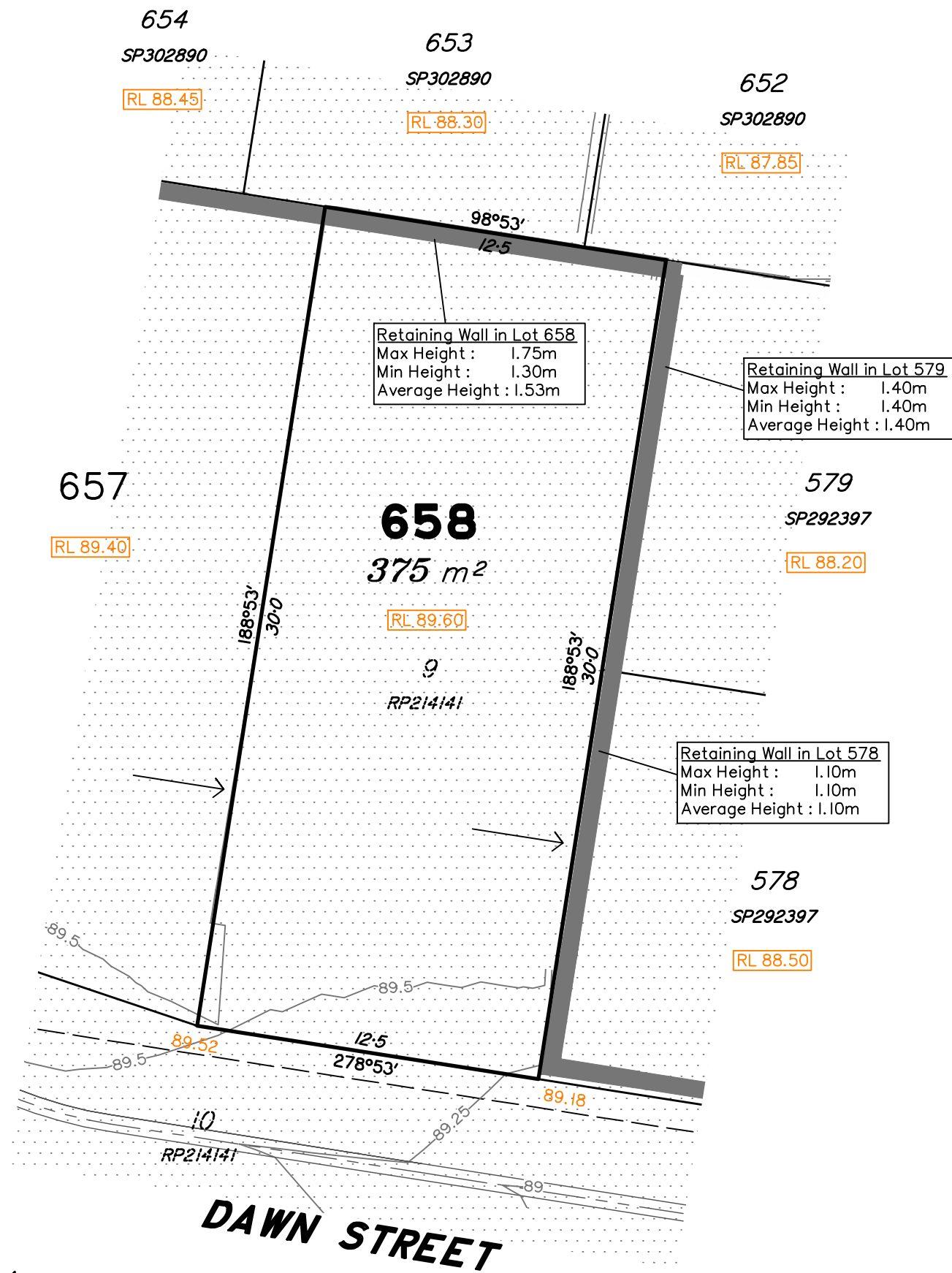

**LEGEND**

- Area of Fill
- Area of Cut
- Design Contours
- Zero Lot Boundary
- Retaining Wall
- 38.78 Finished Surface Design Level
- RL 38.78 Finished Pad Design Level
- 1.0 Depth of Fill

(Not all items in this legend may be relevant to the lot shown hereon)

**NOTES**

This plan has been prepared from preliminary survey plan (SP302893) and engineering plans provided on the 08/08/18 by Premise Engineering.

Lot 658 is restricted to the depth of 15.24 metres below the surface, as defined on the plan M3172.

Development Approval for reconfiguration of a lot and material change of use (Application 1489/2017/CA) have been approved by Ipswich City Council (25/09/2017).

Development Approval has been granted for Operational Works for the proposed lot (17.09.18 - ref: OW - 6005/2018)

No.	by	Date	Description
A	TBG	05/10/18	Original Issue

Scale 1:200 – Lengths are in Metres.

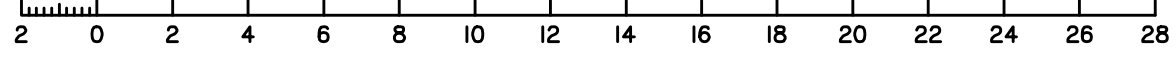

**saunders havill group**  
 Saunders Havill Group Pty Ltd ABN 24 144 972 949  
 Brisbane • Emerald • Rockhampton  
 head office 9 Thompson St Bowen Hills Q 4006  
 phone 1300 123 SHG web www.saundershavill.com  
 ■ surveying ■ town planning ■ urban design ■ environmental management ■ landscape architecture

This Disclosure Plan is prepared for the sole purpose of satisfying the Disclosure requirements of the Land Sales Act and SHOULD NOT be used for any other purpose, particularly As-constructed purposes. This information is compiled from Design plans only, unless otherwise stated, and therefore is subject to final survey and construction of operational works.

**Disclosure Plan for Proposed Lot 658 (Restricted) on SP302893**  
 Described as part of Lot 860 (Restricted) on SP300831  
 Existing Title Reference: 51156557  
 Locality of Redbank Plains (Ipswich City Council)

Level Datum: AHD der.  
 Origin of Levels: PM203226  
 RL of Origin: 75.312  
 Contour Interval: 0.25m  
 Scale @A3 1: 200  
 Dwg No. 8655 S 08 DP A\_658

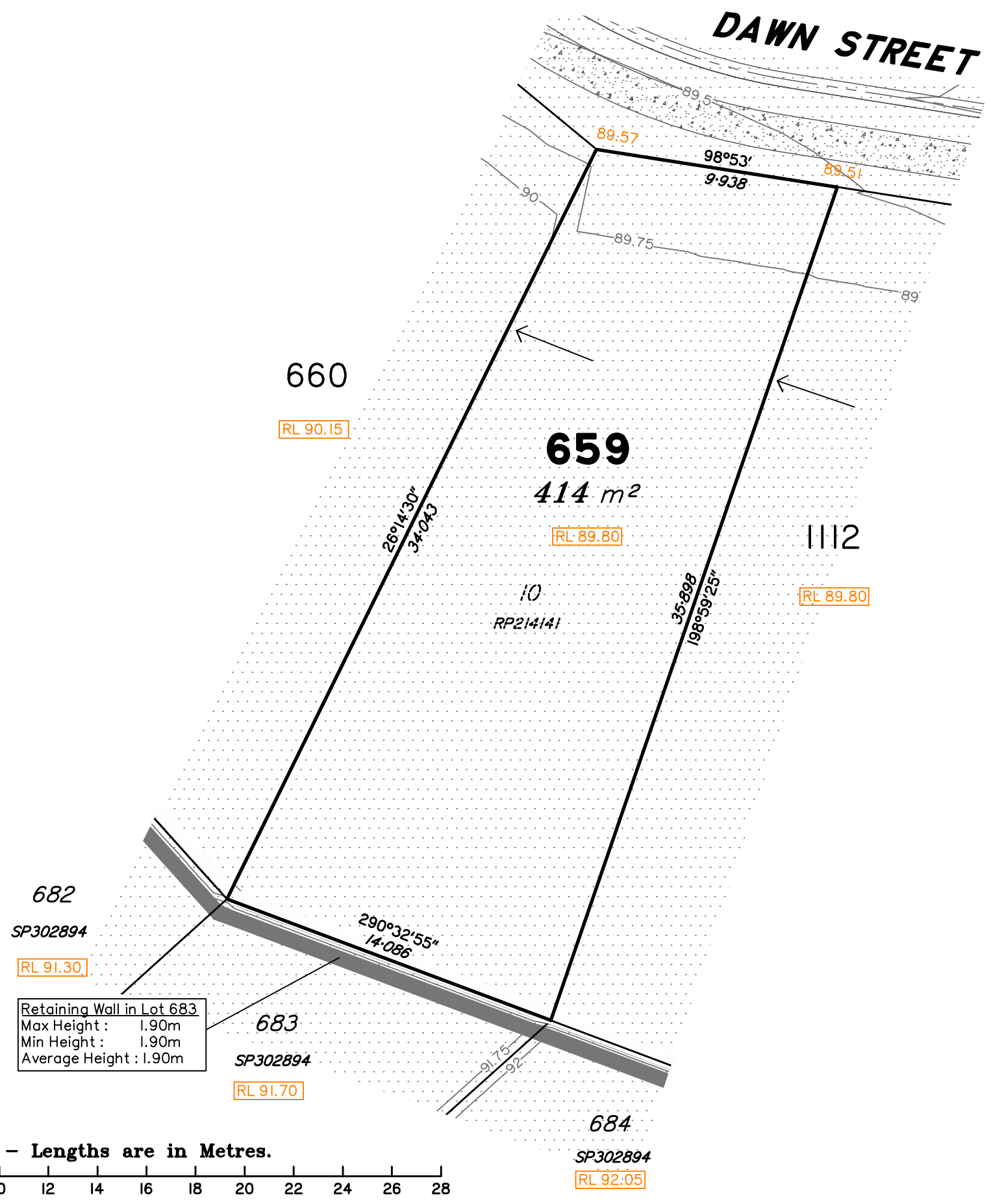

**LEGEND**

- Area of Fill
  - Area of Cut
  - Design Contours
  - Zero Lot Boundary
  - Retaining Wall
  - 38.78 Finished Surface Design Level
  - RL 38.78 Finished Pad Design Level
  - 1.0 Depth of Fill
- (Not all items in this legend may be relevant to the lot shown hereon)

**NOTES**

This plan has been prepared from preliminary survey plan (SP302893) and engineering plans provided on the 08/08/18 & 14/01/18 by Premise Engineering.

Lot 659 is restricted to the depth of 15.24 metres below the surface, as defined on the plan M3172.

Development Approval for reconfiguration of a lot and material change of use (Application 1489/2017/CA) have been approved by Ipswich City Council (25/09/2017).

Development Approval has been granted for Operational Works for the proposed lot (17.09.18 - ref: OW - 6005/2018)

No.	by	Date	Description
A	TBG	05/10/18	Original Issue
B	TBG	14/01/19	Lot 659 Subdivided into 2 lots. Area recalcd.

**SH saunders havill group**

Saunders Havill Group Pty Ltd ABN 24 144 972 949  
Brisbane • Emerald • Rockhampton  
head office 9 Thompson St Bowen Hills Q 4006  
phone 1300 123 SHG web www.saundershavill.com

• surveying • town planning • urban design • environmental management • landscape architecture

This Disclosure Plan is prepared for the sole purpose of satisfying the Disclosure requirements of the Land Sales Act and SHOULD NOT be used for any other purpose, particularly As-constructed purposes. This information is compiled from Design plans only, unless otherwise stated, and therefore is subject to final survey and construction of operational works.

**Disclosure Plan for Proposed Lot 659 (Restricted) on SP302893**  
Described as part of Lot 860 (Restricted) on SP300831  
Existing Title Reference: 51156557  
Locality of Redbank Plains (Ipswich City Council)

Level Datum: AHD der.  
Origin of Levels: PM203226  
RL of Origin: 75.312  
Contour Interval: 0.25m  
Scale @A3 1: 200  
Dwg No. 8655 S 08 DP B\_659

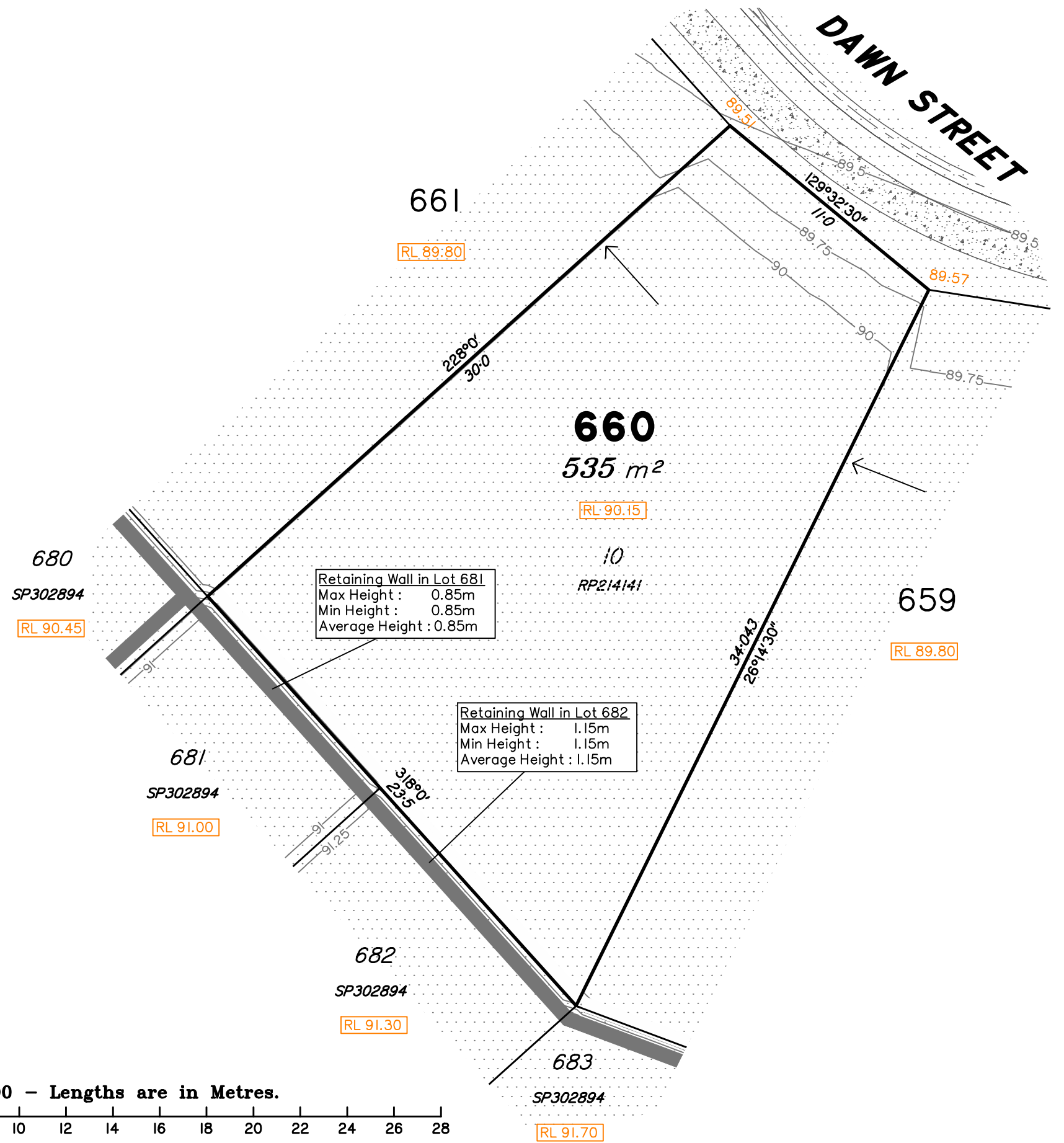

**LEGEND**

- Area of Fill
- Area of Cut
- Design Contours
- Zero Lot Boundary
- Retaining Wall
- 38.78 Finished Surface Design Level
- RL 38.78 Finished Pad Design Level
- 1.0 Depth of Fill

(Not all items in this legend may be relevant to the lot shown hereon)

**NOTES**

This plan has been prepared from preliminary survey plan (SP302893) and engineering plans provided on the 08/08/18 by Premise Engineering.

Lot 660 is restricted to the depth of 15.24 metres below the surface, as defined on the plan M3172.

Development Approval for reconfiguration of a lot and material change of use (Application 1489/2017/CA) have been approved by Ipswich City Council (25/09/2017).

Development Approval has been granted for Operational Works for the proposed lot (17.09.18 - ref: OW - 6005/2018)

Scale 1:200 – Lengths are in Metres.

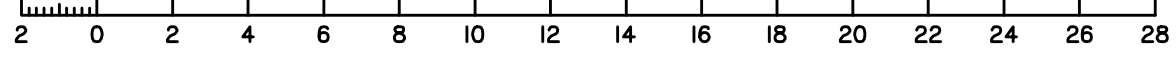

No.	by	Date	Description
A	TBG	05/10/18	Original Issue
B	TBG	14/01/19	Zero Lot Boundary added to Lot 659



Saunders Havill Group Pty Ltd ABN 24 144 972 949  
 Brisbane • Emerald • Rockhampton  
 head office 9 Thompson St Bowen Hills Q 4006  
 phone 1300 123 SHG web www.saundershavill.com

■ surveying ■ town planning ■ urban design ■ environmental management ■ landscape architecture

This Disclosure Plan is prepared for the sole purpose of satisfying the Disclosure requirements of the Land Sales Act and SHOULD NOT be used for any other purpose, particularly As-constructed purposes. This information is compiled from Design plans only, unless otherwise stated, and therefore is subject to final survey and construction of operational works.

**Disclosure Plan for Proposed Lot 660 (Restricted) on SP302893**

Described as part of Lot 860 (Restricted) on SP300831  
 Existing Title Reference: 51156557

Locality of Redbank Plains (Ipswich City Council)

Level Datum: AHD der.  
 Origin of Levels: PM203226  
 RL of Origin: 75.312  
 Contour Interval: 0.25m  
 Scale @A3 1: 200  
 Dwg No. 8655 S 08 DP B\_660

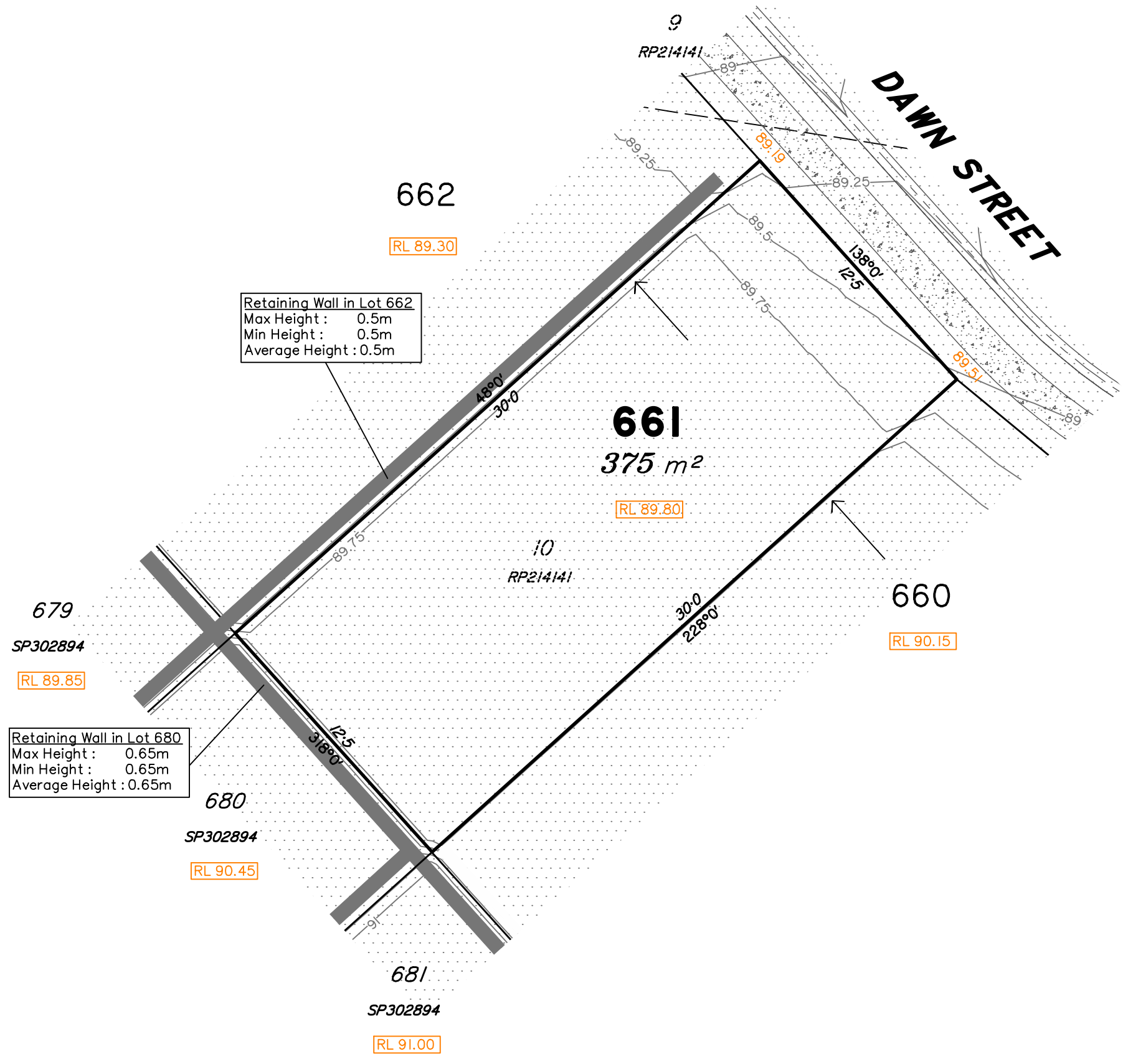

**LEGEND**

- Area of Fill
- Area of Cut
- Design Contours
- Zero Lot Boundary
- Retaining Wall
- 38.78 Finished Surface Design Level
- RL 38.78 Finished Pad Design Level
- 1.0 Depth of Fill

(Not all items in this legend may be relevant to the lot shown hereon)

**NOTES**

This plan has been prepared from preliminary survey plan (SP302893) and engineering plans provided on the 08/08/18 by Premise Engineering.

Lot 661 is restricted to the depth of 15.24 metres below the surface, as defined on the plan M3172.

Development Approval for reconfiguration of a lot and material change of use (Application 1489/2017/CA) have been approved by Ipswich City Council (25/09/2017).

Development Approval has been granted for Operational Works for the proposed lot (17.09.18 - ref: OW - 6005/2018)

Scale 1:200 – Lengths are in Metres.

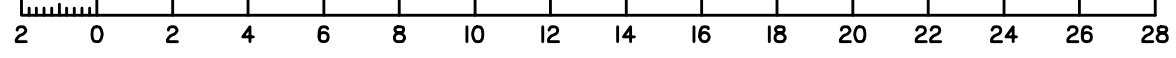

No.	by	Date	Description
A	TBG	05/10/18	Original Issue

**saunders havill group**

Saunders Havill Group Pty Ltd ABN 24 144 972 949  
 Brisbane • Emerald • Rockhampton  
 head office 9 Thompson St Bowen Hills Q 4006  
 phone 1300 123 SHG web www.saundershavill.com

• surveying • town planning • urban design • environmental management • landscape architecture

This Disclosure Plan is prepared for the sole purpose of satisfying the Disclosure requirements of the Land Sales Act and SHOULD NOT be used for any other purpose, particularly As-constructed purposes. This information is compiled from Design plans only, unless otherwise stated, and therefore is subject to final survey and construction of operational works.

**Disclosure Plan for Proposed Lot 661 (Restricted) on SP302893**  
 Described as part of Lot 860 (Restricted) on SP300831  
 Existing Title Reference: 51156557  
 Locality of Redbank Plains (Ipswich City Council)

Level Datum: AHD der.  
 Origin of Levels: PM203226  
 RL of Origin: 75.312  
 Contour Interval: 0.25m  
 Scale @A3 1: 200  
 Dwg No. 8655 S 08 DP A\_661

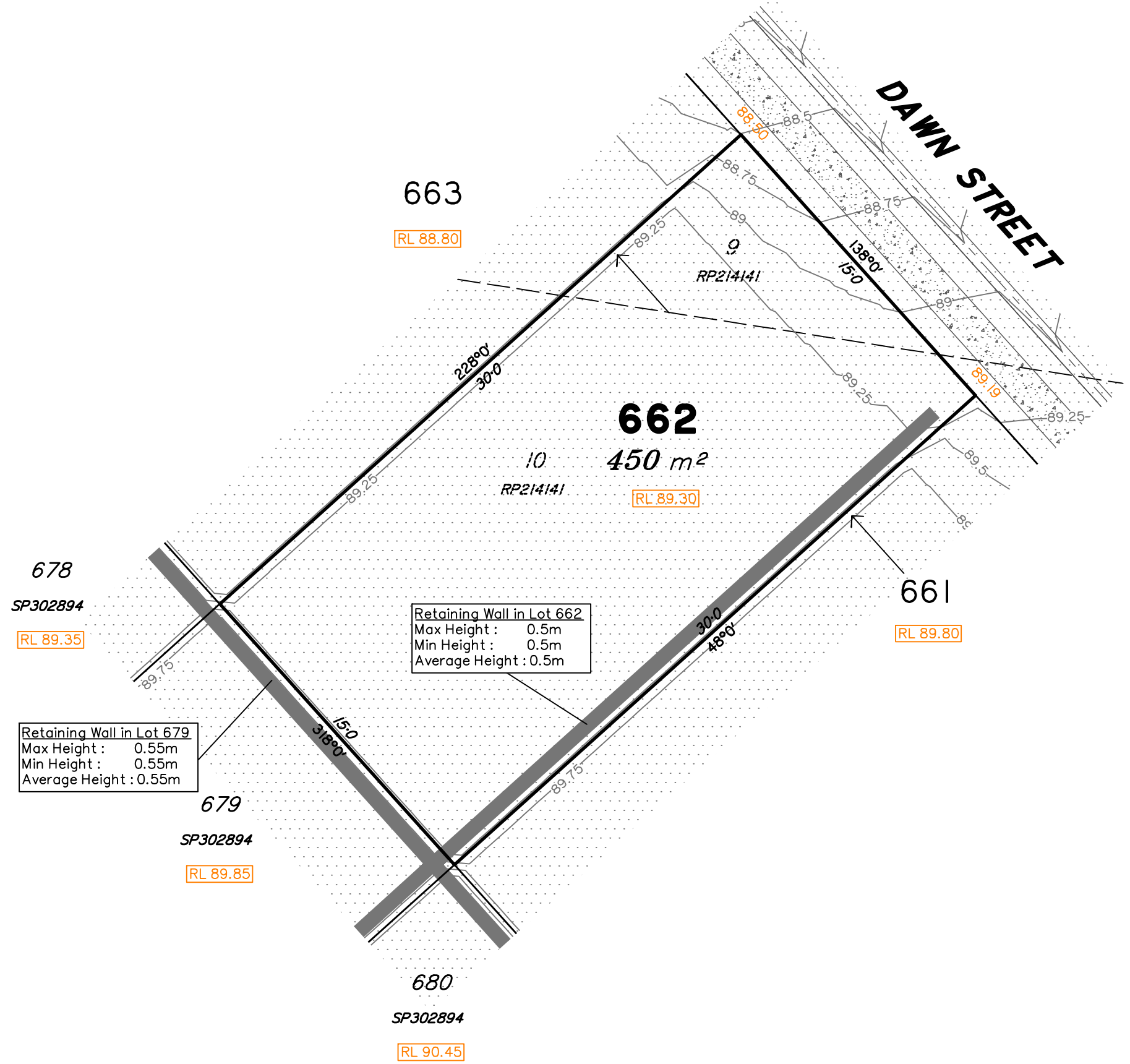

Retaining Wall in Lot 662  
 Max Height : 0.5m  
 Min Height : 0.5m  
 Average Height : 0.5m

Retaining Wall in Lot 679  
 Max Height : 0.55m  
 Min Height : 0.55m  
 Average Height : 0.55m

Scale 1:200 – Lengths are in Metres.

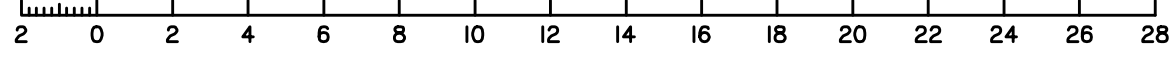

**LEGEND**

- Area of Fill
- Area of Cut
- Design Contours
- Zero Lot Boundary
- Retaining Wall
- 38.78 Finished Surface Design Level
- RL 38.78 Finished Pad Design Level
- 1.0 Depth of Fill

(Not all items in this legend may be relevant to the lot shown hereon)

**NOTES**

This plan has been prepared from preliminary survey plan (SP302893) and engineering plans provided on the 08/08/18 by Premise Engineering.

Lot 662 is restricted to the depth of 15.24 metres below the surface, as defined on the plan M3172.

Development Approval for reconfiguration of a lot and material change of use (Application 1489/2017/CA) have been approved by Ipswich City Council (25/09/2017).

Development Approval has been granted for Operational Works for the proposed lot (17.09.18 - ref: OW - 6005/2018)

No.	by	Date	Description
A	TBG	05/10/18	Original Issue

**saunders havill group**  
 Saunders Havill Group Pty Ltd ABN 24 144 972 949  
 Brisbane • Emerald • Rockhampton  
 head office 9 Thompson St Bowen Hills Q 4006  
 phone 1300 123 SHG web www.saundershavill.com  
 • surveying • town planning • urban design • environmental management • landscape architecture

This Disclosure Plan is prepared for the sole purpose of satisfying the Disclosure requirements of the Land Sales Act and SHOULD NOT be used for any other purpose, particularly As-constructed purposes. This information is compiled from Design plans only, unless otherwise stated, and therefore is subject to final survey and construction of operational works.

**Disclosure Plan for Proposed Lot 662 (Restricted) on SP302893**  
 Described as part of Lot 860 (Restricted) on SP300831  
 Existing Title Reference: 51156557  
 Locality of Redbank Plains (Ipswich City Council)

Level Datum: AHD der.  
 Origin of Levels: PM203226  
 RL of Origin: 75.312  
 Contour Interval: 0.25m  
 Scale @A3 1: 200  
 Dwg No. 8655 S 08 DP A\_662

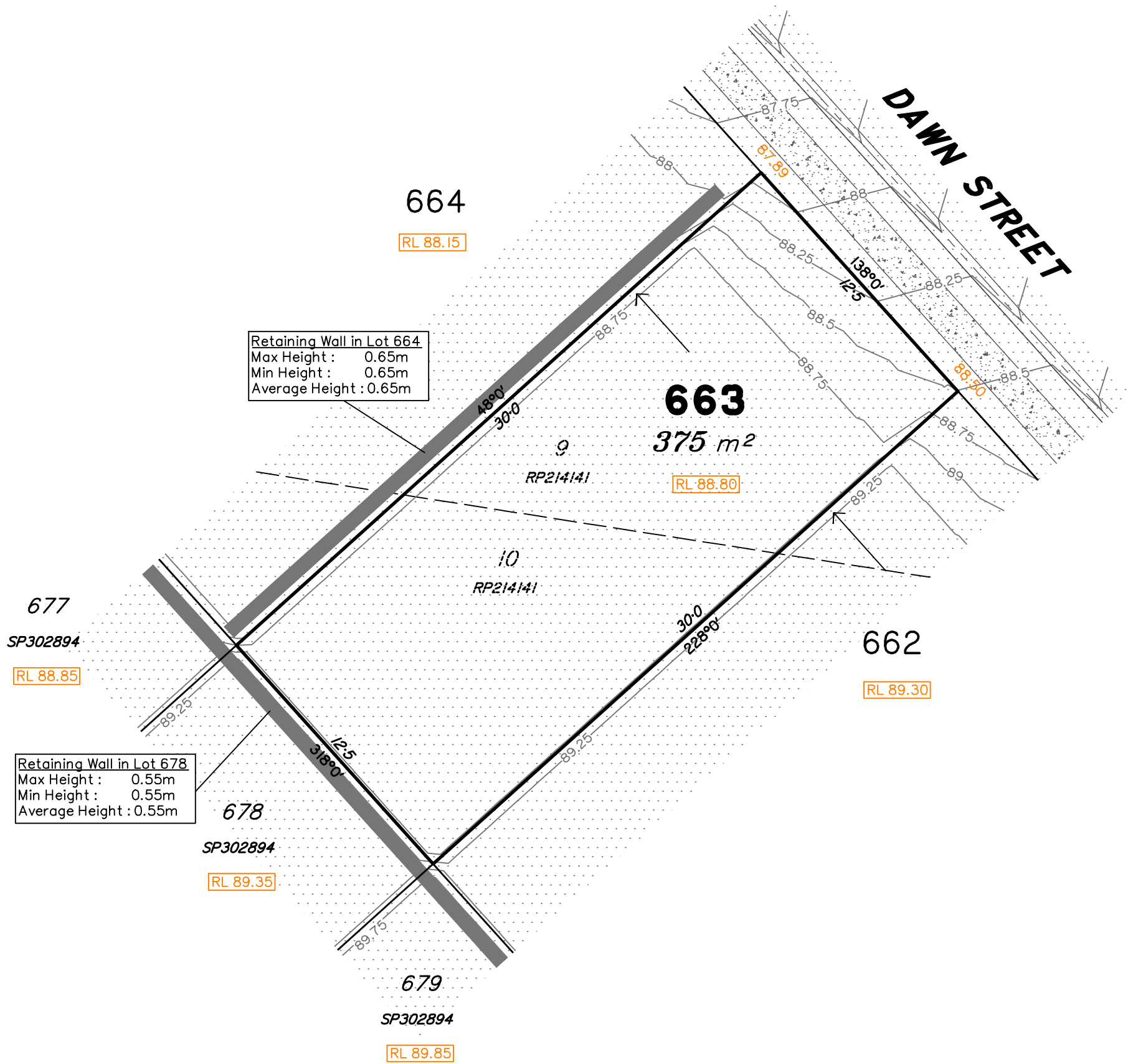

**LEGEND**

- Area of Fill
- Area of Cut
- Design Contours
- Zero Lot Boundary
- Retaining Wall
- 38.78 Finished Surface Design Level
- RL 38.78 Finished Pad Design Level
- 1.0 Depth of Fill

(Not all items in this legend may be relevant to the lot shown hereon)

**NOTES**

This plan has been prepared from preliminary survey plan (SP302893) and engineering plans provided on the 08/08/18 by Premise Engineering.

Lot 663 is restricted to the depth of 15.24 metres below the surface, as defined on the plan M3172.

Development Approval for reconfiguration of a lot and material change of use (Application 1489/2017/CA) have been approved by Ipswich City Council (25/09/2017).

Development Approval has been granted for Operational Works for the proposed lot (17.09.18 - ref: OW - 6005/2018)

Scale 1:200 – Lengths are in Metres.

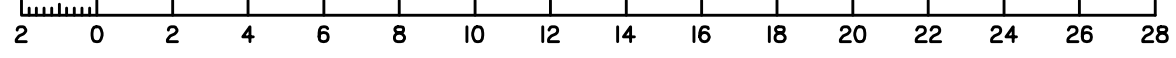

No.	by	Date	Description
A	TBG	05/10/18	Original Issue

**saunders havill group**  
 Saunders Havill Group Pty Ltd ABN 24 144 972 949  
 Brisbane • Emerald • Rockhampton  
 head office 9 Thompson St Bowen Hills Q 4006  
 phone 1300 123 SHG web www.saundershavill.com  
 • surveying • town planning • urban design • environmental management • landscape architecture

This Disclosure Plan is prepared for the sole purpose of satisfying the Disclosure requirements of the Land Sales Act and SHOULD NOT be used for any other purpose, particularly As-constructed purposes. This information is compiled from Design plans only, unless otherwise stated, and therefore is subject to final survey and construction of operational works.

**Disclosure Plan for Proposed Lot 663 (Restricted) on SP302893**  
 Described as part of Lot 860 (Restricted) on SP300831  
 Existing Title Reference: 51156557  
 Locality of Redbank Plains (Ipswich City Council)

Level Datum: AHD der.  
 Origin of Levels: PM203226  
 RL of Origin: 75.312  
 Contour Interval: 0.25m  
 Scale @A3 1: 200  
 Dwg No. 8655 S 08 DP A\_663



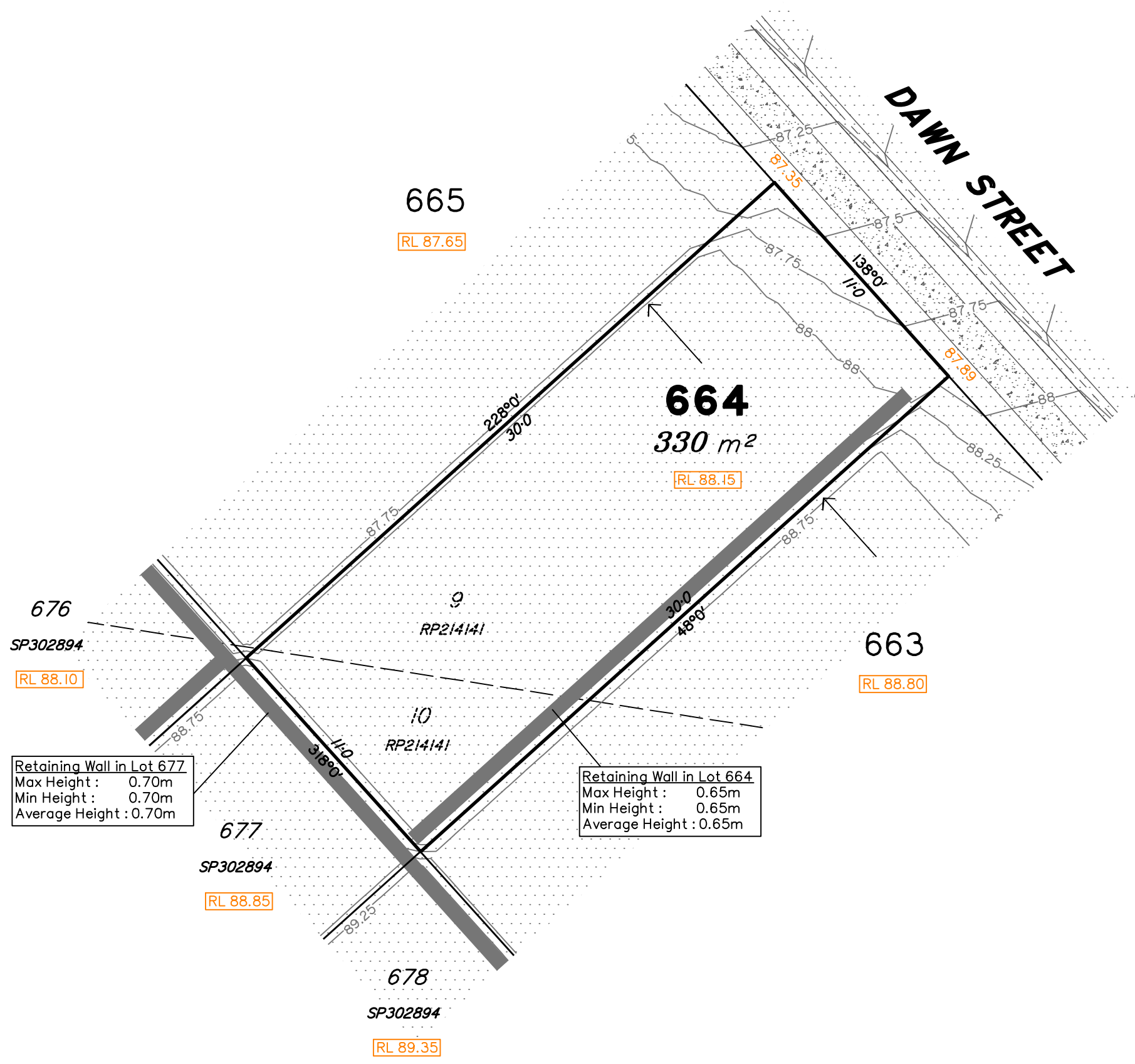

LEGEND	
	Area of Fill
	Area of Cut
	Design Contours
	Zero Lot Boundary
	Retaining Wall
38.78	Finished Surface Design Level
RL 38.78	Finished Pad Design Level
1.0	Depth of Fill

(Not all items in this legend may be relevant to the lot shown hereon)

**NOTES**

This plan has been prepared from preliminary survey plan (SP302893) and engineering plans provided on the 08/08/18 by Premise Engineering.

Lot 664 is restricted to the depth of 15.24 metres below the surface, as defined on the plan M3172.

Development Approval for reconfiguration of a lot and material change of use (Application 1489/2017/CA) have been approved by Ipswich City Council (25/09/2017).

Development Approval has been granted for Operational Works for the proposed lot (17.09.18 - ref: OW - 6005/2018)

Retaining Wall in Lot 677  
 Max Height : 0.70m  
 Min Height : 0.70m  
 Average Height : 0.70m

Retaining Wall in Lot 664  
 Max Height : 0.65m  
 Min Height : 0.65m  
 Average Height : 0.65m

Scale 1:200 – Lengths are in Metres.

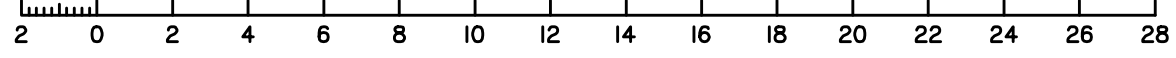

No.	by	Date	Description
A	TBG	05/10/18	Original Issue

**saunders havill group**  
 Saunders Havill Group Pty Ltd ABN 24 144 972 949  
 Brisbane • Emerald • Rockhampton  
 head office 9 Thompson St Bowen Hills Q 4006  
 phone 1300 123 SHG web www.saundershavill.com  
 • surveying • town planning • urban design • environmental management • landscape architecture

This Disclosure Plan is prepared for the sole purpose of satisfying the Disclosure requirements of the Land Sales Act and SHOULD NOT be used for any other purpose, particularly As-constructed purposes. This information is compiled from Design plans only, unless otherwise stated, and therefore is subject to final survey and construction of operational works.

**Disclosure Plan for Proposed Lot 664 (Restricted) on SP302893**  
 Described as part of Lot 860 (Restricted) on SP300831  
 Existing Title Reference: 51156557  
 Locality of Redbank Plains (Ipswich City Council)

Level Datum: AHD der.  
 Origin of Levels: PM203226  
 RL of Origin: 75.312  
 Contour Interval: 0.25m  
 Scale @A3 1: 200  
 Dwg No. 8655 S 08 DP A\_664

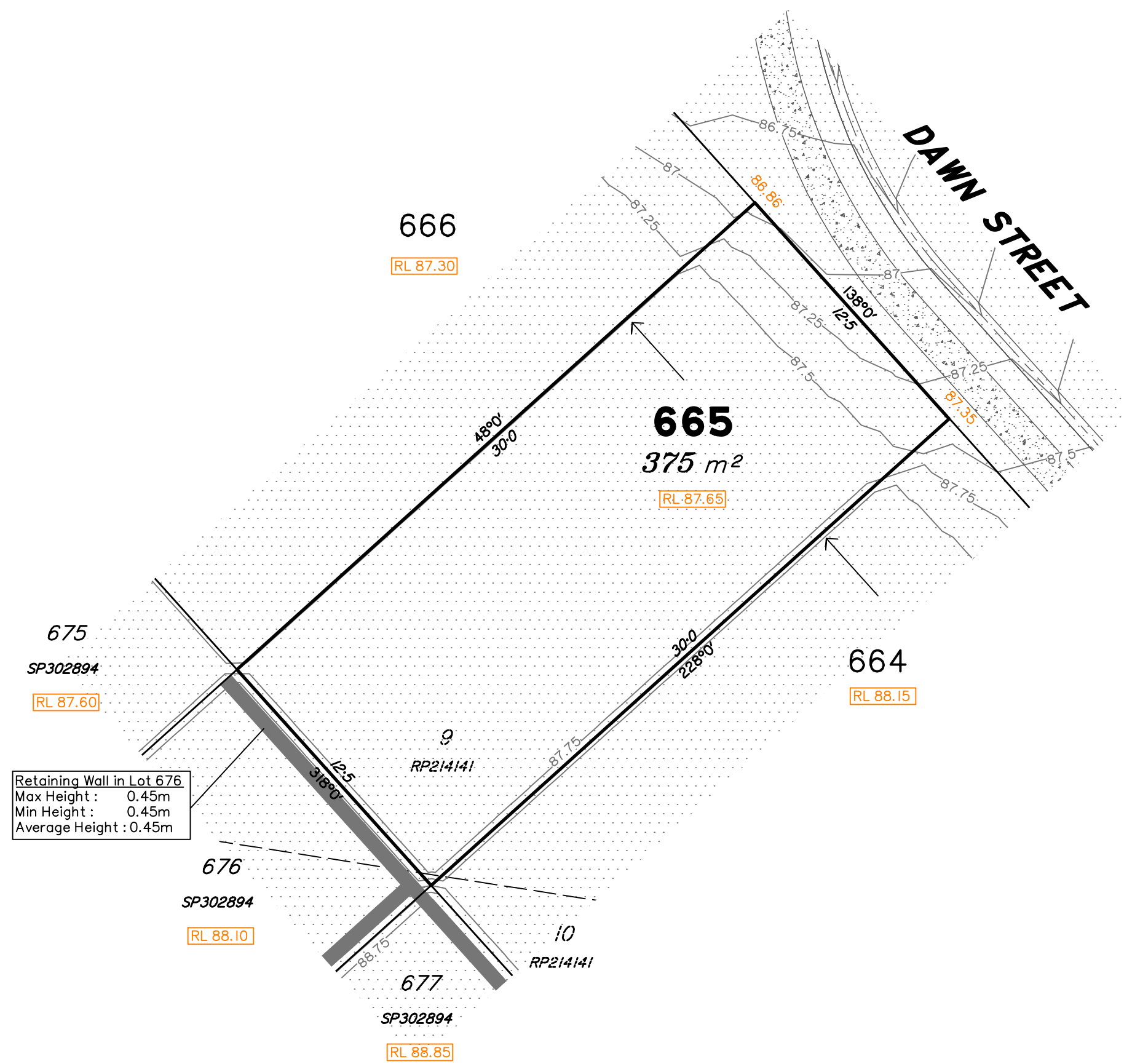

Scale 1:200 – Lengths are in Metres.

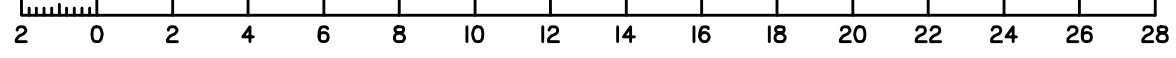

**LEGEND**

- Area of Fill
- Area of Cut
- Design Contours
- Zero Lot Boundary
- Retaining Wall
- 38.78 Finished Surface Design Level
- RL 38.78 Finished Pad Design Level
- 1.0 Depth of Fill

(Not all items in this legend may be relevant to the lot shown hereon)

**NOTES**

This plan has been prepared from preliminary survey plan (SP302893) and engineering plans provided on the 08/08/18 by Premise Engineering.

Lot 665 is restricted to the depth of 15.24 metres below the surface, as defined on the plan M3172.

Development Approval for reconfiguration of a lot and material change of use (Application 1489/2017/CA) have been approved by Ipswich City Council (25/09/2017).

Development Approval has been granted for Operational Works for the proposed lot (17.09.18 - ref: OW - 6005/2018)

No.	by	Date	Description
A	TBG	05/10/18	Original Issue

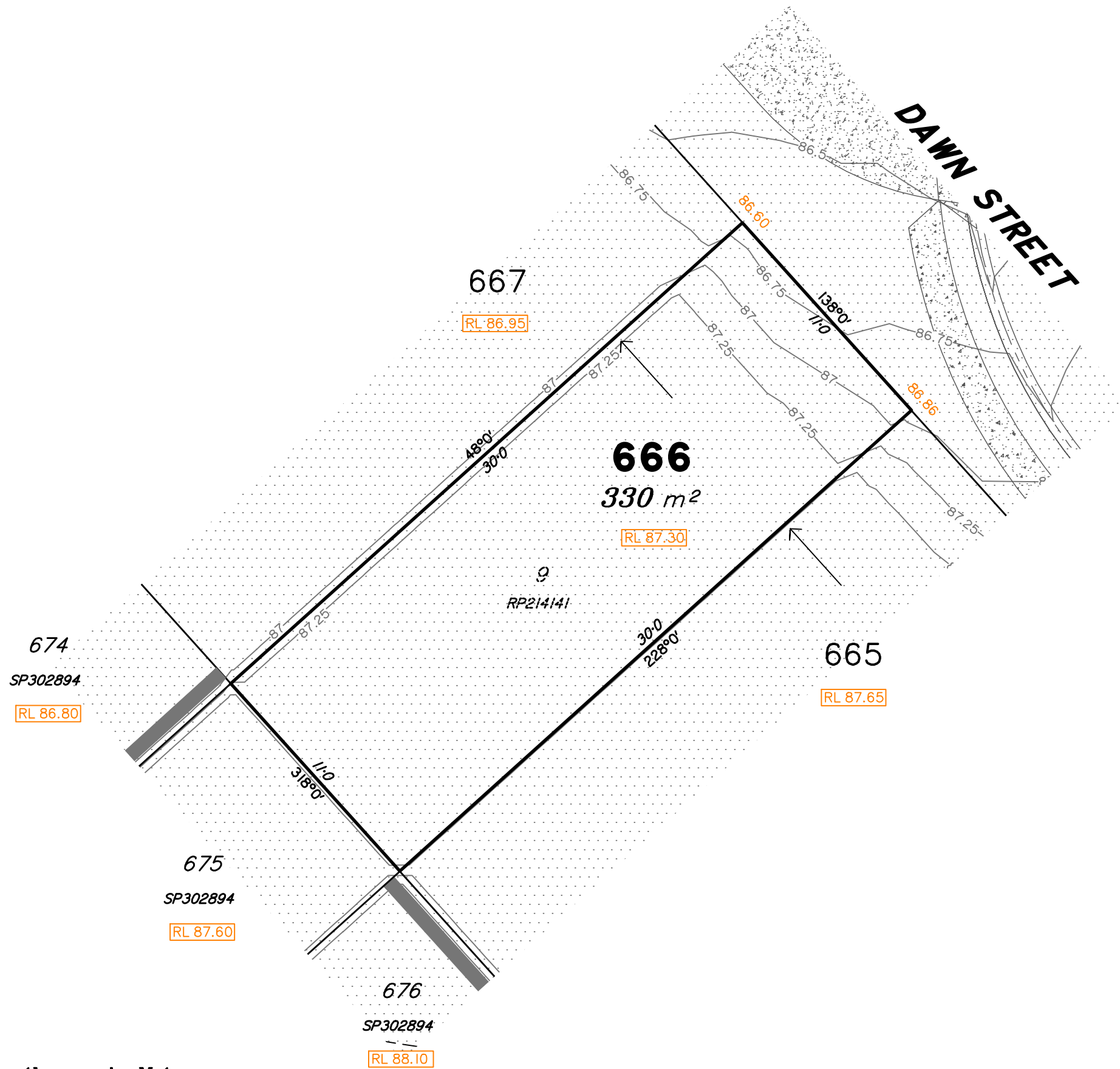

LEGEND	
	Area of Fill
	Area of Cut
	Design Contours
	Zero Lot Boundary
	Retaining Wall
38.78	Finished Surface Design Level
RL 38.78	Finished Pad Design Level
1.0	Depth of Fill

(Not all items in this legend may be relevant to the lot shown hereon)

**NOTES**

This plan has been prepared from preliminary survey plan (SP302893) and engineering plans provided on the 08/08/18 by Premise Engineering.

Lot 666 is restricted to the depth of 15.24 metres below the surface, as defined on the plan M3172.

Development Approval for reconfiguration of a lot and material change of use (Application 1489/2017/CA) have been approved by Ipswich City Council (25/09/2017).

Development Approval has been granted for Operational Works for the proposed lot (17.09.18 - ref: OW - 6005/2018)

Scale 1:200 – Lengths are in Metres.

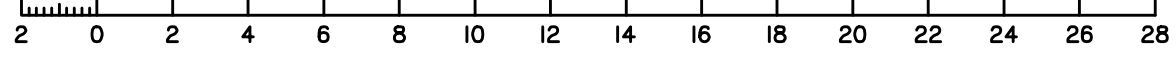

No.	by	Date	Description
A	TBG	05/10/18	Original Issue

**saunders havill group**

Saunders Havill Group Pty Ltd ABN 24 144 972 949  
 Brisbane • Emerald • Rockhampton  
 head office 9 Thompson St Bowen Hills Q 4006  
 phone 1300 123 SHG web www.saundershavill.com

• surveying • town planning • urban design • environmental management • landscape architecture

This Disclosure Plan is prepared for the sole purpose of satisfying the Disclosure requirements of the Land Sales Act and SHOULD NOT be used for any other purpose, particularly As-constructed purposes. This information is compiled from Design plans only, unless otherwise stated, and therefore is subject to final survey and construction of operational works.

**Disclosure Plan for Proposed Lot 666 (Restricted) on SP302893**  
 Described as part of Lot 860 (Restricted) on SP300831  
 Existing Title Reference: 51156557  
 Locality of Redbank Plains (Ipswich City Council)

Level Datum: AHD der.  
 Origin of Levels: PM203226  
 RL of Origin: 75.312  
 Contour Interval: 0.25m  
 Scale @A3 1: 200  
 Dwg No. 8655 S 08 DP A\_666

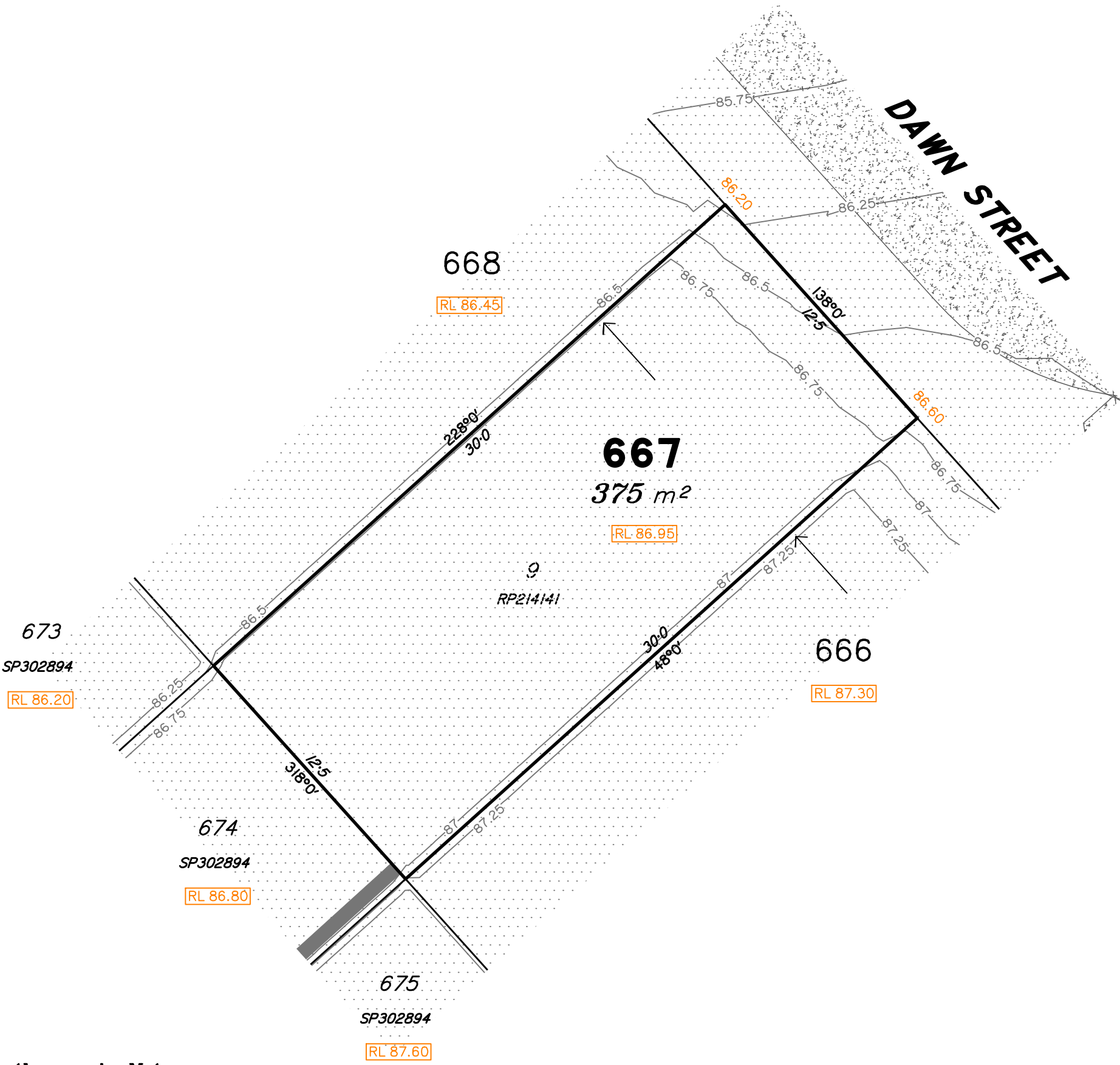

LEGEND	
	Area of Fill
	Area of Cut
	Design Contours
	Zero Lot Boundary
	Retaining Wall
<b>38.78</b>	Finished Surface Design Level
<b>RL 38.78</b>	Finished Pad Design Level
<b>1.0</b>	Depth of Fill

(Not all items in this legend may be relevant to the lot shown hereon)

**NOTES**

This plan has been prepared from preliminary survey plan (SP302893) and engineering plans provided on the 08/08/18 by Premise Engineering.

Lot 667 is restricted to the depth of 15.24 metres below the surface, as defined on the plan M3172.

Development Approval for reconfiguration of a lot and material change of use (Application 1489/2017/CA) have been approved by Ipswich City Council (25/09/2017).

Development Approval has been granted for Operational Works for the proposed lot (17.09.18 - ref: OW - 6005/2018)

Scale 1:200 – Lengths are in Metres.

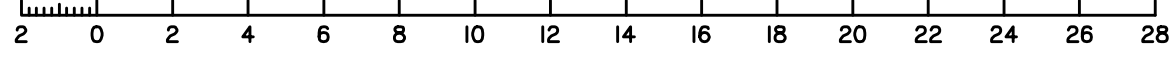

No.	by	Date	Description
A	TBG	05/10/18	Original Issue

**saunders havill group**

Saunders Havill Group Pty Ltd ABN 24 144 972 949  
 Brisbane • Emerald • Rockhampton  
 head office 9 Thompson St Bowen Hills Q 4006  
 phone 1300 123 SHG web www.saundershavill.com

■ surveying ■ town planning ■ urban design ■ environmental management ■ landscape architecture

This Disclosure Plan is prepared for the sole purpose of satisfying the Disclosure requirements of the Land Sales Act and SHOULD NOT be used for any other purpose, particularly As-constructed purposes. This information is compiled from Design plans only, unless otherwise stated, and therefore is subject to final survey and construction of operational works.

**Disclosure Plan for Proposed Lot 667 (Restricted) on SP302893**  
 Described as part of Lot 860 (Restricted) on SP300831  
 Existing Title Reference: 51156557  
 Locality of Redbank Plains (Ipswich City Council)

Level Datum: AHD der.  
 Origin of Levels: PM203226  
 RL of Origin: 75.312  
 Contour Interval: 0.25m  
 Scale @A3 1: 200  
 Dwg No. 8655 S 08 DP A\_667

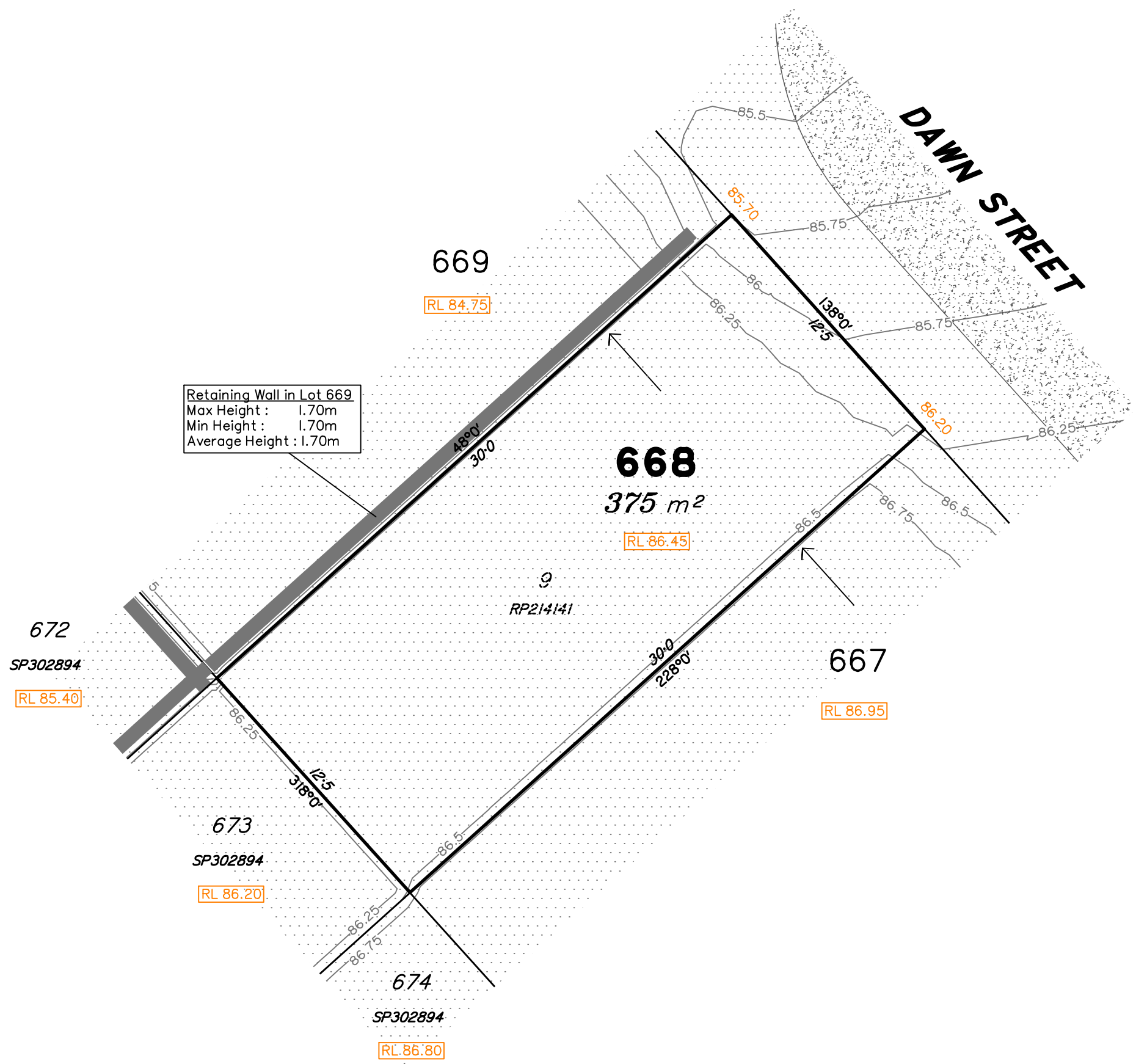

**LEGEND**

- Area of Fill
- Area of Cut
- Design Contours
- Zero Lot Boundary
- Retaining Wall
- 38.78 Finished Surface Design Level
- RL 38.78 Finished Pad Design Level
- 1.0 Depth of Fill

(Not all items in this legend may be relevant to the lot shown hereon)

**NOTES**

This plan has been prepared from preliminary survey plan (SP302893) and engineering plans provided on the 08/08/18 by Premise Engineering.

Lot 668 is restricted to the depth of 15.24 metres below the surface, as defined on the plan M3172.

Development Approval for reconfiguration of a lot and material change of use (Application 1489/2017/CA) have been approved by Ipswich City Council (25/09/2017).

Development Approval has been granted for Operational Works for the proposed lot (17.09.18 - ref: OW - 6005/2018)

Scale 1:200 – Lengths are in Metres.

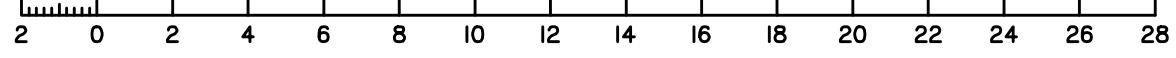

No.	by	Date	Description
A	TBG	05/10/18	Original Issue

**saunders havill group**

Saunders Havill Group Pty Ltd ABN 24 144 972 949  
 Brisbane • Emerald • Rockhampton  
 head office 9 Thompson St Bowen Hills Q 4006  
 phone 1300 123 SHG web www.saundershavill.com

• surveying • town planning • urban design • environmental management • landscape architecture

This Disclosure Plan is prepared for the sole purpose of satisfying the Disclosure requirements of the Land Sales Act and SHOULD NOT be used for any other purpose, particularly As-constructed purposes. This information is compiled from Design plans only, unless otherwise stated, and therefore is subject to final survey and construction of operational works.

**Disclosure Plan for Proposed Lot 668 (Restricted) on SP302893**

Described as part of Lot 860 (Restricted) on SP300831  
 Existing Title Reference: 51156557

Locality of Redbank Plains (Ipswich City Council)

Level Datum: AHD der.  
 Origin of Levels: PM203226  
 RL of Origin: 75.312  
 Contour Interval: 0.25m

Scale @A3 1: 200  
 Dwg No. 8655 S 08 DP A\_668

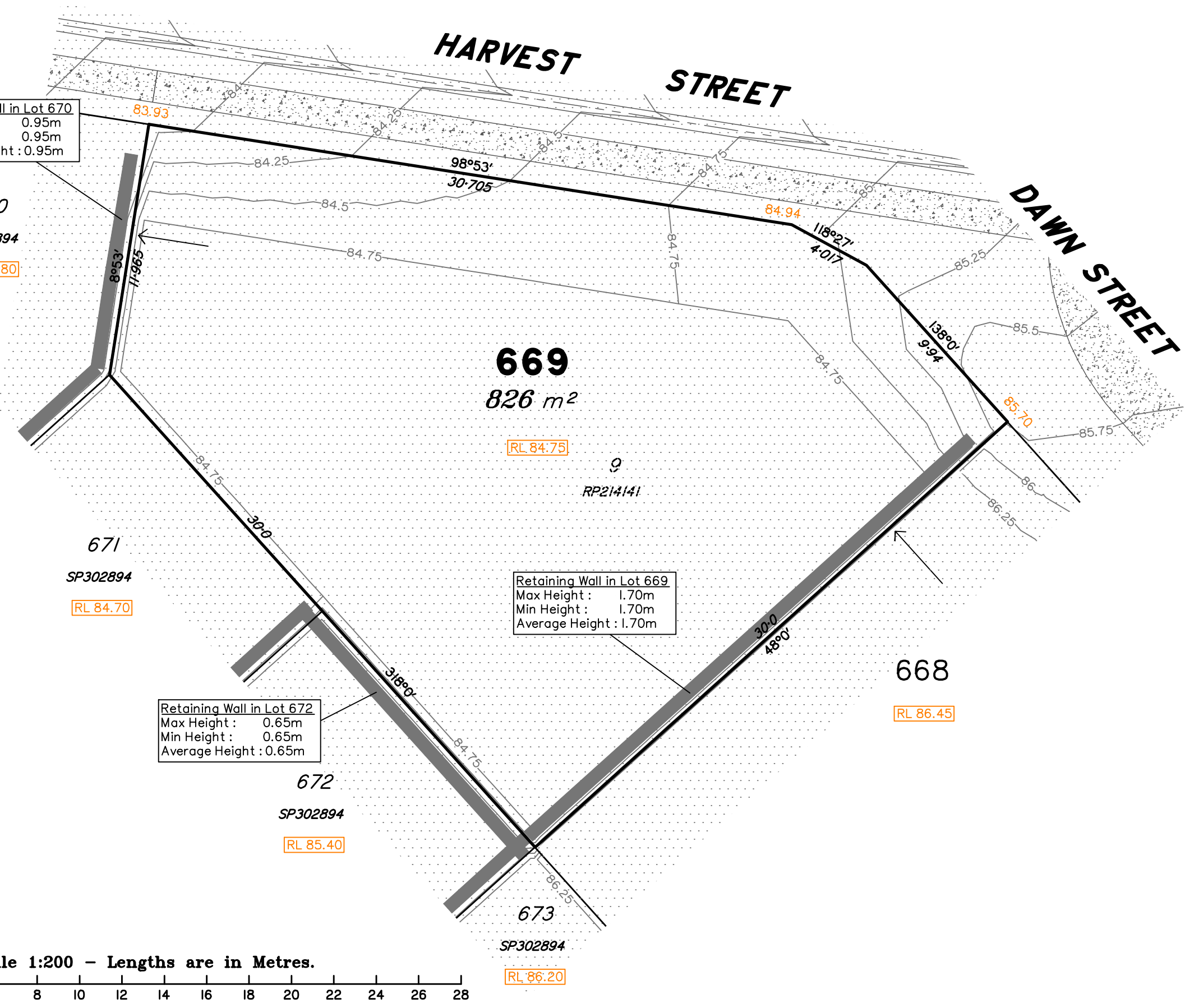

Retaining Wall in Lot 670  
 Max Height : 0.95m  
 Min Height : 0.95m  
 Average Height : 0.95m

Retaining Wall in Lot 669  
 Max Height : 1.70m  
 Min Height : 1.70m  
 Average Height : 1.70m

Retaining Wall in Lot 672  
 Max Height : 0.65m  
 Min Height : 0.65m  
 Average Height : 0.65m

**LEGEND**

- Area of Fill
- Area of Cut
- Design Contours
- Zero Lot Boundary
- Retaining Wall
- 38.78 Finished Surface Design Level
- RL 38.78 Finished Pad Design Level
- 1.0 Depth of Fill

(Not all items in this legend may be relevant to the lot shown hereon)

**NOTES**

This plan has been prepared from preliminary survey plan (SP302893) and engineering plans provided on the 08/08/18 by Premise Engineering.

Lot 669 is restricted to the depth of 15.24 metres below the surface, as defined on the plan M3172.

Development Approval for reconfiguration of a lot and material change of use (Application 1489/2017/CA) have been approved by Ipswich City Council (25/09/2017).

Development Approval has been granted for Operational Works for the proposed lot (17.09.18 - ref: OW - 6005/2018)

Scale 1:200 – Lengths are in Metres.

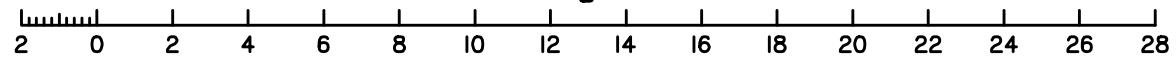

No.	by	Date	Description
A	TBG	05/10/18	Original Issue

**SH saunders havill group**

Saunders Havill Group Pty Ltd ABN 24 144 972 949  
 Brisbane • Emerald • Rockhampton  
 head office 9 Thompson St Bowen Hills Q 4006  
 phone 1300 123 SHG web www.saundershavill.com

• surveying • town planning • urban design • environmental management • landscape architecture

This Disclosure Plan is prepared for the sole purpose of satisfying the Disclosure requirements of the Land Sales Act and SHOULD NOT be used for any other purpose, particularly As-constructed purposes. This information is compiled from Design plans only, unless otherwise stated, and therefore is subject to final survey and construction of operational works.

**Disclosure Plan for Proposed Lot 669 (Restricted) on SP302893**  
 Described as part of Lot 860 (Restricted) on SP300831  
 Existing Title Reference: 51156557  
 Locality of Redbank Plains (Ipswich City Council)

Level Datum: AHD der.  
 Origin of Levels: PM203226  
 RL of Origin: 75.312  
 Contour Interval: 0.25m  
 Scale @A3 1: 200  
 Dwg No. 8655 S 08 DP A\_669



9001 (Pt)

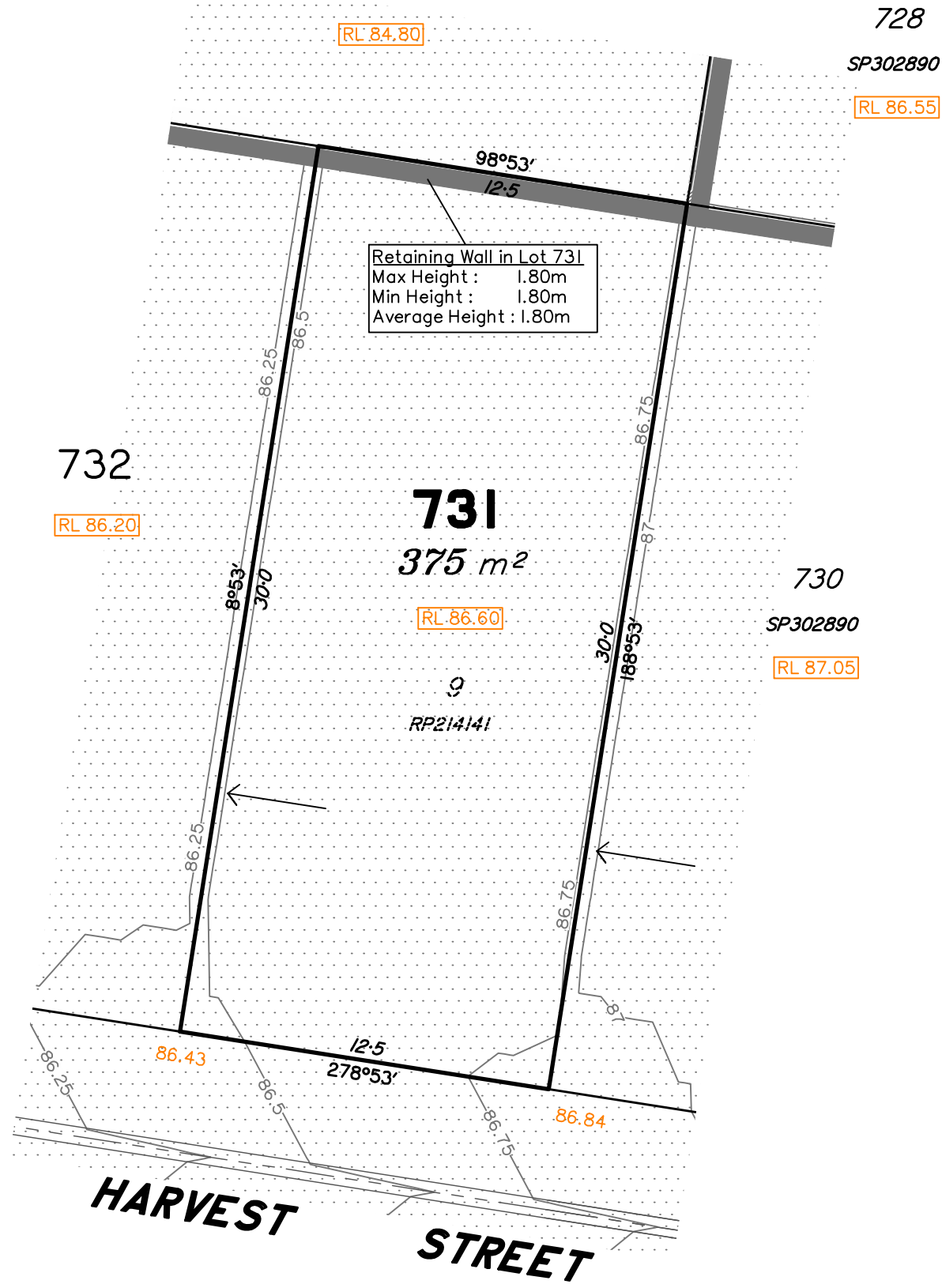

**LEGEND**

- Area of Fill
- Area of Cut
- Design Contours
- Zero Lot Boundary
- Retaining Wall
- 38.78 Finished Surface Design Level
- RL 38.78 Finished Pad Design Level
- 1.0 Depth of Fill

(Not all items in this legend may be relevant to the lot shown hereon)

**NOTES**

This plan has been prepared from preliminary survey plan (SP302893) and engineering plans provided on the 08/08/18 by Premise Engineering.

Lot 731 is restricted to the depth of 15.24 metres below the surface, as defined on the plan M3172.

Development Approval for reconfiguration of a lot and material change of use (Application 1489/2017/CA) have been approved by Ipswich City Council (25/09/2017).

Development Approval has been granted for Operational Works for the proposed lot (17.09.18 - ref: OW - 6005/2018)

Scale 1:200 – Lengths are in Metres.

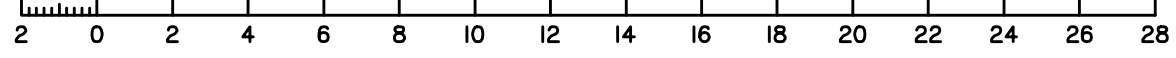

No.	by	Date	Description
A	TBG	05/10/18	Original Issue



Saunders Havill Group Pty Ltd ABN 24 144 972 949  
 Brisbane • Emerald • Rockhampton  
 head office 9 Thompson St Bowen Hills Q 4006  
 phone 1300 123 SHG web www.saundershavill.com

• surveying • town planning • urban design • environmental management • landscape architecture

This Disclosure Plan is prepared for the sole purpose of satisfying the Disclosure requirements of the Land Sales Act and SHOULD NOT be used for any other purpose, particularly As-constructed purposes. This information is compiled from Design plans only, unless otherwise stated, and therefore is subject to final survey and construction of operational works.

**Disclosure Plan for Proposed Lot 731 (Restricted) on SP302893**

Described as part of Lot 860 (Restricted) on SP300831  
 Existing Title Reference: 51156557

Locality of Redbank Plains (Ipswich City Council)

Level Datum: AHD der.  
 Origin of Levels: PM203226  
 RL of Origin: 75.312  
 Contour Interval: 0.25m  
 Scale @A3 1: 200  
 Dwg No. 8655 S 08 DP A\_731

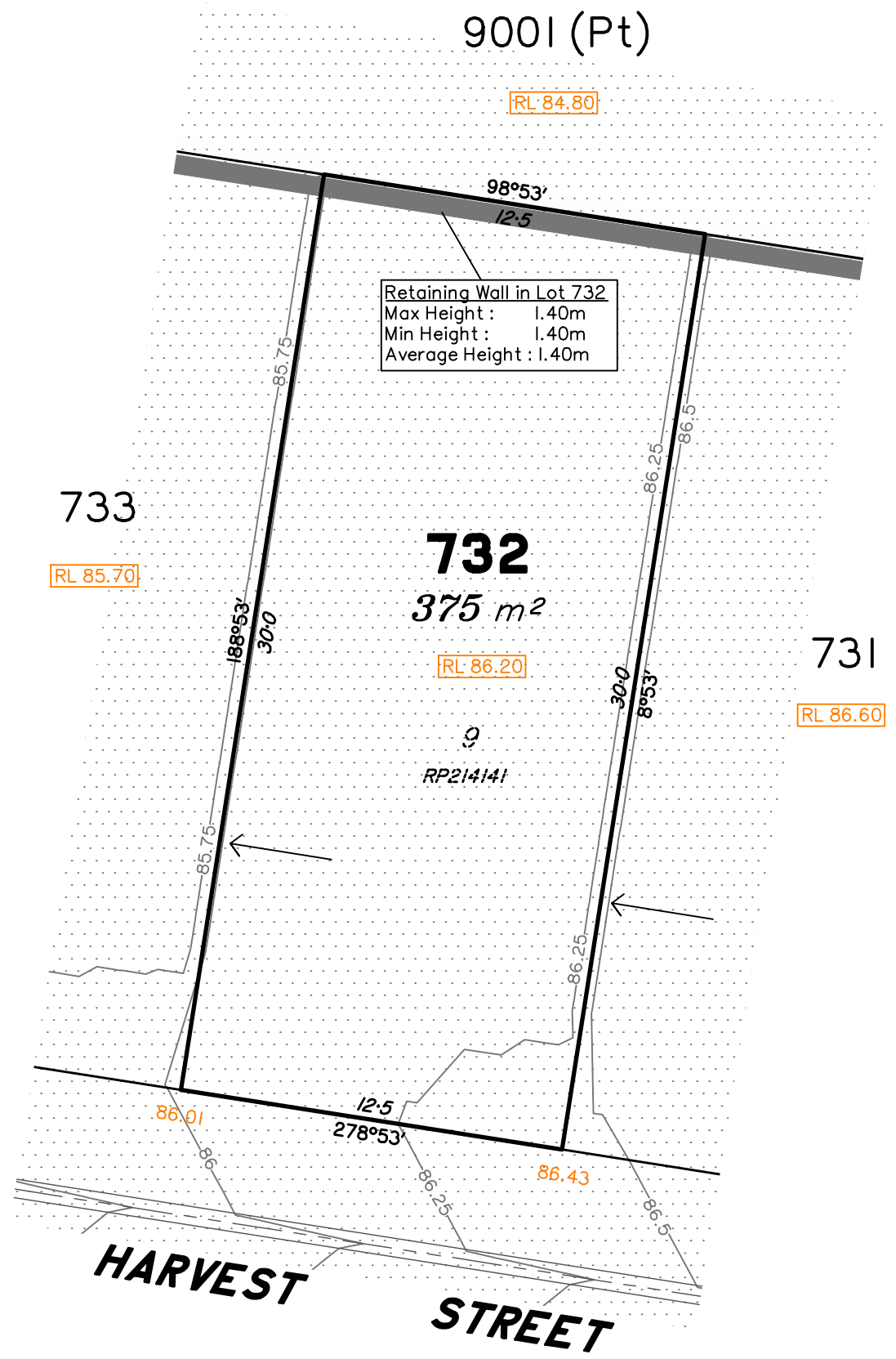

**LEGEND**

- Area of Fill
- Area of Cut
- Design Contours
- ← Zero Lot Boundary
- Retaining Wall
- 38.78 Finished Surface Design Level
- RL 38.78 Finished Pad Design Level
- 1.0 Depth of Fill

(Not all items in this legend may be relevant to the lot shown hereon)

**NOTES**

This plan has been prepared from preliminary survey plan (SP302893) and engineering plans provided on the 08/08/18 by Premise Engineering.

Lot 732 is restricted to the depth of 15.24 metres below the surface, as defined on the plan M3172.

Development Approval for reconfiguration of a lot and material change of use (Application 1489/2017/CA) have been approved by Ipswich City Council (25/09/2017).

Development Approval has been granted for Operational Works for the proposed lot (17.09.18 - ref: OW - 6005/2018)

Scale 1:200 – Lengths are in Metres.

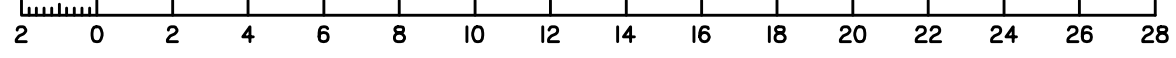

No.	by	Date	Description
A	TBG	05/10/18	Original Issue



Saunders Havill Group Pty Ltd ABN 24 144 972 949  
 Brisbane • Emerald • Rockhampton  
 head office 9 Thompson St Bowen Hills Q 4006  
 phone 1300 123 SHG web www.saundershavill.com

■ surveying ■ town planning ■ urban design ■ environmental management ■ landscape architecture

This Disclosure Plan is prepared for the sole purpose of satisfying the Disclosure requirements of the Land Sales Act and SHOULD NOT be used for any other purpose, particularly As-constructed purposes. This information is compiled from Design plans only, unless otherwise stated, and therefore is subject to final survey and construction of operational works.

**Disclosure Plan for Proposed Lot 732 (Restricted) on SP302893**

Described as part of Lot 860 (Restricted) on SP300831  
 Existing Title Reference: 51156557

Locality of Redbank Plains (Ipswich City Council)

Level Datum: AHD der.  
 Origin of Levels: PM203226  
 RL of Origin: 75.312  
 Contour Interval: 0.25m  
 Scale @A3 1: 200  
 Dwg No. 8655 S 08 DP A\_732



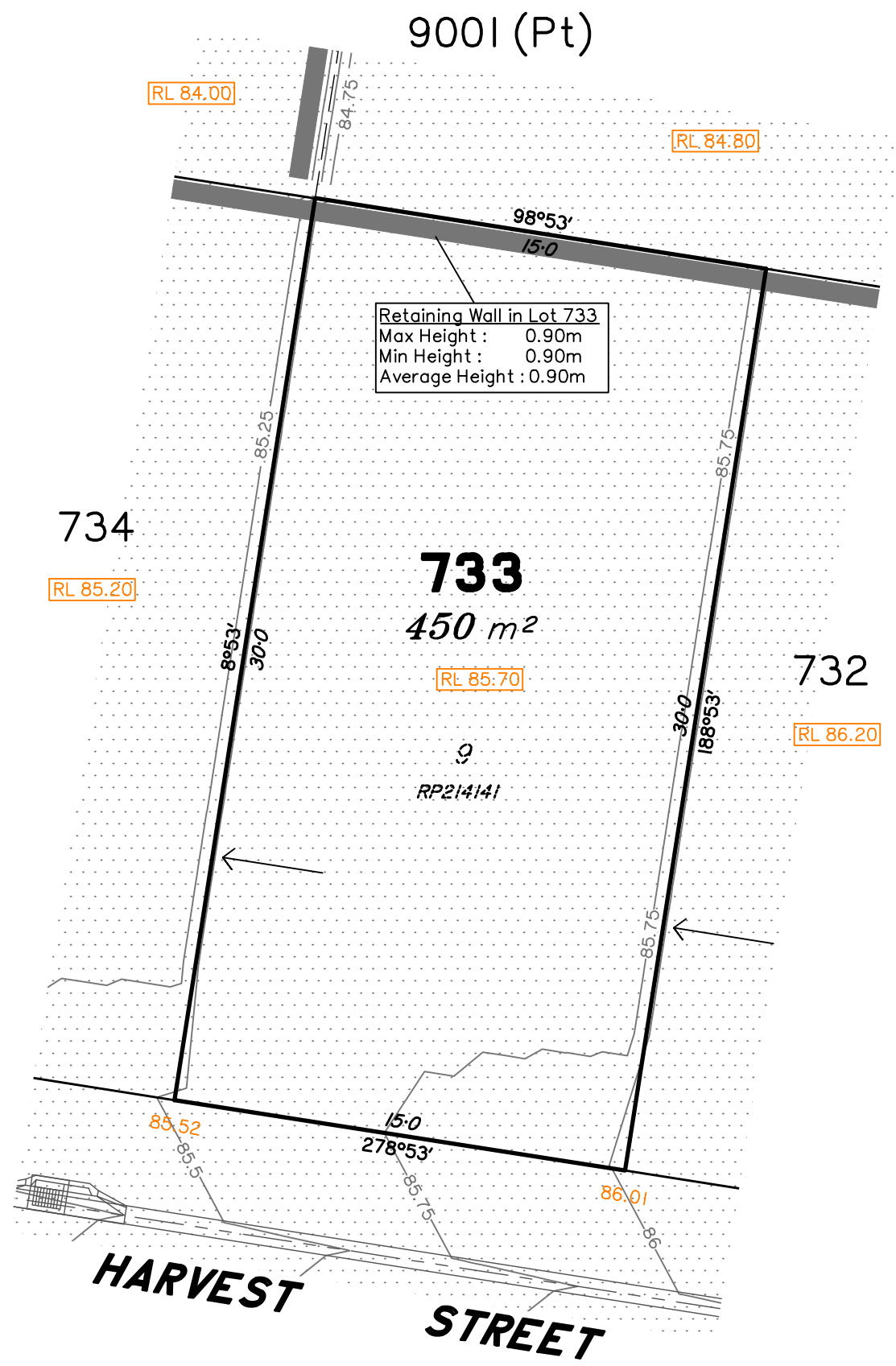

**LEGEND**

- Area of Fill
  - Area of Cut
  - Design Contours
  - Zero Lot Boundary
  - Retaining Wall
  - 38.78 Finished Surface Design Level
  - RL 38.78 Finished Pad Design Level
  - 1.0 Depth of Fill
- (Not all items in this legend may be relevant to the lot shown hereon)

**NOTES**

This plan has been prepared from preliminary survey plan (SP302893) and engineering plans provided on the 08/08/18 by Premise Engineering.

Lot 733 is restricted to the depth of 15.24 metres below the surface, as defined on the plan M3172.

Development Approval for reconfiguration of a lot and material change of use (Application 1489/2017/CA) have been approved by Ipswich City Council (25/09/2017).

Development Approval has been granted for Operational Works for the proposed lot (17.09.18 - ref: OW - 6005/2018)

Scale 1:200 – Lengths are in Metres.

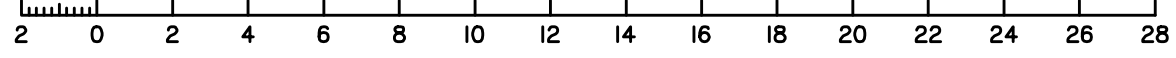

No.	by	Date	Description
A	TBG	05/10/18	Original Issue

**saunders havill group**  
 Saunders Havill Group Pty Ltd ABN 24 144 972 949  
 Brisbane • Emerald • Rockhampton  
 head office 9 Thompson St Bowen Hills Q 4006  
 phone 1300 123 SHG web www.saundershavill.com  
 ■ surveying ■ town planning ■ urban design ■ environmental management ■ landscape architecture

This Disclosure Plan is prepared for the sole purpose of satisfying the Disclosure requirements of the Land Sales Act and SHOULD NOT be used for any other purpose, particularly As-constructed purposes. This information is compiled from Design plans only, unless otherwise stated, and therefore is subject to final survey and construction of operational works.

**Disclosure Plan for Proposed Lot 733 (Restricted) on SP302893**  
 Described as part of Lot 860 (Restricted) on SP300831  
 Existing Title Reference: 51156557  
 Locality of Redbank Plains (Ipswich City Council)

Level Datum: AHD der.  
 Origin of Levels: PM203226  
 RL of Origin: 75.312  
 Contour Interval: 0.25m  
 Scale @A3 1: 200  
 Dwg No. 8655 S 08 DP A\_733

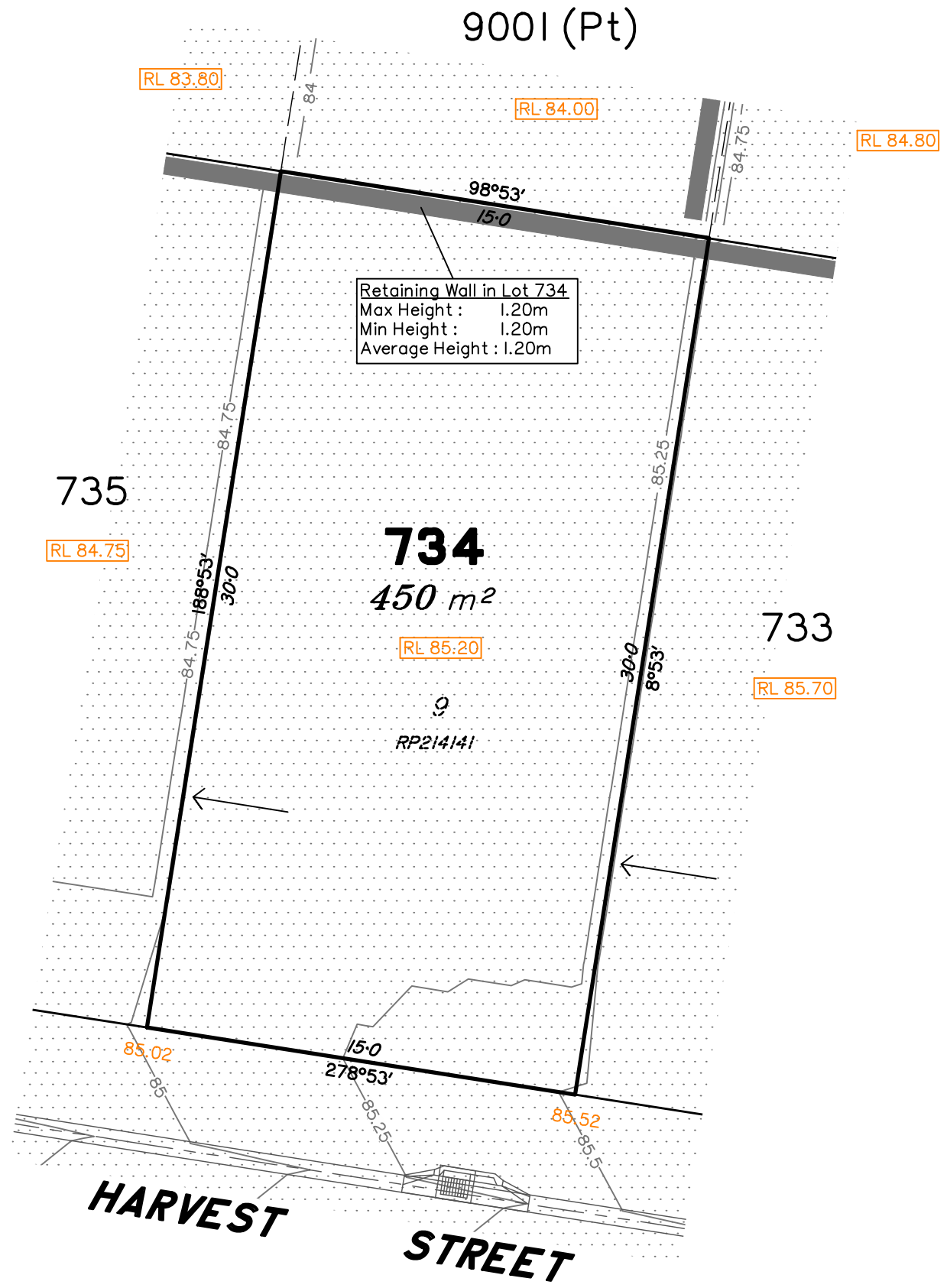

Retaining Wall in Lot 734  
 Max Height : 1.20m  
 Min Height : 1.20m  
 Average Height : 1.20m

**LEGEND**

- Area of Fill
- Area of Cut
- Design Contours
- Zero Lot Boundary
- Retaining Wall
- 38.78 Finished Surface Design Level
- RL 38.78 Finished Pad Design Level
- 1.0 Depth of Fill

(Not all items in this legend may be relevant to the lot shown hereon)

**NOTES**

This plan has been prepared from preliminary survey plan (SP302893) and engineering plans and mark-ups provided on the 08/08/18 & 03/10/18 by Premise Engineering.

Lot 734 is restricted to the depth of 15.24 metres below the surface, as defined on the plan M3172.

Development Approval for reconfiguration of a lot and material change of use (Application 1489/2017/CA) have been approved by Ipswich City Council (25/09/2017).

Development Approval has been granted for Operational Works for the proposed lot (17.09.18 - ref: OW - 6005/2018)

Scale 1:200 – Lengths are in Metres.

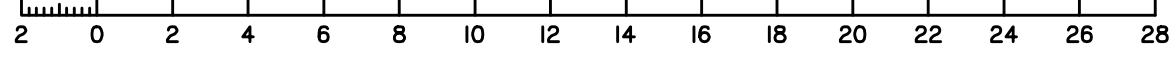

No.	by	Date	Description
A	TBG	05/10/18	Original Issue

**saunders havill group**  
 Saunders Havill Group Pty Ltd ABN 24 144 972 949  
 Brisbane • Emerald • Rockhampton  
 head office 9 Thompson St Bowen Hills Q 4006  
 phone 1300 123 SHG web www.saundershavill.com  
 ■ surveying ■ town planning ■ urban design ■ environmental management ■ landscape architecture

This Disclosure Plan is prepared for the sole purpose of satisfying the Disclosure requirements of the Land Sales Act and SHOULD NOT be used for any other purpose, particularly As-constructed purposes. This information is compiled from Design plans only, unless otherwise stated, and therefore is subject to final survey and construction of operational works.

**Disclosure Plan for Proposed Lot 734 (Restricted) on SP302893**  
 Described as part of Lot 860 (Restricted) on SP300831  
 Existing Title Reference: 51156557  
 Locality of Redbank Plains (Ipswich City Council)

Level Datum: AHD der.  
 Origin of Levels: PM203226  
 RL of Origin: 75.312  
 Contour Interval: 0.25m  
 Scale @A3 1: 200  
 Dwg No. 8655 S 08 DP A\_734

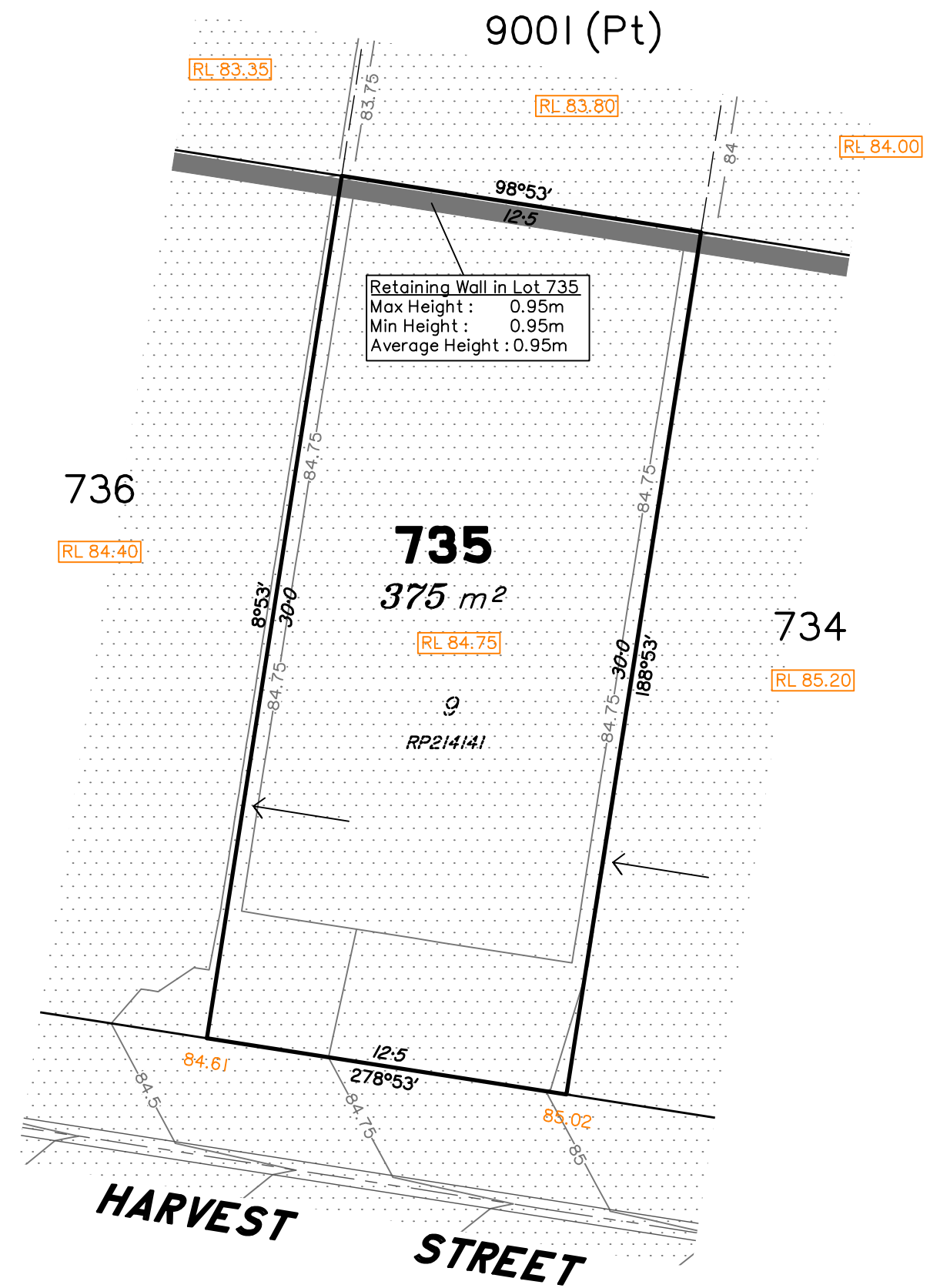

Scale 1:200 – Lengths are in Metres.

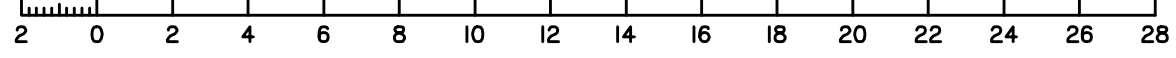

**LEGEND**

- Area of Fill
- Area of Cut
- Design Contours
- Zero Lot Boundary
- Retaining Wall
- 38.78 Finished Surface Design Level
- RL 38.78 Finished Pad Design Level
- 1.0 Depth of Fill

(Not all items in this legend may be relevant to the lot shown hereon)

**NOTES**

This plan has been prepared from preliminary survey plan (SP302893) and engineering plans provided on the 08/08/18 by Premise Engineering.

Lot 735 is restricted to the depth of 15.24 metres below the surface, as defined on the plan M3172.

Development Approval for reconfiguration of a lot and material change of use (Application 1489/2017/CA) have been approved by Ipswich City Council (25/09/2017).

Development Approval has been granted for Operational Works for the proposed lot (17.09.18 - ref: OW - 6005/2018)

No.	by	Date	Description
A	TBG	05/10/18	Original Issue

**saunders havill group**  
 Saunders Havill Group Pty Ltd ABN 24 144 972 949  
 Brisbane • Emerald • Rockhampton  
 head office 9 Thompson St Bowen Hills Q 4006  
 phone 1300 123 SHG web www.saundershavill.com  
 ■ surveying ■ town planning ■ urban design ■ environmental management ■ landscape architecture

This Disclosure Plan is prepared for the sole purpose of satisfying the Disclosure requirements of the Land Sales Act and SHOULD NOT be used for any other purpose, particularly As-constructed purposes. This information is compiled from Design plans only, unless otherwise stated, and therefore is subject to final survey and construction of operational works.

**Disclosure Plan for Proposed Lot 735 (Restricted) on SP302893**  
 Described as part of Lot 860 (Restricted) on SP300831  
 Existing Title Reference: 51156557  
 Locality of Redbank Plains (Ipswich City Council)

Level Datum: AHD der.  
 Origin of Levels: PM203226  
 RL of Origin: 75.312  
 Contour Interval: 0.25m  
 Scale @A3 1: 200  
 Dwg No. 8655 S 08 DP A\_735



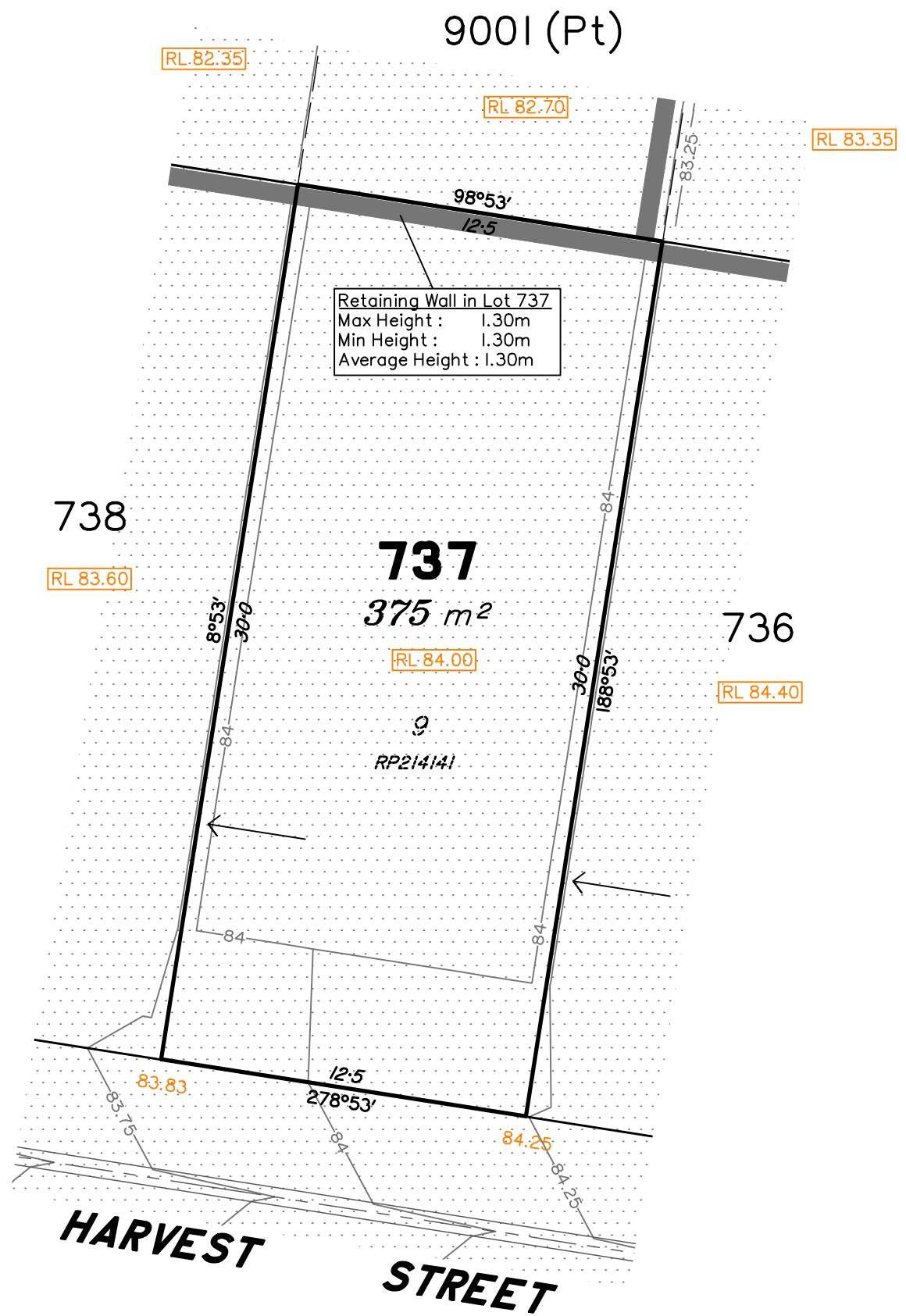

**LEGEND**

- Area of Fill
- Area of Cut
- Design Contours
- Zero Lot Boundary
- Retaining Wall
- 38.78 Finished Surface Design Level
- RL 38.78 Finished Pad Design Level
- 1.0 Depth of Fill

(Not all items in this legend may be relevant to the lot shown hereon)

**NOTES**

This plan has been prepared from preliminary survey plan (SP302893) and engineering plans provided on the 08/08/18 by Premise Engineering.

Lot 737 is restricted to the depth of 15.24 metres below the surface, as defined on the plan M3172.

Development Approval for reconfiguration of a lot and material change of use (Application 1489/2017/CA) have been approved by Ipswich City Council (25/09/2017).

Development Approval has been granted for Operational Works for the proposed lot (17.09.18 - ref: OW - 6005/2018)

Scale 1:200 – Lengths are in Metres.

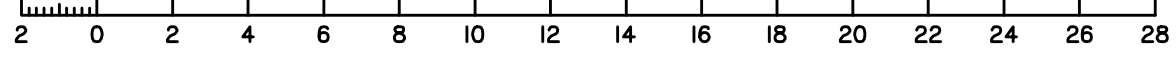

No.	by	Date	Description
A	TBG	05/10/18	Original Issue



Saunders Havill Group Pty Ltd ABN 24 144 972 949  
 Brisbane • Emerald • Rockhampton  
 head office 9 Thompson St Bowen Hills Q 4006  
 phone 1300 123 SHG web www.saundershavill.com

■ surveying ■ town planning ■ urban design ■ environmental management ■ landscape architecture

This Disclosure Plan is prepared for the sole purpose of satisfying the Disclosure requirements of the Land Sales Act and SHOULD NOT be used for any other purpose, particularly As-constructed purposes. This information is compiled from Design plans only, unless otherwise stated, and therefore is subject to final survey and construction of operational works.

**Disclosure Plan for Proposed Lot 737 (Restricted) on SP302893**

Described as part of Lot 860 (Restricted) on SP300831  
 Existing Title Reference: 51156557

Locality of Redbank Plains (Ipswich City Council)

Level Datum: AHD der.  
 Origin of Levels: PM203226  
 RL of Origin: 75.312  
 Contour Interval: 0.25m  
 Scale @A3 1: 200  
 Dwg No. 8655 S 08 DP A\_737

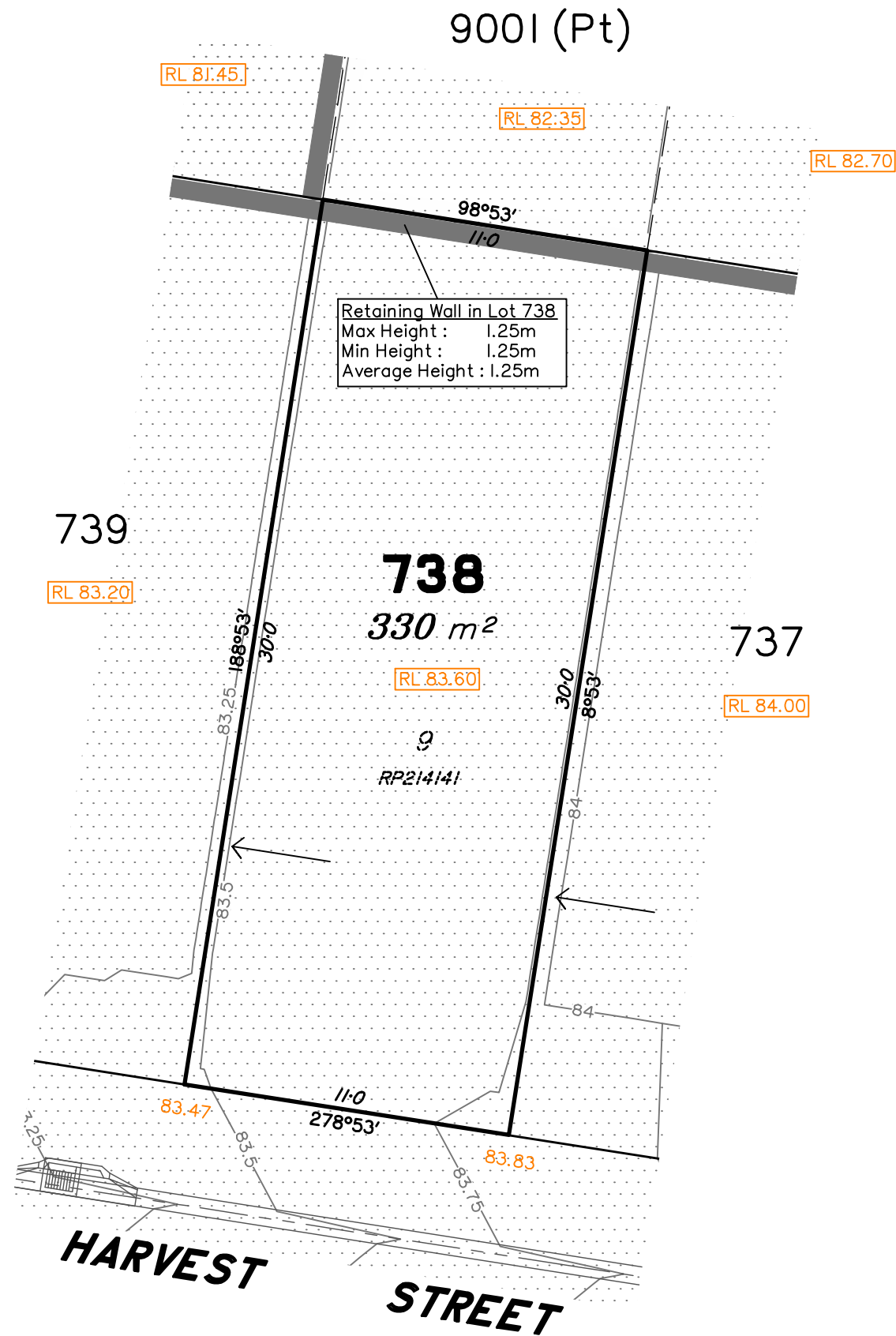

Scale 1:200 – Lengths are in Metres.

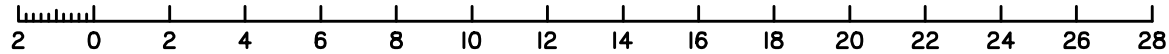

**LEGEND**

- Area of Fill
- Area of Cut
- Design Contours
- ← Zero Lot Boundary
- Retaining Wall
- 38.78 Finished Surface Design Level
- RL 38.78 Finished Pad Design Level
- 1.0 Depth of Fill

(Not all items in this legend may be relevant to the lot shown hereon)

**NOTES**

This plan has been prepared from preliminary survey plan (SP302893) and engineering plans provided on the 08/08/18 by Premise Engineering.

Lot 738 is restricted to the depth of 15.24 metres below the surface, as defined on the plan M3172.

Development Approval for reconfiguration of a lot and material change of use (Application 1489/2017/CA) have been approved by Ipswich City Council (25/09/2017).

Development Approval has been granted for Operational Works for the proposed lot (17.09.18 - ref: OW - 6005/2018)

No.	by	Date	Description
A	TBG	05/10/18	Original Issue



Saunders Havill Group Pty Ltd ABN 24 144 972 949  
 Brisbane • Emerald • Rockhampton  
 head office 9 Thompson St Bowen Hills Q 4006  
 phone 1300 123 SHG web www.saundershavill.com

• surveying • town planning • urban design • environmental management • landscape architecture

This Disclosure Plan is prepared for the sole purpose of satisfying the Disclosure requirements of the Land Sales Act and SHOULD NOT be used for any other purpose, particularly As-constructed purposes. This information is compiled from Design plans only, unless otherwise stated, and therefore is subject to final survey and construction of operational works.

**Disclosure Plan for Proposed Lot 738 (Restricted) on SP302893**

Described as part of Lot 860 (Restricted) on SP300831  
 Existing Title Reference: 51156557

Locality of Redbank Plains (Ipswich City Council)

Level Datum: AHD der.  
 Origin of Levels: PM203226  
 RL of Origin: 75.312  
 Contour Interval: 0.25m  
 Scale @A3 1: 200  
 Dwg No. 8655 S 08 DP A\_738



9001 (Pt)

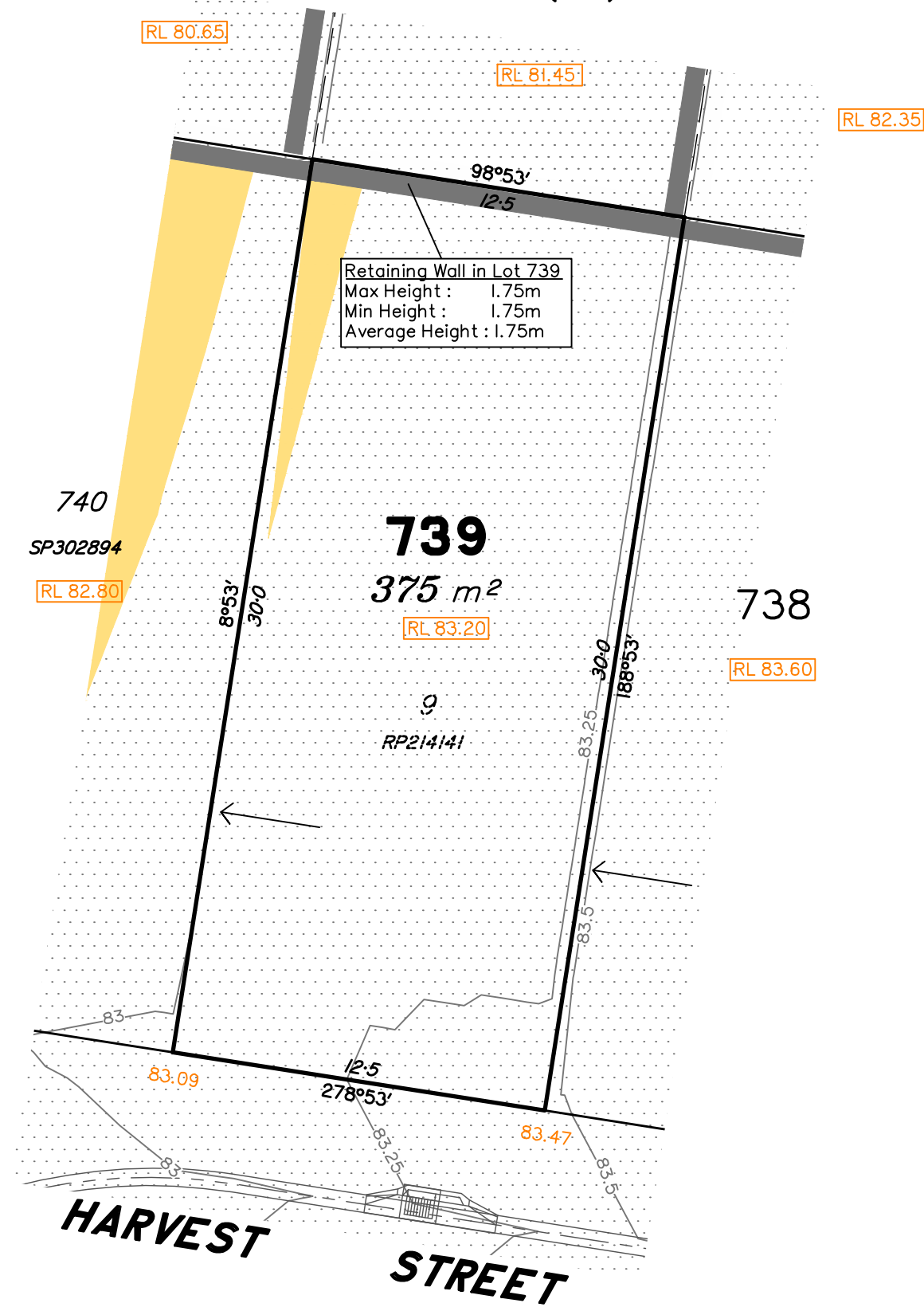

Retaining Wall in Lot 739  
 Max Height : 1.75m  
 Min Height : 1.75m  
 Average Height : 1.75m

**LEGEND**

- Area of Fill
- Area of Cut
- Design Contours
- Zero Lot Boundary
- Retaining Wall
- 38.78 Finished Surface Design Level
- RL 38.78 Finished Pad Design Level
- 1.0 Depth of Fill

(Not all items in this legend may be relevant to the lot shown hereon)

**NOTES**

This plan has been prepared from preliminary survey plan (SP302893) and engineering plans and mark-ups provided on the 08/08/18 & 03/10/18 by Premise Engineering & field survey conducted by Saunders Havill in July 2019.

Lot 739 is restricted to the depth of 15.24 metres below the surface, as defined on the plan M3172.

Development Approval for reconfiguration of a lot and material change of use (Application 1489/2017/CA) have been approved by Ipswich City Council (25/09/2017).

Development Approval has been granted for Operational Works for the proposed lot (17.09.18 - ref: OW - 6005/2018)

Parts of Lot 739 are subject to fill less than 0.25m in depth.

All fill shall be placed and compacted in a controlled manner so that Level 1 level of responsibility may be achieved and certified as per AS3798-2007.

No.	by	Date	Description
A	TBG	05/10/18	Original Issue
B	TBG	08/08/19	Ret Wall on western boundary removed

Scale 1:200 – Lengths are in Metres.

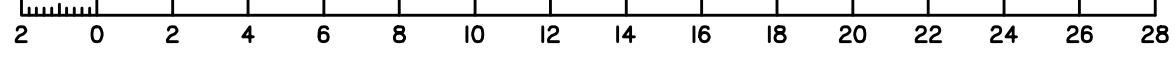

**saunders havill group**  
 Saunders Havill Group Pty Ltd ABN 24 144 972 949  
 Brisbane • Emerald • Rockhampton  
 head office 9 Thompson St Bowen Hills Q 4006  
 phone 1300 123 SHG web www.saundershavill.com  
 • surveying • town planning • urban design • environmental management • landscape architecture

This Disclosure Plan is prepared for the sole purpose of satisfying the Disclosure requirements of the Land Sales Act and SHOULD NOT be used for any other purpose, particularly As-constructed purposes. This information is compiled from Design plans only, unless otherwise stated, and therefore is subject to final survey and construction of operational works.

**Disclosure Plan for Proposed Lot 739 (Restricted) on SP302893**  
 Described as part of Lot 860 (Restricted) on SP300831  
 Existing Title Reference: 51156557  
 Locality of Redbank Plains (Ipswich City Council)

Level Datum: AHD der.  
 Origin of Levels: PM203226  
 RL of Origin: 75.312  
 Contour Interval: 0.25m  
 Scale @A3 1: 200  
 Dwg No. 8655 S 08 DP B\_739

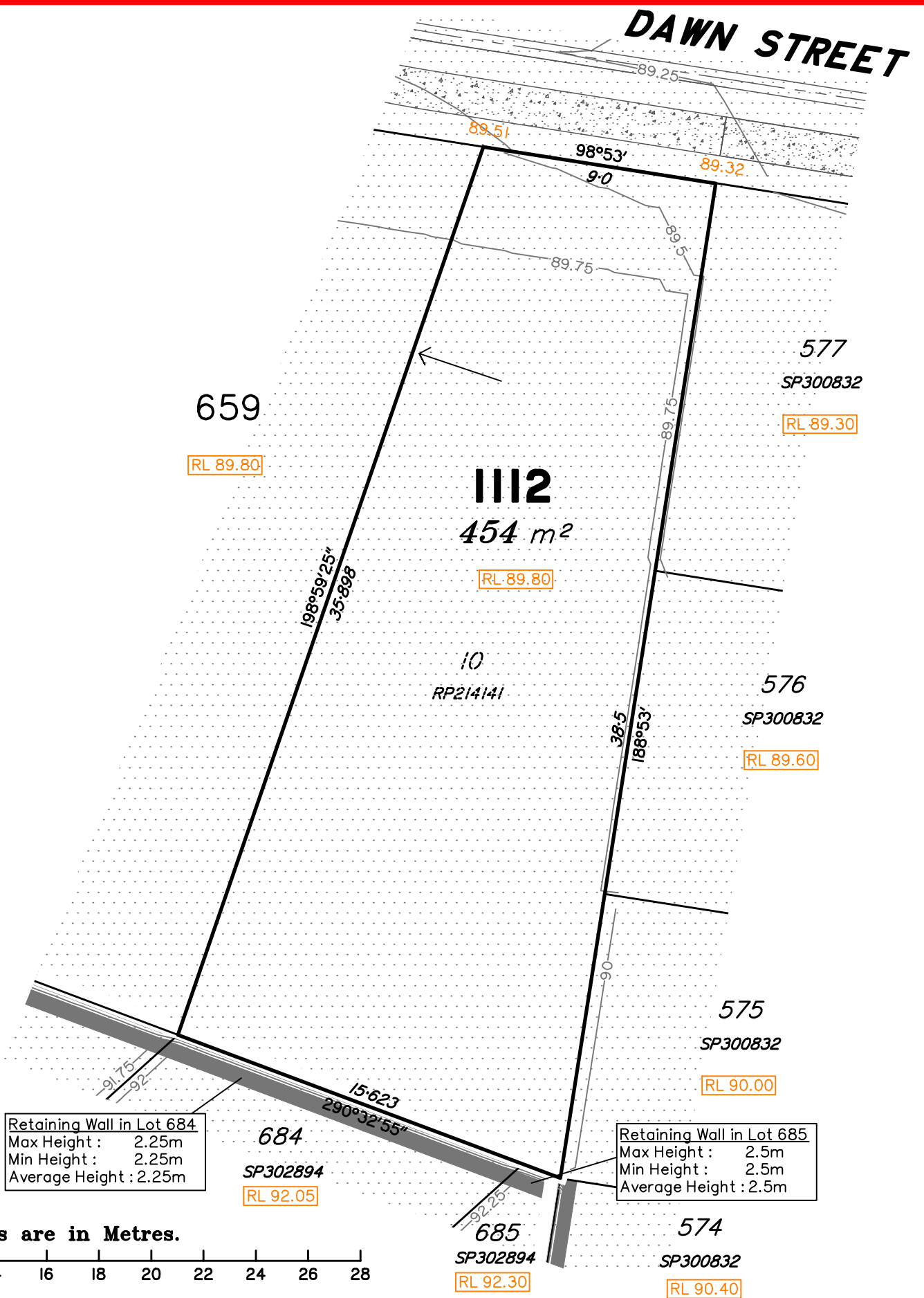

**LEGEND**

- Area of Fill
- Area of Cut
- Design Contours
- Zero Lot Boundary
- Retaining Wall
- 38.78 Finished Surface Design Level
- RL 38.78 Finished Pad Design Level
- 1.0 Depth of Fill

(Not all items in this legend may be relevant to the lot shown hereon)

**NOTES**

This plan has been prepared from preliminary survey plan (SP302893) and engineering plans provided on the 08/08/18 & 14/01/18 by Premise Engineering.

Lot 1112 is restricted to the depth of 15.24 metres below the surface, as defined on the plan M3172.

Development Approval for reconfiguration of a lot and material change of use (Application 1489/2017/CA) have been approved by Ipswich City Council (25/09/2017).

Development Approval has been granted for Operational Works for the proposed lot (17.09.18 - ref: OW - 6005/2018)

Retaining Wall in Lot 684  
 Max Height : 2.25m  
 Min Height : 2.25m  
 Average Height : 2.25m

Retaining Wall in Lot 685  
 Max Height : 2.5m  
 Min Height : 2.5m  
 Average Height : 2.5m

Scale 1:200 – Lengths are in Metres.

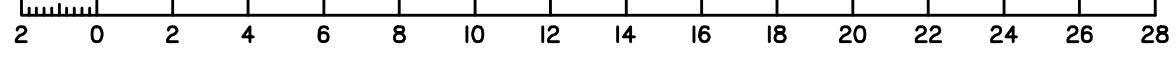

No.	by	Date	Description
A	TBG	14/01/19	Original Issue

**saunders havill group**

Saunders Havill Group Pty Ltd ABN 24 144 972 949  
 Brisbane • Emerald • Rockhampton  
 head office 9 Thompson St Bowen Hills Q 4006  
 phone 1300 123 SHG web www.saundershavill.com

• surveying • town planning • urban design • environmental management • landscape architecture

This Disclosure Plan is prepared for the sole purpose of satisfying the Disclosure requirements of the Land Sales Act and SHOULD NOT be used for any other purpose, particularly As-constructed purposes. This information is compiled from Design plans only, unless otherwise stated, and therefore is subject to final survey and construction of operational works.

**Disclosure Plan for Proposed Lot 1112 (Restricted) on SP302893**  
 Described as part of Lot 860 (Restricted) on SP300831  
 Existing Title Reference: 51156557  
 Locality of Redbank Plains (Ipswich City Council)

Level Datum: AHD der.  
 Origin of Levels: PM203226  
 RL of Origin: 75.312  
 Contour Interval: 0.25m  
 Scale @A3 1: 200  
 Dwg No. 8655 S 08 DP A\_1112