

NOTES

This plan has been prepared from As Constructed Surveys of sewerage and water services only. No other services have been located.

Before starting any demolition, excavation or construction on the site, the relevant person should make an independent and updated enquiry of "dial before you dig" and any relevant service providers to ascertain the existence of further services (if any) and the accurate location of those not able to have been surveyed at the time of preparing this plan.

* No responsibility can be accepted by Saunders Havill Group Pty Ltd, for any damage caused to any underground service or any loss or injury so suffered if enquiry and verification have not been completed in accordance with this note.

** This note is an integral part of this plan/data. Reproduction of this plan or any part of it without this note being included in full will render the information shown on such reproduction invalid and not suitable for use.

LEGEND



SYMBOLS **ABBREVIATIONS**

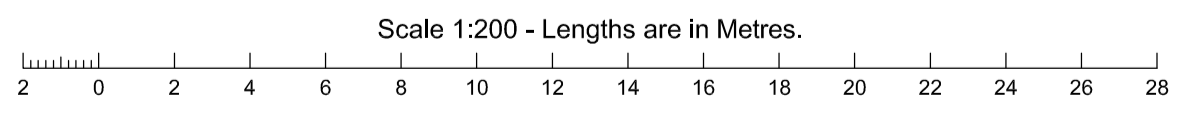
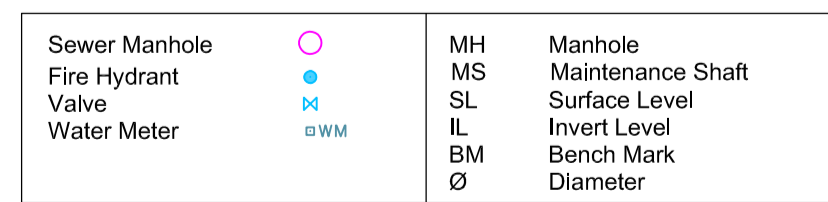

saunders havill group
 Saunders Havill Group Pty Ltd ABN 24 144 972 949
 Brisbane • Emerald • Rockhampton
 head office 9 Thompson St Bowen Hills Q 4006
 phone 1300 123 SHG web www.saundershavill.com

• surveying • town planning • urban design • environmental management • landscape architecture

No.	Drawn	Date	Description	Checked
A	TG	05.09.17	ORIGINAL ISSUE	MK

Plan of **As Constructed Sewer Sketch (Sheet 1 of 2)**

Project **EDENS CROSSING - STAGE 1**

Client **Peet Pty Ltd**

Surveyed	Date	Lot Description
CU	Aug 2017	SP292394

Level Datum: AHD der.

Origin of Levels: PM203098
 RL of Origin: 66.641

Contour Interval:

Locality: Redbank Plains
 Local Government: Ipswich City Council

surveying

Scale @A1 1:200
 @A3 1:400

Dwg No. **8459 S 02 SE A**



900
SP264172

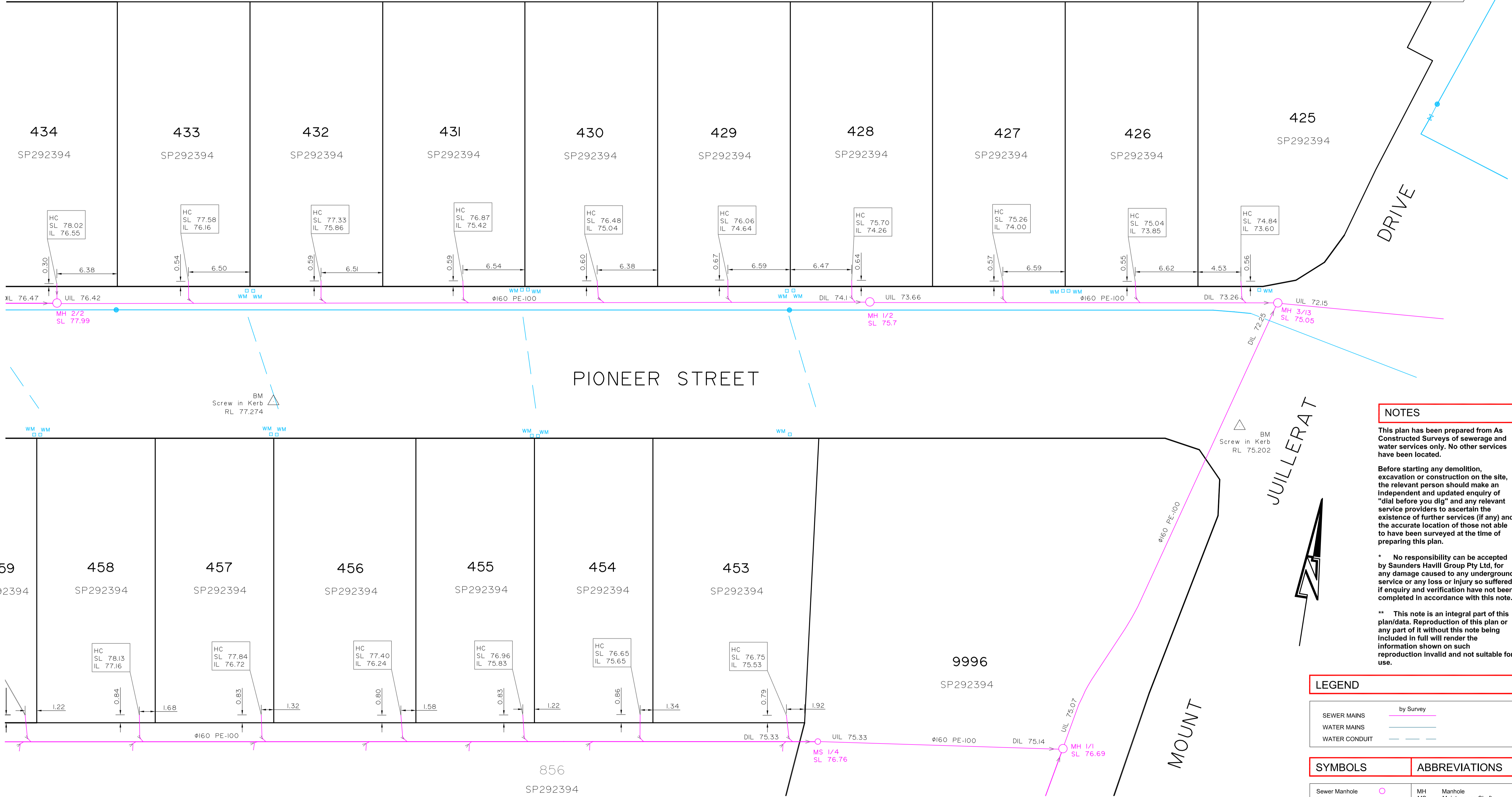

NOTES

This plan has been prepared from As Constructed Surveys of sewerage and water services only. No other services have been located.

Before starting any demolition, excavation or construction on the site, the relevant person should make an independent and updated enquiry of "dial before you dig" and any relevant service providers to ascertain the existence of further services (if any) and the accurate location of those not able to have been surveyed at the time of preparing this plan.

* No responsibility can be accepted by Saunders Havill Group Pty Ltd, for any damage caused to any underground service or any loss or injury so suffered if enquiry and verification have not been completed in accordance with this note.

** This note is an integral part of this plan/data. Reproduction of this plan or any part of it without this note being included in full will render the information shown on such reproduction invalid and not suitable for use.

LEGEND

SEWER MAINS	by Survey
WATER MAINS	
WATER CONDUIT	

SYMBOLS **ABBREVIATIONS**

Sewer Manhole	○	MH	Manhole
Fire Hydrant	●	MS	Maintenance Shaft
Valve	⊕	SL	Surface Level
Water Meter	⊗	IL	Invert Level
	□ WM	BM	Bench Mark
	∅	∅	Diameter

SH saunders havill group
 Saunders Havill Group Pty Ltd ABN 24 144 972 949
 Brisbane • Emerald • Rockhampton
 head office 9 Thompson St Bowen Hills Q 4006
 phone 1300 123 SHG web www.saundershavill.com
 • surveying • town planning • urban design • environmental management • landscape architecture

No.	Drawn	Date	Description	Checked
A	TG	05.09.17	ORIGINAL ISSUE	MK

Plan of **As Constructed Sewer Sketch (Sheet 2 of 2)**
 Project **EDENS CROSSING - STAGE 1**
 Client **Peet Pty Ltd**

Surveyed	Date	Lot Description
CU	Aug 2017	SP292394
Level Datum: AHD der.		Locality: Redbank Plains
Origin of Levels: PM203098		Local Government:
RL of Origin: 66.641		Ipswich City Council
Contour Interval:		

surveying
 Scale @A1 1:200
 @A3 1:400
 Dwg No. **8459 S 02 SE A**