

LEGEND:

- EXISTING CONTOURS (500mm INTERVALS)
- DESIGN CONTOURS (500mm INTERVALS)
- DESIGN LEVELS
TW - TOP OF WALL
BW - BOTTOM OF WALL
- LOT BENCH LEVEL
- DESIGN SURFACE LEVEL
- RETAINING WALL
- EXISTING RETAINING WALL
- FUTURE RETAINING WALL
- APC EASY WALL BLOCK AND CAP OR SIMILAR
- 90° AG DRAIN
- FUTURE AG DRAIN BY BUILDER
- DRIVEWAY LOCATION (D= DOUBLE DRIVE 7.0m,
S= SINGLE DRIVE 4.0m, (W= WIDE DRIVE 9.5m)
(LOCATED 0.5m/1.0m FROM BOUNDARY)
- RETAINING WALL / BATTER HEIGHT
- DRAINAGE SWALE
- EXTENT OF FILL (COMPACTED UNDER
LEVEL 1 GITA SUPERVISION)

I:\2009\03Mar2009\C080322-BluestoneLand\Drawings\WGA090322-7C-DR-CV-0020.dwg, D: 22/05/2025 10:07 AM, gtr001shy

When sheet printed full size, the scale bar is 100mm.
0 50 100mm

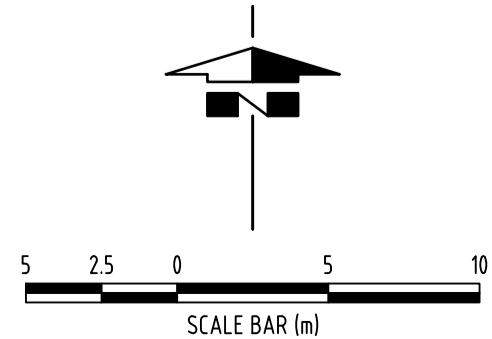

Client

Level 3,
70 Hindmarsh Square,
Adelaide, SA 5000

Telephone 1800 790 700
Facsimile (08) 8261 0700
Web peet.com.au

FOR APPROVAL
NOT FOR CONSTRUCTION

REV.	DATE	DESCRIPTION	DRAFT	ENG.	CHKD
A	11.03.25	FIRST CUT	GPB	SJA	
B	31.03.25	PRELIMINARY ISSUE	GPB	SJA	
C	12.05.25	PRELIMINARY ISSUE	GPB	SJA	
D	22.05.25	APPROVAL ISSUE	GPB	SJA	

WGA

PEET LIMITED
BLUESTONE LAND DIVISION
MT. BARKER - STAGE 7C
LOT BENCHING PLAN 1 OF 3

A1	DOCUMENT NUMBER	Project Number	Sheet No.	Rev.
Design GPB	Drawn GPB	WGA090322-7C-DR-CV-0020		D

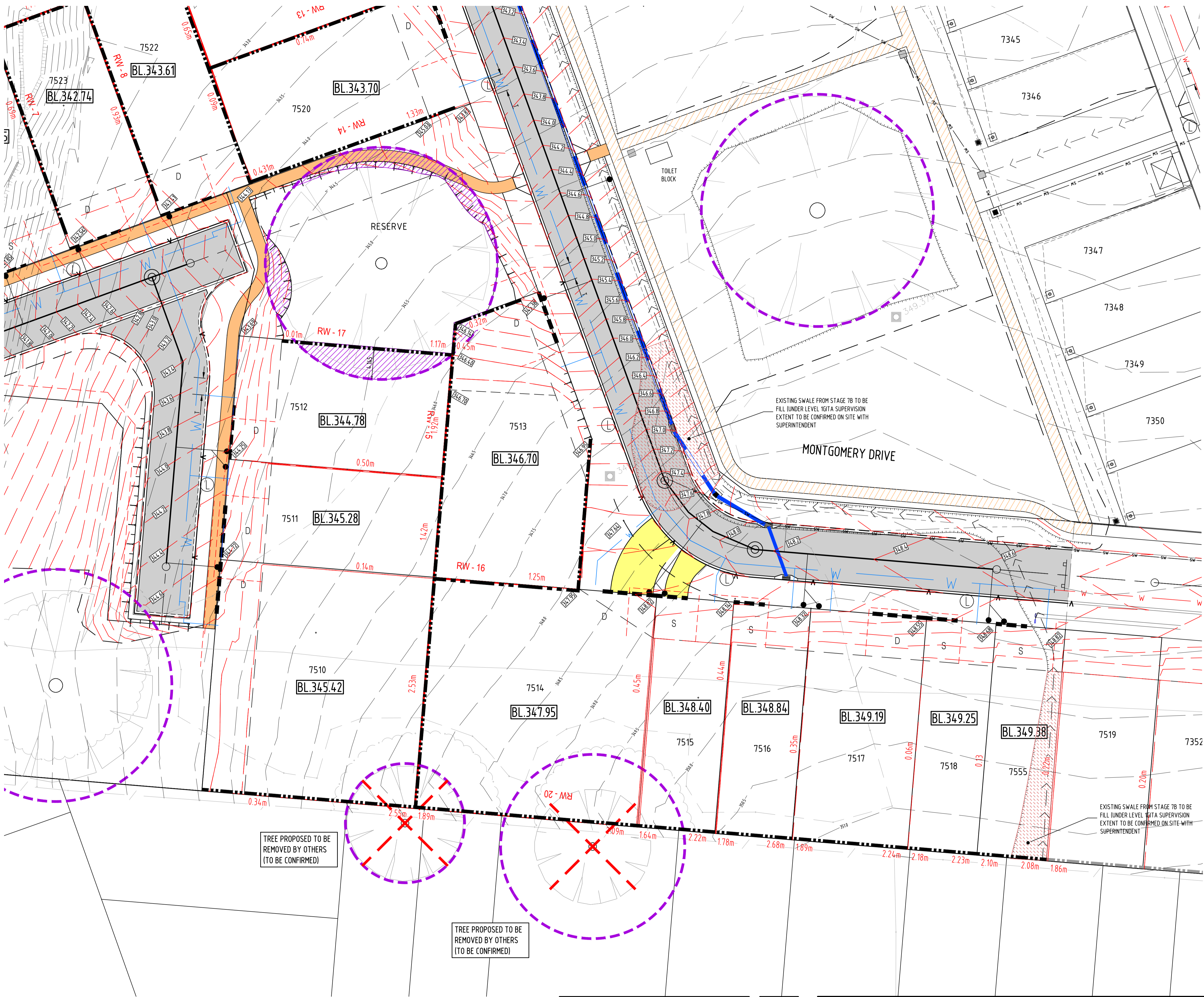

- EXISTING CONTOURS (500mm INTERVALS)
- DESIGN CONTOURS (500mm INTERVALS)
- DESIGN LEVELS
TW - TOP OF WALL
BW - BOTTOM OF WALL
- LOT BENCH LEVEL
- DESIGN SURFACE LEVEL
- RETAINING WALL
- EXISTING RETAINING WALL
- FUTURE RETAINING WALL
- APC - EASY WALL BLOCK AND CAP OR SIMILAR.
- 90° AG DRAIN
- FUTURE AG DRAIN BY BUILDER
- DRIVEWAY LOCATION (D - DOUBLE DRIVE 7.0m,
S - SINGLE DRIVE 4.0m, W - WIDE DRIVE 9.5m)
(LOCATED 0.5m/1.0m FROM BOUNDARY)
- RETAINING WALL / BATTER HEIGHT
2.00m
- DRAINAGE SWALE
- EXTENT OF FILL (COMPACTED UNDER
LEVEL 1GITA SUPERVISION)

I:\2009\03\Mar2009\0308022-BluestoneLandDivision\Stage7\CD\Drawings\WGA090322-7C-DR-CV-0022.dwg, E: 28/05/2025 2:29 PM, gbrackley

When sheet printed full size, the scale bar is 100mm.

TREE PROPOSED TO BE
REMOVED BY OTHERS
(TO BE CONFIRMED)

TREE PROPOSED TO BE
REMOVED BY OTHERS
(TO BE CONFIRMED)

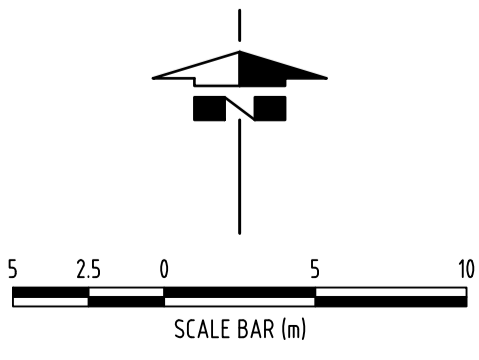

Client

Level 3,
70 Hindmarsh Square,
Adelaide, SA 5000

Telephone 1800 790 700
Facsimile (08) 8261 0700
Web peet.com.au

FOR APPROVAL
NOT FOR CONSTRUCTION

REV.	DATE	DESCRIPTION	DRAFT	ENG.	CHKD
A	11.03.25	FIRST CUT	GPB	SJA	
B	25.03.25	PRELIMINARY ISSUE	GPB	SJA	
C	31.03.25	PRELIMINARY ISSUE	GPB	SJA	
D	12.05.25	PRELIMINARY ISSUE	GPB	SJA	
E	22.05.25	APPROVAL ISSUE	GPB	SJA	



PEET LIMITED
BLUESTONE LAND DIVISION
MT. BARKER - STAGE 7C
LOT BENCHING PLAN 3 OF 3

A1 DOCUMENT NUMBER
Project Number Sheet No. Rev.

Design Drawn
GPB GPB

WGA090322-7C-DR-CV-0022 **E**