

LEGEND	
	Area of Cut
	Area of Fill
	Design Contours
	1:2
	Batter Line / Change of Grade
	Retaining Wall
	RL XX.XX
	XX.XX
	Optional Built to Boundary Wall
	300mm x 300mm Subsurface Drainage Pit (indicative location)

(Not all items in this legend may be relevant to the lot shown on this plan)

NOTES

This plan has been prepared from preliminary survey plan (SP357496) and engineering data provided on the 11/08/2025 by KN Group Pty Ltd.

Development approval was granted for this subdivision by the Ipswich City Council on 18/06/2024.
(Application No: 9367/2022/CA).
For updates to this approval visit www.ipswich.qld.gov.au

At the time of publication of this plan, Ipswich City Council have not yet granted operational works approval for this lot (Application No: 5556/2025/OW)

All fill shall be placed and compacted in a controlled manner so that Level 1 level of responsibility may be achieved and certified as per AS3798-2007.



ISSUES				CHECKED AH
NO.	DRAWN	DATE	DESCRIPTION	
A	MS	02.09.2025	ORIGINAL ISSUE	

THIS DISCLOSURE PLAN IS PREPARED FOR THE SOLE PURPOSE OF SATISFYING THE DISCLOSURE REQUIREMENTS OF THE LAND SALES ACT AND **SHOULD NOT** BE USED FOR ANY OTHER PURPOSE, PARTICULARLY AS-CONSTRUCTED PURPOSES. THIS INFORMATION IS COMPILED FROM DESIGN PLANS ONLY, UNLESS OTHERWISE STATED, AND THEREFORE IS SUBJECT TO FINAL SURVEY AND CONSTRUCTION OF OPERATIONAL WORKS.

LEVEL DATUM:	AHD Der.
ORIGIN OF LEVELS:	PM203677
RL OF ORIGIN:	80.916
CONTOUR INTERVAL:	0.25m
SCALE	0 1 2 5m
1:200	

PLAN OF	
PROPOSED LOT 1333 ON SP357496	
DESCRIBED AS:	PART OF LOT 114 ON SP256133
EXISTING TITLE REFERENCE:	50945046
LOCALITY:	REDBANK PLAINS
LOCAL GOVERNMENT:	IPSWICH CITY COUNCIL

DRAWING TITLE	
DISCLOSURE PLAN	
DRAWING NO.	9919 S 14 DP A_1333





ISSUES				CHECKED AH	THIS DISCLOSURE PLAN IS PREPARED FOR THE SOLE PURPOSE OF SATISFYING THE DISCLOSURE REQUIREMENTS OF THE LAND SALES ACT AND SHOULD NOT BE USED FOR ANY OTHER PURPOSE. PARTICULARLY AS-CONSTRUCTED PURPOSES. THIS INFORMATION IS COMPILED FROM DESIGN PLANS ONLY, UNLESS OTHERWISE STATED, AND THEREFORE IS SUBJECT TO FINAL SURVEY AND CONSTRUCTION OF OPERATIONAL WORKS.
NO.	DRAWN	DATE	DESCRIPTION		
A	MS	02.09.2025	ORIGINAL ISSUE		

THIS DISCLOSURE PLAN IS PREPARED FOR THE
SOLE PURPOSE OF SATISFYING THE DISCLOSURE
REQUIREMENTS OF THE LAND SALES ACT AND
SHOULD NOT BE USED FOR ANY OTHER PURPOSE.
PARTICULARLY AS-CONSTRUCTED PURPOSES.
THIS INFORMATION IS COMPILED FROM DESIGN
PLANS ONLY, UNLESS OTHERWISE STATED, AND
THEREFORE IS SUBJECT TO FINAL SURVEY AND
CONSTRUCTION OF OPERATIONAL WORKS.

LEVEL DATUM:	AHD Der.
ORIGIN OF LEVELS:	PM203677
RL OF ORIGIN:	80.916
CONTOUR INTERVAL:	0.25m
SCALE	0 1 2 5m
1:200	

PLAN OF	
PROPOSED LOT 1334 ON SP357496	
DESCRIBED AS:	PART OF LOT 114 ON SP256133
EXISTING TITLE REFERENCE:	50945046
LOCALITY:	REDBANK PLAINS
LOCAL GOVERNMENT:	IPSWICH CITY COUNCIL

DRAWING TITLE
DISCLOSURE PLAN
DRAWING NO.
9919 S 14 DP A_1334

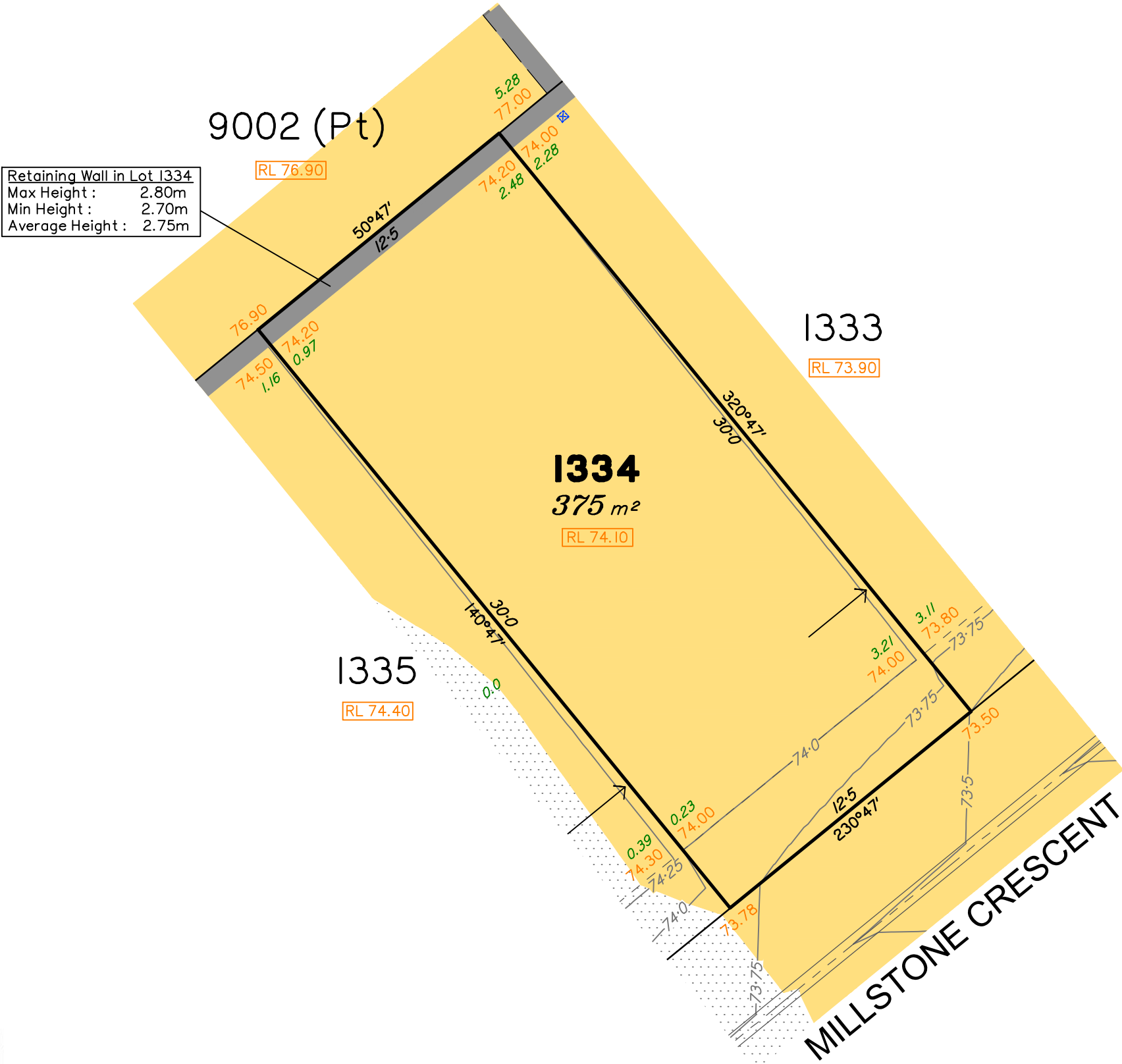

LEGEND	
	Area of Cut
	Area of Fill
	Design Contours
	Depth of Fill
	Batter Line / Change of Grade
	Retaining Wall
	Preferred Earthworks Pad Level
	Finished Surface Design Level
	Optional Built to Boundary Wall
	300mm x 300mm Subsurface Drainage Pit (indicative location)

(Not all items in this legend may be relevant to the lot shown on this plan)

NOTES

This plan has been prepared from preliminary survey plan (SP357496) and engineering data provided on the 11/08/2025 by KN Group Pty Ltd.

Development approval was granted for this subdivision by the Ipswich City Council on 18/06/2024.
(Application No: 9367/2022/CA).
For updates to this approval visit www.ipswich.qld.gov.au

At the time of publication of this plan, Ipswich City Council have not yet granted operational works approval for this lot (Application No: 5556/2025/OW)

All fill shall be placed and compacted in a controlled manner so that Level 1 level of responsibility may be achieved and certified as per AS3798-2007.

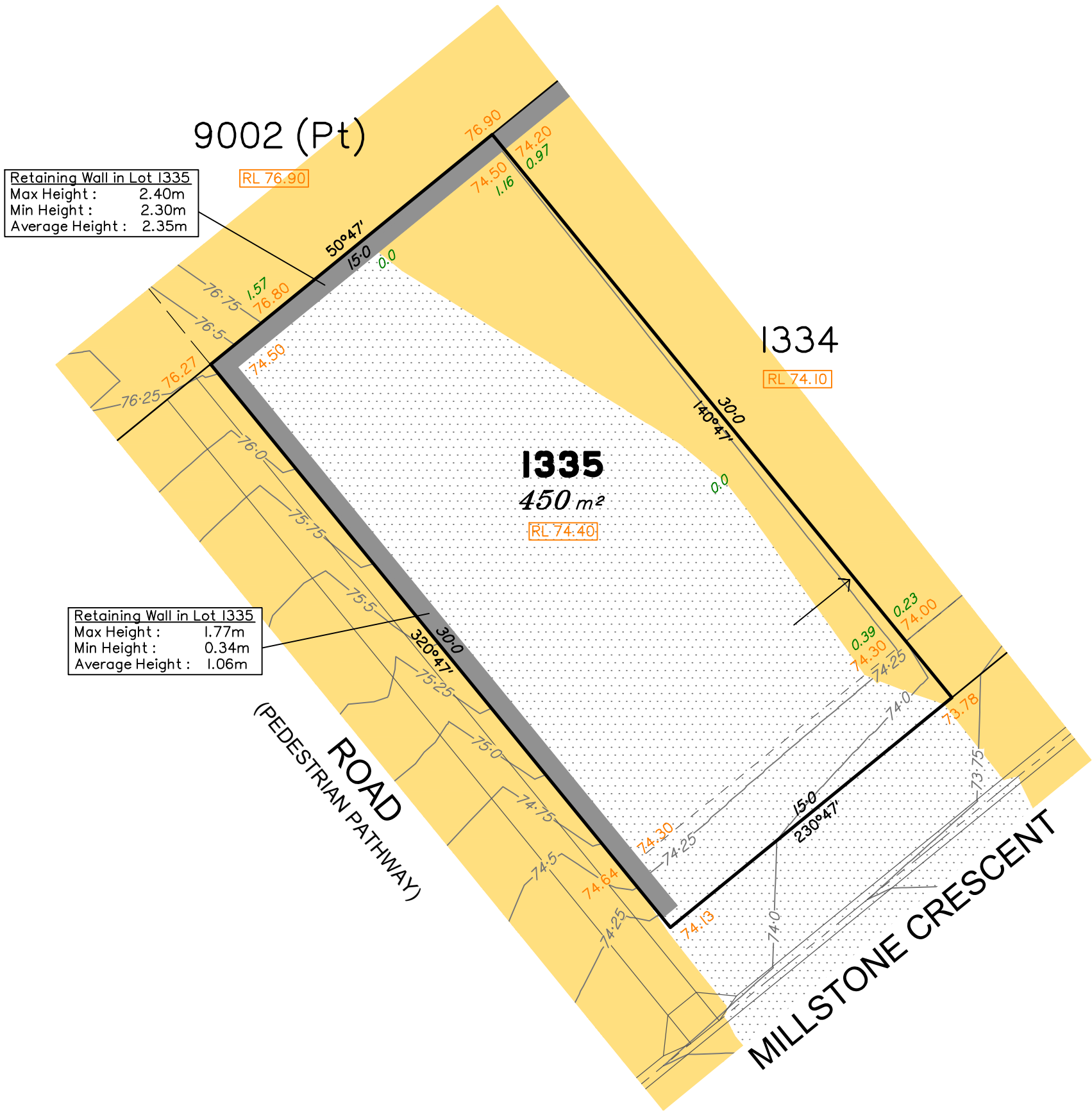

LEGEND	
	Area of Cut
	Area of Fill
	Design Contours
	Depth of Fill
	Batter Line / Change of Grade
	Retaining Wall
	Preferred Earthworks Pad Level
	Finished Surface Design Level
	Optional Built to Boundary Wall
	300mm x 300mm Subsurface Drainage Pit (indicative location)

(Not all items in this legend may be relevant to the lot shown on this plan)

NOTES
This plan has been prepared from preliminary survey plan (SP357496) and engineering data provided on the 11/08/2025 by KN Group Pty Ltd.
Development approval was granted for this subdivision by the Ipswich City Council on 18/06/2024. (Application No: 9367/2022/CA). For updates to this approval visit www.ipswich.qld.gov.au
At the time of publication of this plan, Ipswich City Council have not yet granted operational works approval for this lot (Application No: 5556/2025/OW)
All fill shall be placed and compacted in a controlled manner so that Level 1 level of responsibility may be achieved and certified as per AS3798-2007.



ISSUES				CHECKED AH	THIS DISCLOSURE PLAN IS PREPARED FOR THE SOLE PURPOSE OF SATISFYING THE DISCLOSURE REQUIREMENTS OF THE LAND SALES ACT AND SHOULD NOT BE USED FOR ANY OTHER PURPOSE, PARTICULARLY AS-CONSTRUCTED PURPOSES. THIS INFORMATION IS COMPILED FROM DESIGN PLANS ONLY, UNLESS OTHERWISE STATED, AND THEREFORE IS SUBJECT TO FINAL SURVEY AND CONSTRUCTION OF OPERATIONAL WORKS.	LEVEL DATUM:	AHD Der.	PLAN OF		DRAWING TITLE	
NO.	DRAWN	DATE	DESCRIPTION			ORIGIN OF LEVELS:	PM203677 80.916	PROPOSED LOT 1335 ON SP357496		DISCLOSURE PLAN	
A	MS	02.09.2025	ORIGINAL ISSUE			RL OF ORIGIN:		DESCRIBED AS: PART OF LOT 114 ON SP256133			
						CONTOUR INTERVAL:	0.25m	EXISTING TITLE REFERENCE: 50945046			
						SCALE	0 1 2 5m	LOCALITY: REDBANK PLAINS		DRAWING NO.	
						1:200		LOCAL GOVERNMENT: IPSWICH CITY COUNCIL		9919 S 14 DP A_1335	





ISSUES				CHECKED
NO.	DRAWN	DATE	DESCRIPTION	
A	MS	02.09.2025	ORIGINAL ISSUE	AH

THIS DISCLOSURE PLAN IS PREPARED FOR THE SOLE PURPOSE OF SATISFYING THE DISCLOSURE REQUIREMENTS OF THE LAND SALES ACT AND **SHOULD NOT** BE USED FOR ANY OTHER PURPOSE, PARTICULARLY AS-CONSTRUCTED PURPOSES. THIS INFORMATION IS COMPILED FROM DESIGN PLANS ONLY, UNLESS OTHERWISE STATED, AND THEREFORE IS SUBJECT TO FINAL SURVEY AND CONSTRUCTION OF OPERATIONAL WORKS.

LEVEL DATUM:	AHD Der.
ORIGIN OF LEVELS:	PM203677
RL OF ORIGIN:	80.916
CONTOUR INTERVAL:	0.25m
SCALE	0 1 2 5m
1:200	

PLAN OF	
PROPOSED LOT 1336 ON SP357496	
DESCRIBED AS:	PART OF LOT 114 ON SP256133
EXISTING TITLE REFERENCE:	50945046
LOCALITY:	REDBANK PLAINS
LOCAL GOVERNMENT:	IPSWICH CITY COUNCIL

DRAWING TITLE
DISCLOSURE PLAN
DRAWING NO.
9919 S 14 DP A_1336

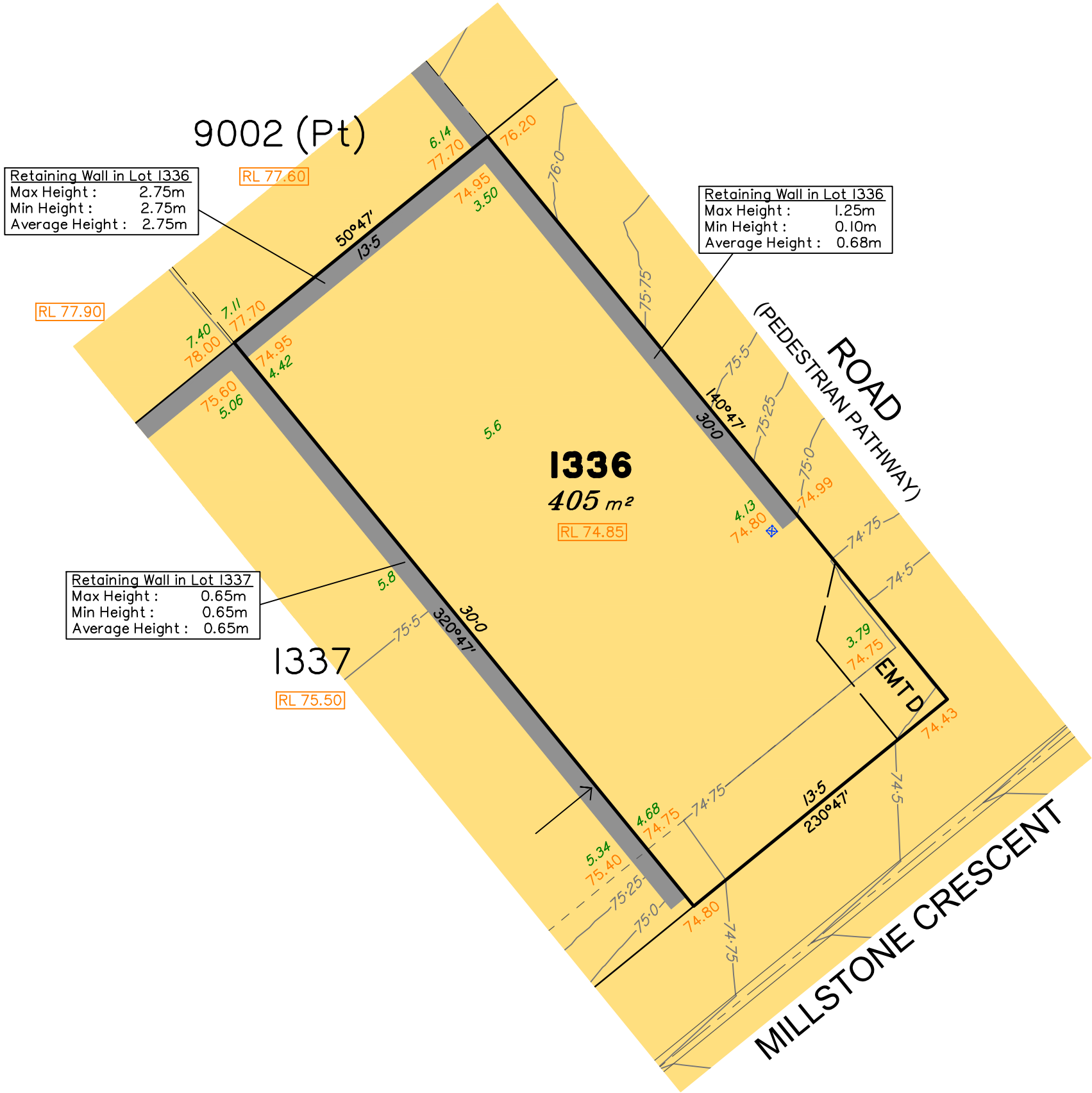

LEGEND	
	Area of Cut
	Area of Fill
	Design Contours
	Depth of Fill
	Batter Line / Change of Grade
	Retaining Wall
	Preferred Earthworks Pad Level
	Finished Surface Design Level
	Optional Built to Boundary Wall
	300mm x 300mm Subsurface Drainage Pit (indicative location)

(Not all items in this legend may be relevant to the lot shown on this plan)

NOTES
This plan has been prepared from preliminary survey plan (SP357496) and engineering data provided on the 11/08/2025 by KN Group Pty Ltd.
Development approval was granted for this subdivision by the Ipswich City Council on 18/06/2024. (Application No: 9367/2022/CA). For updates to this approval visit www.ipswich.qld.gov.au
At the time of publication of this plan, Ipswich City Council have not yet granted operational works approval for this lot (Application No: 5556/2025/OW)
All fill shall be placed and compacted in a controlled manner so that Level 1 level of responsibility may be achieved and certified as per AS3798-2007.
Lot 1336 contains Easement D on SP357496 for services benefiting Energex.

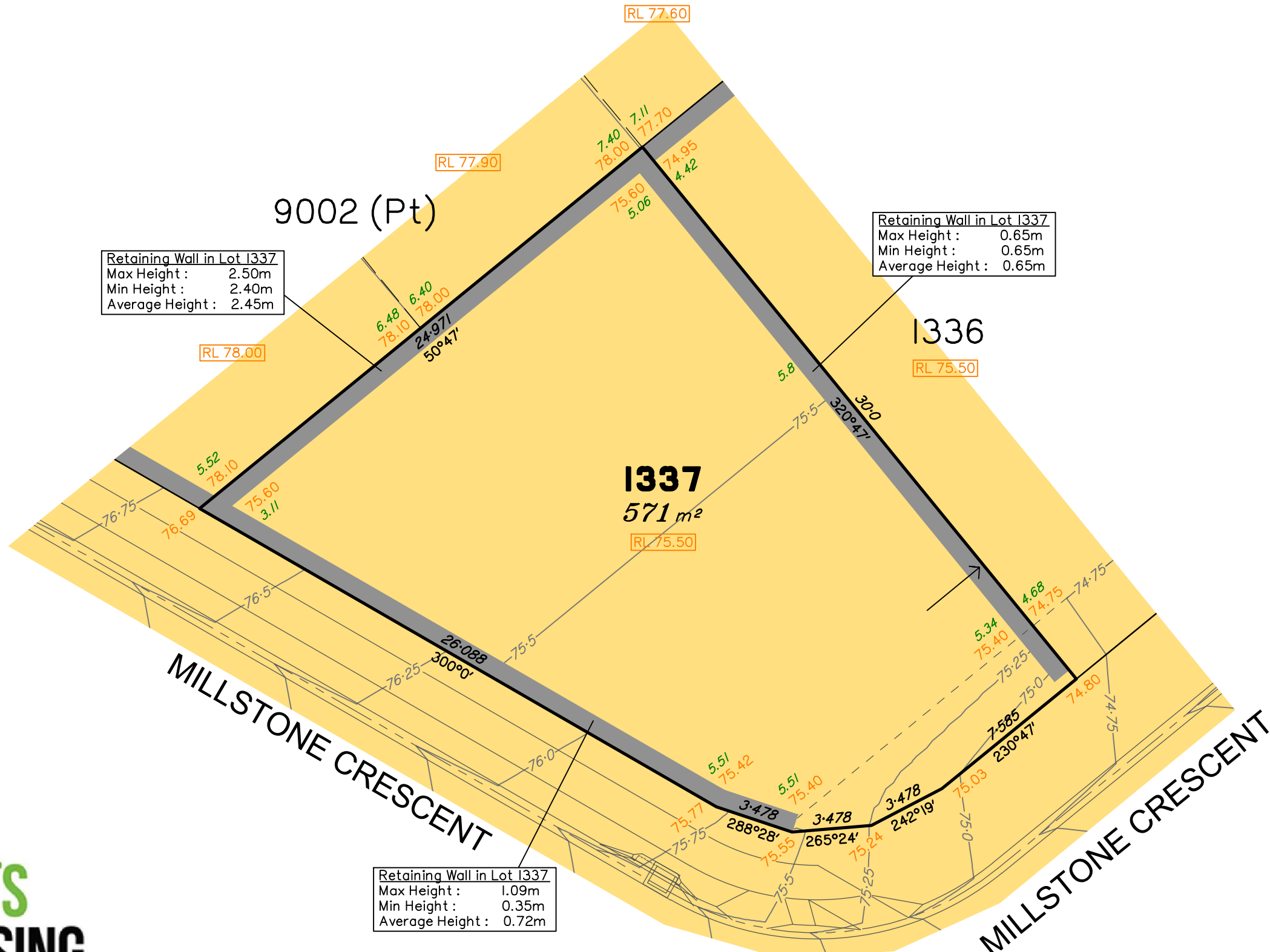

LEGEND	
	Area of Cut
	Area of Fill
	Design Contours
	Depth of Fill
	Batter Line / Change of Grade
	Retaining Wall
	Preferred Earthworks Pad Level
	Finished Surface Design Level
	Optional Built to Boundary Wall
	300mm x 300mm Subsurface Drainage Pit (indicative location)

(Not all items in this legend may be relevant to the lot shown on this plan)

NOTES

This plan has been prepared from preliminary survey plan (SP357496) and engineering data provided on the 11/08/2025 by KN Group Pty Ltd.

Development approval was granted for this subdivision by the Ipswich City Council on 18/06/2024.
(Application No: 9367/2022/CA).
For updates to this approval visit www.ipswich.qld.gov.au

At the time of publication of this plan, Ipswich City Council have not yet granted operational works approval for this lot (Application No: 5556/2025/OW)

All fill shall be placed and compacted in a controlled manner so that Level 1 level of responsibility may be achieved and certified as per AS3798-2007.

EDEN'S
CROSSING
STAGE 32B

Saunders
Havill
BOWEN HILLS | SPRINGFIELD
1300 123 744 | mail@saundershavill.com



ISSUES				CHECKED
NO.	DRAWN	DATE	DESCRIPTION	
A	MS	02.09.2025	ORIGINAL ISSUE	AH

THIS DISCLOSURE PLAN IS PREPARED FOR THE SOLE PURPOSE OF SATISFYING THE DISCLOSURE REQUIREMENTS OF THE LAND SALES ACT AND **SHOULD NOT** BE USED FOR ANY OTHER PURPOSE, PARTICULARLY AS-CONSTRUCTED PURPOSES. THIS INFORMATION IS COMPILED FROM DESIGN PLANS ONLY, UNLESS OTHERWISE STATED, AND THEREFORE IS SUBJECT TO FINAL SURVEY AND CONSTRUCTION OF OPERATIONAL WORKS.

LEVEL DATUM:	AHD Der.
ORIGIN OF LEVELS:	PM203677
RL OF ORIGIN:	80.916
CONTOUR INTERVAL:	0.25m
SCALE	0 1 2 5m
1:200	

PLAN OF	
PROPOSED LOT 1337 ON SP357496	
DESCRIBED AS:	PART OF LOT 114 ON SP256133
EXISTING TITLE REFERENCE:	50945046
LOCALITY:	REDBANK PLAINS
LOCAL GOVERNMENT:	IPSWICH CITY COUNCIL

DRAWING TITLE	
DISCLOSURE PLAN	
DRAWING NO.	9919 S 14 DP A_1337



PEET

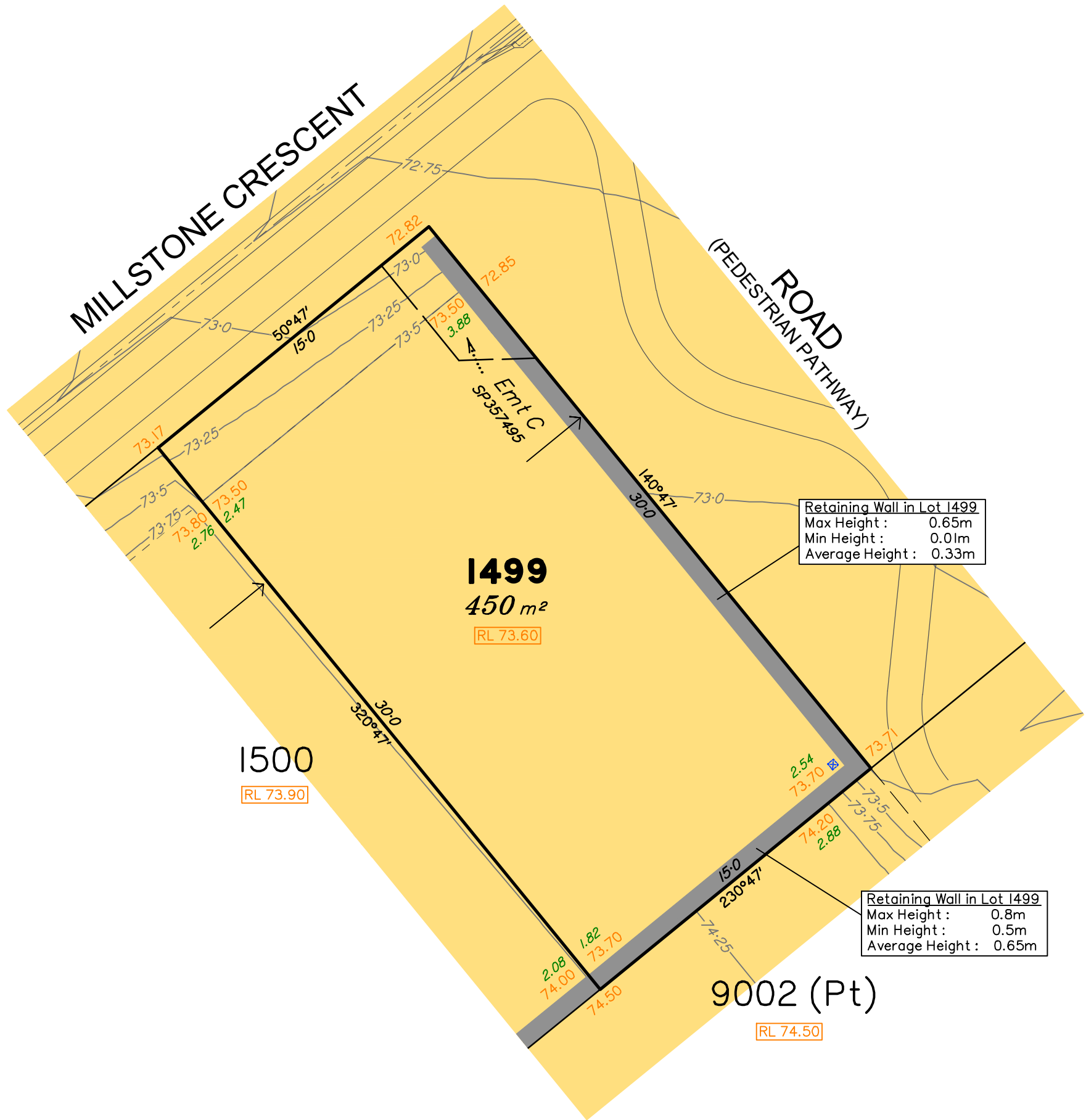

LEGEND	
	Area of Cut
	Area of Fill
	Design Contours
	Depth of Fill
	Batter Line / Change of Grade
	Retaining Wall
	Preferred Earthworks Pad Level
	Finished Surface Design Level
	Optional Built to Boundary Wall
	300mm x 300mm Subsurface Drainage Pit (indicative location)

(Not all items in this legend may be relevant to the lot shown on this plan)

NOTES

This plan has been prepared from preliminary survey plan (SP357496) and engineering data provided on the 11/08/2025 by KN Group Pty Ltd.

Development approval was granted for this subdivision by the Ipswich City Council on 18/06/2024.
(Application No: 9367/2022/CA).
For updates to this approval visit www.ipswich.qld.gov.au

At the time of publication of this plan, Ipswich City Council have not yet granted operational works approval for this lot (Application No: 5556/2025/OW)

All fill shall be placed and compacted in a controlled manner so that Level 1 level of responsibility may be achieved and certified as per AS3798-2007.

Lot 1499 contains Easement C on SP357495 for services benefiting Energex.

EDEN'S
CROSSING
STAGE 32B

Saunders
Havill
BOWEN HILLS | SPRINGFIELD
1300 123 744 | mail@saundershavill.com



ISSUES			
NO.	DRAWN	DATE	DESCRIPTION
A	MS	02.09.2025	ORIGINAL ISSUE

CHECKED
AH

THIS DISCLOSURE PLAN IS PREPARED FOR THE SOLE PURPOSE OF SATISFYING THE DISCLOSURE REQUIREMENTS OF THE LAND SALES ACT AND **SHOULD NOT** BE USED FOR ANY OTHER PURPOSE, PARTICULARLY AS-CONSTRUCTED PURPOSES. THIS INFORMATION IS COMPILED FROM DESIGN PLANS ONLY, UNLESS OTHERWISE STATED, AND THEREFORE IS SUBJECT TO FINAL SURVEY AND CONSTRUCTION OF OPERATIONAL WORKS.

LEVEL DATUM:	AHD Der.
ORIGIN OF LEVELS:	PM203677
RL OF ORIGIN:	80.916
CONTOUR INTERVAL:	0.25m
SCALE	0 1 2 5m
1:200	

PLAN OF	
PROPOSED LOT 1499 ON SP357496	
DESCRIBED AS:	PART OF LOT 114 ON SP256133
EXISTING TITLE REFERENCE:	50945046
LOCALITY:	REDBANK PLAINS
LOCAL GOVERNMENT:	IPSWICH CITY COUNCIL

DRAWING TITLE
DISCLOSURE PLAN
DRAWING NO.
9919 S 14 DP A_1499



PEET



ISSUES			
NO.	DRAWN	DATE	DESCRIPTION
A	MS	02.09.2025	ORIGINAL ISSUE

CHECKED
AH

THIS DISCLOSURE PLAN IS PREPARED FOR THE SOLE PURPOSE OF SATISFYING THE DISCLOSURE REQUIREMENTS OF THE LAND SALES ACT AND **SHOULD NOT** BE USED FOR ANY OTHER PURPOSE, PARTICULARLY AS-CONSTRUCTED PURPOSES. THIS INFORMATION IS COMPILED FROM DESIGN PLANS ONLY, UNLESS OTHERWISE STATED, AND THEREFORE IS SUBJECT TO FINAL SURVEY AND CONSTRUCTION OF OPERATIONAL WORKS.

LEVEL DATUM:	AHD Der.
ORIGIN OF LEVELS:	PM203677
RL OF ORIGIN:	80.916
CONTOUR INTERVAL:	0.25m
SCALE	0 1 2 5m
1:200	

PLAN OF	
PROPOSED LOT 1500 ON SP357496	
DESCRIBED AS:	PART OF LOT 114 ON SP256133
EXISTING TITLE REFERENCE:	50945046
LOCALITY:	REDBANK PLAINS
LOCAL GOVERNMENT:	IPSWICH CITY COUNCIL

DRAWING TITLE
DISCLOSURE PLAN
DRAWING NO.
9919 S 14 DP A_1500

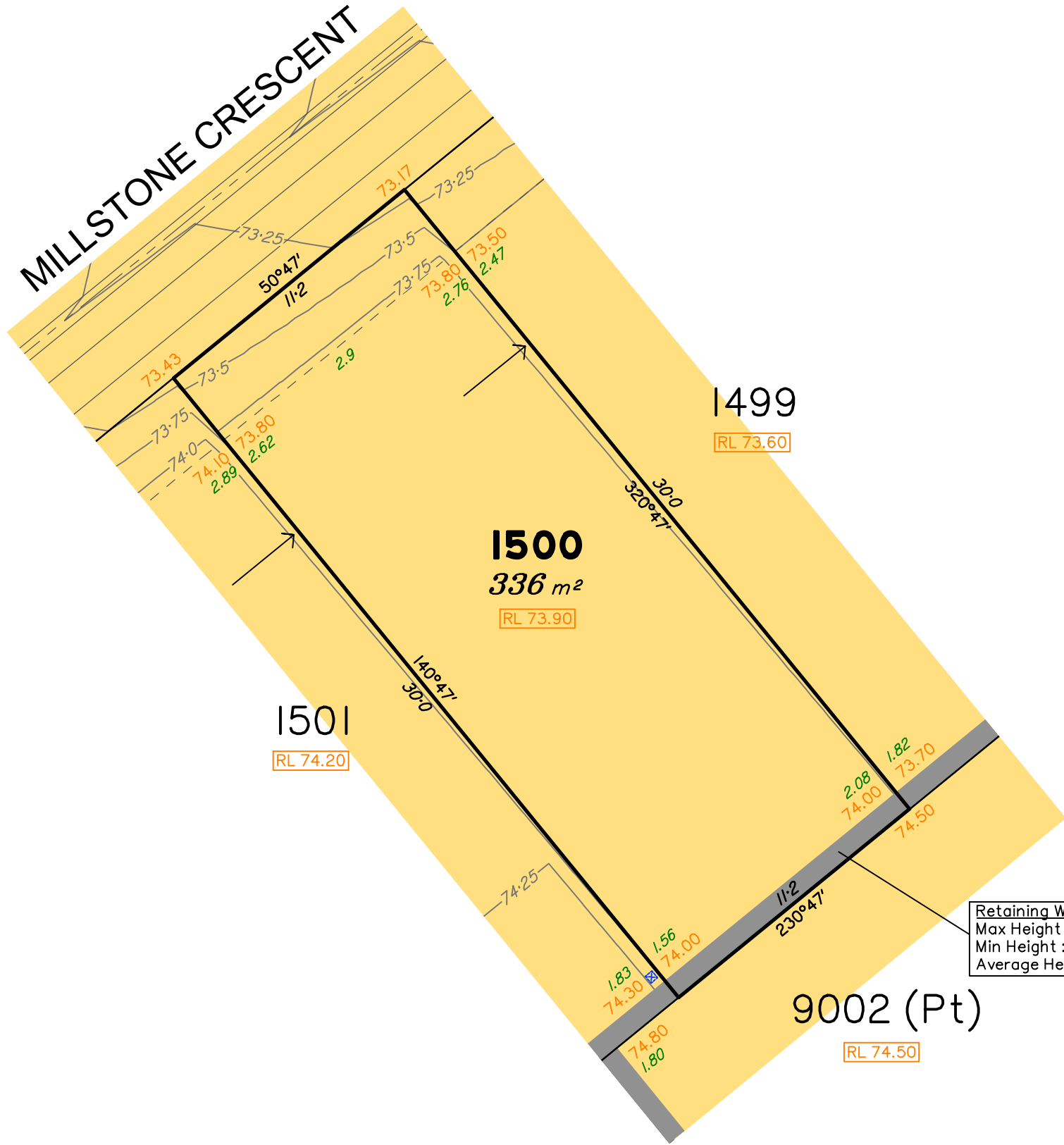

LEGEND	
	Area of Cut
	Area of Fill
	Design Contours
	Depth of Fill
	Batter Line / Change of Grade
	Retaining Wall
	Preferred Earthworks Pad Level
	Finished Surface Design Level
	Optional Built to Boundary Wall
	300mm x 300mm Subsurface Drainage Pit (indicative location)

(Not all items in this legend may be relevant to the lot shown on this plan)

NOTES
This plan has been prepared from preliminary survey plan (SP357496) and engineering data provided on the 11/08/2025 by KN Group Pty Ltd.
Development approval was granted for this subdivision by the Ipswich City Council on 18/06/2024. (Application No: 9367/2022/CA). For updates to this approval visit www.ipswich.qld.gov.au
At the time of publication of this plan, Ipswich City Council have not yet granted operational works approval for this lot (Application No: 5556/2025/OW)
All fill shall be placed and compacted in a controlled manner so that Level 1 level of responsibility may be achieved and certified as per AS3798-2007.

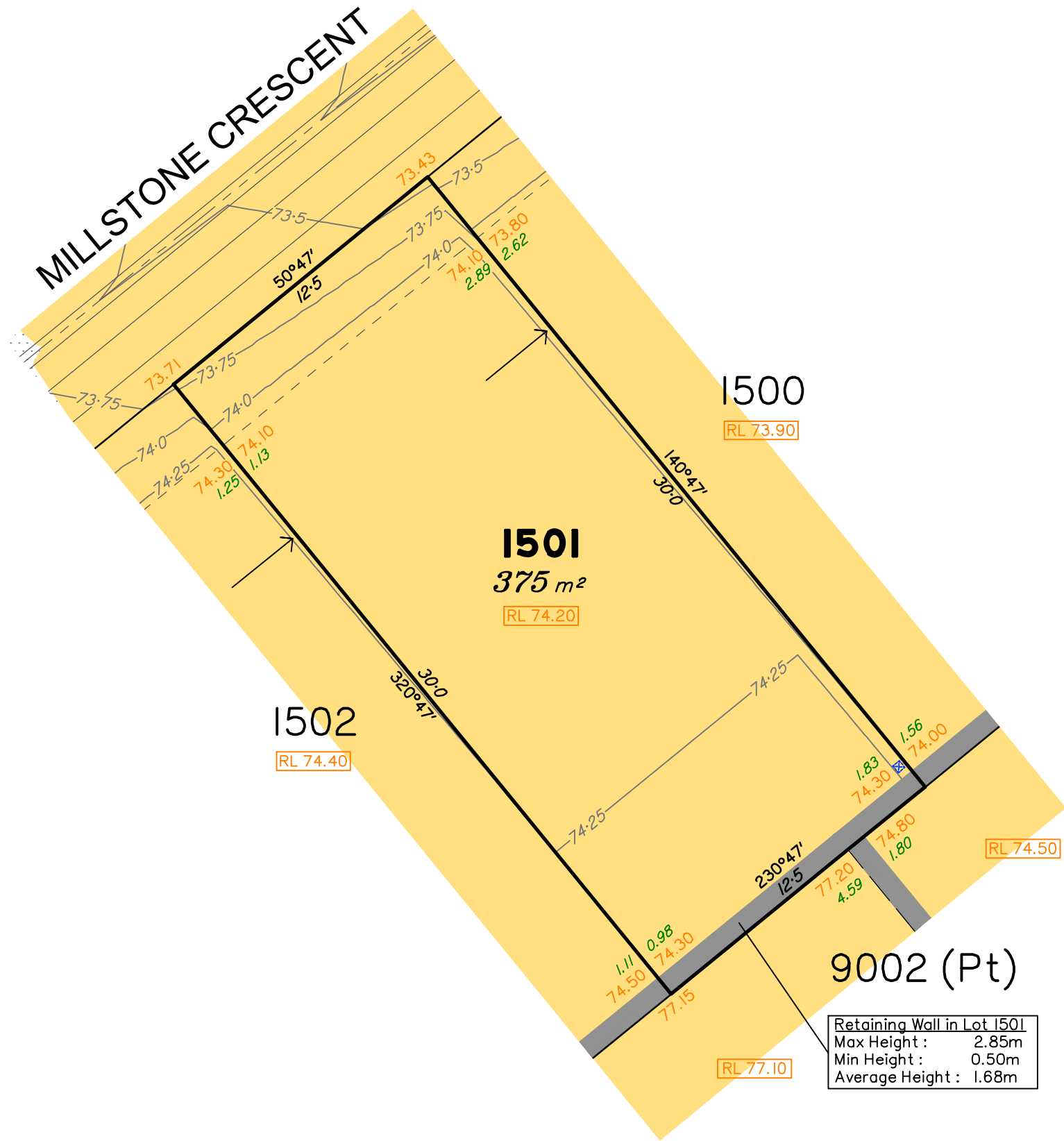

LEGEND	
	Area of Cut
	Area of Fill
	Design Contours
	Depth of Fill
	Batter Line / Change of Grade
	Retaining Wall
	Preferred Earthworks Pad Level
	Finished Surface Design Level
	Optional Built to Boundary Wall
	300mm x 300mm Subsurface Drainage Pit (indicative location)

(Not all items in this legend may be relevant to the lot shown on this plan)

NOTES

This plan has been prepared from preliminary survey plan (SP357496) and engineering data provided on the 11/08/2025 by KN Group Pty Ltd.

Development approval was granted for this subdivision by the Ipswich City Council on 18/06/2024.
(Application No: 9367/2022/CA).
For updates to this approval visit www.ipswich.qld.gov.au

At the time of publication of this plan, Ipswich City Council have not yet granted operational works approval for this lot (Application No: 5556/2025/OW)

All fill shall be placed and compacted in a controlled manner so that Level 1 level of responsibility may be achieved and certified as per AS3798-2007.

EDEN'S
CROSSING
STAGE 32B

Saunders
Havill
BOWEN HILLS | SPRINGFIELD
1300 123 744 | mail@saundershavill.com



ISSUES				CHECKED AH
NO.	DRAWN	DATE	DESCRIPTION	
A	MS	02.09.2025	ORIGINAL ISSUE	

THIS DISCLOSURE PLAN IS PREPARED FOR THE SOLE PURPOSE OF SATISFYING THE DISCLOSURE REQUIREMENTS OF THE LAND SALES ACT AND **SHOULD NOT** BE USED FOR ANY OTHER PURPOSE, PARTICULARLY AS-CONSTRUCTED PURPOSES. THIS INFORMATION IS COMPILED FROM DESIGN PLANS ONLY, UNLESS OTHERWISE STATED, AND THEREFORE IS SUBJECT TO FINAL SURVEY AND CONSTRUCTION OF OPERATIONAL WORKS.

LEVEL DATUM:	AHD Der.
ORIGIN OF LEVELS:	PM203677
RL OF ORIGIN:	80.916
CONTOUR INTERVAL:	0.25m
SCALE	0 1 2 5m
1:200	

PLAN OF	
PROPOSED LOT 1501 ON SP357496	
DESCRIBED AS:	PART OF LOT 114 ON SP256133
EXISTING TITLE REFERENCE:	50945046
LOCALITY:	REDBANK PLAINS
LOCAL GOVERNMENT:	IPSWICH CITY COUNCIL

DRAWING TITLE	
DISCLOSURE PLAN	
DRAWING NO.	9919 S 14 DP A_1501



PEET

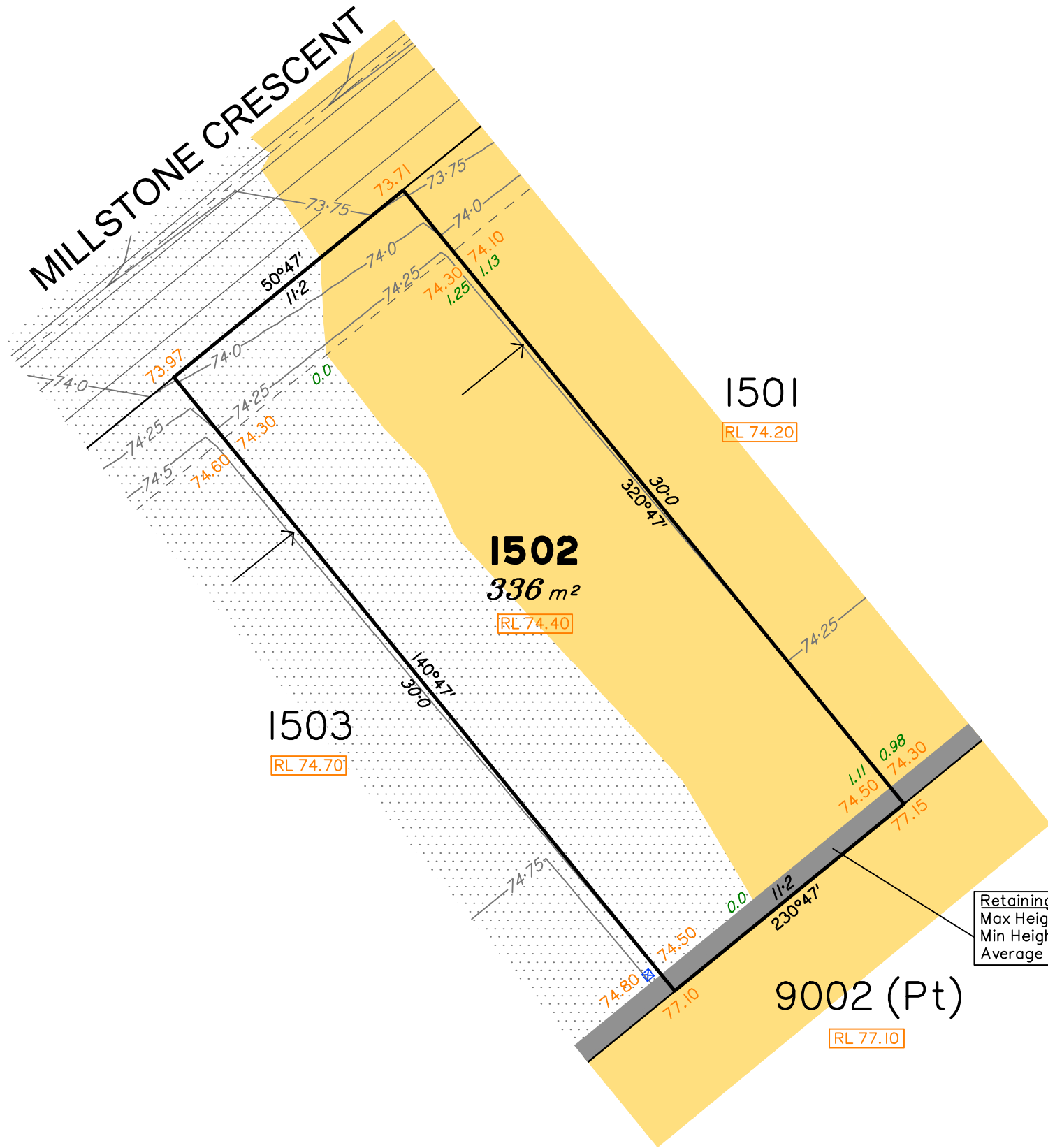

LEGEND	
	Area of Cut
	Area of Fill
	Design Contours
	Depth of Fill
	Batter Line / Change of Grade
	Retaining Wall
	Preferred Earthworks Pad Level
	Finished Surface Design Level
	Optional Built to Boundary Wall
	300mm x 300mm Subsurface Drainage Pit (indicative location)

(Not all items in this legend may be relevant to the lot shown on this plan)

NOTES

This plan has been prepared from preliminary survey plan (SP357496) and engineering data provided on the 11/08/2025 by KN Group Pty Ltd.

Development approval was granted for this subdivision by the Ipswich City Council on 18/06/2024.
(Application No: 9367/2022/CA).
For updates to this approval visit www.ipswich.qld.gov.au

At the time of publication of this plan, Ipswich City Council have not yet granted operational works approval for this lot (Application No: 5556/2025/OW)

All fill shall be placed and compacted in a controlled manner so that Level 1 level of responsibility may be achieved and certified as per AS3798-2007.

EDEN'S
CROSSING
STAGE 32B

Saunders
Havill
BOWEN HILLS | SPRINGFIELD
1300 123 744 | mail@saundershavill.com



ISSUES			
NO.	DRAWN	DATE	DESCRIPTION
A	MS	02.09.2025	ORIGINAL ISSUE

CHECKED
AH

THIS DISCLOSURE PLAN IS PREPARED FOR THE SOLE PURPOSE OF SATISFYING THE DISCLOSURE REQUIREMENTS OF THE LAND SALES ACT AND **SHOULD NOT** BE USED FOR ANY OTHER PURPOSE, PARTICULARLY AS-CONSTRUCTED PURPOSES. THIS INFORMATION IS COMPILED FROM DESIGN PLANS ONLY, UNLESS OTHERWISE STATED, AND THEREFORE IS SUBJECT TO FINAL SURVEY AND CONSTRUCTION OF OPERATIONAL WORKS.

LEVEL DATUM:	AHD Der.
ORIGIN OF LEVELS:	PM203677
RL OF ORIGIN:	80.916
CONTOUR INTERVAL:	0.25m
SCALE	0 1 2 5m
1:200	

PLAN OF	
PROPOSED LOT 1502 ON SP357496	
DESCRIBED AS:	PART OF LOT 114 ON SP256133
EXISTING TITLE REFERENCE:	50945046
LOCALITY:	REDBANK PLAINS
LOCAL GOVERNMENT:	IPSWICH CITY COUNCIL

DRAWING TITLE	
DISCLOSURE PLAN	
DRAWING NO.	9919 S 14 DP A_1502



PEET

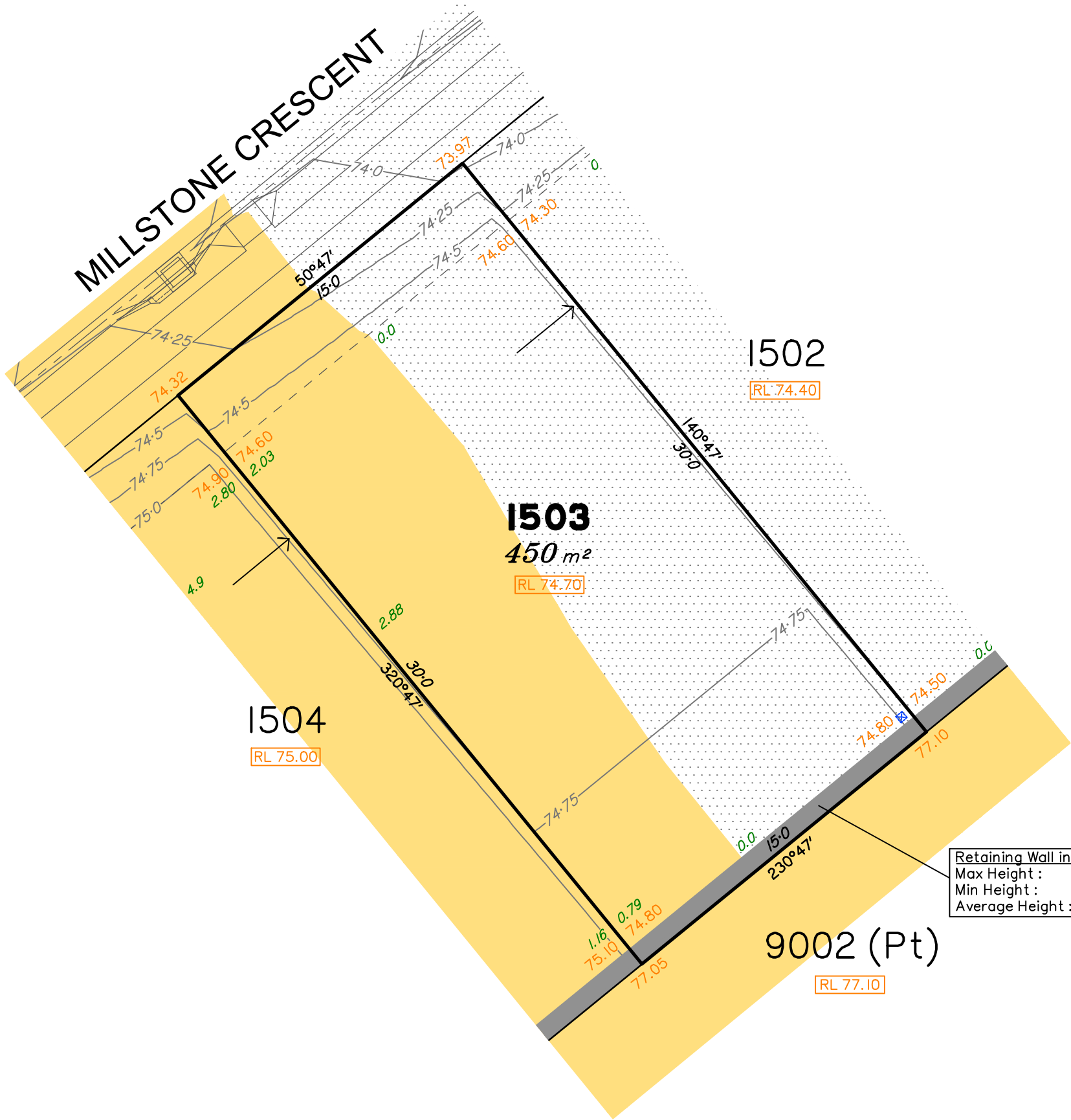

LEGEND	
	Area of Cut
	Area of Fill
	Design Contours
	Depth of Fill
	Batter Line / Change of Grade
	Retaining Wall
	Preferred Earthworks Pad Level
	Finished Surface Design Level
	Optional Built to Boundary Wall
	300mm x 300mm Subsurface Drainage Pit (indicative location)

(Not all items in this legend may be relevant to the lot shown on this plan)

NOTES
This plan has been prepared from preliminary survey plan (SP357496) and engineering data provided on the 11/08/2025 by KN Group Pty Ltd.
Development approval was granted for this subdivision by the Ipswich City Council on 18/06/2024. (Application No: 9367/2022/CA). For updates to this approval visit www.ipswich.qld.gov.au
At the time of publication of this plan, Ipswich City Council have not yet granted operational works approval for this lot (Application No: 5556/2025/OW)
All fill shall be placed and compacted in a controlled manner so that Level 1 level of responsibility may be achieved and certified as per AS3798-2007.

PEET

ISSUES			
NO.	DRAWN	DATE	DESCRIPTION
A	MS	02.09.2025	ORIGINAL ISSUE

CHECKED
AH

THIS DISCLOSURE PLAN IS PREPARED FOR THE SOLE PURPOSE OF SATISFYING THE DISCLOSURE REQUIREMENTS OF THE LAND SALES ACT AND **SHOULD NOT** BE USED FOR ANY OTHER PURPOSE, PARTICULARLY AS-CONSTRUCTED PURPOSES. THIS INFORMATION IS COMPILED FROM DESIGN PLANS ONLY, UNLESS OTHERWISE STATED, AND THEREFORE IS SUBJECT TO FINAL SURVEY AND CONSTRUCTION OF OPERATIONAL WORKS.

LEVEL DATUM:	AHD Der.
ORIGIN OF LEVELS:	PM203677
RL OF ORIGIN:	80.916
CONTOUR INTERVAL:	0.25m
SCALE	0 1 2 5m
1:200	

PLAN OF	
PROPOSED LOT 1503 ON SP357496	
DESCRIBED AS:	PART OF LOT 114 ON SP256133
EXISTING TITLE REFERENCE:	50945046
LOCALITY:	REDBANK PLAINS
LOCAL GOVERNMENT:	IPSWICH CITY COUNCIL

DRAWING TITLE
DISCLOSURE PLAN
DRAWING NO.
9919 S 14 DP A_1503



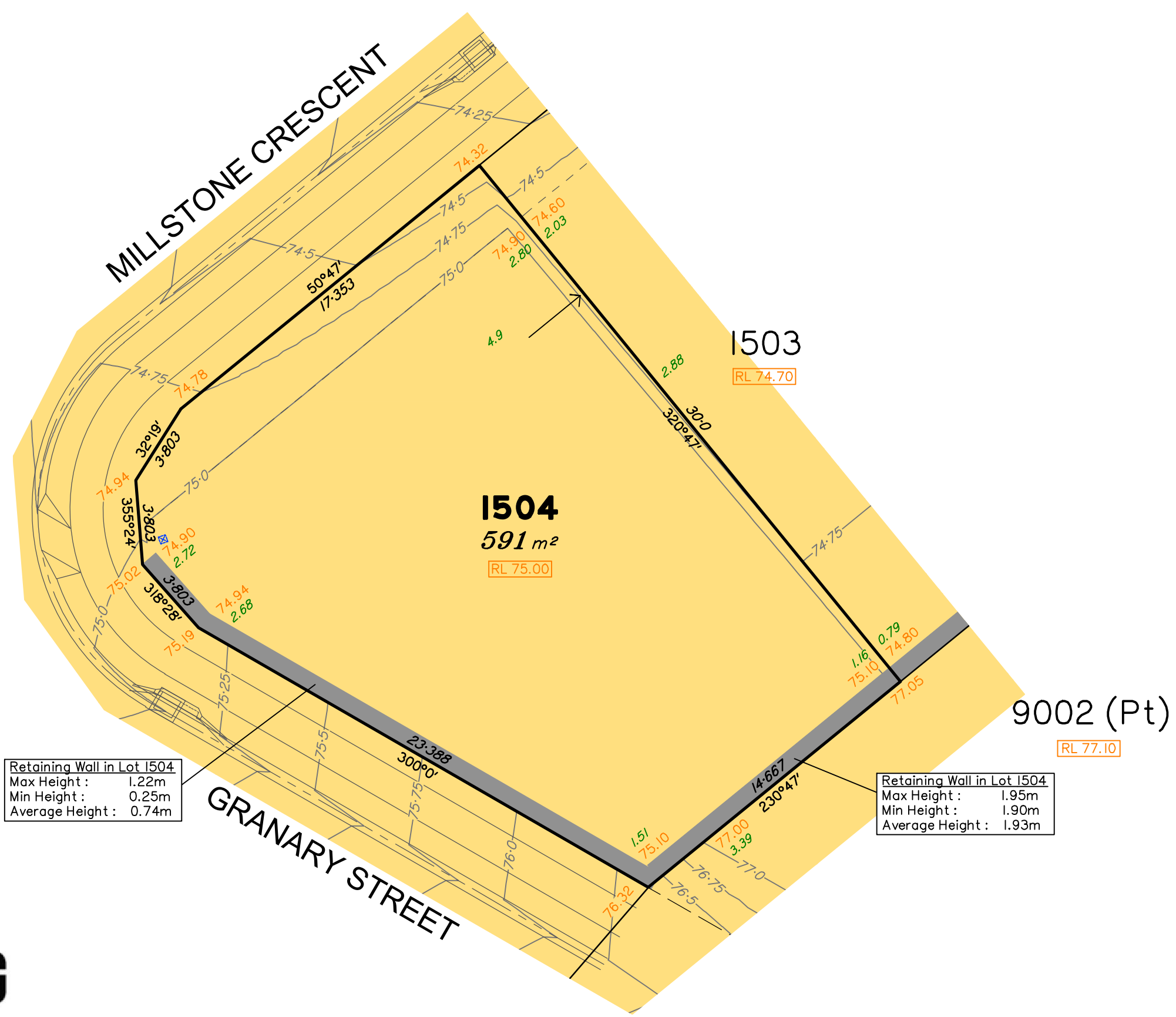

Retaining Wall in Lot 1504
Max Height : 1.22m
Min Height : 0.25m
Average Height : 0.74m

Retaining Wall in Lot 1504
Max Height : 1.95m
Min Height : 1.90m
Average Height : 1.93m

LEGEND

Area of Cut

Area of Fill

1:2

RL XX.XX

XX.XX

(Not all items in this legend may be relevant to the lot shown on this plan)

NOTES

This plan has been prepared from preliminary survey plan (SP357496) and engineering data provided on the 11/08/2025 by KN Group Pty Ltd.

Development approval was granted for this subdivision by the Ipswich City Council on 18/06/2024.
(Application No: 9367/2022/CA).
For updates to this approval visit www.ipswich.qld.gov.au

At the time of publication of this plan, Ipswich City Council have not yet granted operational works approval for this lot (Application No: 5556/2025/OW)

All fill shall be placed and compacted in a controlled manner so that Level 1 level of responsibility may be achieved and certified as per AS3798-2007.

EDEN'S
CROSSING

STAGE 32B

PEET

Saunders
Havill

BOWEN HILLS | SPRINGFIELD
1300 123 744 | mail@saundershavill.com



ISSUES				CHECKED AH	THIS DISCLOSURE PLAN IS PREPARED FOR THE SOLE PURPOSE OF SATISFYING THE DISCLOSURE REQUIREMENTS OF THE LAND SALES ACT AND SHOULD NOT BE USED FOR ANY OTHER PURPOSE, PARTICULARLY AS-CONSTRUCTED PURPOSES. THIS INFORMATION IS COMPILED FROM DESIGN PLANS ONLY, UNLESS OTHERWISE STATED, AND THEREFORE IS SUBJECT TO FINAL SURVEY AND CONSTRUCTION OF OPERATIONAL WORKS.	LEVEL DATUM:	AHD Der.	PLAN OF		DRAWING TITLE	
NO.	DRAWN	DATE	DESCRIPTION			ORIGIN OF LEVELS:	PM203677 80.916	DESCRIBED AS:	PART OF LOT 114 ON SP256133	DISCLOSURE PLAN	
	MS	02.09.2025	ORIGINAL ISSUE			CONTOUR INTERVAL:	0.25m	EXISTING TITLE REFERENCE:	50945046	DRAWING NO.	
						SCALE	0 1 2 5m	LOCALITY:	REDBANK PLAINS	LOCAL GOVERNMENT:	IPSWICH CITY COUNCIL
						1:200				9919 S 14 DP A_1504	



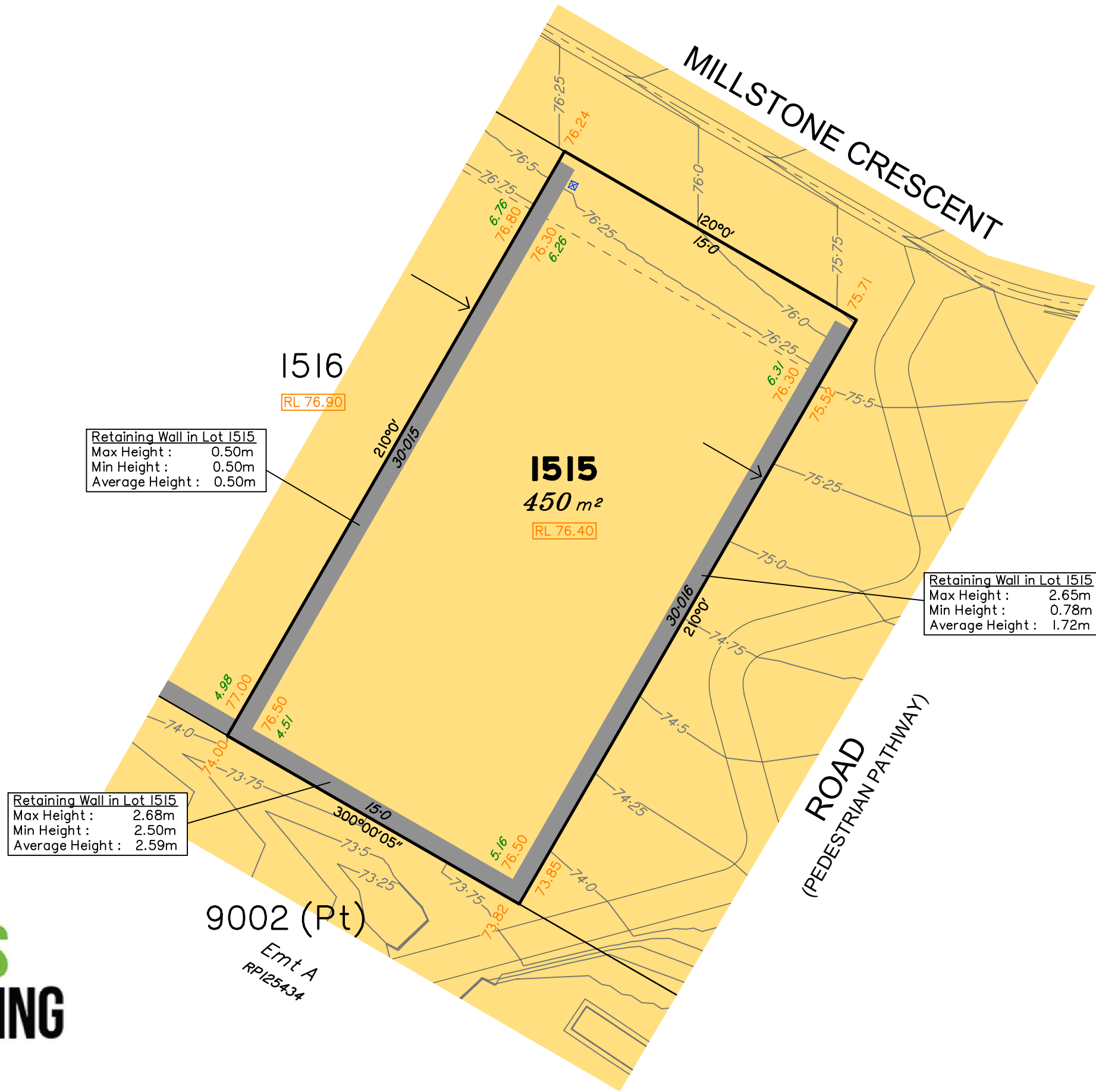

LEGEND	
	Area of Cut
	Area of Fill
	Design Contours
	Depth of Fill
	Batter Line / Change of Grade
	Retaining Wall
	Preferred Earthworks Pad Level
	Finished Surface Design Level
	Optional Built to Boundary Wall
	300mm x 300mm Subsurface Drainage Pit (indicative location)

(Not all items in this legend may be relevant to the lot shown on this plan)

NOTES

This plan has been prepared from preliminary survey plan (SP357496) and engineering data provided on the 11/08/2025 by KN Group Pty Ltd.

Development approval was granted for this subdivision by the Ipswich City Council on 18/06/2024.
(Application No: 9367/2022/CA).
For updates to this approval visit www.ipswich.qld.gov.au

At the time of publication of this plan, Ipswich City Council have not yet granted operational works approval for this lot (Application No: 5556/2025/OW)

All fill shall be placed and compacted in a controlled manner so that Level 1 level of responsibility may be achieved and certified as per AS3798-2007.

EDEN'S
CROSSING
STAGE 32B

Saunders
Havill
BOWEN HILLS | SPRINGFIELD
1300 123 744 | mail@saundershavill.com



ISSUES				CHECKED
NO.	DRAWN	DATE	DESCRIPTION	
A	MS	02.09.2025	ORIGINAL ISSUE	AH

THIS DISCLOSURE PLAN IS PREPARED FOR THE SOLE PURPOSE OF SATISFYING THE DISCLOSURE REQUIREMENTS OF THE LAND SALES ACT AND **SHOULD NOT** BE USED FOR ANY OTHER PURPOSE, PARTICULARLY AS-CONSTRUCTED PURPOSES. THIS INFORMATION IS COMPILED FROM DESIGN PLANS ONLY, UNLESS OTHERWISE STATED, AND THEREFORE IS SUBJECT TO FINAL SURVEY AND CONSTRUCTION OF OPERATIONAL WORKS.

LEVEL DATUM:	AHD Der.
ORIGIN OF LEVELS:	PM203677
RL OF ORIGIN:	80.916
CONTOUR INTERVAL:	0.25m
SCALE	0 1 2 5m
1:200	

PLAN OF	
PROPOSED LOT 1515 ON SP357496	
DESCRIBED AS:	PART OF LOT 114 ON SP256133
EXISTING TITLE REFERENCE:	50945046
LOCALITY:	REDBANK PLAINS
LOCAL GOVERNMENT:	IPSWICH CITY COUNCIL

DRAWING TITLE	
DISCLOSURE PLAN	
DRAWING NO.	9919 S 14 DP A_1515



PEET



ISSUES			
NO.	DRAWN	DATE	DESCRIPTION
A	MS	02.09.2025	ORIGINAL ISSUE

CHECKED
AH

THIS DISCLOSURE PLAN IS PREPARED FOR THE SOLE PURPOSE OF SATISFYING THE DISCLOSURE REQUIREMENTS OF THE LAND SALES ACT AND **SHOULD NOT** BE USED FOR ANY OTHER PURPOSE, PARTICULARLY AS-CONSTRUCTED PURPOSES. THIS INFORMATION IS COMPILED FROM DESIGN PLANS ONLY, UNLESS OTHERWISE STATED, AND THEREFORE IS SUBJECT TO FINAL SURVEY AND CONSTRUCTION OF OPERATIONAL WORKS.

LEVEL DATUM:	AHD Der.
ORIGIN OF LEVELS:	PM203677
RL OF ORIGIN:	80.916
CONTOUR INTERVAL:	0.25m
SCALE	0 1 2 5m
1:200	

PLAN OF	
PROPOSED LOT 1516 ON SP357496	
DESCRIBED AS:	PART OF LOT 114 ON SP256133
EXISTING TITLE REFERENCE:	50945046
LOCALITY:	REDBANK PLAINS
LOCAL GOVERNMENT:	IPSWICH CITY COUNCIL

DRAWING TITLE
DISCLOSURE PLAN
DRAWING NO.
9919 S 14 DP A_1516

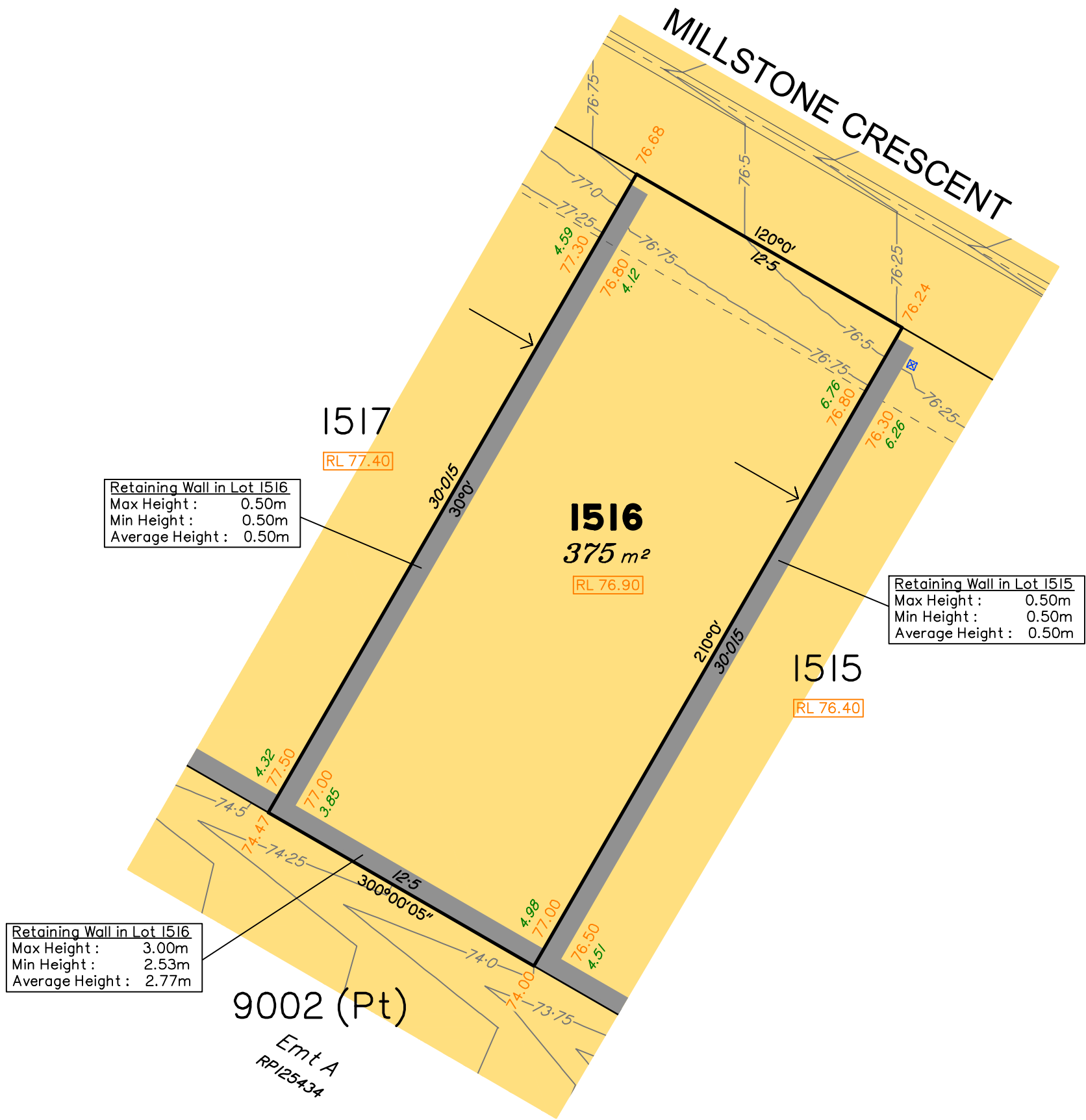

LEGEND

- Area of Cut
- Area of Fill
- Design Contours
- 1:2 Depth of Fill
- Batter Line / Change of Grade
- Retaining Wall
- RL XX.XX Preferred Earthworks Pad Level
- XX.XX Finished Surface Design Level
- Optional Built to Boundary Wall
- 300mm x 300mm Subsurface Drainage Pit (indicative location)

(Not all items in this legend may be relevant to the lot shown on this plan)

NOTES

This plan has been prepared from preliminary survey plan (SP357496) and engineering data provided on the 11/08/2025 by KN Group Pty Ltd.

Development approval was granted for this subdivision by the Ipswich City Council on 18/06/2024.
(Application No: 9367/2022/CA).
For updates to this approval visit www.ipswich.qld.gov.au

At the time of publication of this plan, Ipswich City Council have not yet granted operational works approval for this lot (Application No: 5556/2025/OW)

All fill shall be placed and compacted in a controlled manner so that Level 1 level of responsibility may be achieved and certified as per AS3798-2007.



ISSUES				CHECKED
NO.	DRAWN	DATE	DESCRIPTION	
A	MS	02.09.2025	ORIGINAL ISSUE	AH

THIS DISCLOSURE PLAN IS PREPARED FOR THE SOLE PURPOSE OF SATISFYING THE DISCLOSURE REQUIREMENTS OF THE LAND SALES ACT AND **SHOULD NOT** BE USED FOR ANY OTHER PURPOSE, PARTICULARLY AS-CONSTRUCTED PURPOSES. THIS INFORMATION IS COMPILED FROM DESIGN PLANS ONLY, UNLESS OTHERWISE STATED, AND THEREFORE IS SUBJECT TO FINAL SURVEY AND CONSTRUCTION OF OPERATIONAL WORKS.

LEVEL DATUM:	AHD Der.
ORIGIN OF LEVELS:	PM203677
RL OF ORIGIN:	80.916
CONTOUR INTERVAL:	0.25m
SCALE	0 1 2 5m
1:200	

PLAN OF	
PROPOSED LOT 1517 ON SP357496	
DESCRIBED AS:	PART OF LOT 114 ON SP256133
EXISTING TITLE REFERENCE:	50945046
LOCALITY:	REDBANK PLAINS
LOCAL GOVERNMENT:	IPSWICH CITY COUNCIL

DRAWING TITLE
DISCLOSURE PLAN
DRAWING NO.
9919 S 14 DP A_1517

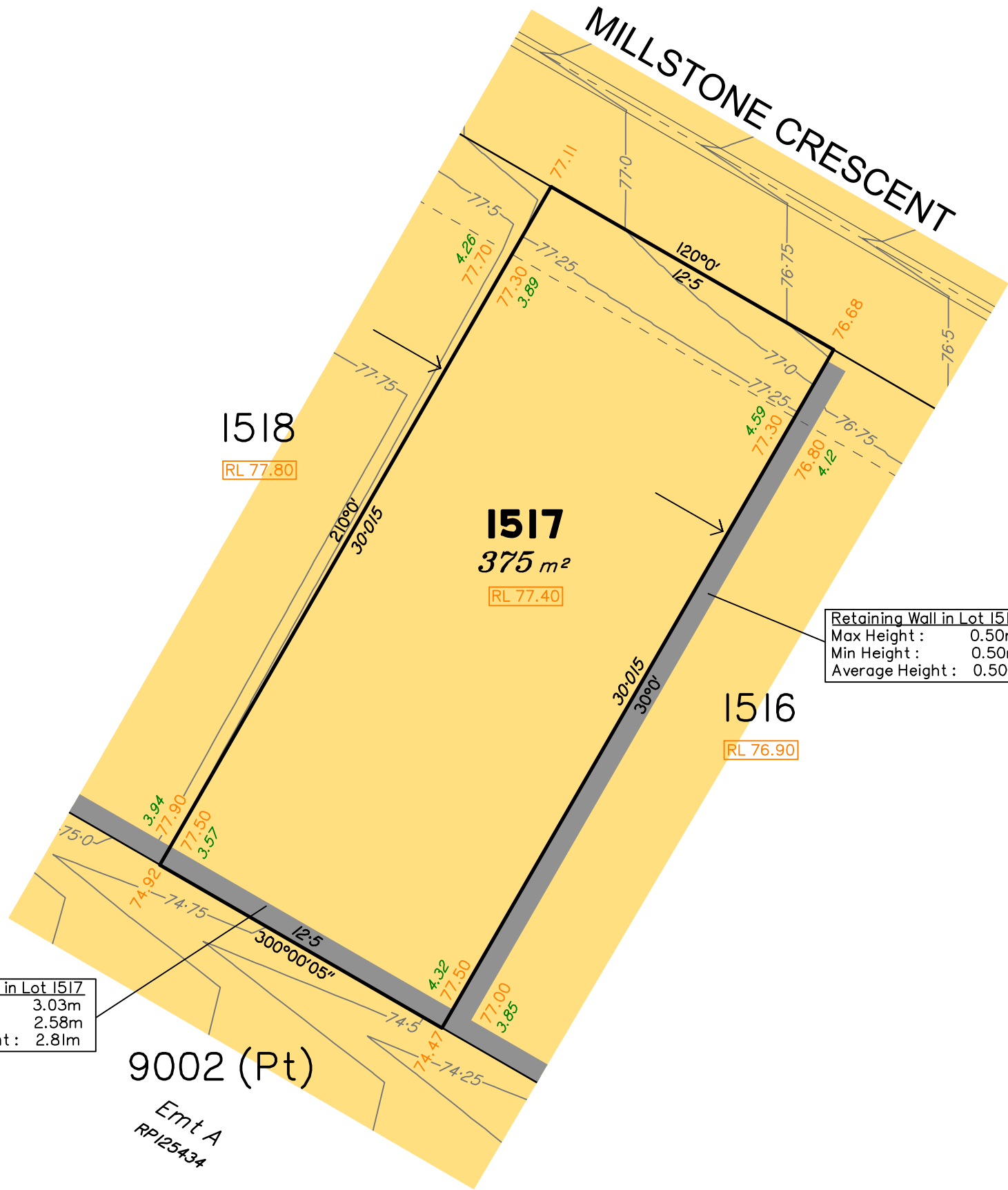

LEGEND	
	Area of Cut
	Area of Fill
	Design Contours
	Depth of Fill
	Batter Line / Change of Grade
	Retaining Wall
	Preferred Earthworks Pad Level
	Finished Surface Design Level
	Optional Built to Boundary Wall
	300mm x 300mm Subsurface Drainage Pit (indicative location)

(Not all items in this legend may be relevant to the lot shown on this plan)

NOTES

This plan has been prepared from preliminary survey plan (SP357496) and engineering data provided on the 11/08/2025 by KN Group Pty Ltd.

Development approval was granted for this subdivision by the Ipswich City Council on 18/06/2024.
(Application No: 9367/2022/CA).
For updates to this approval visit www.ipswich.qld.gov.au

At the time of publication of this plan, Ipswich City Council have not yet granted operational works approval for this lot (Application No: 5556/2025/OW)

All fill shall be placed and compacted in a controlled manner so that Level 1 level of responsibility may be achieved and certified as per AS3798-2007.



ISSUES				CHECKED AH
NO.	DRAWN	DATE	DESCRIPTION	
A	MS	02.09.2025	ORIGINAL ISSUE	

THIS DISCLOSURE PLAN IS PREPARED FOR THE SOLE PURPOSE OF SATISFYING THE DISCLOSURE REQUIREMENTS OF THE LAND SALES ACT AND **SHOULD NOT** BE USED FOR ANY OTHER PURPOSE, PARTICULARLY AS-CONSTRUCTED PURPOSES. THIS INFORMATION IS COMPILED FROM DESIGN PLANS ONLY, UNLESS OTHERWISE STATED, AND THEREFORE IS SUBJECT TO FINAL SURVEY AND CONSTRUCTION OF OPERATIONAL WORKS.

LEVEL DATUM:	AHD Der.
ORIGIN OF LEVELS:	PM203677
RL OF ORIGIN:	80.916
CONTOUR INTERVAL:	0.25m
SCALE	0 1 2 5m
1:200	

PLAN OF PROPOSED LOT 1518 ON SP357496	
DESCRIBED AS:	PART OF LOT 114 ON SP256133
EXISTING TITLE REFERENCE:	50945046
LOCALITY:	REDBANK PLAINS
LOCAL GOVERNMENT:	IPSWICH CITY COUNCIL

DRAWING TITLE DISCLOSURE PLAN
DRAWING NO. 9919 S 14 DP A_1518

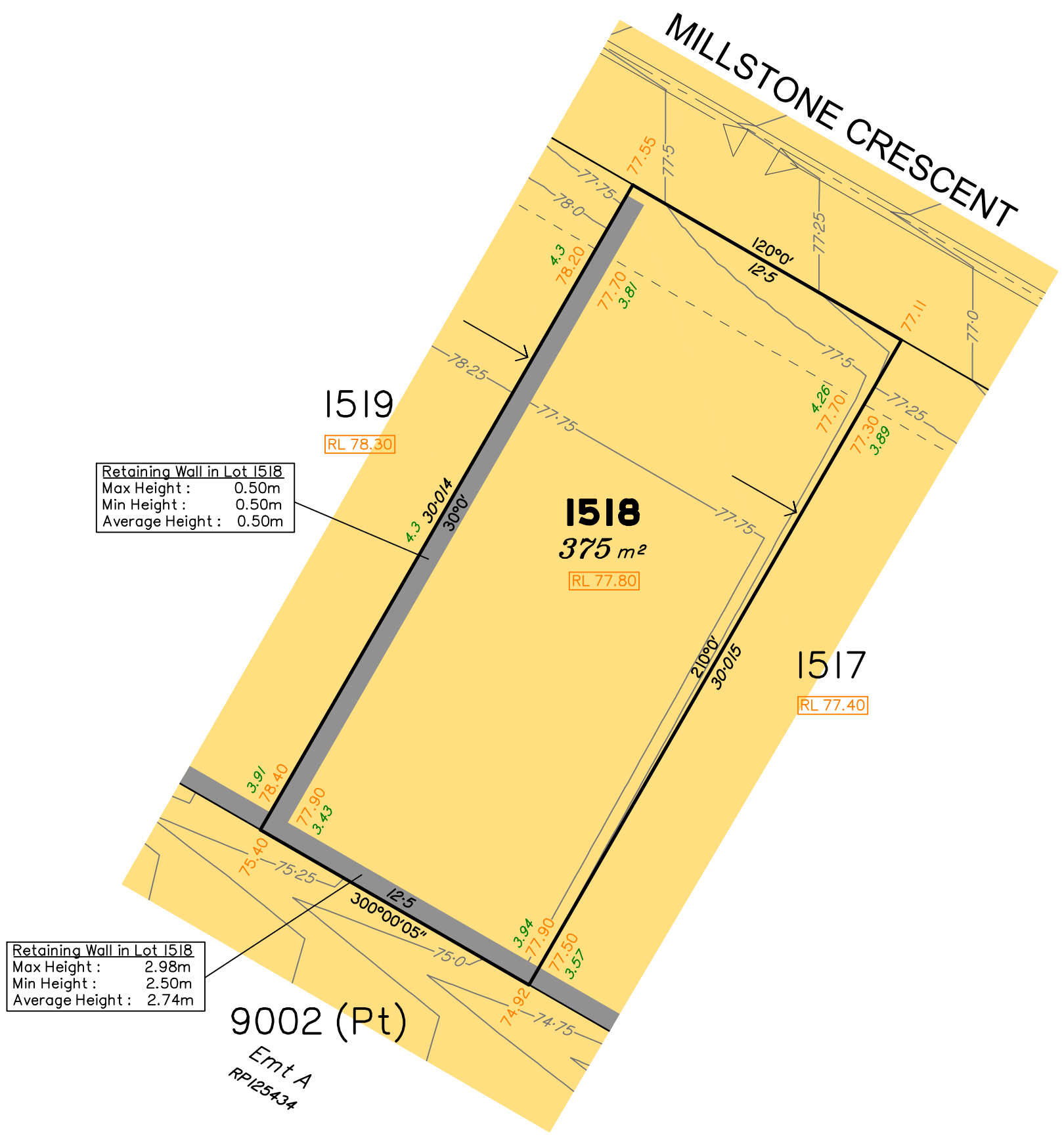

LEGEND	
	Area of Cut
	Area of Fill
	Design Contours
	Depth of Fill
	Batter Line / Change of Grade
	Retaining Wall
	Preferred Earthworks Pad Level
	Finished Surface Design Level
	Optional Built to Boundary Wall
	300mm x 300mm Subsurface Drainage Pit (indicative location)

(Not all items in this legend may be relevant to the lot shown on this plan)

NOTES
This plan has been prepared from preliminary survey plan (SP357496) and engineering data provided on the 11/08/2025 by KN Group Pty Ltd.
Development approval was granted for this subdivision by the Ipswich City Council on 18/06/2024. (Application No: 9367/2022/CA). For updates to this approval visit www.ipswich.qld.gov.au
At the time of publication of this plan, Ipswich City Council have not yet granted operational works approval for this lot (Application No: 5556/2025/OW)
All fill shall be placed and compacted in a controlled manner so that Level 1 level of responsibility may be achieved and certified as per AS3798-2007.



ISSUES			
NO.	DRAWN	DATE	DESCRIPTION
A	MS	02.09.2025	ORIGINAL ISSUE

CHECKED
AH

THIS DISCLOSURE PLAN IS PREPARED FOR THE SOLE PURPOSE OF SATISFYING THE DISCLOSURE REQUIREMENTS OF THE LAND SALES ACT AND **SHOULD NOT** BE USED FOR ANY OTHER PURPOSE, PARTICULARLY AS-CONSTRUCTED PURPOSES. THIS INFORMATION IS COMPILED FROM DESIGN PLANS ONLY, UNLESS OTHERWISE STATED, AND THEREFORE IS SUBJECT TO FINAL SURVEY AND CONSTRUCTION OF OPERATIONAL WORKS.

LEVEL DATUM:	AHD Der.
ORIGIN OF LEVELS:	PM203677
RL OF ORIGIN:	80.916
CONTOUR INTERVAL:	0.25m
SCALE	0 1 2 5m
1:200	

PLAN OF	
PROPOSED LOT 1519 ON SP357496	
DESCRIBED AS:	PART OF LOT 114 ON SP256133
EXISTING TITLE REFERENCE:	50945046
LOCALITY:	REDBANK PLAINS
LOCAL GOVERNMENT:	IPSWICH CITY COUNCIL

DRAWING TITLE
DISCLOSURE PLAN
DRAWING NO.
9919 S 14 DP A_1519

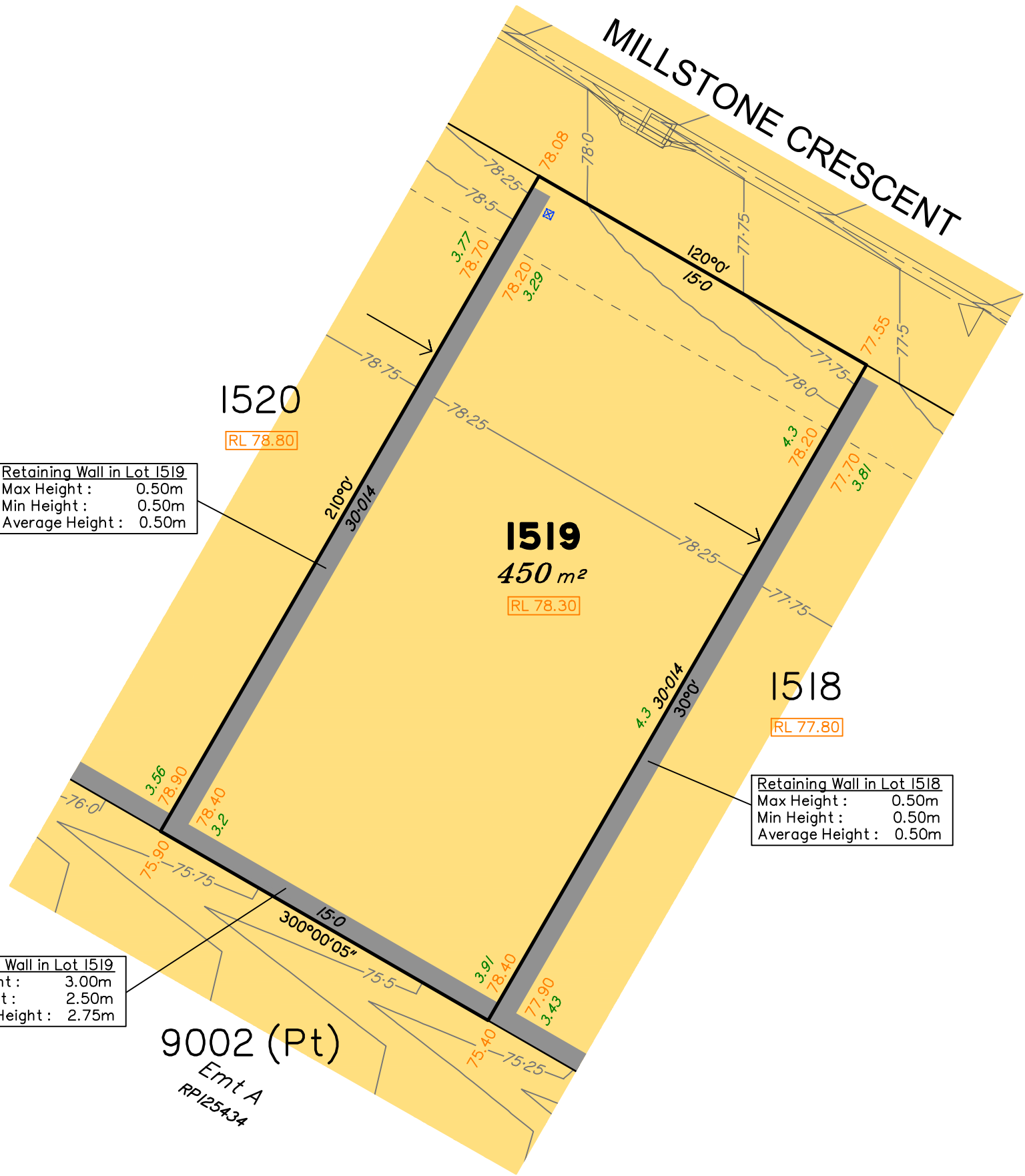

LEGEND	
	Area of Cut
	Area of Fill
	Design Contours
	Depth of Fill
	Batter Line / Change of Grade
	Retaining Wall
	Preferred Earthworks Pad Level
	Finished Surface Design Level
	Optional Built to Boundary Wall
	300mm x 300mm Subsurface Drainage Pit (indicative location)

(Not all items in this legend may be relevant to the lot shown on this plan)

NOTES

This plan has been prepared from preliminary survey plan (SP357496) and engineering data provided on the 11/08/2025 by KN Group Pty Ltd.

Development approval was granted for this subdivision by the Ipswich City Council on 18/06/2024.
(Application No: 9367/2022/CA).
For updates to this approval visit www.ipswich.qld.gov.au

At the time of publication of this plan, Ipswich City Council have not yet granted operational works approval for this lot (Application No: 5556/2025/OW)

All fill shall be placed and compacted in a controlled manner so that Level 1 level of responsibility may be achieved and certified as per AS3798-2007.

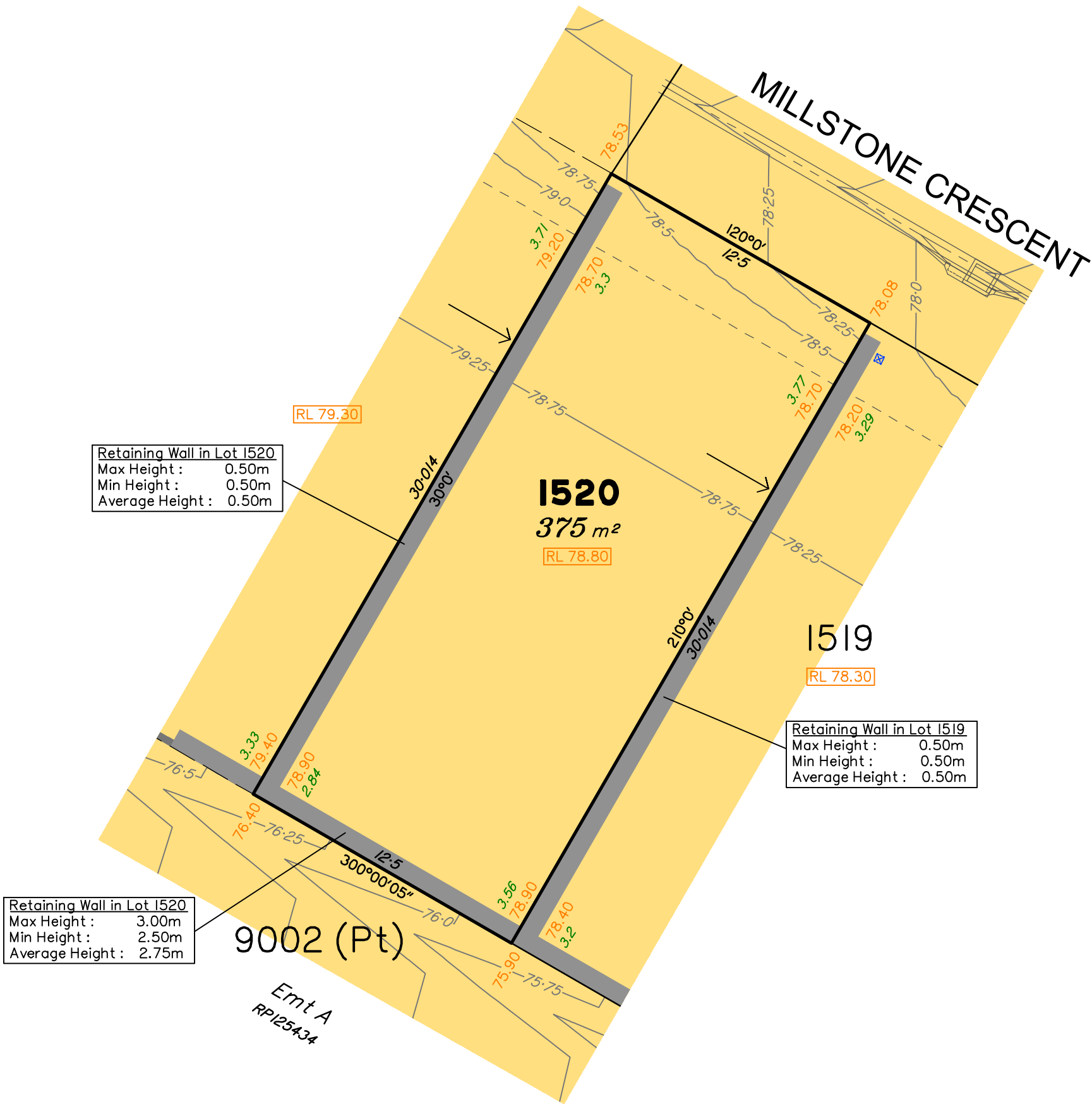

LEGEND

- Area of Cut
- Area of Fill
- Design Contours
- Depth of Fill
- Batter Line / Change of Grade
- Retaining Wall
- Preferred Earthworks Pad Level
- Finished Surface Design Level
- Optional Built to Boundary Wall
- 300mm x 300mm Subsurface Drainage Pit (indicative location)

(Not all items in this legend may be relevant to the lot shown on this plan)

NOTES

This plan has been prepared from preliminary survey plan (SP357496) and engineering data provided on the 11/08/2025 by KN Group Pty Ltd.

Development approval was granted for this subdivision by the Ipswich City Council on 18/06/2024.
(Application No: 9367/2022/CA).
For updates to this approval visit www.ipswich.qld.gov.au

At the time of publication of this plan, Ipswich City Council have not yet granted operational works approval for this lot (Application No: 5556/2025/OW)

All fill shall be placed and compacted in a controlled manner so that Level 1 level of responsibility may be achieved and certified as per AS3798-2007.

PEET

ISSUES				CHECKED	AH
NO.	DRAWN	DATE	DESCRIPTION		
A	MS	02.09.2025	ORIGINAL ISSUE		

THIS DISCLOSURE PLAN IS PREPARED FOR THE SOLE PURPOSE OF SATISFYING THE DISCLOSURE REQUIREMENTS OF THE LAND SALES ACT AND **SHOULD NOT** BE USED FOR ANY OTHER PURPOSE, PARTICULARLY AS-CONSTRUCTED PURPOSES. THIS INFORMATION IS COMPILED FROM DESIGN PLANS ONLY, UNLESS OTHERWISE STATED, AND THEREFORE IS SUBJECT TO FINAL SURVEY AND CONSTRUCTION OF OPERATIONAL WORKS.

LEVEL DATUM:	AHD Der.
ORIGIN OF LEVELS:	PM203677
RL OF ORIGIN:	80.916
CONTOUR INTERVAL:	0.25m
SCALE	0 1 2 5m
1:200	

PLAN OF	
PROPOSED LOT 1520 ON SP357496	
DESCRIBED AS:	PART OF LOT 114 ON SP256133
EXISTING TITLE REFERENCE:	50945046
LOCALITY:	REDBANK PLAINS
LOCAL GOVERNMENT:	IPSWICH CITY COUNCIL

DRAWING TITLE
DISCLOSURE PLAN
DRAWING NO.
9919 S 14 DP A_1520

