



ISSUES			
NO.	DRAWN	DATE	DESCRIPTION
A	MS	02.09.2025	ORIGINAL ISSUE

THIS DISCLOSURE PLAN IS PREPARED FOR THE SOLE PURPOSE OF SATISFYING THE DISCLOSURE REQUIREMENTS OF THE LAND SALES ACT AND **SHOULD NOT** BE USED FOR ANY OTHER PURPOSE, PARTICULARLY AS-CONSTRUCTED PURPOSES. THIS INFORMATION IS COMPILED FROM DESIGN PLANS ONLY, UNLESS OTHERWISE STATED, AND THEREFORE IS SUBJECT TO FINAL SURVEY AND CONSTRUCTION OF OPERATIONAL WORKS.

LEVEL DATUM:	AHD Der.
ORIGIN OF LEVELS:	PM203677
RL OF ORIGIN:	80.916
CONTOUR INTERVAL:	0.25m
SCALE	0 1 2 5m
1:200	

PLAN OF	PROPOSED LOT 1324 ON SP357495
DESCRIBED AS:	PART OF LOT 114 ON SP256133
EXISTING TITLE REFERENCE:	50945046
LOCALITY:	REDBANK PLAINS
LOCAL GOVERNMENT:	IPSWICH CITY COUNCIL

DRAWING TITLE	DISCLOSURE PLAN
DRAWING NO.	9919 S 13 DP A_1324

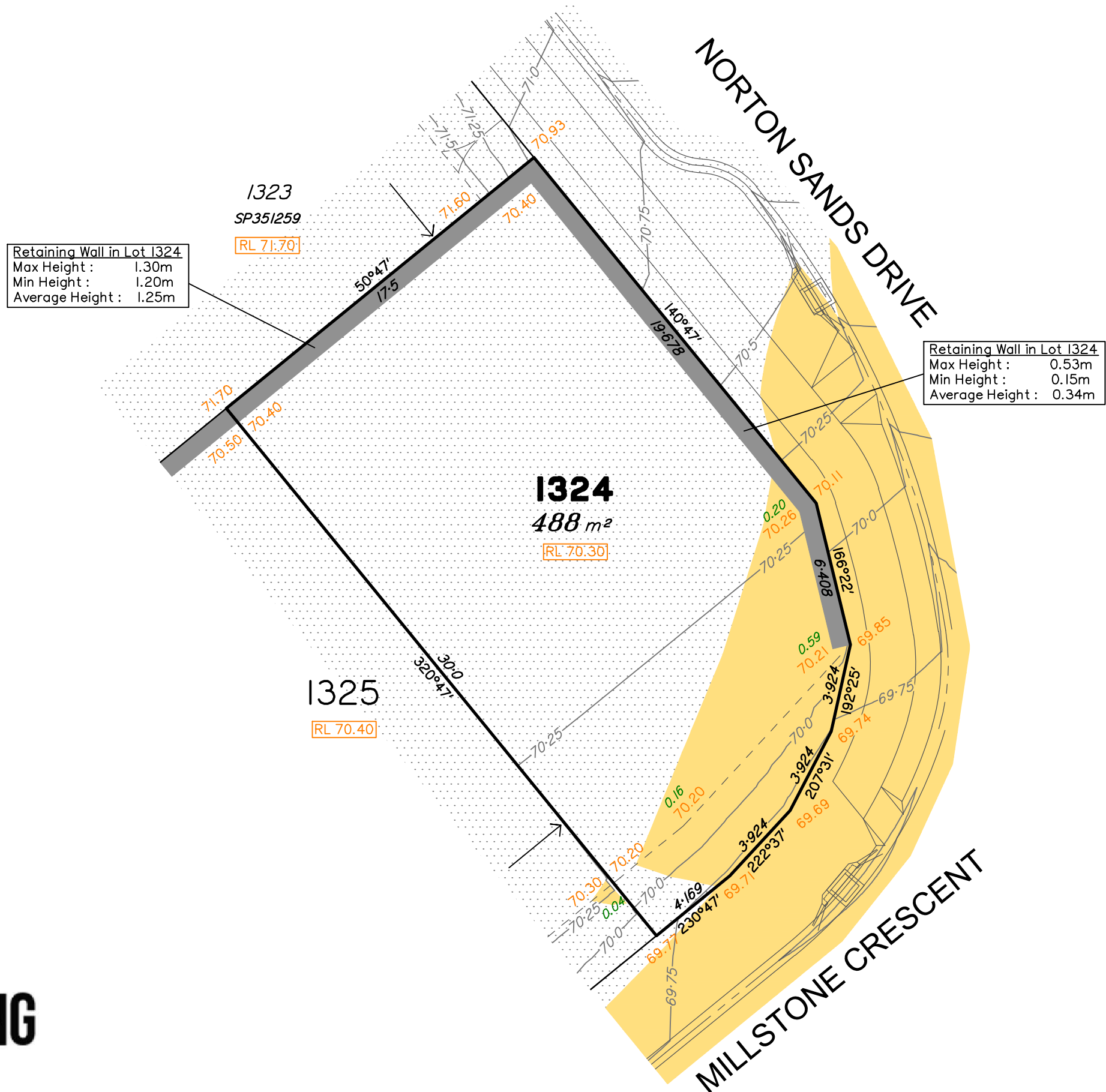

Retaining Wall in Lot 1324
Max Height : 1.30m
Min Height : 1.20m
Average Height : 1.25m

Retaining Wall in Lot 1324
Max Height : 0.53m
Min Height : 0.15m
Average Height : 0.34m

LEGEND	
	Area of Cut
	Area of Fill
	Design Contours
	1:2 Depth of Fill
	Batter Line / Change of Grade
	Retaining Wall
	Preferred Earthworks Pad Level
	XX.XX Finished Surface Design Level
	Optional Built to Boundary Wall
	300mm x 300mm Subsurface Drainage Pit (indicative location)

(Not all items in this legend may be relevant to the lot shown on this plan)

NOTES

This plan has been prepared from preliminary survey plan (SP357495) and engineering data provided on the 11/08/2025 by KN Group Pty Ltd.

Development approval was granted for this subdivision by the Ipswich City Council on 18/06/2024.
(Application No: 9367/2022/CA).
For updates to this approval visit www.ipswich.qld.gov.au

Development approval for operational works for this lot was granted by Ipswich City Council on 04/07/2025 (Application No: 3884/2025/OW)

All fill shall be placed and compacted in a controlled manner so that Level 1 level of responsibility may be achieved and certified as per AS3798-2007.

LEGEND	
	Area of Cut
	Area of Fill
	Design Contours
	Depth of Fill
	Batter Line / Change of Grade
	Retaining Wall
	Preferred Earthworks Pad Level
	Finished Surface Design Level
	Optional Built to Boundary Wall
	300mm x 300mm Subsurface Drainage Pit (indicative location)

(Not all items in this legend may be relevant to the lot shown on this plan)

NOTES

This plan has been prepared from preliminary survey plan (SP357495) and engineering data provided on the 11/08/2025 by KN Group Pty Ltd.

Development approval was granted for this subdivision by the Ipswich City Council on 18/06/2024.
(Application No: 9367/2022/CA).
For updates to this approval visit www.ipswich.qld.gov.au

Development approval for operational works for this lot was granted by Ipswich City Council on 04/07/2025 (Application No: 3884/2025/OW)

All fill shall be placed and compacted in a controlled manner so that Level 1 level of responsibility may be achieved and certified as per AS3798-2007.

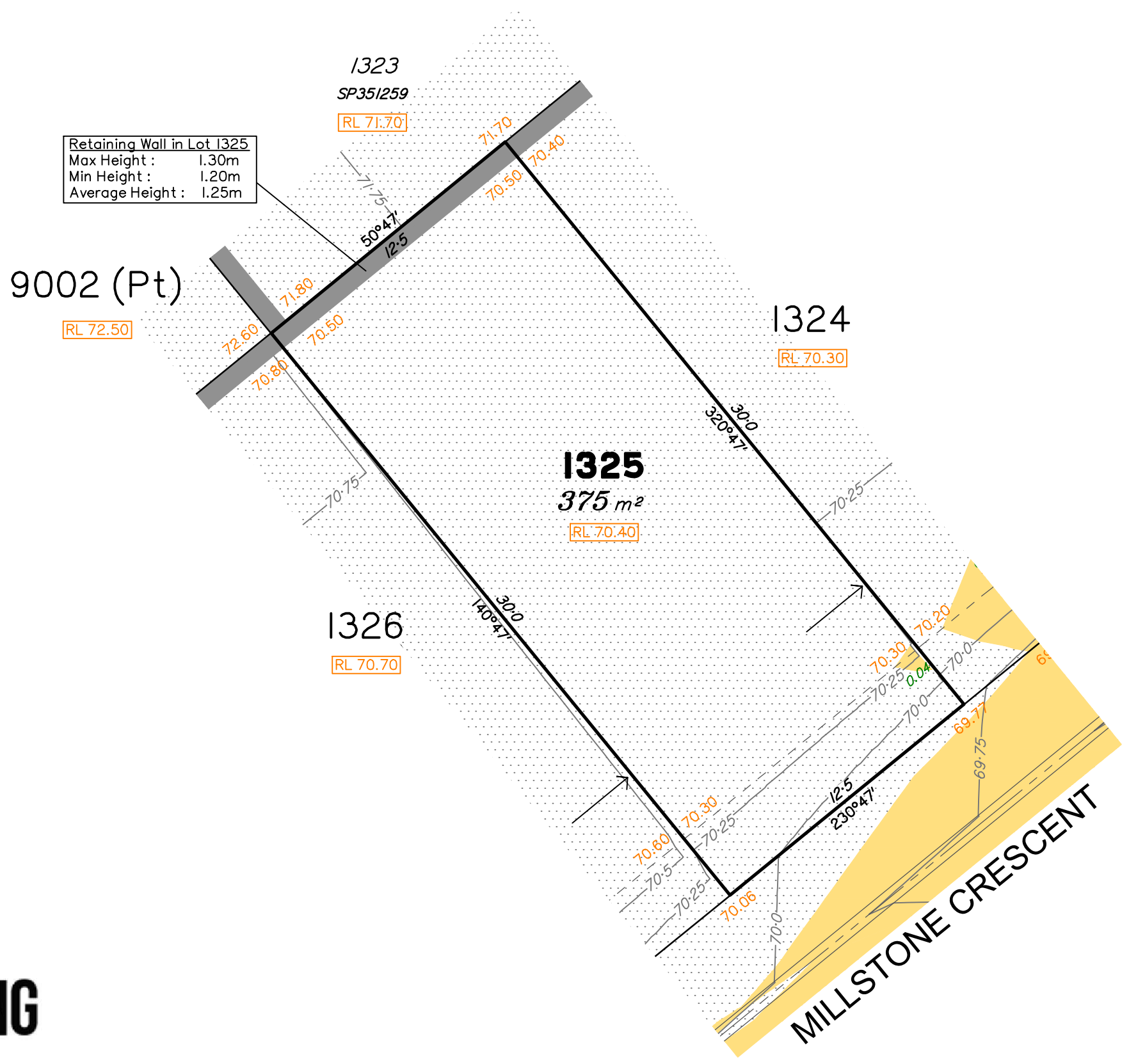

Retaining Wall in Lot 1325
Max Height : 1.30m
Min Height : 1.20m
Average Height : 1.25m

EDEN'S CROSSING
STAGE 32A

PEET

Saunders Havill
BOWEN HILLS | SPRINGFIELD
1300 123 744 | mail@saundershavill.com



ISSUES			
NO.	DRAWN	DATE	DESCRIPTION
A	MS	02.09.2025	ORIGINAL ISSUE

THIS DISCLOSURE PLAN IS PREPARED FOR THE SOLE PURPOSE OF SATISFYING THE DISCLOSURE REQUIREMENTS OF THE LAND SALES ACT AND **SHOULD NOT** BE USED FOR ANY OTHER PURPOSE, PARTICULARLY AS-CONSTRUCTED PURPOSES. THIS INFORMATION IS COMPILED FROM DESIGN PLANS ONLY, UNLESS OTHERWISE STATED, AND THEREFORE IS SUBJECT TO FINAL SURVEY AND CONSTRUCTION OF OPERATIONAL WORKS.

LEVEL DATUM: AHD Der.
ORIGIN OF LEVELS: PM203677
RL OF ORIGIN: 80.916
CONTOUR INTERVAL: 0.25m
SCALE: 1:200

PLAN OF PROPOSED LOT 1325 ON SP357495
DESCRIBED AS: PART OF LOT 114 ON SP256133
EXISTING TITLE REFERENCE: 50945046
LOCALITY: REDBANK PLAINS
LOCAL GOVERNMENT: IPSWICH CITY COUNCIL

DRAWING TITLE: DISCLOSURE PLAN
DRAWING NO.: 9919 S 13 DP A_1325



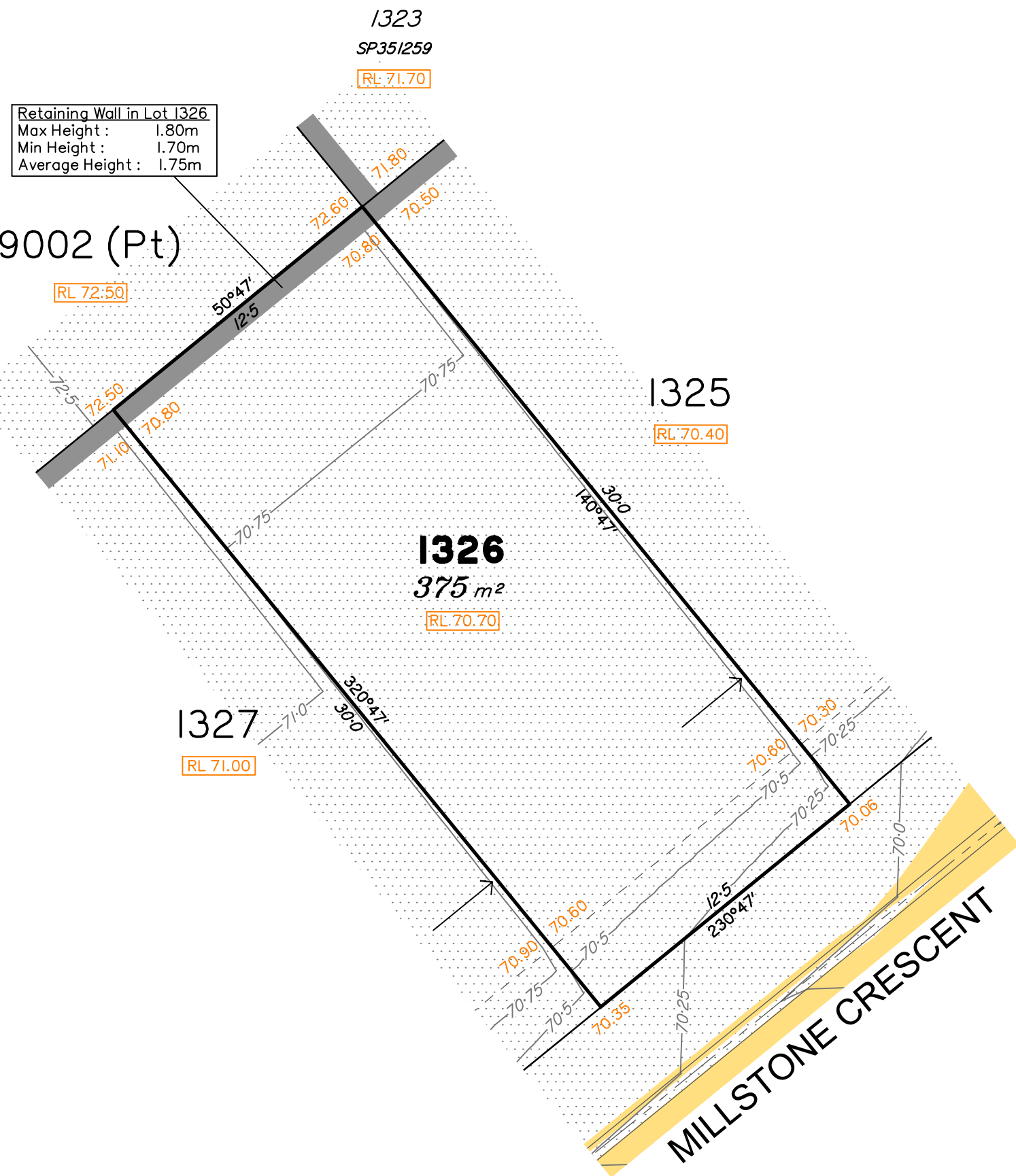

Retaining Wall in Lot 1326
 Max Height : 1.80m
 Min Height : 1.70m
 Average Height : 1.75m

LEGEND	
	Area of Cut
	Area of Fill
	Design Contours
	Depth of Fill
	Batter Line / Change of Grade
	Retaining Wall
	Preferred Earthworks Pad Level
	Finished Surface Design Level
	Optional Built to Boundary Wall
	300mm x 300mm Subsurface Drainage Pit (indicative location)

(Not all items in this legend may be relevant to the lot shown on this plan)

NOTES

This plan has been prepared from preliminary survey plan (SP357495) and engineering data provided on the 11/08/2025 by KN Group Pty Ltd.

Development approval was granted for this subdivision by the Ipswich City Council on 18/06/2024.
 (Application No: 9367/2022/CA).
 For updates to this approval visit www.ipswich.qld.gov.au

Development approval for operational works for this lot was granted by Ipswich City Council on 04/07/2025 (Application No: 3884/2025/OW)

EDEN'S CROSSING
 STAGE 32A

PEET

Saunders Havill
 BOWEN HILLS | SPRINGFIELD
 1300 123 744 | mail@saundershavill.com



ISSUES			
NO.	DRAWN	DATE	DESCRIPTION
A	MS	02.09.2025	ORIGINAL ISSUE

THIS DISCLOSURE PLAN IS PREPARED FOR THE SOLE PURPOSE OF SATISFYING THE DISCLOSURE REQUIREMENTS OF THE LAND SALES ACT AND **SHOULD NOT** BE USED FOR ANY OTHER PURPOSE, PARTICULARLY AS-CONSTRUCTED PURPOSES. THIS INFORMATION IS COMPILED FROM DESIGN PLANS ONLY, UNLESS OTHERWISE STATED, AND THEREFORE IS SUBJECT TO FINAL SURVEY AND CONSTRUCTION OF OPERATIONAL WORKS.

LEVEL DATUM:	AHD Der.
ORIGIN OF LEVELS:	PM203677
RL OF ORIGIN:	80.916
CONTOUR INTERVAL:	0.25m
SCALE	0 1 2 5m
1:200	

PLAN OF	PROPOSED LOT 1326 ON SP357495
DESCRIBED AS:	PART OF LOT 114 ON SP256133
EXISTING TITLE REFERENCE:	50945046
LOCALITY:	REDBANK PLAINS
LOCAL GOVERNMENT:	IPSWICH CITY COUNCIL

DRAWING TITLE	DISCLOSURE PLAN
DRAWING NO.	9919 S 13 DP A_1326



LEGEND	
	Area of Cut
	Area of Fill
	Design Contours
	Depth of Fill
	Batter Line / Change of Grade
	Retaining Wall
	Preferred Earthworks Pad Level
	Finished Surface Design Level
	Optional Built to Boundary Wall
	300mm x 300mm Subsurface Drainage Pit (indicative location)

(Not all items in this legend may be relevant to the lot shown on this plan)

NOTES

This plan has been prepared from preliminary survey plan (SP357495) and engineering data provided on the 11/08/2025 by KN Group Pty Ltd.

Development approval was granted for this subdivision by the Ipswich City Council on 18/06/2024. (Application No: 9367/2022/CA). For updates to this approval visit www.ipswich.qld.gov.au

Development approval for operational works for this lot was granted by Ipswich City Council on 04/07/2025 (Application No: 3884/2025/OW)

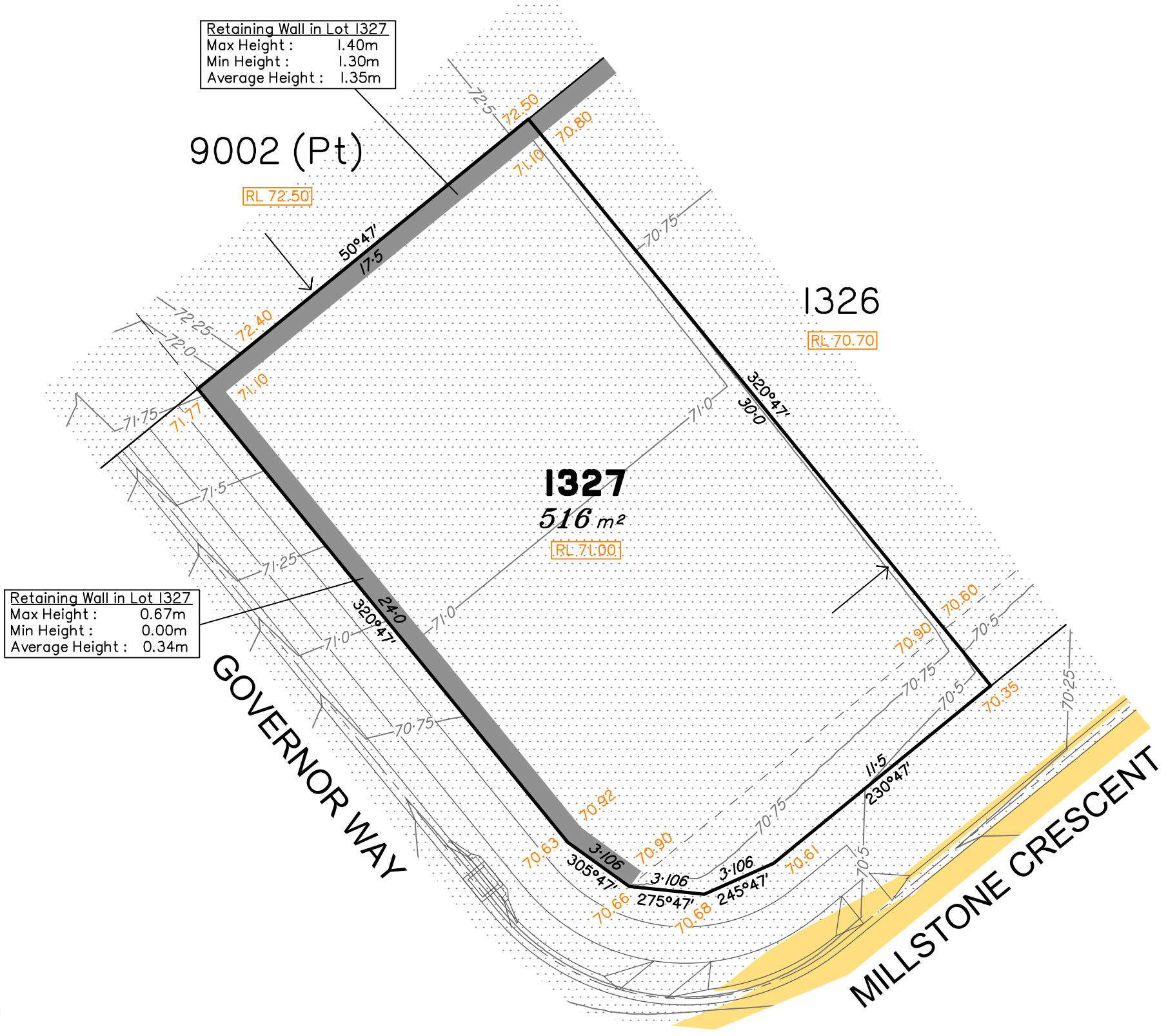

Retaining Wall in Lot 1327
Max Height : 1.40m
Min Height : 1.30m
Average Height : 1.35m

Retaining Wall in Lot 1327
Max Height : 0.67m
Min Height : 0.00m
Average Height : 0.34m



ISSUES			
NO.	DRAWN	DATE	DESCRIPTION
A	MS	02.09.2025	ORIGINAL ISSUE

THIS DISCLOSURE PLAN IS PREPARED FOR THE SOLE PURPOSE OF SATISFYING THE DISCLOSURE REQUIREMENTS OF THE LAND SALES ACT AND SHOULD NOT BE USED FOR ANY OTHER PURPOSE, PARTICULARLY AS-CONSTRUCTED PURPOSES. THIS INFORMATION IS COMPILED FROM DESIGN PLANS ONLY, UNLESS OTHERWISE STATED, AND THEREFORE IS SUBJECT TO FINAL SURVEY AND CONSTRUCTION OF OPERATIONAL WORKS.

LEVEL DATUM:	AHD Der.
ORIGIN OF LEVELS:	PM203677
RL OF ORIGIN:	80.916
CONTOUR INTERVAL:	0.25m
SCALE	0 1 2 5m
1:200	

PLAN OF	PROPOSED LOT 1327 ON SP357495
DESCRIBED AS:	PART OF LOT 114 ON SP256133
EXISTING TITLE REFERENCE:	50945046
LOCALITY:	REDBANK PLAINS
LOCAL GOVERNMENT:	IPSWICH CITY COUNCIL

DRAWING TITLE	DISCLOSURE PLAN
DRAWING NO.	9919 S 13 DP A_1327



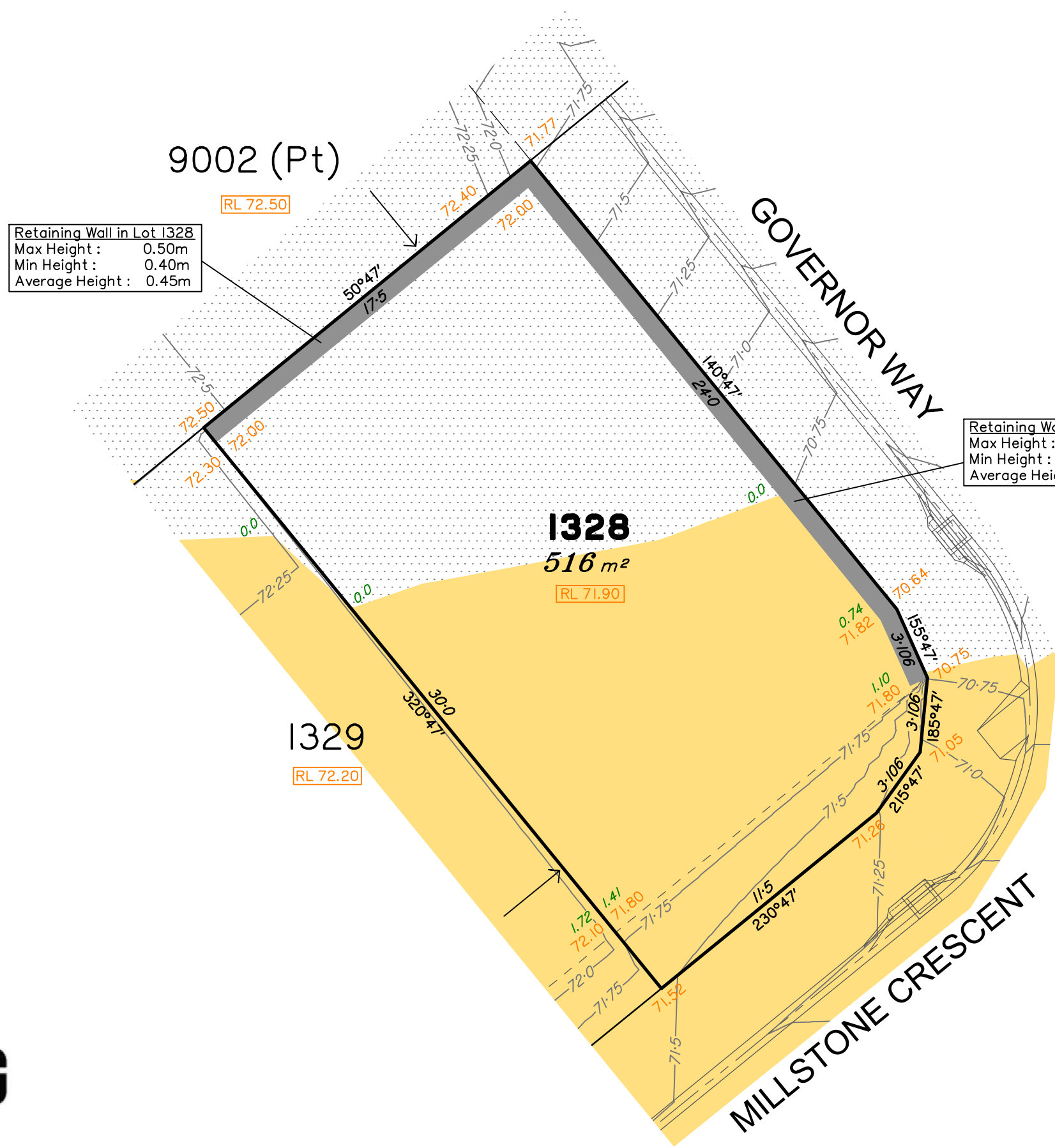

Retaining Wall in Lot 1328
Max Height : 0.50m
Min Height : 0.40m
Average Height : 0.45m

Retaining Wall in Lot 1328
Max Height : 1.18m
Min Height : 0.23m
Average Height : 0.71m

LEGEND	
	Area of Cut
	Area of Fill
	Design Contours
	Depth of Fill
	Batter Line / Change of Grade
	Retaining Wall
	Preferred Earthworks Pad Level
	Finished Surface Design Level
	Optional Built to Boundary Wall
	300mm x 300mm Subsurface Drainage Pit (indicative location)

(Not all items in this legend may be relevant to the lot shown on this plan)

NOTES

This plan has been prepared from preliminary survey plan (SP357495) and engineering data provided on the 11/08/2025 by KN Group Pty Ltd.

Development approval was granted for this subdivision by the Ipswich City Council on 18/06/2024.
(Application No: 9367/2022/CA).
For updates to this approval visit www.ipswich.qld.gov.au

Development approval for operational works for this lot was granted by Ipswich City Council on 04/07/2025 (Application No: 3884/2025/OW)

All fill shall be placed and compacted in a controlled manner so that Level 1 level of responsibility may be achieved and certified as per AS3798-2007.

ISSUES			
NO.	DRAWN	DATE	DESCRIPTION
A	MS	02.09.2025	ORIGINAL ISSUE

THIS DISCLOSURE PLAN IS PREPARED FOR THE SOLE PURPOSE OF SATISFYING THE DISCLOSURE REQUIREMENTS OF THE LAND SALES ACT AND **SHOULD NOT** BE USED FOR ANY OTHER PURPOSE, PARTICULARLY AS-CONSTRUCTED PURPOSES. THIS INFORMATION IS COMPILED FROM DESIGN PLANS ONLY, UNLESS OTHERWISE STATED, AND THEREFORE IS SUBJECT TO FINAL SURVEY AND CONSTRUCTION OF OPERATIONAL WORKS.

LEVEL DATUM:	AHD Der.
ORIGIN OF LEVELS:	PM203677
RL OF ORIGIN:	80.916
CONTOUR INTERVAL:	0.25m
SCALE	0 1 2 5m
1:200	

PLAN OF	PROPOSED LOT 1328 ON SP357495
DESCRIBED AS:	PART OF LOT 114 ON SP256133
EXISTING TITLE REFERENCE:	50945046
LOCALITY:	REDBANK PLAINS
LOCAL GOVERNMENT:	IPSWICH CITY COUNCIL

DRAWING TITLE	DISCLOSURE PLAN
DRAWING NO.	9919 S 13 DP A_1328



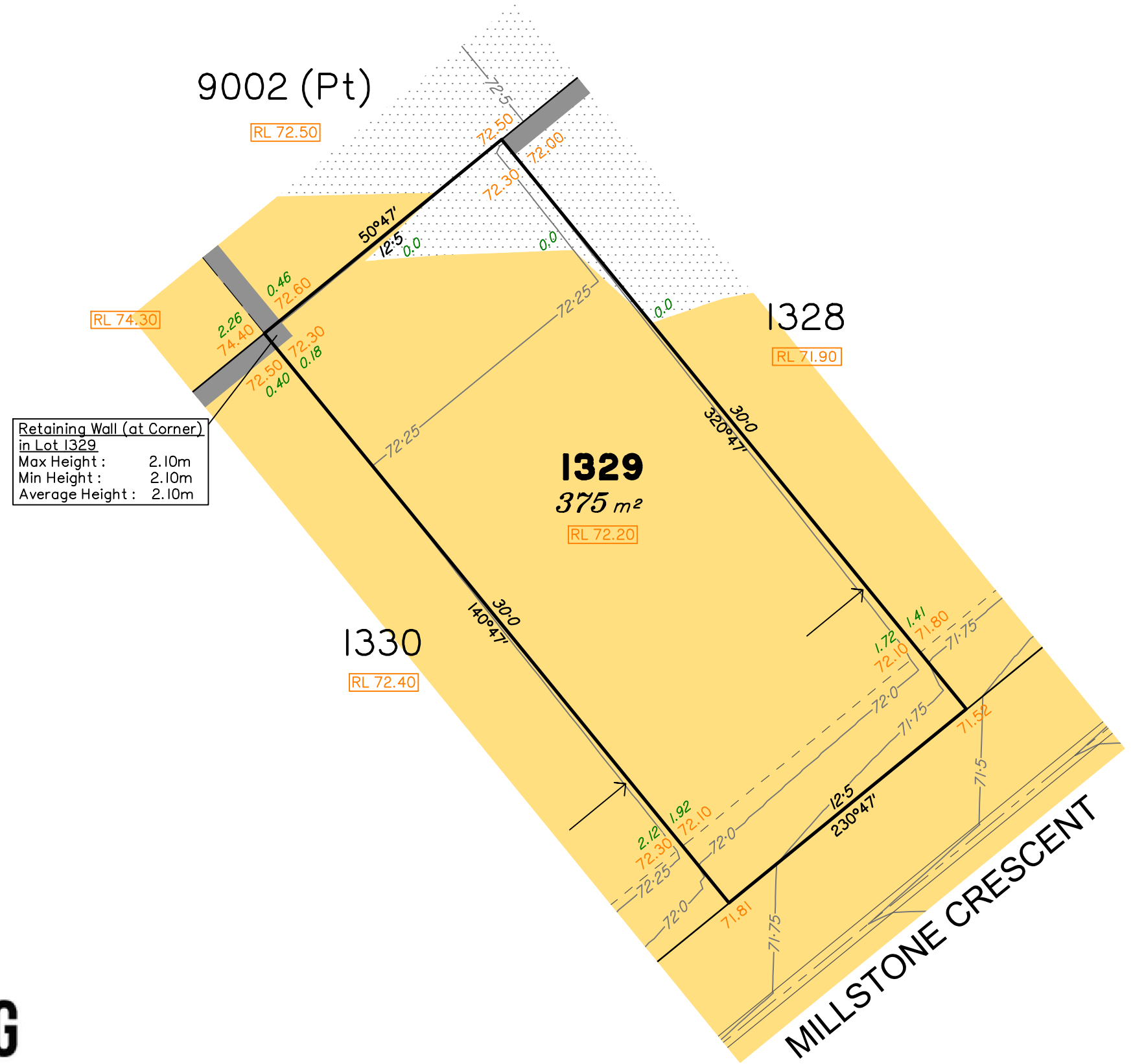

Retaining Wall (at Corner) in Lot 1329
Max Height : 2.10m
Min Height : 2.10m
Average Height : 2.10m

LEGEND	
	Area of Cut
	Area of Fill
	Design Contours
	Depth of Fill
	Batter Line / Change of Grade
	Retaining Wall
	Preferred Earthworks Pad Level
	Finished Surface Design Level
	Optional Built to Boundary Wall
	300mm x 300mm Subsurface Drainage Pit (indicative location)

(Not all items in this legend may be relevant to the lot shown on this plan)

NOTES

This plan has been prepared from preliminary survey plan (SP357495) and engineering data provided on the 11/08/2025 by KN Group Pty Ltd.

Development approval was granted for this subdivision by the Ipswich City Council on 18/06/2024.
(Application No: 9367/2022/CA).
For updates to this approval visit www.ipswich.qld.gov.au

Development approval for operational works for this lot was granted by Ipswich City Council on 04/07/2025 (Application No: 3884/2025/OW)

All fill shall be placed and compacted in a controlled manner so that Level 1 level of responsibility may be achieved and certified as per AS3798-2007.

ISSUES			
NO.	DRAWN	DATE	DESCRIPTION
A	MS	02.09.2025	ORIGINAL ISSUE

THIS DISCLOSURE PLAN IS PREPARED FOR THE SOLE PURPOSE OF SATISFYING THE DISCLOSURE REQUIREMENTS OF THE LAND SALES ACT AND **SHOULD NOT** BE USED FOR ANY OTHER PURPOSE, PARTICULARLY AS-CONSTRUCTED PURPOSES. THIS INFORMATION IS COMPILED FROM DESIGN PLANS ONLY, UNLESS OTHERWISE STATED, AND THEREFORE IS SUBJECT TO FINAL SURVEY AND CONSTRUCTION OF OPERATIONAL WORKS.

LEVEL DATUM:	AHD Der.
ORIGIN OF LEVELS:	PM203677
RL OF ORIGIN:	80.916
CONTOUR INTERVAL:	0.25m
SCALE	0 1 2 5m
1:200	

PLAN OF	PROPOSED LOT 1329 ON SP357495
DESCRIBED AS:	PART OF LOT 114 ON SP256133
EXISTING TITLE REFERENCE:	50945046
LOCALITY:	REDBANK PLAINS
LOCAL GOVERNMENT:	IPSWICH CITY COUNCIL

DRAWING TITLE	DISCLOSURE PLAN
DRAWING NO.	9919 S 13 DP A_1329





ISSUES			
NO.	DRAWN	DATE	DESCRIPTION
A	MS	02.09.2025	ORIGINAL ISSUE

THIS DISCLOSURE PLAN IS PREPARED FOR THE SOLE PURPOSE OF SATISFYING THE DISCLOSURE REQUIREMENTS OF THE LAND SALES ACT AND **SHOULD NOT** BE USED FOR ANY OTHER PURPOSE, PARTICULARLY AS-CONSTRUCTED PURPOSES. THIS INFORMATION IS COMPILED FROM DESIGN PLANS ONLY, UNLESS OTHERWISE STATED, AND THEREFORE IS SUBJECT TO FINAL SURVEY AND CONSTRUCTION OF OPERATIONAL WORKS.

LEVEL DATUM:	AHD Der.
ORIGIN OF LEVELS:	PM203677
RL OF ORIGIN:	80.916
CONTOUR INTERVAL:	0.25m
SCALE	0 1 2 5m
1:200	

PLAN OF	PROPOSED LOT 1330 ON SP357495
DESCRIBED AS:	PART OF LOT 114 ON SP256133
EXISTING TITLE REFERENCE:	50945046
LOCALITY:	REDBANK PLAINS
LOCAL GOVERNMENT:	IPSWICH CITY COUNCIL

DRAWING TITLE	DISCLOSURE PLAN
DRAWING NO.	9919 S 13 DP A_1330

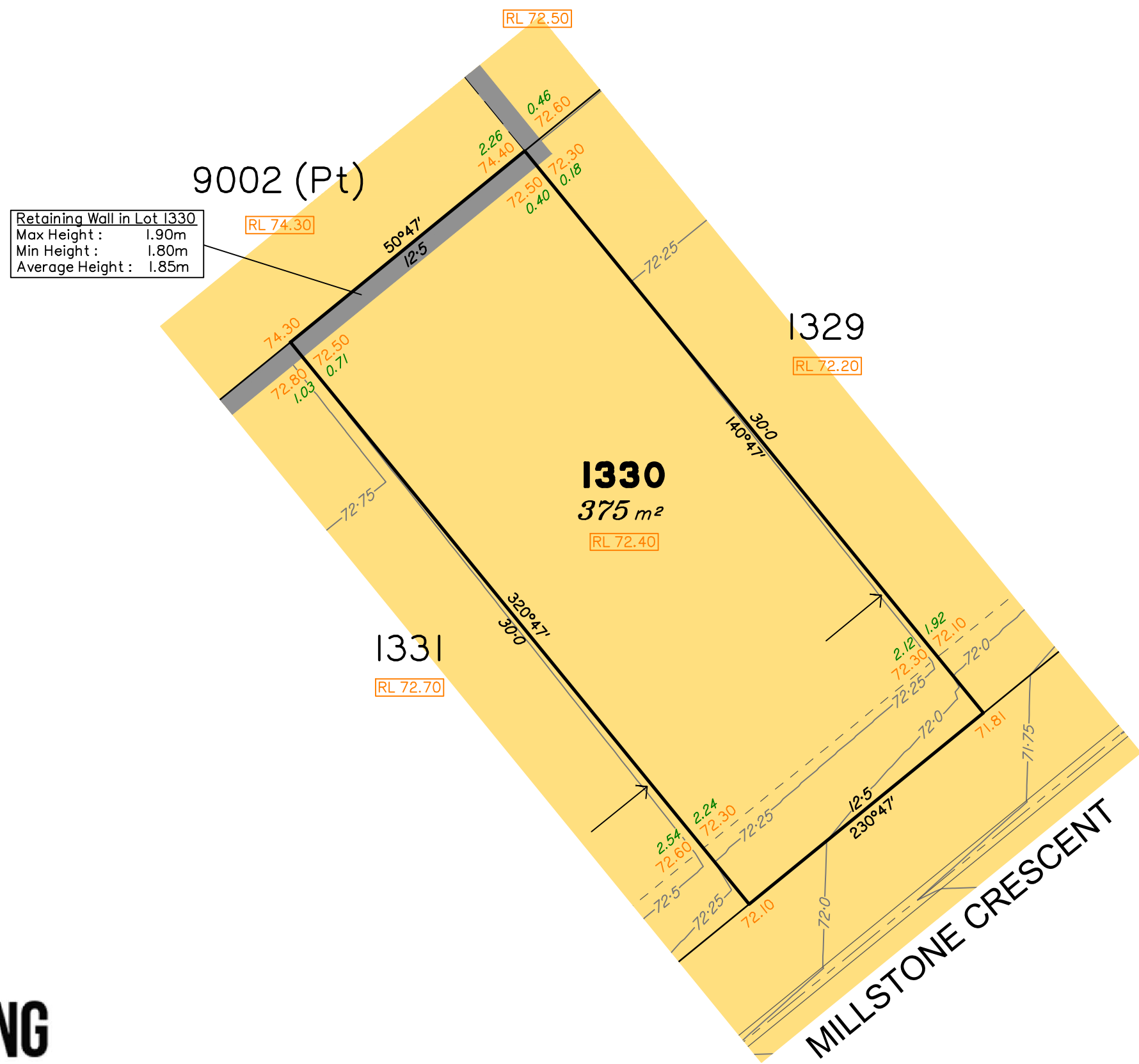

Retaining Wall in Lot 1330
Max Height : 1.90m
Min Height : 1.80m
Average Height : 1.85m

LEGEND	
	Area of Cut
	Area of Fill
	Design Contours
	Depth of Fill
	Batter Line / Change of Grade
	Retaining Wall
	Preferred Earthworks Pad Level
	Finished Surface Design Level
	Optional Built to Boundary Wall
	300mm x 300mm Subsurface Drainage Pit (indicative location)

(Not all items in this legend may be relevant to the lot shown on this plan)

NOTES

This plan has been prepared from preliminary survey plan (SP357495) and engineering data provided on the 11/08/2025 by KN Group Pty Ltd.

Development approval was granted for this subdivision by the Ipswich City Council on 18/06/2024. (Application No: 9367/2022/CA). For updates to this approval visit www.ipswich.qld.gov.au

Development approval for operational works for this lot was granted by Ipswich City Council on 04/07/2025 (Application No: 3884/2025/OW)

All fill shall be placed and compacted in a controlled manner so that Level 1 level of responsibility may be achieved and certified as per AS3798-2007.

LEGEND	
	Area of Cut
	Area of Fill
	Design Contours
	Depth of Fill
	Batter Line / Change of Grade
	Retaining Wall
	Preferred Earthworks Pad Level
	Finished Surface Design Level
	Optional Built to Boundary Wall
	300mm x 300mm Subsurface Drainage Pit (indicative location)

(Not all items in this legend may be relevant to the lot shown on this plan)

NOTES

This plan has been prepared from preliminary survey plan (SP357495) and engineering data provided on the 11/08/2025 by KN Group Pty Ltd.

Development approval was granted for this subdivision by the Ipswich City Council on 18/06/2024. (Application No: 9367/2022/CA). For updates to this approval visit www.ipswich.qld.gov.au

Development approval for operational works for this lot was granted by Ipswich City Council on 04/07/2025 (Application No: 3884/2025/OW)

All fill shall be placed and compacted in a controlled manner so that Level 1 level of responsibility may be achieved and certified as per AS3798-2007.

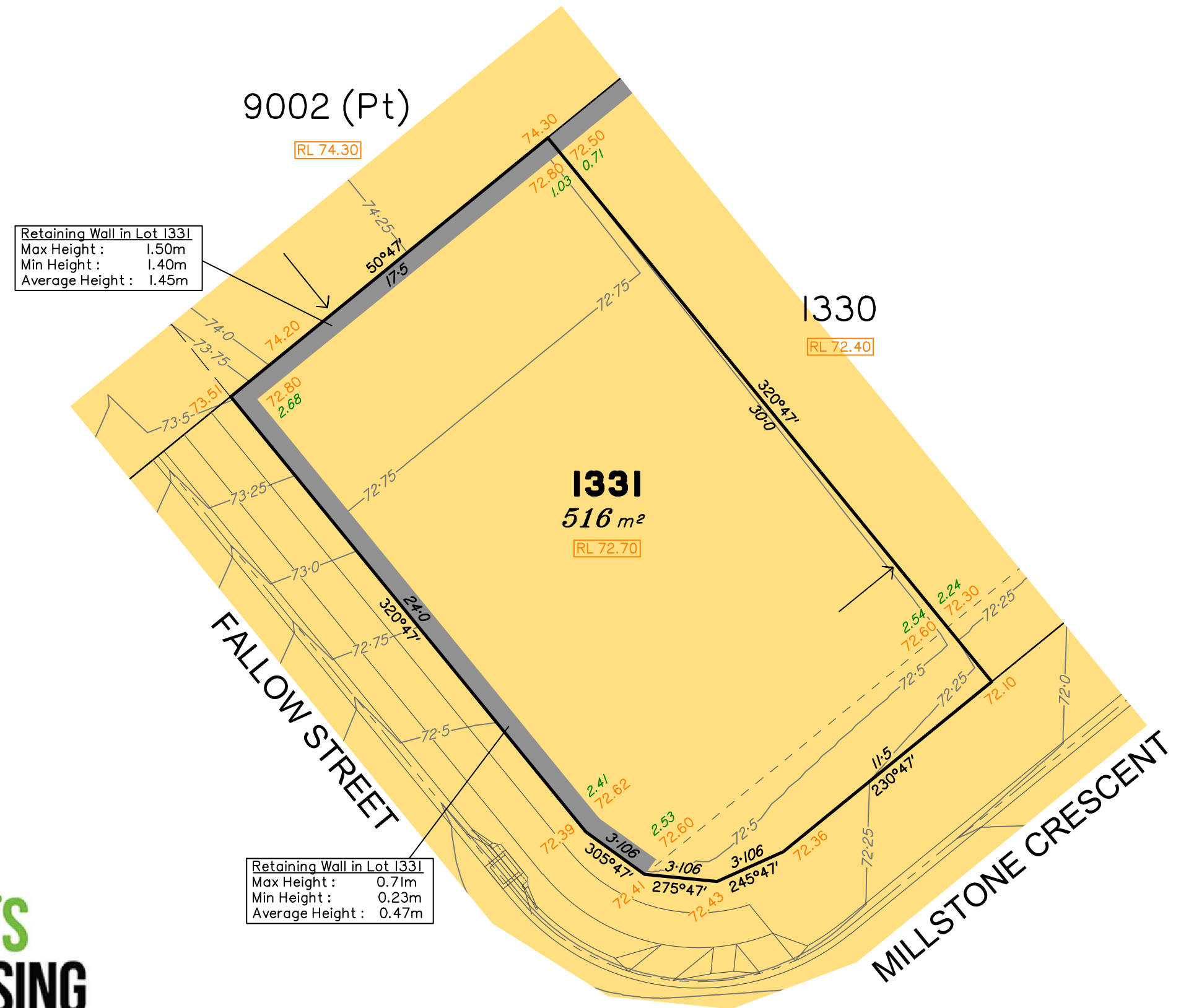

Retaining Wall in Lot 1331
 Max Height : 1.50m
 Min Height : 1.40m
 Average Height : 1.45m

Retaining Wall in Lot 1331
 Max Height : 0.71m
 Min Height : 0.23m
 Average Height : 0.47m

EDEN'S CROSSING
 STAGE 32A

PEET

Saunders Havill
 BOWEN HILLS | SPRINGFIELD
 1300 123 744 | mail@saundershavill.com



ISSUES			
NO.	DRAWN	DATE	DESCRIPTION
A	MS	02.09.2025	ORIGINAL ISSUE

CHECKED: AH

THIS DISCLOSURE PLAN IS PREPARED FOR THE SOLE PURPOSE OF SATISFYING THE DISCLOSURE REQUIREMENTS OF THE LAND SALES ACT AND SHOULD NOT BE USED FOR ANY OTHER PURPOSE, PARTICULARLY AS-CONSTRUCTED PURPOSES. THIS INFORMATION IS COMPILED FROM DESIGN PLANS ONLY, UNLESS OTHERWISE STATED, AND THEREFORE IS SUBJECT TO FINAL SURVEY AND CONSTRUCTION OF OPERATIONAL WORKS.

LEVEL DATUM: AHD Der.
 ORIGIN OF LEVELS: PM203677
 RL OF ORIGIN: 80.916
 CONTOUR INTERVAL: 0.25m
 SCALE: 1:200

PLAN OF PROPOSED LOT 1331 ON SP357495
 DESCRIBED AS: PART OF LOT 114 ON SP256133
 EXISTING TITLE REFERENCE: 50945046
 LOCALITY: REDBANK PLAINS
 LOCAL GOVERNMENT: IPSWICH CITY COUNCIL

DRAWING TITLE: DISCLOSURE PLAN
 DRAWING NO.: 9919 S 13 DP A_1331





ISSUES			
NO.	DRAWN	DATE	DESCRIPTION
A	MS	02.09.2025	ORIGINAL ISSUE

THIS DISCLOSURE PLAN IS PREPARED FOR THE SOLE PURPOSE OF SATISFYING THE DISCLOSURE REQUIREMENTS OF THE LAND SALES ACT AND **SHOULD NOT** BE USED FOR ANY OTHER PURPOSE, PARTICULARLY AS-CONSTRUCTED PURPOSES. THIS INFORMATION IS COMPILED FROM DESIGN PLANS ONLY, UNLESS OTHERWISE STATED, AND THEREFORE IS SUBJECT TO FINAL SURVEY AND CONSTRUCTION OF OPERATIONAL WORKS.

LEVEL DATUM:	AHD Der.
ORIGIN OF LEVELS:	PM203677
RL OF ORIGIN:	80.916
CONTOUR INTERVAL:	0.25m
SCALE	0 1 2 5m
1:200	

PLAN OF	PROPOSED LOT 1332 ON SP357495
DESCRIBED AS:	PART OF LOT 114 ON SP256133
EXISTING TITLE REFERENCE:	50945046
LOCALITY:	REDBANK PLAINS
LOCAL GOVERNMENT:	IPSWICH CITY COUNCIL

DRAWING TITLE	DISCLOSURE PLAN
DRAWING NO.	9919 S 13 DP A_1332

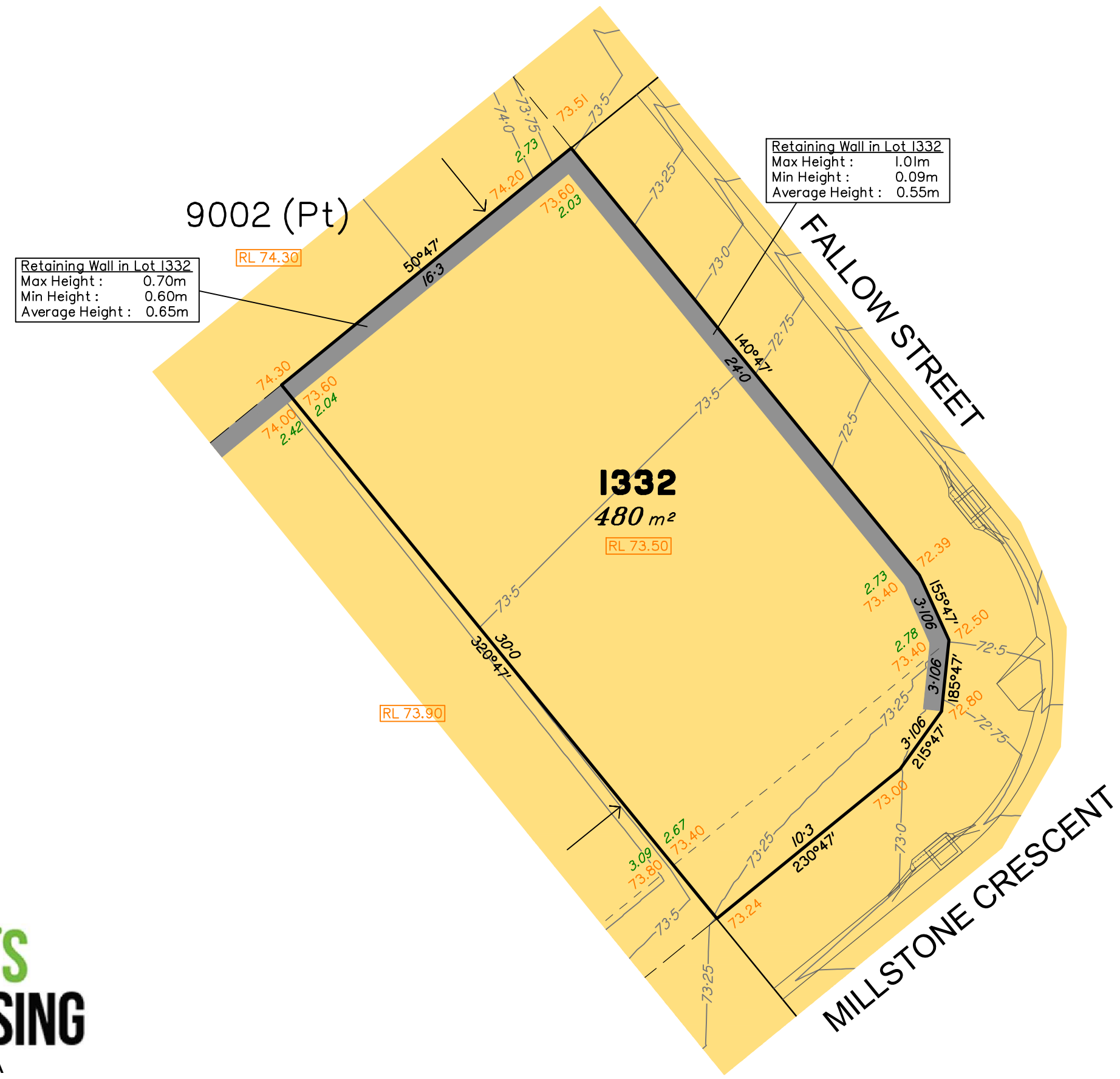

Retaining Wall in Lot 1332
Max Height : 0.70m
Min Height : 0.60m
Average Height : 0.65m

Retaining Wall in Lot 1332
Max Height : 1.01m
Min Height : 0.09m
Average Height : 0.55m

LEGEND	
	Area of Cut
	Area of Fill
	Design Contours
	1:2 Depth of Fill
	Batter Line / Change of Grade
	Retaining Wall
	RL XX.XX Preferred Earthworks Pad Level
	XX.XX Finished Surface Design Level
	Optional Built to Boundary Wall
	300mm x 300mm Subsurface Drainage Pit (indicative location)

(Not all items in this legend may be relevant to the lot shown on this plan)

NOTES

This plan has been prepared from preliminary survey plan (SP357495) and engineering data provided on the 11/08/2025 by KN Group Pty Ltd.

Development approval was granted for this subdivision by the Ipswich City Council on 18/06/2024.
(Application No: 9367/2022/CA).
For updates to this approval visit www.ipswich.qld.gov.au

Development approval for operational works for this lot was granted by Ipswich City Council on 04/07/2025 (Application No: 3884/2025/OW)

All fill shall be placed and compacted in a controlled manner so that Level 1 level of responsibility may be achieved and certified as per AS3798-2007.

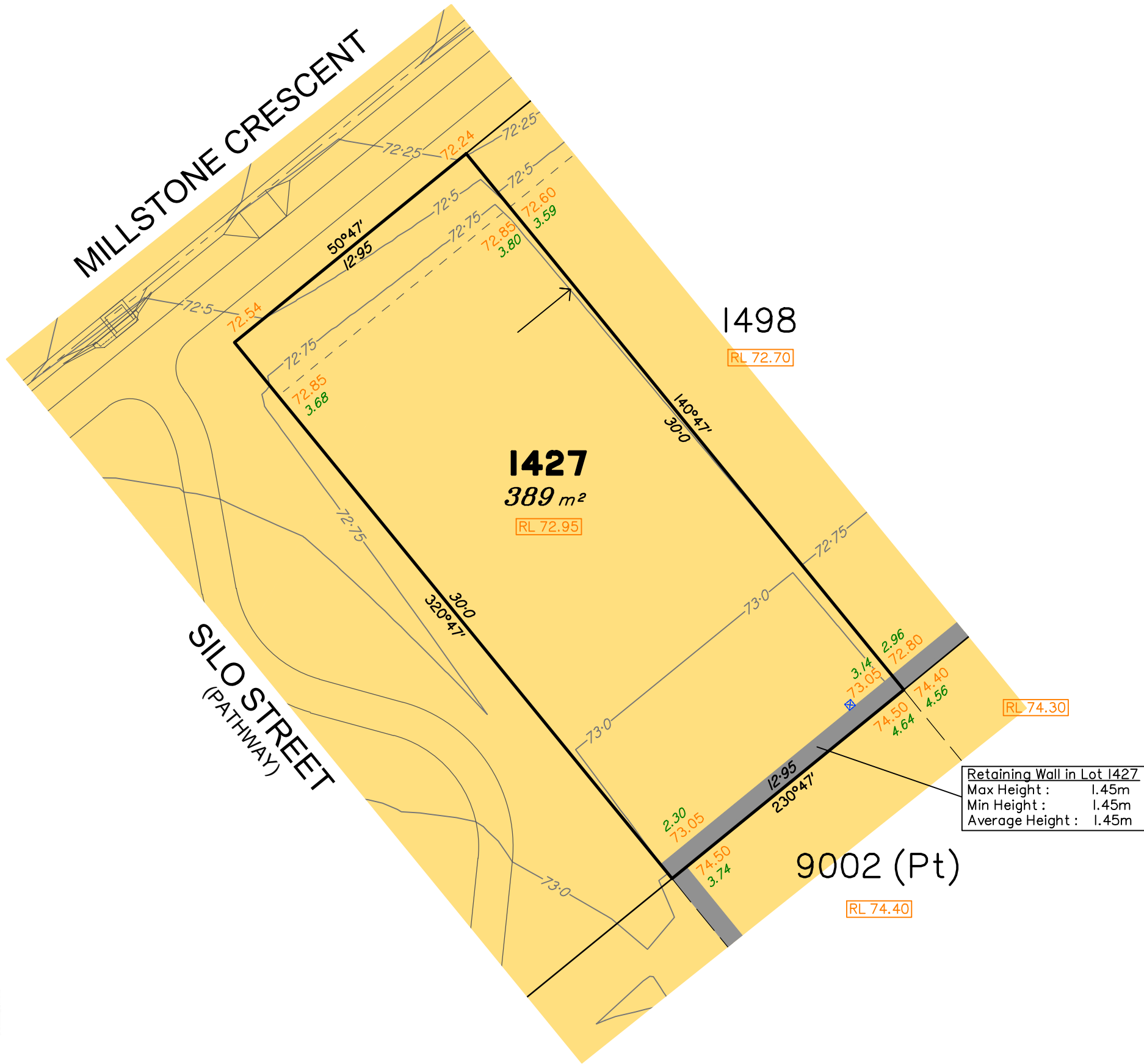

LEGEND	
	Area of Cut
	Area of Fill
	Design Contours
	Depth of Fill
	Batter Line / Change of Grade
	Retaining Wall
	Preferred Earthworks Pad Level
	Finished Surface Design Level
	Optional Built to Boundary Wall
	300mm x 300mm Subsurface Drainage Pit (indicative location)

(Not all items in this legend may be relevant to the lot shown on this plan)

NOTES

This plan has been prepared from preliminary survey plan (SP357495) and engineering data provided on the 11/08/2025 by KN Group Pty Ltd.

Development approval was granted for this subdivision by the Ipswich City Council on 18/06/2024. (Application No: 9367/2022/CA). For updates to this approval visit www.ipswich.qld.gov.au

Development approval for operational works for this lot was granted by Ipswich City Council on 04/07/2025 (Application No: 3884/2025/OW)

All fill shall be placed and compacted in a controlled manner so that Level 1 level of responsibility may be achieved and certified as per AS3798-2007.

Retaining Wall in Lot 1427
 Max Height : 1.45m
 Min Height : 1.45m
 Average Height : 1.45m

EDEN'S CROSSING
 STAGE 32A

PEET

Saunders Havill
 BOWEN HILLS | SPRINGFIELD
 1300 123 744 | mail@saundershavill.com



ISSUES			
NO.	DRAWN	DATE	DESCRIPTION
A	MS	02.09.2025	ORIGINAL ISSUE

THIS DISCLOSURE PLAN IS PREPARED FOR THE SOLE PURPOSE OF SATISFYING THE DISCLOSURE REQUIREMENTS OF THE LAND SALES ACT AND **SHOULD NOT** BE USED FOR ANY OTHER PURPOSE, PARTICULARLY AS-CONSTRUCTED PURPOSES. THIS INFORMATION IS COMPILED FROM DESIGN PLANS ONLY, UNLESS OTHERWISE STATED, AND THEREFORE IS SUBJECT TO FINAL SURVEY AND CONSTRUCTION OF OPERATIONAL WORKS.

LEVEL DATUM:	AHD Der.
ORIGIN OF LEVELS:	PM203677
RL OF ORIGIN:	80.916
CONTOUR INTERVAL:	0.25m
SCALE	0 1 2 5m
1:200	

PLAN OF	PROPOSED LOT 1427 ON SP357495
DESCRIBED AS:	PART OF LOT 114 ON SP256133
EXISTING TITLE REFERENCE:	50945046
LOCALITY:	REDBANK PLAINS
LOCAL GOVERNMENT:	IPSWICH CITY COUNCIL

DRAWING TITLE	DISCLOSURE PLAN
DRAWING NO.	9919 S 13 DP A_1427



MILLSTONE CRESCENT

NORTON SANDS DRIVE

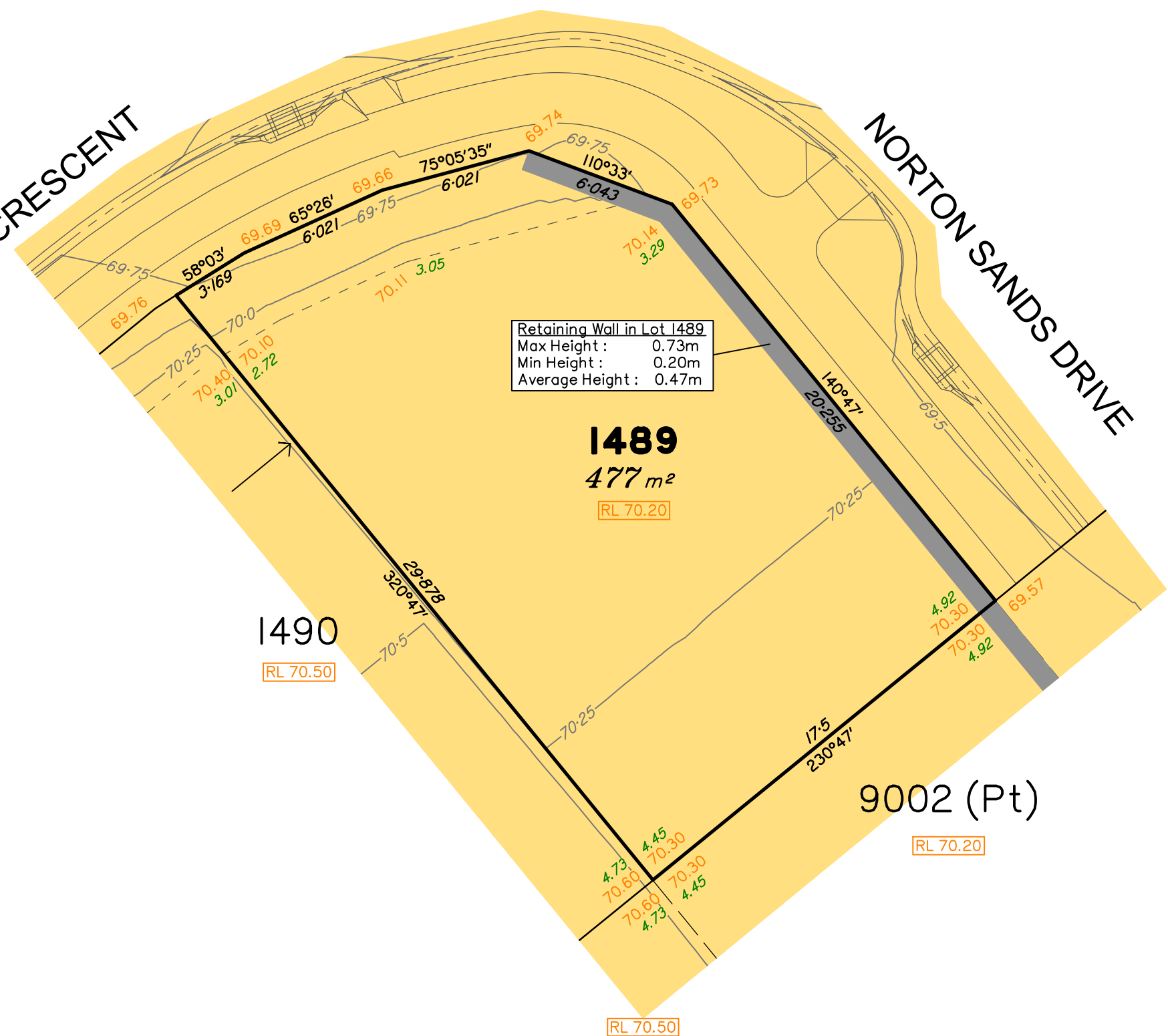

Retaining Wall in Lot 1489
 Max Height : 0.73m
 Min Height : 0.20m
 Average Height : 0.47m

1489
 477 m²
 RL 70.20

1490
 RL 70.50

9002 (Pt)
 RL 70.20

LEGEND	
	Area of Cut
	Area of Fill
	Design Contours
	Depth of Fill
	Batter Line / Change of Grade
	Retaining Wall
	Preferred Earthworks Pad Level
	Finished Surface Design Level
	Optional Built to Boundary Wall
	300mm x 300mm Subsurface Drainage Pit (indicative location)

(Not all items in this legend may be relevant to the lot shown on this plan)

NOTES

This plan has been prepared from preliminary survey plan (SP357495) and engineering data provided on the 11/08/2025 by KN Group Pty Ltd.

Development approval was granted for this subdivision by the Ipswich City Council on 18/06/2024. (Application No: 9367/2022/CA). For updates to this approval visit www.ipswich.qld.gov.au

Development approval for operational works for this lot was granted by Ipswich City Council on 04/07/2025 (Application No: 3884/2025/OW)

All fill shall be placed and compacted in a controlled manner so that Level 1 level of responsibility may be achieved and certified as per AS3798-2007.

EDEN'S CROSSING
 STAGE 32A

PEET

Saunders Havill
 BOWEN HILLS | SPRINGFIELD
 1300 123 744 | mail@saundershavill.com



ISSUES			
NO.	DRAWN	DATE	DESCRIPTION
A	MS	02.09.2025	ORIGINAL ISSUE

THIS DISCLOSURE PLAN IS PREPARED FOR THE SOLE PURPOSE OF SATISFYING THE DISCLOSURE REQUIREMENTS OF THE LAND SALES ACT AND **SHOULD NOT** BE USED FOR ANY OTHER PURPOSE, PARTICULARLY AS-CONSTRUCTED PURPOSES. THIS INFORMATION IS COMPILED FROM DESIGN PLANS ONLY, UNLESS OTHERWISE STATED, AND THEREFORE IS SUBJECT TO FINAL SURVEY AND CONSTRUCTION OF OPERATIONAL WORKS.

LEVEL DATUM:	AHD Der.
ORIGIN OF LEVELS:	PM203677
RL OF ORIGIN:	80.916
CONTOUR INTERVAL:	0.25m
SCALE	0 1 2 5m
1:200	

PLAN OF	PROPOSED LOT 1489 ON SP357495
DESCRIBED AS:	PART OF LOT 114 ON SP256133
EXISTING TITLE REFERENCE:	50945046
LOCALITY:	REDBANK PLAINS
LOCAL GOVERNMENT:	IPSWICH CITY COUNCIL

DRAWING TITLE	DISCLOSURE PLAN
DRAWING NO.	9919 S 13 DP A_1489



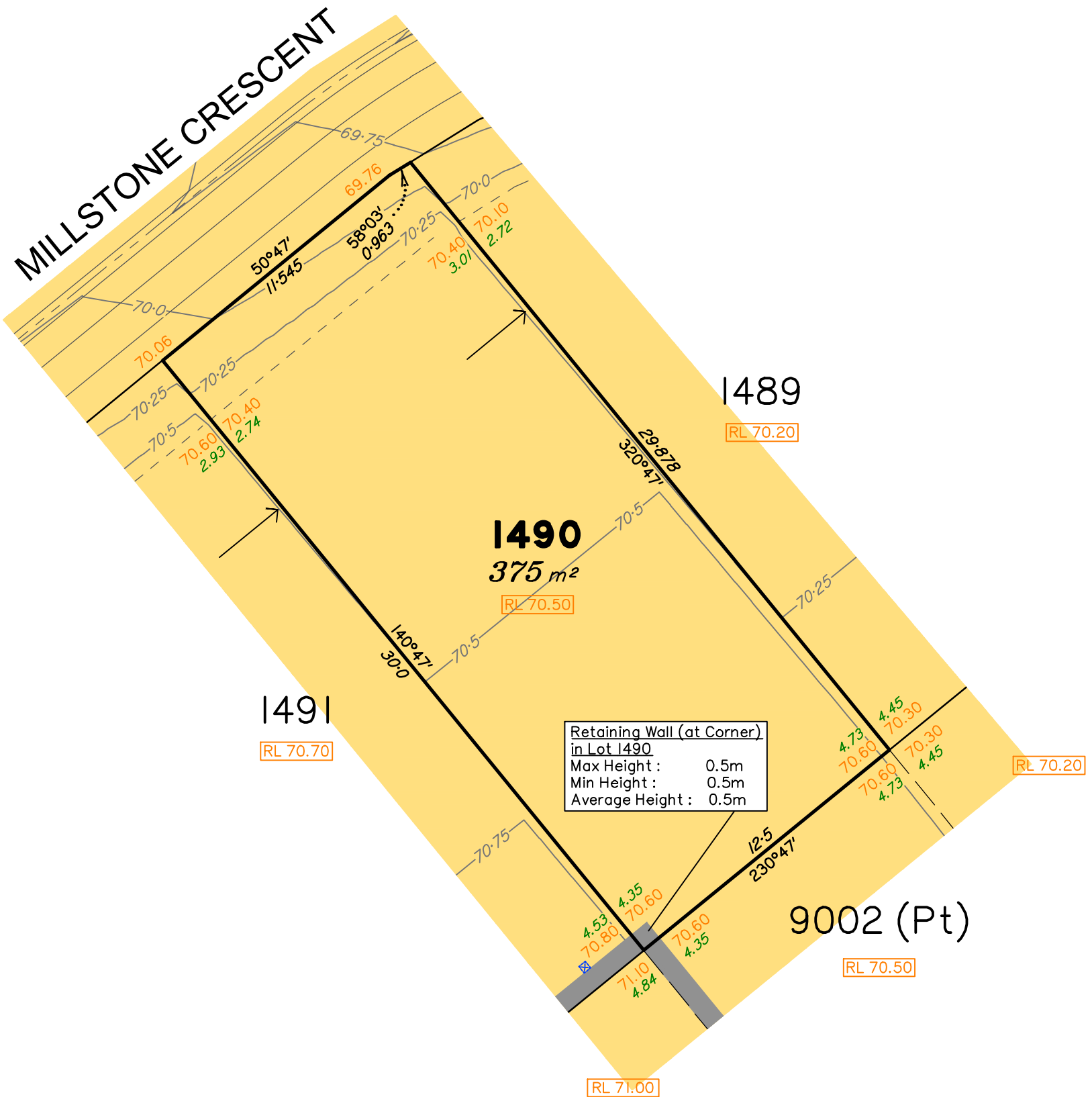

LEGEND	
	Area of Cut
	Area of Fill
	Design Contours
	Depth of Fill
	Batter Line / Change of Grade
	Retaining Wall
	Preferred Earthworks Pad Level
	Finished Surface Design Level
	Optional Built to Boundary Wall
	300mm x 300mm Subsurface Drainage Pit (indicative location)

(Not all items in this legend may be relevant to the lot shown on this plan)

NOTES

This plan has been prepared from preliminary survey plan (SP357495) and engineering data provided on the 11/08/2025 by KN Group Pty Ltd.

Development approval was granted for this subdivision by the Ipswich City Council on 18/06/2024. (Application No: 9367/2022/CA). For updates to this approval visit www.ipswich.qld.gov.au

Development approval for operational works for this lot was granted by Ipswich City Council on 04/07/2025 (Application No: 3884/2025/OW)

All fill shall be placed and compacted in a controlled manner so that Level 1 level of responsibility may be achieved and certified as per AS3798-2007.

Retaining Wall (at Corner) in Lot 1490
 Max Height : 0.5m
 Min Height : 0.5m
 Average Height : 0.5m

EDEN'S CROSSING
 STAGE 32A

PEET

Saunders Havill
 BOWEN HILLS | SPRINGFIELD
 1300 123 744 | mail@saundershavill.com



ISSUES			
NO.	DRAWN	DATE	DESCRIPTION
A	MS	02.09.2025	ORIGINAL ISSUE

THIS DISCLOSURE PLAN IS PREPARED FOR THE SOLE PURPOSE OF SATISFYING THE DISCLOSURE REQUIREMENTS OF THE LAND SALES ACT AND **SHOULD NOT** BE USED FOR ANY OTHER PURPOSE, PARTICULARLY AS-CONSTRUCTED PURPOSES. THIS INFORMATION IS COMPILED FROM DESIGN PLANS ONLY, UNLESS OTHERWISE STATED, AND THEREFORE IS SUBJECT TO FINAL SURVEY AND CONSTRUCTION OF OPERATIONAL WORKS.

LEVEL DATUM:	AHD Der.
ORIGIN OF LEVELS:	PM203677
RL OF ORIGIN:	80.916
CONTOUR INTERVAL:	0.25m
SCALE	0 1 2 5m
1:200	

PLAN OF	PROPOSED LOT 1490 ON SP357495
DESCRIBED AS:	PART OF LOT 114 ON SP256133
EXISTING TITLE REFERENCE:	50945046
LOCALITY:	REDBANK PLAINS
LOCAL GOVERNMENT:	IPSWICH CITY COUNCIL

DRAWING TITLE	DISCLOSURE PLAN
DRAWING NO.	9919 S 13 DP A_1490



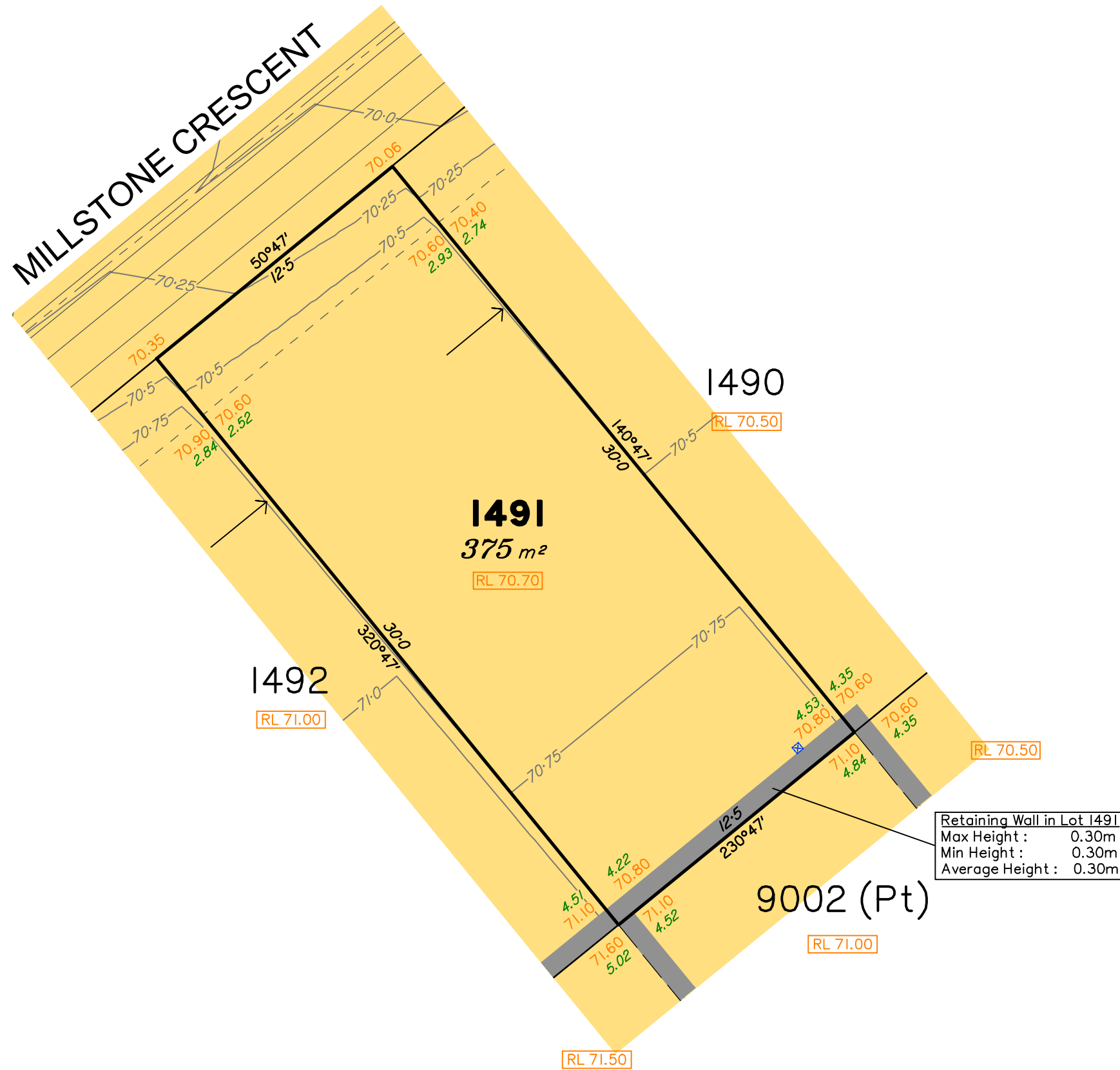

LEGEND	
	Area of Cut
	Area of Fill
	Design Contours
	Depth of Fill
	Batter Line / Change of Grade
	Retaining Wall
	Preferred Earthworks Pad Level
	Finished Surface Design Level
	Optional Built to Boundary Wall
	300mm x 300mm Subsurface Drainage Pit (indicative location)

(Not all items in this legend may be relevant to the lot shown on this plan)

NOTES

This plan has been prepared from preliminary survey plan (SP357495) and engineering data provided on the 11/08/2025 by KN Group Pty Ltd.

Development approval was granted for this subdivision by the Ipswich City Council on 18/06/2024. (Application No: 9367/2022/CA). For updates to this approval visit www.ipswich.qld.gov.au

Development approval for operational works for this lot was granted by Ipswich City Council on 04/07/2025 (Application No: 3884/2025/OW)

All fill shall be placed and compacted in a controlled manner so that Level 1 level of responsibility may be achieved and certified as per AS3798-2007.

Retaining Wall in Lot 1491
 Max Height : 0.30m
 Min Height : 0.30m
 Average Height : 0.30m

EDEN'S CROSSING
 STAGE 32A

PEET

Saunders Havill
 BOWEN HILLS | SPRINGFIELD
 1300 123 744 | mail@saundershavill.com



ISSUES			
NO.	DRAWN	DATE	DESCRIPTION
A	MS	02.09.2025	ORIGINAL ISSUE

THIS DISCLOSURE PLAN IS PREPARED FOR THE SOLE PURPOSE OF SATISFYING THE DISCLOSURE REQUIREMENTS OF THE LAND SALES ACT AND **SHOULD NOT** BE USED FOR ANY OTHER PURPOSE, PARTICULARLY AS-CONSTRUCTED PURPOSES. THIS INFORMATION IS COMPILED FROM DESIGN PLANS ONLY, UNLESS OTHERWISE STATED, AND THEREFORE IS SUBJECT TO FINAL SURVEY AND CONSTRUCTION OF OPERATIONAL WORKS.

LEVEL DATUM: AHD Der.
 ORIGIN OF LEVELS: PM203677
 RL OF ORIGIN: 80.916
 CONTOUR INTERVAL: 0.25m
 SCALE: 1:200

PLAN OF PROPOSED LOT 1491 ON SP357495
 DESCRIBED AS: PART OF LOT 114 ON SP256133
 EXISTING TITLE REFERENCE: 50945046
 LOCALITY: REDBANK PLAINS
 LOCAL GOVERNMENT: IPSWICH CITY COUNCIL

DRAWING TITLE: DISCLOSURE PLAN
 DRAWING NO.: 9919 S 13 DP A_1491



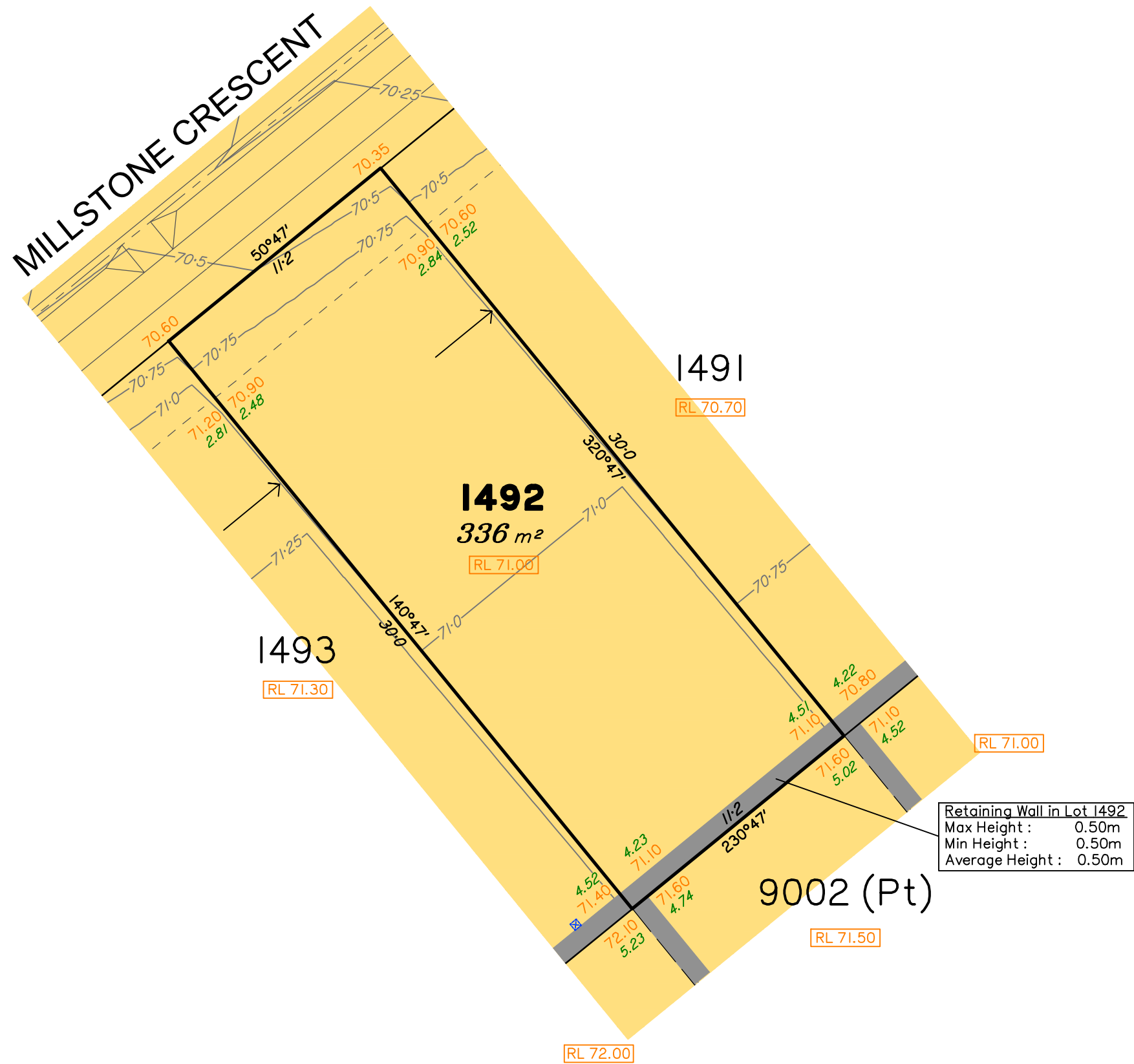

LEGEND	
	Area of Cut
	Area of Fill
	Design Contours
	Depth of Fill
	Batter Line / Change of Grade
	Retaining Wall
	Preferred Earthworks Pad Level
	Finished Surface Design Level
	Optional Built to Boundary Wall
	300mm x 300mm Subsurface Drainage Pit (indicative location)

(Not all items in this legend may be relevant to the lot shown on this plan)

NOTES

This plan has been prepared from preliminary survey plan (SP357495) and engineering data provided on the 11/08/2025 by KN Group Pty Ltd.

Development approval was granted for this subdivision by the Ipswich City Council on 18/06/2024. (Application No: 9367/2022/CA). For updates to this approval visit www.ipswich.qld.gov.au

Development approval for operational works for this lot was granted by Ipswich City Council on 04/07/2025 (Application No: 3884/2025/OW)

All fill shall be placed and compacted in a controlled manner so that Level 1 level of responsibility may be achieved and certified as per AS3798-2007.

Retaining Wall in Lot 1492
 Max Height : 0.50m
 Min Height : 0.50m
 Average Height : 0.50m

EDEN'S CROSSING
 STAGE 32A

PEET

Saunders Havill
 BOWEN HILLS | SPRINGFIELD
 1300 123 744 | mail@saundershavill.com



ISSUES			
NO.	DRAWN	DATE	DESCRIPTION
A	MS	02.09.2025	ORIGINAL ISSUE

THIS DISCLOSURE PLAN IS PREPARED FOR THE SOLE PURPOSE OF SATISFYING THE DISCLOSURE REQUIREMENTS OF THE LAND SALES ACT AND **SHOULD NOT** BE USED FOR ANY OTHER PURPOSE, PARTICULARLY AS-CONSTRUCTED PURPOSES. THIS INFORMATION IS COMPILED FROM DESIGN PLANS ONLY, UNLESS OTHERWISE STATED, AND THEREFORE IS SUBJECT TO FINAL SURVEY AND CONSTRUCTION OF OPERATIONAL WORKS.

LEVEL DATUM: AHD Der.
 ORIGIN OF LEVELS: PM203677
 RL OF ORIGIN: 80.916
 CONTOUR INTERVAL: 0.25m
 SCALE: 1:200

PLAN OF: PROPOSED LOT 1492 ON SP357495
 DESCRIBED AS: PART OF LOT 114 ON SP256133
 EXISTING TITLE REFERENCE: 50945046
 LOCALITY: REDBANK PLAINS
 LOCAL GOVERNMENT: IPSWICH CITY COUNCIL

DRAWING TITLE: DISCLOSURE PLAN
 DRAWING NO.: 9919 S 13 DP A_1492





ISSUES			
NO.	DRAWN	DATE	DESCRIPTION
A	MS	02.09.2025	ORIGINAL ISSUE

THIS DISCLOSURE PLAN IS PREPARED FOR THE SOLE PURPOSE OF SATISFYING THE DISCLOSURE REQUIREMENTS OF THE LAND SALES ACT AND **SHOULD NOT** BE USED FOR ANY OTHER PURPOSE, PARTICULARLY AS-CONSTRUCTED PURPOSES. THIS INFORMATION IS COMPILED FROM DESIGN PLANS ONLY, UNLESS OTHERWISE STATED, AND THEREFORE IS SUBJECT TO FINAL SURVEY AND CONSTRUCTION OF OPERATIONAL WORKS.

LEVEL DATUM: AHD Der.
ORIGIN OF LEVELS: PM203677
RL OF ORIGIN: 80.916
CONTOUR INTERVAL: 0.25m
SCALE: 1:200

PLAN OF PROPOSED LOT 1493 ON SP357495
DESCRIBED AS: PART OF LOT 114 ON SP256133
EXISTING TITLE REFERENCE: 50945046
LOCALITY: REDBANK PLAINS
LOCAL GOVERNMENT: IPSWICH CITY COUNCIL

DRAWING TITLE: DISCLOSURE PLAN
DRAWING NO.: 9919 S 13 DP A_1493

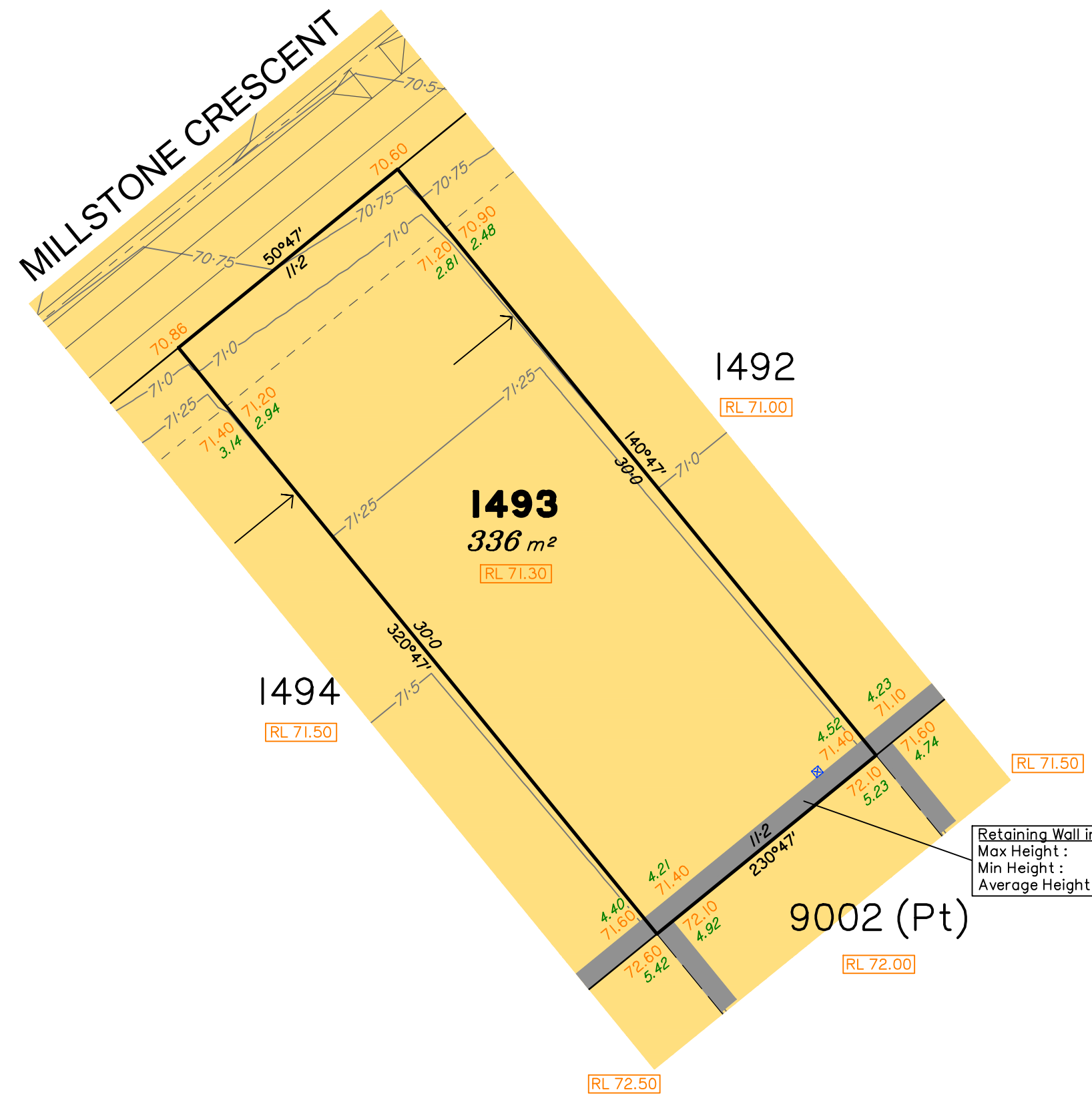

LEGEND	
	Area of Cut
	Area of Fill
	Design Contours
	Depth of Fill
	Batter Line / Change of Grade
	Retaining Wall
	Preferred Earthworks Pad Level
	Finished Surface Design Level
	Optional Built to Boundary Wall
	300mm x 300mm Subsurface Drainage Pit (indicative location)

(Not all items in this legend may be relevant to the lot shown on this plan)

NOTES

This plan has been prepared from preliminary survey plan (SP357495) and engineering data provided on the 11/08/2025 by KN Group Pty Ltd.

Development approval was granted for this subdivision by the Ipswich City Council on 18/06/2024. (Application No: 9367/2022/CA). For updates to this approval visit www.ipswich.qld.gov.au

Development approval for operational works for this lot was granted by Ipswich City Council on 04/07/2025 (Application No: 3884/2025/OW)

All fill shall be placed and compacted in a controlled manner so that Level 1 level of responsibility may be achieved and certified as per AS3798-2007.





ISSUES			
NO.	DRAWN	DATE	DESCRIPTION
A	MS	02.09.2025	ORIGINAL ISSUE

THIS DISCLOSURE PLAN IS PREPARED FOR THE SOLE PURPOSE OF SATISFYING THE DISCLOSURE REQUIREMENTS OF THE LAND SALES ACT AND **SHOULD NOT** BE USED FOR ANY OTHER PURPOSE, PARTICULARLY AS-CONSTRUCTED PURPOSES. THIS INFORMATION IS COMPILED FROM DESIGN PLANS ONLY, UNLESS OTHERWISE STATED, AND THEREFORE IS SUBJECT TO FINAL SURVEY AND CONSTRUCTION OF OPERATIONAL WORKS.

LEVEL DATUM: AHD Der.
ORIGIN OF LEVELS: PM203677
RL OF ORIGIN: 80.916
CONTOUR INTERVAL: 0.25m
SCALE: 1:200

PLAN OF PROPOSED LOT 1494 ON SP357495
DESCRIBED AS: PART OF LOT 114 ON SP256133
EXISTING TITLE REFERENCE: 50945046
LOCALITY: REDBANK PLAINS
LOCAL GOVERNMENT: IPSWICH CITY COUNCIL

DRAWING TITLE: DISCLOSURE PLAN
DRAWING NO.: 9919 S 13 DP A_1494

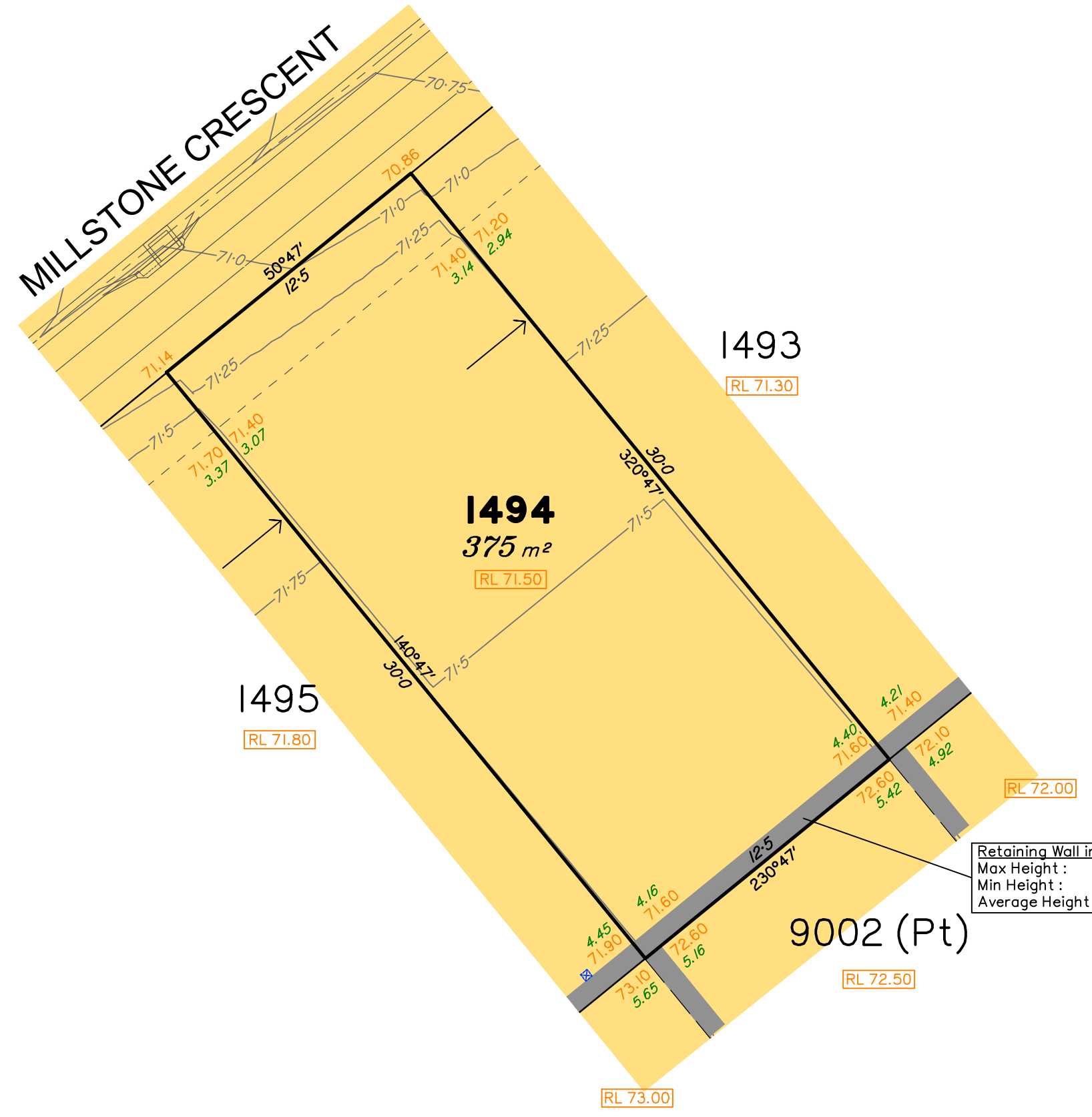

Retaining Wall in Lot 1494
Max Height : 1.00m
Min Height : 1.00m
Average Height : 1.00m

LEGEND	
	Area of Cut
	Area of Fill
	Design Contours
	1:2 Depth of Fill
	Batter Line / Change of Grade
	Retaining Wall
	Preferred Earthworks Pad Level
	Finished Surface Design Level
	Optional Built to Boundary Wall
	300mm x 300mm Subsurface Drainage Pit (indicative location)

(Not all items in this legend may be relevant to the lot shown on this plan)

NOTES

This plan has been prepared from preliminary survey plan (SP357495) and engineering data provided on the 11/08/2025 by KN Group Pty Ltd.

Development approval was granted for this subdivision by the Ipswich City Council on 18/06/2024. (Application No: 9367/2022/CA). For updates to this approval visit www.ipswich.qld.gov.au

Development approval for operational works for this lot was granted by Ipswich City Council on 04/07/2025 (Application No: 3884/2025/OW)

All fill shall be placed and compacted in a controlled manner so that Level 1 level of responsibility may be achieved and certified as per AS3798-2007.





ISSUES			
NO.	DRAWN	DATE	DESCRIPTION
A	MS	02.09.2025	ORIGINAL ISSUE

THIS DISCLOSURE PLAN IS PREPARED FOR THE SOLE PURPOSE OF SATISFYING THE DISCLOSURE REQUIREMENTS OF THE LAND SALES ACT AND **SHOULD NOT** BE USED FOR ANY OTHER PURPOSE, PARTICULARLY AS-CONSTRUCTED PURPOSES. THIS INFORMATION IS COMPILED FROM DESIGN PLANS ONLY, UNLESS OTHERWISE STATED, AND THEREFORE IS SUBJECT TO FINAL SURVEY AND CONSTRUCTION OF OPERATIONAL WORKS.

LEVEL DATUM: AHD Der.
ORIGIN OF LEVELS: PM203677
RL OF ORIGIN: 80.916
CONTOUR INTERVAL: 0.25m
SCALE: 1:200

PLAN OF PROPOSED LOT 1496 ON SP357495
DESCRIBED AS: PART OF LOT 114 ON SP256133
EXISTING TITLE REFERENCE: 50945046
LOCALITY: REDBANK PLAINS
LOCAL GOVERNMENT: IPSWICH CITY COUNCIL

DRAWING TITLE: DISCLOSURE PLAN
DRAWING NO.: 9919 S 13 DP A_1496

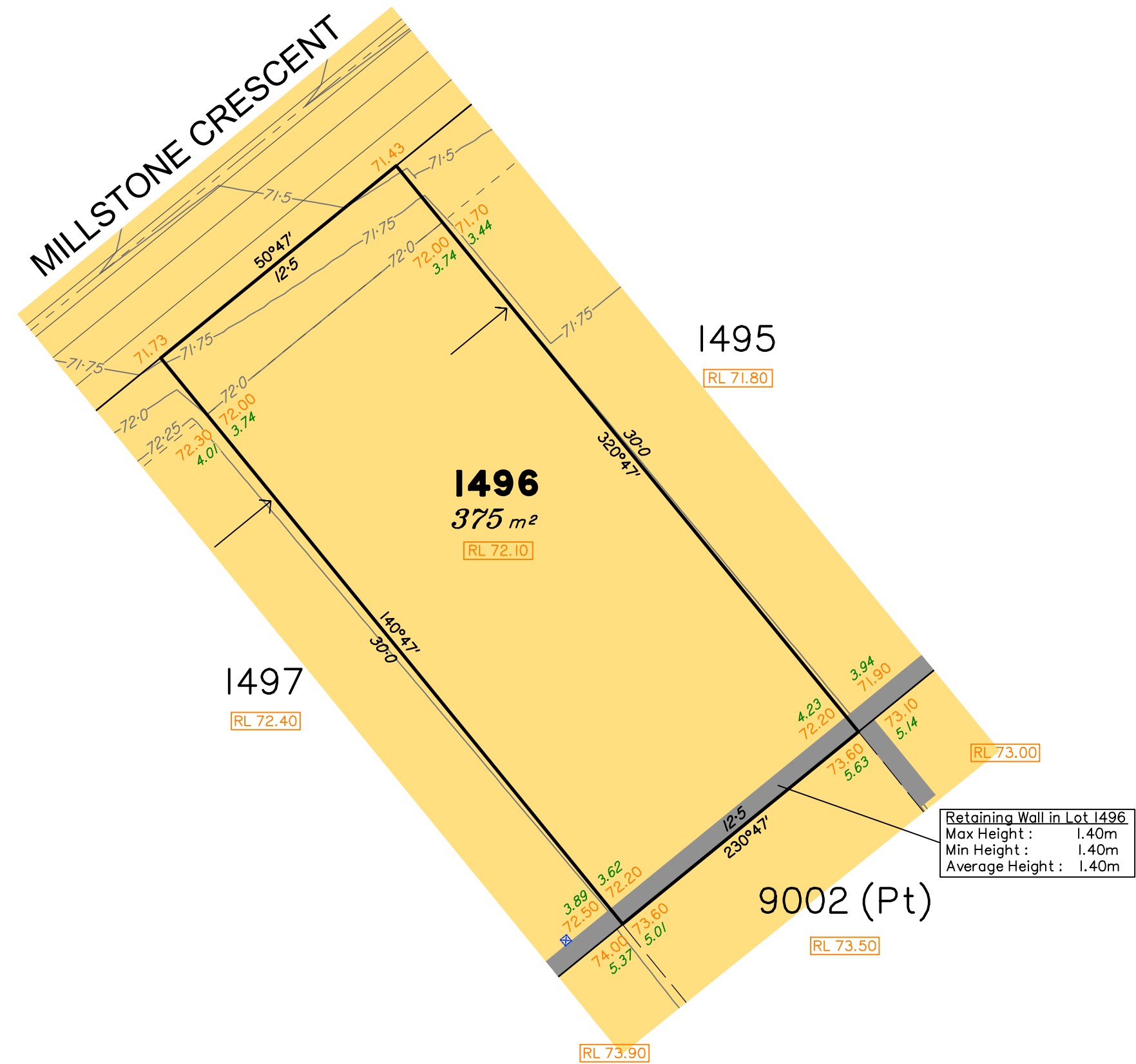

Retaining Wall in Lot 1496
Max Height : 1.40m
Min Height : 1.40m
Average Height : 1.40m

LEGEND	
	Area of Cut
	Area of Fill
	Design Contours
	Depth of Fill
	Batter Line / Change of Grade
	Retaining Wall
	Preferred Earthworks Pad Level
	Finished Surface Design Level
	Optional Built to Boundary Wall
	300mm x 300mm Subsurface Drainage Pit (indicative location)

(Not all items in this legend may be relevant to the lot shown on this plan)

NOTES

This plan has been prepared from preliminary survey plan (SP357495) and engineering data provided on the 11/08/2025 by KN Group Pty Ltd.

Development approval was granted for this subdivision by the Ipswich City Council on 18/06/2024. (Application No: 9367/2022/CA). For updates to this approval visit www.ipswich.qld.gov.au

Development approval for operational works for this lot was granted by Ipswich City Council on 04/07/2025 (Application No: 3884/2025/OW)

All fill shall be placed and compacted in a controlled manner so that Level 1 level of responsibility may be achieved and certified as per AS3798-2007.



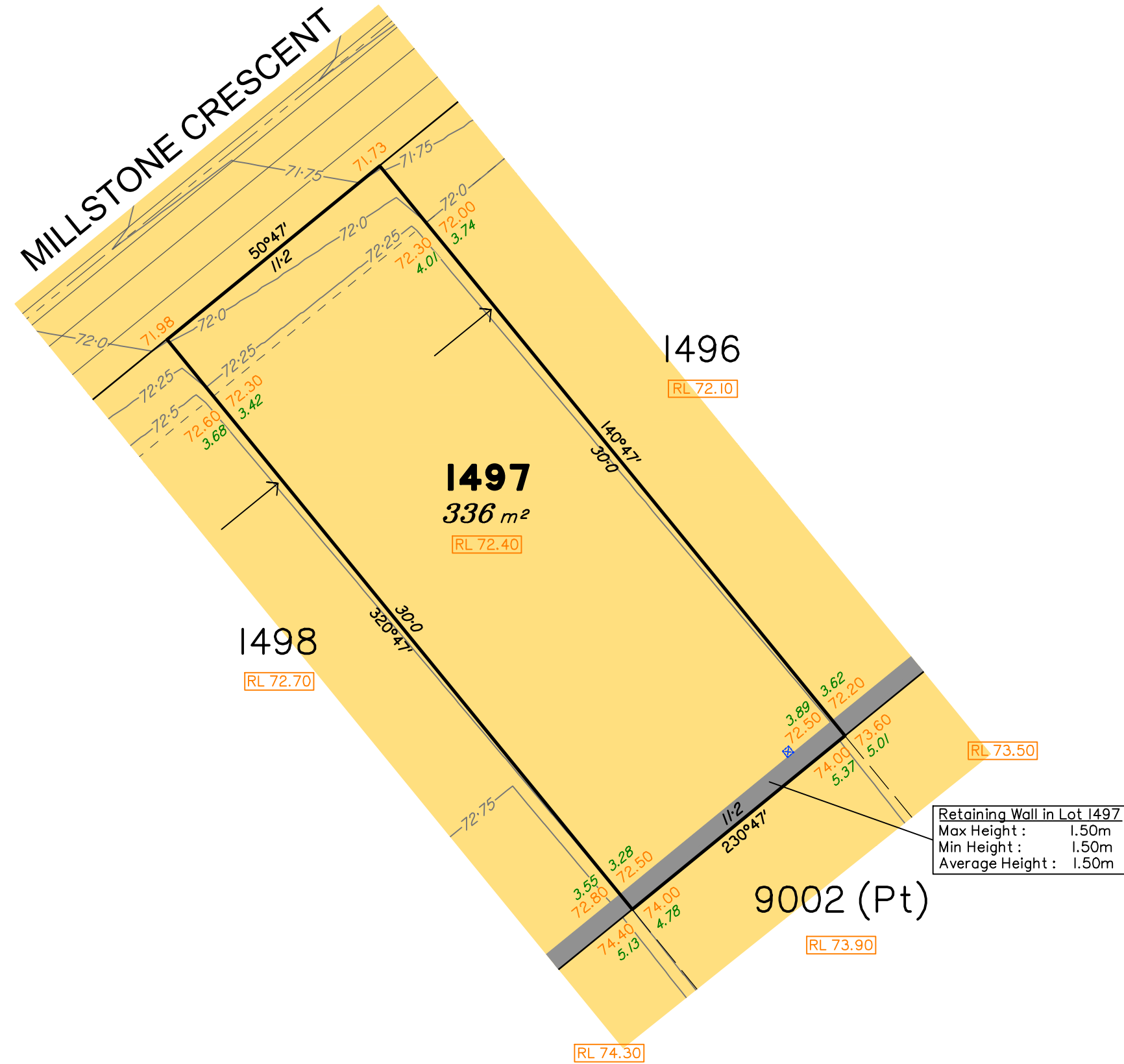

LEGEND	
	Area of Cut
	Area of Fill
	Design Contours
	Depth of Fill
	Batter Line / Change of Grade
	Retaining Wall
	Preferred Earthworks Pad Level
	Finished Surface Design Level
	Optional Built to Boundary Wall
	300mm x 300mm Subsurface Drainage Pit (indicative location)

(Not all items in this legend may be relevant to the lot shown on this plan)

NOTES

This plan has been prepared from preliminary survey plan (SP357495) and engineering data provided on the 11/08/2025 by KN Group Pty Ltd.

Development approval was granted for this subdivision by the Ipswich City Council on 18/06/2024. (Application No: 9367/2022/CA). For updates to this approval visit www.ipswich.qld.gov.au

Development approval for operational works for this lot was granted by Ipswich City Council on 04/07/2025 (Application No: 3884/2025/OW)

All fill shall be placed and compacted in a controlled manner so that Level 1 level of responsibility may be achieved and certified as per AS3798-2007.

Retaining Wall in Lot 1497
Max Height : 1.50m
Min Height : 1.50m
Average Height : 1.50m



ISSUES			
NO.	DRAWN	DATE	DESCRIPTION
A	MS	02.09.2025	ORIGINAL ISSUE

THIS DISCLOSURE PLAN IS PREPARED FOR THE SOLE PURPOSE OF SATISFYING THE DISCLOSURE REQUIREMENTS OF THE LAND SALES ACT AND **SHOULD NOT** BE USED FOR ANY OTHER PURPOSE, PARTICULARLY AS-CONSTRUCTED PURPOSES. THIS INFORMATION IS COMPILED FROM DESIGN PLANS ONLY, UNLESS OTHERWISE STATED, AND THEREFORE IS SUBJECT TO FINAL SURVEY AND CONSTRUCTION OF OPERATIONAL WORKS.

LEVEL DATUM:	AHD Der.
ORIGIN OF LEVELS:	PM203677
RL OF ORIGIN:	80.916
CONTOUR INTERVAL:	0.25m
SCALE	0 1 2 5m
1:200	

PLAN OF	PROPOSED LOT 1497 ON SP357495
DESCRIBED AS:	PART OF LOT 114 ON SP256133
EXISTING TITLE REFERENCE:	50945046
LOCALITY:	REDBANK PLAINS
LOCAL GOVERNMENT:	IPSWICH CITY COUNCIL

DRAWING TITLE	DISCLOSURE PLAN
DRAWING NO.	9919 S 13 DP A_1497



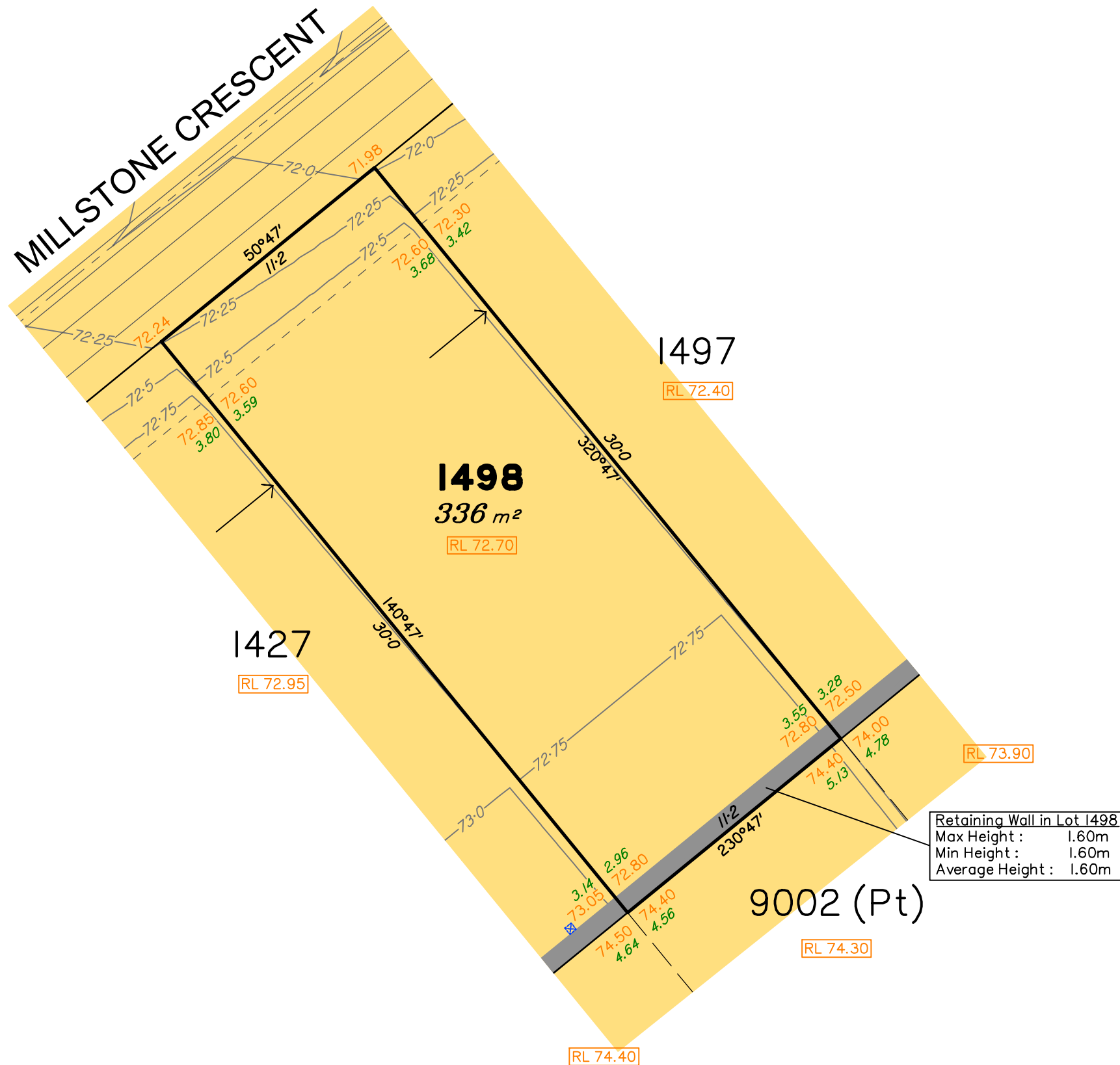

LEGEND	
	Area of Cut
	Area of Fill
	Design Contours
	Depth of Fill
	Batter Line / Change of Grade
	Retaining Wall
	Preferred Earthworks Pad Level
	Finished Surface Design Level
	Optional Built to Boundary Wall
	300mm x 300mm Subsurface Drainage Pit (indicative location)

(Not all items in this legend may be relevant to the lot shown on this plan)

NOTES

This plan has been prepared from preliminary survey plan (SP357495) and engineering data provided on the 11/08/2025 by KN Group Pty Ltd.

Development approval was granted for this subdivision by the Ipswich City Council on 18/06/2024. (Application No: 9367/2022/CA). For updates to this approval visit www.ipswich.qld.gov.au

Development approval for operational works for this lot was granted by Ipswich City Council on 04/07/2025 (Application No: 3884/2025/OW)

All fill shall be placed and compacted in a controlled manner so that Level 1 level of responsibility may be achieved and certified as per AS3798-2007.

Retaining Wall in Lot 1498
Max Height : 1.60m
Min Height : 1.60m
Average Height : 1.60m



ISSUES			
NO.	DRAWN	DATE	DESCRIPTION
A	MS	02.09.2025	ORIGINAL ISSUE

THIS DISCLOSURE PLAN IS PREPARED FOR THE SOLE PURPOSE OF SATISFYING THE DISCLOSURE REQUIREMENTS OF THE LAND SALES ACT AND **SHOULD NOT** BE USED FOR ANY OTHER PURPOSE, PARTICULARLY AS-CONSTRUCTED PURPOSES. THIS INFORMATION IS COMPILED FROM DESIGN PLANS ONLY, UNLESS OTHERWISE STATED, AND THEREFORE IS SUBJECT TO FINAL SURVEY AND CONSTRUCTION OF OPERATIONAL WORKS.

LEVEL DATUM:	AHD Der.
ORIGIN OF LEVELS:	PM203677
RL OF ORIGIN:	80.916
CONTOUR INTERVAL:	0.25m
SCALE	0 1 2 5m
1:200	

PLAN OF	PROPOSED LOT 1498 ON SP357495
DESCRIBED AS:	PART OF LOT 114 ON SP256133
EXISTING TITLE REFERENCE:	50945046
LOCALITY:	REDBANK PLAINS
LOCAL GOVERNMENT:	IPSWICH CITY COUNCIL

DRAWING TITLE	DISCLOSURE PLAN
DRAWING NO.	9919 S 13 DP A_1498

