

250m² - 885m²
\$205,000*

*Price subject to availability and change.

Beachside living at its best.

It's morning swims at the beach with the family. It's picnics with your neighbours at the local park. It's moments like these that make your life what it is, and at Golden Bay, your life will make your day.

Stage 4G offers you the opportunity to live the coastal lifestyle you've always dreamed of, with a number of blocks located a mere 245m from the stunning Golden Bay beach. You'll find yourself a stone's throw from

Sunset Hill Park and the excitement of the Foreshore Park currently under construction, providing plenty of opportunities to head outside and explore.

Life at Golden Bay Estate means you'll never be far from everyday necessities, with a range of parks, playgrounds, childcare centres, local schools and shops close by. You'll be a few short minutes from convenience with Secret Harbour Square just down the road.

While for those in search of more options, the entertainment and retail hubs of Rockingham and Mandurah are all a short distance from home.

With so many opportunities within this growing coastal community, you'll be spoilt for choice.

Golden Bay, where your life makes your day.



GOLDEN BAY
SEASIDE

STAGE PLAN

STAGE 4G RELEASE

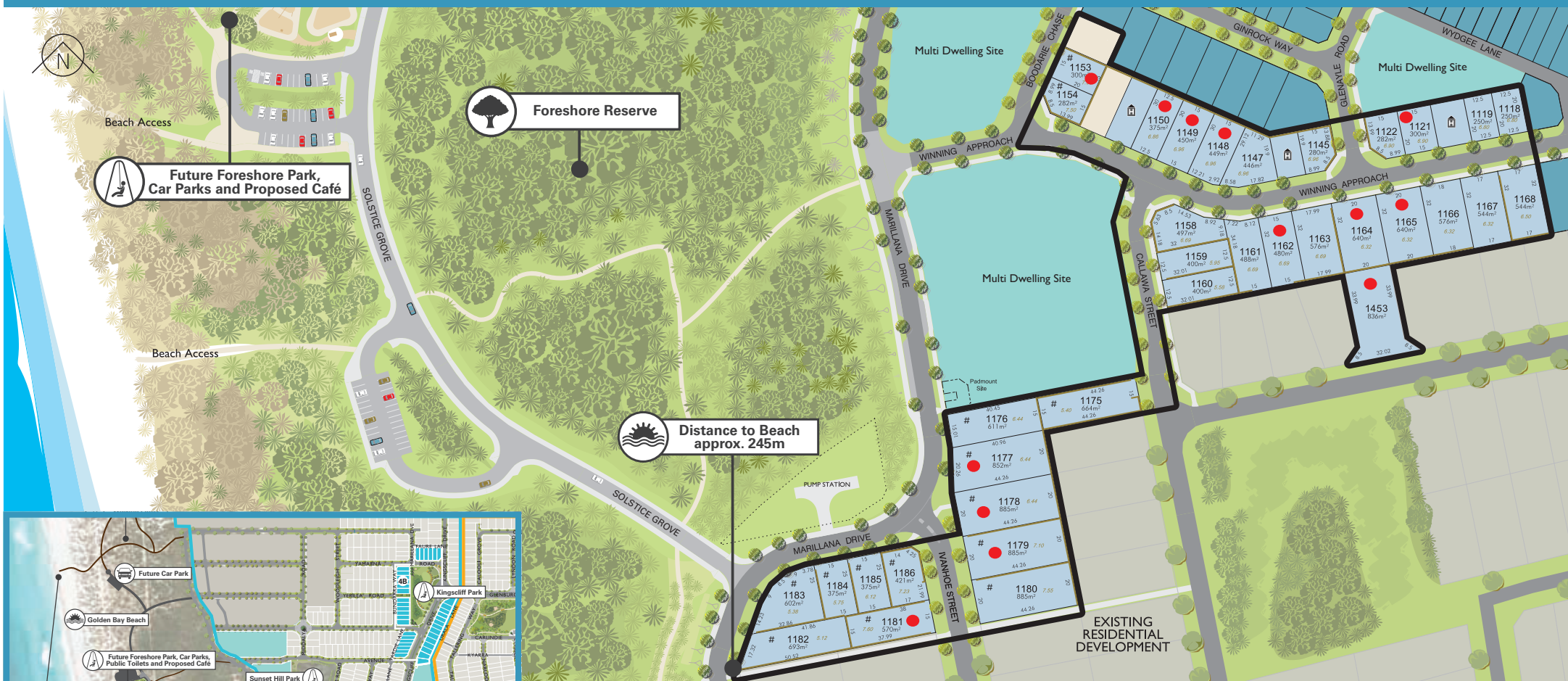

LEGEND

- Multi Dwelling Site
- Current Release
- Previous Release
- Future Release
- Existing Residential Development
- 6.10 Lot Height
- Retaining Wall
- Foot path
- # Bushfire Attack Level Rating (BAL) Applicable
- Retained by the Department of Communities
- Sold

For more information please call the Sales and Information Centre on 0438 387 449 or visit goldenbay.com.au

Whilst every care has been taken with the preparation of these particulars, which we believe to be correct, they are in no way warranted by the selling agent or its clients in whole or in part and should not be construed as forming part of any contract. Any intending purchasers are advised to make necessary enquiries to satisfy themselves on all matters in this respect. All areas and dimensions are subject to survey. Sales Agent: Peet Estates.



Government of Western Australia
Department of Communities

Life
YOUR WAY

PEET