

### DETAIL PLAN

HORIZ 0 5 10 20 30 40

SCALE 1500H AT A1 SIZE  
1:1000H AT A3 SIZE

### LEGEND

- 5 ALLOTMENT NUMBER
- Ch68.17 CENTRELINE CHAINAGE
- DW POTABLE WATER MAIN
- NDW NON DRINKING WATER MAIN
- G GAS MAIN OR CONDUIT
- E S.E.C. CABLE OR CONDUIT
- NBN TELECOM CABLE OR CONDUIT
- HD HOUSE DRAIN
- PROPOSED DRAIN & PIT
- EXISTING DRAIN & PIT
- PROPERTY INLET PIT
- EXISTING PROPERTY INLET PIT
- DRAINAGE PIT NUMBER
- S PROPOSED SEWER LINE
- ExS EXISTING SEWER LINE
- T.B.M. STAR PICKET
- P.S.M.
- ES53.26 EXISTING SURFACE LEVEL
- FS53.40 FINISHED SURFACE LEVEL
- TB53.40 TOP OF BATTER LEVEL
- PROPOSED KERB & CHANNEL
- EXISTING KERB & CHANNEL
- STREET SIGN
- EXTENT OF FORMED BATTER
- DENOTES FILL GREATER THAN 200mm FOR CONSTRUCTION
- PROPOSED PAVEMENT
- PROPOSED CONCRETE
- EXISTING PAVEMENT
- PROPOSED FOOTPATH
- PROPOSED DRIVEWAY
- OVERLAND FLOW DIRECTION

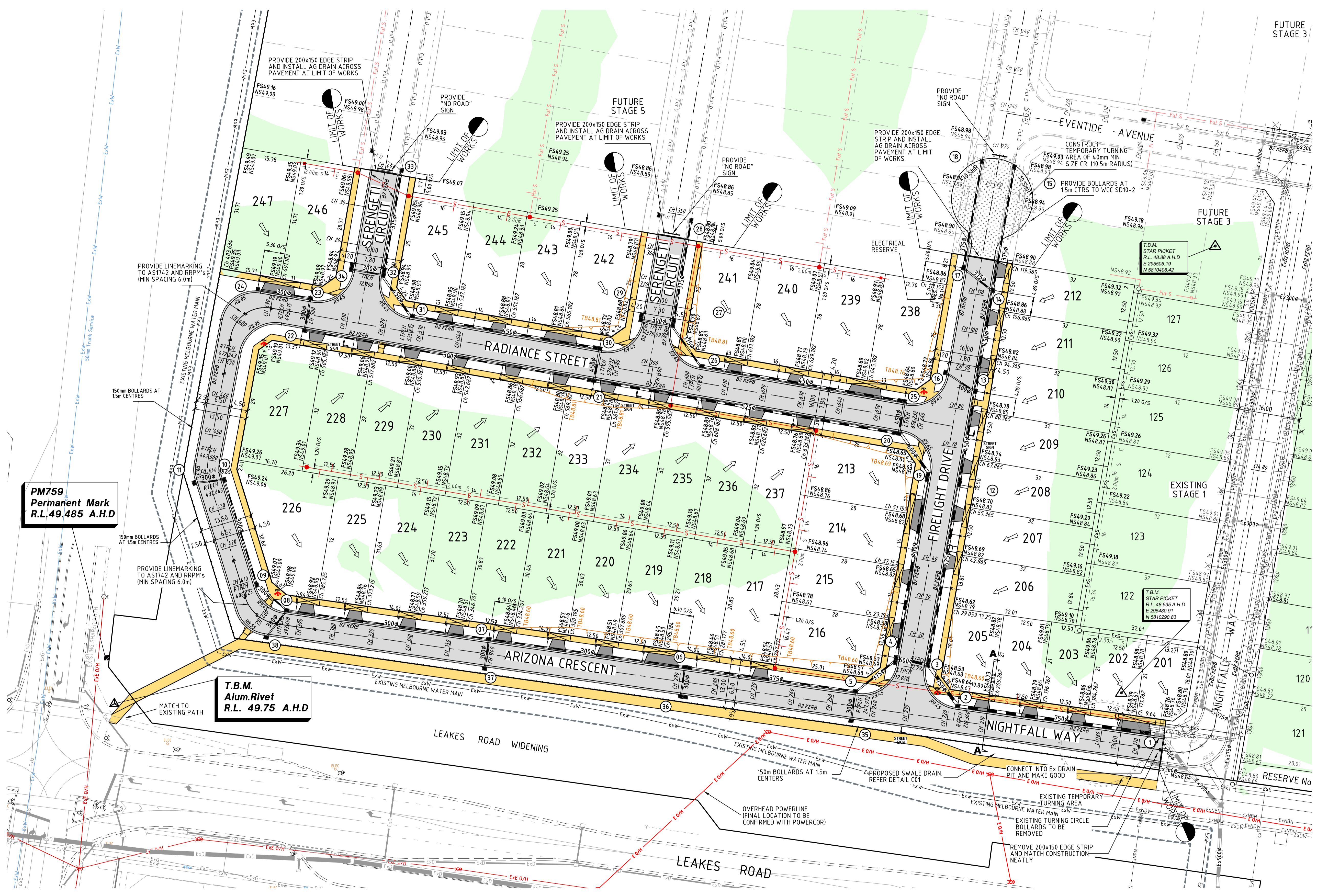

**PM759**  
Permanent Mark  
R.L. 49.485 A.H.D

**T.B.M.**  
Alum. Rivet  
R.L. 49.75 A.H.D

COUNCIL REFERENCE NO.: 75/110/6826/13/02

REV	DATE	REVISION	APP'D	ISSUE	DATE	ISSUE	APP'D
				05	29.06.16	AS CONSTRUCTED ISSUE	JL
				04	23.09.15	ISSUE FOR APPROVAL	JL
C	21.10.15	PRAM CROSSINGS ADDED NEAR LOTS 229 & 245	JL	03	16.09.15	ISSUE FOR APPROVAL	JL
B	09.09.15	DETAILS ADDED / AMENDED	JL	02	30.07.15	ISSUE FOR APPROVAL	JL
A	30.07.15	KERB TYPE UPDATED	JL	01	13.07.15	ISSUE FOR APPROVAL	JL

DESIGNED	DATE	DRAWN	SCALE
A. Kumar	10.07.2015	E. Parry	1:500
CHECKED	SHEET SIZE	APPROVED	MELWAY
J. Lynch	A1	B. Vocale	202 C1

TGM Group Melbourne  
765 Glenferrie Road  
(PO Box 2304)  
Heworth Vic 3122  
T 03 8862 9333  
F 03 9819 4909  
ABN 11 125 568 461  
www.tgmgroup.com

Melbourne | Geelong | Ballarat

JAS-ANZ Accredited: Quality ISO 9001 - OH&S AS/NZS 4801 - Environment ISO 14001

CLIENT

PROJECT  
**HAVEN AT TARNEIT**  
STAGE 2  
830 LEAKES ROAD, TARNEIT  
WYNDHAM CITY COUNCIL

CIVIL DRAWING				
DRAWING TITLE				
DETAIL PLAN				
TGM DRAWING NUMBER	CLIENT DRAWING NUMBER	SHEET	OF	REV
12369-202-C02		2	19	C 5