

**ATTENTION TO CONTRACTOR**

- IT IS THE CONTRACTORS RESPONSIBILITY TO ENSURE THAT THE DIGITAL PLAN, PROVIDED FOR SETOUT PURPOSES, MATCHES THE TBM CO-ORDINATES SHOWN.
- WHERE CONCRETE WORKS ABOUT A SEWER ACCESS CHAMBER SURROUND OR SIMILAR STRUCTURE, AN EXPANSION JOINT OF APPROVAL MATERIAL SHALL BE PROVIDED BETWEEN THE TWO FACES.

**WARNING**

**BWARE OF UNDERGROUND SERVICES**  
THE LOCATION OF UNDERGROUND SERVICES ARE APPROXIMATE ONLY AND THEIR EXACT POSITION SHOULD BE PROVEN ON SITE. NO GUARANTEE IS GIVEN THAT ALL EXISTING SERVICES ARE SHOWN.

**SHEET INDEX**

SHT No.	VER	DESCRIPTION
1	C	LAYOUT PLAN AND DETAILS
2	A	LAYOUT PLAN AND DETAILS
3	B	INTERSECTION DETAILS
4	A	INTERSECTION DETAILS
5	A	ROAD LONGSECTIONS - SHEET 1
6	A	ROAD LONGSECTIONS - SHEET 2
7	A	ROAD LONGSECTIONS - SHEET 3
8	B	ROAD CROSS SECTIONS - SHEET 1
9	A	ROAD CROSS SECTIONS - SHEET 2
10	A	ROAD CROSS SECTIONS - SHEET 3
11	A	ROAD CROSS SECTIONS - SHEET 4
12	A	ROAD CROSS SECTIONS - SHEET 5
13	A	DRAINAGE LONGITUDINAL SECTIONS - SHEET 1
14	A	DRAINAGE LONGITUDINAL SECTIONS - SHEET 2
15	A	DRAINAGE LONGITUDINAL SECTIONS - SHEET 3
16	B	TYPICAL CROSS SECTIONS
17	A	SIGNAGE AND LINEMARKING

*These plans are design plans and are indicative only and parties must not make any objection, requisition or claim for compensation in relation to the plans. The final condition of lots upon completion may vary from the condition described in the plans. The Property may have been filled, raised, levelled, compacted or cut prior to the Vendor becoming registered proprietor of the Property and the condition of the Property may change after completion of works due to circumstances beyond the Vendor's control. No warranty or representation is given or to be construed in respect of such works or changes in condition. Parties should review the plans carefully, make their own inquiries and obtain independent advice before taking any action in relation to the Property.*

REMOVE EXISTING CONCRETE EDGE STRIP, "NO ROAD" SIGN & BARRIER AND MATCH NEATLY TO EXISTING CONSTRUCTION

RECONSTRUCT END 3.75m OF EXISTING PAVEMENT AND KERBS TO SUIT FINAL ALIGNMENT OF NEW ROAD.

FUTURE SHARED PATH TO BE CONSTRUCTED WITH WATERWAY WORKS. REFER TO 8890W02 DRAWING SET, NOT PART OF THIS STAGE 14 WORKS SCOPE.

**FUTURE DRAINAGE RESERVE**

BI-DIRECTIONAL HAZARD BOARD

INSTALL INDUSTRIAL STANDARD CROSSOVER FOR MAINTENANCE ACCESS

INSTALL BOLLARDS, CENTRE BOLLARDS TO BE COLLAPSABLE FOR ACCESS

SITE OF WORKS

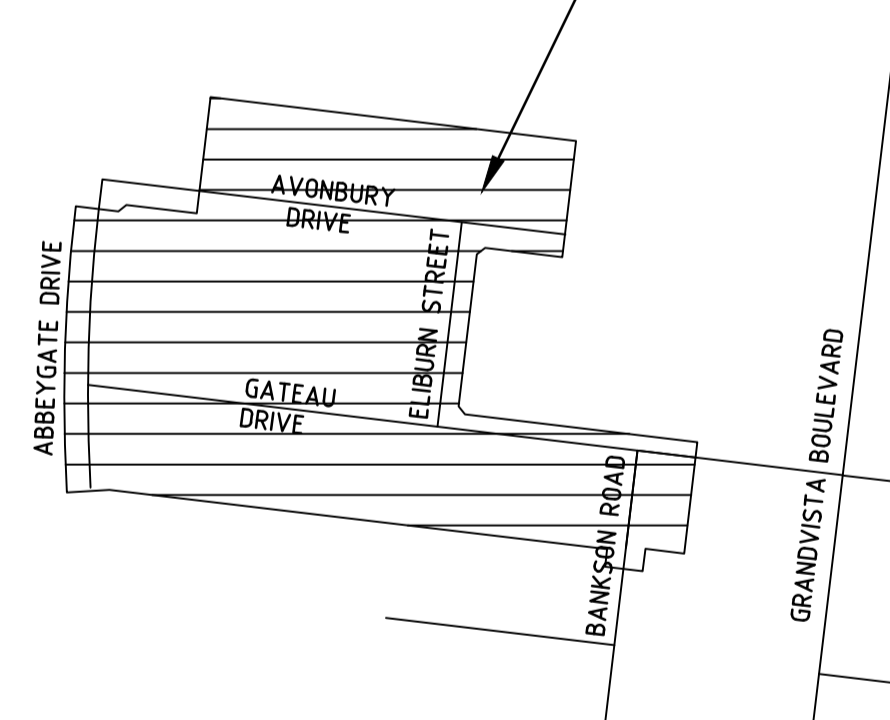

SITE LOCALITY PLAN  
NOT TO SCALE

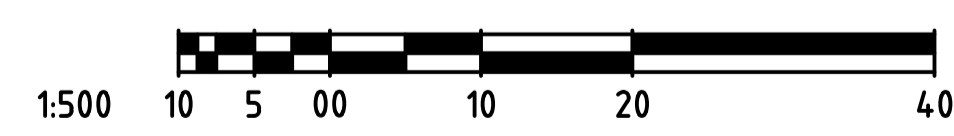

REFER SHEET 2 FOR CONTINUATION

PLAN  
SCALE 1:500

**SERVICE OFFSETS AND LOCATION TABLE**

ROAD NAME	RESERVE WIDTH	WATER		GAS		ELECTRICITY				TELECOMMUNICATIONS		BOK	
		DW	NDW	SIDE	OFFSET	POLE		U/G CABLE		SIDE	OFFSET	SIDE	SIDE
						SIDE	OFFSET	SIDE	OFFSET				
GATEAU DRIVE	16.00	3.20 S	2.70 S	2.25 S	N	0.80*	N	2.60	N	1.85	4.05 N	4.35 S	
AVONBURY DRIVE	16.00	3.20 N	2.70 N	2.25 N	S	0.80*	S	2.60	S	1.80	4.35 N	4.05 S	
ABBEGATE DRIVE	14.50	3.20 E	2.70 E	2.25 E	W	0.80*	W	1.40	W	0.65	2.55 W	4.35 E	
BANKSTON ROAD	16.00	3.20 E	2.70 E	2.25 E	W	0.80*	W	2.60	W	1.85	4.05 W	4.35 E	
ELBURN STREET	16.00	3.20 W	2.70 W	2.25 W	E	0.80*	E	2.60	E	1.85	4.35 W	4.05 E	

NOTE: \* OFFSET FROM BACK OF KERB

**SYMBOL LEGEND**

Drains	Prop	Exist	Temporary Bench Mark (TBM)	•
Sewer <300	—S—	—S—	Ex/Natural/FS Level	28.57
Sewer >300	—S—	—S—	FS @ Building Line	BL28.57
Water	—W—	—W—	Top/Toe of Batter	10P28.57 / 10E28.57
House Drain	—H—	—H—	Top Ret. Wall Level	10W28.57
Property Inlet	—P—	—P—	Fill Prop/Ex (0.2m-0.5m depth)	[Symbol]
Street Sign	—S—	—S—	Fill Prop/Ex (>0.5m depth)	[Symbol]
PSM	—P—	—P—	Cut Prop/Ex (>0.2m depth)	[Symbol]
Retaining Wall	—R—	—R—	Threshold Treatment	[Symbol]
Conduits 50mm	—C—	—C—		
Conduits 100mm	—C—	—C—		
Ex Gas/Elect/Tel	—G—	—G—		

VER	DATE	REMARKS
C	22.02.19	SHARED PATH REMOVED
B	04.10.18	WATER CONDUITS AMENDED
A	17.04.18	CONSTRUCTION ISSUE

**breese pitt dixon pty. ltd.**  
land surveyors civil engineers

MELWAY REF. 204 E9

**CORNERSTONE ESTATE  
STAGE 14  
LAYOUT PLAN & DETAILS**

MUNICIPALITY: WYNDHAM

REFERENCE: 8890 - E/14

SCALE AS SHOWN DATUM AHD DATE OCT '17 SHEET 1 OF 17

1/19 cato street  
hawthorn east, 3123  
telephone 8823 2300  
fax no. 8823 2310