

These plans are design plans and are indicative only and parties must not make any objection, requisition or claim for compensation in relation to the plans. The final condition of lots upon completion may vary from the condition described in the plans.

The Property may have been filled, raised, levelled, compacted or cut prior to the Vendor becoming registered proprietor of the Property and the condition of the Property may change after completion of works due to circumstances beyond the Vendor's control. No warranty or representation is given or to be construed in respect of such works or changes in condition.

Parties should review the plans carefully, make their own inquiries and obtain independent advice before taking any action in relation to the Property.

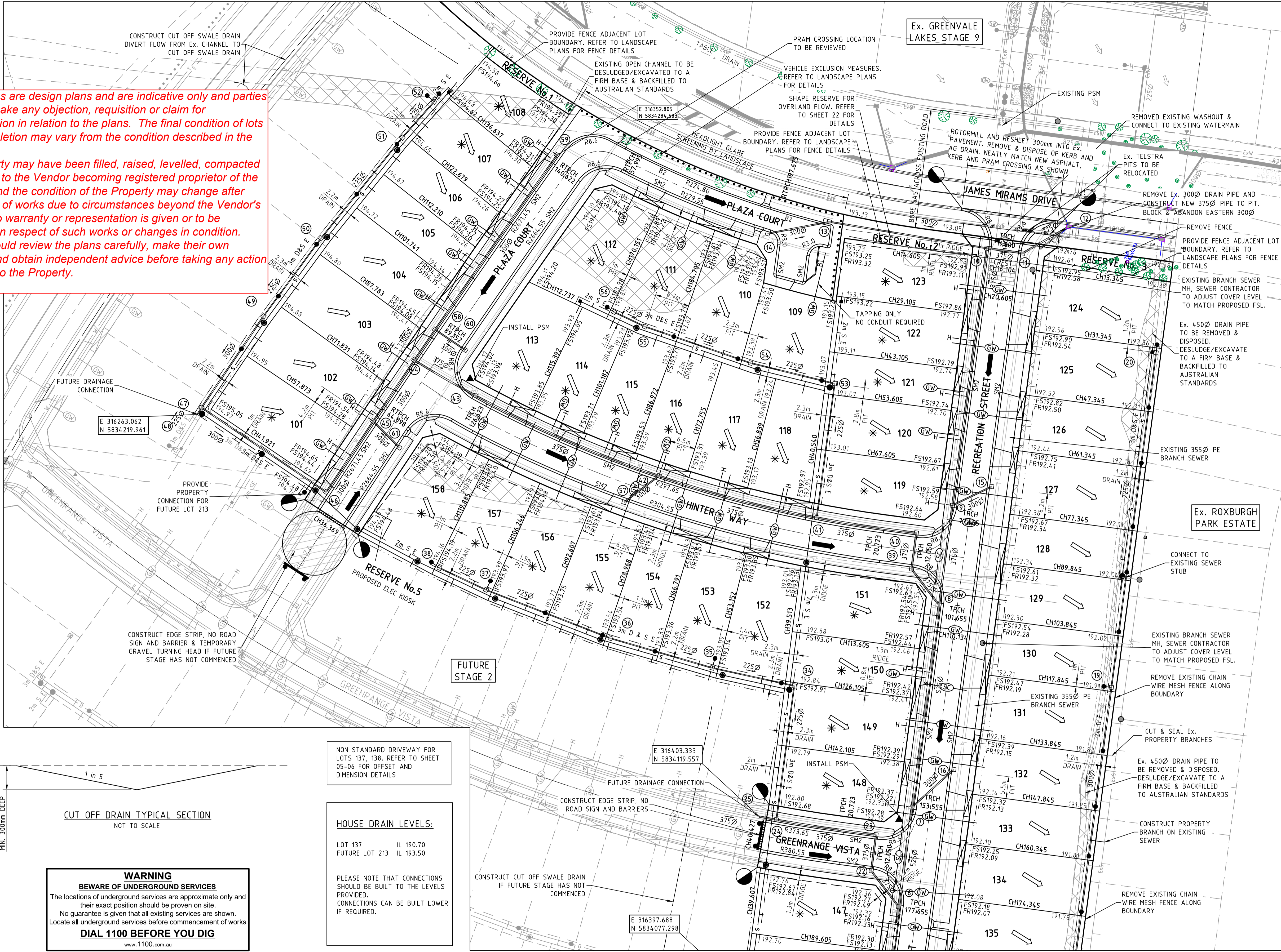

**LEGEND - LAYOUT PLAN**

- STORMWATER DRAIN, PIT & PROPERTY INLET
- SWALE DRAIN
- SEWER & MAINTENANCE STRUCTURES
- HOUSE DRAIN
- ELECTRICITY (U.GROUND) (INDICATIVE ONLY)
- ELECTRICITY (O.HEAD) (INDICATIVE ONLY)
- GAS (INDICATIVE ONLY)
- TELSTRA (INDICATIVE ONLY)
- WATER (INDICATIVE ONLY)
- RECYCLED WATER (INDICATIVE ONLY)
- AG. DRAIN (INDICATIVE ONLY)
- OPTIC FIBRE (INDICATIVE ONLY)
- SERVICE CONDUITS
- TACTILE PAVERS
- EXISTING ELECTRICITY (UNDERGROUND) (INDICATIVE ONLY)
- EXISTING ELECTRICITY (OVERHEAD) (INDICATIVE ONLY)
- EXISTING GAS (INDICATIVE ONLY)
- EXISTING TELSTRA (INDICATIVE ONLY)
- EXISTING OPTIC FIBRE (INDICATIVE ONLY)
- EXISTING WATER (INDICATIVE ONLY)
- EXISTING RECYCLED WATER (INDICATIVE ONLY)
- EXISTING STORMWATER DRAIN (INDICATIVE ONLY)
- EXISTING SEWER (INDICATIVE ONLY)
- EXISTING HOUSE DRAIN
- EXISTING SWALE DRAIN
- FUTURE AG DRAIN (INDICATIVE ONLY)
- FUTURE ELECTRICITY (UNDERGROUND) (INDICATIVE ONLY)
- FUTURE ELECTRICITY (OVERHEAD) (INDICATIVE ONLY)
- FUTURE GAS (INDICATIVE ONLY)
- FUTURE TELSTRA (INDICATIVE ONLY)
- FUTURE OPTIC FIBRE (INDICATIVE ONLY)
- FUTURE WATER (INDICATIVE ONLY)
- FUTURE RECYCLED WATER (INDICATIVE ONLY)
- FUTURE STORMWATER DRAIN (INDICATIVE ONLY)
- FUTURE SEWER (INDICATIVE ONLY)
- FUTURE HOUSE DRAIN
- EXISTING SURFACE LEVEL
- FINISHED BUILDING LINE LEVEL
- FINISHED RIDGE LINE LEVEL
- TOP OF RETAINING WALL
- BOTTOM OF RETAINING WALL
- RETAINING WALL
- ZERO LOT LINES
- PAVEMENT TREATMENT
- STRUCTURAL FILL > 200mm DEEP
- CUT > 200mm DEEP
- DIRECTION OF FALL
- OVERLAND FLOW
- ALLOTMENT TO BE GRADED EVENLY IN DIRECTION OF FALL TO LEVELS INDICATED
- CONCRETE EDGE STRIP WITH SUBSOIL DRAIN, "NO ROAD" SIGN & BARRIER
- LIMIT OF WORKS
- EXISTING TREE TO BE REMOVED
- EXISTING TREE TO BE RETAINED
- PERMANENT SURVEY MARK
- TEMPORARY BENCH MARK
- PROPOSED DRIVEWAY

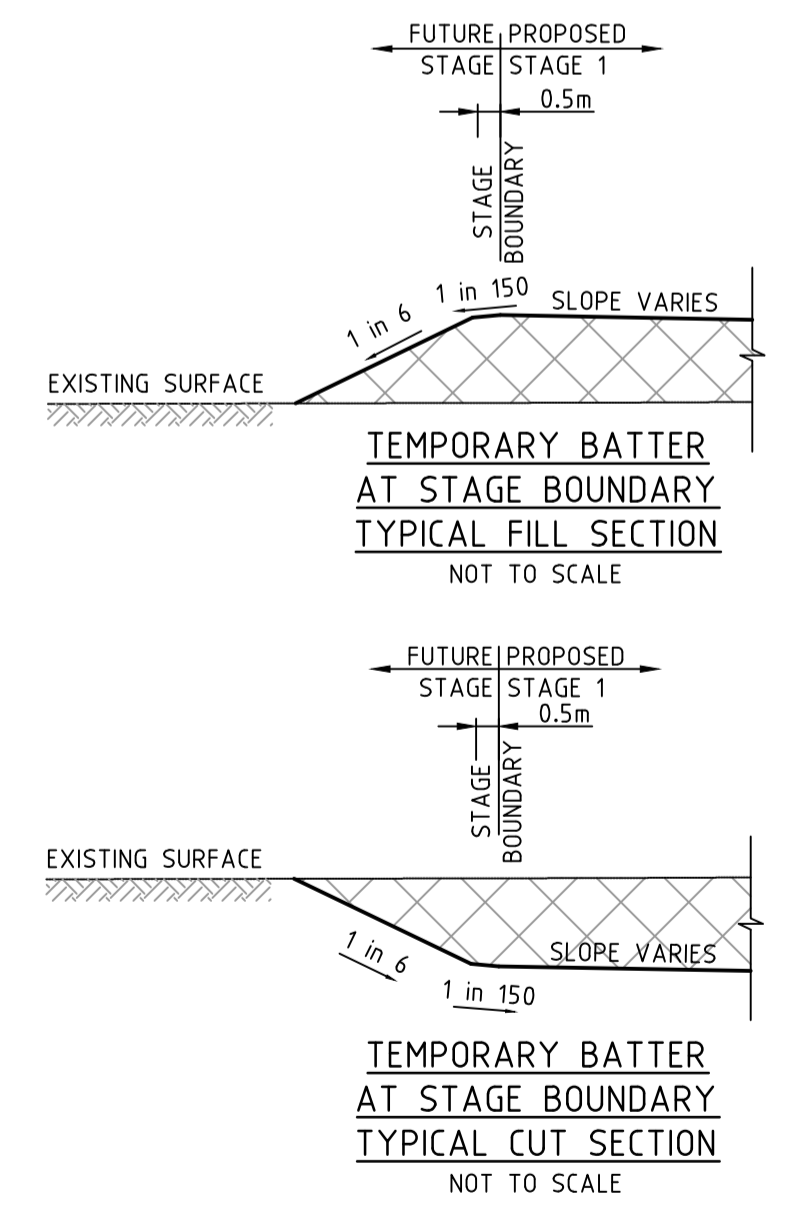

**CUT OFF DRAIN TYPICAL SECTION**  
NOT TO SCALE

**HOUSE DRAIN LEVELS:**

LOT 137	IL 190.70
FUTURE LOT 213	IL 193.50

PLEASE NOTE THAT CONNECTIONS SHOULD BE BUILT TO THE LEVELS PROVIDED. CONNECTIONS CAN BE BUILT LOWER IF REQUIRED.

**WARNING**  
**BEWARE OF UNDERGROUND SERVICES**  
The locations of underground services are approximate only and their exact position should be proven on site. No guarantee is given that all existing services are shown. Locate all underground services before commencement of works.  
**DIAL 1100 BEFORE YOU DIG**  
www.1100.com.au

I	ISSUED FOR CONSTRUCTION	7.08.14	NS	MB
H	UPDATED POS EASEMENTS	31.07.14	AP/AP	MB
P	AS CONSTRUCTED	19.03.15	AP/AP	MB
O	CONSTRUCTION ISSUE	15.10.14	AP/AP	MB
N	POS AMENDMENT LOT 151	24.09.14	AP/AP	MB
M	LOT 132/133 DWAY AMENDMENTS	17.09.14	JZ/JZ	MB
L	LOTS 131/132 DWAY AMENDMENTS	09.09.14	AP/AP	MB
K	ISSUED FOR CONSTRUCTION	14.08.14	MB/SS	MB
J	DW'S FOR LOTS 137,138,151A & 151 AMENDED	8.08.14	MB/NS	MB
REVISION		DATE	DES/DFT	APPD



All setting out should be carried out in accordance with GAA/Council's standard drawings or as nominated on hard copy plans provided by SMEC. Any digital information supplied by this office is for information only. Any discrepancies should be discussed with the superintendent.

Designed  
J.Zhou  
Drawn  
S.Sathasivam  
Checked  
Z.Gosev  
Authorised  
M.Bouwmeester  
Date  
December 2013

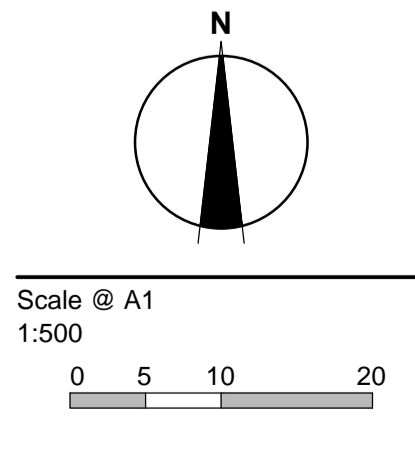

© SMEC Australia Pty Ltd  
ABN 47 065 475 148  
These designs and drawings are the copyright of SMEC Australia Pty Ltd.  
The drawing shall not be reproduced or copied, in whole or part, without the written permission of SMEC Australia Pty Ltd.  
The contents of this drawing are electronically generated, are confidential and may only be used for the purpose for which they are intended.



**URBAN DEVELOPMENT**  
Level 10, 71 Queens Road, Melbourne VIC 3004  
p +61 3 9514 1500 | f +61 3 9514 1502 | www.smec.com

**Arena Estate, Roxburgh Park**  
Stage 1  
Hume City Council  
Roadworks and Drainage  
Layout Plan - 1

Drawing No. 0740E-01-02 Rev P  
Sheet No. 2 of 32

As Constructed

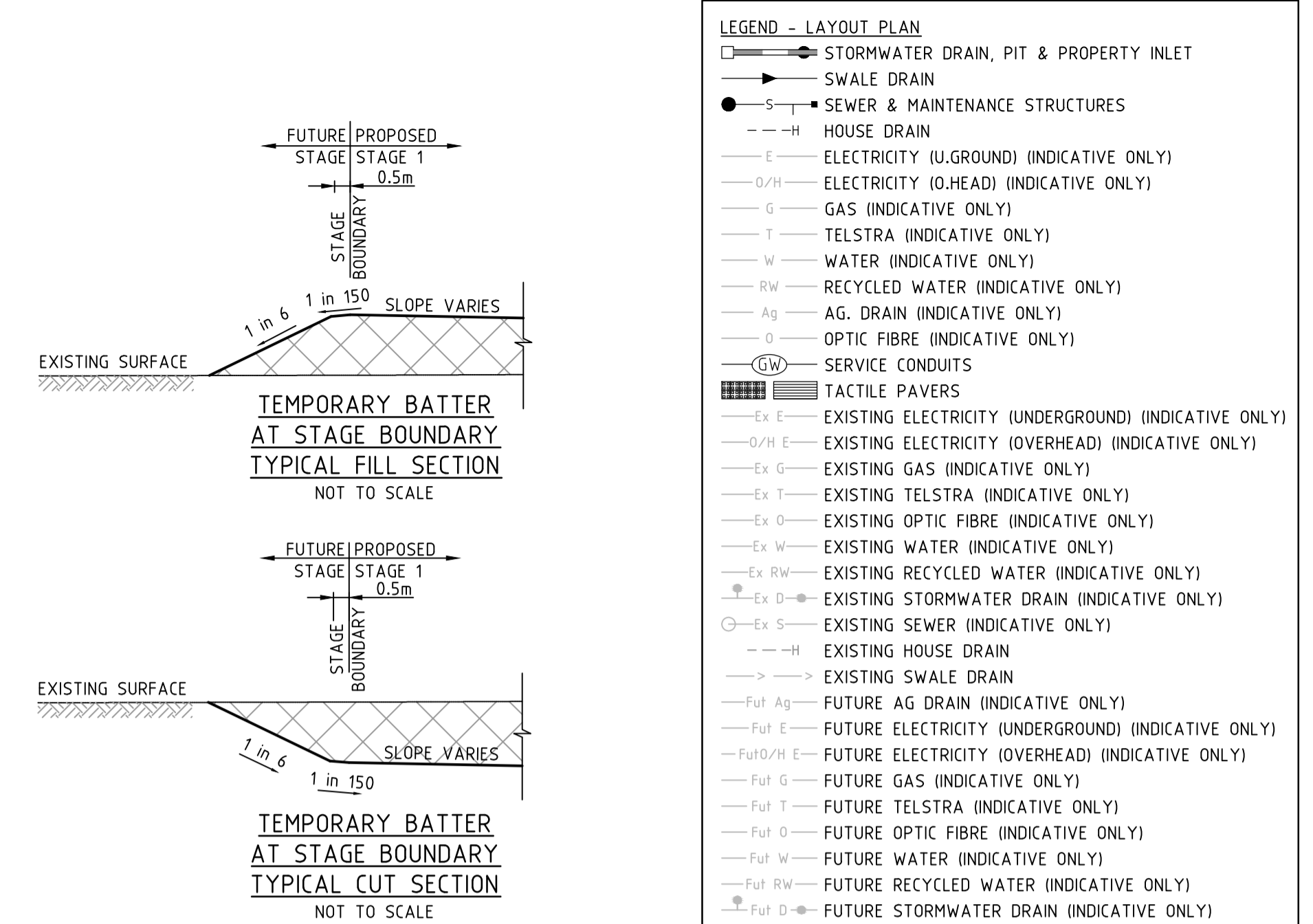
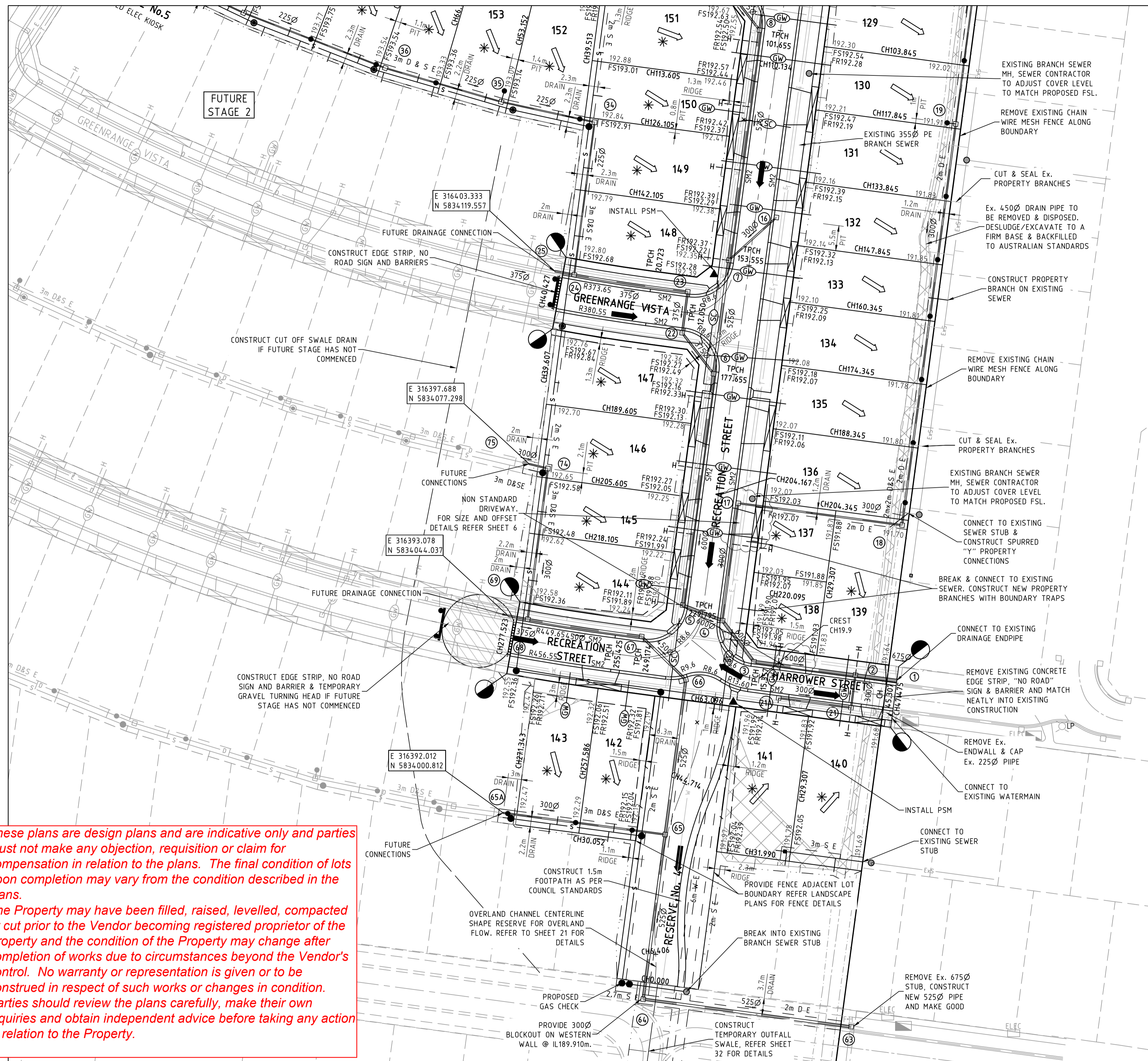

- LEGEND - LAYOUT PLAN**
- STORMWATER DRAIN, PIT & PROPERTY INLET
  - SWALE DRAIN
  - SEWER & MAINTENANCE STRUCTURES
  - HOUSE DRAIN
  - ELECTRICITY (U.GROUND) (INDICATIVE ONLY)
  - ELECTRICITY (O.HEAD) (INDICATIVE ONLY)
  - GAS (INDICATIVE ONLY)
  - TELSTRA (INDICATIVE ONLY)
  - WATER (INDICATIVE ONLY)
  - RECYCLED WATER (INDICATIVE ONLY)
  - AG. DRAIN (INDICATIVE ONLY)
  - OPTIC FIBRE (INDICATIVE ONLY)
  - SERVICE CONDUITS
  - TACTILE PAVERS
  - EXISTING ELECTRICITY (UNDERGROUND) (INDICATIVE ONLY)
  - EXISTING ELECTRICITY (OVERHEAD) (INDICATIVE ONLY)
  - EXISTING GAS (INDICATIVE ONLY)
  - EXISTING TELSTRA (INDICATIVE ONLY)
  - EXISTING OPTIC FIBRE (INDICATIVE ONLY)
  - EXISTING WATER (INDICATIVE ONLY)
  - EXISTING RECYCLED WATER (INDICATIVE ONLY)
  - EXISTING STORMWATER DRAIN (INDICATIVE ONLY)
  - EXISTING SEWER (INDICATIVE ONLY)
  - EXISTING HOUSE DRAIN
  - EXISTING SWALE DRAIN
  - FUTURE AG DRAIN (INDICATIVE ONLY)
  - FUTURE ELECTRICITY (UNDERGROUND) (INDICATIVE ONLY)
  - FUTURE ELECTRICITY (OVERHEAD) (INDICATIVE ONLY)
  - FUTURE GAS (INDICATIVE ONLY)
  - FUTURE TELSTRA (INDICATIVE ONLY)
  - FUTURE OPTIC FIBRE (INDICATIVE ONLY)
  - FUTURE WATER (INDICATIVE ONLY)
  - FUTURE RECYCLED WATER (INDICATIVE ONLY)
  - FUTURE STORMWATER DRAIN (INDICATIVE ONLY)
  - FUTURE SEWER (INDICATIVE ONLY)
  - FUTURE HOUSE DRAIN
  - EXISTING SURFACE LEVEL
  - FINISHED BUILDING LINE LEVEL
  - FINISHED RIDGE LINE LEVEL
  - TOP OF RETAINING WALL
  - BOTTOM OF RETAINING WALL
  - RETAINING WALL
  - ZERO LOT LINES
  - PAVEMENT TREATMENT
  - STRUCTURAL FILL > 200mm DEEP
  - CUT > 200mm DEEP
  - DIRECTION OF FLOW
  - OVERLAND FLOW
  - ALLOTMENT TO BE GRADED EVENLY IN DIRECTION OF FALL TO LEVELS INDICATED
  - CONCRETE EDGE STRIP WITH SUBSOIL DRAIN, "NO ROAD" SIGN & BARRIER
  - LIMIT OF WORKS
  - EXISTING TREE TO BE REMOVED
  - EXISTING TREE TO BE RETAINED
  - PERMANENT SURVEY MARK
  - TEMPORARY BENCH MARK
  - PROPOSED DRIVEWAY

NON STANDARD DRIVEWAY FOR LOTS 137, 138. REFER TO SHEET 05-06 FOR OFFSET AND DIMENSION DETAILS

**HOUSE DRAIN LEVELS:**  
 LOT 137 IL 190.70  
 FUTURE LOT 213 IL 193.50

PLEASE NOTE THAT CONNECTIONS SHOULD BE BUILT TO THE LEVELS PROVIDED.  
 CONNECTIONS CAN BE BUILT LOWER IF REQUIRED.

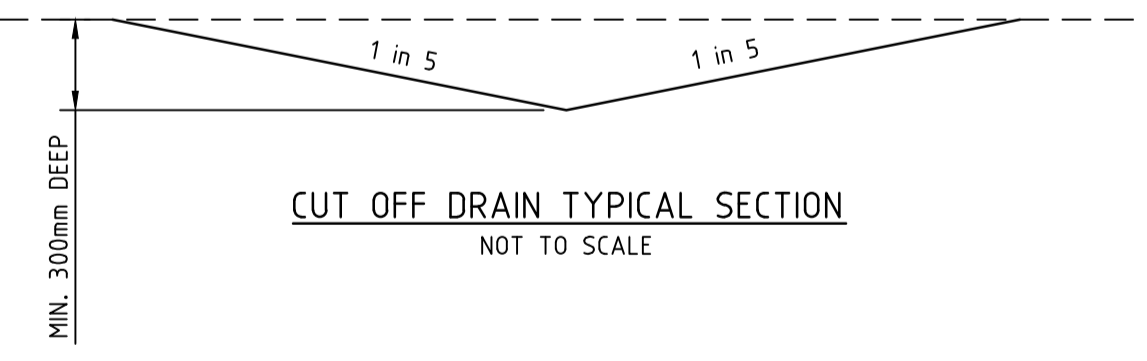

**WARNING**  
**BEWARE OF UNDERGROUND SERVICES**  
 The locations of underground services are approximate only and their exact position should be proven on site.  
 No guarantee is given that all existing services are shown. Locate all underground services before commencement of works  
**DIAL 1100 BEFORE YOU DIG**  
 www.1100.com.au

*These plans are design plans and are indicative only and parties must not make any objection, requisition or claim for compensation in relation to the plans. The final condition of lots upon completion may vary from the condition described in the plans.*

*The Property may have been filled, raised, levelled, compacted or cut prior to the Vendor becoming registered proprietor of the Property and the condition of the Property may change after completion of works due to circumstances beyond the Vendor's control. No warranty or representation is given or to be construed in respect of such works or changes in condition.*

*Parties should review the plans carefully, make their own inquiries and obtain independent advice before taking any action in relation to the Property.*

I	DW'S FOR LOTS 137,138,151A & 151 AMENDED	8.08.14	MB/NS	MB
H	ISSUED FOR CONSTRUCTION	7.08.14	NS	MB
G	UPDATED POS EASEMENTS	31.07.14	AP/AP	MB
O	AS CONSTRUCTED	19.03.15	AP/AP	MB
N	CONSTRUCTION ISSUE	15.10.14	AP/AP	MB
M	POS AMENDMENT FOR LOT 151	24.09.14	AP/AP	MB
L	LOT 132/133 DWAY AMENDMENTS	17.09.14	JZ/JZ	MB
K	LOTS 131/132 DWAY AMENDMENTS	09.09.14	AP/AP	MB
J	ISSUED FOR CONSTRUCTION	14.08.14	MB/SS	MB
REVISION		DATE	DES/DFT	APPD



Principal  
 Peet Limited  
 Level 3, 492 St Kilda Road  
 Melbourne VIC 3004

All setting out should be carried out in accordance with GAA/Council's standard drawings or as nominated on hard copy plans provided by SMEC. Any digital information supplied by this office is for information only. Any discrepancies should be discussed with the superintendent.

Designed  
 J.Zhou  
 Drawn  
 S.Sathasivam  
 Checked  
 Z.Gosev  
 Authorised  
 M.Bouwmeester  
 Date  
 December 2013

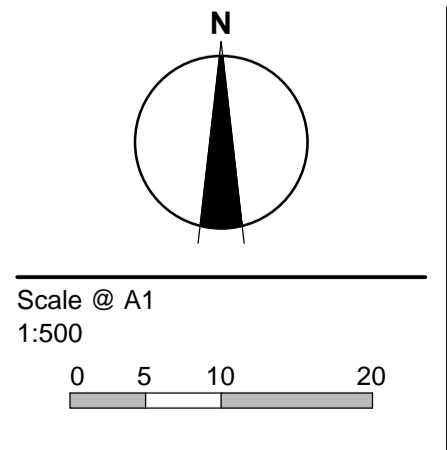

© SMEC Australia Pty Ltd  
 ABN 47 065 475 148  
 These designs and drawings are the copyright of SMEC Australia Pty Ltd.  
 The drawing shall not be reproduced or copied, in whole or part, without the written permission of SMEC Australia Pty Ltd.  
 The contents of this drawing are electronically generated, are confidential and may only be used for the purpose for which they are intended.

**URBAN DEVELOPMENT**  
 Level 10, 71 Queens Road, Melbourne VIC 3004  
 p +61 3 9514 1500 | f +61 3 9514 1502 | www.smec.com

**Arena Estate, Roxburgh Park**  
 Stage 1  
 Hume City Council  
 Roadworks and Drainage  
 Layout Plan - 2

**Drawing No. 0740E-01-03** **Rev O**  
 Sheet No. 3 of 32

**As Constructed**

These plans are design plans and are indicative only and parties must not make any objection, requisition or claim for compensation in relation to the plans. The final condition of lots upon completion may vary from the condition described in the plans.

The Property may have been filled, raised, levelled, compacted or cut prior to the Vendor becoming registered proprietor of the Property and the condition of the Property may change after completion of works due to circumstances beyond the Vendor's control. No warranty or representation is given or to be construed in respect of such works or changes in condition. Parties should review the plans carefully, make their own inquiries and obtain independent advice before taking any action in relation to the Property.

LEGEND	
	EXISTING SURFACE
	DESIGN SURFACE
	DRAINAGE PIPE/PIT
	EXISTING DRAINAGE PIPE/PIT
	HYDRAULIC GRADE LINE

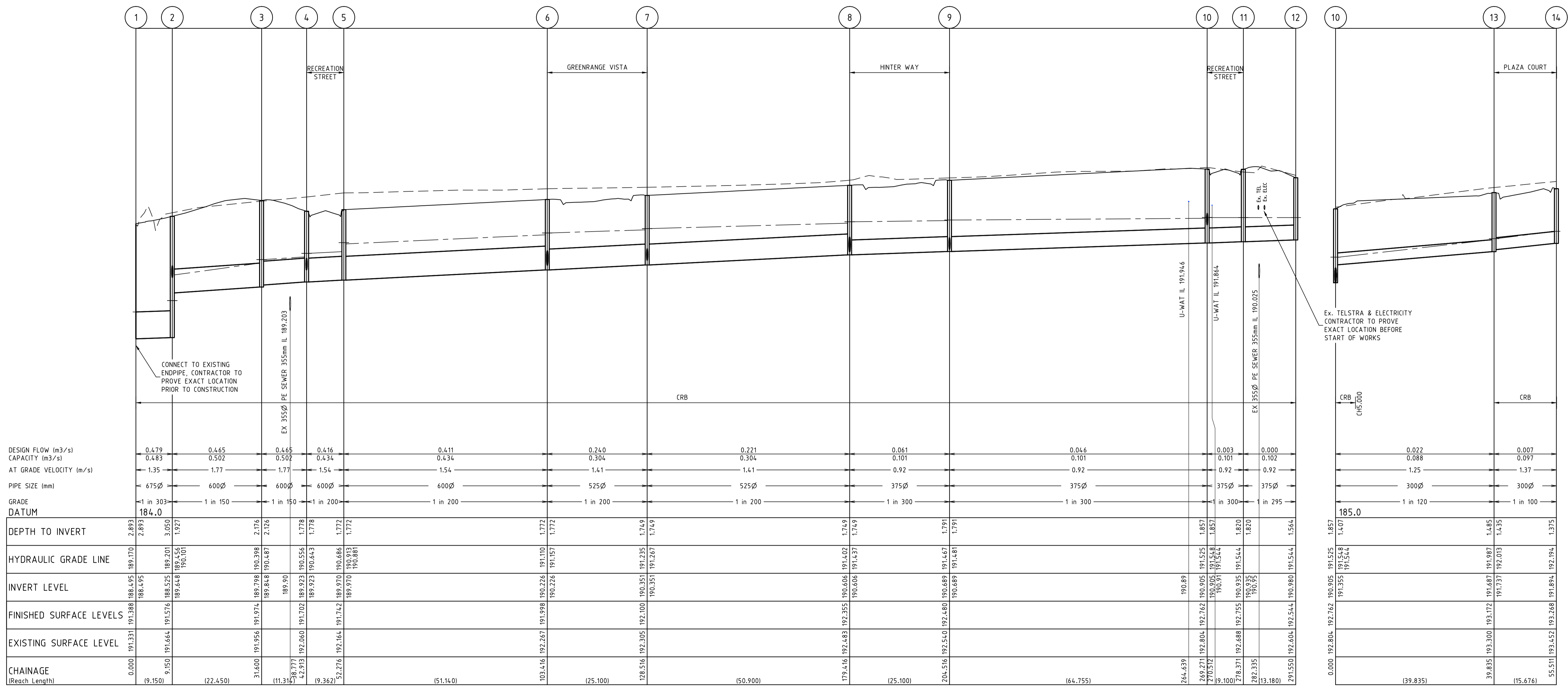

REVISION	DATE	DES/DFT	APPD
G AS CONSTRUCTED	19.03.15	AP/AP	MB
F CONSTRUCTION ISSUE	15.10.14	AP/AP	MB
E ISSUED FOR CONSTRUCTION	7.08.14	NS	MB
D COUNCIL COMMENTS	9.07.14	AP/AP	MB
C ISSUED FOR TENDER	11.03.14	JZ/JZ	MB
B DRAIN AMENDED	12.02.14	JZ/JZ	MB
A ISSUED TO COUNCIL FOR APPROVAL	24.01.14	JZ/SS	MB



All setting out should be carried out in accordance with GAA/Council's standard drawings or as nominated on hard copy plans provided by SMEC Urban. Any digital information supplied by this office is for information only. Any discrepancies should be discussed with the superintendent.

Designed  
J.Zhou  
Drawn  
S.Sathasivam  
Checked  
Z.Gosev  
Authorised  
M.Bouwmeester  
Date  
December 2013

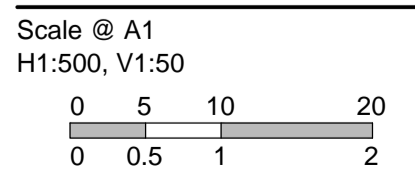

© SMEC Australia Pty Ltd  
ABN 47 065 475 148  
These designs and drawings are the copyright of SMEC Australia Pty Ltd.  
The drawing shall not be reproduced or copied, in whole or part, without the written permission of SMEC Australia Pty Ltd.  
The contents of this drawing are electronically generated, are confidential and may only be used for the purpose for which they are intended.

SMEC Urban  
Level 10, 71 Queens Road, Melbourne, VIC, 3004  
p +61 3 9869 0800 | f +61 3 9869 0900 | www.smec.com.au

Adelaide +61 8 8223 6455  
Brisbane +61 7 3831 8988  
Carlisle +61 2 6126 1900  
Geelong +61 3 5228 3100  
Gold Coast +61 7 5578 0222  
Taranaki +61 3 5173 0100

**Arena Estate, Roxburgh Park**  
Stage 1  
Hume City Council  
Roadworks and Drainage  
Drainage Longitudinal Sections - 1

Drawing No. **0740E-01-23** Rev G  
Sheet No. 23 of 32

As Constructed

These plans are design plans and are indicative only and parties must not make any objection, requisition or claim for compensation in relation to the plans. The final condition of lots upon completion may vary from the condition described in the plans.

The Property may have been filled, raised, levelled, compacted or cut prior to the Vendor becoming registered proprietor of the Property and the condition of the Property may change after completion of works due to circumstances beyond the Vendor's control. No warranty or representation is given or to be construed in respect of such works or changes in condition.

Parties should review the plans carefully, make their own inquiries and obtain independent advice before taking any action in relation to the Property.

LEGEND	
	EXISTING SURFACE
	DESIGN SURFACE
	DRAINAGE PIPE/PIT
	EXISTING DRAINAGE PIPE/PIT
	HYDRAULIC GRADE LINE

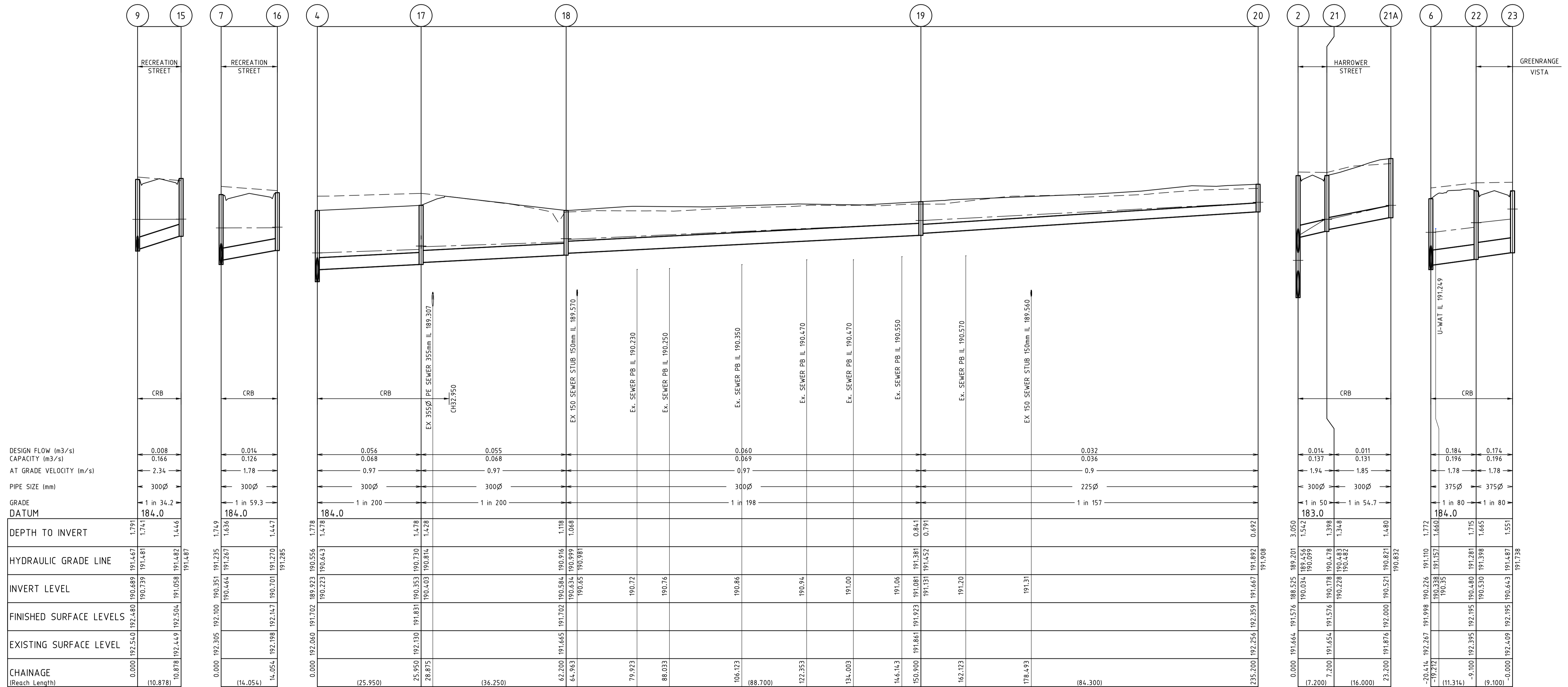

REVISION	DATE	DES/DFT	APPD
A	24.01.14	JZ/SS	MB
B	12.02.14	JZ/JZ	MB
C	11.03.14	JZ/JZ	MB
D	9.07.14	AP/AP	MB
E	7.08.14	NS	MB
F	15.10.14	AP/AP	MB
G	19.03.15	AP/AP	MB



All setting out should be carried out in accordance with GAA/Council's standard drawings or as nominated on hard copy plans provided by SMEC Urban. Any digital information supplied by this office is for information only. Any discrepancies should be discussed with the superintendent.

Designed  
J.Zhou  
Drawn  
S.Sathasivam  
Checked  
Z.Gosev  
Authorised  
M.Bouwmeester  
Date  
December 2013

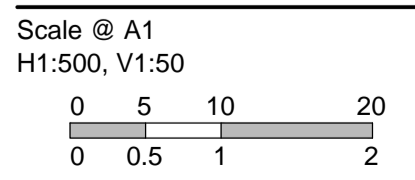

© SMEC Australia Pty Ltd  
ABN 47 065 475 148  
These designs and drawings are the copyright of SMEC Australia Pty Ltd.  
The drawing shall not be reproduced or copied, in whole or part, without the written permission of SMEC Australia Pty Ltd.  
The contents of this drawing are electronically generated, are confidential and may only be used for the purpose for which they are intended.

**SMEC Urban**  
Level 10, 71 Queens Road, Melbourne, VIC, 3004  
p +61 3 9869 0800 | f +61 3 9869 0900 | www.smec.com.au

Adelaide +61 8 8223 6455  
Brisbane +61 7 3831 8988  
Carlisle +61 2 6126 1900  
Geelong +61 3 5228 3100  
Gold Coast +61 7 5578 0222  
Taraikon +61 3 5173 0190

**Arena Estate, Roxburgh Park**  
Stage 1  
Hume City Council  
Roadworks and Drainage  
Drainage Longitudinal Sections - 2

**Drawing No. 0740E-01-24**      **Rev G**  
Sheet No. 24 of 32

**As Constructed**

LEGEND	
---	EXISTING SURFACE
---	DESIGN SURFACE
---	DRAINAGE PIPE/PIT
---	EXISTING DRAINAGE PIPE/PIT
---	HYDRAULIC GRADE LINE

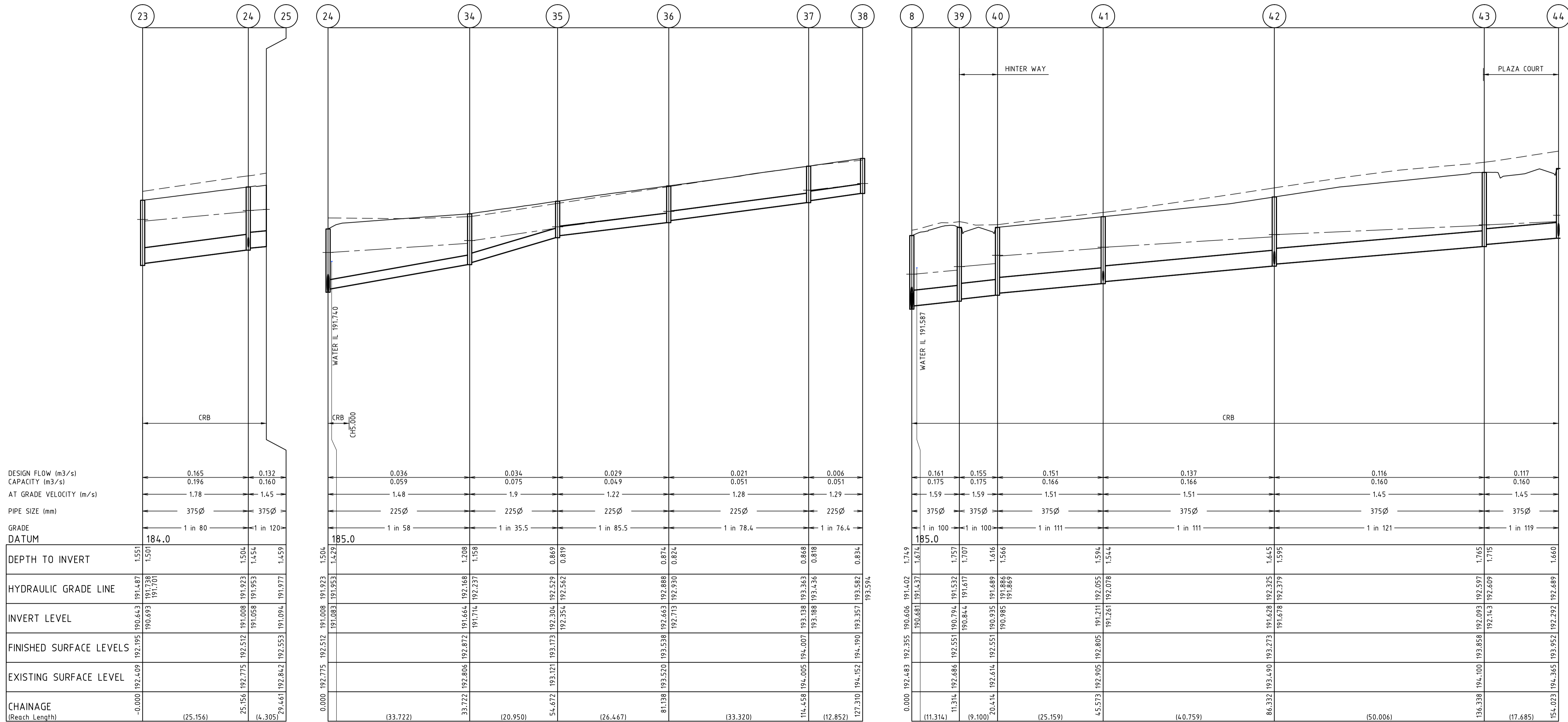

REVISION	DATE	DES/DT	APPD
H AS CONSTRUCTED	19.03.15	AP/AP	MB
G CONSTRUCTION ISSUE	15.10.14	AP/AP	MB
F POS AMENDMENT LOT 151	24.09.14	AP/AP	MB
E ISSUED FOR CONSTRUCTION	7.08.14	NS	MB
D COUNCIL COMMENTS	9.07.14	AP/AP	MB
C ISSUED FOR TENDER	11.03.14	JZ/JZ	MB
B DRAIN AMENDED	12.02.14	JZ/JZ	MB
A ISSUED TO COUNCIL FOR APPROVAL	24.01.14	JZ/SS	MB

**arena**  
AT AITKEN

Principal  
Peet Limited  
Level 3, 492 St Kilda Road  
Melbourne VIC 3004

All setting out should be carried out in accordance with GAA/Council's standard drawings or as nominated on hard copy plans provided by SMEC. Any digital information supplied by this office is for information only. Any discrepancies should be discussed with the superintendent.

Designed  
J.Zhou  
Drawn  
S.Sathasivam  
Checked  
Z.Gosev  
Authorised  
M.Bouwmeester  
Date  
December 2013

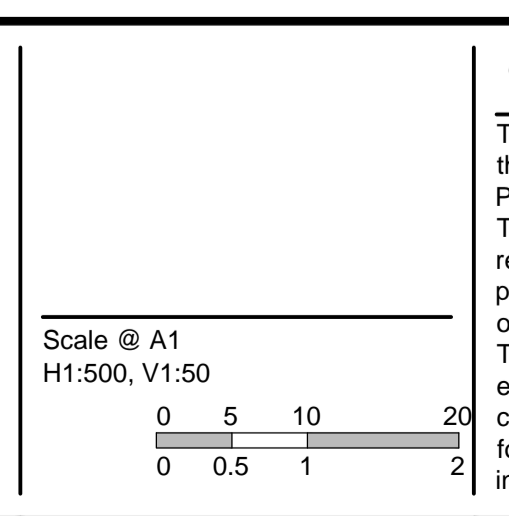

© SMEC Australia Pty Ltd  
ABN 47 065 475 149  
These designs and drawings are the copyright of SMEC Australia Pty Ltd.  
The drawing shall not be reproduced or copied, in whole or part, without the written permission of SMEC Australia Pty Ltd.  
The contents of this drawing are electronically generated, are confidential and may only be used for the purpose for which they are intended.

**URBAN DEVELOPMENT**  
Level 10, 71 Queens Road, Melbourne VIC 3004  
p +61 3 9514 1500 | f +61 3 9514 1502 | www.smec.com

**Arena Estate, Roxburgh Park**  
Stage 1  
Hume City Council  
Roadworks and Drainage  
Drainage Longitudinal Sections - 3

Drawing No. 0740E-01-25 Rev H  
Sheet No. 25 of 32

As Constructed

LEGEND	
	EXISTING SURFACE
	DESIGN SURFACE
	DRAINAGE PIPE/PIT
	EXISTING DRAINAGE PIPE/PIT
	HYDRAULIC GRADE LINE

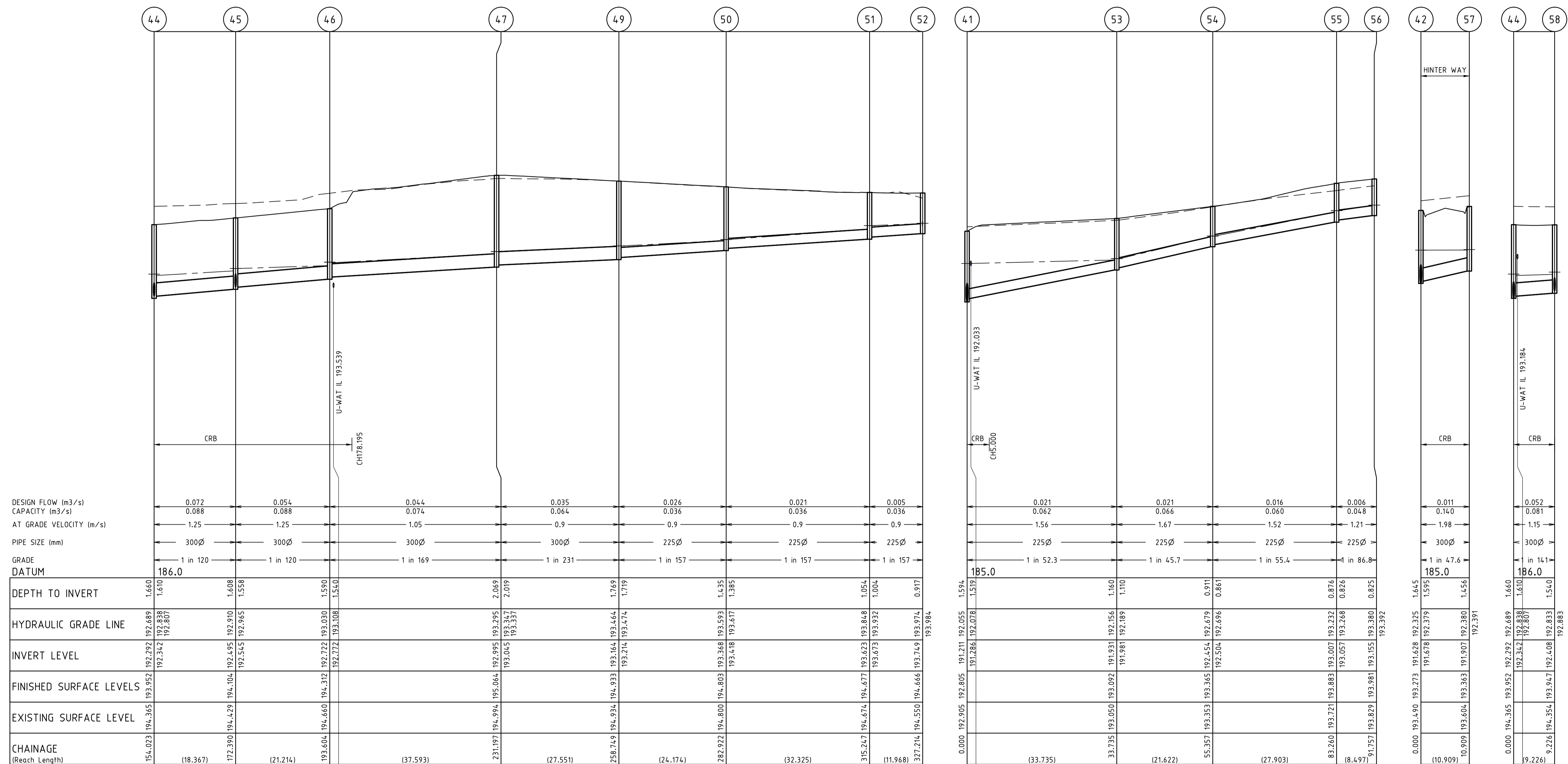

REVISION	DATE	DES/DFT	APPD
A	24.01.14	JZ/SS	MB
B	12.02.14	JZ/JZ	MB
C	11.03.14	JZ/JZ	MB
D	9.07.14	AP/AP	MB
E	7.08.14	NS	MB
F	15.10.14	AP/AP	MB
G	19.03.15	AP/AP	MB

**areng**  
AT AITKEN

Principal  
Peet Limited  
Level 3, 492 St Kilda Road  
Melbourne VIC 3004

All setting out should be carried out in accordance with GAA/Council's standard drawings or as nominated on hard copy plans provided by SMEC Urban. Any digital information supplied by this office is for information only. Any discrepancies should be discussed with the superintendent.

Designed  
J.Zhou  
Drawn  
S.Sathasivam  
Checked  
Z.Gosev  
Authorised  
M.Bouwmeester  
Date  
December 2013

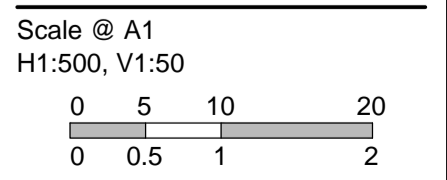

© SMEC Australia Pty Ltd  
ABN 47 065 475 148  
These designs and drawings are the copyright of SMEC Australia Pty Ltd.  
The drawing shall not be reproduced or copied, in whole or part, without the written permission of SMEC Australia Pty Ltd.  
The contents of this drawing are electronically generated, are confidential and may only be used for the purpose for which they are intended.

**SMEC**  
Local People. Global Experience.

**SmeC Urban**  
Level 10, 71 Queens Road, Melbourne, VIC, 3004  
p +61 3 9869 0800 | f +61 3 9869 0900 | www.smeccom.au

Adelaide +61 8 8223 6455  
Brisbane +61 7 3831 8988  
Carlisle +61 2 6126 1900  
Geelong +61 3 5228 3100  
Gold Coast +61 7 5578 0222  
Taraikon +61 3 5173 0190

**Arena Estate, Roxburgh Park**  
Stage 1  
Hume City Council  
Roadworks and Drainage  
Drainage Longitudinal Sections - 4

Drawing No. **0740E-01-26** Rev G  
Sheet No. 26 of 32  
As Constructed

LEGEND	
	EXISTING SURFACE
	DESIGN SURFACE
	DRAINAGE PIPE/PIT
	EXISTING DRAINAGE PIPE/PIT
	HYDRAULIC GRADE LINE

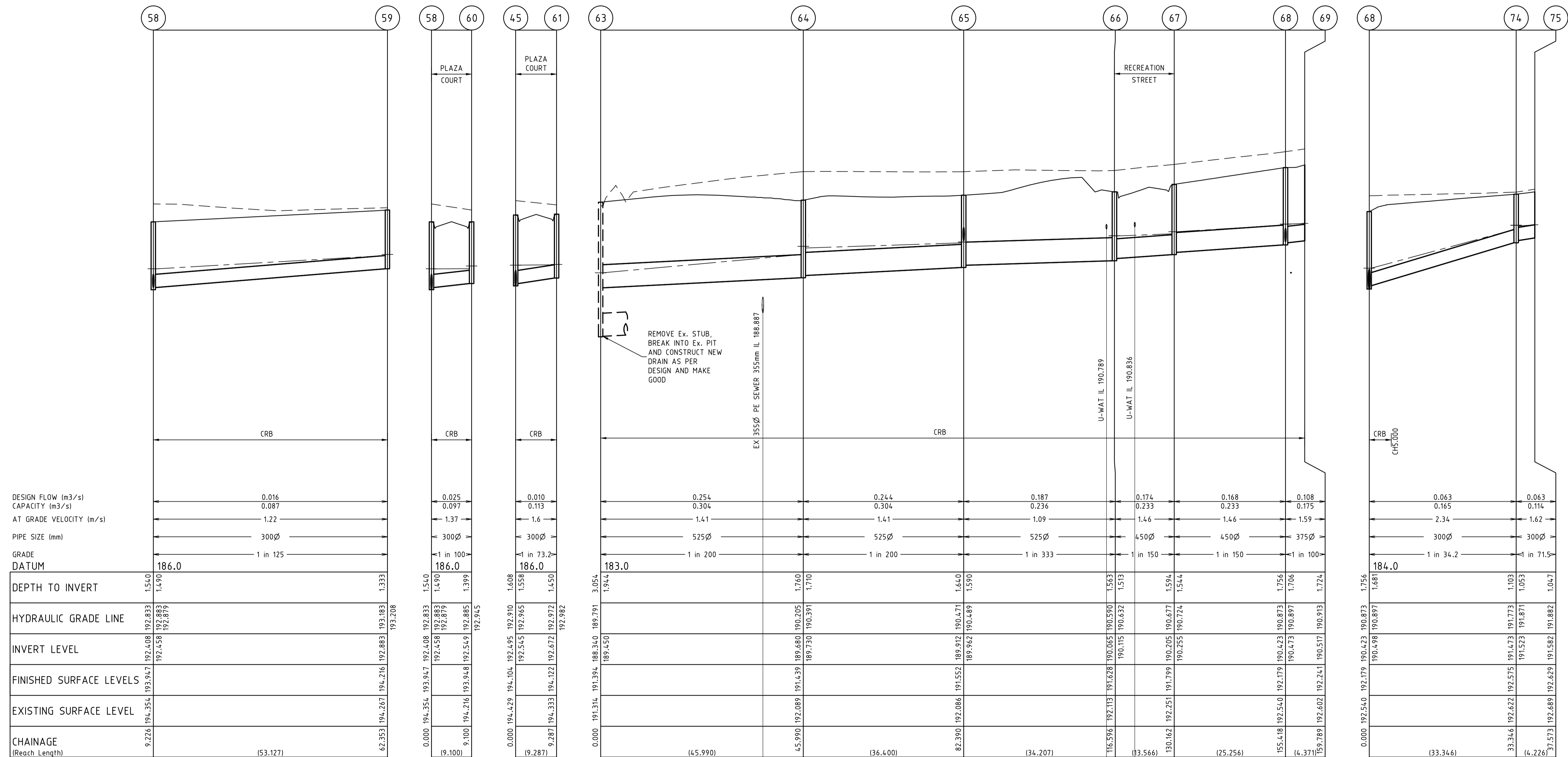

REVISION	DATE	DES/DFT	APPD
A	24.01.14	JZ/SS	MB
B	12.02.14	JZ/JZ	MB
C	11.03.14	JZ/JZ	MB
D	9.07.14	AP/AP	MB
E	7.08.14	NS	MB
F	15.10.14	AP/AP	MB
G	19.03.15	AP/AP	MB



Principal  
Peet Limited  
Level 3, 492 St Kilda Road  
Melbourne VIC 3004

All setting out should be carried out in accordance with GAA/Council's standard drawings or as nominated on hard copy plans provided by SMEC Urban. Any digital information supplied by this office is for information only. Any discrepancies should be discussed with the superintendent.

Designed  
J.Zhou  
Drawn  
S.Sathasivam  
Checked  
Z.Gosev  
Authorised  
M.Bouwmeester  
Date  
December 2013

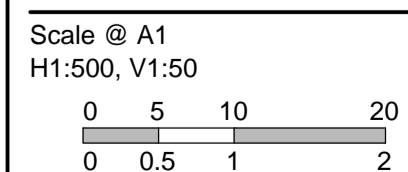

© SMEC Australia Pty Ltd  
ABN 47 065 475 148  
These designs and drawings are the copyright of SMEC Australia Pty Ltd.  
The drawing shall not be reproduced or copied, in whole or part, without the written permission of SMEC Australia Pty Ltd.  
The contents of this drawing are electronically generated, are confidential and may only be used for the purpose for which they are intended.



SmeC Urban  
Level 10, 71 Queens Road, Melbourne, VIC, 3004  
p +61 3 9869 0800 | f +61 3 9869 0900 | www.smeccom.au

Adelaide +61 8 8223 6455  
Brisbane +61 7 3831 8988  
Carlisle +61 2 6126 1900  
Geelong +61 3 5228 3100  
Gold Coast +61 7 5578 0222  
Taraikon +61 3 5173 0190

**Arena Estate, Roxburgh Park**  
Stage 1  
Hume City Council  
Roadworks and Drainage  
Drainage Longitudinal Sections - 5

Drawing No. 0740E-01-27  
Sheet No. 27 of 32

Rev G

As Constructed

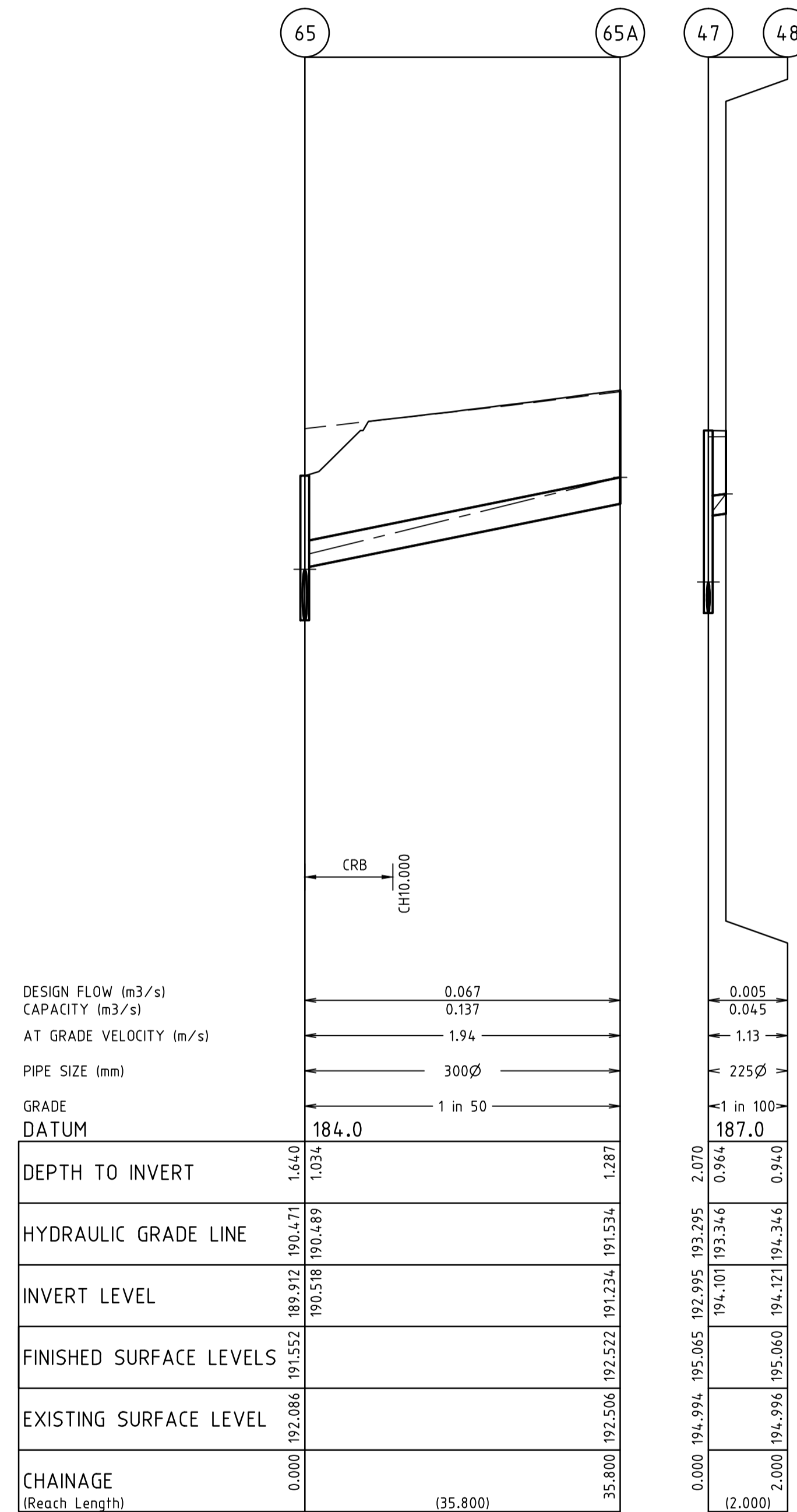

PIT NUMBER	TYPE	INTERNAL		INLET		OUTLET		F.S.L. (m)	DEPTH (m)	STANDARD DRAWING	REMARKS
		WIDTH (mm)	LENGTH (mm)	DIAMETER (mm)	INVERT R.L.(m)	DIAMETER (mm)	INVERT R.L. (m)				
1	ENDPIPE			675	188.495			191.388	2.893		CONNECT TO EXISTING ENDPIPE
2	CHANNEL GRATED PIT	900	900	600	189.648	675	188.525	191.576	3.050	SD215/SD245	TO BE HAUNCHED
3	CHANNEL GRATED PIT	1050	900	600	189.848	600	189.798	191.974	2.176	SD215/SD245	TO BE HAUNCHED
4	CHANNEL GRATED PIT	1050	900	600	189.923	600	189.923	191.702	1.778	SD215/SD245	TO BE HAUNCHED
5	CHANNEL GRATED PIT	900	900	600	189.970	600	189.970	191.742	1.772	SD215/SD245	TO BE HAUNCHED
6	JUNCTION PIT	900	900	525	190.226	600	190.226	191.998	1.772	SD230/SD245	TO BE HAUNCHED
7	CHANNEL GRATED PIT	900	900	525	190.351	525	190.351	192.100	1.749	SD215/SD245	TO BE HAUNCHED
8	JUNCTION PIT	900	900	375	190.606	525	190.606	192.355	1.749	SD230/SD245	TO BE HAUNCHED
9	CHANNEL GRATED PIT	600	900	375	190.689	375	190.689	192.480	1.791	SD215	
10	CHANNEL GRATED PIT	600	900	375	190.905	375	190.905	192.762	1.857	SD215	
11	CHANNEL GRATED PIT	600	900	375	190.935	375	190.935	192.755	1.820	SD215	
12	Ex JUNCTION PIT	600	900	600	190.980	375	190.980	192.544	1.564		REMOVE Ex. 300Ø DRAIN PIPE AND CONSTRUCT NEW 375Ø PIPE TO PIT
13	DOUBLE CHANNEL GRATED PIT (HB2)	600	900	300	191.737	300	191.687	193.172	1.485	SD211	
14	CHANNEL GRATED PIT	600	900	300	191.894	300	191.894	193.268	1.375	SD215	
15	CHANNEL GRATED PIT	600	900	300	191.058	300	191.058	192.504	1.446	SD215	
16	CHANNEL GRATED PIT	600	900	300	190.701	300	190.701	192.147	1.447	SD215	
17	JUNCTION PIT	600	900	300	190.403	300	190.353	191.831	1.478	SD230	
18	JUNCTION PIT	600	900	300	190.634	300	190.584	191.702	1.118	SD230	
19	JUNCTION PIT	600	900	225	191.131	300	191.081	191.923	0.841	SD230	
20	JUNCTION PIT	600	900	225	191.667	225	191.667	192.359	0.692	SD230	
21	CHANNEL GRATED PIT	600	900	300	190.228	300	190.178	191.576	1.398	SD215	
21A	CHANNEL GRATED PIT	600	900	300	190.521	300	190.521	192.000	1.480	SD215	
22	CHANNEL GRATED PIT	600	900	375	190.530	375	190.480	192.195	1.715	SD215	
23	CHANNEL GRATED PIT	600	900	375	190.693	375	190.643	192.195	1.551	SD215	
24	JUNCTION PIT	600	900	375	191.058	375	191.008	192.512	1.504	SD230	
25	ENDPIPE			225	191.083						BLANK OFF ENDPIPE
25	ENDPIPE			225	191.083						BLANK OFF ENDPIPE
34	JUNCTION PIT	600	900	225	191.714	225	191.664	192.872	1.208	SD230	
35	JUNCTION PIT	600	900	225	192.354	225	192.304	193.173	0.869	SD230	
36	JUNCTION PIT	600	900	225	192.713	225	192.663	193.538	0.874	SD230	
37	JUNCTION PIT	600	900	225	193.188	225	193.138	194.007	0.868	SD230	
38	JUNCTION PIT	600	900	225	193.357	225	193.307	194.190	0.884	SD230	
39	CHANNEL GRATED PIT	600	900	375	190.844	375	190.794	192.551	1.757	SD215	
40	CHANNEL GRATED PIT	600	900	375	190.985	375	190.935	192.551	1.616	SD215	
41	JUNCTION PIT	600	900	375	191.261	375	191.211	192.805	1.594	SD230	
42	CHANNEL GRATED PIT	600	900	375	191.678	375	191.628	193.273	1.645	SD215	
43	CHANNEL GRATED PIT	600	900	375	192.143	375	192.093	193.858	1.765	SD215	
44	JUNCTION PIT	600	900	300	192.342	375	192.292	193.952	1.660	SD230	
45	CHANNEL GRATED PIT	600	900	300	192.545	300	192.495	194.104	1.608	SD215	
46	JUNCTION PIT	600	900	300	192.772	300	192.722	194.312	1.590	SD230	
47	JUNCTION PIT	600	900	300	193.045	300	192.995	195.064	2.069	SD230	
48	ENDPIPE			225	194.101						BLANK OFF ENDPIPE
48	ENDPIPE			225	194.101						BLANK OFF ENDPIPE
49	JUNCTION PIT	600	900	225	193.214	300	193.164	194.933	1.769	SD230	
50	JUNCTION PIT	600	900	225	193.418	225	193.368	194.803	1.435	SD230	
51	JUNCTION PIT	600	900	225	193.673	225	193.623	194.677	1.054	SD230	
52	JUNCTION PIT	600	900	225	193.749	225	193.699	194.666	0.917	SD230	
53	JUNCTION PIT	600	900	225	191.981	225	191.931	193.092	1.160	SD230	
54	JUNCTION PIT	600	900	225	192.504	225	192.454	193.365	0.911	SD230	
55	JUNCTION PIT	600	900	225	193.057	225	193.007	193.883	0.876	SD230	
56	JUNCTION PIT	600	900	225	193.155	225	193.105	193.981	0.825	SD230	
57	CHANNEL GRATED PIT	600	900	300	191.907	300	191.857	193.363	1.456	SD215	
58	CHANNEL GRATED PIT	600	900	300	192.458	300	192.408	193.947	1.540	SD215	
59	JUNCTION PIT	600	900	300	192.883	300	192.833	194.216	1.333	SD230	
60	CHANNEL GRATED PIT	600	900	300	192.549	300	192.499	193.948	1.399	SD215	
61	CHANNEL GRATED PIT	600	900	300	192.672	300	192.622	194.122	1.450	SD215	
63	Ex CHANNEL GRATED PIT	900	900	525	189.450	525	188.350	191.394	3.054		REMOVE Ex. 675Ø STUB, CONSTRUCT NEW 525Ø PIPE
64	JUNCTION PIT	900	900	525	189.730	525	189.680	191.439	1.760	SD230/SD245	TO BE HAUNCHED
65	JUNCTION PIT	900	900	525	189.962	525	189.912	191.552	1.640	SD230/SD245	TO BE HAUNCHED
65A	ENDPIPE			300	190.518						BLANK OFF ENDPIPE
66	DOUBLE CHANNEL GRATED PIT	900	900	450	190.115	525	190.065	191.628	1.563	SD216/SD245	TO BE HAUNCHED
67	CHANNEL GRATED PIT	600	900	450	190.255	450	190.205	191.799	1.594	SD215	
68	JUNCTION PIT	600	900	375	190.473	450	190.423	192.179	1.756	SD230	
69	ENDPIPE			300	190.498						BLANK OFF ENDPIPE
74	JUNCTION PIT	600	900	300	191.523	300	191.473	192.575	1.103	SD230	
75	ENDPIPE			300	191.502						BLANK OFF ENDPIPE

REVISION	DATE	DESIGN	APPD
H	19.03.15	AP/AP	MB
G	15.10.14	AP/AP	MB
F	24.09.14	AP/AP	MB
E	7.08.14	NS	MB
D	9.07.14	AP/AP	MB
C	11.03.14	JZ/JZ	MB
B	12.02.14	JZ/JZ	MB
A	24.01.14	JZ/SS	MB

**arena**  
AT AITKEN

Principal  
Peet Limited  
Level 3, 492 St Kilda Road  
Melbourne VIC 3004

All setting out should be carried out in accordance with GAA/Council's standard drawings or as nominated on hard copy plans provided by SMEC. Any digital information supplied by this office is for information only. Any discrepancies should be discussed with the superintendent.

Designed  
J.Zhou  
Drawn  
S.Sathisvam  
Checked  
Z.Gosev  
Authorised  
M.Bouwmeester  
Date  
December 2013

Scale @ A1

© SMEC Australia Pty Ltd  
ABN 47 065 475 149  
These designs and drawings are the copyright of SMEC Australia Pty Ltd.  
The drawing shall not be reproduced or copied, in whole or part, without the written permission of SMEC Australia Pty Ltd.  
The contents of this drawing are electronically generated, are confidential and may only be used for the purpose for which they are intended.

**URBAN DEVELOPMENT**  
Level 10, 71 Queens Road, Melbourne VIC 3004  
p +61 3 9514 1500 | f +61 3 9514 1502 | www.smec.com

**Arena Estate, Roxburgh Park**  
Stage 1  
Hume City Council  
Roadworks and Drainage  
Drainage Longitudinal Sections - 6 & Pit Schedule  
**Drawing No. 0740E-01-28**  
Sheet No. 28 of 32  
**Rev H**  
**As Constructed**