

# NEWHAVEN ESTATE STAGE 7A PEET NO. 1895 PTY LTD

## GENERAL NOTES:

- ALL LEVELS ARE TO AUSTRALIAN HEIGHT DATUM AND ALL COORDINATES ARE TO MAP GRID OF AUSTRALIA (MGA) ZONE 55.
- ALL EXISTING SURFACE LEVELS SHOWN ON THE ENGINEERING DRAWINGS HAVE BEEN INTERPOLATED FROM A DIGITAL TERRAIN MODEL. THESE LEVELS HAVE BEEN USED AS THE BASIS FOR ALL ENGINEERING DESIGN AND DETERMINATION OF QUANTITIES AND ARE ACCURATE TO WITHIN ±0.05m.
- ALL WORKS TO BE CARRIED OUT IN ACCORDANCE WITH PEET'S MODIFIED AS4000-1997 - AMENDED FROM GENERAL CONDITIONS OF CONTRACT FOR USE IN VICTORIA, THE ROAD & DRAINAGE SPECIFICATION, APPROVED MUNICIPALITY SPECIFICATIONS AND STANDARD DRAWINGS AND TO THE SATISFACTION OF THE SUPERINTENDENT AND THE MUNICIPAL ENGINEER OR HIS REPRESENTATIVE.
- ROAD CHAINAGES REFER TO ROAD CENTRELINES. CHAINAGES FOR INTERSECTIONS AND CUL-DE-SACS REFER TO THE LIP OF KERB
- THE LOCATION OF EXISTING SERVICES SHOULD BE DETERMINED BY THE CONTRACTOR PRIOR TO COMMENCING ANY EXCAVATION BY CONTACTING ALL LOCAL SERVICE AUTHORITIES. ANY EXISTING SERVICES SHOWN ON THESE DRAWINGS ARE OFFERED AS A GUIDE ONLY AND ARE NOT GUARANTEED AS CORRECT.
- WHERE REQUIRED ANY BUILDINGS, TROUGHS, FENCES AND OTHER STRUCTURES ON SITE ARE TO BE REMOVED AS DIRECTED BY THE ENGINEER. THE COST OF REMOVAL IS TO BE INCLUDED IN THE OVERALL EARTHWORKS FIGURE UNLESS A SPECIFIC ITEM FOR REMOVAL IS DENOTED IN THE SCHEDULE.
- ALL EXCAVATED ROCK AND SURPLUS SPOIL TO BE REMOVED AND DISPOSED OFF SITE UNLESS NOTED OTHERWISE.
- ALL FILLING ON LOTS AND WITHIN ROAD RESERVES GREATER THAN 200mm IS TO BE UNDERTAKEN USING LEVEL 1 SUPERVISION AND BE COMPLETED IN ACCORDANCE WITH AS 3798-2007. FILL AREAS ARE TO BE STRIPPED OF TOPSOIL, FILLED AND REPLACED WITH TOPSOIL (WHERE REQUIRED) TO OBTAIN THE FINAL LEVELS SHOWN ON THE DRAWINGS.
- FILLING MATERIAL IS TO BE IN ACCORDANCE WITH THE SPECIFICATION, AS 3798-2007 & TO THE SATISFACTION OF COUNCIL AND THE SUPERINTENDENT.
- ALL BATTERS SHALL BE 1 IN 6, UNLESS OTHERWISE SHOWN.
- NO FILL OR STOCKPILING OF MATERIAL IS TO BE PLACED ON ANY RESERVE FOR PUBLIC OPEN SPACE UNLESS OTHERWISE DIRECTED OR APPROVED BY THE SUPERINTENDENT.
- TBM'S TO BE RE-ESTABLISHED BY THE LICENSED SURVEYOR IF FOUND TO BE MISSING AT THE COMMENCEMENT OF CONSTRUCTION. THE CONTRACTOR WILL BE RESPONSIBLE FOR CARE AND MAINTENANCE OF T.B.M.'S THEREAFTER.
- AT LEAST 3 DAYS PRIOR TO COMMENCING WORK ON EXCAVATIONS IN EXCESS OF 1.50m DEEP, A NOTIFICATION FORM MUST BE SENT TO WORKSAFE. THE CONTRACTOR IS TO COMPLY WITH WORKSAFE, THE MINES (TRENCHES) REGULATION 1982, THE MINES ACT 1958 AND OCCUPATIONAL HEALTH AND SAFETY ACT 1985, 2004.
- ALL SERVICE TRENCHES UNDER DRIVEWAYS, FOOTPATHS AND PARKING BAYS TO BE BACKFILLED WITH CLASS 2 CRUSHED ROCK. SERVICE TRENCHES LESS THAN 750mm BEHIND KERB AND CHANNEL OR PAVED TRAFFIC AREAS ARE ALSO TO BE BACKFILLED WITH COMPACTED CLASS 2 CRUSHED ROCK.
- WHERE REQUIRED, ALL EXISTING DAMS, DEPRESSIONS AND DRAINS ARE TO BE BREACHED, DRAINED, DESLUDGED AND SHALL BE EXCAVATED TO A CLEAN FIRM BASE. THE SURFACE SHALL BE INSPECTED, APPROVED AND LEVELED BY THE ENGINEER PRIOR TO COMMENCEMENT OF FILLING. THE FILL SHALL BE APPROVED SELECTED ON SITE MATERIAL OR APPROVED IMPORTED MATERIAL. THE FILL SHALL BE PLACED UNDER CONTROLLED MOISTURE CONDITIONS IN ACCORDANCE WITH THE SPECIFICATION
- NO BLASTING TO BE CARRIED OUT WITHIN THE MUNICIPALITY WITHOUT OBTAINING COUNCIL'S PERMISSION.
- GAS AND WATER CONDUITS ARE TO BE:  
Ø50mm - CLASS 12 P.V.C. - SINGLE SERVICE  
Ø100mm - CLASS 12 P.V.C. - DUAL SERVICE (DRINKING AND NON DRINKING WATER)  
WITH THE FOLLOWING MINIMUM COVER TO FINISHED SURFACE LEVELS:  
ROAD PAVEMENT - 0.80m  
VERGE, FOOTPATHS - 0.45m
- ALL SERVICE CONDUIT TRENCHES UNDER ROAD PAVEMENTS TO BE BACKFILLED IN ACCORDANCE WITH RELEVANT MUNICIPALITY OR ROAD AUTHORITY SPECIFICATION.
- AG/SUBSOIL DRAIN TO BE LAID BEHIND KERB WHERE REQUIRED IN ACCORDANCE WITH THE COUNCIL STANDARD DRAWINGS AND CONNECTED TO UNDERGROUND DRAINAGE.
- ALL STORMWATER DRAINS ARE TO BE CLASS '2' R.C. PIPES UNLESS OTHERWISE SHOWN. ALL R.C. JOINTS ARE TO BE RUBBER RING JOINTED (R.R.J.).
- CENTRELINES OF ALL EASEMENT DRAINS ARE OFFSET 1.0m OR 2.2m (WHERE OUTSIDE OF SEWER) FROM THE PROPERTY LINE UNLESS SHOWN OTHERWISE.
- WHERE CURVED PIPE ALIGNMENTS ARE SHOWN ON THE FACE PLANS THEY ARE TO BE LAID PARALLEL TO THE BACK OF KERB, EXCEPT WHERE A RADIUS HAS BEEN SPECIFICALLY NOMINATED. CURVED PIPES ARE TO BE APPROVED BY COUNCIL AND IN ACCORDANCE WITH THE MANUFACTURERS SPECIFICATIONS.
- WATER TAPPINGS TO BE LOCATED IN CENTRE OF ALLOTMENTS UNLESS OTHERWISE SHOWN.
- TELSTRA IS TO BE NOTIFIED 7 DAYS PRIOR TO PLACEMENT OF CONCRETE WORKS.
- PAVEMENT DEPTHS MAY BE MODIFIED AS DIRECTED BY THE SUPERINTENDENT. PAVEMENT TO BE BOXED OUT TO MINIMUM DEPTH DENOTED, INSPECTED AND IF SUBGRADE IS IN QUESTION, FURTHER TESTING CARRIED OUT TO DETERMINE FINAL PAVEMENT DEPTH.
- WHERE PAVEMENT IS CONSTRUCTED ON FILLING, FILL MATERIAL IS TO BE APPROVED BY THE SUPERINTENDENT AND COUNCIL. FILLING TO BE CONSTRUCTED IN LAYERS 150mm THICK WITH COMPACTION ACHIEVING 95% AUSTRALIAN STANDARD DENSITY.
- WHEN PAVEMENT EXCAVATION IS IN ROCK, ALL LOOSE MATERIAL (INCLUDING ROCKS AND CLAY) MUST BE REMOVED. THE SUB-GRADE MUST THEN BE REGULATED WITH COUNCIL APPROVED MATERIAL.
- LINE MARKING AND SIGNAGE TO BE INSTALLED IN ACCORDANCE WITH AS 1742 SERIES UNLESS NOTED OTHERWISE. STREET SIGNS ARE TO BE INSTALLED IN ACCORDANCE WITH COUNCIL STANDARDS.
- ALL TEMPORARY WARNING SIGNS USED DURING CONSTRUCTION SHALL BE SUPPLIED AND MAINTAINED IN ACCORDANCE WITH AS 1742-3.
- TACTILE GROUND SURFACE INDICATORS ARE TO BE INSTALLED IN ACCORDANCE WITH THE DISABILITY DISCRIMINATION ACT AND RELEVANT COUNCIL STANDARD DRAWINGS.
- CONTRACTOR TO PROVIDE AN ENVIRONMENTAL MANAGEMENT PLAN INCLUDING SILT AND SEDIMENT RUNOFF PROTECTION ETC. PRIOR TO THE COMMENCEMENT OF WORKS.
- ALL TREES AND SHRUBS ARE TO BE RETAINED UNLESS OTHERWISE SHOWN. IF ROAD AND DRAINAGE CONSTRUCTION NECESSITATES THEIR REMOVAL, WRITTEN PERMISSION MUST BE OBTAINED FROM THE SUPERINTENDENT.
- TREES NOT SPECIFIED FOR REMOVAL ARE TO BE PROTECTED WITH APPROPRIATE EXCLUSION FENCING PRIOR TO COMMENCEMENT OF ANY WORKS.

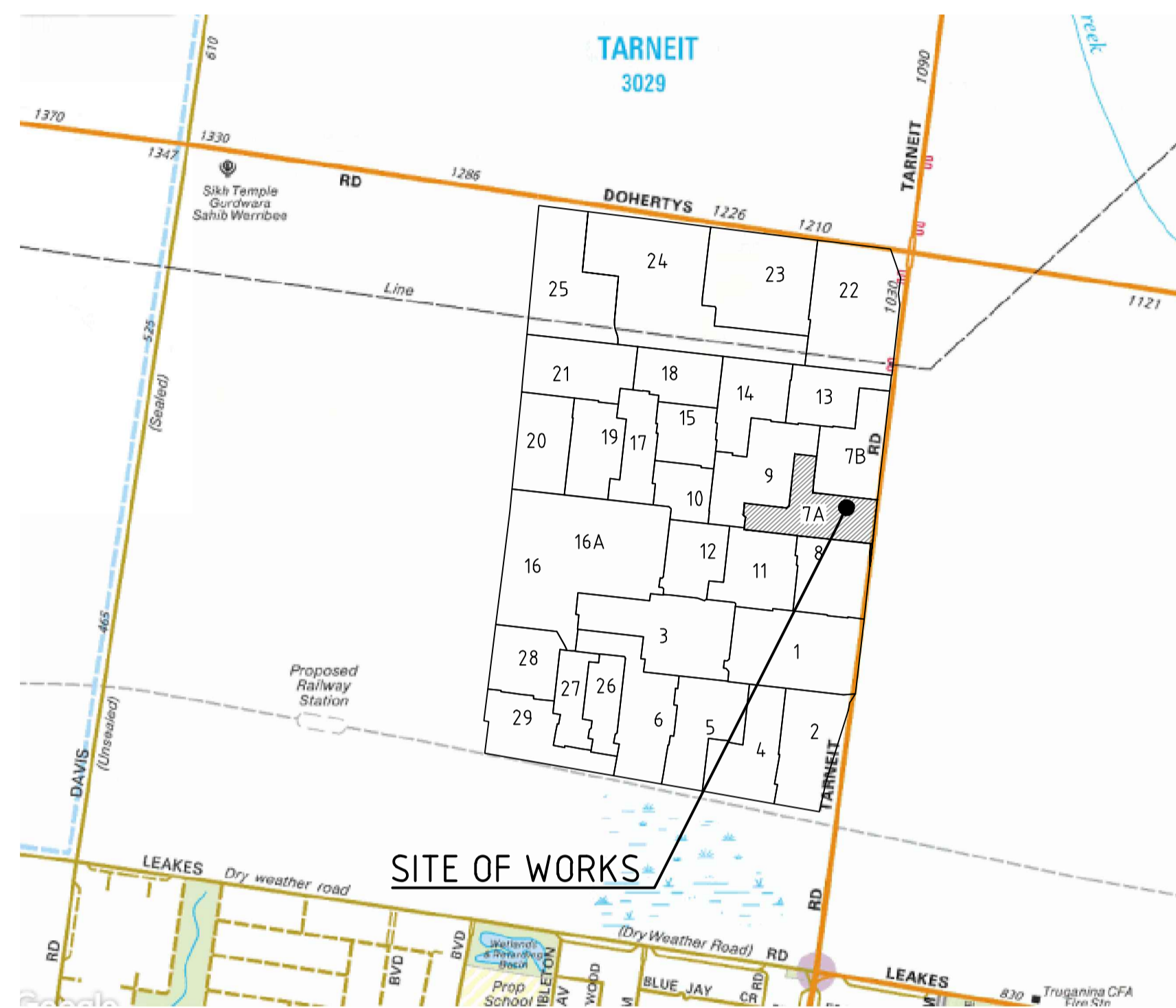

COPYRIGHT MELWAY PUBLISHING PTY LTD  
REPRODUCED WITH PERMISSION



## LOCALITY PLAN

SCALE: NOT TO SCALE  
MELWAY: 359 B11

## SERVICE LOCATION TABLE

ROAD NAME	POTABLE WATER		RECYCLED WATER		GAS		NBN (TELECOM)		ELECTRICITY				TREE	
	SIDE	OFFSET	SIDE	OFFSET	SIDE	OFFSET	SIDE	OFFSET	POLE	U/G CABLE	SIDE	OFFSET	SIDE	OFFSET
NAVIGATION ROAD	W	3.29	W	2.58	W	1.97	E	1.85	TBC	VARIES*	E	2.45	BOTH	1.00*
CULTURE LANE	W	2.90	W	2.42	W	2.00	E	1.83	TBC	VARIES*	E	2.55	BOTH	1.00*
ODYSSEY BOULEVARD	S	3.85	S	3.12	S	2.50	N	1.85	TBC	VARIES*	N	2.74	BOTH	1.00*
UNIVERSAL ROAD	E	2.90	E	2.42	E	2.00	W	1.83	TBC	VARIES*	W	2.55	BOTH	1.00*
LEGION AVENUE	S	2.90	S	2.42	N	2.00	S	1.83	TBC	VARIES*	N	2.55	BOTH	1.00*

- TELECOMMUNICATIONS AND ELECTRICITY CABLES TO BE CONSTRUCTED IN A COMMON TRENCH IN ACCORDANCE WITH ELECTRICITY AUTHORITY STANDARD DRG'S
- \* = OFFSET 0.80m FROM BACK OF KERB UNLESS OTHERWISE STATED. REFER ELECTRICAL DESIGN DRAWINGS
- # = BEHIND BACK OF KERB



**WARNING**  
BEWARE OF UNDERGROUND/OVERHEAD SERVICES  
THE LOCATION OF SERVICES ARE APPROXIMATE ONLY AND THEIR EXACT POSITION SHOULD BE PROVEN ON SITE. NO GUARANTEE IS GIVEN THAT ALL EXISTING SERVICES ARE SHOWN. SPECIAL CONSIDERATION SHOULD BE GIVEN TO CONSTRUCTION PROCEDURES UNDER OVERHEAD ELECTRICITY TRANSMISSION LINES.

## DRAWING SCHEDULE

REFERENCE	DESCRIPTION	REVISION	SHEET No.
CR100	FACE SHEET	9	1
CR200	DETAIL PLAN	9	2
CR201	SERVICES PLAN	7	3
CR300	ROAD LONGITUDINAL SECTIONS, SHEET 1 OF 3	4	4
CR301	ROAD LONGITUDINAL SECTIONS, SHEET 2 OF 3	4	5
CR400	ROAD CROSS SECTIONS, ODYSSEY BOULEVARD	3	6
CR401	ROAD CROSS SECTIONS, ODYSSEY BOULEVARD	2	7
CR402	ROAD CROSS SECTIONS, ODYSSEY BLVD, NAVIGATION RD & CULTURE LN	3	8
CR403	ROAD CROSS SECTIONS, LEGION AVENUE	3	9
CR500	INTERSECTION DETAILS, SHEET 1 OF 3	2	10
CR501	INTERSECTION DETAILS, SHEET 2 OF 3	5	11
CR502	INTERSECTION DETAILS, SHEET 3 OF 3	2	12
CR600	DRAINAGE LONG SECTIONS	3	13
CR601	DRAINAGE LONG SECTIONS	4	14
CR602	DRAINAGE LONG SECTIONS	3	15
CR603	DRAINAGE LONG SECTIONS	3	16
CR604	DRAINAGE LONG SECTIONS	6	17
CR700	PAVEMENT AND TYPICAL DETAILS	4	18
CR800	SIGNAGE AND LINE MARKING PLAN	6	19
CR900	STRUCTURAL PIT 77	4	20

DESCRIPTION	EXISTING	PROPOSED
WATER MAIN, VALVE AND HYDRANT	DW - X	DW
WATER RECYCLED	NDW	NDW
UNDERGROUND ELECTRICITY	E	E
OVERHEAD ELECTRICITY & POLE	OE	OE
TELSTRA & SERVICE PIT	T	T
OPTIC FIBRE	OF	OF
OVERHEAD TELSTRA	OT	OT
GAS MAIN	G	G
BRANCH SEWER & MANHOLE	S	S
SEWER & MANHOLE	S	S
SEWER RISING MAIN	SRM	SRM
CENTRAL INVERT	>	>
COUNCIL STORMWATER DRAIN & PIT		
STORMWATER DRAINAGE PROPERTY INLETS		
COUNCIL STORMWATER PITS		
HOUSE DRAIN	H	H
AG DRAIN AND FLUSHER	AG	AG
MWC STORMWATER DRAIN & PIT		
MWC STORMWATER PITS		
STORMWATER DRAINAGE PIT NUMBER	1	1
GAS & WATER CONDUITS	GW	GW
CONCRETE VEHICLE CROSSING/INDUSTRIAL CROSSING		
PAVEMENT SAWCUT LINE		SAWCUT
RIDGE / CHANGE OF GRADE LINE		
SURFACE CONTOUR MINOR	- 168.90 -	168.90
SURFACE CONTOUR MAJOR	- 169.00 -	169.00
SURFACE LEVEL	E123.45	F124.68
BATTER LEVEL (TOP / TOE)	T124.80	T124.80
EARTHWORKS GRADE		1 in 150
SIGN AND POST		
LIGHT & POLE (BY OTHERS)		
STREET SIGN		
PERMANENT SURVEY MARK		
TEMPORARY BENCH MARK		
BOLLARD		
ROAD CHAINAGES	CH116.57 (L/R)TP CH116.57	CH116.57 (L/R)TP CH116.57
LOT CHAINAGE	CH20.06	CH20.06
SETOUT POINT		A2
LIMIT OF WORKS		
BATTER		
EXCAVATION GREATER THAN 0.20m		
FILLING GREATER THAN 0.20m		
FILL EXTENTS		
ROCK BEACHING		
RETAINING WALL - CONCRETE		
FENCE - TREE PROTECTION		
FENCE - VEHICLE EXCLUSION		
FENCES		
GUARD RAIL		
TREE (& SURVEYED CANOPY) TO BE RETAINED		
TREE TO BE REMOVED		
VEGETATION LINE		
FOOTPATH		
FOOTPATH (HEAVY DUTY - 200mm THICK)		

file name: 303439CR100.dwg, layout name: CR100, plotted by: George Vyzantidis, file location: G:\303439CR100\A\A\CR100.dwg, plot date: 09/07/2020 2:23 PM, Sheet 1 of 20 Sheets

Rev	Description	Approved	Date
9	ISSUED FOR CONSTRUCTION	M.H.	08-07-20
8	AMENDMENTS TO UTILITIES CORRIDOR	MH	29-05-20
7	LOT LEVELS ADDED	M.H.	28-02-20
6	AS CONSTRUCTED	MH	05-12-19
5	SHARED PATH LINE MARKING AMENDED, ODYSSEY BLVD XS & LEVELS AMENDED	M.H.	30-08-19
4	ODYSSEY BLVD INT AMENDMENTS, ADDTNL DRAINAGE IN UTILITIES CORRIDOR	M.H.	29-05-19
3	STAGE 7 BOUNDARY AMENDED TO 7A	M.H.	19-02-19
2	HOUSE DRAIN CONNECTIONS ADDED TO CR604	M.H.	10-01-19
1	Amendments	Approved	Date



© Spiire Australia Pty Ltd All Rights Reserved  
This document is produced by Spiire Australia Pty Ltd solely for the benefit of and use by the client in accordance with the terms of the retainer. Spiire Australia Pty Ltd does not and shall not assume any responsibility or liability whatsoever to any third party arising out of any use or reliance by third party on the content of this document.

**spiire**

414 La Trobe Street PO Box 16084 Melbourne  
Victoria 3007 Australia T 61 3 9993 7888  
spiire.com.au ABN 55 050 029 635

**PEET**

Designed  
H. SPURLING  
Authorised  
M. HOLMES

Checked  
A. CHARALAMBOUS  
Date  
30-08-19

**NEWHAVEN ESTATE  
STAGE 7A  
ROAD & DRAINAGE FACE SHEET  
FACE SHEET**  
WYNDHAM CITY COUNCIL  
PEET NO. 1895 PTY LTD

**CONSTRUCTION** Drg No **303439CR100** Rev **9**

ALIGNMENT ODYSSEY ROAD CL

POINT NO	EASTING	NORTHING
R1	295322.486	5811278.487
R2	295278.753	5811283.353
R3	295145.630	5811294.116
1/4	295143.724	5811294.277
1/2	295141.820	5811294.453
3/4	295139.917	5811294.643
R4	295138.016	5811294.847
R5	295023.013	5811307.643

CURVE	RADIUS	ARC L	CHORD MID ORD	QTR ORD
ROAD R3-ROAD R4	253.800	7.649	7.649	0.029
				0.007

NOTE:  
TOP OF BATTER LEVELS FOR LOTS 701, 708, 709, 716 AND 715, TO BE ACHIEVED AS STATED TO ENSURE OVERLAND FLOW CONVEYANCE.

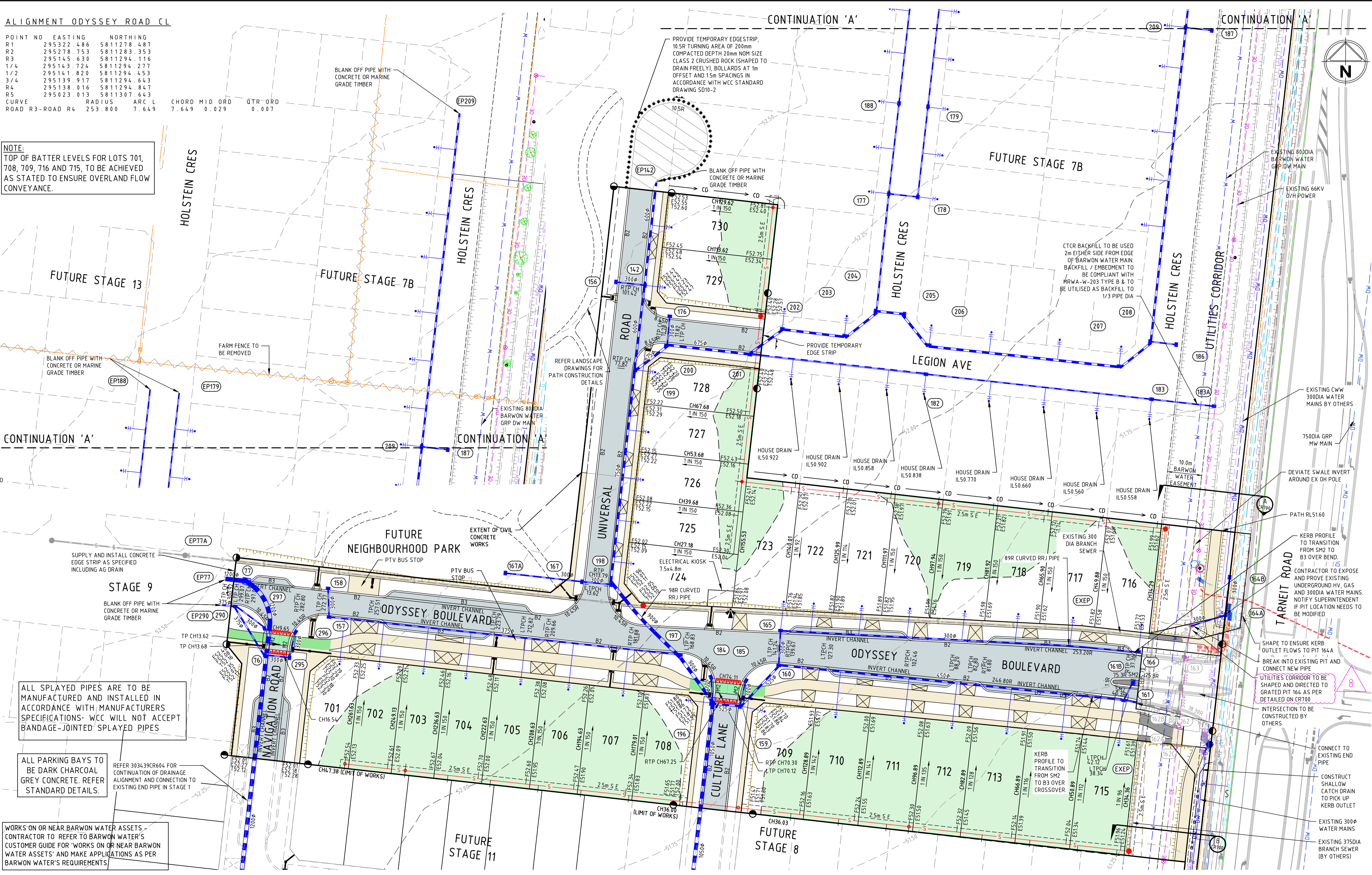

ALL SPLAYED PIPES ARE TO BE MANUFACTURED AND INSTALLED IN ACCORDANCE WITH MANUFACTURERS SPECIFICATIONS. WCC WILL NOT ACCEPT BANDAGE-JOINTED SPLAYED PIPES

ALL PARKING BAYS TO BE DARK CHARCOAL GREY CONCRETE. REFER STANDARD DETAILS.

WORKS ON OR NEAR BARWON WATER ASSETS - CONTRACTOR TO REFER TO BARWON WATER'S CUSTOMER GUIDE FOR 'WORKS ON OR NEAR BARWON WATER ASSETS' AND MAKE APPLICATIONS AS PER BARWON WATER'S REQUIREMENTS

Rev	Amendments	Approved	Date
9	ISSUED FOR CONSTRUCTION	M.H.	09-07-20
8	NOTE REGARDING SHAPING OF UTILITIES CORRIDOR ADDED	M.H.	08-07-20
7	UTILITIES CORRIDOR AMENDMENTS	MH	29-05-20
6	LOT LEVELS ADDED	M.H.	28-02-20
5	AS CONSTRUCTED	MH	05-12-19
4	ODYSSEY BLVD LEVELS AMENDED	M.H.	30-08-19
3	ODYSSEY BLVD INTERSECTION AMENDMENTS	M.H.	29-05-19
2	STAGE 7 BOUNDARY AMENDED TO 7A	M.H.	19-02-19

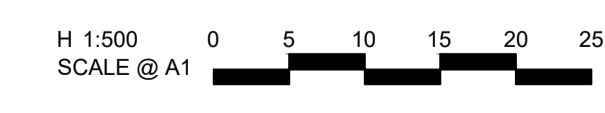

AS/NZS 15300  
 AS/NZS 15300  
 AS/NZS 15300

© Spiire Australia Pty Ltd All Rights Reserved  
 This document is produced by Spiire Australia Pty Ltd solely for the benefit of and use by the client in accordance with the terms of the retainer. Spiire Australia Pty Ltd does not and shall not assume any responsibility or liability whatsoever to any third party arising out of any use or reliance by third party on the content of this document.

**spiire**

414 La Trobe Street PO Box 16084 Melbourne  
 Victoria 3007 Australia T 61 3 9993 7888  
 spiire.com.au ABN 55 050 029 635

**PEET**

Designed  
H. SPURLING

Checked  
A. CHARALAMBOUS

Authorised  
M. HOLMES

Date  
30-08-19

**NEWHAVEN ESTATE  
 STAGE 7A  
 ROAD & DRAINAGE LAYOUT PLAN  
 DETAIL PLAN  
 WYNDHAM CITY COUNCIL  
 PEET NO. 1895 PTY LTD**

**CONSTRUCTION** Drg No 303439CR200 Rev 9

file name: 303439CR200.dwg, layout name: CD200, created by: George Yacoubich, file location: G:\303439CR200\CAD\ALAD\plot.dwg, plot date: 09/07/2020, 02:23 PM Sheet 2 of 20 Sheets