

**LEGEND**

- 56 — Post Construction Contours
- - - - - Topographic Change In Grade
- + 35.53 Post Construction Surface Level
- ▭ Concrete Path or Driveway
- Kerb and Channel
- - - - - Retaining Walls

**ENGINEER'S CERTIFICATION**

I, **Ryan Ashworth**, being a Certified/ Registered Engineer and duly authorised representative of **PEAKURBAN Pty Ltd**, hereby, certify the information contained in this drawing as generally an accurate "As Constructed" representation of the works.

*RA*  
RPEQ (Signature)      19674      Date: 28/10/2020  
RPEQ No.

For and on behalf of **PEAKURBAN Pty Ltd**.  
In making this certificate we have relied upon information provided by others.

We RPS Australia East Pty Ltd, Registered Surveyor – Land hereby certify that the Levels and Dimensions shown hereon are a correct record of our Survey which was performed in accordance with Council Accuracy Standards

*[Signature]*  
Authorised Delegate      16/07/2020  
Date

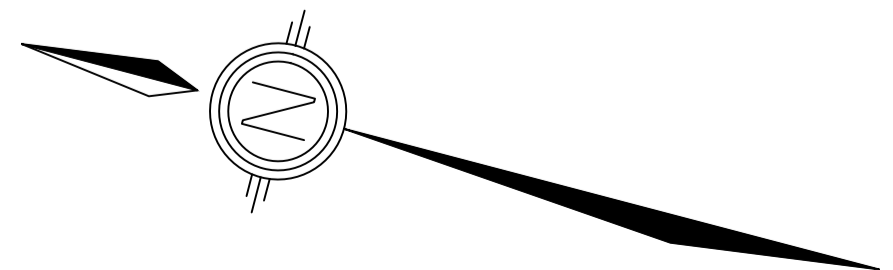
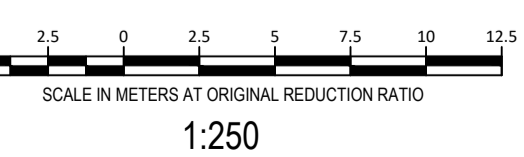
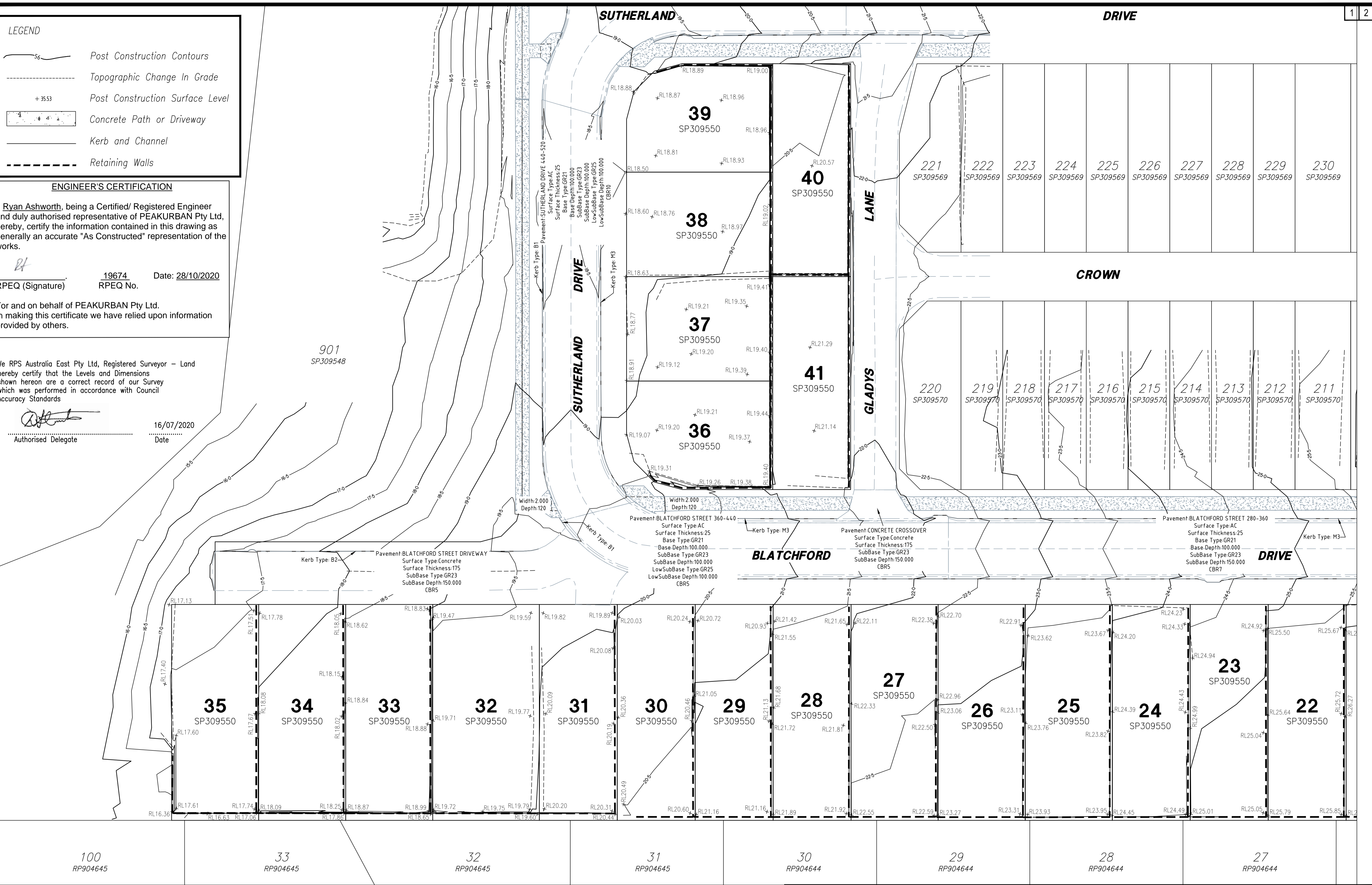

|                                   |  |  |                             |
|-----------------------------------|--|--|-----------------------------|
| PROJECT<br><b>SAMSONVALE ROAD</b> |  | CLIENT<br><b>PEET LIMITED</b>                                    |                             |
| LEVEL DATUM<br>AHD                | SCALE<br><b>1:250 @ A1</b>                 | <b>AS CONSTRUCTED<br/>POST CONSTRUCTION CONTOURS<br/>STAGE 4</b> |                             |
| ORIGIN<br>PM 108388<br>RL 19.893  | Date: <b>OCTOBER 2020</b><br>Surveyed: RPS |  |                             |
| Comp by: TJE                      | Parish: STRATHPINE                         | Job Ref: 142823-6  | Reference: <b>142823-22</b> |
| FB :      LB :                    | DWG: 142823 Stage4POST                     | Local Authority: MORETON BAY REGIONAL COUNCIL                    | Rev                         |

**RPS**

RPS Australia East Pty Ltd  
ACN 140 292 762  
ABN 44 140 292 762  
Level 4 HQ South, 520 Wickham St  
PO Box 1559  
Fortitude Valley QLD 4006  
T +61 7 3539 9500  
F +61 7 3237 8833  
W rpsgroup.com.au

© COPYRIGHT PROTECTS THIS PLAN  
Unauthorized reproduction or amendment  
not permitted. Please contact the author.



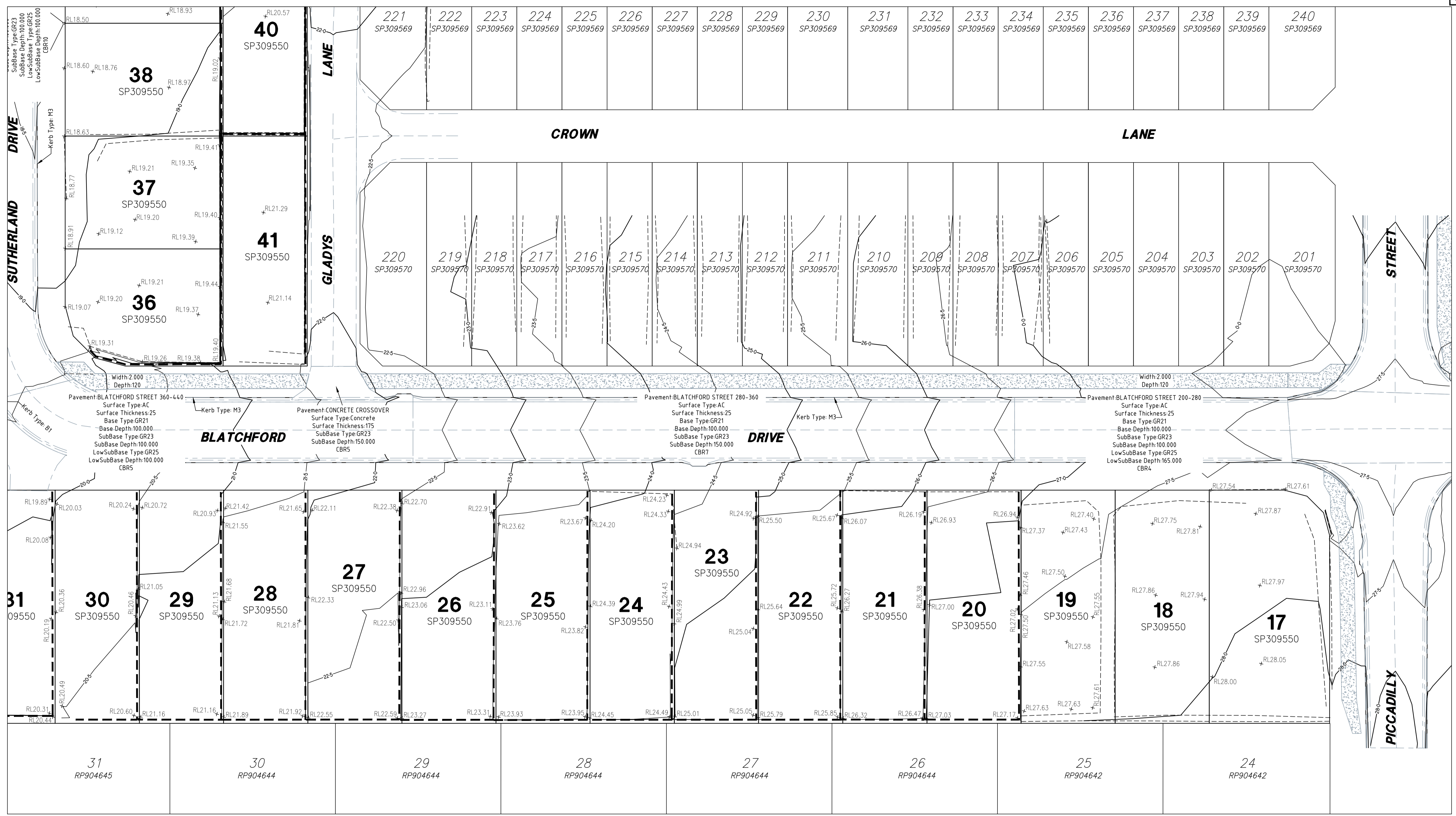

**LEGEND**

- Post Construction Contours
- Topographic Change In Grade
- Post Construction Surface Level
- Concrete Path or Driveway
- Kerb and Channel
- Retaining Walls

**ENGINEER'S CERTIFICATION**

I, **Ryan Ashworth**, being a Certified/ Registered Engineer and duly authorised representative of PEAKURBAN Pty Ltd, hereby, certify the information contained in this drawing as generally an accurate "As Constructed" representation of the works.

Date: 28/10/2020  
 RPEQ (Signature) RPEQ No. 19674

For and on behalf of PEAKURBAN Pty Ltd.  
 In making this certificate we have relied upon information provided by others.

We RPS Australia East Pty Ltd, Registered Surveyor – Land hereby certify that the Levels and Dimensions shown hereon are a correct record of our Survey which was performed in accordance with Council Accuracy Standards

16/10/2020  
 Authorised Delegate Date

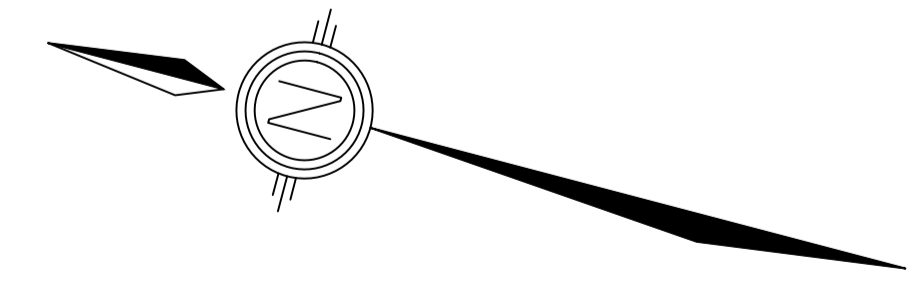

|                                   |   |  |                               |
|-----------------------------------|---|--|-------------------------------|
| PROJECT<br><b>SAMSONVALE ROAD</b> |   | CLIENT<br><b>PEET LIMITED</b>                                    |                               |
| LEVEL DATUM<br>AHD                | SCALE<br><b>1:250 @ A1</b>  | <b>AS CONSTRUCTED<br/>POST CONSTRUCTION CONTOURS<br/>STAGE 4</b> |                               |
| ORIGIN<br>PM 108388<br>RL 19.893  | Date: <u>OCTOBER 2020</u><br>Surveyed: RPS                          |  |                               |
| Comp. by: TJE                     | Parish: STRATHPINE<br>Local Authority: MORETON BAY REGIONAL COUNCIL |  |                               |
| FB :                              | LB :  | Job Ref<br>142823-6  | Reference<br><b>142823-22</b> |

RPS Australia East Pty Ltd  
 ACN 140 292 762  
 ABN 44 140 292 762  
 Level 4 HQ South, 520 Wickham St  
 PO Box 1559  
 Fortitude Valley QLD 4006  
 T +61 7 3539 9500  
 F +61 7 3237 8833  
 W rpsgroup.com.au

© COPYRIGHT PROTECTS THIS PLAN  
 Unauthorised reproduction or amendment  
 not permitted. Please contact the author.



| SEWERAGE RETICULATION |                                |
|-----------------------|--------------------------------|
| ESTATE/STAGE          | STAGE 4                        |
| SITE ADDRESS          | 84 SAMSONVALE ROAD, STRATHPINE |

**ENGINEER'S CERTIFICATION**

I, Ryan Ashworth, being a Certified/ Registered Engineer and duly authorised representative of PEAKURBAN Pty Ltd, hereby, certify the information contained in this drawing as generally an accurate "As Constructed" representation of the works.

*RA*  
 19674 Date: 28/10/2020  
 RPEQ (Signature) RPEQ No.

For and on behalf of PEAKURBAN Pty Ltd.  
 In making this certificate we have relied upon information provided by others.

We RPS Australia East Pty Ltd, Registered Surveyor – Land hereby certify that the Levels and Dimensions shown hereon are a correct record of our Survey which was performed in accordance with Council Accuracy Standards

*[Signature]*  
 12/10/2020  
 Authorised Delegate Date

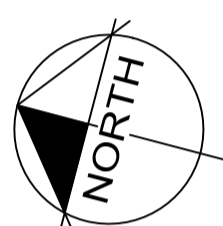

901  
SP309548

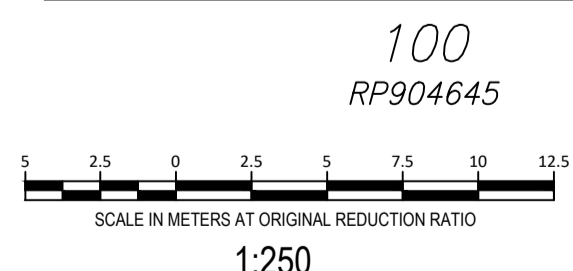
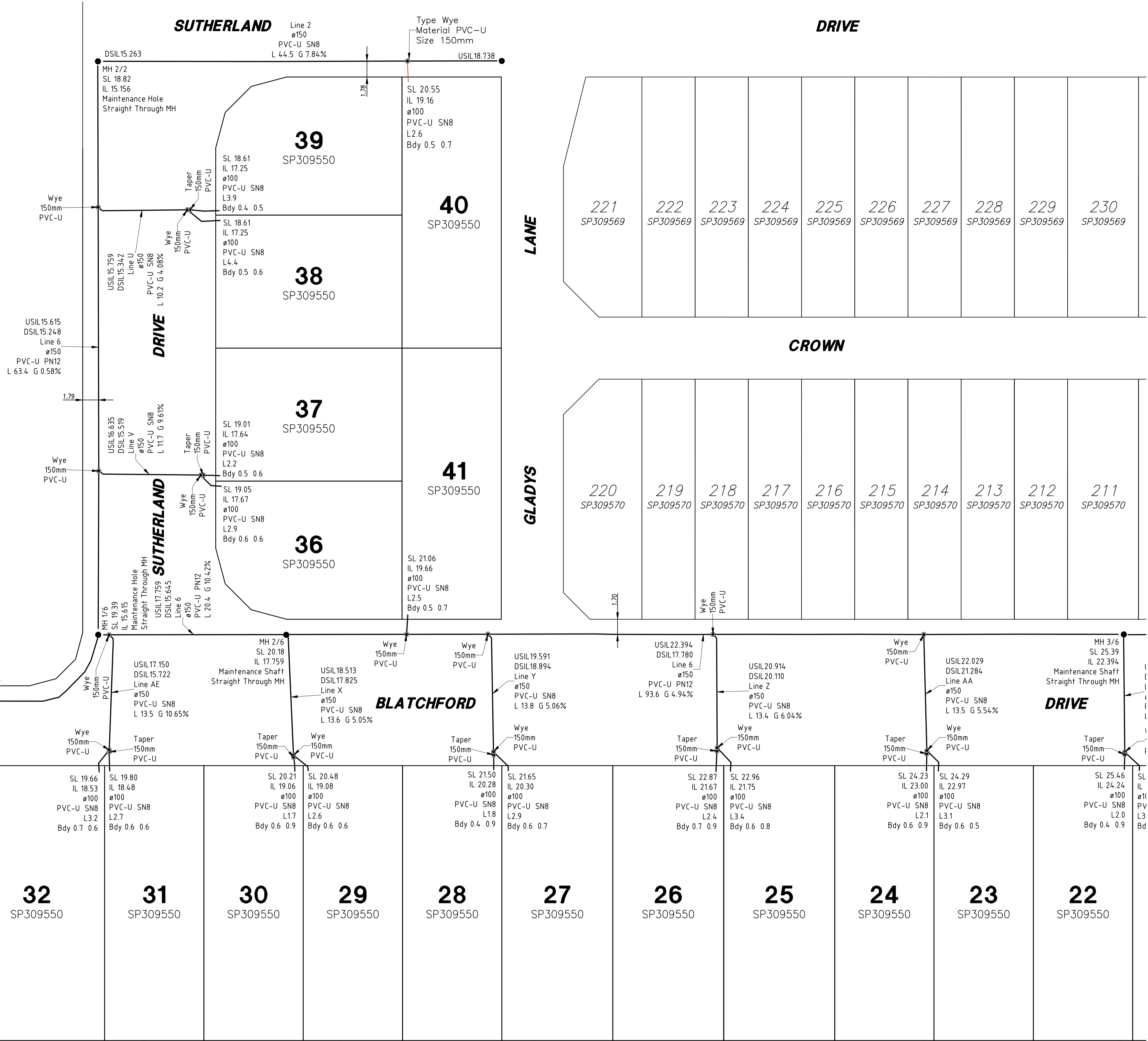

33  
RP904645

32  
RP904645

31  
RP904645

30  
RP904644

29  
RP904644

28  
RP904644

27  
RP904644

| A1    | -    | -         | -     | -       | -      | - |
|-------|------|-----------|-------|---------|--------|---|
|       | -    | -         | -     | -       | -      | - |
|       | -    | -         | -     | -       | -      | - |
|       | -    | -         | -     | -       | -      | - |
|       | -    | -         | -     | -       | -      | - |
| INDEX | DATE | REVISIONS | DRAWN | CHECKED | PASSED |   |

| DRAWN    | RPS  | 12/10/2020 |
|----------|------|------------|
| CHECKED  | RPS  | 12/10/2020 |
| PASSED   | -    | -          |
| INITIALS | DATE |            |

**RPS**

RPS Australia Asia Pacific  
 Level 4 HQ South  
 520 Wickham St  
 Fortitude Valley  
 QLD 4006  
 T +61 7 3539 8500  
 W rpsgroup.com

Unitywater

Unitywater

AS - CONSTRUCTED  
SEWERAGE RETICULATION

|             |               |
|-------------|---------------|
| SCALE       | 1:250 @ A1    |
| SHEET       | 1 OF 2 SHEETS |
| DRAWING NO. | 142823-19     |

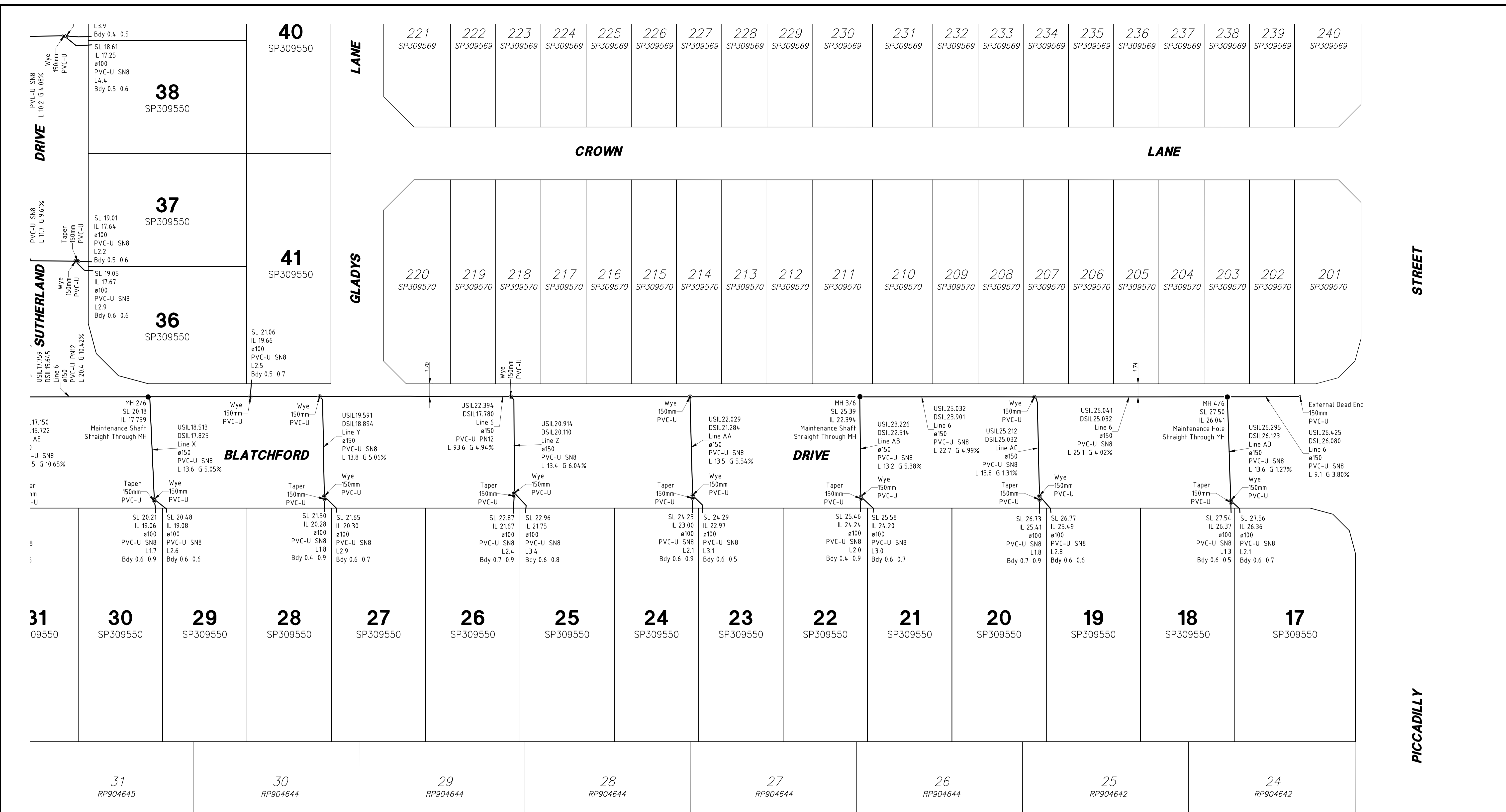

**ENGINEER'S CERTIFICATION**

I, Ryan Ashworth, being a Certified/ Registered Engineer and duly authorised representative of PEAKURBAN Pty Ltd, hereby, certify the information contained in this drawing as generally an accurate "As Constructed" representation of the works.

*RA*  
RPEQ (Signature)      19674      Date: 28/10/2020  
RPEQ No.

For and on behalf of PEAKURBAN Pty Ltd.  
In making this certificate we have relied upon information provided by others.

We RPS Australia East Pty Ltd, Registered Surveyor – Land hereby certify that the Levels and Dimensions shown hereon are a correct record of our Survey which was performed in accordance with Council Accuracy Standards

*[Signature]*  
Authorised Delegate      12/10/2020  
Date

| SEWERAGE RETICULATION |                                |
|-----------------------|--------------------------------|
| ESTATE/STAGE          | STAGE 4                        |
| SITE ADDRESS          | 84 SAMSONVALE ROAD, STRATHPINE |

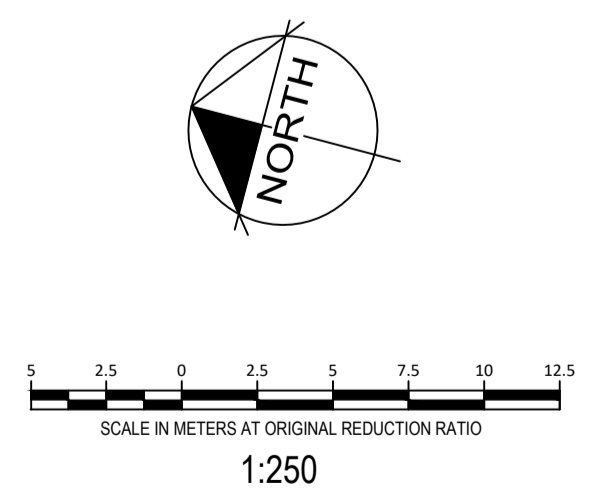

| <b>A1</b> | -    | -         | - | - | -     | -       |        |
|-----------|------|-----------|---|---|-------|---------|--------|
|           | -    | -         | - | - | -     | -       |        |
|           | -    | -         | - | - | -     | -       |        |
|           | -    | -         | - | - | -     | -       |        |
| INDEX     | DATE | REVISIONS |   |   | DRAWN | CHECKED | PASSED |
|           |      |           |   |   |       |         |        |

|          |     |            |
|----------|-----|------------|
| DRAWN    | RPS | 12/10/2020 |
| CHECKED  | RPS | 12/10/2020 |
| PASSED   | -   | -          |
| INITIALS | -   | DATE       |

**RPS**

RPS Australia Asia Pacific  
Level 4 HQ South      PO Box 1559  
520 Wickham St      Fortitude Valley  
Fortitude Valley      QLD 4006  
QLD 4006      T+61 7 3539 9500  
W rpsgroup.com



**Unitywater**

AS - CONSTRUCTED  
SEWERAGE RETICULATION

|             |               |
|-------------|---------------|
| SCALE       | 1:250 @ A1    |
| SHEET       | 2 OF 2 SHEETS |
| DRAWING NO. | 142823-19     |



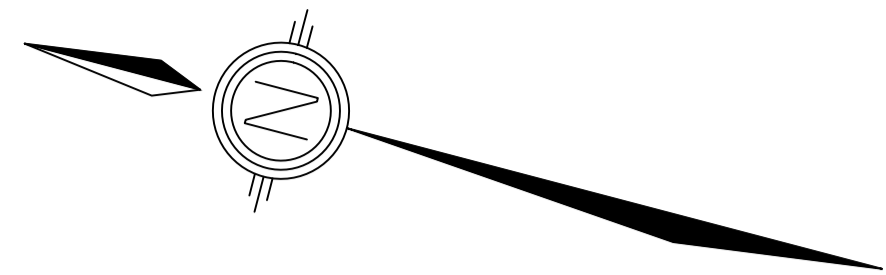

**ENGINEER'S CERTIFICATION**

I, Ryan Ashworth, being a Certified/ Registered Engineer and duly authorised representative of PEAKURBAN Pty Ltd, hereby, certify the information contained in this drawing as generally an accurate "As Constructed" representation of the works.

*RA*  
 RPEQ (Signature)      19674      Date: 28/10/2020  
 RPEQ No.

For and on behalf of PEAKURBAN Pty Ltd.  
 In making this certificate we have relied upon information provided by others.

We RPS Australia East Pty Ltd, Registered Surveyor – Land hereby certify that the Levels and Dimensions shown hereon are a correct record of our Survey which was performed in accordance with Council Accuracy Standards

*[Signature]*  
 Authorised Delegate      23/10/2020  
 Date

901  
 SP309548

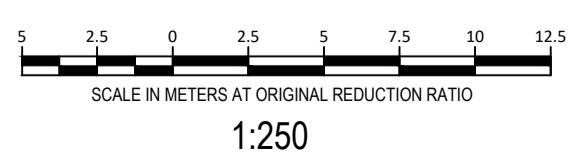
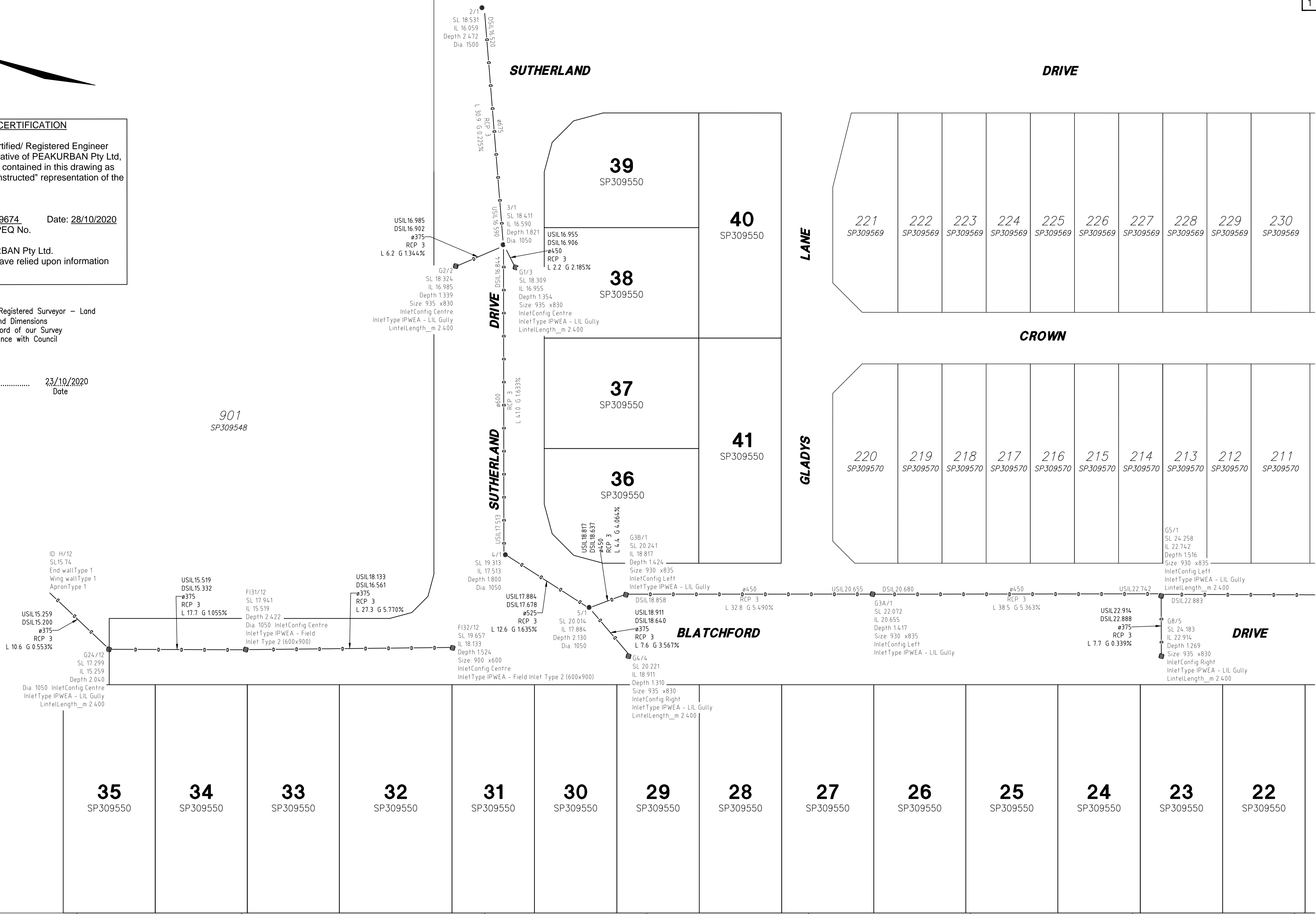

|                                   |                            |   |   |
|-----------------------------------|----------------------------|---|---|
| PROJECT<br><b>SAMSONVALE ROAD</b> |                            | CLIENT<br><b>PEET LIMITED</b>   |   |
| LEVEL DATUM<br>AHD                | SCALE<br><b>1:250 @ A1</b> | <b>AS CONSTRUCTED<br/>                 STORMWATER DRAINAGE<br/>                 STAGE 4</b> |   |
| ORIGIN<br>PM 108388<br>RL 19.893  | Date: <b>OCTOBER 2020</b>  |   |   |
| Comp. by: <b>TJE</b>              | Parish: <b>STRATHPINE</b>  |   |   |
| FB :                              | LB :                       | DWG. <b>142823 Stage4STORM</b>  | Local Authority <b>MORETON BAY REGIONAL COUNCIL</b> |
|                                   |                            | Job Ref<br><b>142823-6</b>  | Reference<br><b>142823-21</b>                       |
|                                   |                            | Rev   |   |

**RPS**  
 RPS Australia East Pty Ltd  
 ACN 140 292 762  
 ABN 44 140 292 762  
 Level 4 HQ South, 520 Wickham St  
 PO Box 1559  
 Fortitude Valley QLD 4006  
 T +61 7 3539 9500  
 F +61 7 3237 8833  
 W rpsgroup.com.au

© COPYRIGHT PROTECTS THIS PLAN  
 Unauthorised reproduction or amendment  
 not permitted. Please contact the author.



**ENGINEER'S CERTIFICATION**

I, Ryan Ashworth, being a Certified/ Registered Engineer and duly authorised representative of PEAKURBAN Pty Ltd, hereby, certify the information contained in this drawing as generally an accurate "As Constructed" representation of the works.

*RA*  
RPEQ (Signature) 19674 RPEQ No. Date: 28/10/2020

For and on behalf of PEAKURBAN Pty Ltd. In making this certificate we have relied upon information provided by others.

We RPS Australia East Pty Ltd, Registered Surveyor – Land hereby certify that the Levels and Dimensions shown hereon are a correct record of our Survey which was performed in accordance with Council Accuracy Standards

*[Signature]*  
Authorised Delegate 23/10/2020 Date

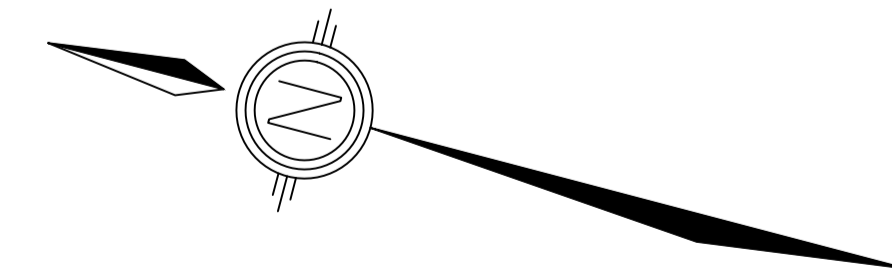

|                                   |                            |   |   |
|-----------------------------------|----------------------------|---|---|
| PROJECT<br><b>SAMSONVALE ROAD</b> |                            | CLIENT<br><b>PEET LIMITED</b>                             |   |
| LEVEL DATUM<br>AHD                | SCALE<br><b>1:250 @ A1</b> | <b>AS CONSTRUCTED<br/>STORMWATER DRAINAGE<br/>STAGE 4</b> |   |
| ORIGIN<br>PM 108388<br>RL 19.893  | Date: <b>OCTOBER 2020</b>  |   |   |
| Comp. by: <b>TJE</b>              | Parish: <b>STRATHPINE</b>  |   |   |
| FB :                              | LB :                       | DWG. <b>142823 Stage4STORM</b>                            | Local Authority <b>MORETON BAY REGIONAL COUNCIL</b> |
|                                   |                            | Job Ref<br><b>142823-6</b>                                | Reference<br><b>142823-21</b>                       |

RPS Australia East Pty Ltd  
ACN 140 292 762  
ABN 44 140 292 762  
Level 4 HQ South, 520 Wickham St  
PO Box 1559  
Fortitude Valley QLD 4006  
T +61 7 3539 9500  
F +61 7 3237 8833  
W rpsgroup.com.au

© COPYRIGHT PROTECTS THIS PLAN  
Unauthorised reproduction or amendment  
not permitted. Please contact the author.



**ENGINEER'S CERTIFICATION**

I, Ryan Ashworth, being a Certified/ Registered Engineer and duly authorised representative of PEAKURBAN Pty Ltd, hereby, certify the information contained in this drawing as generally an accurate "As Constructed" representation of the works.

*RA*  
 RPEQ (Signature) 19674 Date: 28/10/2020  
 RPEQ No.

For and on behalf of PEAKURBAN Pty Ltd.  
 In making this certificate we have relied upon information provided by others.

We RPS Australia East Pty Ltd, Registered Surveyor – Land hereby certify that the Levels and Dimensions shown hereon are a correct record of our Survey which was performed in accordance with Council Accuracy Standards

*[Signature]*  
 Authorised Delegate 12/10/2020  
 Date

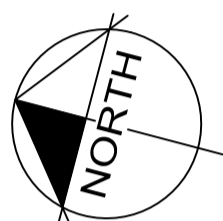

901  
 SP309548

**SUTHERLAND**

**DRIVE**

**LANE**

**CROWN**

**GLADYS**

**BLATCHFORD**

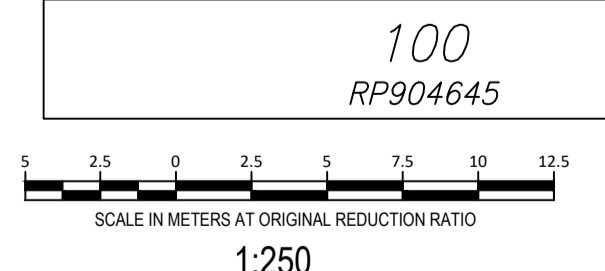
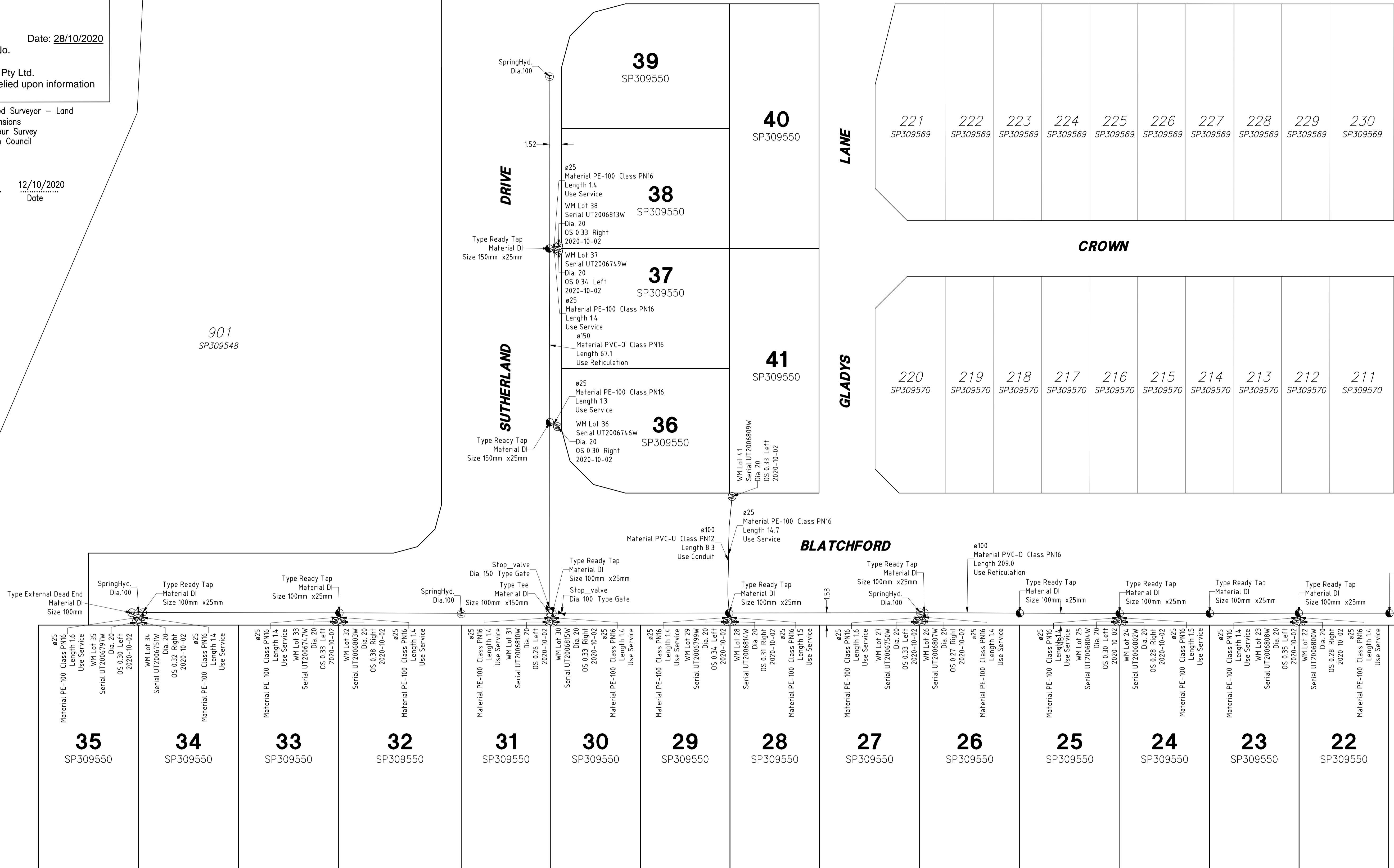

33  
 RP904645

32  
 RP904645

31  
 RP904645

30  
 RP904644

29  
 RP904644

28  
 RP904644

27  
 RP904644

**A1**

| INDEX | DATE | REVISIONS | DRAWN | CHECKED | PASSED |
|-------|------|-----------|-------|---------|--------|
| -     | -    | -         | -     | -       | -      |
| -     | -    | -         | -     | -       | -      |
| -     | -    | -         | -     | -       | -      |
| -     | -    | -         | -     | -       | -      |
| -     | -    | -         | -     | -       | -      |

| DRAWN | DATE       |
|-------|------------|
| RPS   | 12/10/2020 |
| RPS   | 12/10/2020 |
| -     | -          |
| -     | -          |

RPS Australia Asia Pacific  
 Level 4 HQ South PO Box 1559  
 520 Wickham St Fortitude Valley  
 Fortitude Valley QLD 4006  
 QLD 4006  
 T+61 7 3539 9500  
 W rpsgroup.com

Unitywater

**Unitywater**  
 AS - CONSTRUCTED  
 WATER RETICULATION

|             |               |
|-------------|---------------|
| SCALE       | 1:250 @ A1    |
| SHEET       | 1 OF 2 SHEETS |
| DRAWING NO. | 142823-20     |

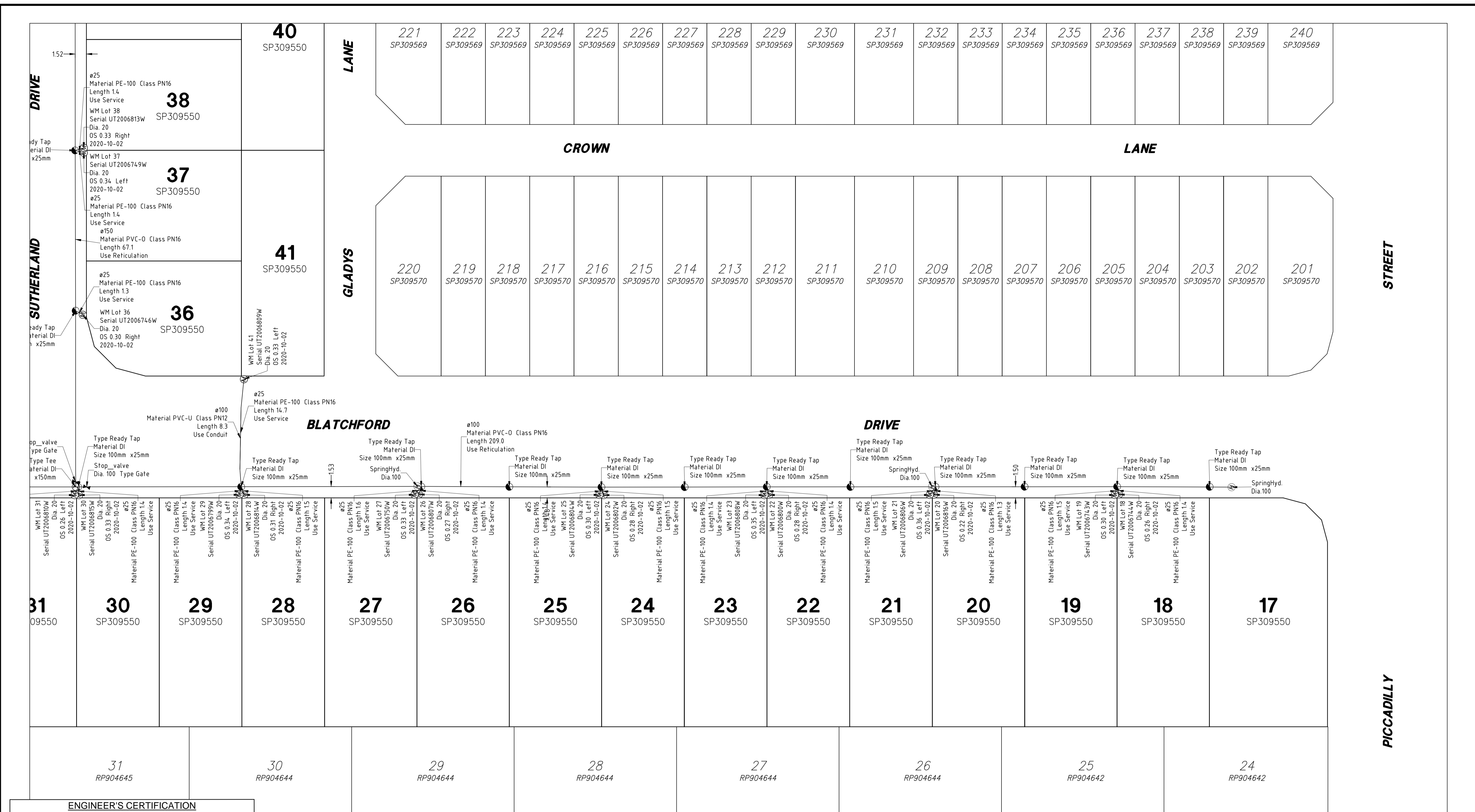

**ENGINEER'S CERTIFICATION**

I, Ryan Ashworth, being a Certified/ Registered Engineer and duly authorised representative of PEAKURBAN Pty Ltd, hereby, certify the information contained in this drawing as generally an accurate "As Constructed" representation of the works.

*RA*  
RPEQ (Signature)      19674      Date: 28/10/2020  
RPEQ No.

For and on behalf of PEAKURBAN Pty Ltd.  
In making this certificate we have relied upon information provided by others.

We RPS Australia East Pty Ltd, Registered Surveyor – Land hereby certify that the Levels and Dimensions shown hereon are a correct record of our Survey which was performed in accordance with Council Accuracy Standards

*[Signature]*  
Authorised Delegate      12/10/2020      Date

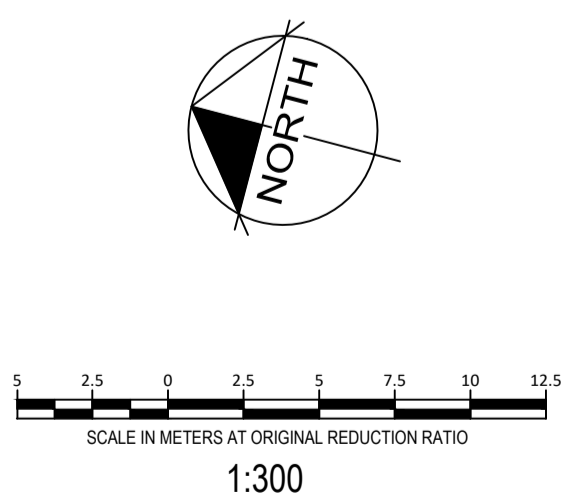

|    |       |      |           |       |         |        |
|----|-------|------|-----------|-------|---------|--------|
| A1 | INDEX | DATE | REVISIONS | DRAWN | CHECKED | PASSED |
|    | -     | -    | -         | -     | -       | -      |

|          |     |            |
|----------|-----|------------|
| DRAWN    | RPS | 12/10/2020 |
| CHECKED  | RPS | 12/10/2020 |
| PASSED   | -   | -          |
| INITIALS | -   | DATE       |

**RPS**

RPS Australia Asia Pacific  
Level 4 HQ South      PO Box 1559  
520 Wickham St      Fortitude Valley  
Fortitude Valley      QLD 4006  
QLD 4006      T+61 7 3539 9500  
Wrpigroup.com



**Unitywater**

AS - CONSTRUCTED  
WATER RETICULATION

|             |               |
|-------------|---------------|
| SCALE       | 1:250 @ A1    |
| SHEET       | 2 OF 2 SHEETS |
| DRAWING NO. | 142823-20     |