

AMENDED IN RED

23 DEC 2015

By: *[Signature]* (name)
MEDQ

PLANS AND DOCUMENTS
referred to in the PDA APPROVAL

- 5 MAR 2015

MEDQ

VEGETATION MANAGEMENT PLAN FLAGSTONE WEST STAGE I

Excluding Stages 1A-1D SUBMISSION

DRAWING SCHEDULE

Dwg No.	Drawing Title	Issue	Date
6207 E 01	Vegetation Management Plan Cover Sheet	C	19/02/2015
6207 E 02	Vegetation Management Plan Notes	C	19/02/2015
6207 E 03	Vegetation Management Plan Internal Development	C	19/02/2015
6207 E 04	Vegetation Management Plan Internal Development	C	19/02/2015
6207 E 05	Vegetation Management Plan Internal Development	C	19/02/2015
6207 E 06	Vegetation Management Plan Internal Development	C	19/02/2015
6207 E 07	Vegetation Management Plan Internal Development	C	19/02/2015
6207 E 08	Vegetation Management Plan Internal Development	C	19/02/2015
6207 E 09	Vegetation Management Plan Internal Development	C	19/02/2015
6207 E 10	Vegetation Management Plan Internal Development	C	19/02/2015
6207 E 11	Vegetation Management Plan Internal Development	C	19/02/2015
6207 E 12	Vegetation Management Plan Internal Development	C	19/02/2015
6207 E 13	Vegetation Management Plan Internal Development	C	19/02/2015
6207 E 14	Vegetation Management Plan Internal Development	C	19/02/2015
6207 E 15	Vegetation Management Plan Internal Development	C	19/02/2015
6207 E 16	Vegetation Management Plan Internal Development	C	19/02/2015
6207 E 17	Vegetation Management Plan Internal Development	C	19/02/2015
6207 E 18	Vegetation Management Plan Internal Development	C	19/02/2015
6207 E 19	Vegetation Management Plan Internal Development	C	19/02/2015
6207 E 20	Vegetation Management Plan Internal Development	C	19/02/2015
6207 E 21	Vegetation Management Plan Internal Development	C	19/02/2015
6207 E 22	Vegetation Management Plan Appendix 1 - Tree Schedules	C	19/02/2015
6207 E 23	Vegetation Management Plan Appendix 2 - NESS Compliance	C	19/02/2015
6207 E 24	Vegetation Management Plan Appendix 3 - Context Plan - Sandy Creek	C	19/02/2015
6207 E 25	Vegetation Management Plan Appendix 4 - Significant Biodiversity Values Plan	C	19/02/2015

Version C of this VMP retains edits and amendments requested by
Economic Development Queensland (EDQ)

For the plans removed above, which correspond to Stages 1A-1D, refer
Approved Vegetation Management Plan Flagstone West Stage 1A-1D,
Rev F

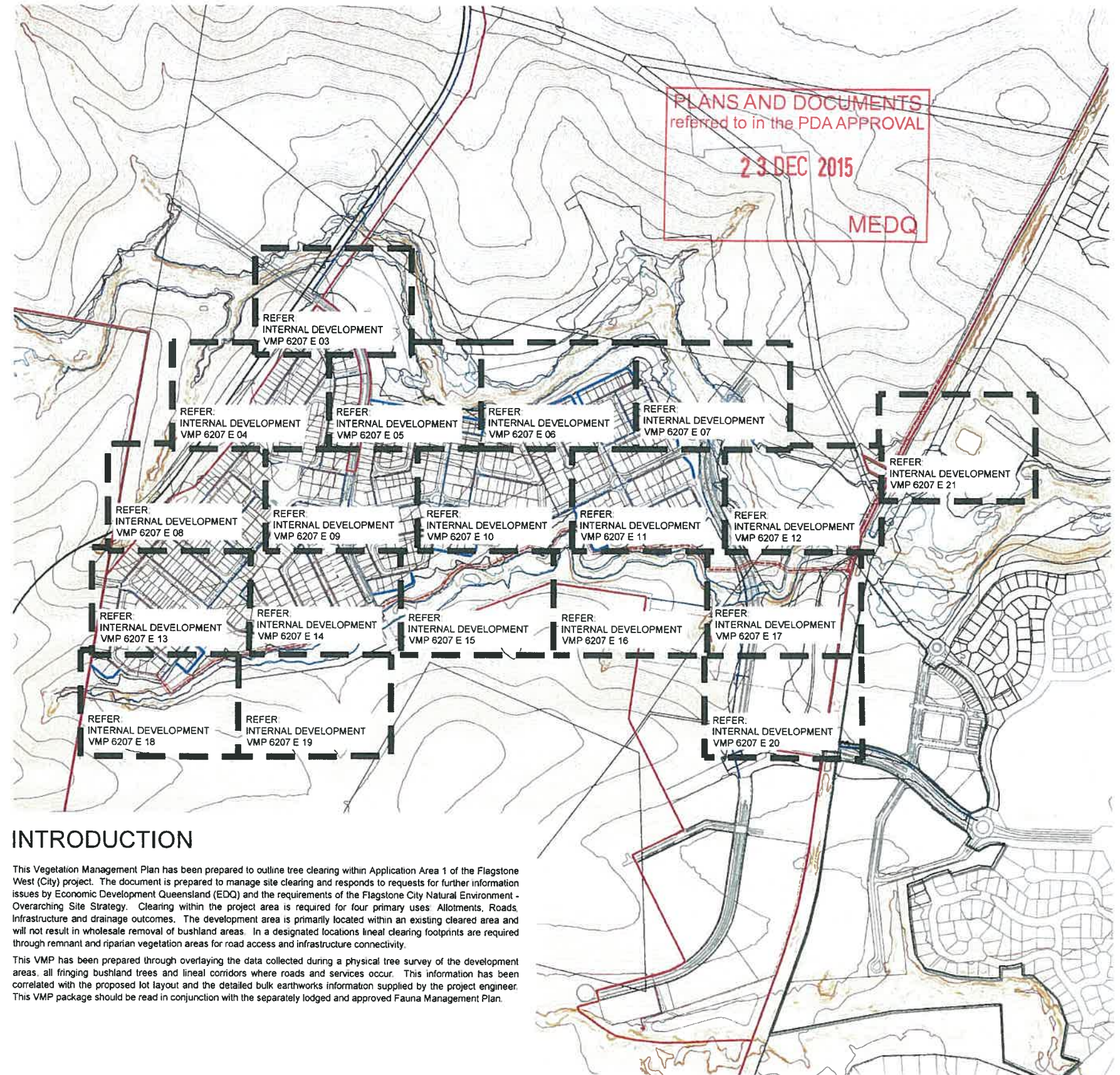

INTRODUCTION

This Vegetation Management Plan has been prepared to outline tree clearing within Application Area 1 of the Flagstone West (City) project. The document is prepared to manage site clearing and responds to requests for further information issues by Economic Development Queensland (EDQ) and the requirements of the Flagstone City Natural Environment - Overarching Site Strategy. Clearing within the project area is required for four primary uses: Allotments, Roads, Infrastructure and drainage outcomes. The development area is primarily located within an existing cleared area and will not result in wholesale removal of bushland areas. In a designated locations lineal clearing footprints are required through remnant and riparian vegetation areas for road access and infrastructure connectivity.

This VMP has been prepared through overlaying the data collected during a physical tree survey of the development areas, all fringing bushland trees and lineal corridors where roads and services occur. This information has been correlated with the proposed lot layout and the detailed bulk earthworks information supplied by the project engineer. This VMP package should be read in conjunction with the separately lodged and approved Fauna Management Plan.

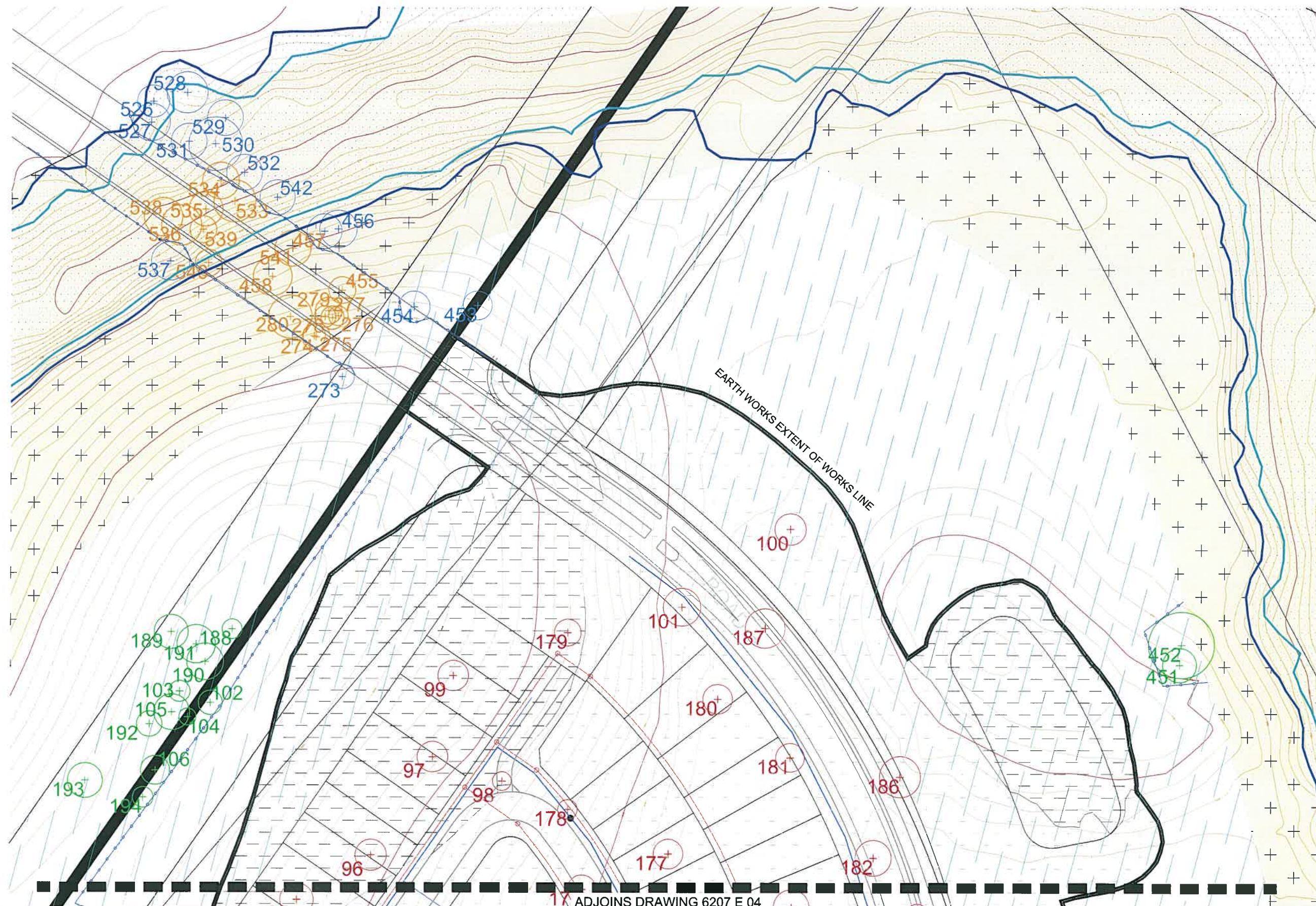

	<p>RETAINED TREES: Trees to be retained and protected within open space area. Trees located on the edge of earth works extent of works line are subject to review on site by an arborist (if required).</p> <p>EXISTING TREES TO BE REMOVED: Trees to be removed as a result of the Internal Development Area clearing.</p>
	<p>EXISTING TREES TO BE REMOVED: Trees to be removed as a result of the severance corridor clearing area.</p>
	<p>EXISTING TREES TO BE RETAINED: Trees to be retained and protected outside of severance corridor. Trees located on the edge of road works are subject to review on site by an arborist (if required).</p> <p>EXISTING TREES TO BE REMOVED: Trees to be removed as a result of the Road way clearing area.</p>
	<p>EXISTING TREES TO BE RETAINED: Trees to be retained and protected outside of roadway. Trees located on the edge of road works are subject to review on site by an arborist (if required).</p>
	<p>CIVIL ENGINEER CUT AREA: Refer Engineering drawings for detail</p>
	<p>CIVIL ENGINEER FILL AREA: Refer Engineering drawings for detail</p>
	<p>EXCLUSION FENCING: Install exclusion fence to to protect retained vegetation and rehabilitation works.</p>
	<p>INDICATIVE LOCATIONS OF STOCKPILE MATERIAL: Confirm locations on site at Pre Start meeting.</p>
	<p>INDICATIVE VEHICULAR ACCESS POINTS: Confirm best suited locations on site away from retained vegetation.</p>
	<p>EARTH WORKS EXTENT OF WORKS LINE: Refer Engineering drawings for detail</p>
	<p>MAPPED REMNANT VEGETATION</p>
	<p>FIRE BREAK (5M WIDTH): As per Bushfire Management Plan prepared by Jensen Bowers</p>
	<p>EXTENT OF CLEARING / SEPARATION REQUIRED: As per Bushfire Management Plan prepared by Jensen Bowers</p>
	<p>TRUNK SEWER: As per Engineering plans</p>

Engineers and/ or clearing contractors to prepare sediment and erosion control measures to ensure no movement of material off site and minimal movement on site.

Refer to Existing Tree Plot Schedule for detailed list of trees including number, Botanical name, girth, spread, height and determination of removal, investigation or retention.

Tree extents shown on this plan series are the Tree Protection Zones (TPZs) as specified in AS4970-2009.



DISCLAIMER:
Designs documented on this drawing are the property of Saunders Havill Group Pty Ltd and are not authorised for reproduction or use in whole or part without written permission.

These plans have been prepared for the exclusive use of the client, Saunders Havill Group do not accept responsibility for any use of or reliance upon the contents of these drawings by any third party. Confirm all dimensions on site and clarify any discrepancies prior to construction.



AMENDMENTS:			
Issue	Date	Description	Check
A	12/11/2014	CLIENT COMMENTS	MS
B	21/11/2014	SUBMISSION	MS
C	19/02/2015	EDQ RE-SUBMISSION	MS

PROJECT:
FLAGSTONE WEST STAGE 1

SCALE:
1:400@A1
1:800@A3

A horizontal graphic scale bar with tick marks at 0, 5, 10, and 20 meters. The text '0', '5', '10', and '20m' is placed above the corresponding tick marks. The bar itself is a thick black line with white tick marks.

environmental management

DRAWING:
VEGETATION MANAGEMENT PLAN
INTERNAL DEVELOPMENT AREA

DATE: February 15	CHECKED: MS
CLIENT REF.: 6207	DRAWN: TB
DRAWING No.: 6207 E 03 VMP C	

ADJOINS DRAWING 6207 E 03

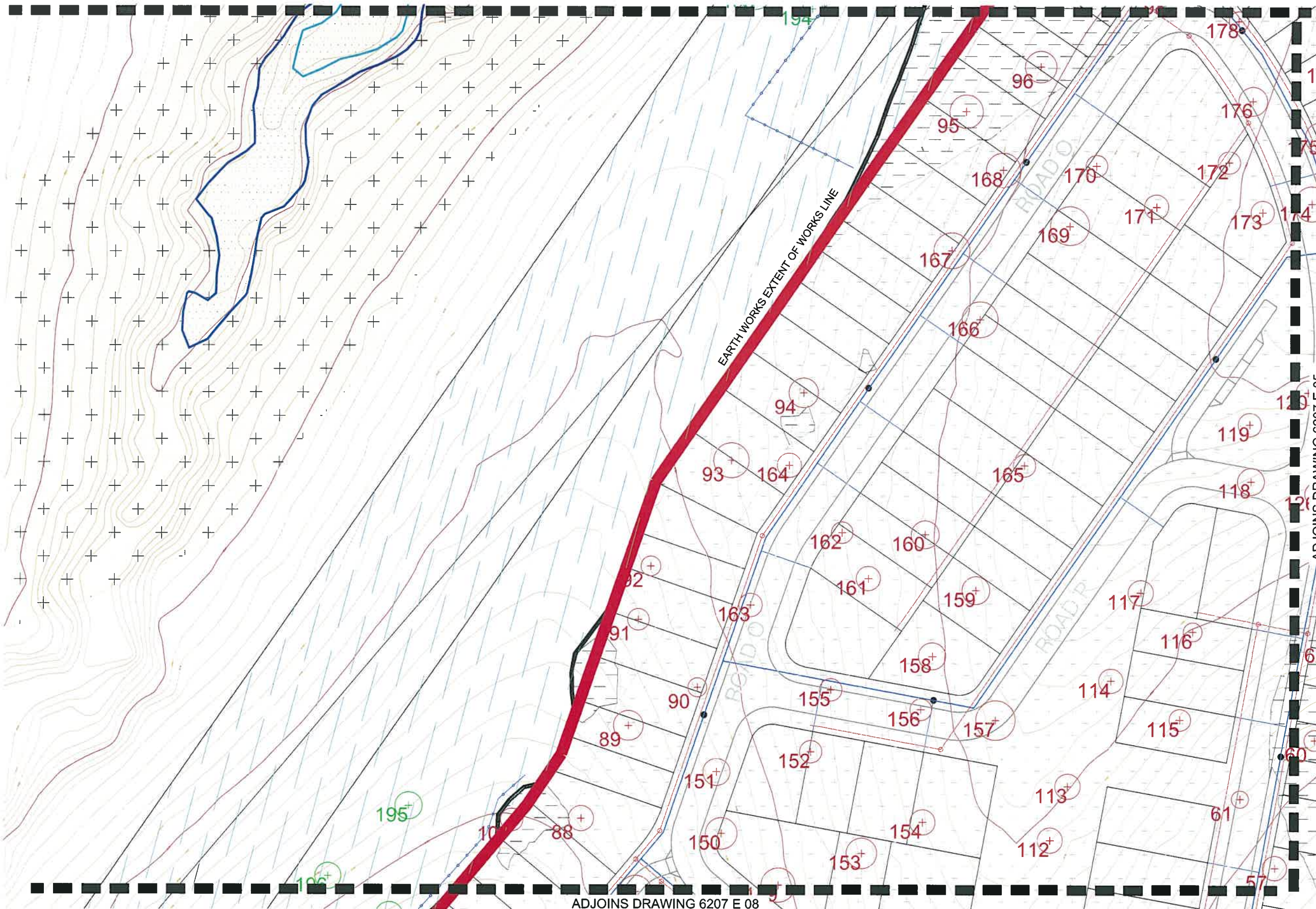

LEGEND

- RETAINED TREES:**
Trees to be retained and protected within open space area. Trees located on the edge of earth works extent of works line are subject to review on site by an arborist (if required).
- EXISTING TREES TO BE REMOVED:**
Trees to be removed as a result of the Internal Development Area clearing.
- EXISTING TREES TO BE REMOVED:**
Trees to be removed as a result of the sewerline corridor clearing area.
- EXISTING TREES TO BE RETAINED:**
Trees to be retained and protected outside of sewerline corridor. Trees located on the edge of road works are subject to review on site by an arborist (if required).
- EXISTING TREES TO BE REMOVED:**
Trees to be removed as a result of the Road way clearing area.
- EXISTING TREES TO BE RETAINED:**
Trees to be retained and protected outside of roadway. Trees located on the edge of road works are subject to review on site by an arborist (if required).
- CIVIL ENGINEER CUT AREA:**
Refer Engineering drawings for detail
- CIVIL ENGINEER FILL AREA:**
Refer Engineering drawings for detail
- EXCLUSION FENCING:**
Install exclusion fence to protect retained vegetation and rehabilitation works.
- INDICATIVE LOCATIONS OF STOCKPILE MATERIAL:**
Confirm locations on site at Pre Start meeting.
- INDICATIVE VEHICULAR ACCESS POINTS:**
Confirm best suited locations on site away from retained vegetation.
- EARTH WORKS EXTENT OF WORKS LINE:**
Refer Engineering drawings for detail
- MAPPED REMNANT VEGETATION**
- FIRE BREAK (5M WIDTH):**
As per Bushfire Management Plan prepared by Jensen Bowers
- EXTENT OF CLEARING / SEPARATION REQUIRED:**
As per Bushfire Management Plan prepared by Jensen Bowers
- TRUNK SEWER:**
As per Engineering plans

NOTES:

Engineers and/ or clearing contractors to prepare sediment and erosion control measures to ensure no movement of material off site and minimal movement on site.

REFER 6207 E 22 FOR TREE SCHEDULES

Refer to Existing Tree Plot Schedule for detailed list of trees including number, Botanical name, girth, spread, height and determination of removal, investigation or retention.

Tree extents shown on this plan series are the Tree Protection Zones (TPZs) as specified in AS4970-2009.

KEY PLAN

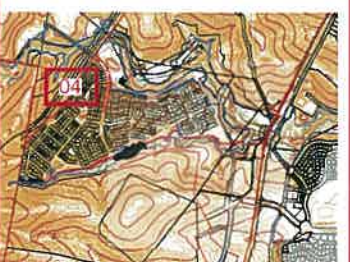

saunders havill group
 Saunders Havill Group Pty Ltd ABN 24 144 972 949
 Brisbane • Emerald • Gladstone
 head office 9 Thompson St Bowen Hills Q 4006
 phone 1300 123 SHG web www.saundershavill.com

surveying • town planning • urban design • environmental management • landscape architecture

DISCLAIMER:
 Designs documented on this drawing are the property of Saunders Havill Group Pty Ltd and are not authorised for reproduction or use in whole or part without written permission.

These plans have been prepared for the exclusive use of the client, Saunders Havill Group. We do not accept responsibility for any use of or reliance upon the contents of these drawings by any third party. Confirm all assumptions on site and clarify any discrepancies prior to construction.

APPROVED COMPANY
 ISO 9001 Quality Management System
 QMS

APPROVED COMPANY
 ISO 14001 Environmental Management System
 QMS

AMENDMENTS:			
Issue	Date	Description	Checked
A	12/11/2014	CLIENT COMMENTS	MS
B	21/11/2014	SUBMISSION	MS
C	19/02/2015	EDQ RE-SUBMISSION	MS

CLIENT:
PEET FLAGSTONE CITY PTY LTD

PROJECT:
FLAGSTONE WEST STAGE 1

SCALE:
1:400@A1
1:800@A3

environmental management

DRAWING:
VEGETATION MANAGEMENT PLAN
INTERNAL DEVELOPMENT AREA

DATE: February 15
CLIENT REF.: 6207
DRAWING No.: 6207 E 04 VMP C

CHECKED: MS
DRAWN: TB

ADJOINS DRAWING 6207 E 03

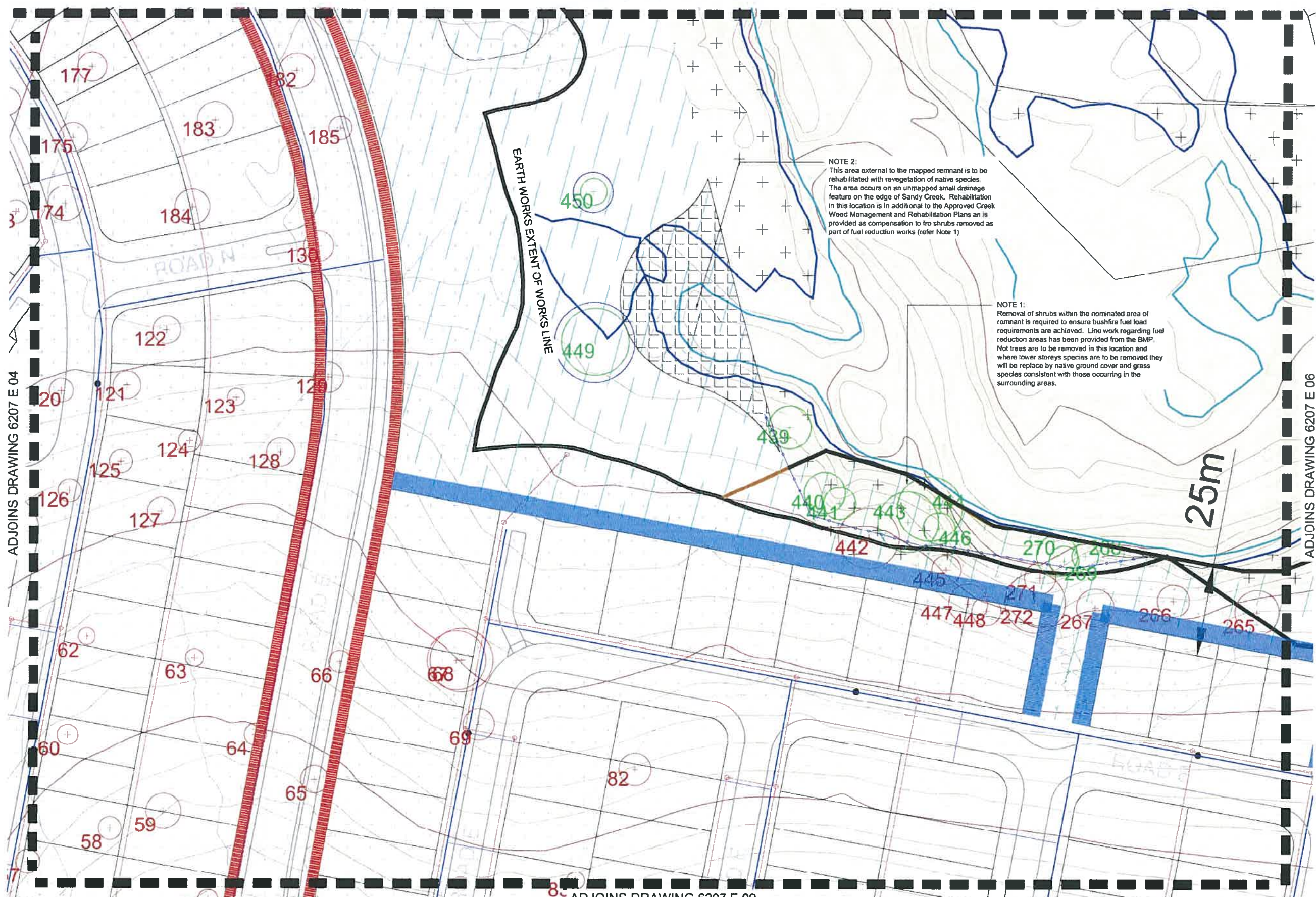

NOTE 2:
This area external to the mapped remnant is to be rehabilitated with revegetation of native species. The area occurs on an unmapped small drainage feature on the edge of Sandy Creek. Rehabilitation in this location is in addition to the Approved Creek Weed Management and Rehabilitation Plans and is provided as compensation to for shrubs removed as part of fuel reduction works (refer Note 1)

NOTE 1:
Removal of shrubs within the nominated area of remnant is required to ensure bushfire fuel load requirements are achieved. Line work regarding fuel reduction areas has been provided from the BMP. Not trees are to be removed in this location and where lower storeys species are to be removed they will be replaced by native ground cover and grass species consistent with those occurring in the surrounding areas.

- LEGEND**
- RETAINED TREES:
Trees to be retained and protected within open space area. Trees located on the edge of earth works extent of works line are subject to review on site by an arborist (if required).
 - EXISTING TREES TO BE REMOVED:
Trees to be removed as a result of the sewerline corridor clearing area.
 - EXISTING TREES TO BE REMOVED:
Trees to be removed as a result of the sewerline corridor clearing area.
 - EXISTING TREES TO BE RETAINED:
Trees to be retained and protected outside of sewerline corridor. Trees located on the edge of road works are subject to review on site by an arborist (if required).
 - EXISTING TREES TO BE REMOVED:
Trees to be removed as a result of the road way clearing area.
 - EXISTING TREES TO BE RETAINED:
Trees to be retained and protected outside of roadway. Trees located on the edge of road works are subject to review on site by an arborist (if required).
 - CIVIL ENGINEER CUT AREA
Refer Engineering drawings for detail
 - CIVIL ENGINEER FILL AREA
Refer Engineering drawings for detail
 - EXCLUSION FENCING:
Install exclusion fence to protect retained vegetation and rehabilitation works.
 - INDICATIVE LOCATIONS OF STOCKPILE MATERIAL
Confirm locations on site at Pre Start meeting
 - INDICATIVE VEHICULAR ACCESS POINTS:
Confirm best suited locations on site away from retained vegetation
 - EARTH WORKS EXTENT OF WORKS LINE
Refer Engineering drawings for detail
 - MAPPED REMNANT VEGETATION
 - FIRE BREAK (5M WIDTH)
As per Bushfire Management Plan prepared by Jensen Bowlers
 - EXTENT OF CLEARING / SEPARATION REQUIRED
As per Bushfire Management Plan prepared by Jensen Bowlers
 - TRUNK SEWER
As per Engineering plans

NOTES:

Engineers and/ or clearing contractors to prepare sediment and erosion control measures to ensure no movement of material off site and minimal movement on site

REFER 6207 E 22 FOR TREE SCHEDULES

Refer to Existing Tree Plot Schedule for detailed list of trees including number, Botanical name, girth, spread, height and determination of removal, investigation or retention.

Tree extents shown on this plan series are the Tree Protection Zones (TPZs) as specified in AS4970-2009.

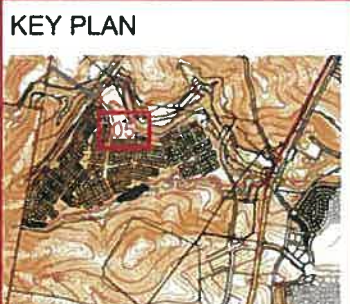

saunders havill group
Saunders Havill Group Pty Ltd
Brisbane • Emerald • Gladstone
9 Thompson St Bowen Hills Q 4006
1300 123 SHG
www.saundershavill.com

■ surveying ■ town planning ■ urban design ■ environmental management ■ landscape architecture

DISCLAIMER:
Designs and drawings are the property of Saunders Havill Group Pty Ltd and are not to be used for any other purpose without the written consent of the company.

APPROVED COMPANY
ISO 9001
QMS

APPROVED COMPANY
ISO 14001
QMS

Issue	Date	Client/Project	Checklist
A	12/11/2014	CLIENT COMMENTS	MS
B	21/11/2014	SUBMISSION	MS
C	19/02/2015	EDD RE-SUBMISSION	MS

CLIENT:
PEET FLAGSTONE CITY PTY LTD

PROJECT:
FLAGSTONE WEST STAGE 1

SCALE:
1:400@A1
1:800@A3

environmental management

DRAWING:
VEGETATION MANAGEMENT PLAN
INTERNAL DEVELOPMENT AREA

DATE: February 15
CHECKED: MS

CLIENT REF: 6207
DATE: 15/02/2015

DRAWING No.: 6207 E 05 VMP C

J:\6207 Flagstone City, Jimboomba (Peel Limited)\Working Files\AutoCAD\IE - Vegetation (Assessment, Management and Rehabilitation) Plans\6207 E 01 Vegetation Management Plan.dwg

ADJOINS DRAWING 6207 E 03

EARTH WORKS EXTENT OF WORKS LINE

ADJOINS DRAWING 6207 E 14

LEGEND

- RETAINED TREES:**
Trees to be retained and protected within open space area. Trees located on the edge of earth works extent of works line are subject to review on site by an arborist (if required).
- EXISTING TREES TO BE REMOVED:**
Trees to be removed as a result of the Internal Development Area clearing.
- EXISTING TREES TO BE REMOVED:**
Trees to be removed as a result of the sewerline corridor clearing area.
- EXISTING TREES TO BE RETAINED:**
Trees to be retained and protected outside of sewerline corridor. Trees located on the edge of road works are subject to review on site by an arborist (if required).
- EXISTING TREES TO BE REMOVED:**
Trees to be removed as a result of the Road way clearing area.
- EXISTING TREES TO BE RETAINED:**
Trees to be retained and protected outside of roadway. Trees located on the edge of road works are subject to review on site by an arborist (if required).
- CIVIL ENGINEER CUT AREA:**
Refer Engineering drawings for detail
- CIVIL ENGINEER FILL AREA:**
Refer Engineering drawings for detail
- EXCLUSION FENCING:**
Install exclusion fence to protect retained vegetation and rehabilitation works.
- INDICATIVE LOCATIONS OF STOCKPILE MATERIAL:**
Confirm locations on site at Pre Start meeting.
- INDICATIVE VEHICULAR ACCESS POINTS:**
Confirm best suited locations on site away from retained vegetation.
- EARTH WORKS EXTENT OF WORKS LINE:**
Refer Engineering drawings for detail
- MAPPED REMNANT VEGETATION**
- FIRE BREAK (5M WIDTH):**
As per Bushfire Management Plan prepared by Jensen Bowers
- EXTENT OF CLEARING / SEPARATION REQUIRED:**
As per Bushfire Management Plan prepared by Jensen Bowers
- TRUNK SEWER:**
As per Engineering plans

NOTES:

Engineers and/ or clearing contractors to prepare sediment and erosion control measures to ensure no movement of material off site and minimal movement on site.

REFER 6207 E 22 FOR TREE SCHEDULES

Refer to Existing Tree Plot Schedule for detailed list of trees including number, Botanical name, girth, spread, height and determination of removal, investigation or retention.

Tree extents shown on this plan series are the Tree Protection Zones (TPZs) as specified in AS4970-2009.

KEY PLAN



Saunders Havill Group Pty Ltd ABN 24 144 972 949
Brisbane • Emerald • Gladstone
head office 9 Thompson St Bowen Hills Q 4006
phone 1300 123 SHG web www.saundershavill.com

■ surveying ■ town planning ■ urban design ■ environmental management ■ landscape architecture

DISCLAIMER:

Designs documented on this drawing are the property of Saunders Havill Group Pty Ltd and are not authorised for reproduction or use in whole or part without written permission.
These plans have been prepared for the exclusive use of the client, Saunders Havill Group and do not accept responsibility for any use of or reliance upon the contents of these drawings by any third party. Confirm all dimensions on site and clarify any discrepancies prior to construction.



AMENDMENTS:

Issue	Date	Description	Checked
A	12/11/2014	CLIENT COMMENTS	MS
B	21/11/2014	SUBMISSION	MS
C	19/02/2015	EDQ RE-SUBMISSION	MS

CLIENT:

PEET FLAGSTONE CITY PTY LTD

PROJECT:

FLAGSTONE WEST STAGE 1

SCALE:

1:400@A1
1:800@A3

0 5 10 20m

environmental management

DRAWING:
VEGETATION MANAGEMENT PLAN
INTERNAL DEVELOPMENT AREA

DATE: February 15

CHECKED: MS

CLIENT REF.: 6207

DRAWN: TB

DRAWING No.: 6207 E 08 VMP C

J:\6207 Flagstone City, Jimboomba (Peet Limited)\Working Files\AutoCAD\IE - Vegetation (Assessment, Management and Rehabilitation) Plans\6207 E 01 Vegetation Management Plan.dwg

ADJOINS DRAWING 6207 E 08

ADJOINS DRAWING 6207 E 18

LEGEND

- RETAINED TREES:**
Trees to be retained and protected within open space area. Trees located on the edge of earth works extent of works line are subject to review on site by an arborist (if required).
- EXISTING TREES TO BE REMOVED:**
Trees to be removed as a result of the Internal Development Area clearing.
- EXISTING TREES TO BE REMOVED:**
Trees to be removed as a result of the sewerline corridor clearing area.
- EXISTING TREES TO BE RETAINED:**
Trees to be retained and protected outside of sewerline corridor. Trees located on the edge of road works are subject to review on site by an arborist (if required).
- EXISTING TREES TO BE RETAINED:**
Trees to be retained and protected outside of roadway. Trees located on the edge of road works are subject to review on site by an arborist (if required).
- CIVIL ENGINEER CUT AREA:**
Refer Engineering drawings for detail
- CIVIL ENGINEER FILL AREA:**
Refer Engineering drawings for detail
- EXCLUSION FENCING:**
Install exclusion fence to protect retained vegetation and rehabilitation works.
- INDICATIVE LOCATIONS OF STOCKPILE MATERIAL:**
Confirm locations on site at Pre Start meeting.
- INDICATIVE VEHICULAR ACCESS POINTS:**
Confirm best suited locations on site away from retained vegetation.
- EARTH WORKS EXTENT OF WORKS LINE:**
Refer Engineering drawings for detail
- MAPPED REMNANT VEGETATION**
- FIRE BREAK (5M WIDTH):**
As per Bushfire Management Plan prepared by Jensen Bowers
- EXTENT OF CLEARING / SEPARATION REQUIRED:**
As per Bushfire Management Plan prepared by Jensen Bowers
- TRUNK SEWER:**
As per Engineering plans

NOTES:

Engineers and/ or clearing contractors to prepare sediment and erosion control measures to ensure no movement of material off site and minimal movement on site.

REFER 6207 E 22 FOR TREE SCHEDULES

Refer to Existing Tree Plot Schedule for detailed list of trees including number, Botanical name, girth, spread, height and determination of removal, investigation or retention.

Tree extents shown on this plan series are the Tree Protection Zones (TPZs) as specified in AS4970-2009.

KEY PLAN



AMENDMENTS:			
Issue	Date	Description	Checked
A	12/11/2014	CLIENT COMMENTS	MS
B	21/11/2014	SUBMISSION	MS
C	19/02/2015	EDQ RE-SUBMISSION	MS

CLIENT: PEET FLAGSTONE CITY PTY LTD	
PROJECT: FLAGSTONE WEST STAGE 1	
SCALE: 1:400@A1 1:800@A3	0 5 10 20m

environmental management	
DRAWING: VEGETATION MANAGEMENT PLAN INTERNAL DEVELOPMENT AREA	
DATE: February 15	CHECKED: MS
CLIENT REF.: 6207	DRAWN: TB
DRAWING No.: 6207 E 13 VMP C	

J:\6207 Flagstone City, Jimboomba (Peel Limited)\Working Files\AutoCAD\IE - Vegetation (Assessment, Management and Rehabilitation) Plans\6207 E 01 Vegetation Management Plan.dwg

ADJOINS DRAWING 6207 E 09

ADJOINS DRAWING 6207 E 19

LEGEND

- RETAINED TREES:**
Trees to be retained and protected within open space area. Trees located on the edge of earth works extent of works line are subject to review on site by an arborist (if required).
- EXISTING TREES TO BE REMOVED:**
Trees to be removed as a result of the Internal Development Area clearing.
- EXISTING TREES TO BE RETAINED:**
Trees to be retained and protected outside of sewerline corridor. Trees located on the edge of road works are subject to review on site by an arborist (if required).
- EXISTING TREES TO BE RETAINED:**
Trees to be retained and protected outside of roadway. Trees located on the edge of road works are subject to review on site by an arborist (if required).
- CIVIL ENGINEER CUT AREA:**
Refer Engineering drawings for detail
- CIVIL ENGINEER FILL AREA:**
Refer Engineering drawings for detail
- EXCLUSION FENCING:**
Install exclusion fence to protect retained vegetation and rehabilitation works.
- INDICATIVE LOCATIONS OF STOCKPILE MATERIAL:**
Confirm locations on site at Pre-Start meeting.
- INDICATIVE VEHICULAR ACCESS POINTS:**
Confirm best suited locations on site away from retained vegetation.
- EARTH WORKS EXTENT OF WORKS LINE:**
Refer Engineering drawings for detail
- MAPPED REMNANT VEGETATION**
- FIRE BREAK (5M WIDTH):**
As per Bushfire Management Plan prepared by Jensen Bowers
- EXTENT OF CLEARING / SEPARATION REQUIRED:**
As per Bushfire Management Plan prepared by Jensen Bowers
- TRUNK SEWER:**
As per Engineering plans

NOTES:

Engineers and/ or clearing contractors to prepare sediment and erosion control measures to ensure no movement of material off site and minimal movement on site.

REFER 6207 E 22 FOR TREE SCHEDULES

Refer to Existing Tree Plot Schedule for detailed list of trees including number, Botanical name, girth, spread, height and determination of removal, investigation or retention.

Tree extents shown on this plan series are the Tree Protection Zones (TPZs) as specified in AS4970-2009.

KEY PLAN



saunders havill group
Saunders Havill Group Pty Ltd ABN 24 144 972 949
Brisbane • Emerald • Gladstone
head office 9 Thompson St Bowen Hills Q 4006
phone 1300 123 SHG web www.saundershavill.com

• surveying • town planning • urban design • environmental management • landscape architecture

DISCLAIMER:
Designs documented on this drawing are the property of Saunders Havill Group Pty Ltd and are not to be used for reproduction or use in whole or part without written permission.
These plans have been prepared for the exclusive use of the client. Saunders Havill Group does not accept responsibility for any use of or reliance upon the contents of these drawings by any third party. Confirm all dimensions on site and clarify any discrepancies prior to construction.



AMENDMENTS:			
Issue	Date	Description	Checked
A	12/11/2014	CLIENT COMMENTS	MS
B	21/11/2014	SUBMISSION	MS
C	19/02/2015	EDQ RE-SUBMISSION	MS

CLIENT:
PEET FLAGSTONE CITY PTY LTD

PROJECT:
FLAGSTONE WEST STAGE 1

SCALE:
1:400@A1
1:800@A3

environmental management

DRAWING:
VEGETATION MANAGEMENT PLAN
INTERNAL DEVELOPMENT AREA

DATE: February 15
CLIENT REF.: 6207
DRAWING No.: 6207 E 14 VMP C

CHECKED: MS
DRAWN: TB

















J:\6207 Flagstone City, Jimboomba (Peel Limited)\Working Files\AutoCAD\ - Vegetation (Assessment, Management and Rehabilitation) Plans\6207 E 01 Vegetation Management Plan.dwg

ADJOINS DRAWING 6207 E 10

EARTH WORKS EXTENT OF WORKS LINE

Possible future selective clearing
required for open space purposes.
refer final Landscape Architecture
drawings for details

LEGEND

-  **RETAINED TREES:**
Trees to be retained and protected within open space areas. Trees located on the edge of earth works extent of works line are subject to review on site by an arborist (if required).
-  **EXISTING TREES TO BE REMOVED:**
Trees to be removed as a result of the Internal Development Area clearing.
-  **EXISTING TREES TO BE REMOVED:**
Trees to be removed as a result of the sewerline corridor clearing area.
-  **EXISTING TREES TO BE RETAINED:**
Trees to be retained and protected outside of sewerline corridor. Trees located on the edge of road works are subject to review on site by an arborist (if required).
-  **EXISTING TREES TO BE REMOVED:**
Trees to be removed as a result of the Road way clearing area.
-  **EXISTING TREES TO BE RETAINED:**
Trees to be retained and protected outside of roadway. Trees located on the edge of road works are subject to review on site by an arborist (if required).
-  **CIVIL ENGINEER CUT AREA:**
Refer Engineering drawings for detail
-  **CIVIL ENGINEER FILL AREA:**
Refer Engineering drawings for detail
-  **EXCLUSION FENCING:**
Install exclusion fence to protect retained vegetation and rehabilitation works.
-  **INDICATIVE LOCATIONS OF STOCKPILE MATERIAL:**
Confirm locations on site at Pre Start meeting.
-  **INDICATIVE VEHICULAR ACCESS POINTS:**
Confirm best suited locations on site away from retained vegetation.
-  **EARTH WORKS EXTENT OF WORKS LINE:**
Refer Engineering drawings for detail
-  **MAPPED REMNANT VEGETATION**
-  **FIRE BREAK (5M WIDTH):**
As per Bushfire Management Plan prepared by Jensen Bowers
-  **EXTENT OF CLEARING / SEPARATION REQUIRED:**
As per Bushfire Management Plan prepared by Jensen Bowers
-  **TRUNK SEWER:**
As per Engineering plans

NOTES:

Engineers and/ or clearing contractors to prepare sediment and erosion control measures to ensure no movement of material off site and minimal movement on site.

REFER 6207 E 22 FOR TREE SCHEDULES

Refer to Existing Tree Plot Schedule for detailed list of trees including number, Botanical name, girth, spread, height and determination of removal, investigation or retention.

Tree extents shown on this plan series are the Tree Protection Zones (TPZs) as specified in AS4970-2009.

KEY PLAN



saunders havill group
Saunders Havill Group Pty Ltd ABN 24 144 972 949
Brisbane • Emerald • Gladstone
head office 9 Thompson St Bowen Hills Q 4006
phone 1300 123 SHG web www.saundershavill.com

■ surveying ■ town planning ■ urban design ■ environmental management ■ landscape architecture

DISCLAIMER:
Designs documented on this drawing are the property of Saunders Havill Group Pty Ltd and are not authorised for reproduction or use in whole or part without written permission.
These plans have been prepared for the exclusive use of the client, Saunders Havill Group do not accept responsibility for any use of or reliance upon the contents of these drawings by any third party. Confirm all dimensions on site and clarify any discrepancies prior to construction.



AMENDMENTS:			
Issue	Date	Description	Checked
A	12/11/2014	CLIENT COMMENTS	MS
B	21/11/2014	SUBMISSION	MS
C	19/02/2015	EDQ RE-SUBMISSION	MS

CLIENT:
PEET FLAGSTONE CITY PTY LTD

PROJECT:
FLAGSTONE WEST STAGE 1

SCALE:
1:400@A1
1:800@A3

environmental management

DRAWING:
**VEGETATION MANAGEMENT PLAN
INTERNAL DEVELOPMENT AREA**

DATE: February 15

CHECKED: MS

CLIENT REF.: 6207

DRAWN: TB

DRAWING No.: 6207 E 15 VMP C

J:\6207 Flagstone City, Jimboomba (Peel Limited)\Working Files\AutoCAD\VE - Vegetation (Assessment, Management and Rehabilitation) Plans\6207 E 01 Vegetation Management Plan.dwg

ADJOINS DRAWING 6207 E 13

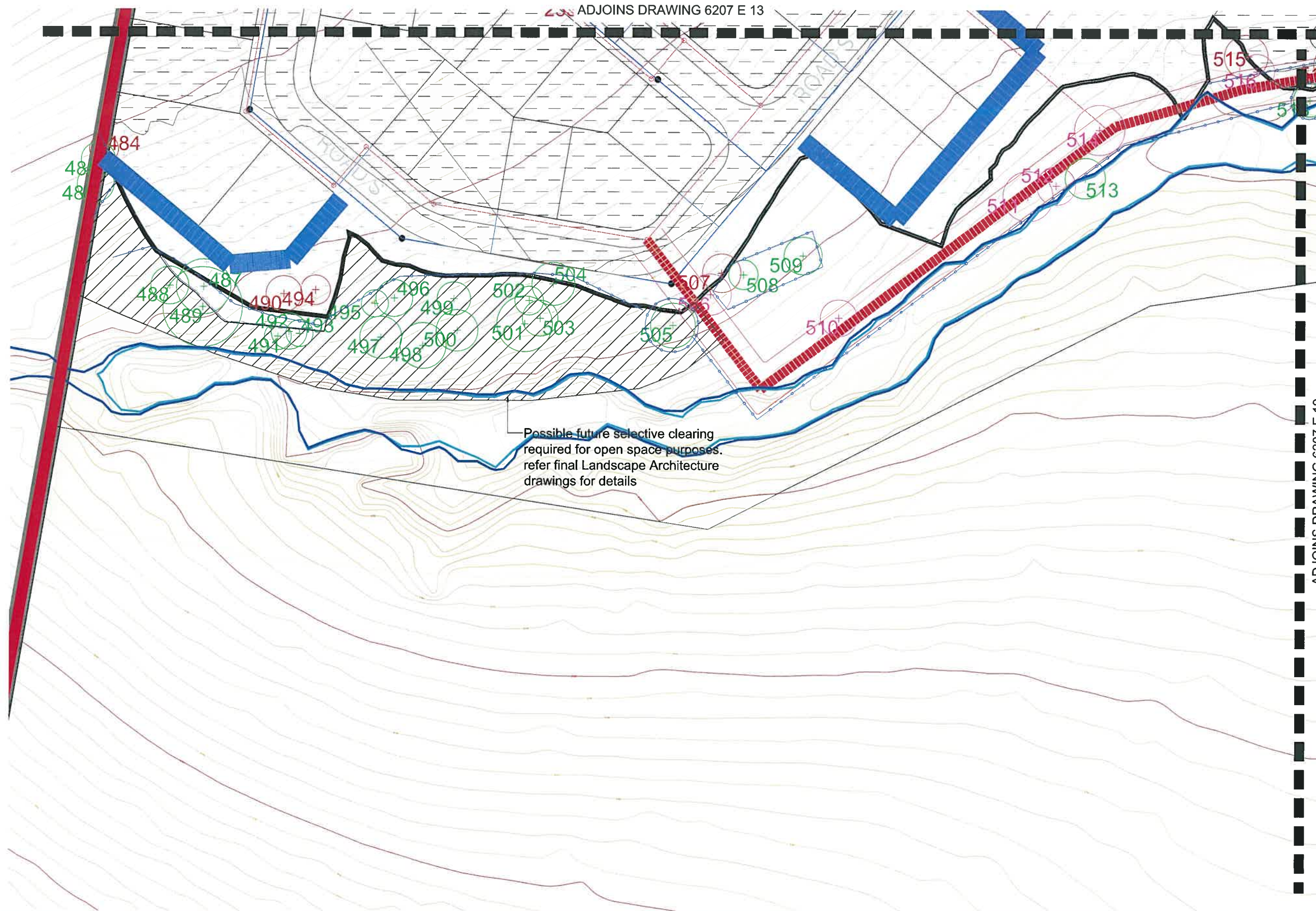

LEGEND

- RETAINED TREES:**
Trees to be retained and protected within open space area. Trees located on the edge of earth works extent of works line are subject to review on site by an arborist (if required).
- EXISTING TREES TO BE REMOVED:**
Trees to be removed as a result of the Internal Development Area clearing.
- EXISTING TREES TO BE REMOVED:**
Trees to be removed as a result of the sewerline corridor clearing area.
- EXISTING TREES TO BE RETAINED:**
Trees to be retained and protected outside of sewerline corridor. Trees located on the edge of road works are subject to review on site by an arborist (if required).
- EXISTING TREES TO BE REMOVED:**
Trees to be removed as a result of the Road way clearing area.
- EXISTING TREES TO BE RETAINED:**
Trees to be retained and protected outside of roadway. Trees located on the edge of road works are subject to review on site by an arborist (if required).
- CIVIL ENGINEER CUT AREA:**
Refer Engineering drawings for detail
- CIVIL ENGINEER FILL AREA:**
Refer Engineering drawings for detail
- EXCLUSION FENCING:**
Install exclusion fence to protect retained vegetation and rehabilitation works.
- INDICATIVE LOCATIONS OF STOCKPILE MATERIAL:**
Confirm locations on site at Pre Start meeting.
- INDICATIVE VEHICULAR ACCESS POINTS:** Confirm best suited locations on site away from retained vegetation.
- EARTH WORKS EXTENT OF WORKS LINE:**
Refer Engineering drawings for detail
- MAPPED REMNANT VEGETATION**
- FIRE BREAK (5M WIDTH):**
As per Bushfire Management Plan prepared by Jensen Bowers
- EXTENT OF CLEARING / SEPARATION REQUIRED:**
As per Bushfire Management Plan prepared by Jensen Bowers
- TRUNK SEWER:**
As per Engineering plans

NOTES:

Engineers and/ or clearing contractors to prepare sediment and erosion control measures to ensure no movement of material off site and minimal movement on site.

REFER 6207 E 22 FOR TREE SCHEDULES

Refer to Existing Tree Plot Schedule for detailed list of trees including number, Botanical name, girth, spread, height and determination of removal, investigation or retention.

Tree extents shown on this plan series are the Tree Protection Zones (TPZs) as specified in AS4970-2009.

KEY PLAN



saunders havill group
Saunders Havill Group Pty Ltd ABN 24 144 972 949
Brisbane • Emerald • Gladstone
head office 9 Thompson St Bowen Hills Q 4006
phone 1800 123 SHG web www.saundershavill.com

surveying • town planning • urban design • environmental management • landscape architecture

DISCLAIMER:
Designs documented on this drawing are the property of Saunders Havill Group Pty Ltd and are not authorised for reproduction or use in whole or part without written permission.
These plans have been prepared for the exclusive use of the client, Saunders Havill Group do not accept responsibility for any use of or reliance upon the contents of these drawings by any third party. Confirm all dimensions on site and clarify any discrepancies prior to construction.



AMENDMENTS:			
Issue	Date	Description	Checked
A	12/11/2014	CLIENT COMMENTS	MS
B	21/11/2014	SUBMISSION	MS
C	19/02/2015	EDQ RE-SUBMISSION	MS

CLIENT:
PEET FLAGSTONE CITY PTY LTD

PROJECT:
FLAGSTONE WEST STAGE 1

SCALE:
1:400@A1
1:800@A3

environmental management

DRAWING:
**VEGETATION MANAGEMENT PLAN
INTERNAL DEVELOPMENT AREA**

DATE: February 15
CLIENT REF.: 6207
DRAWING No.: 6207 E 18 VMP C

CHECKED: MS
DRAWN: TB

J:\6207 Flagstone City, Jimboomba (Peet Limited)\Working Files\AutoCAD\IE - Vegetation (Assessment, Management and Rehabilitation) Plans\6207 E 01 Vegetation Management Plan.dwg

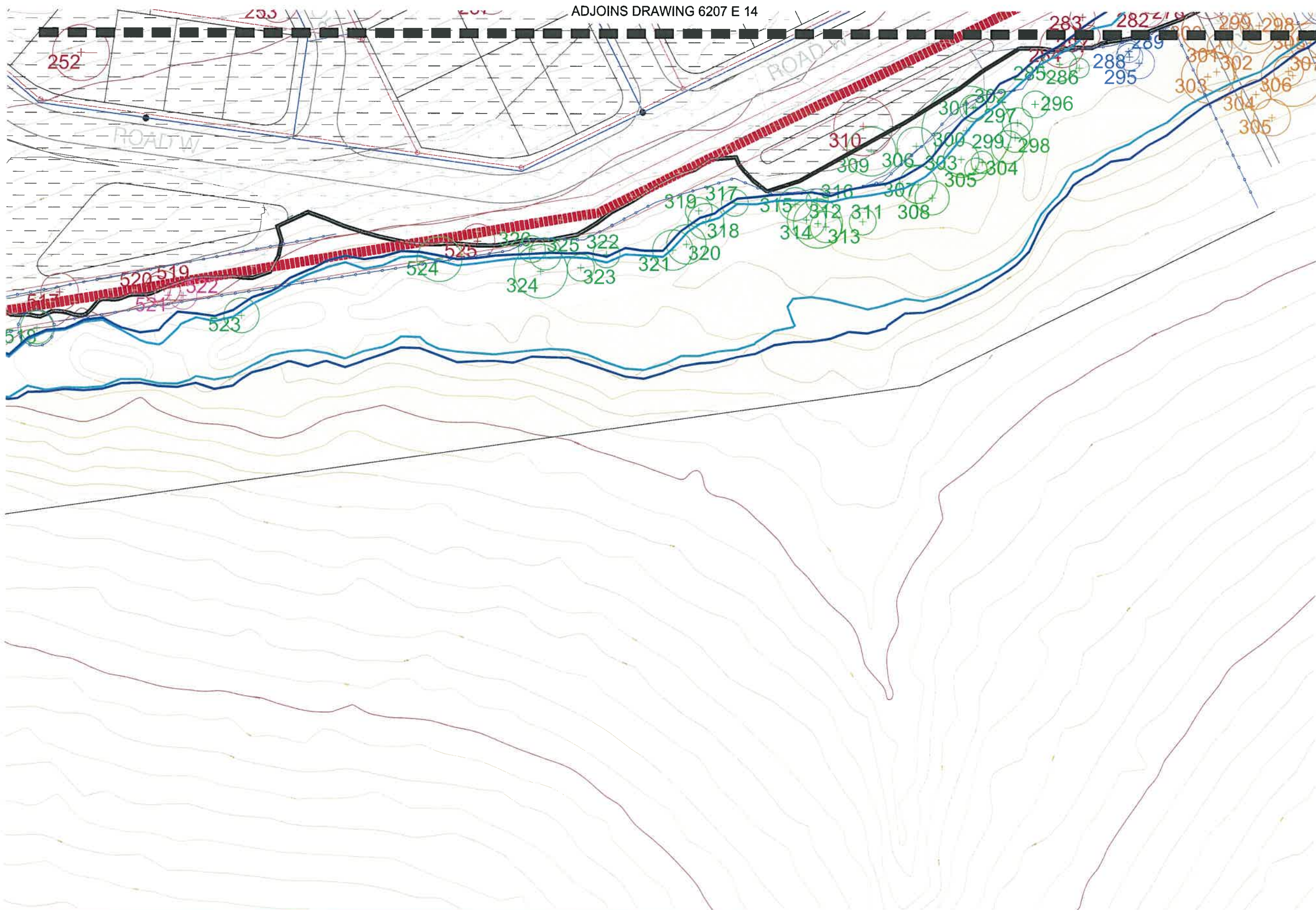

LEGEND

- RETAINED TREES:**
Trees to be retained and protected within open space area. Trees located on the edge of earth works extent of works line are subject to review on site by an arborist (if required).
- EXISTING TREES TO BE REMOVED:**
Trees to be removed as a result of the Internal Development Area clearing.
- EXISTING TREES TO BE REMOVED:**
Trees to be removed as a result of the sewerline corridor clearing area.
- EXISTING TREES TO BE RETAINED:**
Trees to be retained and protected outside of sewerline corridor. Trees located on the edge of road works are subject to review on site by an arborist (if required).
- EXISTING TREES TO BE REMOVED:**
Trees to be removed as a result of the Road way clearing area.
- EXISTING TREES TO BE RETAINED:**
Trees to be retained and protected outside of roadway. Trees located on the edge of road works are subject to review on site by an arborist (if required).
- CIVIL ENGINEER CUT AREA:**
Refer Engineering drawings for detail.
- CIVIL ENGINEER FILL AREA:**
Refer Engineering drawings for detail.
- EXCLUSION FENCING:**
Install exclusion fence to protect retained vegetation and rehabilitation works.
- INDICATIVE LOCATIONS OF STOCKPILE MATERIAL:**
Confirm locations on site at Pre Start meeting.
- INDICATIVE VEHICULAR ACCESS POINTS:**
Confirm best suited locations on site away from retained vegetation.
- EARTH WORKS EXTENT OF WORKS LINE:**
Refer Engineering drawings for detail.
- MAPPED REMNANT VEGETATION**
- FIRE BREAK (5M WIDTH):**
As per Bushfire Management Plan prepared by Jensen Bowers
- EXTENT OF CLEARING / SEPARATION REQUIRED:**
As per Bushfire Management Plan prepared by Jensen Bowers
- TRUNK SEWER:**
As per Engineering plans

NOTES:

Engineers and/ or clearing contractors to prepare sediment and erosion control measures to ensure no movement of material off site and minimal movement on site.

REFER 6207 E 22 FOR TREE SCHEDULES

Refer to Existing Tree Plot Schedule for detailed list of trees including number, Botanical name, girth, spread, height and determination of removal, investigation or retention.

Tree extents shown on this plan series are the Tree Protection Zones (TPZs) as specified in AS4970-2009.

KEY PLAN



AMENDMENTS:			
Issue	Date	Description	Checked
A	12/11/2014	CLIENT COMMENTS	MS
B	21/11/2014	SUBMISSION	MS
C	19/02/2015	EDQ RE-SUBMISSION	MS

CLIENT:
PEET FLAGSTONE CITY PTY LTD

PROJECT:
FLAGSTONE WEST STAGE 1

SCALE:
1:400@A1
1:800@A3

environmental management

DRAWING:
**VEGETATION MANAGEMENT PLAN
INTERNAL DEVELOPMENT AREA**

DATE: February 15	CHECKED: MS
CLIENT REF.: 6207	DRAWN: TB
DRAWING No.: 6207 E 19 VMP C	

J:\6207 Flagstone City, Jimboomba (Peet Limited)\Working Files\AutoCAD\VE - Vegetation (Assessment, Management and Rehabilitation) Plans\VMP Stage 1A-1D\6207 E 01 Vegetation Management Plan.dwg
ADJOINS DRAWING 6207 E 05

NOTE: The construction zone is set by Civil at 4.5 m from the sewer line. Construction methods will preferentially adopt access and construction zones along the allotment edge

AMENDED IN RED
23 DEC 2015
By: *Bradley Baulk* (name)
MEDQ

Retain Tree 537.
Implement ground
protection
measures in
accordance with
AS4970-2009.

Retain Tree 734.
Implement ground
protection
measures in
accordance with
AS4970-2009.

Retain Tree 737.
Implement ground
protection
measures in
accordance with
AS4970-2009.

Retain Tree 731.
Implement ground
protection
measures in
accordance with
AS4970-2009.

Retain Tree 430

NOTE 1:
Removal of shrubs within the nominated area of
remnant is required to ensure bushfire fuel load
requirements are achieved. Line work regarding fuel
reduction areas has been provided from the BMP.
Not trees are to be removed in this location and
where lower storey species are to be removed they
will be replaced by native ground cover and grass
species consistent with those occurring in the
surrounding areas.

NOTE:
In consultation with the project civil engineer a nominal 5m construction
access zone has been applied to one side and the base of each drainage
outlet structure. Only trees in direct conflict with the construction zone
are shown for removal as impacts are temporary and trees are located in
a bushland setting reducing risks associated with dieback and/or ultimate
loss.

- LEGEND**
- RETAINED TREES:
Trees to be retained and protected within open
space area. Trees located on the edge of earth
works extent of works line are subject to review
on site by an arborist (if required)
 - EXISTING TREES TO BE REMOVED:
Trees to be removed as a result of the Internal
Development Area clearing.
 - EXISTING TREES TO BE REMOVED:
Trees to be removed as a result of the sewerline
corridor clearing area.
 - EXISTING TREES TO BE RETAINED:
Trees to be retained and protected outside of
sewerline corridor. Trees located on the edge of
road works are subject to review on site by an
arborist (if required)
 - EXISTING TREES TO BE REMOVED:
Trees to be removed as a result of the Road
way clearing area.
 - EXISTING TREES TO BE RETAINED:
Trees to be retained and protected outside of
roadway. Trees located on the edge of road
works are subject to review on site by an
arborist (if required)
 - EXISTING TREES TO BE REMOVED:
Additional trees to be removed as a result of the
infrastructure requirements (sewer, basins etc)
 - CIVIL ENGINEER CUT AREA:
Refer Engineering drawings for detail
 - CIVIL ENGINEER FILL AREA:
Refer Engineering drawings for detail
 - EXCLUSION FENCING:
Install exclusion fence to protect retained
vegetation and rehabilitation works.
 - EARTH WORKS EXTENT OF
WORKS LINE:
Refer Engineering drawings for detail
 - MAPPED REMNANT VEGETATION
 - FIRE BREAK (5M WIDTH):
As per Bushfire Management Plan prepared by
Jensen Bowers
 - EXTENT OF CLEARING /
SEPARATION REQUIRED:
As per Bushfire Management Plan prepared by
Jensen Bowers
 - TRUNK SEWER:
As per Engineering plans
 - PROPOSED 250 WATER MAIN:
As per Engineering plans

NOTES:

Engineers and/or clearing contractors to prepare
sediment and erosion control measures to ensure
no movement of material off site and minimal
movement on site.

REFER 6207 E 22 FOR TREE SCHEDULES

Refer to Existing Tree Plot Schedule for detailed
list of trees including number, Botanical name,
girth, spread, height and determination of removal,
investigation or retention.

Tree extents shown on this plan series are the
Tree Protection Zones (TPZs) as specified in
AS4970-2009.

Where minor encroachment of a TPZ occurs for
as part of a temporary construction zone (eg
access to drainage structures) trees on the
waterway or bushland side of the works are
proposed on this VMP plan for retention. While it
may be possible that minor works result in the die
back or even loss of the tree its bushland context
does not result in increased risk to open space
users.



saunders havill group
saunders havill group Pty Ltd ABN 24 144 972 949
Brisbane • Emerald • Gladstone
head office 9 Thompson St Bowen Hills Q 4006
phone 800 123 5HG web www.saundershavill.com

■ surveying ■ town planning ■ urban design ■ environmental management ■ landscape architecture

DISCLAIMER:
Designs documented on this drawing are the property of Saunders Havill Group Pty Ltd and
are not to be reproduced or used in whole or part without written permission.
These plans have been prepared for the exclusive use of the client, Saunders Havill Group
do not accept responsibility for any use of or reliance upon the contents of these drawings
by any third party. Confirm all dimensions on site and clarify any discrepancies prior to
construction.

APPROVED COMPANY
ISO9001 Quality Management System
QMS

APPROVED COMPANY
ISO14001 Environmental Management System
QMS

AMENDMENTS:

Issue	Date	Description	Checked
A	12/11/2014	CLIENT COMMENTS	MS
B	21/11/2014	SUBMISSION	MS
C	19/02/2015	EDQ RE-SUBMISSION	MS
D	29/09/2015	EDQ RE-SUBMISSION	MS
E	27/10/2015	UPDATED ENGINEERING BASE	MS
F	08/12/2015	UPDATED ENGINEERING BASE	MS

CLIENT:
PEET FLAGSTONE CITY PTY LTD

PROJECT:
FLAGSTONE WEST STAGE 1A-1D

SCALE:
1:400@A1
1:800@A3

environmental management

DRAWING:
VEGETATION MANAGEMENT PLAN
INTERNAL DEVELOPMENT AREA

DATE: December 15
CLIENT REF.: 6207
DRAWING No.: 6207 E 06 VMP F

CHECKED: MS
DRAWN: TL

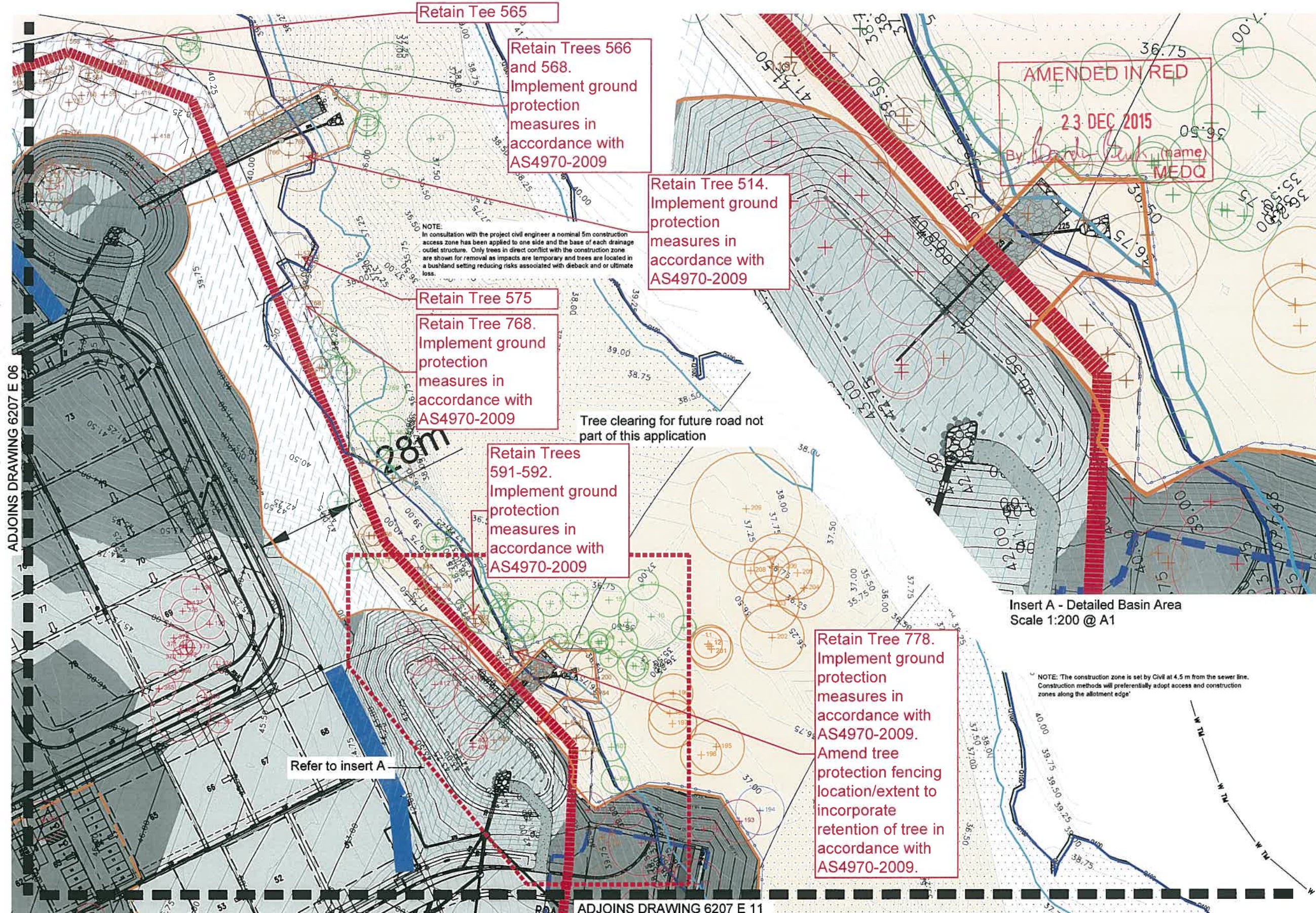

LEGEND

- RETAINED TREES:**
Trees to be retained and protected within open space area. Trees located on the edge of earth works extent of works line are subject to review on site by an arborist (if required).
- EXISTING TREES TO BE REMOVED:**
Trees to be removed as a result of the Internal Development Area clearing.
- EXISTING TREES TO BE REMOVED:**
Trees to be removed as a result of the sewerline corridor clearing area.
- EXISTING TREES TO BE RETAINED:**
Trees to be retained and protected outside of sewerline corridor. Trees located on the edge of road works are subject to review on site by an arborist (if required).
- EXISTING TREES TO BE REMOVED:**
Trees to be removed as a result of the Road way clearing area.
- EXISTING TREES TO BE RETAINED:**
Trees to be retained and protected outside of roadway. Trees located on the edge of road works are subject to review on site by an arborist (if required).
- EXISTING TREES TO BE REMOVED:**
Additional trees to be removed as a result of the infrastructure requirements (sewer, basins etc).
- CIVIL ENGINEER CUT AREA:**
Refer Engineering drawings for detail
- CIVIL ENGINEER FILL AREA:**
Refer Engineering drawings for detail
- EXCLUSION FENCING:**
Install exclusion fence to protect retained vegetation and rehabilitation works.
- EARTH WORKS EXTENT OF WORKS LINE:**
Refer Engineering drawings for detail
- MAPPED REMNANT VEGETATION**
- FIRE BREAK (5M WIDTH):**
As per Bushfire Management Plan prepared by Jensen Bowers
- EXTENT OF CLEARING / SEPARATION REQUIRED:**
As per Bushfire Management Plan prepared by Jensen Bowers
- TRUNK SEWER:**
As per Engineering plans
- PROPOSED 250 WATER MAIN:**
As per Engineering plans

NOTES:

Engineers and/or clearing contractors to prepare sediment and erosion control measures to ensure no movement of material off site and minimal movement on site.

REFER 6207 E 22 FOR TREE SCHEDULES

Refer to Existing Tree Plot Schedule for detailed list of trees including number, Botanical name, girth, spread, height and determination of removal, investigation or retention.

Tree extents shown on this plan series are the Tree Protection Zones (TPZs) as specified in AS4970-2009.

Where minor encroachment of a TPZ occurs for as part of a temporary construction zone (eg access to drainage structures) trees on the waterway or bushland side of the works are proposed on this VMP plan for retention. While it may be possible that minor works result in the die back or even loss of the tree its bushland context does not result in increased risk to open space users.

KEY PLAN



DISCLAIMER:

Designs documented on this drawing are the property of Saunders Havill Group Pty Ltd and are not to be used for any other project without the written consent of Saunders Havill Group Pty Ltd. These plans have been prepared for the exclusive use of the client, Saunders Havill Group Pty Ltd, and are not to be used for any other project without the written consent of Saunders Havill Group Pty Ltd. The client is responsible for ensuring that the plans are used in accordance with the intended purpose and for any other use or reliance upon the contents of these drawings by any third party. Copies of drawings on site and copy any discrepancies prior to construction.



AMENDMENTS:

Issue	Date	Description	Checked
A	12/11/2014	CLIENT COMMENTS	MS
B	21/11/2014	SUBMISSION	MS
C	19/02/2015	EDQ RE-SUBMISSION	MS
D	28/09/2015	EDQ RE-SUBMISSION	MS
E	27/10/2015	UPDATED ENGINEERING BASE	MS
F	08/12/2015	UPDATED ENGINEERING BASE	MS

CLIENT:

PEET FLAGSTONE CITY PTY LTD

PROJECT:

FLAGSTONE WEST STAGE 1A-1D

SCALE:

1:400@A1
1:800@A3

0 5 10 20m

environmental management

DRAWING:
VEGETATION MANAGEMENT PLAN
INTERNAL DEVELOPMENT AREA

DATE: December 15

CHECKED: MS

CLIENT REF.: 6207

DRAWN: TL

DRAWING No.: 6207 E 07 VMP F



LEGEND

- RETAINED TREES:**
Trees to be retained and protected within open space area. Trees located on the edge of earth works extent of works line are subject to review on site by an arborist (if required).
- EXISTING TREES TO BE REMOVED:**
Trees to be removed as a result of the Internal Development Area clearing.
- EXISTING TREES TO BE REMOVED:**
Trees to be removed as a result of the sewerline corridor clearing area.
- EXISTING TREES TO BE RETAINED:**
Trees to be retained and protected outside of sewerline corridor. Trees located on the edge of road works are subject to review on site by an arborist (if required).
- EXISTING TREES TO BE REMOVED:**
Trees to be removed as a result of the Road way clearing area.
- EXISTING TREES TO BE RETAINED:**
Trees to be retained and protected outside of roadway. Trees located on the edge of road works are subject to review on site by an arborist (if required).
- EXISTING TREES TO BE REMOVED:**
Additional trees to be removed as a result of the infrastructure requirements (sewer, basins etc)
- CIVIL ENGINEER CUT AREA:**
Refer Engineering drawings for detail
- CIVIL ENGINEER FILL AREA:**
Refer Engineering drawings for detail
- EXCLUSION FENCING:**
Install exclusion fence to protect retained vegetation and rehabilitation works.
- EARTH WORKS EXTENT OF WORKS LINE:**
Refer Engineering drawings for detail
- MAPPED REMNANT VEGETATION**
- FIRE BREAK (5M WIDTH):**
As per Bushfire Management Plan prepared by Jensen Bowers
- EXTENT OF CLEARING / SEPARATION REQUIRED:**
As per Bushfire Management Plan prepared by Jensen Bowers
- TRUNK SEWER:**
As per Engineering plans
- PROPOSED 250 WATER MAIN:**
As per Engineering plans

NOTES:

Engineers and/ or clearing contractors to prepare sediment and erosion control measures to ensure no movement of material off site and minimal movement on site.

REFER 6207 E 22 FOR TREE SCHEDULES

Refer to Existing Tree Plot Schedule for detailed list of trees including number, Botanical name, girth, spread, height and determination of removal, investigation or retention.

Tree extents shown on this plan series are the Tree Protection Zones (TPZs) as specified in AS4970-2009.

Where minor encroachment of a TPZ occurs for as part of a temporary construction zone (eg access to drainage structures) trees on the waterway or bushland side of the works are proposed on this VMP plan for retention. While it may be possible that minor works result in the die back or even loss of the tree its bushland context does not result in increased risk to open space users.

KEY PLAN

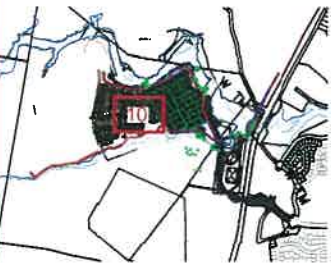

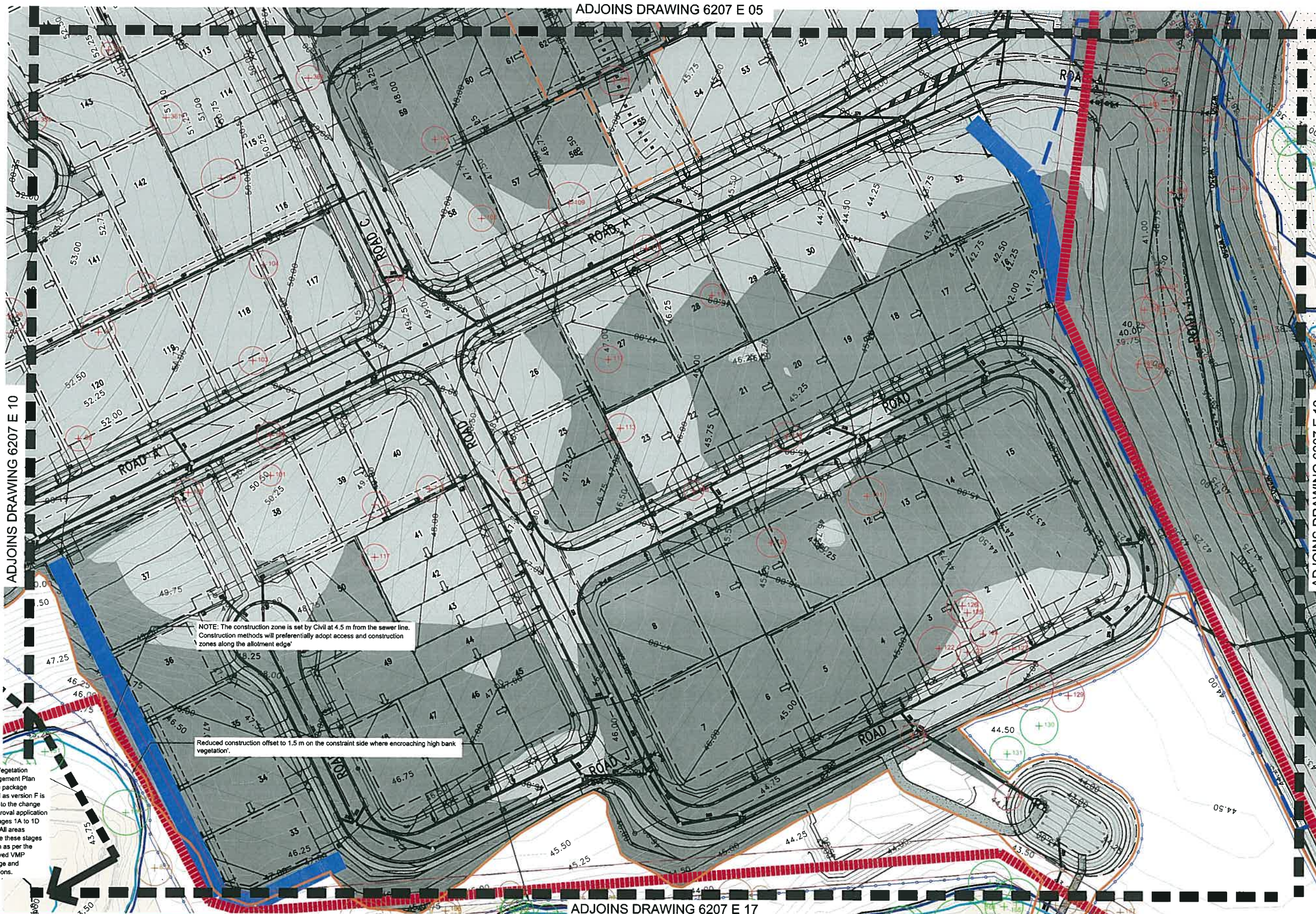

LEGEND

- RETAINED TREES:**
Trees to be retained and protected within open space area. Trees located on the edge of earth works extent of works line are subject to review on site by an arborist (if required).
- EXISTING TREES TO BE REMOVED:**
Trees to be removed as a result of the Internal Development Area clearing.
- EXISTING TREES TO BE REMOVED:**
Trees to be removed as a result of the sewerline corridor clearing area.
- EXISTING TREES TO BE RETAINED:**
Trees to be retained and protected outside of sewerline corridor. Trees located on the edge of road works are subject to review on site by an arborist (if required).
- EXISTING TREES TO BE REMOVED:**
Trees to be removed as a result of the Road way clearing area.
- EXISTING TREES TO BE RETAINED:**
Trees to be retained and protected outside of roadway. Trees located on the edge of road works are subject to review on site by an arborist (if required).
- EXISTING TREES TO BE REMOVED:**
Additional trees to be removed as a result of the infrastructure requirements (sewer, basins etc).
- CIVIL ENGINEER CUT AREA:**
Refer Engineering drawings for detail
- CIVIL ENGINEER FILL AREA:**
Refer Engineering drawings for detail
- EXCLUSION FENCING:**
Install exclusion fence to protect retained vegetation and rehabilitation works.
- EARTH WORKS EXTENT OF WORKS LINE:**
Refer Engineering drawings for detail
- MAPPED REMNANT VEGETATION**
- FIRE BREAK (5M WIDTH):**
As per Bushfire Management Plan prepared by Jensen Bowers
- EXTENT OF CLEARING / SEPARATION REQUIRED:**
As per Bushfire Management Plan prepared by Jensen Bowers
- TRUNK SEWER:**
As per Engineering plans
- PROPOSED 250 WATER MAIN:**
As per Engineering plans

NOTES:

Engineers and/ or clearing contractors to prepare sediment and erosion control measures to ensure no movement of material off site and minimal movement on site.

REFER 6207 E 22 FOR TREE SCHEDULES

Refer to Existing Tree Plot Schedule for detailed list of trees including number, Botanical name, girth, spread, height and determination of removal, investigation or retention.

Tree extents shown on this plan series are the Tree Protection Zones (TPZs) as specified in AS4970-2009.

Where minor encroachment of a TPZ occurs for as part of a temporary construction zone (eg access to drainage structures) trees on the waterway or bushland side of the works are proposed on this VMP plan for retention. While it may be possible that minor works result in the die back or even loss of the tree its bushland context does not result in increased risk to open space users.

KEY PLAN



Saunders Havill Group Pty Ltd ABN 24 144 972 949
Brisbane • Emerald • Gladstone
head office 9 Thompson St Bowen Hills Q 4006
phone 1300 123 SHG web www.saundershavill.com

• surveying • town planning • urban design • environmental management • landscape architecture

DISCLAIMER:

Designs documented on this drawing are the property of Saunders Havill Group Pty Ltd and are not to be reproduced or used in whole or part without written permission.

These plans have been prepared for the exclusive use of the client, Saunders Havill Group do not accept responsibility for any use of or reliance upon the contents of these drawings by any third party. Confirm all dimensions on site and clarify any discrepancies prior to construction.



AMENDMENTS:

Issue	Date	Description	Checked
A	12/11/2014	CLIENT COMMENTS	MS
B	21/11/2014	SUBMISSION	MS
C	19/02/2015	EDO RE-SUBMISSION	MS
D	29/09/2015	EDO RE-SUBMISSION	MS
E	27/10/2015	UPDATED ENGINEERING BASE	MS
F	08/12/2015	UPDATED ENGINEERING BASE	MS

CLIENT:

PEET FLAGSTONE CITY PTY LTD

PROJECT:

FLAGSTONE WEST STAGE 1A-1D

SCALE:

1:400@A1
1:800@A3

0 5 10 20m

environmental management

DRAWING:
VEGETATION MANAGEMENT PLAN
INTERNAL DEVELOPMENT AREA

DATE: December 15

CHECKED: MS

CLIENT REF.: 6207

DRAWN: TL

DRAWING No.: 6207 E 11 VMP F

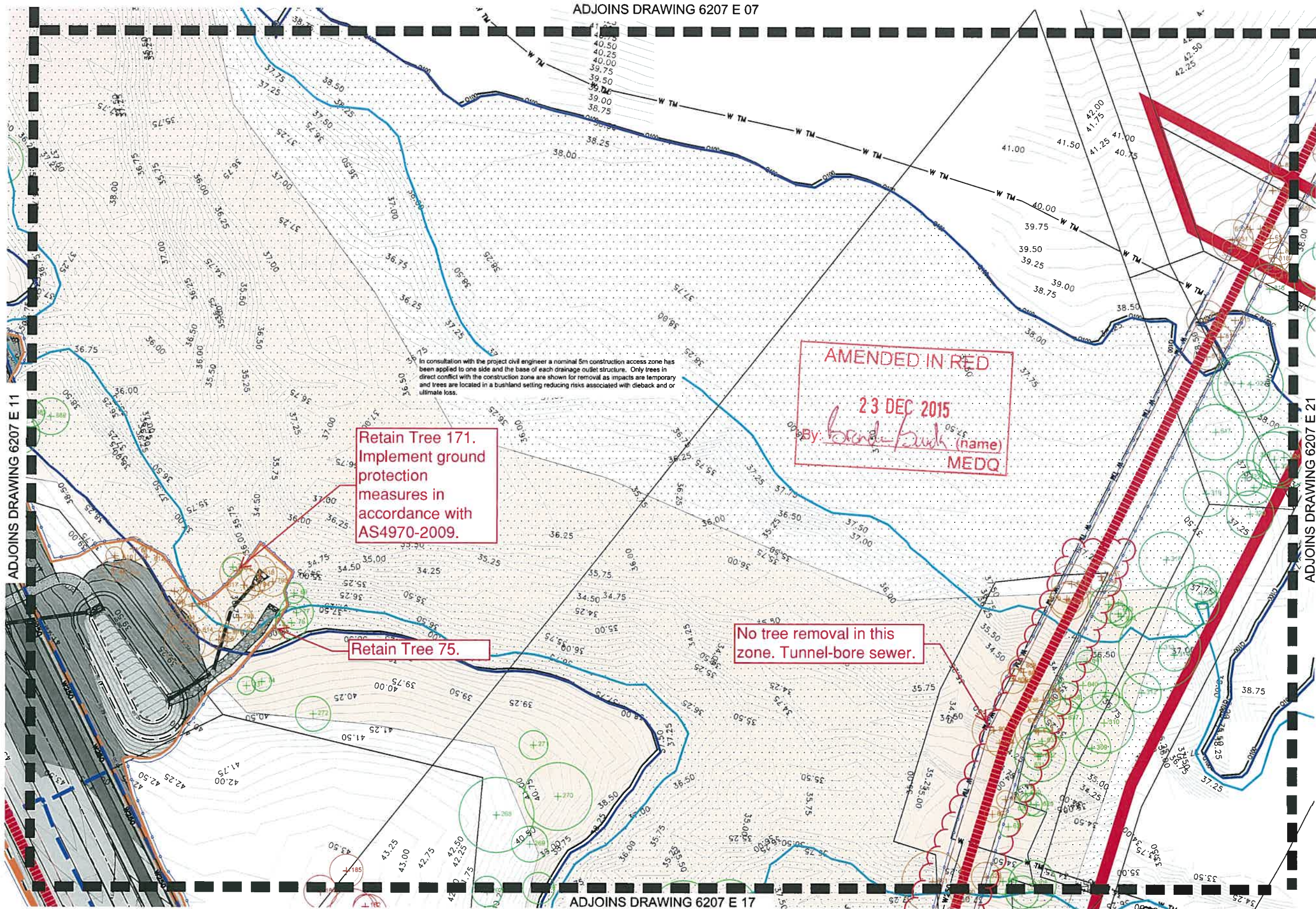

LEGEND

- RETAINED TREES:**
Trees to be retained and protected within open space area. Trees located on the edge of earth works extent of works line are subject to review on site by an arborist (if required).
- EXISTING TREES TO BE REMOVED:**
Trees to be removed as a result of the Internal Development Area clearing.
- EXISTING TREES TO BE RETAINED:**
Trees to be retained and protected outside of sewerline corridor. Trees located on the edge of road works are subject to review on site by an arborist (if required).
- EXISTING TREES TO BE REMOVED:**
Trees to be removed as a result of the Road way clearing area.
- EXISTING TREES TO BE RETAINED:**
Trees to be retained and protected outside of roadway. Trees located on the edge of road works are subject to review on site by an arborist (if required).
- EXISTING TREES TO BE REMOVED:**
Additional trees to be removed as a result of the infrastructure requirements (sewer, basins etc).
- CIVIL ENGINEER CUT AREA:**
Refer Engineering drawings for detail
- CIVIL ENGINEER FILL AREA:**
Refer Engineering drawings for detail
- EXCLUSION FENCING:**
Install exclusion fence to protect retained vegetation and rehabilitation works.
- EARTH WORKS EXTENT OF WORKS LINE:**
Refer Engineering drawings for detail
- MAPPED REMNANT VEGETATION**
- FIRE BREAK (5M WIDTH):**
As per Bushfire Management Plan prepared by Jensen Bowers
- EXTENT OF CLEARING / SEPARATION REQUIRED:**
As per Bushfire Management Plan prepared by Jensen Bowers
- TRUNK SEWER:**
As per Engineering plans
- PROPOSED 250 WATER MAIN:**
As per Engineering plans

NOTES:

Engineers and/ or clearing contractors to prepare sediment and erosion control measures to ensure no movement of material off site and minimal movement on site.

REFER 6207 E 22 FOR TREE SCHEDULES

Refer to Existing Tree Plot Schedule for detailed list of trees including number, Botanical name, girth, spread, height and determination of removal, investigation or retention.

Tree extents shown on this plan series are the Tree Protection Zones (TPZs) as specified in AS4970-2009.

Where minor encroachment of a TPZ occurs for as part of a temporary construction zone (eg access to drainage structures) trees on the waterway or bushland side of the works are proposed on this VMP plan for retention. While it may be possible that minor works result in the die back or even loss of the tree its bushland context does not result in increased risk to open space users.

KEY PLAN



Issue	Date	Description	Checked
A	12/11/2014	CLIENT COMMENTS	MS
B	21/11/2014	SUBMISSION	MS
C	19/02/2015	EDQ RE-SUBMISSION	MS
D	29/09/2015	EDQ RE-SUBMISSION	MS
E	27/10/2015	UPDATED ENGINEERING BASE	MS
F	08/12/2015	UPDATED ENGINEERING BASE	MS

CLIENT: PEET FLAGSTONE CITY PTY LTD	PROJECT: FLAGSTONE WEST STAGE 1A-1D
SCALE: 1:400@A1 1:800@A3	DATE: December 15 CLIENT REF.: 6207 DRAWING No.: 6207 E 12 VMP F
CHECKED: MS DRAWN: TL	

J:\6207 Flagstone City, Jimboomba (Peet Limited)\Working Files\AutoCAD - Vegetation Management and Rehabilitation\Plans\VMP Stage 1A-1D\6207 E 01 Vegetation Management Plan.dwg

ADJOINS DRAWING 6207 E 11

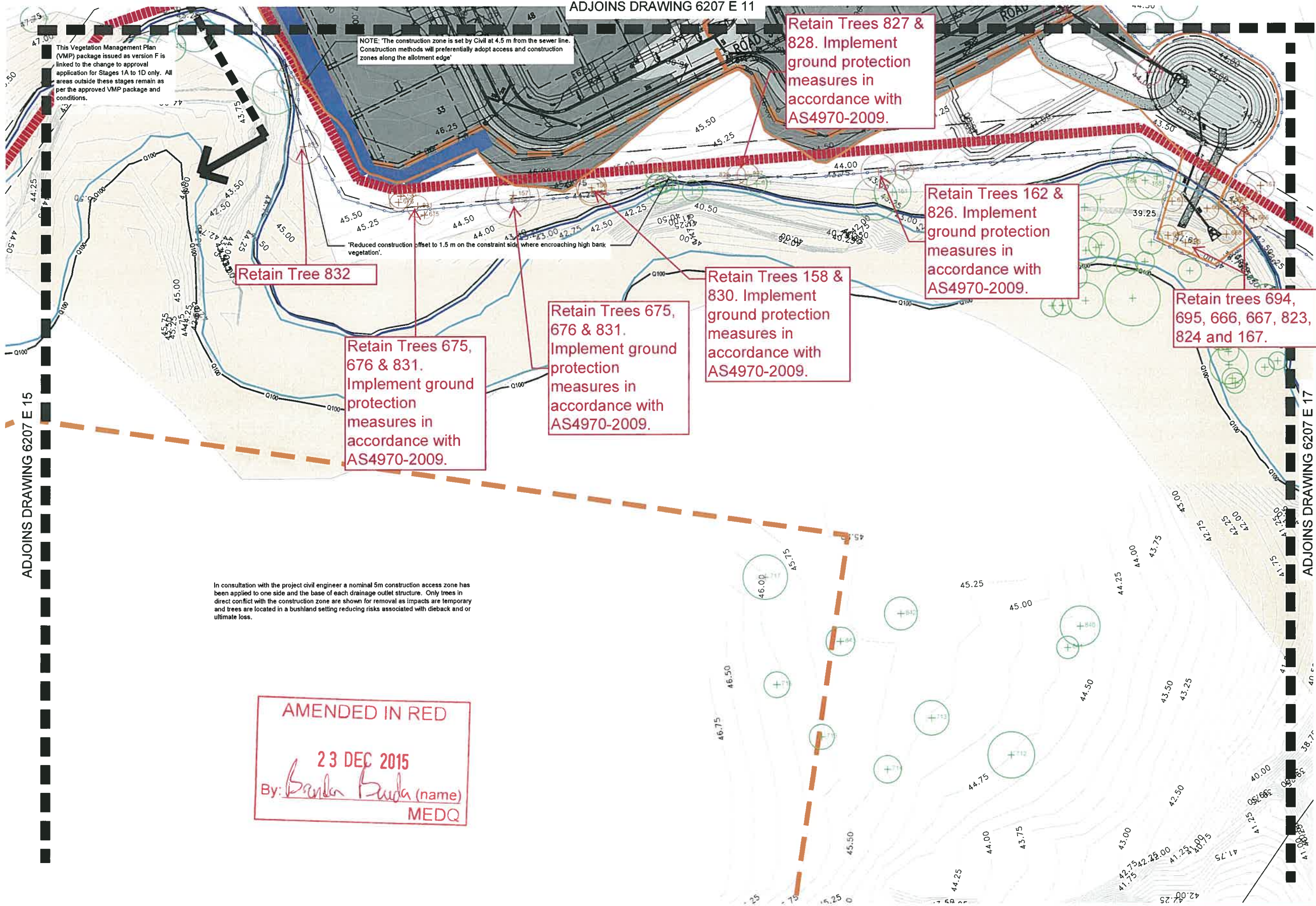

LEGEND

- RETAINED TREES:**
 - Trees to be retained and protected within open space area. Trees located on the edge of earth work extent of works line are subject to review on site by an arborist (if required).
- EXISTING TREES TO BE REMOVED:**
 - Trees to be removed as a result of the Internal Development Area clearing.
- EXISTING TREES TO BE REMOVED:**
 - Trees to be removed as a result of the sewerline corridor clearing area.
- EXISTING TREES TO BE RETAINED:**
 - Trees to be retained and protected outside of sewerline corridor. Trees located on the edge of road works are subject to review on site by an arborist (if required).
- EXISTING TREES TO BE REMOVED:**
 - Trees to be removed as a result of the Road way clearing area.
- EXISTING TREES TO BE RETAINED:**
 - Trees to be retained and protected outside of roadway. Trees located on the edge of road works are subject to review on site by an arborist (if required).
- EXISTING TREES TO BE REMOVED:**
 - Additional trees to be removed as a result of the infrastructure requirements (sewer, basins etc).
- CIVIL ENGINEER CUT AREA:**
 - Refer Engineering drawings for detail
- CIVIL ENGINEER FILL AREA:**
 - Refer Engineering drawings for detail
- EXCLUSION FENCING:**
 - Install exclusion fence to protect retained vegetation and rehabilitation works.
- EARTH WORKS EXTENT OF WORKS LINE:**
 - Refer Engineering drawings for detail
- MAPPED REMNANT VEGETATION**
- FIRE BREAK (5M WIDTH):**
 - As per Bushfire Management Plan prepared by Jensen Bowers
- EXTENT OF CLEARING / SEPARATION REQUIRED:**
 - As per Bushfire Management Plan prepared by Jensen Bowers
- TRUNK SEWER:**
 - As per Engineering plans
- PROPOSED 250 WATER MAIN:**
 - As per Engineering plans

NOTES:

Engineers and/ or clearing contractors to prepare sediment and erosion control measures to ensure no movement of material off site and minimal movement on site.

REFER 6207 E 22 FOR TREE SCHEDULES

Refer to Existing Tree Plot Schedule for detailed list of trees including number, Botanical name, girth, spread, height and determination of removal, investigation or retention.

Tree extents shown on this plan series are the Tree Protection Zones (TPZs) as specified in AS4970-2009.

Where minor encroachment of a TPZ occurs for as part of a temporary construction zone (eg access to drainage structures) trees on the waterway or bushland side of the works are proposed on this VMP plan for retention. While it may be possible that minor works result in the die back or even loss of the tree its bushland context does not result in increased risk to open space users.

KEY PLAN

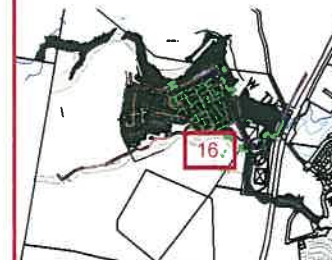

saunders havill group
Saunders Havill Group Pty Ltd ABN 24 144 972 949
Brisbane • Emerald • Gladstone
head office 9 Thompson St Bowen Hills Q 4006
phone 1300 123 SHG web www.saundershavill.com
surveying • town planning • urban design • environmental management • landscape architecture

DISCLAIMER:
Designs documented on this drawing are the property of Saunders Havill Group Pty Ltd and are not to be reproduced or used in whole or part without written permission.
These plans have been prepared for the exclusive use of the client. Saunders Havill Group do not accept responsibility for any use of or reliance upon the contents of these drawings by any third party. Confirm all dimensions on site and clarify any discrepancies prior to construction.

APPROVED COMPANY
ISO9001
Quality
Management
System
QMS

APPROVED COMPANY
ISO14001
Environmental
Management
System
QMS

AMENDMENTS:			
Issue	Date	Description	Checked
A	12/11/2014	CLIENT COMMENTS	MS
B	21/11/2014	SUBMISSION	MS
C	19/02/2015	EDQ RE-SUBMISSION	MS
D	29/09/2015	EDQ RE-SUBMISSION	MS
E	27/10/2015	UPDATED ENGINEERING BASE	MS
F	08/12/2015	UPDATED ENGINEERING BASE	MS

CLIENT:
PEET FLAGSTONE CITY PTY LTD

PROJECT:
FLAGSTONE WEST STAGE 1A-1D

SCALE:
1:400@A1
1:800@A3

environmental management

DRAWING:
VEGETATION MANAGEMENT PLAN
INTERNAL DEVELOPMENT AREA

DATE: December 15
CHECKED: MS

CLIENT REF.: 6207
DRAWN: TL

DRAWING No.: 6207 E 16 VMP F

ADJOINS DRAWING 6207 E 12

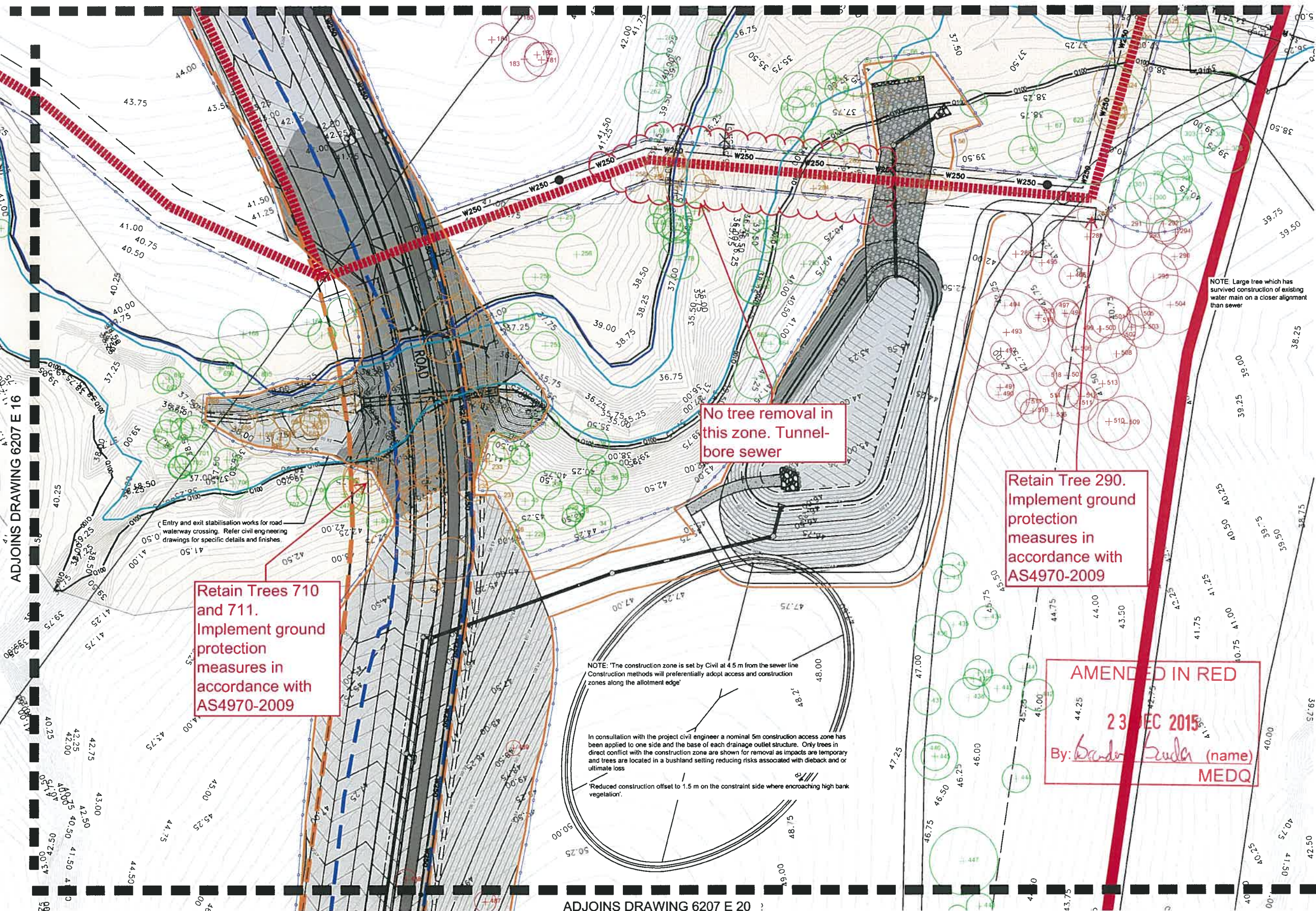

LEGEND

- RETAINED TREES:**
Trees to be retained and protected within open space area. Trees located on the edge of earth works extent of works line are subject to review on site by an arborist (if required).
- EXISTING TREES TO BE REMOVED:**
Trees to be removed as a result of the Internal Development Area clearing.
- EXISTING TREES TO BE REMOVED:**
Trees to be removed as a result of the sewerline corridor clearing area.
- EXISTING TREES TO BE RETAINED:**
Trees to be retained and protected outside of sewer line corridor. Trees located on the edge of road works are subject to review on site by an arborist (if required).
- EXISTING TREES TO BE REMOVED:**
Trees to be removed as a result of the Road way clearing area.
- EXISTING TREES TO BE RETAINED:**
Trees to be retained and protected outside of roadway. Trees located on the edge of road works are subject to review on site by an arborist (if required).
- EXISTING TREES TO BE REMOVED:**
Additional trees to be removed as a result of the Infrastructure requirements (sewer, basins etc).
- CIVIL ENGINEER CUT AREA:**
Refer Engineering drawings for detail
- CIVIL ENGINEER FILL AREA:**
Refer Engineering drawings for detail
- EXCLUSION FENCING:**
Install exclusion fence to protect retained vegetation and rehabilitation works.
- EARTH WORKS EXTENT OF WORKS LINE:**
Refer Engineering drawings for detail
- MAPPED REMNANT VEGETATION**
- FIRE BREAK (5M WIDTH):**
As per Bushfire Management Plan prepared by Jensen Bowers
- EXTENT OF CLEARING / SEPARATION REQUIRED:**
As per Bushfire Management Plan prepared by Jensen Bowers
- TRUNK SEWER:**
As per Engineering plans
- PROPOSED 250 WATER MAIN:**
As per Engineering plans

NOTES:

Engineers and/ or clearing contractors to prepare sediment and erosion control measures to ensure no movement of material off site and minimal movement on site.

REFER 6207 E 22 FOR TREE SCHEDULES

Refer to Existing Tree Plot Schedule for detailed list of trees including number, Botanical name, girth, spread, height and determination of removal, investigation or retention.

Tree extents shown on this plan series are the Tree Protection Zones (TPZs) as specified in AS4970-2009.

Where minor encroachment of a TPZ occurs for as part of a temporary construction zone (eg access to drainage structures) trees on the waterway or bushland side of the works are proposed on this VMP plan for retention. While it may be possible that minor works result in the die back or even loss of the tree its bushland context does not result in increased risk to open space users.

KEY PLAN

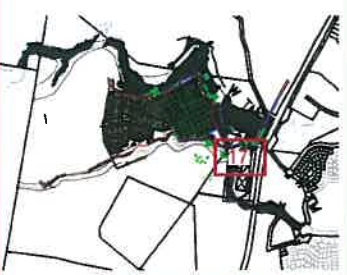

DISCLAIMER:

Designs documented on this drawing are the property of Saunders Havill Group Pty Ltd and are not to be reproduced or used in whole or part without written permission.

This plan has been prepared for the exclusive use of the client. Saunders Havill Group does not accept responsibility for any use of or reliance upon the contents of these drawings by any third party. Confirm all dimensions on site and clarify any discrepancies prior to construction.



AMENDMENTS:

Issue	Date	Description	Checked
A	12/11/2014	CLIENT COMMENTS	MS
B	21/11/2014	SUBMISSION	MS
C	19/02/2015	EDO RE-SUBMISSION	MS
D	29/09/2015	EDO RE-SUBMISSION	MS
E	27/10/2015	UPDATED ENGINEERING BASE	MS
F	08/12/2015	UPDATED ENGINEERING BASE	MS

CLIENT:

PEET FLAGSTONE CITY PTY LTD

PROJECT:

FLAGSTONE WEST STAGE 1A-1D

SCALE:

1:400@A1
1:800@A3

environmental management

DRAWING:
VEGETATION MANAGEMENT PLAN
INTERNAL DEVELOPMENT AREA

DATE: December 15

CHECKED: MS

CLIENT REF.: 6207

DRAWN: TL

DRAWING No.: 6207 E 17 VMP F

ADJOINS DRAWING 6207 E 18

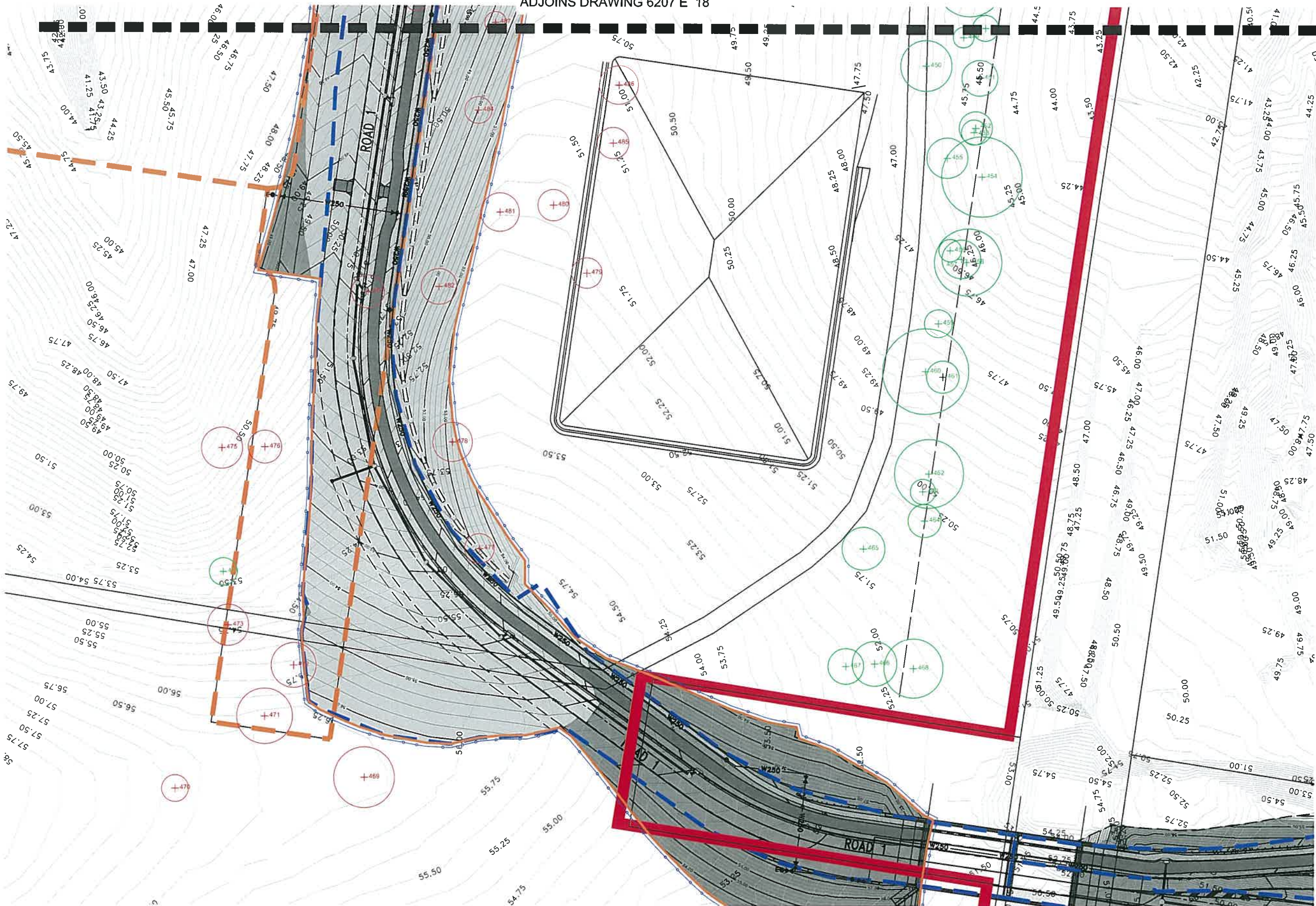

LEGEND

- RETAINED TREES:**
Trees to be retained and protected within open space area. Trees located on the edge of earth works extent of works line are subject to review on site by an arborist (if required).
- EXISTING TREES TO BE REMOVED:**
Trees to be removed as a result of the Internal Development Area clearing.
- EXISTING TREES TO BE RETAINED:**
Trees to be retained and protected outside of sewerline corridor. Trees located on the edge of road works are subject to review on site by an arborist (if required).
- EXISTING TREES TO BE REMOVED:**
Trees to be removed as a result of the Road way clearing area.
- EXISTING TREES TO BE RETAINED:**
Trees to be retained and protected outside of roadway. Trees located on the edge of road works are subject to review on site by an arborist (if required).
- EXISTING TREES TO BE REMOVED:**
Additional trees to be removed as a result of the infrastructure requirements (sewer, basins etc).
- CIVIL ENGINEER CUT AREA:**
Refer Engineering drawings for detail
- CIVIL ENGINEER FILL AREA:**
Refer Engineering drawings for detail
- EXCLUSION FENCING:**
Install exclusion fence to protect retained vegetation and rehabilitation works.
- EARTH WORKS EXTENT OF WORKS LINE:**
Refer Engineering drawings for detail
- MAPPED REMNANT VEGETATION**
- FIRE BREAK (5M WIDTH):**
As per Bushfire Management Plan prepared by Jensen Bowers
- EXTENT OF CLEARING / SEPARATION REQUIRED:**
As per Bushfire Management Plan prepared by Jensen Bowers
- TRUNK SEWER:**
As per Engineering plans
- PROPOSED 250 WATER MAIN:**
As per Engineering plans

NOTES:

Engineers and/ or clearing contractors to prepare sediment and erosion control measures to ensure no movement of material off site and minimal movement on site.

REFER 6207 E 22 FOR TREE SCHEDULES

Refer to Existing Tree Plot Schedule for detailed list of trees including number, Botanical name, girth, spread, height and determination of removal, investigation or retention.

Tree extents shown on this plan series are the Tree Protection Zones (TPZs) as specified in AS4970-2009.

Where minor encroachment of a TPZ occurs for as part of a temporary construction zone (eg access to drainage structures) trees on the waterway or bushland side of the works are proposed on this VMP plan for retention. While it may be possible that minor works result in the die back or even loss of the tree its bushland context does not result in increased risk to open space users.

KEY PLAN



Saunders Havill Group Pty Ltd ABN 24 144 972 949
Brisbane • Emerald • Gladstone
head office 9 Thompson St Bowen Hills Q 4006
phone 1300 123 5HG web www.saundershavill.com

■ surveying ■ town planning ■ urban design ■ environmental management ■ landscape architecture

DISCLAIMER:
Designs documented on this drawing are the property of Saunders Havill Group Pty Ltd and are not to be reproduced or used in whole or part without written permission.
These plans have been prepared for the exclusive use of the client. Saunders Havill Group do not accept responsibility for any use of or reliance upon the contents of these drawings by any third party. Confirm all dimensions on site and clarify any discrepancies prior to construction.



AMENDMENTS:			
Issue	Date	Description	Checked
A	12/11/2014	CLIENT COMMENTS	MS
B	21/11/2014	SUBMISSION	MS
C	19/02/2015	EDQ RE-SUBMISSION	MS
D	29/09/2015	EDQ RE-SUBMISSION	MS
E	27/10/2015	UPDATED ENGINEERING BASE	MS
F	08/12/2015	UPDATED ENGINEERING BASE	MS

CLIENT:
PEET FLAGSTONE CITY PTY LTD

PROJECT:
FLAGSTONE WEST STAGE 1A-1D

SCALE:
1:400@A1
1:800@A3

environmental management

DRAWING:
VEGETATION MANAGEMENT PLAN
INTERNAL DEVELOPMENT AREA

DATE: December 15

CHECKED: MS

CLIENT REF.: 6207

DRAWN: TL

DRAWING No.: 6207 E 20 VMP F

\\N6207 Flagstone City, Jimboomba (Peet Limited)\Working Files\AutoCAD - Vegetation (Assessment, Management and Rehabilitation) Plans\N6207 E 01 Vegetation Management Plan.dwg

ADJOINS DRAWING 6207 E 12



LEGEND

- RETAINED TREES:**
Trees to be retained and protected within open space area. Trees located on the edge of earth works extent of works line are subject to review on site by an arborist (if required)
- EXISTING TREES TO BE REMOVED:**
Trees to be removed as a result of the Internal Development Area clearing.
- EXISTING TREES TO BE REMOVED:**
Trees to be removed as a result of the sewerline corridor clearing area.
- EXISTING TREES TO BE RETAINED:**
Trees to be retained and protected outside of sewerline corridor. Trees located on the edge of road works are subject to review on site by an arborist (if required)
- EXISTING TREES TO BE REMOVED:**
Trees to be removed as a result of the Road way clearing area.
- EXISTING TREES TO BE RETAINED:**
Trees to be retained and protected outside of roadway. Trees located on the edge of road works are subject to review on site by an arborist (if required)
- EXISTING TREES TO BE REMOVED:**
Additional trees to be removed as a result of the infrastructure requirements (sewer, basins etc)
- CIVIL ENGINEER CUT AREA:**
Refer Engineering drawings for detail
- CIVIL ENGINEER FILL AREA:**
Refer Engineering drawings for detail
- EXCLUSION FENCING:**
Install exclusion fence to protect retained vegetation and rehabilitation works.
- EARTH WORKS EXTENT OF WORKS LINE:**
Refer Engineering drawings for detail
- MAPPED REMNANT VEGETATION**
- FIRE BREAK (5M WIDTH):**
As per Bushfire Management Plan prepared by Jensen Bowers
- EXTENT OF CLEARING / SEPARATION REQUIRED:**
As per Bushfire Management Plan prepared by Jensen Bowers
- TRUNK SEWER:**
As per Engineering plans
- PROPOSED 250 WATER MAIN:**
As per Engineering plans

NOTES:

Engineers and/ or clearing contractors to prepare sediment and erosion control measures to ensure no movement of material off site and minimal movement on site.

REFER 6207 E 22 FOR TREE SCHEDULES

Refer to Existing Tree Plot Schedule for detailed list of trees including number, Botanical name, girth, spread, height and determination of removal, investigation or retention.

Tree extents shown on this plan series are the Tree Protection Zones (TPZs) as specified in AS4970-2009.

Where minor encroachment of a TPZ occurs for as part of a temporary construction zone (eg access to drainage structures) trees on the waterway or bushland side of the works are proposed on this VMP plan for retention. While it may be possible that minor works result in the die back or even loss of the tree its bushland context does not result in increased risk to open space users.

KEY PLAN



AMENDMENTS:		
Issue	Date	Description
A	12/11/2014	CLIENT COMMENTS
B	21/11/2014	SUBMISSION
C	19/02/2015	EDQ RE-SUBMISSION
D	29/09/2015	EDQ RE-SUBMISSION
E	27/10/2015	UPDATED ENGINEERING BASE
F	08/12/2015	UPDATED ENGINEERING BASE

CLIENT:
PEET FLAGSTONE CITY PTY LTD

PROJECT:
FLAGSTONE WEST STAGE 1A-1D

SCALE:
1:400@A1
1:800@A3

environmental management	
DRAWING: VEGETATION MANAGEMENT PLAN INTERNAL DEVELOPMENT AREA	
DATE: December 15	CHECKED: MS
CLIENT REF.: 6207	DRAWN: TL
DRAWING No.: 6207 E 21 VMP F	