

**FLAGSTONE  
STAGE 1O**  
for  
**PEET FLAGSTONE  
CITY PTY LTD**

**IMPORTANT NOTES:**  
This plan has been prepared for PEET FLAGSTONE CITY PTY LTD to Logan City Council, for the purpose of recording. As Constructed Details of a new service constructed under a specific Council Approval and should not be used for any other purpose.  
No report is made on any other services, nor any services that may exist before or be constructed after, the time of survey, or constructed under any other approval.  
The property boundaries, easements and lot numbers shown herein may be proposed only and subject to registration by the Department of Natural Resources. All property information should be determined from the registered Survey Plans.  
All dimensions should be verified and confirmed against the latest information prior to commencement by any person using this plan for building purposes.  
Veris Australia Pty Ltd accepts no responsibility for any changes made to construction or otherwise, after the date of this plan. Any discrepancies should be clarified in writing with the relevant Authority prior to commencement of the work.

Copyright © Veris Australia Pty Ltd, July, 2018.  
THESE SERVICES AND DRAWINGS ARE COPYRIGHTED AND ARE NOT TO BE USED OR REPRODUCED WITHOUT THE WRITTEN PERMISSION OF VERIS.  
Data Sources: Cadastral Boundaries: 2018; LCC Master/AS/FSM 2014-04; As-con survey: Veris; Business Memorandum: Engineering Design

Rev	Description	Date	By	Check
C	Issue	12/11/2018	JM	
B	Issue	07/11/2018	EM	
A	Progress Plot	05/09/2018	JM	
	Issue			Drawn

Local Authority: LCC  
Horizontal Meridian: MGA  
Vertical Level Datum: AHD D  
Level Origin: PM107142(RL9.078)  
Scale: 1:500 @ A1  
Surveyed: DE / LS  
Designed: BRADLEES  
Drawn: JMC  
Checked: JMC  
Plot Date: 12 Nov, 2018  
Computer File Ref: 430109-11151-ARW01-C.dwg

**AS-CONSTRUCTED  
ROOFWATER**



BRISBANE WHITSUNDAYS  
(07) 3954 8700 (07) 4944 5122  
MACKAY CAIRNS  
(07) 4951 2911 (07) 4951 6722  
veris.com.au  
ACN 615 730 727  
Veris Australia Pty Ltd

Drawing No: Issue  
**430109-11151-ARW01 C**

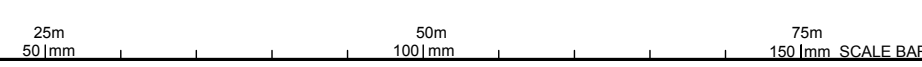



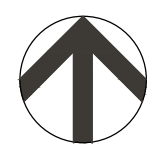

**FLAGSTONE  
STAGE 10**  
For  
**PEET FLAGSTONE  
CITY PTY LTD**

**IMPORTANT NOTES:**  
This Plan has been prepared for PEET FLAGSTONE CITY PTY LTD to register City elements for the purpose of recording the As-Constructed details of a new service constructed under a specific Council Approval and should not be used for any other purpose.  
No report is made on any other services, nor any services that may exist before or be constructed after the time of survey, or constructed under any other approval.  
The property boundaries, assessments and lot numbers shown herein may be proposed only and subject to registration by the Department of Natural Resources. All property information should be determined from the registered Survey Plans.  
All dimensions should be verified and confirmed against the latest information prior to commencement by any person using this plan for building purposes.  
Veris Australia Pty Ltd accepts no responsibility for any changes made to construction or otherwise, after the date of this plan. Any discrepancies should be clarified in writing with the relevant Authority prior to commencement of the work.

Copyright © Veris Australia Pty Ltd, July 2018  
These Issues and Drawings are COPYRIGHTED and ARE NOT TO BE USED OR REPRODUCED without the written permission of Veris.

**Data Sources**  
Cadastral Boundaries: 3010-LC-Master/AD/F84 2014-JHQ  
As-on survey: Veris  
Engineering Design: Bradlees Menhardt

Issue	Date	Drawn
A	15/10/18	JMC
B	17/10/18	JMC
C	19/10/18	JMC

Local Authority: LCC  
Horizontal Meridian: MGA  
Vertical Level Datum: AHD D  
Level Origin: PM107142(RL98.078)  
Scale: 1:500 @ A1  
Surveyed: DE JLS  
Designed: BRADLEES  
Drawn: JMC  
Checked: JMC  
Pick Date: 01 Nov, 2018  
Computer File Ref: 430109-11151-AS01-C.dwg

**AS-CONSTRUCTED  
SEWER  
RETICULATION**



**veris**  
BRISBANE WHITSUNDAYS  
(07) 466 4700 (07) 466 1122  
MACKAY CAIRNS  
(07) 466 12911 (07) 466 6722  
veris.com.au  
ACN 615 736 727  
Veris Australia Pty Ltd

Drawing No. Issue  
430109-11151-AS01 C

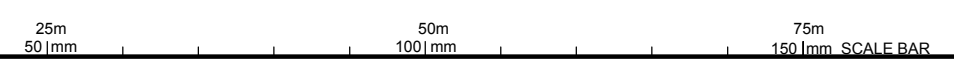





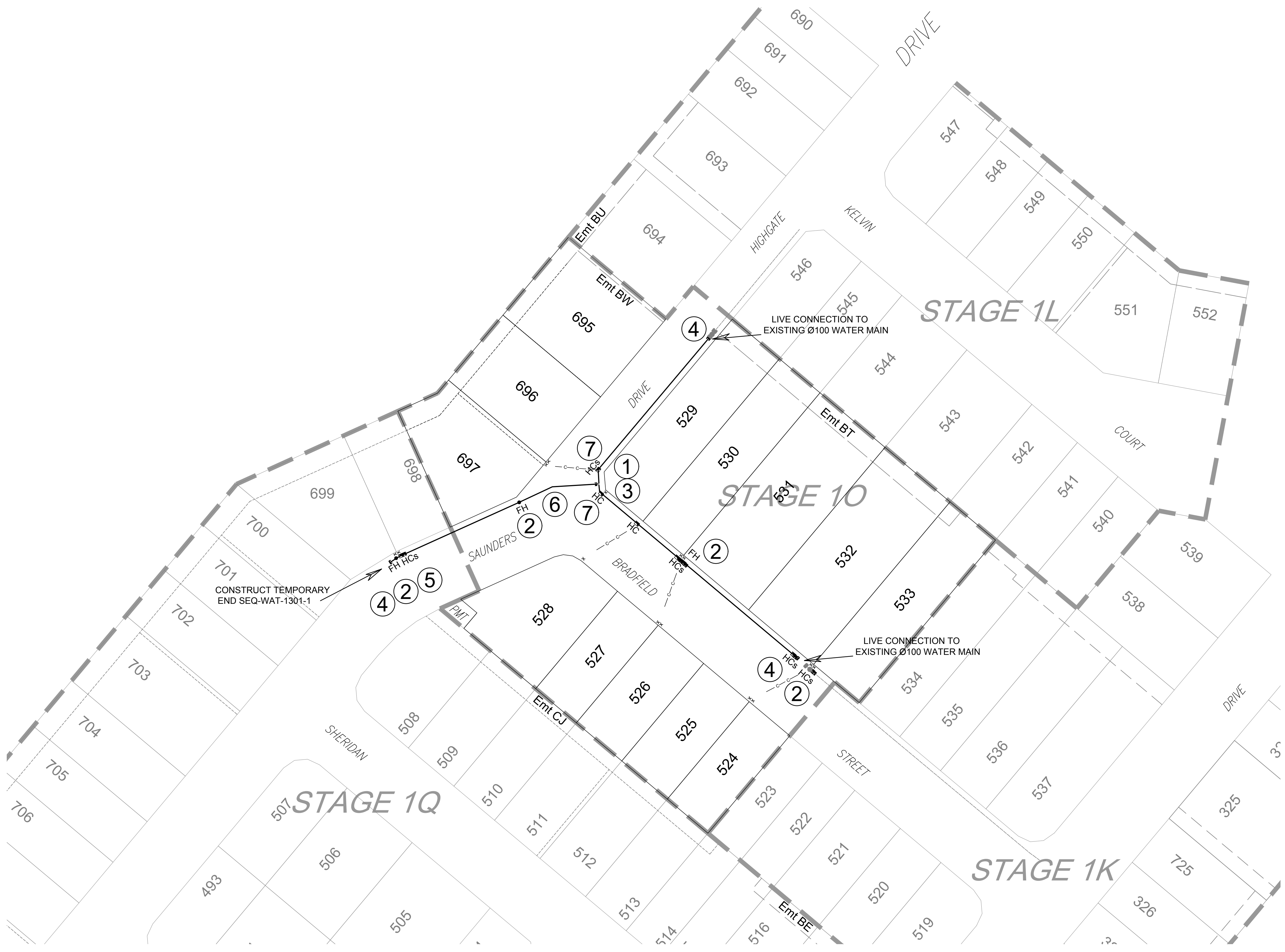

Consulting Engineer's Certification.

I, ..... hereby certify that the As Constructed information shown on this plan is a true and correct record of the sizes, types, materials, classes etc., and it corresponds with the relevant approved Engineering Drawings.

Signed..... RPEQ No ..... Dated.....

Registered Surveyor's Certification.

We, Veris Australia Pty Ltd ..... hereby certify that the horizontal and vertical locations, and dimensions shown on this plan are a true and correct record of the As Constructed information.

Signed *AJ. April* Cadastral Surveyor & Delegate Reg. No 6448  
 Dated 31/10/2018

**FLAGSTONE STAGE 10**  
**PEET FLAGSTONE CITY PTY LTD**

IMPORTANT NOTES:  
 This Plan has been prepared for PEET FLAGSTONE CITY PTY LTD to assist in the construction of a new service constructed under a specific Council Approval and should not be used for any other purpose.  
 No report is made on any other services, nor any services that may exist before or be constructed after the time of survey, or constructed under any other approval.  
 The property boundaries, easements and lot numbers shown herein may be proposed only and subject to registration by the Department of Natural Resources. All property information should be determined from the registered Survey Plans.  
 All dimensions should be verified and confirmed against the latest information prior to commencement by any person using this plan for building purposes.  
 Veris Australia Pty Ltd accepts no responsibility for any changes made to construction or otherwise, after the date of this plan. Any discrepancies should be clarified in writing with the relevant Authority prior to commencement of the work.  
 Copyright © Veris Australia Pty Ltd, July 2018  
 THESE DRAWINGS AND DRAWINGS ARE COPYRIGHTED AND ARE NOT TO BE USED OR REPRODUCED WITHOUT THE WRITTEN PERMISSION OF VERIS  
 Data Sources: 3010-L-Classes/AD/F84 2014-4kg  
 As-con survey: Veris  
 Engineering Design: Bradlees Merchants

**LEGEND**

Ø100 PVC-O Pipe ————  
 Ø100 uPVC CONDUIT ————  
 House Connection ————  
 Service Point(Indicative) x

- ① Ø100 Stop Valve
- ② Ø100 Fire Hydrant
- ③ Ø100 x Ø100 Tee (14.0kN)
- ④ Ø100 Dead End Cap (14.0kN)
- ⑤ Ø100 11.25° BEND (2.7kN)
- ⑥ Ø100 22.5° BEND (5.5kN)
- ⑦ Ø100 45° BEND (10.7kN)

Rev	Description	Date	By	Check
C	Remove valve & hydrant	31.10.2018	JMC	
B	Progress Plot	18.10.2018	JMC	
A	Progress Plot	24.10.2018	JMC	
1	Issue	31.10.2018	JMC	

**AS-CONSTRUCTED WATER RETICULATION**

**veris**

BRISBANE 071 968 4700 WHITSUNDAYS 071 464 1122  
 MACKAY 071 464 2911 CAIRNS 071 464 6722

veris.com.au  
 ACN 615 736 727  
 Veris Australia Pty Ltd

Drawing No. 430109-11151-AW01 C Issue

